

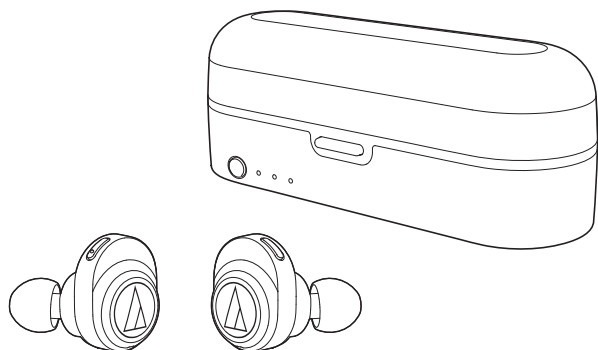

# ATH-CKR7TW

**User Manual**  
Wireless Headphones



# Introduction

Thank you for purchasing this Audio-Technica product.

Before using the product, please read through the Quick Start Guide and Caution Guide, as well as this user manual when necessary, to ensure that you use the product correctly.

## Safety precautions

Although this product was designed to be used safely, failing to use it correctly may result in an accident. To ensure safety, observe all warnings and cautions while using the product.

### Cautions for the product

- Do not use the product near medical equipment. Radio waves may affect cardiac pacemakers and medical electronic equipment. Do not use the product inside medical facilities.
- When using the product in aircraft, follow airline instructions.
- Do not use the product near automatic control devices such as automatic doors and fire alarms. Radio waves may affect electronic equipment and cause accidents due to malfunction.
- Do not disassemble, modify or attempt to repair the product to avoid electric shock, malfunction or fire.
- Do not subject the product to strong impact to avoid electric shock, malfunction or fire.
- Do not handle the product with wet hands to avoid electric shock or injury.
- Disconnect the product from a device if the product begins to malfunction, producing smoke, odor, heat, unwanted noise or showing other signs of damage. In such a case, contact your local Audio-Technica dealer.
- Do not allow the product to get wet to avoid electric shock or malfunction.
- Do not put foreign matter such as combustible materials, metal, or liquid in the product.
- Do not cover the product with a cloth to avoid fire or injury by overheating.
- Follow applicable laws regarding mobile phone and headphone use if using headphones while driving.
- Do not use the product in places where the inability to hear ambient sound presents a serious risk (such as at railroad crossings, train stations, and construction sites).
- Keep out of reach of small children.
- When charging, make sure to use the included USB charging cable.
- Do not charge with devices that have quick-charge functionality (with a voltage of 5 V or more). Doing so may cause the product to malfunction.
- To prevent damage to your hearing, do not raise the volume too high. Listening to loud sound for an extended period may cause temporary or permanent hearing loss.
- Discontinue use if skin irritation results from direct contact with the product.
- If you begin to feel unwell while using the product, discontinue use immediately.
- When removing from your ears, check to make sure the silicone part is still attached to the product. If the silicone part becomes lodged in your ears and you are unable to remove it, consult a physician at once.
- If you develop an itch from wearing the product, discontinue use.

# Safety precautions

## Cautions for rechargeable battery

The product is equipped with a rechargeable battery (lithium polymer battery).

- If battery fluid gets into eyes, do not rub them. Rinse thoroughly with clean water such as tap water and consult a doctor immediately.
- If battery fluid leaks, do not touch fluid with bare hands. If fluid remains inside the product, it may cause malfunction. If battery fluid leaks, contact your local Audio-Technica dealer.
  - If fluid gets in your mouth, gargle thoroughly with clean water such as tap water and consult a doctor immediately.
  - If your skin or clothing comes in contact with fluid, immediately wash the affected skin or clothing with water. If you experience skin irritation, consult a doctor.
- To avoid leakage, generation of heat or explosion:
  - Never heat, disassemble or modify the battery, nor dispose of it in a fire.
  - Do not attempt to pierce with a nail, hit with a hammer or step on the battery.
  - Do not drop the product or subject it to strong impact.
  - Do not get the battery wet.
- Do not use, leave or store the battery in the following places:
  - Area exposed to direct sunlight or high temperatures and humidity
  - Inside of a car under the blazing sun
  - Near heat sources such as heat registers
- Charge only with the included USB cable to avoid malfunction or fire.
- The internal rechargeable battery of this product cannot be replaced by the user. The battery may have reached the end of its service life if the usage time becomes significantly shorter even after the battery has been fully charged. If this is the case, the battery needs to be repaired. Contact your local Audio-Technica dealer for repair details.
- When the product is disposed of, the built-in rechargeable battery needs to be discarded properly. Contact your local Audio-Technica dealer to learn how to properly dispose of the battery.

### For customers in the USA

#### FCC Notice

##### Warning

This device complies with Part 15 of the FCC Rules. Operation is subject to the following two conditions: (1) This device may not cause harmful interference, and (2) this device must accept any interference received, including interference that may cause undesired operation.

##### Caution

You are cautioned that any changes or modifications not expressly approved in this manual could void your authority to operate this equipment.

Note: This equipment has been tested and found to comply with the limits for a Class B digital device, pursuant to part 15 of the FCC Rules. These limits are designed to provide reasonable protection against harmful interference in a residential installation. This equipment generates, uses and can radiate radio frequency energy and, if not installed and used in accordance with the instructions, may cause harmful interference to radio communications. However, there is no guarantee that interference will not occur in a particular installation. If this equipment does cause harmful interference to radio or television reception, which can be determined by turning the equipment off and on, the user is encouraged to try to correct the interference by one or more of the following measures:

- Reorient or relocate the receiving antenna.
- Increase the separation between the equipment and receiver.
- Connect the equipment to an outlet on a circuit different from that to which the receiver is connected.
- Consult the dealer or an experienced radio/TV technician for help.

### RF Exposure Statement

This transmitter must not be co-located or operated in conjunction with any other antenna or transmitter used in other systems. This device complies with FCC radiation exposure limits set forth for an uncontrolled environment and meets the FCC radio frequency (RF) Exposure Guidelines. This equipment has very low levels of RF energy that is deemed to comply without testing of specific absorption rate (SAR).

### For customers in Canada

#### IC statement

##### CAN ICES-3 (B)/NMB-3(B)

This device complies with Industry Canada's licence-exempt RSSs. Operation is subject to the following two conditions: (1) This device may not cause interference; and (2) This device must accept any interference, including interference that may cause undesired operation of the device.

Under Industry Canada regulations, this radio transmitter may only operate using an antenna of a type and maximum (or lesser) gain approved for the transmitter by Industry Canada. To reduce potential radio interference to other users, the antenna type and its gain should be so chosen that the equivalent isotropically radiated power (e.i.r.p.) is not more than that necessary for successful communication.

This device complies with RSS-102 radiation exposure limits set forth for an uncontrolled environment.

#### French:

Le présent appareil est conforme aux CNR d'Industrie Canada applicables aux appareils radio exempts de licence. L'exploitation est autorisée aux deux conditions suivantes : (1) l'appareil ne doit pas produire de brouillage, et (2) l'utilisateur de l'appareil doit accepter tout brouillage radio électrique subi, même si le brouillage est susceptible d'en compromettre le fonctionnement.

## Notes on use

- Be sure to read the connected device's user manual before use.
- Audio-Technica will not be liable in any way for any loss of data in the unlikely event that such losses should occur while using the product.
- The structure of the product makes it easy for sound to leak. On public transportation or in other public places, keep the volume low so as not to disturb other people.
- Minimize the volume on your device before connecting the product.
- When using the product in a dry environment, you may feel a tingling sensation in your ears. This is caused by static electricity accumulated on your body, not by product malfunction.
- Do not subject the product to strong impact.
- Do not store the product in direct sunlight, near heating devices, or in hot, humid, or dusty places. Additionally, do not allow the product to get wet.
- When the product is used for a long time, the product may become discolored due to ultraviolet light (especially direct sunlight) and wear.
- Make sure to hold the plug when connecting and disconnecting the USB charging cable. The USB charging cable may become severed or an accident may occur if you pull on the cable itself.
- When you are not using the USB charging cable, disconnect it from the product.
- If the product is placed in a bag while the USB charging cable is still connected, the USB charging cable may become caught, severed, or broken.
- This product can be used to talk on the phone only when using a mobile telephone network. Support for telephony apps that use a mobile data network is not guaranteed.
- If you use the product near an electronic device or transmitter (such as a mobile phone) which is not connected with the product, unwanted noise may be heard. In this case, move the product away from the electronic device or transmitter.
- If you use the product near a TV or radio antenna, noise may be seen or heard in the television or radio signal. In this case, move the product away from the TV or radio antenna.
- To protect the built-in rechargeable battery, charge it at least once every 6 months. If too much time passes between charges, the life of the rechargeable battery may be reduced, or the rechargeable battery may no longer be able to be charged.

## For a more comfortable Bluetooth® communication experience

The effective communication range of this product varies depending on obstructions and radio wave conditions.

For a more enjoyable experience, please use the product as close as possible to the Bluetooth device. To minimize noise and sound disruptions, avoid placing your body or other obstacles between the product's antenna and the Bluetooth device.

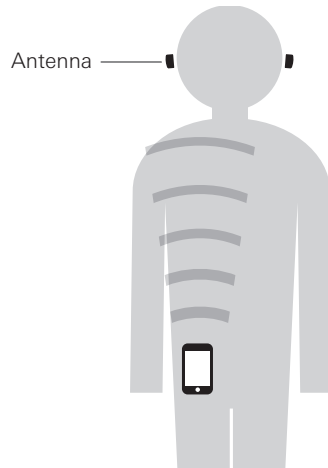

# Part names and functions

## Headphones

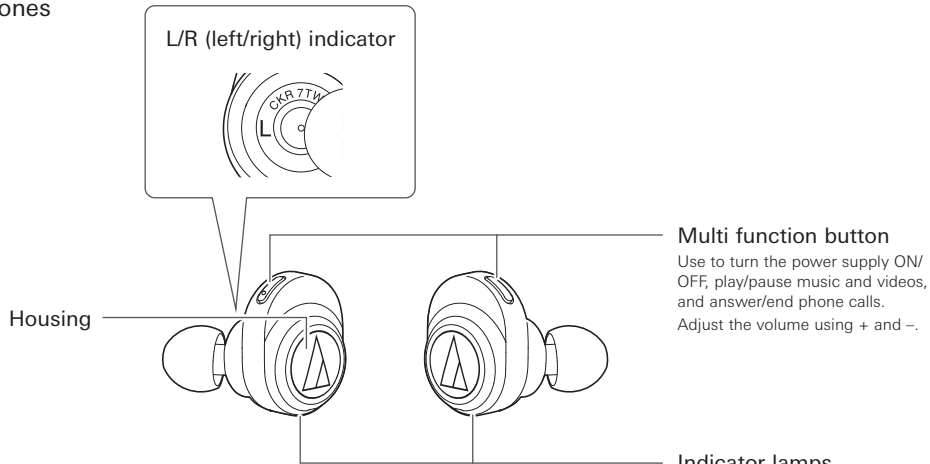

## Charging case

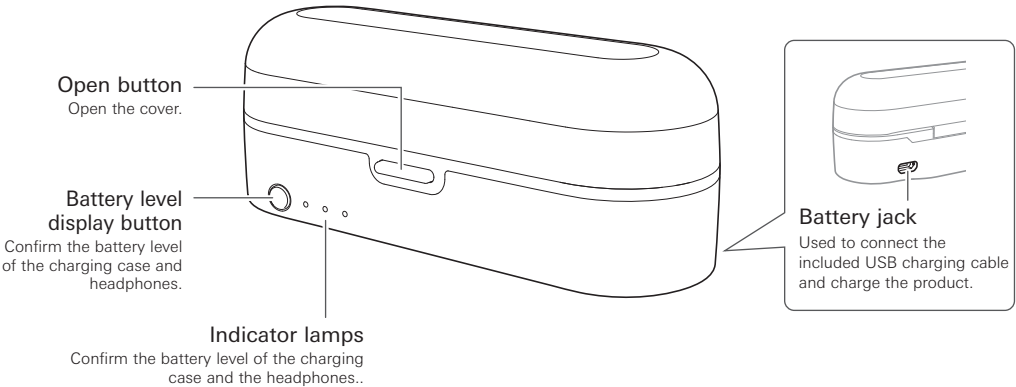

### ■ Accessories

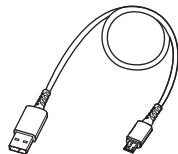

- USB charging cable (30 cm (12"))



- Eartips\* (XS, S, M, L)

- 3D loop support

\* At the time of purchase, the M-size eartips are attached to the main unit.

# Charging the battery

## Charging the headphones/the charging case

- Fully charge the battery when using for the first time.
- When the rechargeable battery is running low, the headphone will beep through the headphones, and an indicator lamp will flash in red. When these beeps sound, charge the battery.
- It takes about XX hours to charge the headphones and XX hours to charge the charging case fully. (This time may vary depending on usage conditions.)

1. Connect the included USB charging cable (micro USB Type-B side) to the battery jack.
  - The included USB charging cable is designed for exclusive use with the product. Do not use any other USB charging cable.
  - When inserting the USB charging cable into the USB port or battery jack, check that the jack is facing in the correct direction before inserting it directly (horizontally).
2. Connect the included USB charging cable (USB Type-A side) to the computer to start charging.

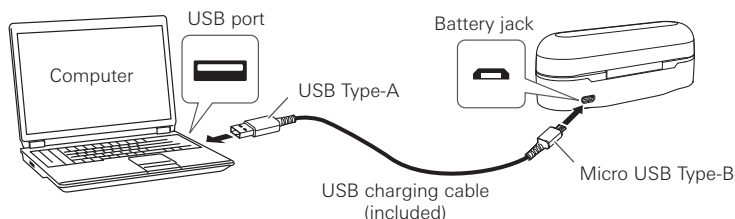

- Do not use other cables to charge the product.
3. Attach the headphones to the charging case.

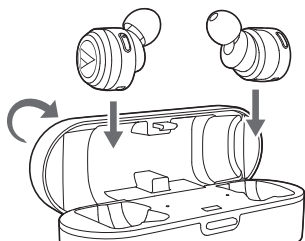

# Charging the battery

4. Close the cover of the charging case.

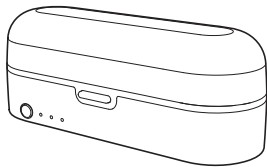

- During charging, the 3 indicator lamps light as follows to indicate the battery level of the charging case.\*

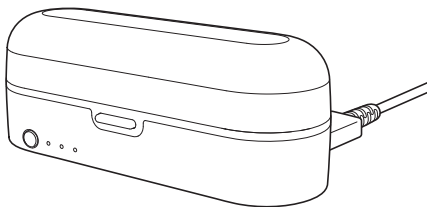
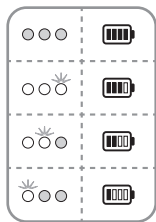

\* It may take several seconds for the indicator lamp to light.

5. When charging is complete, disconnect the USB charging cable (USB Type-A side) from the computer.
6. Disconnect the USB charging cable (micro USB Type-B side) from the the charging case's battery jack.

# Charging the battery

## Charging the headphones with the charging case only

Rechargeable battery is built in the charging case. If you charge the charging case, you can charge the headphones without using the USB cable for charging.

- When the rechargeable battery is running low, the headphone will beep through the headphones, and an indicator lamp will flash in red. When these beeps sound, charge the battery.

1. Attach the headphones to the charging case.
2. Close the cover of the charging case.
  - While charging, the indicator lamp lights as follows (it may take several seconds for the indicator lamp to light).  
Flashes in white : Charging  
White lit → After 10 seconds, off: Charging complete

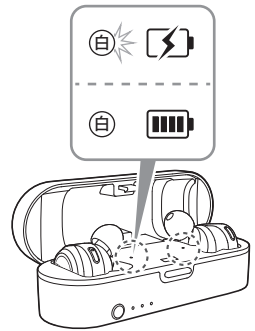

## Confirm the battery level of the charging case and headphones

1. Press the battery level button.
  - During charging, the 3 indicator lamps light as follows to indicate the battery level of the charging case/the headphones.  
Press once: Displays the remaining battery charge of the charging case with blue light.  
Press twice: The remaining battery level of the headphones is displayed with white light.

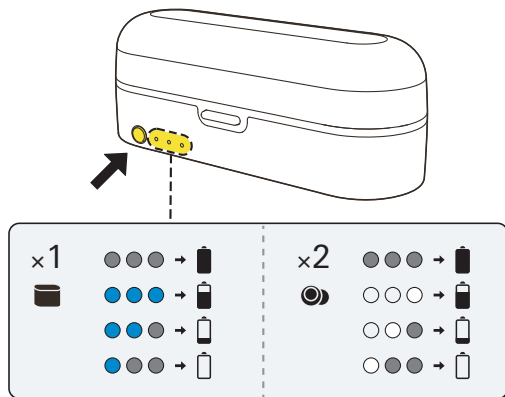



# Connecting via Bluetooth wireless technology

## About pairing

To connect the product to a Bluetooth device, the product needs to pair (register) with the device. Once they are paired, you do not need to pair them again.

However, you will need to pair again in the following cases:

- If the product is deleted from the Bluetooth device's connection history.
- If the product is sent out for repair.
- If 9 or more devices are paired  
(This product can save the pairing information of up to 8 devices. When you pair with a new device after pairing with 8 devices, pairing information for the device with the oldest connection date will be overwritten by the information for the new device.)

## Pairing a Bluetooth device





- Read the user manual for the Bluetooth device.
  - Place the Bluetooth device within 1 m (3.3') of the product to perform pairing correctly.
  - To confirm the progress of the pairing process, wear the product while performing this procedure and listen for the confirmation tone.
1. Take the product out of the charging case.
    - The indicator on the R (right) side starts to blink white.
  2. Use your Bluetooth device to begin the pairing process and search for the product.  
When your Bluetooth device finds the product, "ATH-CKR7TW" will be displayed on the device.
    - For information about using your Bluetooth device, refer to the device's user manual.
  3. Select "ATH-CKR7TW" to pair the product and your Bluetooth device.
    - Some devices may ask for a passkey. In this case, enter "0000". The passkey may also be called a passcode, PIN code, PIN number, or password.
    - The product sounds a confirmation tone when pairing is complete.

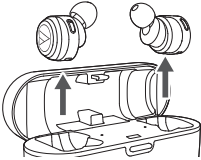

# Using the product

The product can use Bluetooth wireless technology to connect to your device and play music, receive phone calls, etc. Use the product for whichever of these purposes suits your needs.  
Note that Audio-Technica cannot guarantee the operation of displays, such as the battery level display, or applications via Bluetooth devices.

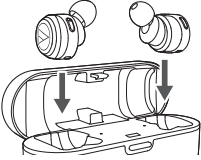
## Power supply ON/OFF

Power supply	Operation		Indicator lamps
ON*1	Take out of the charging case		Light in white, then flash in white. *2 *3
	Press and hold (for about 2 seconds)		
OFF*1	Attach to the charging case		Lights in white, then turns off*3
	Press and hold (for about 4 seconds)		

\*1 If you are wearing the product, you will hear a beep to indicate when the product has turned on and off.  
\*2 It may take several seconds for the indicator lamp to light.  
\*3 For details, please refer to "Indicator lamp display"(p.12).

## Wearing the product

- Insert the side of the product marked "L" (LEFT) into the left ear and the side marked "R" (RIGHT) into the right ear, and then adjust the eartips.

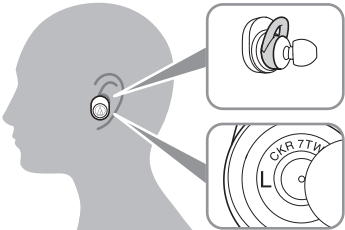

# Using the product

## Listening to music

- To connect for the first time, pair the product and your device via Bluetooth wireless technology. If you have already paired the product and your Bluetooth device, turn on the Bluetooth device's Bluetooth connection before turning on the product.
- Use your Bluetooth device to start playback, referring to the device's user manual as necessary.

### Multi function button (right side)

Press	Play/pause	Plays or pauses music and video playback.*
Press (2 times)	Skip forward	Plays the next track.*
Press (3 times)	Skip back	Plays the previous track.*

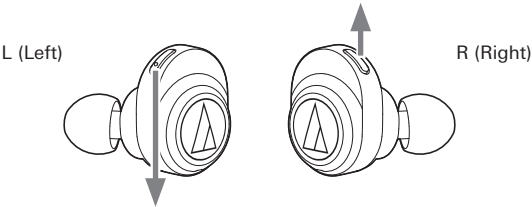

### Multi function button (left side)

Press	Volume up	Increases the volume by 1 level.
Press (2 times)	Volume down	Decreases the volume by 1 level.

\* Some controls may not be available for music and video playback on some smartphones.

- The volume control of some devices may not work well with the product.

# Using the product

## Talking on the phone

- If your Bluetooth device supports telephone features, you can use the product to talk on the phone.
- When your Bluetooth device receives a phone call, the headphone (right side) sounds a ring tone.
- If a call is received while you are listening to music, music playback is paused. When you finish the call, music playback resumes.\* <sup>1</sup>

When	Function	Operation
Receiving a call	Press the multi function button (right side).	Answers the call.
	Press and hold the multi function button (right side) for about 3 seconds.	Rejects the call.
Talking on a call <sup>*2 *3</sup>	Press the multi function button (right side).	Ends the call.

\*1 Depending on your Bluetooth device, music playback may not resume.  
\*2 Adjust the volume of the call on the Bluetooth device side.  
\*3 Call sound is heard only from the headphone R (right) side.  
• The phone call controls explained above may not be available on some smartphones.

## Auto power off function

The product automatically turns off after 5 minutes of not being connected to a device.

## Reset function

If the product does not work or other malfunctions occur, refer to “Charging the battery” (p.5) and connect the USB charging cable that is carrying power, and then reset the product. Disconnecting and then reconnecting the USB charging cable should resolve any problem you are experiencing. If the problem persists, please contact your local Audio-Technica dealer. Resetting does not change any of your settings (pairing information, volume setting, etc.).

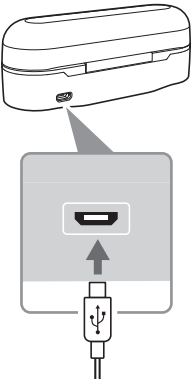

# Using the product

## App for smartphones



<https://app.at-globalsupport.com>

For more convenient control of the product, use our app for smartphones.



## Indicator lamp display

The indicator lamp of the product indicates the product's status as explained below.

Status		Indicator lamp display pattern      ○ White	
Pairing	Searching for device		Flashing quickly (○ : light gently)
	Waiting to be connected	○ ○ ---- ○ ○ ---- ○ ○ ---- ...	Flashing
Connection	Connecting	○ ---- ○ ---- ○ ---- ○ ---- ...	
Battery level	Battery level low	The blue indicator lamp for the pairing and connecting statuses changes to a red indicator lamp.	

## Cleaning

Get into the habit of regularly cleaning the product to ensure that it will last for a long time. Do not use alcohol, paint thinners, or other solvents for cleaning purposes.

- To clean, wipe with a dry cloth.
  - Immediately wipe off any moisture such as sweat that enters the battery jack. Failure to do so may result in a malfunction due to corrosion.
  - Natural oils from the skin are particularly likely to build up on the eartip attachment parts (see figure at right). If these areas are not cleaned, the eartips can become detached. Clean them regularly. Do not touch the areas where sound is produced as they are delicate. Doing so may cause the product to malfunction.
  - Wipe away any perspiration or dirt from the cable with a dry cloth immediately after use. Failure to clean the cable may cause it to deteriorate and harden over time, resulting in malfunction.
  - Wipe the cable's USB plug with a dry cloth if dirty.
  - Clean the eartips by removing them from the headphones and manually cleaning them with a diluted mild detergent. After cleaning, dry before using again.
- If the product will not be used for an extended period of time, store it in a well-ventilated place free from high temperatures and humidity.

# Eartips

## Eartip size

The product includes silicone eartips in 4 sizes (XS, S, M, and L). At the time of purchase, the M-size silicone eartips are attached.

To ensure the best sound quality, select the eartip size that is best suited for you, and adjust the eartips inside your ears for a snug fit. It may be difficult to hear bass sounds if the eartips do not fit snugly in your ears.

## Replacing the eartips

Remove the old eartip and attach the new eartip by pushing it onto the headphone at an angle (see figure).

Push firmly on the eartip so that the inside of the eartip expands, and push the eartip onto the post as far as it will go.

- Periodically remove and clean the eartips as they become dirty easily. Using dirty eartips may cause the headphones themselves to become dirty, resulting in deteriorated sound quality.
- Eartips are consumable parts that degrade through storage and use. If the eartips are loose and easily removed or if they appear to have degraded, purchase replacements.
- When reattaching eartips that were previously removed, be sure to check that they are securely attached. Injury or illness may occur if the eartips become detached and are left inside the ear.

# Troubleshooting Troubleshooting

Problem	Solution
Power is not supplied.	<ul style="list-style-type: none"><li>• Charge the product.</li></ul>
Unable to pair.	<ul style="list-style-type: none"><li>• Confirm that the Bluetooth device communicates using Ver. 2.1+EDR or higher.</li><li>• Place the product and the Bluetooth device within 1 m (3.3') of each other.</li><li>• Set the profiles for the Bluetooth device. For procedures on how to set profiles, refer to the Bluetooth device's user manual.</li><li>• Remove the pairing information for the Bluetooth device then pair the product with this device again.</li></ul>
No sound is heard / Sound is faint.	<ul style="list-style-type: none"><li>• Turn on the power of the product and the Bluetooth device.</li><li>• Turn up the volume of the product and the Bluetooth device.</li><li>• If the Bluetooth device is set to the HFP/HSP connection, switch to the A2DP connection.</li><li>• Move away from obstacles between the product and the Bluetooth device, such as people, metal or walls, and place the product and device closer together.</li><li>• Switch the sound output of the Bluetooth device to the Bluetooth connection.</li></ul>
Sound is distorted / Noise is heard / Sound cuts out.	<ul style="list-style-type: none"><li>• Turn down the volume of the product and the Bluetooth device.</li><li>• Keep this product away from devices that emit radio waves such as microwaves and wireless routers.</li><li>• Keep this product away from TVs, radios, and devices with built-in tuners. These devices can also be affected by the product.</li><li>• Turn off the equalizer settings of the Bluetooth device.</li><li>• Remove obstacles between the product and the Bluetooth device and place them closer together. For details, please refer to "For a more comfortable Bluetooth® communication experience"(p.3)</li></ul>
Cannot hear the voice of the caller / Voice of the caller is too quiet.	<ul style="list-style-type: none"><li>• Turn on the power of the product and the Bluetooth device.</li><li>• Turn up the volume of the product and the Bluetooth device.</li><li>• If the Bluetooth device is set to the A2DP connection, switch to the HFP/HSP connection.</li><li>• Switch the sound output of the Bluetooth device to the Bluetooth connection.</li></ul>
The product cannot be charged.	<ul style="list-style-type: none"><li>• Securely connect the included USB charging cable and charge the product.</li><li>• Confirm that the headphones is attached to the charging case properly.</li><li>• To clean, wipe with a dry cloth.</li><li>• When charging this product with only the charging case, check the remaining battery level of the charging case.</li></ul>
<ul style="list-style-type: none"><li>• For details about how to operate your Bluetooth device, refer to the device's user manual.</li><li>• If the problem still remains, reset the product. To reset the product, refer to "Reset function" (p.11) under "Using the product".</li></ul>	



# Specifications

## Headphones

Type	Dynamic
Driver	11 mm
Sensitivity	102 dB/mW
Frequency response	5 to 45,000Hz
Impedance	16 ohms

## Microphone

Type	MEMS
Polar pattern	Omnidirectional
Sensitivity	-38 dB (1 V/Pa, at 1 kHz)
Frequency response	50 to 4,000 Hz

## Communication specifications

Communication system	Bluetooth version 5,0
RF output	0.7mW EIRP
Maximum communication range	Line of sight - approx. 10 m (33')
Frequency band	2.402 GHz to 2.480 GHz
Modulation method	FHSS
Compatible Bluetooth profiles	A2DP, AVRCP, HFP, HSP
Support codec	Qualcomm® aptX™ audio, AAC, SBC
Supported content protection method	SCMS-T
Transmission band	20 to 20,000 Hz

## Other

Power supply	Headphones: DC 3.7 V lithium ion battery / Charging case: DC 3.7 V lithium polymer battery
Charging time	Headphones: Approx. 2 hours* / Charging case: Approx. 5 hours*
Operating time	Continuous transmission time (music playback): Max. approx. 6 hours (headphones) Max. approx. 15 hours (using the charging case)
Weight	Headphone (left and right): Approx 18 g, Charging case: Approx. 68 g
Operating temperature	5°C to 40°C (41°F to 104°F)
Accessories	<ul style="list-style-type: none"><li>• USB charging cable (30 cm (12")), USB Type-A / micro USB Type-B)</li><li>• Eartips (XS, S, M, L)</li><li>• 3D loop support</li></ul>
Sold separately	<ul style="list-style-type: none"><li>• Eartips ER-CKM55XS, S, M, L</li></ul>

\* This time may vary depending on usage conditions.

For product improvement, the product is subject to modification without notice.

- The Bluetooth® word mark and logos are owned by Bluetooth SIG, Inc. and any use of such marks by Audio-Technica Corporation is under license. All other trademarks are property of their respective owners.
- "AAC" logo is a trademark of Dolby Laboratories.

MODEL / 型号 : ATH-CKR7TW

CMIIT ID: xxxxxx

Charging Case / 充电盒

MADE IN CHINA / 中国制造

OUTPUT / 输出  $5V \approx 0.07A \times 2$

INPUT / 输入  $5V \approx 0.5A$

Audio-Technica Corporation

制造商: 铁三角有限公司

CAN ICES-3(B)/NMB-3(B)

IC Number: 1752B-CKR7TWL HVIN:ATH-CKR7TW-L



R-C-JMF-  
CKR7TW



MODEL / 型号 : ATH-CKR7TW

CMIIT ID: xxxxxx

Charging Case / 充电盒

MADE IN CHINA / 中国制造

OUTPUT / 输出  $5V \approx 0.07A \times 2$

INPUT / 输入  $5V \approx 0.5A$

Audio-Technica Corporation

制造商: 铁三角有限公司

CAN ICES-3(B)/NMB-3(B)

IC Number: 1752B-CKR7TWL HVIN:ATH-CKR7TW-L BK



R-C-JMF-  
CKR7TW



MODEL / 型号 : ATH-CKR7TW

CMIIT ID: xxxxxx

Charging Case / 充电盒

MADE IN CHINA / 中国制造

OUTPUT / 输出  $5V \approx 0.07A \times 2$

INPUT / 输入  $5V \approx 0.5A$

Audio-Technica Corporation

制造商: 铁三角有限公司

CAN ICES-3(B)/NMB-3(B)

IC Number: 1752B-CKR7TWL HVIN:ATH-CKR7TW-L BK (EX)



R-C-JMF-  
CKR7TW



MODEL / 型号 : ATH-CKR7TW

CMIIT ID: xxxxxx

Charging Case / 充电盒

MADE IN CHINA / 中国制造

OUTPUT / 输出  $5V \approx 0.07A \times 2$

INPUT / 输入  $5V \approx 0.5A$

Audio-Technica Corporation

制造商: 铁三角有限公司

CAN ICES-3(B)/NMB-3(B)

IC Number: 1752B-CKR7TWL HVIN:ATH-CKR7TW-L BK (DF)



R-C-JMF-  
CKR7TW



MODEL / 型号 : ATH-CKR7TW

CMIIT ID: xxxxxxx

Charging Case / 充电盒

MADE IN CHINA / 中国制造

OUTPUT / 输出  $5V \approx 0.07A \times 2$

INPUT / 输入  $5V \approx 0.5A$

Audio-Technica Corporation

制造商: 铁三角有限公司

CAN ICES-3(B)/NMB-3(B)

IC Number: 1752B-CKR7TWL HVIN:ATH-CKR7TW-L GY



R-C-JMF-  
CKR7TW



MODEL / 型号 : ATH-CKR7TW

CMIIT ID: xxxxxxx

Charging Case / 充电盒

MADE IN CHINA / 中国制造

OUTPUT / 输出  $5V \approx 0.07A \times 2$

INPUT / 输入  $5V \approx 0.5A$

Audio-Technica Corporation

制造商: 铁三角有限公司

CAN ICES-3(B)/NMB-3(B)

IC Number: 1752B-CKR7TWL HVIN:ATH-CKR7TW-L GY(EX)



R-C-JMF-  
CKR7TW



MODEL / 型号 : ATH-CKR7TW

CMIIT ID: xxxxxxx

Charging Case / 充电盒

MADE IN CHINA / 中国制造

OUTPUT / 输出  $5V \approx 0.07A \times 2$

INPUT / 输入  $5V \approx 0.5A$

Audio-Technica Corporation

制造商: 铁三角有限公司

CAN ICES-3(B)/NMB-3(B)

IC Number: 1752B-CKR7TWL HVIN:ATH-CKR7TW-L GY(DF)



R-C-JMF-  
CKR7TW



MODEL / 型号 : ATH-CKR7TW

CMIIT ID: xxxxxxx

Charging Case / 充电盒

MADE IN CHINA / 中国制造

OUTPUT / 输出  $5V \approx 0.07A \times 2$

INPUT / 输入  $5V \approx 0.5A$

Audio-Technica Corporation

制造商: 铁三角有限公司

CAN ICES-3(B)/NMB-3(B)

IC Number: 1752B-CKR7TWR HVIN:ATH-CKR7TW



R-C-JMF-  
CKR7TW



Audio-Technica Corporation

2-46-1 Nishi-naruse, Machida, Tokyo 194-8666, Japan

©2018 Audio-Technica Corporation

Global Support Contact: [www.at-globalsupport.com](http://www.at-globalsupport.com)

MODEL / 型号 : ATH-CKR7TW

CMIIT ID: xxxxxx

Charging Case / 充电盒

MADE IN CHINA / 中国制造

OUTPUT / 输出  $5V \approx 0.07A \times 2$

INPUT / 输入  $5V \approx 0.5A$

Audio-Technica Corporation

制造商: 铁三角有限公司

CAN ICES-3(B)/NMB-3(B)

IC Number: 1752B-CKR7TWR HVIN:ATH-CKR7TW BK



MODEL / 型号 : ATH-CKR7TW

CMIIT ID: xxxxxx

Charging Case / 充电盒

MADE IN CHINA / 中国制造

OUTPUT / 输出  $5V \approx 0.07A \times 2$

INPUT / 输入  $5V \approx 0.5A$

Audio-Technica Corporation

制造商: 铁三角有限公司

CAN ICES-3(B)/NMB-3(B)

IC Number: 1752B-CKR7TWR HVIN:ATH-CKR7TW BK (EX)



MODEL / 型号 : ATH-CKR7TW

CMIIT ID: xxxxxx

Charging Case / 充电盒

MADE IN CHINA / 中国制造

OUTPUT / 输出  $5V \approx 0.07A \times 2$

INPUT / 输入  $5V \approx 0.5A$

Audio-Technica Corporation

制造商: 铁三角有限公司

CAN ICES-3(B)/NMB-3(B)

IC Number: 1752B-CKR7TWR HVIN:ATH-CKR7TW BK (DF)



MODEL / 型号 : ATH-CKR7TW

CMIIT ID: xxxxxx

Charging Case / 充电盒

MADE IN CHINA / 中国制造

OUTPUT / 输出  $5V \approx 0.07A \times 2$

INPUT / 输入  $5V \approx 0.5A$

Audio-Technica Corporation

制造商: 铁三角有限公司

CAN ICES-3(B)/NMB-3(B)

IC Number: 1752B-CKR7TWR HVIN:ATH-CKR7TW GY



Audio-Technica Corporation

2-46-1 Nishi-naruse, Machida, Tokyo 194-8666, Japan

©2018 Audio-Technica Corporation

Global Support Contact: [www.at-globalsupport.com](http://www.at-globalsupport.com)

MODEL / 型号: ATH-CKR7TW

Charging Case / 充电盒

MADE IN CHINA / 中国制造

OUTPUT / 输出 5V  $\approx$  0.07A  $\times$  2

INPUT / 输入 5V  $\approx$  0.5A

Audio-Technica Corporation

制造商: 铁三角有限公司

CAN ICES-3(B)/NMB-3(B)

IC Number: 1752B-CKR7TWR HVIN: ATH-CKR7TW GY(EX)

CMIIT ID: xxxxxx



R-C-JMF-  
CKR7TW



MODEL / 型号: ATH-CKR7TW

Charging Case / 充电盒

MADE IN CHINA / 中国制造

OUTPUT / 输出 5V  $\approx$  0.07A  $\times$  2

INPUT / 输入 5V  $\approx$  0.5A

Audio-Technica Corporation

制造商: 铁三角有限公司

CAN ICES-3(B)/NMB-3(B)

IC Number: 1752B-CKR7TWR HVIN: ATH-CKR7TW GY(DF)

CMIIT ID: xxxxxx



R-C-JMF-  
CKR7TW



Global Support Contact: [www.at-globalsupport.com](http://www.at-globalsupport.com)

This product complies with or has received approval under radio laws in certain countries and geographic areas.



PB



R-C-JMF-  
CKR7TW

LEFT

FCC ID: JFZCKR7TW-L

IC ID: 1752B-CKR7TWL

CMIIT ID: xxxxxxxxxxxxxx

RIGHT

FCC ID: JFZCKR7TW-R

IC ID: 1752B-CKR7TWR

CMIIT ID: xxxxxxxxxxxxxx

Audio-Technica Corporation

2-46-1 Nishi-naruse, Machida, Tokyo 194-8666, Japan

©2018 Audio-Technica Corporation

Global Support Contact: [www.at-globalsupport.com](http://www.at-globalsupport.com)