

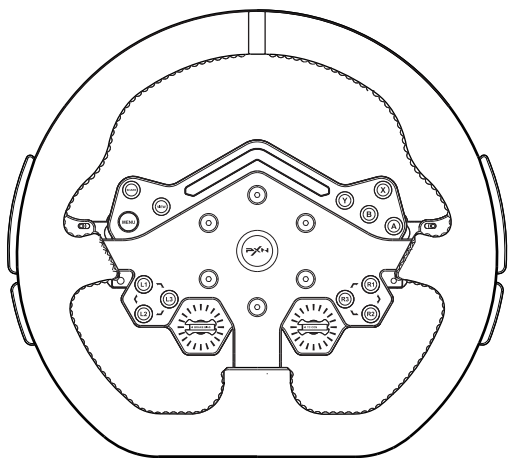

W DS



## STEERING WHEEL

### User Manual

Please read the manual carefully before using the product, and keep this manual for future reference.

#### ⚠ WARNING — Electrical Safety

- \* Please connect, install and remove this product with proper force, don't twist or pull the connectors and interface.
- \* Avoid getting water or other liquids on product or its connectors.
- \* Please keep the product in dry place and keep away from fire, don't expose the product in humid conditions, high temperature or a dusty environment.
- \* Please use the power cables provided with the base, do not use other power cables.
- \* Please don't use the power cable if the cable or its connector is damaged, cracked, or broken.
- \* Make sure that the power supply cable is properly plugged into the steering wheel's base.
- \* Please don't disassemble, refit or repair on your own. Any repairs must be carried out by the manufacturer, the authorized representatives or qualified technicians.
- \* Please use the attached system/ accessories specified by manufacturer only.
- \* If any unusual sound, heat or odor occurs with this product, please stop using it.

#### ⚠ WARNING — Possible injuries caused by force feedback and repetitive movements

To avoid any accident, please take below advice for reference :

- \* Avoid lengthy gaming periods.
- \* Take a break of 10 to 15 minutes after each hour of using this product.
- \* If you feel any fatigue or pain in your hands, wrists, arms, feet or legs, please stop playing and rest for a few hours. If the symptoms or pain indicated persist, please stop playing and consult the doctor.
- \* Please keep out of children's reach.
- \* During gameplay, please always keep your hands in the steering wheel in the correct position, not placed at random.
- \* During gameplay, please never place your hands or your fingers under the pedals or anywhere near the pedal set.
- \* During calibration and gameplay, please never place your hands or your arms through the openings in the steering wheel.



ALWAYS



NEVER



NEVER

The product can only be operated by users aged 16 or above.

#### ⚠ Heavy Product

Be careful not to drop the product on yourself or on anyone else !

- 1 -

## ENGLISH

### 01 System Requirement

Supported platform: PC, PS4, X-ONE, X-SERIES X|S  
Base Requirement: PXN Base

### 02 Package Content

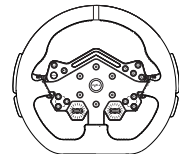

W DS \*1



Paddle Muffer \*4



Wrench \*1

### 03 Installation

#### \* The steering wheel needs to be used with PXN Base

Step 1 Align the top 6 steel balls and bottom 4 steel balls of steering wheel with the corresponding notches on the base's quick release.

Step 2 Press the gold part of the quick release to the steering wheel plate.

Step 3 Push the steering wheel towards the base and release the gold part of the quick release. The quick release will be automatically locked up.

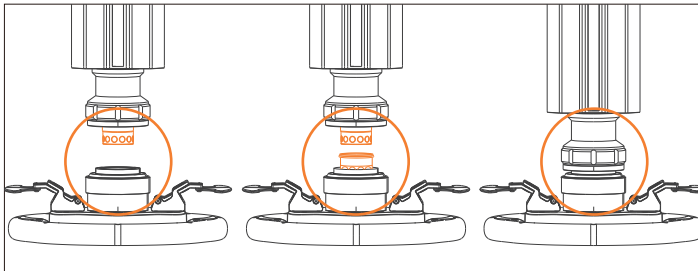

If you want to remove the steering wheel plate, press the gold part of quick release and pull out the steering wheel.

Note: After installation, please try to pull the steering wheel back to ensure that the steering wheel is firmly installed. If it is not securely installed, turn the steering wheel around or remove it and reinstall it and repeat the checking.

- 2 -

### 04 Paddle Adjustment

Step 1 Use the allen wrench in the accessories kit to loosen the screws of the paddles counterclockwise.

Step 2 Adjust the paddles to the right position and then tighten the screws clockwise.

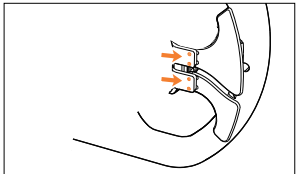

### 05 High Configuration Setting

Download for iOS: App Store search [ PXN Wheel ].

Download for Android: Google Play search [ PXN Wheel ].

Download the APP [ PXN Wheel ] for high configuration settings.

APP Function Introduction :

- Button mapping setting of steering wheel
- Game preset button configuration
- Button testing of steering wheel

### 06 Attention

- Please read this user manual carefully before using the product.
- Avoid strong shocks or vibration and do not drop.
- Do not disassemble, modify and repair by yourself.
- Prevent water or other liquids from entering the product to avoid damage.
- Avoid storing in humid, high temperature, oily smoke and other places.
- Please handle it gently when connect and remove the product.
- Children should be under adult's supervision at all times when using this product.

### 07 Product Specifications

Model	W DS
Connection Method	Quick Release System
Power Supply Type	Wireless Power Supply
Signal Transmission	Wireless Transmission
Package Size	About 410 * 394 * 174 mm
Product Size	About 300 * 300 * 96.5 mm
Product Weight	About 1465 g
Use Temperature	10-40 °C
Use Humidity	20~80 %

- 3 -

### 08 Pairing Method of Steering Wheel and PXN Base

Step 1 Install the base and steering wheel correctly according to the instructions. If the base and steering wheel are not paired, the LED light on the steering wheel will flash.

Step 2 Press and hold view+L3 at this time until the LED light flashes rapidly.

Step 3 Unplug and replug the USB-B cable on the back of the base.

Step 4 Wait for the base to match the steering wheel. After the successful matching, the steering wheel will self check and the LED will remain on.

"PXN" is a registered trademark of ShenZhen PXN Electronics Technology Co., Ltd

PS4 is a registered trademark of Sony Computer Entertainment Inc.

Xbox is a registered trademark of Microsoft Corporation.

All trademarks are the property of their respective owner. Technical specifications are subject to change. Information contained herein is subject to change without prior notice. ShenZhen PXN Electronics Technology Co., Ltd. shall not be made liable for any errors that may appear. Please keep this information for later reference.

S-W DS-V02-2303

### FCC Statement

This device complies with Part 15 of the FCC rules. Operation is subject to the following two conditions: 1) this device may not cause harmful interference, and 2) this device must accept any interference received, including interference that may cause undesired operation.

Note: This equipment has been tested and found to comply with the limits for a Class B digital device, pursuant to part 15 of the FCC Rules. These limits are designed to provide reasonable protection against harmful interference in a residential installation. This equipment generates uses and can radiate radio frequency energy and, if not installed and used in accordance with the instructions, may cause harmful interference to radio communications. However, there is no guarantee that interference will not occur in particular installation. If this equipment does cause harmful interference to radio or television reception, which can be determined by turning the equipment off and on, the user is encouraged to try to correct the interference by one or more of the following measures:

- Reorient or relocate the receiving antenna.
- Increase the separation between the equipment and receiver.
- Connect the equipment into an outlet on a circuit different from that to which the receiver is connected.

--Consult the dealer or an experienced radio/TV technician for help.

Changes or modifications not expressly approved by the party responsible for compliance could void the user's authority to operate the equipment.

#### FCC Radiation Exposure Statement

This device complies with FCC RF radiation exposure limits set forth for an uncontrolled environment. This transmitter must not be co-located or operating in conjunction with any other antenna or transmitter.