

Microwave Oven

INSTRUCTION MANUAL

MODEL: TR923X7ZE-SS0D00

Read these instructions carefully before using your microwave oven, and keep it carefully.

If you follow the instructions, your oven will provide you with many years of good service.

SAVE THESE INSTRUCTIONS CAREFULLY

PRECAUTIONS TO AVOID POSSIBLE EXPOSURE TO EXCESSIVE MICROWAVE ENERGY

- (a) Do not attempt to operate this oven with the door open since open door operation can result in harmful exposure to microwave energy.
It is important not to defeat or tamper with the safety interlocks.
- (b) Do not place any object between the oven front face and the door or allows soil or cleaner residue to accumulate on sealing surfaces.
- (c) Do not operate the oven if it is damaged. It is particularly important that the oven door close properly and that there is no damage to the:
 - (1) DOOR (bent)
 - (2) HINGES AND LATCHES (broken or loosened)
 - (3) DOOR SEALS AND SEALING SURFACES
- (d) The oven should not be adjusted or repaired by anyone except properly qualified service personnel.

Specifications

Model	TR923X7ZE-SS0D00
Rated Voltage	120 V~ 60 Hz
Microwave Input	1200 W
Microwave Output	900 W
Grill	1500 W
Bake	1500 W
Steam	1500 W
Airfry	1500 W

When using electrical appliances basic safety precautions should be followed, including the following:

WARNING - To reduce the risk of burns, electric shock, fire, injury to persons or exposure to excessive microwave energy:

1. Read all instructions before using the appliance.
2. Read and follow the specific: "PRECAUTIONS TO AVOID POSSIBLE EXPOSURE TO EXCESSIVE MICROWAVE ENERGY" found on page 2.
3. This appliance must be grounded. Connect only to properly grounded outlet. See "GROUNDING INSTRUCTIONS" found on page 5.
4. Install or locate this appliance only in accordance with the provided installation instructions.
5. Some products such as whole eggs and sealed containers - for example, closed glass jars - are able to explode and should not be heated in this oven.
6. Use this appliance only for its intended use as described in the manual. Do not use corrosive chemicals or vapors in this appliance. This type of oven is specifically designed to heat, cook or dry food. It is not designed for industrial or laboratory use.
7. As with any appliance, close supervision is necessary when used by children.
8. Do not operate this appliance if it has a damaged cord or plug, if it is not working properly, or if it has been damaged or dropped.
9. This appliance should be serviced only by qualified service personnel. Contact nearest authorized service facility for examination, repair, or adjustment.
10. Do not cover or block any openings on the appliance.
11. Do not store this appliance outdoors. Do not use this product near water - for example, near a kitchen sink, in a wet basement, near a swimming pool, or similar location.
12. Do not immerse cord or plug in water.
13. Keep cord away from heated surface.
14. Do not let cord hang over edge of table or counter.
15. When cleaning surfaces of door and oven that comes together on closing the door, use only mild, nonabrasive soaps, or detergent applied with a sponge or soft cloth.
16. To reduce the risk of fire in the oven cavity:
 - 1). Do not overcook food. Carefully attend appliance when paper, plastic, or other combustible materials are placed inside the oven to facilitate cooking.
 - 2). Remove wire twist-ties from paper or plastic bag before placing bag in oven.
 - 3). If material inside of the oven ignite, keep oven door closed, turn oven off, and disconnect the power cord, or shut off power at the fuse or circuit breaker panel.
 - 4). Do not use the cavity for storage purposes. Do not leave paper products, cooking utensils, or food in the cavity when not in use.

17. Liquids, such as water, coffee, or tea are able to be overheated beyond the boiling point without appearing to be boiling. Visible bubbling or boiling when the container is removed from the microwave oven is not always present.
THIS COULD RESULT IN VERY HOT LIQUID SUDDENLY BOILING OVER WHEN THE CONTAINER IS DISTURBED OR A UTENSIL IS INSERTED INTO THE LIQUID.
To reduce the risk of injury to persons:
- 1) Do not overheat the liquid.
 - 2) Stir the liquid both before and halfway through heating it.
 - 3) Do not use straight-sided containers with narrow necks.
 - 4) After heating, allow the container to stand in the microwave oven for a short time before removing the container.
 - 5) Use extreme care when inserting a spoon or other utensil into the container.
18. Oversized food or oversized metal utensils should not be inserted in a microwave/toaster oven as they may create a fire or risk of electric shock.
19. Do not clean with metal scouring pads. Pieces can burn off the pad and touch electrical parts involving a risk of electric shock.
20. Do not use paper products when appliance is operated in the toaster mode.
21. Do not store any materials, other than manufacturer's recommended accessories, in this oven when not in use.
22. Do not cover racks or any other part of the oven with metal foil. This will cause overheating of the oven.

SAVE THESE INSTRUCTIONS

GROUNDING INSTRUCTIONS

This appliance must be grounded. In the event of an electrical short circuit, grounding reduces the risk of electric shock by providing an escape wire for the electric current. This appliance is equipped with a cord having a grounding wire with a grounding plug. The plug must be plugged into an outlet that is properly installed and grounded.

WARNING - Improper use of the grounding can result in a risk of electric shock. Consult a qualified electrician or serviceman if the grounding instructions are not completely understood, or if doubt exists as to whether the appliance is properly grounded. If it is necessary to use an extension cord, use only a 3-wire extension cord that has a 3-blade grounded plug, and 3-slot receptacle that will accept the plug on the appliance. The marked rating of the extension cord shall be equal to or greater than the electrical rating of the appliance.

DANGER - Electric Shock Hazard

Touching some of the internal components can cause serious personal injury or death. Do not disassemble this appliance.

WARNING - Electric Shock Hazard

Improper use of the grounding can result in electric shock. Do not plug into an outlet until appliance is properly installed and grounded.

1. A short power-supply cord is provided to reduce the risks resulting from becoming entangled in or tripping over a longer cord.
2. Longer cord sets or extension cords are available and may be used if care is exercised in their use.
3. If a long cord or extension cord is used:
 - 1) The marked electrical rating of the cord set or extension cord should be at least as great as the electrical rating of the appliance.
 - 2) The extension cord must be a grounding-type 3-wire cord.
 - 3) The longer cord should be arranged so that it will not drape over the counter top or tabletop where it can be pulled on by children or tripped over unintentionally.

RADIO INTERFERENCE

1. Operation of the microwave oven may cause interference to your radio, TV or similar equipment.
2. When there is interference, it may be reduced or eliminated by taking the following measures:
 - 1) Clean door and sealing surface of the oven
 - 2) Reorient the receiving antenna of radio or television.
 - 3) Relocate the microwave oven with respect to the receiver.
 - 4) Move the microwave oven away from the receiver.
 - 5) Plug the microwave oven into a different outlet so that microwave oven and receiver are on different branch circuits.

This device complies with part 18 of the FCC Rules.

UTENSILS

CAUTION - Personal Injury Hazard

Tightly-closed utensils could explode. Closed containers should be opened and plastic pouches should be pierced before cooking.

See the instructions on "Materials you can use in microwave oven or to be avoided in microwave oven."

There may be certain non-metallic utensils that are not safe to use for microwaving. If in doubt, you can test the utensil in question following the procedure below.

Utensil Test:

1. Fill a microwave-safe container with 1 cup of cold water (250ml) along with the utensil in question.
2. Cook on maximum power for 1 minute.
3. Carefully feel the utensil. If the empty utensil is warm, do not use it for microwave cooking.
4. Do not exceed 1 minute cooking time.

Materials you can use in microwave oven

Utensils	Remarks
Browning dish	Follow manufacturer's instructions. The bottom of browning dish must be at least 3/16 inch (5mm) above the turntable. Incorrect usage may cause the turntable to break.
Dinnerware	Microwave-safe only. Follow manufacturer's instructions. Do not use cracked or chipped dishes.
Glass jars	Always remove lid. Use only to heat food until just warm. Most glass jars are not heat resistant and may break.
Glassware	Heat-resistant oven glassware only. Make sure there is no metallic trim. Do not use cracked or chipped dishes.
Oven cooking bags	Follow manufacturer's instructions. Do not close with metal tie. Make slits to allow steam to escape.
Paper plates and cups	Use for short-term cooking/warming only. Do not leave oven unattended while cooking.
Paper towels	Use to cover food for reheating and absorbing fat. Use with supervision for a short-term cooking only.
Parchment paper	Use as a cover to prevent splattering or a wrap for steaming.
Plastic	Microwave-safe only. Follow the manufacturer's instructions. Should be labeled "Microwave Safe". Some plastic containers soften, as the food inside gets hot. "Boiling bags" and tightly closed plastic bags should be slit, pierced or vented as directed by package.
Plastic wrap	Microwave-safe only. Use to cover food during cooking to retain moisture. Do not allow plastic wrap to touch food.
Thermometers	Microwave-safe only (meat and candy thermometers).
Wax paper	Use as a cover to prevent splattering and retain moisture.

Materials to be avoided in microwave oven

Utensils	Remarks
Aluminum tray	May cause arcing. Transfer food into microwave-safe dish.
Food carton with metal handle	May cause arcing. Transfer food into microwave-safe dish.
Metal or metal-trimmed utensils	Metal shields the food from microwave energy. Metal trim may cause arcing.
Metal twist ties	May cause arcing and could cause a fire in the oven.
Paper bags	May cause a fire in the oven.
Plastic foam	Plastic foam may melt or contaminate the liquid inside when exposed to high temperature.
Wood	Wood will dry out when used in the microwave oven and may split or crack.

NAMES OF OVEN PARTS AND ACCESSORIES

(In case of any differences between the appliance and the pictures in this manual, the product shall prevail.)

Remove the oven and all materials from the carton and oven cavity. Your oven comes with the following accessories:

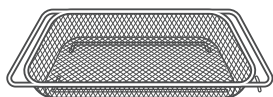
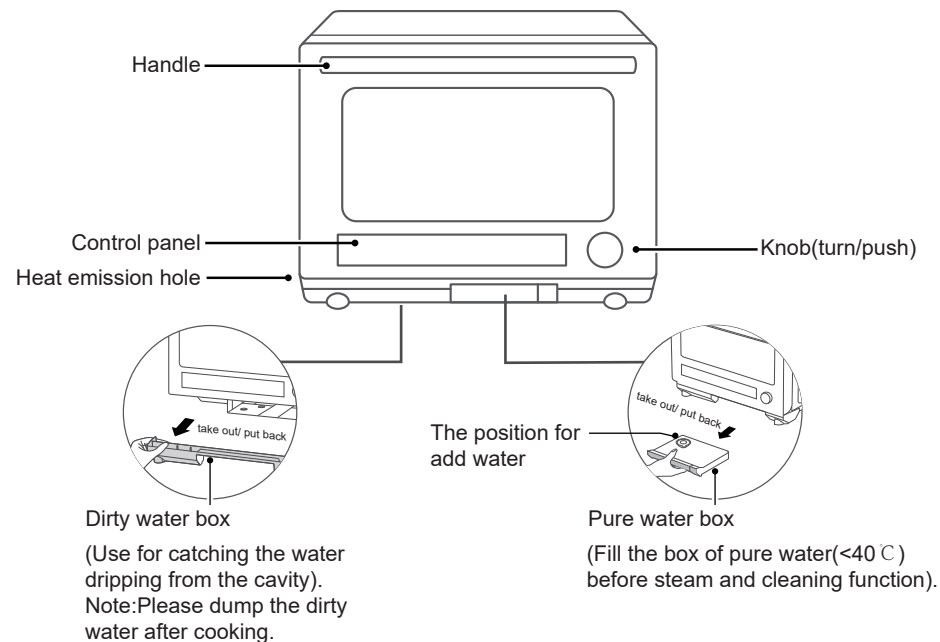

Airfry basket

(Can't be used in steam and microwave cooking)

Place in the cavity slot, use for Airfry cooking.

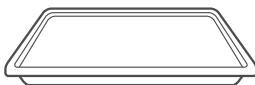

Bake tray

(Can't be used in microwave cooking)

Place in the cavity slot, bake oily food or take food residue.

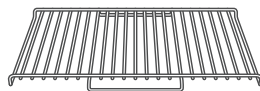

Grill rack

(Can't be used in microwave cooking)

Place on the cavity or on the bake tray, use for grill, bake and steam cooking.

Notes:

Airfry basket: Perforated to contain vegetables.

Bake tray: Designed to contain liquids.

Countertop Installation

Remove all packing material and accessories. Examine the oven for any damage such as dents or broken door. Do not install if oven is damaged.

Cabinet: Remove any protective film found on the microwave oven cabinet surface. Do not remove the waveguide cover that is attached to the oven cavity to protect the magnetron.

Installation

1. Select a level surface that provide enough open space for the intake and/or outlet vents.

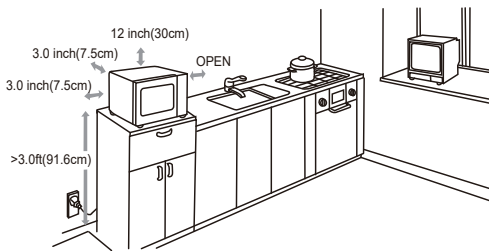

A minimum clearance of 3.0 inches (7.5cm) is required between the oven and any adjacent walls. One side must be open. The minimum installation height is 3.0ft(91.6cm).

- (1) Leave a minimum clearance of 12 inches (30cm) above the oven.
- (2) Do not remove the legs from the bottom of the oven.

- (3) Blocking the intake and/or outlet openings can damage the oven.
- (4) Place the oven as far away from radios and TV as possible. Operation of microwave oven may cause interference to your radio or TV reception.
2. Plug your oven into a standard household outlet. Be sure the voltage and the frequency is the same as the voltage and the frequency on the rating label.

WARNING: Do not install oven over a range cooktop or other heat-producing appliance. If installed near or over a heat source, the oven could be damaged and the warranty would be void.

OPERATION INSTRUCTION

SPEEDY COOKING

In standby mode, press “Confirm/Start” to start microwave cooking for 30 seconds with 100% power level directly.

MICROWAVE FUNCTION

- (1) In standby mode, press “Micro.” once to enter microwave function, the default time is 30 seconds.
- (2) Turn the knob to set the power level, 1000W, 800W, 500W, 300W, 100W are available.
- (3) Press “Confirm/Start” to confirm.
- (4) Turn the knob to set the cooking time, the maximum value is 90 minutes.
- (5) Press “Confirm/Start” to start cooking.

AIRFRY WITHOUT PREHEAT

- (1) In standby mode, press “Airfry” once, the default temperature 350°F will display.
- (2) Turn the knob to set the temperature, 225°F-450°F are available.
- (3) Press “Confirm/Start” to confirm.
- (4) Turn the knob to set the cooking time, the maximum value is 90 minutes.
- (5) Press “Confirm/Start” to start cooking.

AIRFRY WITH PREHEAT

- (1) In standby mode, press “Airfry” twice, the default temperature 350°F will display.
- (2) Turn the knob to set the temperature, 225°F-450°F are available.
- (3) Press “Confirm/Start” to start preheating. When the preheating temperature has arrived, put the food into the oven, then close the door.
- (4) Turn the knob to set the cooking time, the maximum value is 90 minutes.
- (5) Press “Confirm/Start” to start cooking.

GRILL WITHOUT PREHEAT

- (1) In standby mode, press “Grill” once, the default temperature 425°F will display.
- (2) Turn the knob to set the temperature, 225°F-450°F are available.
- (3) Press “Confirm/Start” to confirm.
- (4) Turn the knob to set the cooking time, the maximum value is 90 minutes.
- (5) Press “Confirm/Start” to start cooking.

GRILL WITH PREHEAT

- (1) In standby mode, press “Grill” twice, the default temperature 425°F will display.
- (2) Turn the knob to set the temperature, 225°F-450°F are available.
- (3) Press “Confirm/Start” to start preheating. When the preheating temperature has arrived, put the food into the oven, then close the door.
- (4) Turn the knob to set the cooking time, the maximum value is 90 minutes.
- (5) Press “Confirm/Start” to start cooking.

BAKE WITHOUT PREHEAT

- (1) In standby mode, press "Bake" once, the default temperature 300°F will display.
- (2) Turn the knob to set the temperature, 225°F-450°F are available.
- (3) Press "Confirm/Start" to confirm.
- (4) Turn the knob to set the cooking time, the maximum value is 90 minutes.
- (5) Press "Confirm/Start" to start cooking.

BAKE WITH PREHEAT

- (1) In standby mode, press "Bake" twice, the default temperature 300°F will display.
- (2) Turn the knob to set the temperature, 225°F-450°F are available.
- (3) Press "Confirm/Start" to start preheating. When the preheating temperature has arrived, put the food into the oven, then close the door.
- (4) Turn the knob to set the cooking time, the maximum value is 90 minutes.
- (5) Press "Confirm/Start" to start cooking.

STEAM

- (1) In standby mode, press "Steam" once, the default temperature 200°F will display.
- (2) Turn the knob to set the temperature, 125°F-250°F are available.
- (3) Press "Confirm/Start" to confirm .
- (4) Turn the knob to set the cooking time, the maximum value is 90 minutes.
- (5) Press "Confirm/Start" to start cooking.

ELEC-OPEN

- (1) When starting the cooking, the oven door will be locked automatically.
- (2) In the cooking process or within 30 minutes after the end of cooking, you need to press "ELEC-OPEN" to unlock the door before opening the oven door.
- (3) After 30 minutes of the end of cooking, the oven door will unlock automatically.

AUTO MENU

52 menus are available.

For example, set the defrost function as follow:

- (1) In standby mode, press "Auto Menu" once.
- (2) Turn the knob left to choose the menu 45, "45" will display.
- (3) Press "Confirm/Start" to confirm.
- (4) Turn the knob to set the weight within 100~1500 g.
- (5) Press "Confirm/Start" to start defrosting.

Note: The buzzer will sound to remind of turning over the food during defrosting.

For example, set the fermentation function as follow:

- (1) In standby mode, press "Auto Menu" once.
- (2) Turn the knob left to choose the menu 46, "46" will display.
- (3) Press "Confirm/Start" to confirm.
- (4) Turn the knob to set the temperature within 75°F-115°F.
- (5) Press "Confirm/Start" to confirm.
- (6) Turn the knob to set the cooking time, the maximum value is 12 hours.
- (7) Press "Confirm/Start" to start cooking.

AUTO MENU

- (1) In standby mode, press “Auto Menu” once, 01 will display.
- (2) Turn the knob to choose the disired menu, 52 menus are available.
- (3) Press “Confirm/Start” to start cooking.

Auto Menu chart

NUMBER	MENU	WEIGHT/AMOUNT
01	Chicken Thigh with Honey Sauce	900g
02	Baked Sweet Potato	1000g
03	Baked Shrimp with Spiced Salt	400g
04	Grilled Sausage	300g
05	French Fries	500g
06	Chicken Fillets	350g
07	Crispy Meat	350g
08	Chicken Nuggets	500g
09	Honey Chestnuts	500g
10	Peanuts	300g
11	Shrimp Tempura	400g
12	Japanese Gillette Tonkatsu	500g
13	Grilled Smelts	250g
14	Crispy Shrimp Balls with Milk and Oats	200g
15	Orleans Roasted Chicken Wing	500g
16	Garlic Spare Ribs	400g
17	Grilled Squid with Sauce	800g
18	Low Salt Salmon	200g
19	Low-Fat Roasted Pork Belly	200g

NUMBER	MENU	WEIGHT/AMOUNT
20	Crispy Char Siew	500g
21	Steamed Sea Bass	400g
22	Steamed Frozen Buns	500g
23	Steamed Egg Custard	300g
24	Steamed Ribs	400g
25	Steamed Clams with Black Bean and Pepper	400g
26	Steamed Baby Vegetables with Garlic	400g
27	Steamed Shredded Eggplant	500g
28	Steamed Loofah with Minced Meat	500g
29	Steamed Broccoli	300g
30	Steamed Rice with Coarse Cereals	500g
31	Tremella Lotus Seed Soup	945g
32	Milk Papaya	1000g
33	Candy Sydney Drink	1540g
34	Taro and Sago	820g
35	Black Chicken Soup with Red Dates	1200g
36	Pork Ribs Soup with Cordyceps Flower	1500g
37	Portuguese Egg Tart	9
38	Chiffon Cake	8 inch
39	Cranberry Cookies	12
40	Margarita Cookies	12
41	Italian Pizza	600g
42	Whole Wheat Bread	600g
43	Strawberry Muffin	8
44	Orange Madeleines	180g

NUMBER	MENU	WEIGHT/AMOUNT
45	Defrost	/
46	Ferment	/
47	Keep Warm	/
48	Cavity Deodorization	Note:After cooking the food,it is necessary to remove the residual odor in the cavity.
49	Cavity Cleaning	Note:Cleaning the cavity at regular to lengthen its service life.
50	Limescale Cleaning	/
51	Disinfection	/
52	Cavity Drying	/

Wireless Connection

Connect the network

In standby mode, press and hold "STOP/CANCEL" for 3 seconds, the wifi icon will flash slowly during wireless connection, if it connected successfully, wifi icon will keep light. If it fails, "AP" will display, wifi icon will light off, the oven will return to standby mode after 30 seconds.

Disconnect from the network

In standby mode, press and hold "STOP/CANCEL" for 8 seconds, "----" will flash during disconnection, if the link has been removed successfully, "8888" will display and return to standby mode after 3 seconds. If it fails, "FFFF" will display, the oven will return to standby mode after 3 seconds.

MAINTENANCE

Troubleshooting

Check your problem by using the chart below and try the solutions for each problem. If the microwave oven still does not work properly, contact the nearest authorized service center.

TROUBLE	POSSIBLE CAUSE	POSSIBLE REMEDY
Oven will not start	a. Electrical cord for oven is not plugged in. b. Door is open. c. Wrong operation is set.	a. Plug into the outlet. b. Close the door and try again. c. Check instructions.
Arcing or sparking	a. Materials to be avoided in microwave oven were used. b. The oven is operated when empty. c. Spilled food remains in the cavity.	a. Use microwave-safe cookware only. b. Do not operate with oven empty. c. Clean cavity with wet towel.
Unevenly cooked foods	a. Materials to be avoided in microwave oven were used. b. Food is not defrosted completely. c. Cooking time, power level is not suitable. d. Food is not turned or stirred.	a. Use microwave-safe cookware only. b. Completely defrost food. c. Use correct cooking time, power level. d. Turn or stir food.
Overcooked foods	Cooking time, power level is not suitable.	Use correct cooking time, power level.
Undercooked foods	a. Materials to be avoided in microwave oven were used. b. Food is not defrosted completely. c. Oven ventilation ports are restricted. d. Cooking time, power level is not suitable.	a. Use microwave-safe cookware only. b. Completely defrost food. c. Check to see that oven ventilation ports are not restricted. d. Use correct cooking time, power level.
Improper defrosting	a. Materials to be avoided in microwave oven were used. b. Cooking time, power level is not suitable. c. Food is not turned or stirred.	a. Use microwave-safe cookware only. b. Use correct cooking time, power level. c. Turn or stir food.

Any Changes or modifications not expressly approved by the party responsible for compliance could void the user's authority to operate the equipment.

This device complies with part 15 of the FCC Rules. Operation is subject to the following two conditions: (1) This device may not cause harmful interference, and (2) this device must accept any interference received, including interference that may cause undesired operation.

Note: This equipment has been tested and found to comply with the limits for a Class B digital device, pursuant to part 15 of the FCC Rules. These limits are designed to provide reasonable protection against harmful interference in a residential installation. This equipment generates, uses and can radiate radio frequency energy and, if not installed and used in accordance with the instructions, may cause harmful interference to radio communications. However, there is no guarantee that interference will not occur in a particular installation. If this equipment does cause harmful interference to radio or television reception, which can be determined by turning the equipment off and on, the user is encouraged to try to correct the interference by one or more of the following measures:

- Reorient or relocate the receiving antenna.
- Increase the separation between the equipment and receiver.
- Connect the equipment into an outlet on a circuit different from that to which the receiver is connected.
- Consult the dealer or an experienced radio/TV technician for help.

This equipment complies with FCC radiation exposure limits set forth for an uncontrolled environment. This equipment should be installed and operated with minimum distance 20cm between the radiator& your body.

This transmitter must not be co-located or operating in conjunction with any other antenna or transmitter.