

Thermal Receipt Printer User Manual



Warning :

No part of this manual can be changed without agreement. The company reverses the rights to modify the technology, components, software and hardware. You may ask the distributors for more product information. No part of chapter in this manual can be copied or transmitted in any format without permission.

Please keep use manual for reference



What is in the box:

80mm Thermal Receipt Printer	×1
AC adaptor (with one AC cable power cord)	×1
Data Cable except for Ethernet port	×1
User's Manual	×1
80mm roll Paper	×1
Software Disc(optional)	×1
WIFI antenna (For WIFI printer with external antenna only)	×1

Connecting the cables

- Connect the adaptor cable to the printer power interface.
- Connect the data cable to the printer port.
- Connect the cash draw to the printer.

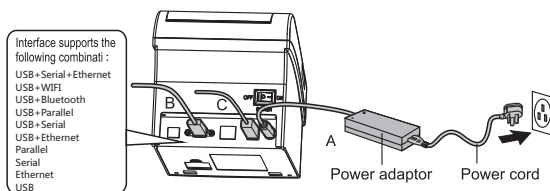

Note: Bluetooth and WIFI connection guide are available in CD

Paper roll installation

Follow the steps below to install the roll paper:

- (1). Open the roll paper cover.
- (2). Insert the roll paper as the following illustration shows.
- (3). Pull out a small roll of paper, and close the roll paper cover.
- (4). Tear up the spare roll paper.

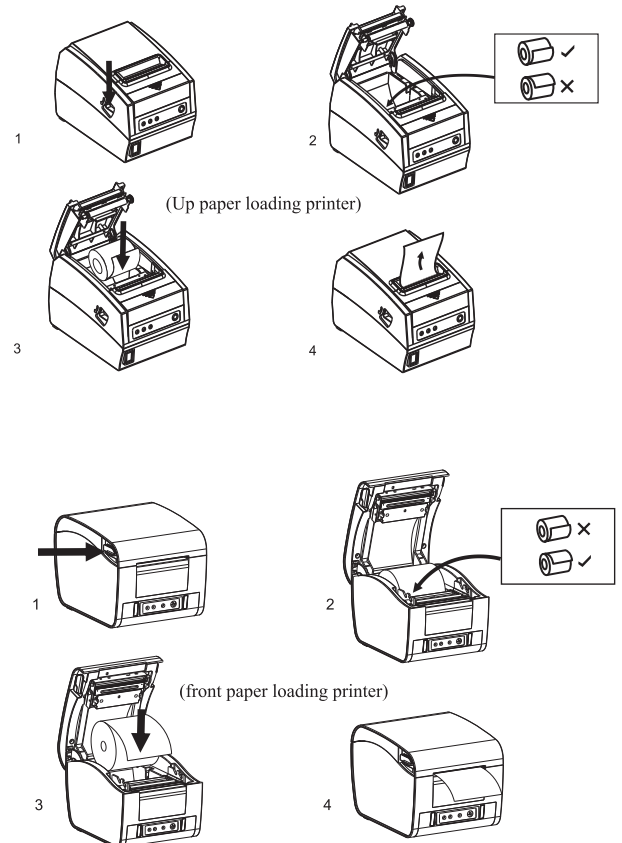

Setting printing Mode(DIP Switches)

DIP switches can be changed settings, such as: cutter, languages, beeper, print density baud rate etc.

DIP Switch functions

DIP Function				
No.	Function	ON	OFF	
SW-1	Select cutter	NO	YES	
SW-2	Select beeper	YES	NO	
SW-3	Select print density	DARK	LIGHT	
SW-4	Two-byte character code	NO	YES	
SW-5	Character per line	42	48	
SW-6	Cutter with cash drawer	YES	NO	
SW-7		ON	OFF	ON
SW-8		ON	ON	OFF
Transmission speed (bps) - bit/s	38400	115200	9600	19200

DIP Switch functions (several models only)

DIP Function				
No.	Function	ON	OFF	
SW-1	Select cutter	NO	YES	
SW-2	Select beeper	YES	NO	
SW-3	58mm	YES	NO	
SW-4	Two-byte character code	NO	YES	
SW-5	Character per line	42	48	
SW-6	Cutter with cash drawer	YES	NO	
SW-3		OFF	OFF	ON
SW-5		OFF	ON	ON
Character per line	48/64CPL	42/56CPL	32/42CPL	32/42CPL
SW-7		ON	OFF	ON
SW-8		ON	ON	OFF
Transmission speed (bps) - bit/s	38400	115200	9600	19200

3

Button name, indicator LED light and function

(1) FEED button

Press to FEED paper manually.

(2) Paper indicator(LED light)

Blue and red light are on means lack of paper, no alarm means all goes well.

(3) Power indicator

Light is on means connected properly.

(4) Error indicator

When out of paper, cutter error or printing head overheat occurred, the ALARM indicator twinkles.

Self Test

Method: When printer is connected power, turn off , press “FEED” button and turn on at the same time, 2 seconds later release “FEED” button, a completed self test will be printed out to show printer settings.

Method to enter hexadecimal mode

Method: When printer is connected power, press“FEED” button and turn on at the same time for about 10 seconds, release “FEED” button to enter data hex dump mode. it will print “Hexadecimal Dump”on the paper.

Reset

Method: When printer is connected power, press“FEED” button and turn on at the same time for about 20 seconds, reset succeed if beeper peals.

How to solve paper jam

(1) Method 1

Re-start printer.

(2) Method 2

Open the battery cover near paper exit. Turn the white gear on the cutter. Only the cutter back to initial position, can the cover be opened.

Caution: Do not damage the printhead and auto cutter by open the cover forcibly.

4

Cautions:

- (1) Be sure to install your printer on a stable surface and prevent it from vibration and impact.
- (2) Do not use and store in locations subject to high temperature, humidity or pollution levels.
- (3) Connect the power adapter into a properly grounded outlet. Do not share the same plug socket with large-scale electrical motor or other motors which may cause the power supply voltage fluctuations.
- (4) Avoid water or other conductive materials like metal get into the intern of printer. If it happens, unplug the AC power cord immediately.
- (5) Do not print without paper, or it will damage the rubber roller and thermal printhead.
- (6) Unplug your printer before leaving it unused for an extended period.
- (7) Never disassemble or modify the printer for repair or reconstruction.
- (8) Be sure to use the original specified power source.
- (9) Quality roll paper is recommended for premium printing and product maintenance.
- (10) Be sure to turn the product off when plugging and unplugging.
- (11) Place the plug socket around the product for convenience.
- (12) This product is used only below 5000 meters above sea level in tropical climate conditions

Clearance

Timely clean the printhead if one of the below conditions occurred:

- (1) Unclear printing.
- (2) Unclear vertical column in printing paper.
- (3) Noisy feeding.

Cleaning steps are as follows:

- (1) Turn off the printer and open the roll paper cover. Remove the roll paper if any.
- (2) After printing, the thermal head can be very hot. Wait to let it cool before cleaning.
- (3) Clean the thermal elements of the thermal head with a wrung -out cotton moistened with an alcohol solvent.
- (4) Wait till the ethanol completely volatilized to close cover. Then print self-test page.

5

⚠ Notice:

- (1) Please make sure power off when maintaining printer.
- (2) Don't touch or scratch printing head surface, roller and sensors.
- (3) Avoid gas, acetone or other organic solvent.
- (4) Wait till alcohol completely volatilized, close top cover and connect power again.
Try print self test to make sure it works properly.

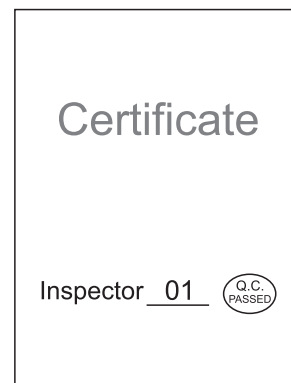

6

FCC warning statements:

This equipment has been tested and found to comply with the limits for a Class B digital device, pursuant to part 15 of the FCC Rules. These limits are designed to provide reasonable protection against harmful interference in a residential installation. This equipment generates, uses and can radiate radio frequency energy and, if not installed and used in accordance with the instructions, may cause harmful interference to radio communications. However, there is no guarantee that interference will not occur in a particular installation. If this equipment does cause harmful interference to radio or television reception, which can be determined by turning the equipment off and on, the user is encouraged to try to correct the interference by one or more of the following measures:

- Reorient or relocate the receiving antenna.
- Increase the separation between the equipment and receiver.
- Connect the equipment into an outlet on a circuit different from that to which the receiver is connected.
- Consult the dealer or an experienced radio/TV technician for help.

Caution: Any changes or modifications to this device not explicitly approved by manufacturer could void your authority to operate this equipment.

This device complies with part 15 of the FCC Rules. Operation is subject to the following two conditions: (1) This device may not cause harmful interference, and (2) this device must accept any interference received, including interference that may cause undesired operation.

The device has been evaluated to meet general RF exposure requirement This equipment complies with FCC radiation exposure limits set forth for an uncontrolled environment.

This equipment should be installed and operated with minimum distance 0.5cm between the radiator & your body.