

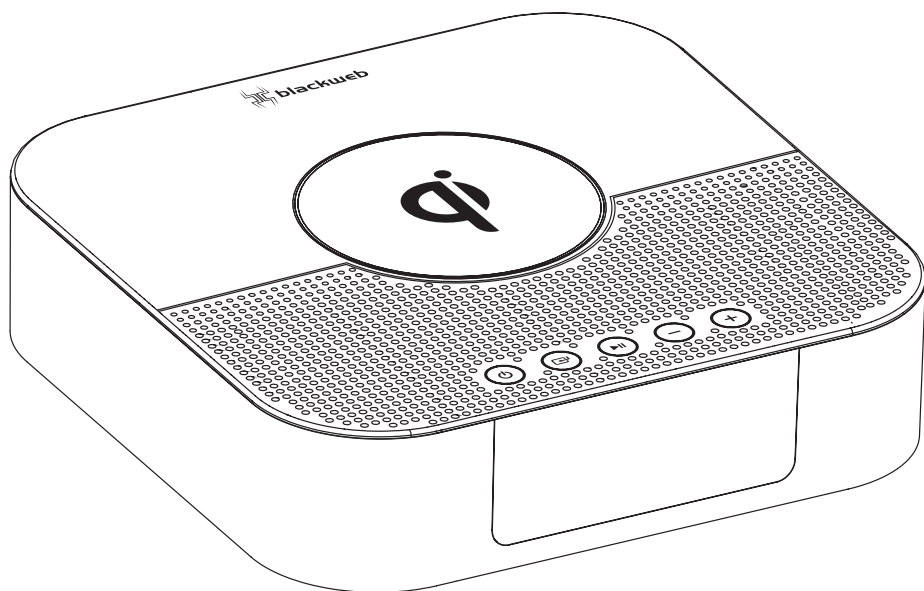

blackweb TM/MC

BWA18AA002C

USER GUIDE GUIDE DE L'UTILISATEUR



SOUND CHARGE
CHARGEUR PAR ALIMENTATION SONORE

CONTENTS

Important Safety Instructions	2
Safety	2
Warning	3
Identifying the Parts	4
Main Unit	4
Remote Control	4
Preparations	5
Prepare the Remote Control	5
Connections	5
Use the AUX Socket	5
Connect to FM Antenna	6
Connect to Power	6
General Operation	6
Power ON/OFF	6
Select Modes	6
Set the Time	6
Set the Alarm Timer	7
Set the Sleep Timer	7
Adjust Display Brightness	8
Adjust the Volume	8
AUX Operation	8
Radio (FM) Operation	8
Auto Scan and Save Preset Station	8
Tuning in a Station	8
Presetting Stations Manually	9
Bluetooth Operation	9
Pair Bluetooth-enabled Devices	9
Listen to Music from Bluetooth Device	10
Troubleshooting	10
Specifications	11
Standard Accessories	11
Warranty	12

IMPORTANT SAFETY INSTRUCTIONS



This lightning flash with arrowhead symbol within an equilateral triangle is intended to alert the user to the presence of non-insulated dangerous voltage within the product's enclosure that may be of sufficient magnitude to constitute a risk of electric shock.



The exclamation point within an equilateral triangle is intended to alert the user to the presence of important operating and maintenance instructions in the literature accompanying the appliance.

Safety

- 1. Read these instructions** - All the safety and operating instructions should be read before this product is operated.
- 2. Keep these instructions** - The safety and operating instructions should be retained for future reference.
- 3. Heed all warnings** - All warnings on the appliance and in the operating instructions should be adhered to.
- 4. Follow all instructions** - All operating and use instructions should be followed.
- 5. Do not use this apparatus near water** - The appliance should not be used near water or moisture - for example, in a wet basement or near a swimming pool and the like.
- 6.** Clean only with a dry cloth.
- 7.** Do not block any ventilation openings. Install in accordance with the manufacturer's instructions.
- 8.** Do not install near any heat sources such as radiators, heaters, stoves, or other apparatus (including amplifiers) that produce heat.
- 9.** Do not defeat the safety purpose of the polarized or grounding-type plug. A polarized plug has two blades with one wider than the other. A grounding type plug has two blades and a third grounding prong. The wide blade or the third prong is provided for your safety. If the provided plug does not fit into your outlet, consult an electrician for replacement of the obsolete outlet.
- 10.** Protect the power cord from being walked on or pinched, particularly at plugs, convenience receptacles and at the point where they exit from the apparatus.
- 11.** Only use attachments/accessories specified by the manufacturer.
- 12.** Use only with the cart, stand, tripod, bracket, or table specified by the manufacturer, or sold with the apparatus. When a cart or rack is used, use caution when moving the cart/apparatus combination to avoid injury from tip-over.
- 13.** Unplug the apparatus during lightning storms or when unused for long periods of time.
- 14.** Refer all servicing to qualified personnel. Servicing is required when the apparatus has been damaged in any way, such as power supply cord or plug is damaged, liquid has been spilled or objects have fallen into the apparatus, the unit has been exposed to rain or moisture, does not operate normally, or has been dropped.
- 15.** ☒ This equipment is a Class II or double insulated electrical appliance. It has been designed in such a way that it does not require a safety connection to electrical earth.
- 16.** The apparatus shall not be exposed to dripping or splashing. No objects filled with liquids, such as vases, shall be placed on the apparatus.
- 17.** Minimum distance around the apparatus for sufficient ventilation is 5cm.
- 18.** The ventilation should not be impeded by covering the ventilation openings with items, such as newspapers, tablecloths, curtains, etc. . .



RISK OF ELECTRIC SHOCK
DO NOT OPEN



CAUTION: TO REDUCE THE RISK OF ELECTRIC SHOCK. DO NOT REMOVE COVER (OR BACK). NO USER-SERVICEABLE PARTS INSIDE. REFER SERVICING TO QUALIFIED SERVICE PERSONNEL.



19. No naked flame sources, such as lighted candles, should be placed on the apparatus.
20. Batteries should be recycled or disposed of as per state and local guidelines.
21. The use of apparatus in moderate or tropical climates.

Caution:

- Use of controls or adjustments or performance of procedures other than those described herein, may result in hazardous radiation exposure or other unsafe operation.
- To reduce the risk of fire or electric shock, do not expose this apparatus to rain or moisture. The apparatus must not be exposed to dripping or splashing and objects filled with liquids, such as vases, must not be placed on apparatus.
- The mains plug/appliance coupler is used as the disconnect device, the disconnect device must remain readily operable.
- Danger of explosion if battery is incorrectly replaced. Replace only with the same or equivalent type.

WARNING

This device complies with Part 15 of the FCC Rules. Operation is subject to the following two conditions:

- (1) This device may not cause harmful interference.
 - (2) This device must accept any interference received, including interference that may cause undesired operation.
2. Changes or modifications not expressly approved by the party responsible for compliance could void the user's authority to operate the equipment.

Note: This equipment has been tested and found to comply with the limits for a class B digital device, pursuant to Part 15 of the FCC Rules. These limits are designed to provide reasonable protection against harmful interference in a residential installation. This equipment generates uses and can radiate radio frequency energy and, if not installed and used in accordance with the instructions, may cause harmful interference to radio communications. However, there is no guarantee that interference will not occur in a particular installation. If this equipment does cause harmful interference to radio or television reception, which can be determined by turning the equipment off and on, the user is encouraged to try to correct the interference by one or more of the following measures:

1. Reorient or relocate the receiving antenna.
2. Increase the separation between the equipment and receiver.
3. Connect the equipment into an outlet on a circuit different from that to which the receiver is connected.
4. Consult the dealer or an experienced radio/TV technician for help.

This equipment complies with FCC radiation exposure limits set forth for an uncontrolled environment. This equipment should be installed and operated with minimum distance 20cm between the radiator & your body.

IDENTIFYING THE PARTS

Main Unit

1. **Qi (Qi) Charging**
2. **Display Panel/Remote Control Sensor**
Show the current status.
Receive the signal from the remote control.
3. **Power button**
Turn on or turn off the unit.
4. **Source button**
Select the play function.
5. **Play/Pause button**
In BT mode, start or pause play.
Press and hold to activate the pairing function in Bluetooth mode and disconnect the existing paired Bluetooth device. Confirm a selection.
Press and hold to scan for radio stations.
6. **+ / - (volume) buttons**
Increase or decrease the volume level.
7. **AC~ Socket** Connect to power.
8. **USB Socket** The USB socket is for service only.
9. **AUX Socket** Connect to an external audio device.
10. **ANT. Socket** Connect to a FM Antenna.

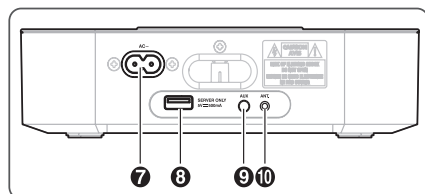
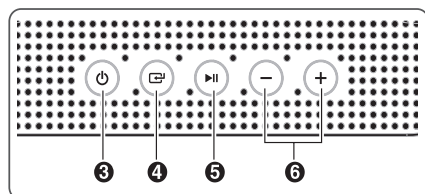
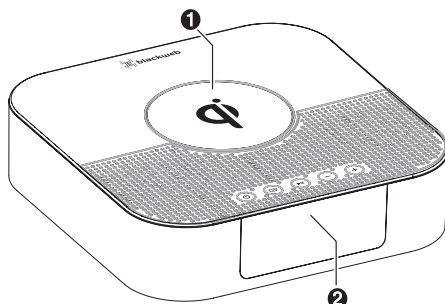

Remote Control

1. **Power** Turn on or turn off unit.
2. **BT/FM/Source** Select the play function.
3. **SNOOZE** Repeat the alarm.
4. **▲/▼** Select a next/preset station.
▶▶ In BT mode, start or pause play.
◀◀▶▶ In BT mode, skip to previous/next track.
Search radio stations manually/ automatically.
5. **Bluetooth icon** Enable Bluetooth pairing mode in Bluetooth mode.
6. **zZ** Set the sleep timer.
7. **DIMMER** Adjust display brightness.
8. **Mute icon** Mute or resume the sound.
9. **Clock icon** Set the clock.
10. **PROG** Preset stations for tuner.
Press and hold to scan for radio stations.
11. **Alarm icon** Set the alarm (1 or 2) timer.
View the alarm (1 or 2) setting.
12. **VOL+ /VOL-** Increase/decrease the volume level.

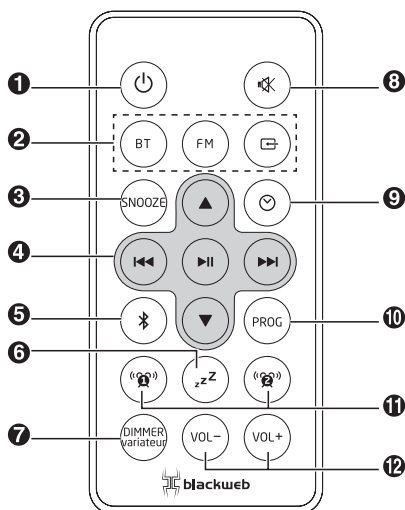

PREPARATIONS

Prepare the Remote Control

The provided Remote Control allows the unit to be operated from a distance.

- Even if the Remote Control is operated within the effective range (19.7 feet), remote control operation may be impossible if there are any obstacles between the unit and the remote control.
- If the Remote Control is operated near other products which generate infrared rays, or if other remote control devices using infrared rays are used near the unit, it may operate incorrectly. Conversely, the other products may operate incorrectly.

First-time use:

The unit has a pre-installed lithium CR2025 battery. Remove the protective tab to activate the remote control battery.

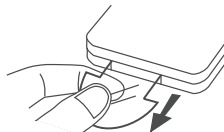

To Replace the Remote Control Battery:

1. Pull out the battery tray and remove the old battery.
2. Place a new CR2025 battery into the battery tray with correct polarity (+/-) as indicated.
3. Insert the battery tray back into the slot.

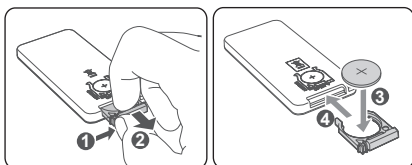

Precautions Concerning Batteries

- When the Remote Control is not to be used for a long time (more than a month), remove the battery from the Remote Control to prevent it from leaking.
- If the batteries leak, wipe away the leakage inside the battery compartment and replace the batteries with new ones.
- Do not use any batteries other than those specified.
- Do not heat or disassemble batteries. Never throw them in fire or water.
- Do not carry or store batteries with other metallic objects. Doing so could cause batteries to short circuit, leak or explode.
- Never recharge a battery unless it is confirmed to be a rechargeable type.

CONNECTIONS

Use the AUX Socket

- Connect the 3.5mm to 3.5mm audio cable to the **AUX** socket on the rear of unit and to the headphone socket on the audio player.

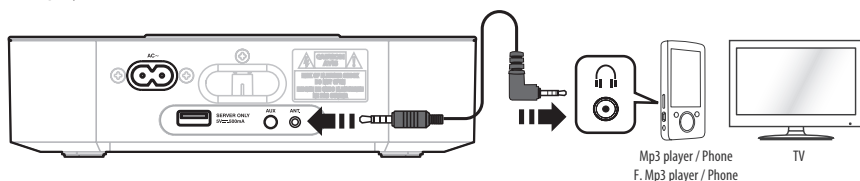

AUX OPERATION

Connect to FM Antenna

- Connect the supplied FM wire antenna to the FM Antenna socket on the unit.

Connect to Power

- **Risk of product damage!** Ensure that the power supply voltage corresponds to the voltage printed on the rating label on the back or the underside of the unit.
- Be sure to unplug the power cord from the outlet when the system is not in use for an extended period of time.
- Connect the AC power cord to the wall socket.

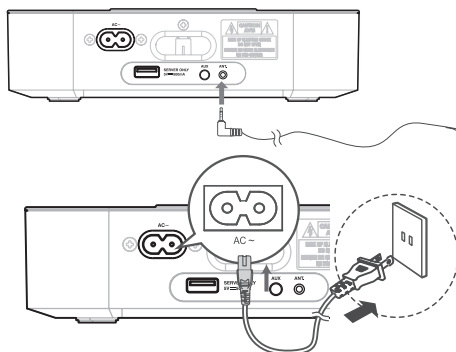

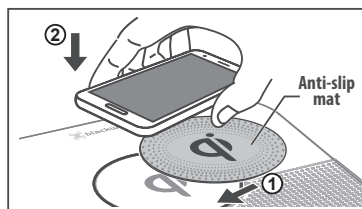

• Uses of Qi (wireless charging)

- This function only works with mobile devices that support **Qi** technology.
1. To prevent the displacement of mobile devices, please put anti-slip mat first.
 2. Make sure your mobile devices are aligned to unit's **Qi** charging area.
- When mobile devices play music while charging **Qi**, mobile devices may appear mobile phenomenon, please reduce unit's volume.
 - When mobile devices can not charge, please check whether mobile devices are shifted.



GENERAL OPERATION

Power ON/OFF







- When you first connect the unit to the main socket, the unit will be in **STANDBY** mode.
- Press the  button on the remote control or on main unit to switch the main unit **ON**.
- Press the  button on the remote control or on main unit to switch the main unit back to **Standby** mode.
- Disconnect the main plug from the main socket if you want to switch the unit off completely.
- If there is no signal under the **BT** and **AUX** mode, the unit will automatically be switched off within 1 minutes.

Select Modes

- Press the  button on the main unit or the **BT / FM** /  on the remote control to switch BT (Bluetooth), FM and **AUX** mode.

Set the Time

The built-in clock shows the correct time in the display.

1. In **STANDBY** mode, press and hold the  button on the remote control, the hour indicator blinks.
 2. Press the  /  buttons on the remote control to set the hour. Then press the  button to confirm the hour.
 3. Press the  /  buttons on the remote control to set the minute. Then press the  button to confirm the minute.
- This will finish the clock setting.

Important:

- If no button is pressed for 15 seconds, the settings will be lost and you will need to start again.















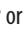

• To display the clock time

- When you press the button, the clock time is displayed. Wait for a few seconds until the display returns to the original display.

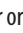
Set the Alarm Timer

You can set two alarms that go off at different times.

- Ensure that you have set the clock correctly.

1. Press and hold the “” or “” buttons on remote control in standby mode for a few seconds and the hour digits will flash.
2. Press the /  buttons on the remote control to set the required hour. Then press the “” or “” buttons to confirm the hour.
3. Press the /  buttons on the remote control to set the required minute. Then press the “” or “” buttons to confirm the minute.
4. Press the /  buttons on the remote control to select an alarm sound source: FM tuner or buzzer. Then press the “” or “” buttons to confirm.
5. Press the /  buttons on the remote control to select the required volume, we recommend no less than 5 as a minimum. Then press the “” or “” buttons to confirm.

• Activate and Deactivate the Alarm Timer:

Press the “” or “” buttons repeatedly to activate or deactivate the timer.



If the timer is activated, [AL 1] or [AL 2] is displayed.

If the timer is deactivated, the [AL 1] or [AL 2] will disappear from the display on the front of the unit.

• Repeat Alarm:

You can press to adjust the interval to repeat alarm. When the alarm rings, press the **SNOOZE** button on remote control. The alarm repeats ringing 9 minutes later.

• Stop Alarm Ring:

When the alarm rings, press the corresponding “” or “” or  button. The alarm stops, but the alarm settings remain.

• View the Alarm Settings:

Press the “” or “” buttons to view the alarm settings.

Set the Sleep Timer

This unit can switch to standby automatically after a set period of time.

1. Press the **zZ** button on remote control repeatedly to select a set period of time (in minutes).



90 → 60 → 30 → 15 → 00

- When the sleep timer is activated, the display will show [**Zz**] and the volume will gradually decrease before the unit powers off.
- 2. Press the **zZ** button on remote control repeatedly until [**00**] is displayed.
- When the sleep timer is deactivated, [**Zz**] disappears from the display.

Adjust Display Brightness



Press the **DIMMER** button on remote control repeatedly to select different levels of display brightness.

Adjust the Volume

During play, press the **VOL** +/- buttons on remote control or on main unit to increase/decrease the volume level. If you wish to turn the sound off, press the  button on the remote control. Press the  button again or press **VOL** +/- button on remote control or on main unit to resume normal listening.

AUX Operation

You can listen to an external audio device through this unit.

1. Ensure that the unit is connected to the TV or audio device.
2. Press the  button on the main unit or the  button on the remote control to select the **AUX** source.
3. Start to play on the audio player.
4. Press the **VOL** +/- button on remote control or on main unit to adjust the volume to your desired level.

Radio (FM) Operation

Auto Scan and Save Preset Station

1. Press the  button on the main unit or the **FM** button on the remote control to select **FM** mode.
2. Press and hold the **PROG** button on the remote control for a few seconds to activate automatic programming.
All available stations are programmed in the order of waveband reception strength.
- The first programmed radio station is played automatically.
3. Press the **▲** or **▼** buttons on the remote control to select a preset number that you want.

Tuning in a Station

Press and hold the **◀◀/▶▶** buttons on the remote control, the frequency changes down or up automatically until a station is found. Press the **◀◀/▶▶** buttons on the remote control repeatedly until you find the station you want.

Presetting Stations Manually

You can preset up to 20 FM stations.



1. Tune in the desired station, then press the PROG button on the remote control.
2. Press the ▲/▼ buttons on the remote control to select the preset number.
3. Press the **PROG** button on the remote control to store the station.
4. Repeat above steps 1 to 3 for each station you want to store in memory with a preset number.

BLUETOOTH® OPERATION

Pair Bluetooth-enabled Devices

The first time you connect your bluetooth device to this player, you need to pair your device to this player.

Note:

- The operational range between this player and a Bluetooth device is approximately 8 meters (without any object between the Bluetooth device and the unit).
 - Before you connect a Bluetooth device to this unit, ensure you know the device's capabilities.
 - Compatibility with all Bluetooth devices is not guaranteed.
 - Any obstacle between this unit and a Bluetooth device can reduce the operational range.
 - If the signal strength is weak, your Bluetooth receiver may disconnect, but it will re-enter pairing mode automatically.
1. During ON mode, press the  button repeatedly on the unit or the **BT** button on the remote control to select Bluetooth mode. "**NO BT**" will show on the display if the unit is not paired to any Bluetooth device.
 2. Activate your Bluetooth device and select the search mode. "**BWA18AA002C**" will appear on your Bluetooth device list.
 - If you cannot find the unit, press and hold the  button on the unit or press the  on the remote control to be searchable. The display will show "**PAIR**" and you will hear "**Pairing**" from the unit.
 3. Select "**BWA18AA002C**" in the pairing list. After successful pairing, you will hear "**Paired**" from the unit, and the display panel shows "**BT**".
 4. Play music from the connected Bluetooth device.

To disconnect the Bluetooth function, you can :

- Switch to another function on the unit.
- Disable the function from your Bluetooth device. The Bluetooth device will be disconnected from the unit after the "**Disconnected**" voice prompt.
- Press and hold the  button on the unit or press the  on the remote control.

Tips:

- Enter "**0000**" for the password if necessary.
- If no other Bluetooth device pairs with this player within two minutes, the player will recover its previous connection.

- The player will also be disconnected when your device is moved beyond the operational range.
- If you want to reconnect your device to this player, place it within the operational range.
- If the device is moved beyond the operational range, when it is brought back, please check if the device is still connected to the player.
- If the connection is lost, follow the instructions above to pair your device to the player again.

Listen to Music from Bluetooth Device

- If the connected Bluetooth device supports Advanced Audio Distribution Profile (A2DP), you can listen to the music stored on the device through the player.
- If the device also supports Audio Video Remote Control Profile (AVRCP), you can use the player's remote control to play music stored on the device.
 1. Pair your device with the player.
 2. Play music via your device (if it supports A2DP).
 3. Use supplied remote control to control play (if it supports AVRCP).
 - To pause/resume play, press the ►|| button on the remote control.
 - To skip to a track, press the ◀◀/▶▶ buttons on the remote control.

TROUBLESHOOTING

To keep the warranty valid, never try to repair the system yourself. If you encounter problems when using this unit, check the following points before requesting service.

No power

- Ensure that the **AC** cord of the apparatus is connected properly.
- Ensure that there is power at the **AC** outlet.

Remote control does not work

- Before you press any playback control button, first select the correct source.
- Reduce the distance between the remote control and the unit.
- Insert the battery with its polarities (+/-) aligned as indicated.
- Replace the battery.
- Aim the remote control directly at the sensor on the front of the unit.

Poor radio reception

- Increase the distance between the unit and your **TV** or **VCR**.
- Fully extend the **FM** antenna.

Timer does not work

- Set the clock correctly.
- Switch on the timer.

Clock/timer setting erased

- Power has been interrupted or the power cord has been disconnected.
- Reset the clock/timer.

This is a 15 minute power off function, one of the ERPII standard requirement for saving power

- When the unit's external input signal level is too low, the unit will be turned off automatically in 15 minutes.
Please increase the volume level of your external device.

SPECIFICATIONS

General

Power Supply	AC 120V~ 60Hz
Power Consumption	20W
Output Power	3W x 2
Total Harmonic Distortion	1%(1kHz, 1W)
Audio Input Sensitivity	500mV
Frequency Response	40Hz - 20kHz
USB (service only)	5V==500mA
Tuning Range	87.5-108MHz
Unit Dimensions (W x H x D)	7.8 x 2.2 x 7.8 inches
Speaker Impedance	2Ω x 2

Bluetooth

Version	V 4.2
Maximum power transmitted	5 dbm
Frequency bands	2402 MHz ~ 2480 MHz

Remote Control

Distance	19.7 feet
Angle	30°
Battery type	CR 2025

STANDARD ACCESSORIES

General

Remote Control	x 1
Owner's Manual	x 1
Power Cord	x 1
3.5mm to 3.5mm audio Cable	x 1
FM Cable	x 1
Anti-slip Mat	x 1

WARRANTY

ONE-YEAR LIMITED WARRANTY

This product carries a warranty that it will be free from defects in material and workmanship for a period of one year from the date of purchase. This warranty is valid for the original retail purchaser from the date of initial retail purchase and is not transferable. Keep your original sales receipt.

IMPORTANT: this warranty does not cover damages resulting from accident, misuse or abuse, lack of reasonable care, the affixing of any attachments not provided with the product, loss of parts, third party repairs, normal wear and tear or subjecting the product to any but the specified voltage. (read directions carefully.)

If service is required during the warranty period, properly pack your unit. We recommend using the original carton and packing materials. Return the product to your nearest Wal-Mart store with the sales receipt. A replacement or refund may be offered at the discretion of Wal-Mart. If additional assistance is needed please contact customer assistance at 1 888 778 8525.

Not applicable in Quebec: Wal-Mart expressly disclaims all responsibility for consequential damages or incidental losses caused by use of the product.

This warranty gives you specific legal rights, and you may also have other rights which may vary from province to province.

SAVE THIS FOR YOUR RECORDS