

UHF Wireless handled microphone

User manual

pls read the User manual before use the device.

尺寸: 95mm*130mm

Product Presentation

This wireless microphone adopts UHF band transmission, featuring wide transmission range, outstanding anti-interference ability, low latency and clear sound quality. It is easy to operate and boasts a long runtime. It is widely applied such occasions as teaching, conference and stage performance.

Notes

Please carefully read the manual before use and be sure to keep it for future use.

Device Layout

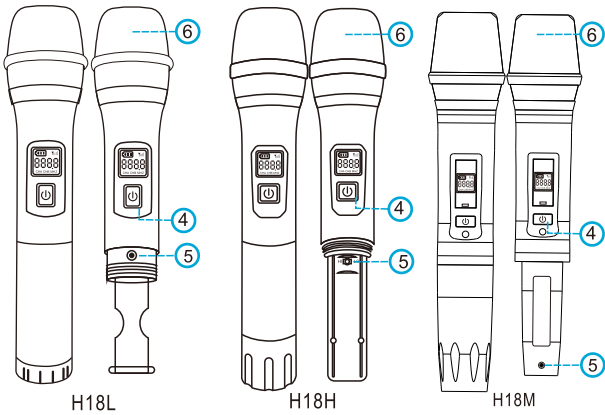

Receiver(H18F6)

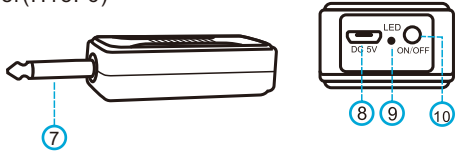

Receiver(H1806)

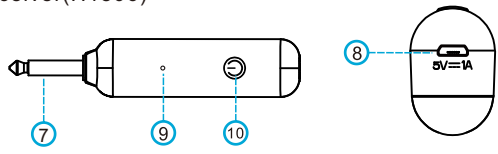

Notes: The picture is for reference only, the actual package of the product shall prevail. The right of interpretation belongs to the company!

- 1, Battery capacity icon
- 2, Frequency icon
- 3, A/B channel icon
- 4, multi-button with Power on/off and voice adjust (hold on 3s for it to be power on, pressing it in short to changed mode at volume+recycle)
- 5, Multi-button with match/frequency conversion
- 6, Net head
- 7, 6.35mm plug to Mic Audio box
- 8, 5V Charge port
- 9, Dual-LED
- 10, Power switch
- 11, Signal Adapter

Product Feature

- 1. Wireless transmission, free from cable mess
- 2. UHF system, excellent anti-interference ability and clear sound quality
- 3. Easy to operate. One key to turn on/off the microphone and volume control.
- 4. The LED screen displays the working status, easy to see.
- 5. Wide application of teaching, recreation, meeting and more.

Basic Operation

- 1. Connection with Amplifier
- 1.1 Insert the receiver plug into the MIC hole of the device



- 1.2 The plug on the receiver is 6.3mm, for some amplifier the "MIC" hole is 3.5mm, please use the additional 3.5mm adapter (include) for connection.

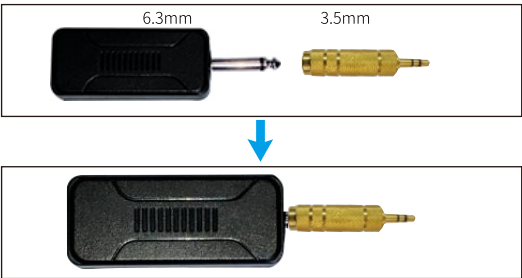

Notes

- A. For some amplifier that do not contain a "mic" hole, please use the Line in or AUX hole for us.
- B. About amplifiers: In general, amplifiers are including but not limited to power amplifiers, small speakers, portable speakers and DVDS. The product is not to blame for a rare case when an amplifying device is devoid of a mic, a line in or an AUX jack.

2. Turn on/off the device

- 2.1 Turn on/off the receiver: Press the power button of the receiver, the blue light on the receiver will flash, waiting for connection. Press again the power button, the blue light will go out. Charge the receiver: When the blue light of the receiver flashes, it indicates low battery power, you need to charge it, the charge port of the device is a standard Micro USB port. To charge the device,

please use the included charge cable to connect it with computers, mobile power bank or power adapter, the red light will always light up when charging, when fully charged, the red light will go

- 2.2 Turn on/off the microphone: Insert two AA batteries, press the power button of the microphone and do not release until the screen lights up and shows "UHF", connect the microphone and the receiver, the blue light will stop flashing when successfully connected, and stay light up.

Notes

We recommend you to use AA Alkaline battery for longer use. When the icon in the display screen changes to and flashes, you need to change batteries.

- 3. Turn on the amplifier and activate the signal mode, adjust the amplifier volume to a proper level, now the microphone begins to work.

Notes

As amplifiers vary in output and current parameters, users are supposed to adjust the volume of both the wireless microphone and the amplifier as well as the distance, or the amplifier will emit a high-pitched whine.

- 4. Volume control: Short press the button after the microphone turns on to adjust the volume, you can adjust the 5 volume levels in turn from 08 to 12. A "Di" volume indicator appears when a volume button is pressed. And you will hear a consecutive "Di-Di-Di-Di" sound when the volume meets its maximum.

Notes

The microphone is on 8th volume grade each time when you turn it on by default.

Advanced Operation

The following are operations you might need to know for frequency interference solutions or misoperations

1. Pairing:

- 1.1 Pairing refers to connection operation between microphone and the designed receiver. Ensure the microphone and the receiver are of sufficient power, and the microphone is in a turned on mode, the receiver in a turned off mode.
- 1.2 Remove the battery cover of the microphone, press and hold pairing button until the display flashes quickly, which means it is waiting to be paired. Turn on the receiver and the blue light of the receiver flickers, meaning it is waiting to be connected. The microphone and the receiver will automatically be paired, and the indicator light will stay on when successfully paired. If the receiver light remains flickering, you have to follow the above steps again until the two get paired.

Notes

- A. Please turn on the microphone and make sure it enters pairing mode before turning on the receiver.
 - B. Pairing time: The microphone is supposed to be paired within ten seconds, after ten seconds, the microphone will exit pairing mode, you have to long press the pairing button until the LED screen flashes.
 - C. If there are several sets of devices that need to be paired, only two microphones (one for the A channel, the other one for the B channel) and one receiver are allowed to be turned on for pairing at a time.
2. Channel Switch: Signal interference may occur in some environments, and it is necessary to switch channels to avoid interference. Short press the pairing button on the microphone,

the frequency number on the display will switch once and the receiver will switch synchronously.

Notes

- A. A successful pairing is required before channel switching.
- B. Sequence of channel frequency change of several sets of devices is as follows: for the first set, long press the -button once, the second press - twice, the third press - three times, and so on, all together 9 devices are supported. Every press, the number on the display.

Product Parameters

| | | |
|------------------------|------------|---------------------------|
| Transmission frequency | | U Band |
| Audio Signal | | Digital Sampling 48Khz |
| Frequency Response | | 50Hz-16Khz |
| Usage Time | | About 6 hours |
| Wireless Range | | 50m (in classroom) |
| Microphone Type | | Dynamic microphone |
| Way of Pairing | | Paired by factory default |
| Power Supply | Receiver | Polymer Lithium battery |
| | Microphone | AA Battery |

FCC Statement

This device complies with part 15 of the FCC rules. Operation is subject to the following two conditions: (1) this device may not cause harmful interference, and (2) this device must accept any interference received, including interference that may cause undesired operation.

Changes or modifications not expressly approved by the party responsible for compliance could void the user's authority to operate the equipment.

NOTE: This equipment has been tested and found to comply with the limits for a Class B digital device, pursuant to part 15 of the FCC Rules. These limits are designed to provide reasonable protection against harmful interference in a residential installation. This equipment generates uses and can radiate radio frequency energy and, if not installed and used in accordance with the instructions, may cause harmful interference to radio communications. However, there is no guarantee that interference will not occur in a particular installation. If this equipment does cause harmful interference to radio or television reception, which can be determined by turning the equipment off and on, the user is encouraged to try to correct the interference by one or more of the following measures:

- Reorient or relocate the receiving antenna.
- Increase the separation between the equipment and receiver.
- Connect the equipment into an outlet on a circuit different from that to which the receiver is connected.
- Consult the dealer or an experienced radio/TV technician for help.

The device has been evaluated to meet general RF exposure requirement. The device can be used in portable exposure condition without restriction.