

BS228RK

TWS Bluetooth Headset

User Manual

Bluetooth headset should be used with the compatible devices which support Bluetooth wireless technology. This allows you to make two calls and enjoy the music streaming at any time freely. Please read this user manual carefully before using the headset, and also read your device's user manual regarding the Bluetooth function, and pay attention to those important safety and maintenance information. Please keep the headset away from children.

Specifications

Bluetooth Version :	V5.0
Bluetooth Profiles Supported :	HFP, HSP, A2DP, AVRCP
Audio Decoding Protocol :	SBC, AAC, APTX
Transmission Power :	Class 2
Operation Range :	Up to 10 meters
Frequency Range :	2.4GHz-2.48GHz
Battery of Headset :	45mAH Li-polymer Battery
Charging Voltage of Headset :	5V±0.2V
Charging Time of Headset :	About 1.5 hours
Battery of Base :	420mAH Li-polymer Battery
Charging Voltage of Base :	4.75V-6V
Charging Time of Base :	About 2 hours
Charging Headset Times from	
Charging Base :	2-3 times
Music Playing Time :	≥ 7 hours
Talk Time :	≥ 7 hours
Standby Time :	About 100 hours
Driver :	φ6mm
Driver sensitivity :	90±3dB
Driver impedance :	16Ω±15%
Driver frequency ring range :	20HZ-20kHz
Dimensions of Charging	
Base(mm) :	L80×W33×H31
Dimensions of Headset(mm) :	L26×W16.6×H24.2
Weight(one headset) :	About 4.5 g
Total Weight :	About 53.8 g

*The time mentioned above may vary due to user's operation mode and device settings.

Structure Sketch

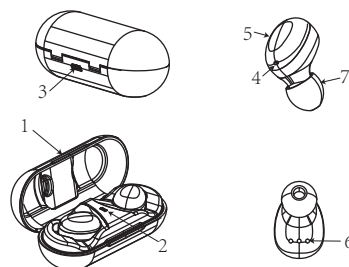

- 1) Charging Base Opening Snap
- 2) Charging Base Indicator
- 3) Micro USB Charging Port
- 4) Indicator and Mic Hole
- 5) Touch Panel
- 6) Charging Pogo Pin
- 7) Ear Tips

Headset Mode

Status No.	Status	Charging Base Performance
1	Pairing Mode with Bluetooth Device	The indicator light of headset flashes red and blue alternately
2	TWS Pairing Mode	The indicator light of headset flashes blue quickly
3	Standby Mode	The indicator light of the headset flashes blue once every 5 seconds
4	Call Mode	When in a call, the indicator light of the headset flashes red every 5 seconds
5	Power On	The indicator light flashes blue for three times.
6	Power Off	The indicator light flashes red for three times.
7	Low Voltage Alarm State	The indicator light flashes red once every 20 seconds

Charging Base Mode

Status No.	Status	Headset Performance
1	Charging Mode of the Charging Base	1.The indicator flashes red when being charged. The red will flash according times until the battery is up to the corresponding level. 2. No being charged or discharging to the earbuds, the indicator is off 3.The indicator light is red when being fully charged
2	Charging Base Battery Indication	The indicator flashing red once every 2 seconds means 25% battery, twice means 50% , 3 times means 75% and 4 times means full battery(100%).

Identify according to L&R and wear the headset (R) and headset (L) respectively



Wearing Steps:

Step①

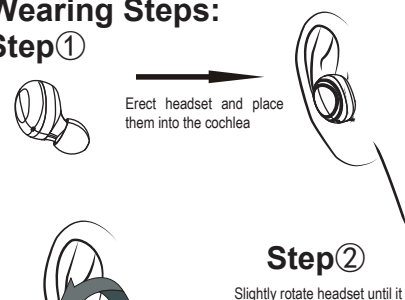

Step②

Slightly rotate headset until it firm

Step③

Make the headset to cochlear edge tightly

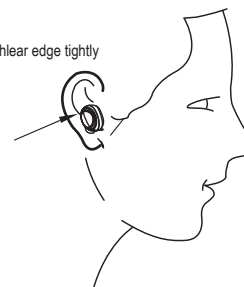

Charging Ways of Headset

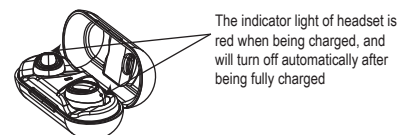

Put the headset (L) (R) to the corresponding position in the bottom of the charging base.

Charging Ways of Charging Base

Use the USB charging cable to charge

The red will flash according times until the battery is up to the corresponding level and will be always on when it is fully charged,

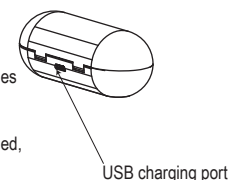

■ Use the USB cable to connect with computer

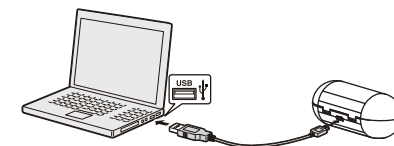

■ Use the USB cable to connect with mobile phone charger

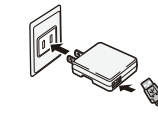

Note 1: Check the charging device is suit to the headset or not.

Note 2: Use only the supplied charger to charge the headset, if use other device may violate the validation or the maintenance article of this product and may cause danger.

Note 3: Do not attempt to force open the built-in battery as this will damage the headset.

Note 4: A fully charged headset will lose its power automatically if left unused. It is recommended to charge the headset each three months.

Note 5: Do not leave the headset in a too hot or too cold condition (best between -10 °C and 50 °C) which may affect the headset's operations although it is fully charged.

Note 6: Do not dispose of the headset into fire or water.

Turning ON/OFF

1 Method

Pick up the headsets from the charging base to turn on automatically. Put them back to power off and charge the headset.

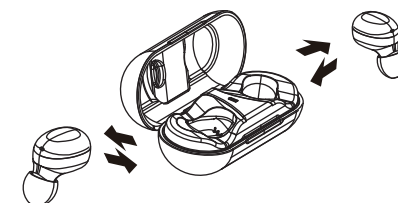

2 Method

In OFF MODE, touch headset(R) or headset(L) MFB for 2 seconds to turn on.

In ON MODE, touch headset(R) or headset(L) MFB for 5 seconds to turn off.

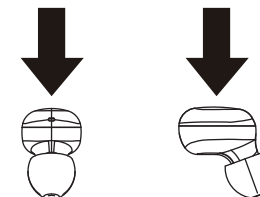

TWS Pairing

1



Pick up the two headsets from the charging base to power on and waiting for few seconds , the two headsets will enter auto-pairing mode. The two headsets connect with each other after few seconds, the headset (R) alternately flashing red and blue, and then open the phone's bluetooth device to search"BS228RK".

Note: When the first time to pairing or after delete the pairing records, the headsets should be paired under 20cm unobstructed.

2

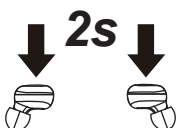

In OFF state, touch MFB key for 2 seconds to power on and waiting for few seconds , the two headsets will enter auto-pairing mode. The two headsets connect with each other after few seconds, the headset (R) alternately flashing red and blue, and then open the phone's bluetooth device to search "BS228RK".

Do as the above ways: 1 or 2 ,and it prompts "Connected" after TWS paired successfully: left headset prompts "Left connected" and right headset prompts "Right connected-pairing"

Cell phone begins to search for bluetooth devices (see the user guide of your phone instructions), and select "BS228RK" from bluetooth device list. the right headset prompts "Pairing successful". the left and right headset prompts "dingdong", and the right headset prompts "Connected".

After the right headset paired with mobile phone successfully, the mobile phone will have a Bluetooth pairing request (iphone must be connected to the Bluetooth interface on the mobile phone), select the match, and the left headset prompts "paring successful".

The master-slave switching function cannot be used without matching the left earphone (L).

Note: When the headsets TWS pairing failures, double touch the headset R and headset L to enter TWS pairing, then pair with phone.

Master-slave switching

The master and slave headset are automatically paired after being turned on. The right headset is the master headset.

When the master headset is placed in the charging box, the slave headset will automatically connect to the mobile phone and can be used continuously.

When the left headset is turn on first and reconnected with mobile phone , the left headset is the master headset.

When the right headset is turn on first and reconnected with mobile phone , the right headset is the master headset.

Note: Single connection instructions: TWS and mobile pairing records are required for single use.

TWS Reconnected

Method1: Touch MFB of headset(R) or headset(L) for 2 seconds to power on →wait for few seconds, the two headsets connect automatically→the headset pairs with the mobile phone that has ever paired after few seconds →reconnected successfully.

Method2: Pick up the headsets from charging base to power on→wait for few seconds, the two headsets connect automatically→the headset pairs with the mobile phone that has ever paired after few seconds →reconnected successfully.

Note: the right and left headset will prompt"Dingdong" after TWS reconnected successfully, the right headset prompts "connected" after reconnected with mobile phone successfully

TWS wake up

If there's no any operations on headsets for more than one minute, it requires to touch the headset to wake it up, then continue for other headset operations.

Answer /End a Call

When call incoming, touch MFB of headset (R) or headset (L) one time to answer the call, when you hear "Di"

In call mode, touch MFB of headset (R) or headset (L) for 2 seconds to end the call when you hear "Di +Call End" .

in call mode, put one of headset into charging base, to end the call.



Reject a call



(1) Touch MFB of headset(R) or headset(L) for 2 seconds to reject the call, the headset prompts "Didi, Call Reject".

(2) When call incoming, put one of headset into charging base, to end the call

Voice Dialing



On standby mode or music playing state, double touch the MFB of headset(L) to activate this function (double touch to start, double touch to close) the headset prompts "Di".

Note: This function only supports phone with voice dialing function

Music Pause/Playing



In standby mode, touch MFB of headset(R or L) to play music and the headset prompts "Di".

On music playing state, double touch MFB of headset(R) to PAUSE music and the headset prompts "Di".



Volume +/-

In call mode or music playing mode, single touch MFB of headset(R) to volume up; single touch MFB of headset(L) to volume down, volume up do not have prompt, you will hear "Di" form right headset when volume is up to maximum.

volume down do not have prompt, 1. in call mode, the right headset prompt: "Di" when volume is up to minimum

2. music playing mode, the left headset prompt: "Di" when volume is up to minimum

Pre/Next Track

In music playing mode, touch MFB of headset(R) for 2 seconds and release when the right headset prompt "Di" to next song; touch MFB of headset(L) for 2 seconds and release when the left headset prompt "Di" to previous song.

Delete Pairing Records on the Headset

In OFF mode, touch MFB of headset(R) or headset(L) about 8 seconds when you hear "Di", and double touch MFB until hearing "Doo" 3 times to delete Pairing Records

Maintenance

- Do not use abrasive cleaning solvents to clean the headset.
- Do not allow the headset to touch with any sharp objects as this will cause scratching and damages.
- Please keep headset away from high-temperature, humidity and dust.

Trouble Shooting

Trouble	Reasons	Solutions
Can not turn on	low battery protection	Charging headsets for 1-2 hours
Can not turn on by picking up the headset (No indicator light when headset being charged)	Charging base low battery protection	Charging both the headsets and charging base for 1-2 hours
No sounds after pairing	Wrong pairing	Pairing again
The two headsets TWS pairing failure/TWS paired successful but can not find the headset(R)	Too many pairing records	Delete pairing records
Charging base without indicator light when charging	DC power supply doesn't output power	Check whether the micro USB charging line is plugged well or not
Headsets without indicator light when charging	The headsets couldn't be charged in charging base	1) Checking headset charging interface whether has touched to POGO PIN of charging base and the location is correct or not. 2) Charging for charging base
Turning off automatically	Low battery	Charging headset for 1-2 hours
Headset echo	Volume is too loud or environment is noisy	Adjust the volume at phone change a place
Noise in call	Environmental interference caused or distance between headset and mobile is too far	Change a place or move the headset close to the mobile phone
Low voice of the calling party	Wearing headset is wrong	Adjusting wearing position of headset
Headphone operation does not work	Unprocessed left headset pairing popup	TWS pairing after pairing is cleared and connected to the phone
Play music from the phone when you touch the button	Unprocessed left headset pairing popup	TWS pairing after pairing is cleared and connected to the phone

NOTE: This equipment has been tested and found to comply with the limits for a Class B digital device, pursuant to part 15 of the FCC Rules. These limits are designed to provide reasonable protection against harmful interference in a residential installation. This equipment generates uses and can radiate radio frequency energy and, if not installed and used in accordance with the instructions, may cause harmful interference to radio communications. However, there is no guarantee that interference will not occur in a particular installation. If this equipment does cause harmful interference to radio or television reception, which can be determined by turning the equipment off and on, the user is encouraged to try to correct the interference by one or more of the following measures:

- Reorient or relocate the receiving antenna.
- Increase the separation between the equipment and receiver.
- Connect the equipment into an outlet on a circuit different from that to which the receiver is connected.
- Consult the dealer or an experienced radio/TV technician for help

Changes or modifications not expressly approved by the party responsible for compliance could void the user's authority to operate the equipment.

This device complies with Part 15 of the FCC Rules. Operation is subject to the following two conditions:

- (1) this device may not cause harmful interference, and
- (2) this device must accept any interference received, including interference that may cause undesired operation.