

# Description of E-Label on the ZNFQ720VS

1. FCC ID is applied by E-label on device.

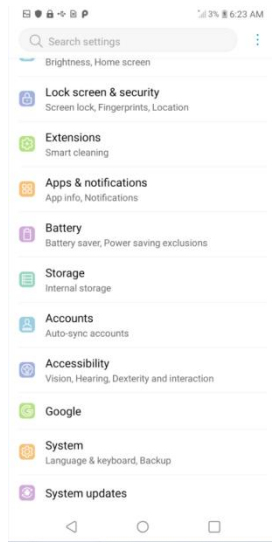

[Step1]

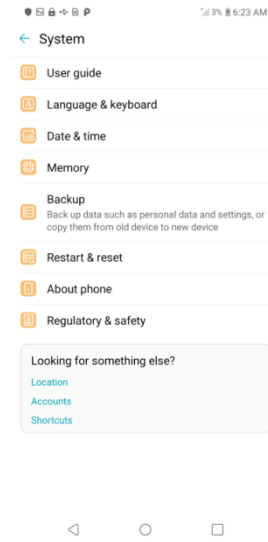

[Step2]



[Step3]

Settings Menu	
Step 1	Select Settings
Step 2	Select System
Step 3	Select Regulatory & safety

## Description of E-Label on the ZNFQ720VS

2. FCC ID is applied on packaging.

FCC ID : ZNFQ720VS

3. Instruction of E-label on the user manual

**Regulatory Information (FCC ID number, etc.)**

For regulatory details, go to **Settings > System > Regulatory & safety.**