



Please read the instructions carefully before using this product!
This product is intended for use mainly in the home,office or similar location.

WIRELESS HEATING THERMOSTATIC CUP MANUAL



Steps for usage:
1.Stick the gray surface of the cup sticker on the bottom of the cup.
2.Press by hand to make the gray surface completely adhere to the bottom of the cup.
3.After pasting, you can put the cup on the coaster for use
4. Do not place the cup sticker on the coaster alone to avoid heat and scald.

Scope Of Delivery
1 x Heating Cup Pastes
1 x Wireless Charger Pad
1 x USB charging cable
1 x User manual

Specifications:
Heating Cup Pastes size: 60*4mm
Wireless Charger size: 100*8 mm
Wireless phone charging output: 15W, 10W, 7.5W, 5W (max.9V/1.67A)



Heating output: 15W
Input: 12V/1.5A-2A; 9V/1.67A; 5V/2A
Transmission distance: < 8 mm
Charging efficiency: > 76 %

Operating Procedures:
1. Connect to power by using standard adapter and USB cable.
2. Red LED flashing indicates standby status.
3. Put your mobile phone on the wireless charger, Blue LED flashing indicates device working in good condition, Red LED flashing indicates connected wrongly, please try connect again from the beginning.
4. Constant temperature: the standard thermostatic cup should be placed in the center of the wireless charger pad, Blue LED flashing indicates working well, Red LED flashing indicates cup is placed incorrectly.
5. Constant temperature: about 131 °F (55 °C) (It can also warm cold water to about 131 °F (55 °C) in approximate 40 minutes, and then remain at 131 °F (55 °C)

WIRELESS CHARGER INSTRUCTIONS

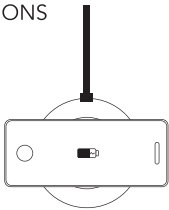
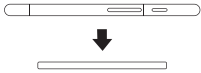

Operation Warning:
1. The device is not workable with ordinary daily cup products.
2. Do you put the standard cup above the your phones when using wireless induction heating, the heating mug and your phones should be used separately.

LED indicator:
ON: The light flashes three times
Standby: Lights off
Charging: Blue light up
Heating: Blue light up
Protection: Lights off
Error message: Red light flashing

Safety Warning:
1. Do not disassemble or modify this product yourself.
2. Please keep the surface of the base clean,if there is water, please wipe it with a dry towel or paper towel.
3.If you need to clean the charger,please make sure that no power is plugged in.
4.The ambient temperature should be maintained at 0-45 °C .
5.It is forbidden to place metal materials such as coins an keys or magnetic materials such as bank cards in the charger,it will affect normal operation.



FCC statement:

This device complies with Part 15 of the FCC rules. Operation is subject to the following two conditions: 1) this device may not cause harmful interference, and 2) this device must accept any interference received, including interference that may cause undesired operation.

Note: This equipment has been tested and found to comply with the limits for a Class B digital device, pursuant to part 15 of the FCC Rules. These limits are designed to provide reasonable protection against harmful interference in a residential installation.

This equipment generates uses and can radiate radio frequency energy and, if not installed and used in accordance with the instructions, may cause harmful interference to radio communications. However, there is no guarantee that interference will not occur in particular installation. If this equipment does cause harmful interference to radio or television reception, which can be determined by turning the equipment off and on, the user is encouraged to try to correct the interference by one or more of the following measures:

–Reorient or relocate the receiving antenna.

–Increase the separation between the equipment and receiver.

–Connect the equipment into an outlet on a circuit different from that to which the receiver is connected.

–Consult the dealer or an experienced radio/TV technician for help.

Changes or modifications not expressly approved by the party responsible for compliance could void the user's authority to operate the equipment.

Radiation Exposure Statement

This device complies with FCC RF radiation exposure limits set forth for an uncontrolled environment. This transmitter must not be co-located or operating in conjunction with any other antenna or transmitter. During the operation of device a distance of 15 cm surrounding the device and 20 cm above the top surface of the device must be respected.