



Package

尺寸/Size	65x90mm
材质 Paper type	封面105g哑粉/内文80g哑粉 Cover 105g Matt art paper/Text 80g Matt art paper
工艺 Print and Finish	单色印刷/骑马订 1color print/Saddle stitching

RMP2105/国际版 65x90mm, 双面印刷, 105g哑粉(封面封底)+80g亚粉(内页), 钉装, K=90%

封底	封面	封底内页留白	封面内页留白
			

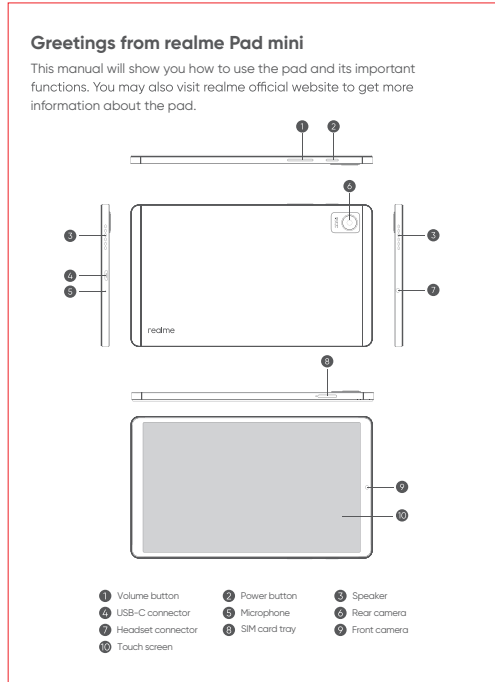

**Warning**

- Do not place the tablet or battery near or inside heating equipment, cooking equipment, high pressure vessels such as rice cookers, ovens, induction cookers, electric ovens, heaters, pressure cookers, water heaters, gas stoves, etc. To prevent the battery overheating which may lead to an explosion.
- The original charger, data cable and battery shall be used. Unapproved charger, data cables, or batteries that are not certified by the manufacturer may result in electric shock, fire, explosion, or other hazards.
- When charging, please place the device in an environment that has a normal room temperature and good ventilation. It is recommended to charge the device in an environment with temperature ranging from 0°C~35°C.
- The device only supports standard Nano SIM card(4FF), using non-standard SIM card may cause damage to your phone.
- The battery can not be removed from the device, if you need to replace, please contact realmé Authorized Service Center.

**Standard accessories**

You are provided with the following standard accessories:  
Pad x 1, Charger x 1, Data Cable x 1, User Manual x 1, SIM Pin x 1.

Specification		
Product	RMP2105	
Main screen parameter	22.05cm (8.71")	
Dimension	218 x 134.5 x 7.6 mm	
Battery	440mAh (24.22Wh/typ) 640mAh (24.36Wh/typ)	
Camera	Rear: ①Megapixel Front: ①Megapixel	
Operating temperature	0°C~35°C	
SAR values	FCC SAR: XXXX(W/kg Body)	
Radio Waves Specifications		
Radio	Frequency	Max. Output Power
GSM	900MHz/1200MHz	33.5dBm
	1800MHz/1900MHz	33.5dBm
WCDMA	Bands 1/2/4/5/8	24dBm
	Bands 1/2/3/4/5/8/19/26/36	24dBm
LTE FDD	Bands 1/2/3/5/7/20/28	24.5dBm
	Band 7	23.5dBm
LTE TDD	Bands 36/38/40/42	24dBm
Bluetooth	2.4 ~ 2.4835GHz	1.36dBm(BR/EDR)
2402 Wi-Fi	2.4 ~ 2.4835GHz	19.36dBm(BR/EDR)
S4G Wi-Fi	5.15 ~ 5.85GHz	17.79dBm(BR/EDR)
	5.45 ~ 5.725GHz	19.36dBm(BR/EDR)
S4G Wi-Fi	5.725 ~ 5.85GHz	18.81dBm(BR/EDR)

This user manual provides the product safety information. Before using the tablet, please read the Safety Guide carefully.

**Statement**

The User Manual contains information regarding safety, operation and customer service. Before using the realmé tablet, please read all the instructions and the security information below, and keep it for backup. More detailed instructions are kept in this product as an electronic file. Please read the built-in instructions on the realmé Tablet. For the latest information, please visit <https://www.realmé.com>.

**Security information**

This tablet is suitable for working in an environment of 0°C to 35°C. Temperature for storage should be between -20°C and 40°C. Excessively high or low temperatures can affect the use of tablet and even damage the tablet and battery. When using the tablet, please avoid places near telephone, television, radio, and office automation machines. Please charge the tablet in an environment between 0°C and 35°C, so as to not reduce battery performance and standby time. If the tablet has a flash charging function, it may not be able to enter the flash charging mode when the temperature is below 0°C or over 35°C.

The operating system of this product supports official system updates. If the user received the ROM system of any third party or modified the system files by cracking, it may lead to security risks of the system, realmé will not provide any support nor take any responsibility for the final use in these cases.

**Battery precautions in use**

- Please do not weld battery terminals. Otherwise, it may cause battery leakage, overheat, explosion and fire.
- Please do not press or pierce the battery with hard objects (for example needle or other sharp objects), to avoid damage, battery leak, overheating or fire.

3. Battery liquid may be harmful if contacted with skin or clothes, your skin might be hurt. Please immediately wash it with water, or go to hospital at once to seek medical help if necessary.

4. If there are any abnormalities like high temperature, discoloration, distortion, bulging, leakage, etc. during operation, charging or preservation, please cease to use the device.

5. Do not expose the battery liquid to eyes. It might cause potential blindness. When happens, wash your eyes immediately or go to the hospital if serious.

6. Do not disassemble or modify the battery, as it may cause battery leakage, overheating, explosion or fire.

7. Do not place or use the battery near fire, heater or other high temperature places. Otherwise, it may cause battery leakage, overheat, explosion or fire.

8. If there is battery leakage or storage smell, please immediately move it from open flame in order to avoid fire or explosion.

9. Please keep the battery away from moist or wet areas from moisture. Otherwise, it may cause battery overheat, swelling and corrosion.

10. Do not place the battery directly in sunlight, or other high temperature areas. Otherwise, battery leakage and overheating may make battery performance descend and service life affected. Keep the battery in a well-ventilated area.

11. Do not use the battery or connect it with a high-voltage power supply, otherwise it may cause a short circuit or burst.

12. The battery can be charged and discharged hundreds of times at least, but it will eventually wear out.

13. Do not dispose the battery as household waste. Dispose the battery according to local regulations.

Caution: Risk of explosion if battery is replaced by an incorrect type. Dispose of used batteries according to the user manual.

**Warning:** Please do not charge the battery over 12 hours.

**Other matters of attention**

1. Adapter shall be installed near the equipment and shall be easily accessible.

2. If any part of the product is cracked or damaged, discontinue use immediately and contact the realmé Service Center.

3. To prevent possible hearing damage, do not listen at high volume levels for long periods.

**Waste Electrical and Electronic Equipment (WEEE)**

This symbol means that according to local laws and regulations your product and/or its battery shall be disposed of separately from household waste. When this product reaches its end of life, you have the choice to give this product to a competent recycling organization. Proper recycling of your product will protect human health and the environment.

→ realmé will seek shared responsibility and cooperation from customers in reducing the environmental impact of their products.

→ realmé will comply with all the applicable laws related to WEEE management.

**EU Declaration of Conformity (DoC)**

Hereby, Realme Charging Mobile Telecommunications Corp., Ltd. declares that this wireless device is in compliance with the essential requirements and other relevant provisions of Directive 2014/53/EU. The full text of the EU declaration of conformity is available at the following internet address:  
<https://www.realmé.com/global/support/eu-declaration>.

**CE certification information (SAR)**

This device was tested for typical body-worn operations with the back of the tablet kept 5.0cm away. To maintain compliance with RF exposure requirements, use accessories that maintain a 5.0cm separation distance between the user's body and the back of the tablet. The use of belt clips, holsters and similar accessories should not contain metallic components in its assembly. The use of accessories that do not satisfy these requirements may not comply with RF exposure requirements, and should be avoided.

If you are using pacemakers, hearing aids, cochlear implant or other device, please use the tablet according to the doctor's advice.

**CE**

Notice:  
Observe national and local regulations where the device is used. This device may be restricted for use, depending on the local network. The operating frequency is 900-5100MHz of W-RF is are restricted to indoor usage only.

**UK**

Please check Radio Waves Specifications in the user manual to see whether this product supports Wi-Fi 5G or not.

**FCC Regulations:**

This tablet complies with part 15 of the FCC Rules.

Operation is subject to the following two conditions:  
(1) This device may not cause harmful interference.  
(2) If this device must accept any interference received, including interference that may cause undesired operation.

This tablet has been tested and found to comply with the limits for a Class B digital device, pursuant to Part 15 of the FCC Rules. These limits are designed to provide reasonable protection against harmful interference to residential installation. This equipment generates, uses and can radiate radio frequency energy and, if not installed and used in accordance with the instructions, may cause harmful interference to radio communications.

However, there is no guarantee that interference will not occur in a particular installation. If this equipment does cause harmful interference to radio or television reception, which can be determined by turning the equipment off and on, the user is encouraged to try to correct the interference by one or more of the following measures:

- Reorient or relocate the receiving antenna.
- Increase the separation between the equipment and receiver.
- Connect the equipment into an outlet on a circuit different from that to which the receiver is connected.
- Consult the dealer or an experienced radio/TV technician for help.

**FCC Note:**

Caution: Changes or modifications not expressly approved by the party responsible for compliance could void the user's authority to operate the equipment.

**RF Exposure Information (SAR)**

This tablet is designed and manufactured not to exceed the emission limits for exposure to radio frequency (RF) energy set by the Federal Communications Commission of the United States.

During SAR testing, this device was set to transmit at its highest certified power level in all tested frequency bands, and placed in positions that simulate RF exposure in near the body with the separation of 1mm. Although the SAR is determined at the highest certified power level, the actual SAR level of the device while operating can be well below the maximum value. This is because the Tablet is designed to operate at multiple power levels so as to use only the power required to reach the network. In general, the closer you are to a wireless base station antenna, the lower the power output.

The exposure standard for wireless devices employing a unit of measurement known as the Specific Absorption Rate, or SAR. The SAR limit set by the FCC is 1.6W/kg.

This device is compliant with SAR for general population / uncontrolled exposure limits in ANSI/IEEE C95.1-1992 and has been tested in accordance with the measurement methods and procedures specified in IEEE1528.

The FCC has granted an Equipment Authorization for this tablet with all reported SAR levels evaluated as in compliance with the FCC RF exposure guidelines. SAR information on this tablet is on file with the FCC and can be found under the Display Grant section of [www.fcc.gov/oet/ea/fccid](http://www.fcc.gov/oet/ea/fccid) after searching on FCC ID: 2AU1FRMXXXX.

For this device, the highest reported SAR value for usage near the body is 0.1 W/kg.

While there may be differences between the SAR levels of various tablets and at various positions, they all meet the government requirements. SAR compliance for body-worn operation is based on a separation distance of 1X mm between the unit and the human body. Carry this device at least 1X mm away from your body to ensure RF exposure level compliant or lower to the reported level. To support body-worn operation, choose the belt clip or holster, which do not contain metallic components, to maintain a separation of 1X mm between this device and your body.

RF exposure compliance with any body-worn accessory, which contains metallic, with not tested and certified, and use such body-worn accessory should be avoided.

**Regulatory**

Steps to Search E-Label: Go to Settings -> About tablet -> Regulatory.

are designed to provide reasonable protection against harmful interference to residential installation. This equipment generates, uses and can radiate radio frequency energy and, if not installed and used in accordance with the instructions, may cause harmful interference to radio communications.

However, there is no guarantee that interference will not occur in a particular installation. If this equipment does cause harmful interference to radio or television reception, which can be determined by turning the equipment off and on, the user is encouraged to try to correct the interference by one or more of the following measures:

- Reorient or relocate the receiving antenna.
- Increase the separation between the equipment and receiver.
- Connect the equipment into an outlet on a circuit different from that to which the receiver is connected.
- Consult the dealer or an experienced radio/TV technician for help.

**FCC Note:**

Caution: Changes or modifications not expressly approved by the party responsible for compliance could void the user's authority to operate the equipment.

**RF Exposure Information (SAR)**

This tablet is designed and manufactured not to exceed the emission limits for exposure to radio frequency (RF) energy set by the Federal Communications Commission of the United States.

During SAR testing, this device was set to transmit at its highest certified power level in all tested frequency bands, and placed in positions that simulate RF exposure in near the body with the separation of 1mm. Although the SAR is determined at the highest certified power level, the actual SAR level of the device while operating can be well below the maximum value. This is because the Tablet is designed to operate at multiple power levels so as to use only the power required to reach the network. In general, the closer you are to a wireless base station antenna, the lower the power output.

The exposure standard for wireless devices employing a unit of measurement known as the Specific Absorption Rate, or SAR. The SAR limit set by the FCC is 1.6W/kg.

This device is compliant with SAR for general population / uncontrolled exposure limits in ANSI/IEEE C95.1-1992 and has been tested in accordance with the measurement methods and procedures specified in IEEE1528.

The FCC has granted an Equipment Authorization for this tablet with all reported SAR levels evaluated as in compliance with the FCC RF exposure guidelines. SAR information on this tablet is on file with the FCC and can be found under the Display Grant section of [www.fcc.gov/oet/ea/fccid](http://www.fcc.gov/oet/ea/fccid) after searching on FCC ID: 2AU1FRMXXXX.

For this device, the highest reported SAR value for usage near the body is 0.1 W/kg.

While there may be differences between the SAR levels of various tablets and at various positions, they all meet the government requirements. SAR compliance for body-worn operation is based on a separation distance of 1X mm between the unit and the human body. Carry this device at least 1X mm away from your body to ensure RF exposure level compliant or lower to the reported level. To support body-worn operation, choose the belt clip or holster, which do not contain metallic components, to maintain a separation of 1X mm between this device and your body.

RF exposure compliance with any body-worn accessory, which contains metallic, with not tested and certified, and use such body-worn accessory should be avoided.

**Regulatory**

Steps to Search E-Label: Go to Settings -> About tablet -> Regulatory.

reach the network. In general, the closer you are to a wireless base station antenna, the lower the power output.

The exposure standard for wireless devices employing a unit of measurement known as the Specific Absorption Rate, or SAR. The SAR limit set by the FCC is 1.6W/kg.

This device is compliant with SAR for general population / uncontrolled exposure limits in ANSI/IEEE C95.1-1992 and has been tested in accordance with the measurement methods and procedures specified in IEEE1528.

The FCC has granted an Equipment Authorization for this tablet with all reported SAR levels evaluated as in compliance with the FCC RF exposure guidelines. SAR information on this tablet is on file with the FCC and can be found under the Display Grant section of [www.fcc.gov/oet/ea/fccid](http://www.fcc.gov/oet/ea/fccid) after searching on FCC ID: 2AU1FRMXXXX.

For this device, the highest reported SAR value for usage near the body is 0.1 W/kg.

While there may be differences between the SAR levels of various tablets and at various positions, they all meet the government requirements. SAR compliance for body-worn operation is based on a separation distance of 1X mm between the unit and the human body. Carry this device at least 1X mm away from your body to ensure RF exposure level compliant or lower to the reported level. To support body-worn operation, choose the belt clip or holster, which do not contain metallic components, to maintain a separation of 1X mm between this device and your body.

RF exposure compliance with any body-worn accessory, which contains metallic, with not tested and certified, and use such body-worn accessory should be avoided.

**Regulatory**

Steps to Search E-Label: Go to Settings -> About tablet -> Regulatory.

**Product Warranty Information**

**1. Service Terms**

Thank you for using realmé tablet. We will provide our product with comprehensive warranty services in accordance with applicable national laws and regulations. In case of any conflict between the following policies and the National Policies or Commissions, the national policies shall prevail.

1. Within 12 months from the purchasing date, in the event that performance failure occurs from normal use, consumer can claim for maintenance. The accessories such as charger, data cable have a 6-month warranty. The battery (including internal battery) has a 12-month warranty.

2. Please ask the dealer to issue an invoice and keep it in a safe to avoid warranty claims.

3. Valid purchase invoice: the invoice shall indicate the serial number of the tablet, factory serial number (both number of the accessories (batteries and charger), product model, color, date, Seller's seal, amount and so on.

4. A valid invoice is essential for protecting your warranty rights. (Valid invoice: the information filled in shall be complete, true and correct without alteration). If you lose the valid invoice and are unable to provide us with a photocopy of them, we will provide your tablet with a 12-month warranty.

5. Our warranty does not cover the other accessories for the product (for instance: the user manual, warranty card, etc.).

Note: The above warranty is only valid for the products sold in this country. realmé have the right of final review and interpretation for the warranty policy.

**II: Warranty Instructions and Conditions**

1. Your warranty please refer to the Warranty Information Card is only valid under normal use of your device. All non-mode damages and any of the following conditions are out of the free warranty, but a repair can be still implemented at your own cost.

A. The warranty period has expired;

B. Damage caused by human factors, including damages caused by usage under improper operating environment and the failure to the user manual;

C. The customer disassembles, repairs or modifies the device without the Company's authorization or has a repaired at a repair shop that is not included in the Company's approved repair network;

D. Damage caused by a force majeure (such as floods, fire, earthquakes and lightning);

E. The user is unable to provide valid proof of purchase or the product model and barcode do not match or are altered;

F. Natural wear and tear of the product (such as casing, keypad, display screen, antenna and other accessories);

G. Faults, damages or defects not caused by the company;

H. Barcode and warranty labels are damaged and unrecognizable.

2. Others

A. External damages (including wear, tear, and scratched) are not entitled to the warranty service;

B. Faults caused by the Internet and wireless information service providers (operation) are not covered by the warranty;

C. Our warranty does not cover services verbally provided by the dealer which violate principles set forth in the warranty card. For products that meet the replacement requirements, you can visit to our nearest Authorized Service Center for replacement. Upon replacement, if the device is faulty, we can replace it with a device of the same specification and model if any accessory is faulty, the faulty accessory will be replaced. Both replacements are free of charge.

3. If any of our products is required to be fixed, you may take it to any realmé Authorized Service Center.

4. If the product requires repair since water enters the device or it is seriously damaged by human factors, the customer needs to sign the repair job sheet form with the realmé Authorized Service Center firstly.

5. All components, parts and accessories replaced during the warranty period shall become the property of the Company.

**III: Considerations for Sending the Device for Repair and Collecting it**

1. When completing the realmé tablet Repair Form, the customer must fill in the product information in detail (including serial number, address, phone number and fault symptoms);

2. Before sending your device for repair, please back up all information and data you have saved on the tablet (such as phone numbers, text messages and pictures) before you delete them to prevent loss or damage during the testing and inspection process. In any circumstances, realmé Authorized Service Center and its staff will not be responsible or obligated to back up or recover your information and data, or accept responsibility for any consequence arising from the loss, damage or deletion of your information and data. Please ensure the legality of the information and data you have saved. To respect your privacy, we will not transmit, backup or examine your information and disassemble they are necessary for us to provide you with service, and we reserve the right to refuse to provide services for illegal content;

3. The Customer shall collect the tablet by presenting the realmé tablet Repair Form. In case the Customer loses the Customer Copy, the Customer should go through the loss reporting procedure with his/her personal ID to valid proof of identity before collecting the tablet.

WARRANTY CARD (Stub Copy)			
Respectable customer, This warranty card is your proof of applying for warranty in the future. Please cooperate with the seller to fill in and keep it properly for future use!			
User Information	Name		
	Address		
	Mobile No.		
Product Information	E-Mail		
	Product Name		
	Product Model		
Vendor Information	Product SN		
	Repair Company Name		
	Address		
Remark	Mobile No.		
	Invoice number		

WARRANTY CARD (Customer Copy)			
Respectable customer, This warranty card is your proof of applying for warranty in the future. Please cooperate with the seller to fill in and keep it properly for future use!			
User Information	Name		
	Address		
	Mobile No.		
Product Information	E-Mail		
	Product Name		
	Product Model		
Vendor Information	Product SN		
	Repair Company Name		
	Address		
Remark	Mobile No.		
	Invoice number		

技术要求/Notes:

公差/Tolerance: ± 1.0mm

套印/Overprinting variance: ± 0.1mm

颜色色差/Ink Density: 3或依照限度样品/ 3 or follow limit board

A. 所有材料必须符合RoHS、HF无卤和REACH的要求

All materials need to meet the requirements of RoHS、Halogen-Free and REACH

B. 符合Accord With :

包装指令Packaging instructions CP65 其他Other\_\_\_\_\_ [勾选Check ]

供应商代码：  
自行添加供应商代码后四位位于  
包材隐密处，以便识别。

标识内容：  
需要标注包装材料、  
材料加工工艺、设计尺寸。

TINNO  
天玑移动

项目名称\国家:

RM

版本: V1.0

页码: P01

图纸尺寸: A3

比例: 1 : 1

绘图: 张艳群

检查: 黎孔刚

审批: 董小林

日期: 2022.03.04

日期: 2022.03.04

日期: 2022.03.04

THIS DOCUMENT CONTAINS PROPR-  
-IERY INFORMATION AND SHALL  
NOT BE DUPLICATED OR DISCLOSED TO  
OTHERS WITHOUT THE PRIOR WROTTEN  
PEMISSION OF NEWIDEA.

特别说明: \*本文属于天玑机密文件, 未经允许禁止外泄! \*