

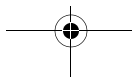

English.....	I
简体中文.....	12
繁體中文.....	23
Türkçe.....	34

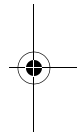

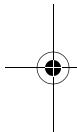
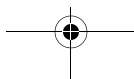
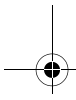
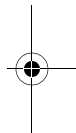
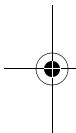

Bluetooth stereo headset

NTE4002



Audio Adapter



Getting Started

1 Insert batteries in your headphones

1. Lift the battery cap on the left headphone and insert the batteries as shown in Figure 1.

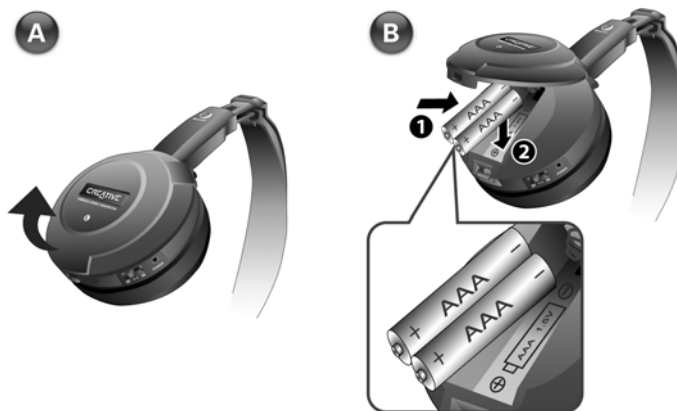

Figure 1



Your Creative Digital Wireless Headphones are supplied with three AAA batteries (two for headphones and one for audio adapter).

2 Insert a battery in your audio adapter

1. Slide the audio adapter cover back and insert the battery as shown in Figure 2.

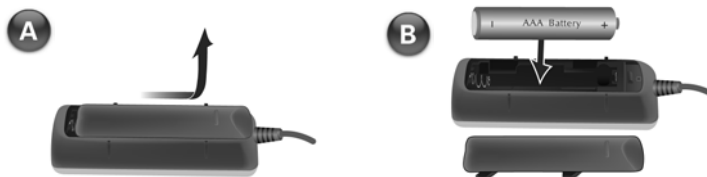

Figure 2

3 Change the headphone ring (optional)

To remove the ring, push the ring tab down and lift it away from the headphone, as shown in Figure 3.



Figure 3



4 Pair your headphones and audio adapter

1. Connect your audio adapter's 3.5 mm minijack to the headphone jack of your audio output device, as shown in Figure 4.

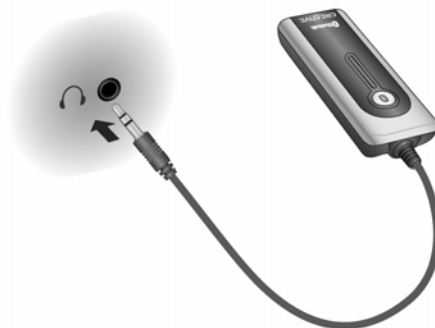

Figure 4

2. On your audio adapter, press and hold the ON/OFF button until the POWER/Bluetooth LED lights up in blue.



3. Switch on your headphones. The POWER LED lights up in red. The Bluetooth LED lights up in blue.
When the Bluetooth LEDs on your audio adapter and headphones blink, the devices are paired and connected.



- You can pair the headphones and audio adapter before or after connecting the audio adapter's minijack to the headphone jack.
- Make sure that your headphones are within the working distance of the audio adapter. When the headphones are out of working range, the Bluetooth LED on both the headphones and the audio adapter remains lit in blue.
- To reconnect the headphones and the audio adapter, bring the two devices closer.
- When battery levels are too low, during the last 10 minutes before your headphones turn off,
 - the POWER LED blinks red.
 - your headphones beep every 30 seconds.
- Pairing your headphones with a new device can take up to 15 seconds. Subsequent pairing with the same device will take significantly less time.

Using Your Headphones

1 Adjust the headphone volume

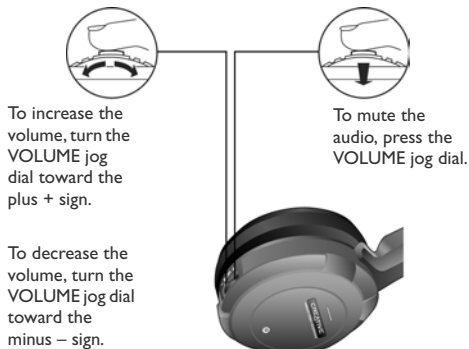

Figure 5

2 Turn off your headphones and adapter

1. Switch off your headphones.
2. On your audio adapter, press and hold the ON/OFF button until the POWER/Bluetooth LED blinks.



- If the audio adapter is not connected to your headphones for more than two minutes, the audio adapter automatically turns off.

General Specifications

Bluetooth version

1.2

Bluetooth 2.4 GHz Class 2 Radio, up to a radius of 10 meters
(Varies depending on environment)

Supported Bluetooth profile

Advanced Audio Distribution Profile (A2DP)

Audio adapter weight

20 g (including battery)

Headphone weight

203 g (including batteries)

Battery type

AAA Alkaline or rechargeable

Play time*

Up to 7 hours

*may vary depending on operation mode and battery specifications.



Frequently Asked Questions

I can't pair my headphones and audio adapter.

Try the following:

- Make sure that the batteries are fresh and are inserted correctly.
- Switch off both audio adapter and headphones.
- Make sure that there are no other Bluetooth devices within 10 meters, while you are pairing them.
- Turn on both the audio adapter and the headphones when they are within one meter of each other.

Can I use the headphones with my Personal Digital Assistant (PDA) or mobile phone?

Yes, you can use the headphones with your PDA or mobile phone, as long as it supports A2DP. For more information on Bluetooth profiles, refer to the User's Guide for your PDA or mobile phone.

How far away from my audio adapter can I be when using my Creative Bluetooth Stereo Headphones?

When using your headphones with the audio adapter, make sure that you are within 10 meters (32.8 feet) of your audio adapter. Your headphones work best when there are no obstructions, such as walls or other electronic devices, between your headphones and the audio adapter. If you use your headphones too far away from the audio adapter, you may hear some crackling sounds.

What causes interference when using the headphones?

Devices that operate within the 2.4 GHz frequency spectrum (for example, cordless phones and some wireless networking devices) may cause interference or crackling sounds while you are using your headphones.



Will my headphones interfere with my computer or car's electronic devices?

You should not experience interference when using your headphones near such devices. For more information on international Bluetooth standards, go to **www.bluetooth.com**.

Can I wear or use my headphones in the rain or when taking a shower?

Your headphones are NOT waterproof. Exposing your headphones to water may cause permanent damage.

Keep this document for future reference.

Please note that your warranty rights are not dependent on product registration.

Copyright © 2005 Creative Technology Ltd. All rights reserved. Information in this document is subject to change without notice and does not represent a commitment on the part of Creative Technology Ltd. No part of this document may be reproduced or transmitted in any form or by any means, electronic or mechanical, including photocopying and recording, for any purpose without the written permission of Creative Technology Ltd. Copyright © 2005 Creative Technology Ltd. Bluetooth is a registered trademark of the Bluetooth SIG, Inc., USA. All other products are trademarks or registered trademarks of their respective owners and are hereby recognised as such. All specifications are subject to change without prior notice. Actual contents may differ slightly from those pictured.

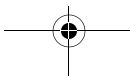

Safety Information

General Safety



- Do not listen to audio at high volume levels for prolonged periods of time.

Servicing

Do not attempt to service the product on your own. Refer all servicing to your local Customer Support Services center.

For removable batteries

- The battery must be recycled or disposed of properly. Contact local agencies for recycling and disposal information.
- Do not allow metal objects to touch the terminals of your battery.
- If there is leakage, an offensive odor, discoloration or deformation during charging or use, remove the battery and do not use it again. Clean your hands well before touching food or sensitive areas, for example, your eyes.



Improper handling of your headphones and audio adapter may void the warranty. For more information on Creative Customer Support Services and Warranty go to www.europe.creative.com/support

Creative 数字无线耳机 CB2530



音频适配器



使用入门

1 将电池放入耳机

1. 打开左耳机的电池盖，如图 1 所示放入电池。



图 1



您的 Creative 数字无线耳机由 3 节 AAA 电池供电（2 节用于耳机，1 节用于音频适配器）。

2 将 1 节电池放入音频适配器

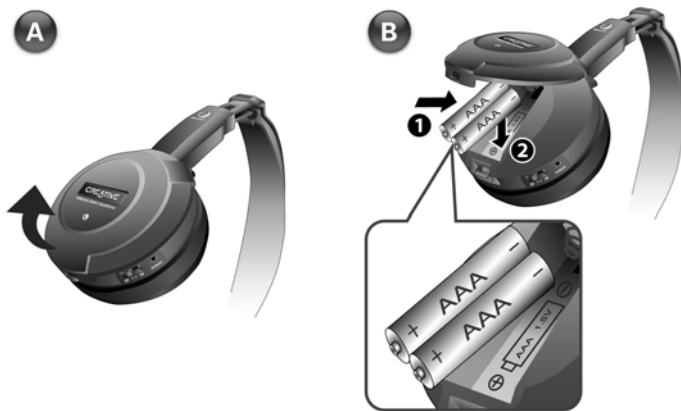
1. 滑动音频适配器的后盖，如图 2 所示放入电池。



图 2

3 更换耳机圈（可选）

要取下耳机圈，按下簧片，将其从耳机上取下，如图 3 所示。

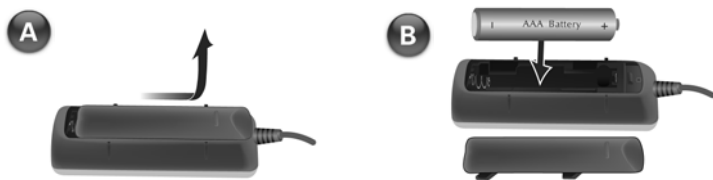

图 3

4 匹配耳机和音频适配器

1. 将音频适配器的 3.5 mm 微型插头连接至音频输出设备的耳机插孔，如图 4 所示。



图 4

2. 按住音频适配器上的开 / 关按钮，直到电源 / 蓝牙 LED 呈蓝色点亮。

3. 打开耳机。电源 LED 呈红色点亮。蓝牙 LED 呈蓝色点亮。
当音频适配器和耳机上的蓝牙 LED 闪烁时，则设备匹配并连接好。

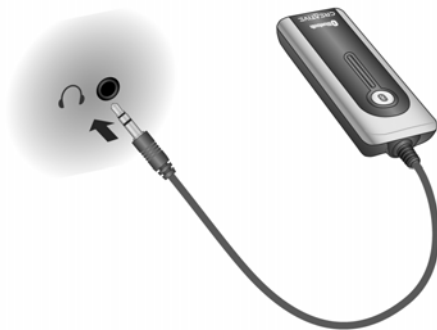

- 您可以在将音频适配器的微型插头连接至耳机插孔之前或之后匹配麦克风和音频适配器。
- 请确保耳机处于音频适配器的有效范围内。当耳机在有效范围外时，耳机和音频适配器上的蓝牙 LED 呈蓝色持续状态。
- 要重新连接耳机和音频适配器，使这两个设备靠近一些。
- 当电池电量不足时，在耳机关闭前的 10 分钟里，
 - 电源 LED 呈红色闪烁。
 - 耳机每隔 30 秒发出鸣叫。
- 将耳机与新的设备匹配可能需要 15 秒。与同一设备的多次匹配所用时间将大为减少。

使用耳机

1 调整耳机音量



图 b

2 关闭耳机和适配器

1. 关闭耳机。
2. 按住音频适配器上的开 / 关按钮，直到电源 / 蓝牙 LED 闪烁。
 - 如果音频适配器持续 2 分钟没有与耳机连接，音频适配器将自动关闭。

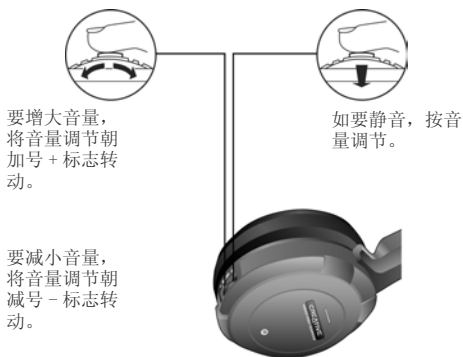

一般规格说明

蓝牙版本

1.2

Bluetooth 2.4 GHz Class 2 Radio, 支持长达 10 米半径内的传输
(根据环境不同有所差异)

支持的协议

蓝牙音频传输协议 - A2DP (Advanced Audio Distribution Profile)

音频适配器重量

20 克 (含电池)

耳机重量

203 克 (含电池)

电池类型

AAA 碱性电池或可充电电池

播放时间 *

长达 7 小时

* 根据实际使用情况不同有所差异。

常见问题

我无法将耳机与音频适配器匹配。

尝试以下解决方案：

- 请确保电池可用并正确放入设备。
- 关闭音频适配器和耳机。
- 请确保在匹配时周围 10 米之内没有其它蓝牙设备。
- 在音频适配器和耳机距离在一米之内时打开这两个设备。

我能将耳机配合我的掌上电脑（PDA）或手机使用吗？

可以，您能够将耳机与支持 A2DP 的 PDA 或手机配合使用。有关蓝牙配置文件的详细信息，请参见 PAD 或手机的用户指南。

使用 Creative Bluetooth Stereo 耳机时距离音频适配器的最大距离能够有多远？

将耳机与音频适配器配合使用时，请确保同音频适配器之间的距离不超过 10 米（32.8 英尺）。如果耳机和音频适配器之间没有障碍物（如墙壁或其它电子设备），效果最好。如果您的耳机和音频适配器之间的距离过大，您可能会听到爆裂声。

使用耳机时会有哪些产生干扰的因素？

工作于 2.4 GHz 频段（如无绳电话和某些无线网络设备）的设备可能使您在使用耳机时产生干扰或爆裂声。

耳机会与电脑或车载电子设备互相干扰吗？

与这些设备距离较近时使用耳机不应产生干扰。关于国际蓝牙标准的详情，可访问 www.bluetooth.com。

在下雨时或淋浴时能佩戴或使用该耳机吗？

您的耳机不具备防水功能。耳机浸水，会造成永久性损坏。

请保留此文档，以备今后参考。

请注意，产品保修并不取决于产品是否注册。

版权 © 2005 Creative Technology Ltd. 版权所有。本文件中的信息如有变化，恕不另行通知；本文件中的信息不代表 Creative Technology Ltd. 的承诺。未经 Creative Technology Ltd. 的事先书面许可，任何机构或个人不得以任何形式或方式随意复制或传播此手册内容，包括电子文本或机器复印，影印件和录音。版权 © 2005 Creative Technology Ltd. 蓝牙是 Bluetooth SIG, Inc., USA 的注册商标。本文中提及的所有其它产品均为其各自所有者的商标或注册商标，在此予以认同。所有技术规格如有变动，恕不另行通知。实际内容可能与图示略有不同。

安全信息

一般安全说明



- 不要长时间地收听过高音量的音频。

维修

不要尝试自行维修产品。将所有维修服务交与您当地的客户支持服务中心。

关于可拆卸电池

- 电池務必回收或妥善处理。电池回收或处理事宜请联系您本地的代理。
- 不要让金属物体接触电池的两极。
- 如果电池在充电或使用过程中出现泄漏，异味，褪色，变形等现象，将电池取出，不再使用。使用之后要将双手洗净再接触食物或敏感部位，例如眼睛。



错误地使用耳机和音频适配器可能使保修服务失效。

有关 Creative 客户支持服务和保修的详细信息请访问 www.aisa.creative.com/support

Creative 數位無線耳機 CB2530

