

Oittm

Smart  
Cool Mist  
Humidifier  
Intelligent Home  
Solutions



WORKS WITH  
amazon alexa

1. This appliance can be used by children aged from 8 years and above and persons with reduced physical, sensory or mental capabilities or lack of experience and knowledge if they have been given supervision or instruction concerning use of the appliance in a safe way and understand the hazards involved.
- 2.Children shall not play with the appliance.
- 3.Cleaning and user maintenance shall not be made by children without supervision.
- 4.If the supply cord is damaged, it must be replaced by the manufacturer, its service agent or similarly qualified persons in order to avoid a hazard.
- 5.Unplug the appliance during filling and cleaning

## Parameters

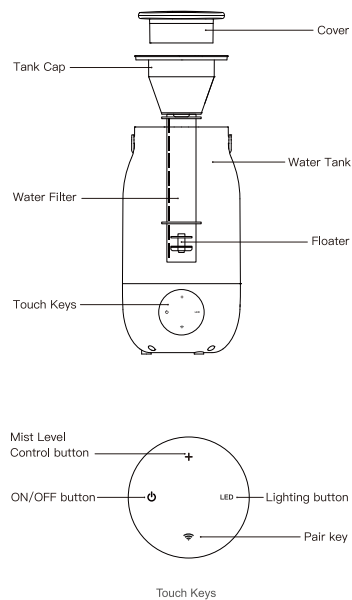

## Usage Specifications:

### LED Indicator

- Three output levels—The LED's will illuminate to reflect which level you have selected
  - 1) HIGH—Blue LED light: For fast humidifying
  - 2) MED—Green LED light: For everyday moisture control
  - 3) LOW—Red LED light: For minimum operation (ideal for night-time use)

- Plug into a standard electrical outlet. The Blue LED Display will turn on for 2 seconds then turn OFF. The Humidifier is in standby mode.

- Press the ON/OFF button once, the humidifier will start on high level.

### Water Shortage Protection

- When the Tank is out of water, the red indicator will flash for 1 minute then the automatic safety shut-off will turn the unit OFF.
- The App will send a message when the water inside reaches low limit. (Need to be connected with home Wi-Fi )

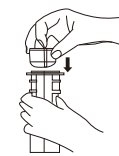

Fig. 1



Fig. 2



Fig. 3

## Set-up

- Make sure the humidifier is unplugged and in the OFF position.
- Put the Floater into the Water Filter like the Fig. 1 (Please make sure the side with label upward)
- Attach Tank Cap to the Water Filter by firmly turning clockwise until tight. (Fig. 3)

### Filling The Water Tank

- Fill the Water Tank above with clean, cool tap water (Do not exceed the MAX water level, or it will have impact on the mist output)
- Cover the water tank lid.
- Plug the AC Adapter into Power Outlet and start it.

### Cleaning

- Turn off and unplug the humidifier (Fig. a).
- Remove the water tank cover (Fig. b).
- Cleaning the inside of water tank (Fig. c).

**CAUTION:** When emptying the water reservoir on the base, make sure that the water is poured away from the Air Passage. If water is poured into the PCB it may damage the humidifier.



Fig. a



Fig. b



Fig. c

## WARNING

- The humidifier is intended for indoor use only. Do not operate the humidifier outdoors.
- Always ensure that there is water in the water tank before operating the humidifier. Use only clean, cool water to fill the water tank.
- Place the humidifier on a smooth, level, waterproof surface that is elevated off the ground.
- Always handle the humidifier with dry hands to avoid electric shock.
- Keep out of reach of children. Close supervision is necessary when this appliance is used by or near children, elderly or disabled persons.
- Do not operate the humidifier with a damaged cord or plug. DO NOT use any attachments not provided with the unit.
- DO NOT attempt to repair or adjust the unit. Servicing must be performed by professional or qualified personnel.
- ALWAYS unplug and empty the water tank when not in use for a long period of time. ALWAYS unplug before removing, filling or emptying the water tank.
- Do not cover the mist outlet on the humidifier or insert objects into the mist outlet.
- Do not leave the humidifier in a closed room as the air could become saturated and leave condensation on walls or furniture.

## Problem solution

If the machine does not work appropriately, please check as following:

Power indicator not illuminated and with no wind and mist	Check plug	Plug into socket
	Check power switch	Turn on power switch
	Didn't place the floater	Place the floater
Power indicator illuminate, the unit with wind but no mist	Not tighten the lid	Tighten the lid securely
	Put the floater in wrong position	Replace the floater according to the instruction
	Water filter not properly attached	Adjust the position of Water filter according to the instruction
Peculiar smelling steam	Ultrasonic Nebulizer not operating	Contact the store where the product was purchased from.
	New machine	Take off tank cover, place the water tank in cool and dry place for 12 hours
	Too dirty water, Or water in tank too long time	Clean water tank
Power indicator illuminate, the unit with no wind and mist	Too much water in the water tank	Pour some water from water tank
	Blower not operating	Contact the store where the product was purchased from
	Dirty Ultrasonic Nebulizer	Clean the Ultrasonic Nebulizer
Weak or No mist output	Too dirty water, Or water in tank too long time	Clean the water tank, fill clean water in
	Too much water in the water tank	reduce water in the water tank

## 1. Add device

### 1.1 Download Oittm Smart APP



Please scan the QR Code, or get Oittm Smart to download on App Store or Google play.

### 1.2 Download & Registration

- Scan the QR code to download "Oittm Smart" Application
- Enter the register/login interface, input the phone number for getting verification code to register or through other methods at the bottom of page connecting to related authorization interface to log in.

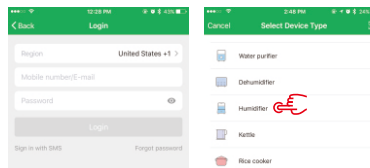

## 1.3 Easy Mode(Recommend)

Preparation: Device has connected with electricity, long press "+" button for 5 seconds until indicator light quickly flashes, the application already stepped into "My Device" interface.

- Phone has connected to Wifi router and been able to connect to Internet.
- Tap the icon "+" on the top right corner of "My Device", choose your device type, enter into "Add Device"
- Make sure the indicator light is flashing quickly, then tap the related button in application.
- Choose the local Wifi and enter the correct password, tap "Next".
- Wait for configuring successfully, then tap "Complete".

**Attention:** there is no Internet connected while the blue light flashing slowly.

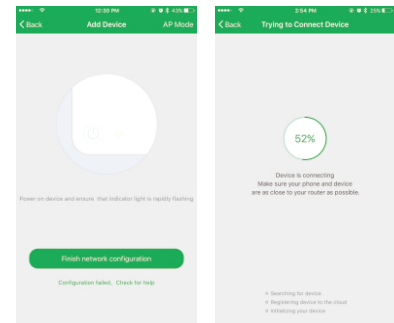

## 2. Enable Smart Life skill in Alexa APP

Choose "Skills" in the options bar, and then search "Smart life" in the input box.

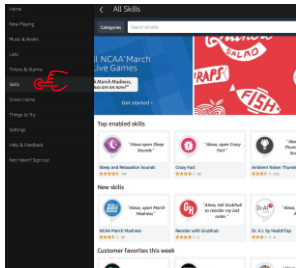

Select Smart life in the search results, and then click "Enable Skill".

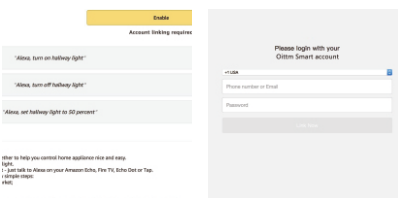

Then input the user name and password of Oittm App that you had previously registered. Only support the account in the United States.

## 3. Control Humidifier Controller by Voice

After the above operation is successful, you can control the humidifier via Echo.

### 3.1 Discover devices

Firstly, you need to say to Echo:

Echo(or Alexa), discover my devices.

Echo will start to find the devices which is added in Smart life APP, which will take about 20 seconds, then it will tell you the result.

You can also click "Discover devices" in Alexa APP, then it will show the devices that found successfully.

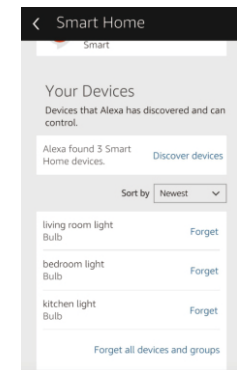

## 3.2 Control devices by voice

Attention: The name of the device must be consistent with the addition of Smart life app.

You can also group the Humidifier and give instructions to control them together.

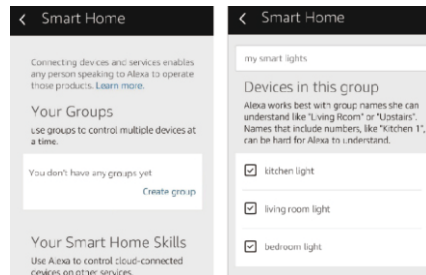

Attention: Echo is one of the wake-up names, which can be any of these three names(Settings): **Alexa, Echo, Amazon**

### 3.3 Support Skill list

You can control devices by instructions like these:

- Alexa(or echo), turn on the humidifier
- Alexa(or echo), turn off the humidifier

## 4. IFTTT - Setup and Usage

### Get Started: How to connect Oittm product to IFTTT?

#### Step 1.

Visit the IFTTT official website on your PC and sign in with your IFTTT account.

**Note:** You can also use IFTTT app and follow similar steps to connect your device to the IFTTT. In this FAQ we take the website setting method for example.

#### Step 2.

"Search" for "Smart Life", and then click "Smart Life" service.

#### Step 3.

Click "Connect", then login your Smart Life ID and then tap "Link Now". (The Smart Life ID is same with Oittm Smart App ID)

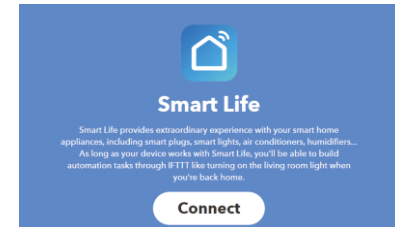

#### Step 4.

Successfully connect your IFTTT account to your Smart Life ID. You are ready to enjoy the IFTTT service of Oittm products now.

## Instructions: 2 methods to use IFTTT with Oittm products.

**Method 1:** On Smart Life service page, choose an existing Applet you need, turn on it and then finish the configuration.

**Method 2:** Create a new Applet on your own. Click "My Applets" at the top and then click "New Applet" at the right top corner of the webpage to create a new Applet.

### Step 1. Create a Trigger.

Tap "this" to choose a Trigger. You can search for "Weather Underground" to choose a Trigger.

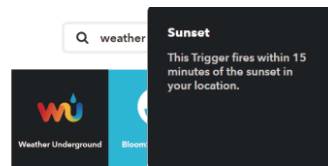

We select "Sunset" as the Trigger.

### Step 2. Create an Action.

Tap "that" to choose an Action. You can search for "smart life" to choose a Smart Life Action.

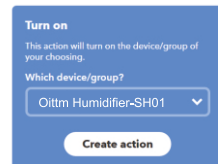

We select "Turn on" of Oittm Humidifier-SH01 as the Action in this case.

## Step 3.

New Applet "If sunset, then turn on Oittm Humidifier-SH01" is created as a result.

### Note:

**The Smart Life service can only work when create an action. You can't use the "Smart Life" as a Trigger.**

## Specification

Name: Smart Humidifier	Rated Frequency : 50-60Hz
Model No : SH01	Product size : 166x166x337mm
Mist Volume : 250mL/hr	Power : 28W
Capacity : 3.0L	Voltage : AC100-240V

ShenZhen RuiMaiDe(RMD)  
Technology Co., LTD

Add: #02-J201, Jinhaitian Commercial Center  
No. 329 Longhuan 3rd Street, Longhua  
District, Shenzhen China. 518109  
Tel: +86 0755 36940221

MADE IN CHINA



## FCC Caution.

This device complies with part 15 of the FCC Rules. Operation is subject to the following two conditions: (1) This device may not cause harmful interference, and (2) this device must accept any interference received, including interference that may cause undesired operation.

Any Changes or modifications not expressly approved by the party responsible for compliance could void the user's authority to operate the equipment.

Note: This equipment has been tested and found to comply with the limits for a Class B digital device, pursuant to part 15 of the FCC Rules. These limits are designed to provide reasonable protection against harmful interference in a residential installation. This equipment generates uses and can radiate radio frequency energy and, if not installed and used in accordance with the instructions, may cause harmful interference to radio communications. However, there is no guarantee that interference will not occur in a particular installation. If this equipment does cause harmful interference to radio or television reception, which can be determined by turning the equipment off and on, the user is encouraged to try to correct the interference by one or more of the following measures:  
-Reorient or relocate the receiving antenna.  
-Increase the separation between the equipment and receiver.  
-Connect the equipment into an outlet on a circuit different from that to which the receiver is connected.  
-Consult the dealer or an experienced radio/TV technician for help.

\*RF warning for Mobile device:  
This equipment complies with FCC radiation exposure limits set forth for an uncontrolled environment. This equipment should be installed and operated with minimum distance 20cm between the radiator & your body.