

## Welcome

to a simpler, smarter way to protect your home.

### Setting up your Uniden AppCam 40PT

1. Open the Uniden One app. The app is available on Apple iTunes, Google Play and the Amazon Store.



2. Connect your mobile device to your WiFi network.

**IMPORTANT** Ensure you are connected to a 2.4GHz (802.11 b/g/bg) and not a 5GHz network.

3. Login to your Uniden One account.

- If you do not have a Uniden One account, click "Register" to create one.

- You can register using your mobile phone number or email address.

- During registration, you will be sent a verification code either by email or by text, depending on what you registered with. Enter the verification code to confirm your registration.

- Once registered, you will see the "Device" page.

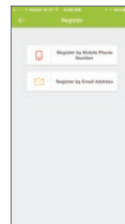

1. Look on the bottom of the camera to view the product label which has the QR code on it.
2. Plug power cord into camera and wait approximately 30 seconds for the camera to power up. The light on the front will change from red to blue and the camera will say "Ready for WiFi Connection".

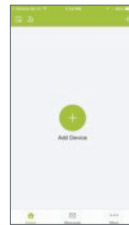

3. On the device manager page, click "Add Device". Scan the QR code with the mobile app.



4. The app should say "The device is offline."
5. Click "Connect to a Network". Input your WiFi password or connect wired connection if using a wired ethernet cable.



### Add Camera to Network

1. Input your WiFi password and click "Next". Wait for the app to register the AppCam 40PT camera to the network.



2. Once the device is added, if you need to configure any port mapping you may do so on this screen. Uniden suggests clicking "Skip" and attempting to remotely view your camera before any advanced setup.



### Using your Uniden AppCam 40PT

1. After setup, go back to the device screen by clicking "Uniden One" in the footer of the app.



2. You will now see your Uniden AppCam 40PT listed in the devices.

### Appearance

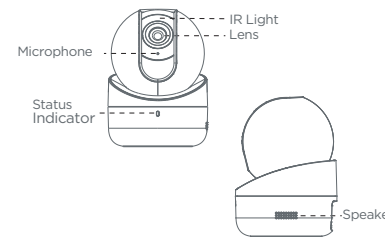

Name	Description
<b>Status Indicator</b>	<ul style="list-style-type: none"> <li>• Steady red: The camera is starting up.</li> <li>• Flashing blue: The camera is started, and is ready for WiFi set-up.</li> <li>• Steady blue: WiFi configuration is completed and the camera is running properly.</li> <li>• Flashing red: network communication is abnormal.</li> </ul>
<b>IR Light</b>	Auto light source for night vision. The light is behind the anti-reflection panel. You can see the light when it is on.

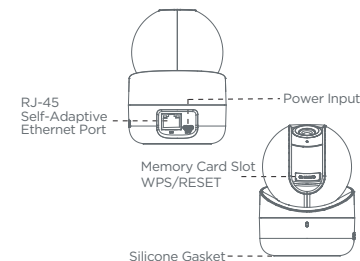

Name	Description
<b>Power Input</b>	Micro USB for power supply, 5V. Plug the power cable into the power input interface to power on the camera.
<b>Memory Card Slot</b>	For microSD card. If a memory card is used, video files will be stored in the memory card. You would need to initialize it in the Uniden One app.
<b>WPS/RESET</b>	<p>WPS: Set WiFi connection via WPS (WiFi Protected Setup) function.</p> <p>RESET: Hold down the button for 4 seconds when the camera is running.</p>

### Installation

#### 1 Install memory card.

- 1 Adjust the tilting position of the camera to expose the removable cover.
- 2 Open the cover to expose the memory card slot, and insert the memory card.
- 3 Install the removable cover back.

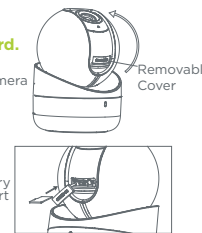

#### 2 Mounting the Camera. (Optional)

- 1 Take out the drill template from the package. Paste it to the desired mounting place.
- 2 Drill two screw holes according to the drill template if you use expansion screws.

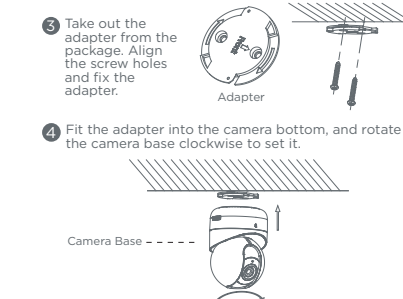
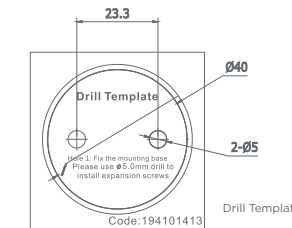

#### 3 Adjust the surveillance angle.

- 1 Rotate the camera body to adjust the panning position.
- 2 Move the dome drive upwards or downwards to adjust tilting position.

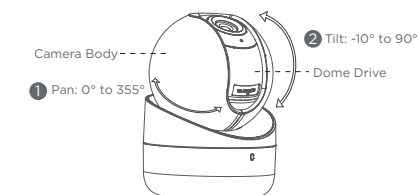

Uniden®



Control remotely from your smartphone or tablet.



FREE Uniden One App - Mobile Remote Access to live video from camera to iPhone®, iPad® and Android® devices. SYSTEM REQUIREMENTS: Network Router with available port.

### Need Help? Contact Us:

- URL: [www.unidensupport.com](http://www.unidensupport.com)
- Phone: (800) 297-1023 - Available 8:30 - 4:30 CST
- Email: [custsupport@uniden.com](mailto:custsupport@uniden.com)
- Facebook: <https://www.facebook.com/UnidenAmerica>
- Twitter: [https://twitter.com/uniden\\_america](https://twitter.com/uniden_america)

uniden.com

Regulatory Information

FCC Information

Please note that changes or modifications not expressly approved by the party responsible for compliance could void the user's authority to operate the equipment.

FCC Compliance

This equipment has been tested and found to comply with the limits for a Class B digital device, pursuant to part 15 of the FCC Rules. These limits are designed to provide reasonable protection against harmful interference in a residential installation. This equipment generates, uses and can radiate radio frequency energy and, if not installed and used in accordance with the instructions, may cause harmful interference to radio communications. However, there is no guarantee that interference will not occur in a particular installation.

FCC Statement

This equipment has been tested and found to comply with the limits for a Class B digital device, pursuant to part 15 of the FCC Rules. These limits are designed to provide reasonable protection against harmful interference in a residential installation. This equipment generates, uses and can radiate

radio frequency energy and, if not installed and used in accordance with the instructions, may cause harmful interference to radio communications. However, there is no guarantee that interference will not occur in a particular installation. If this equipment does cause harmful interference to radio or television reception, which can be determined by turning the equipment off and on, the user is encouraged to try to correct the interference by one or more of the following measures:

- Reorient or relocate the receiving antenna.
- Increase the separation between the equipment and receiver.
- Connect the equipment into an outlet on a circuit different from that to which the receiver is connected.
- Consult the dealer or an experienced radio/TV technician for help.

FCC Radiation Exposure Statement

This device complies with FCC radiation exposure limits set forth for an uncontrolled environment and it also complies with Part 15 of the FCC RF Rules. This equipment must be installed and operated in accordance with provided instructions and the antenna(s) used for this transmitter must be installed to provide a separation distance of at least 20 cm

from all persons and must not be co-located or operating in conjunction with any other antenna or transmitter. End-users and installers must be provided with antenna installation instructions and consider removing the no-collocation statement.

This device complies with Part 15 of the FCC Rules. Operation is subject to the following two conditions:

1. This device may not cause harmful interference, and
2. This device must accept any interference received, including interference that may cause undesired operation

Symbol Conventions

**IMPORTANT** Provides additional information to emphasize or supplement important points of the main text.

**WARNING** Indicates a potentially hazardous situation, which if not avoided, could result in equipment damage, data loss, performance degradation, or unexpected results.

Safety Instructions

These instructions are intended to ensure that a user can use the product correctly to avoid danger or property loss.

Proper configuration of all passwords and other security settings is the responsibility of the installer and/or end-user.

- In the use of the product, you must be in strict compliance with the electrical safety regulations of your area.
- Do not connect several devices to one power adapter as adapter overload may cause over-heating or a fire hazard.
- Please make sure that the plug is firmly connected to the power socket. When the product is mounted on wall or ceiling, the device shall be firmly fixed.

**WARNING**

- Make sure the power supply voltage is correct before using the camera.
- Do not drop the camera or subject it to physical shock.
- Do not touch sensor modules with fingers. If cleaning is necessary, use a clean cloth with a bit of ethanol and wipe it gently. If the camera will not be used for an extended period, replace the lens cap to protect the sensor from dirt.

- Do not aim the camera at the sun or extra bright places. Blooming or smearing may occur, and affect the sensor's endurance at the same time.

- The sensor may be burned out by a laser beam, so when any laser equipment is in use, make sure that the surface of sensor will not be exposed to the laser beam.

- Do not place the camera in extremely hot, cold (the operating temperature shall be -10°C to +40°C), dusty, or damp locations, and do not expose it to high electromagnetic radiation.

- To avoid heat accumulation, ensure that there is good ventilation to the device.

- Keep the camera away from liquids.

- If the product does not work properly, please contact your retailer or Uniden customer service.

- Never attempt to disassemble the camera yourself. (We shall not assume any responsibility for problems caused by unauthorized repair or maintenance.)

Uniden Corporation  
Limited 1 Year Warranty

**Important: Keep your receipt. Proof of original purchase is required for warranty service.**

**WARRANTOR:** Uniden America Corporation ("Uniden")  
**ELEMENTS OF WARRANTY:** Uniden warrants, for one year, to the original retail owner, this Uniden Product to be free from defects in materials & craftsmanship with only the limitations or exclusions set out below. Uniden only warrants the Products contained in the original factory packaging.

**WARRANTY DURATION:** This warranty to the original user shall terminate & be of no further effect 12 months after the date of original retail sale. The warranty is invalid if the Product is (A) damaged or not maintained as reasonable or necessary, (B) modified, altered, or used as part of any conversion kits, subassemblies, or any configurations not sold by Uniden, (C) improperly installed, (D) serviced or repaired by someone other than an authorized Uniden service center for a defect or malfunction covered by this warranty, (E) used in any conjunction with equipment or parts or as part of any system not manufactured by Uniden, or (F) installed or programmed by anyone other than as detailed by the owner's manual for this product.

**STATEMENT OF REMEDY:** In the event that the product does not conform to this warranty at any time while this warranty is in effect, warrantor will either, at its option, repair or replace the defective unit & return it to you without charge for parts, service, or any other cost (except shipping & handling) incurred by warrantor or its representatives in connection with the performance of this warranty. Warrantor, at its option, may replace the unit with a new or refurbished unit. Warrantor is not responsible for any additional costs associated with reinstallation of product.

THE LIMITED WARRANTY SET FORTH ABOVE IS THE SOLE & ENTIRE WARRANTY PERTAINING TO THE PRODUCT AND THE CONTENTS CONTAINED IN THE ORIGINAL FACTORY PACKAGING & IS IN LIEU OF & EXCLUDES ALL OTHER WARRANTIES OF ANY NATURE WHATSOEVER, WHETHER EXPRESS, IMPLIED OR ARISING BY OPERATION OF LAW, INCLUDING, BUT NOT LIMITED TO ANY IMPLIED WARRANTIES OF MERCHANTABILITY OR FITNESS FOR A PARTICULAR PURPOSE. THIS WARRANTY DOES NOT COVER OR PROVIDE FOR THE REIMBURSEMENT OR PAYMENT OF INCIDENTAL OR CONSEQUENTIAL DAMAGES TO THE PRODUCT CAUSED BY IMPROPER INSTALLATION OF THE PRODUCT. THIS WARRANTY DOES NOT COVER ANY COSTS RELATING TO THE REMOVAL, REPLACEMENT, OR INSTALLATION OF ANY PRODUCT.

Some states do not allow this exclusion or limitation of incidental or consequential damages so the above limitation or exclusion may not apply to you.

**LEGAL REMEDIES:** This warranty gives you specific legal rights, & you may also have other rights which vary from state to state. This warranty is void outside the United States of America & Canada.

PROCEDURE FOR OBTAINING

**PERFORMANCE OF WARRANTY:** If, after following the instructions in the owner's manual you are certain that the Product is defective, pack the Product carefully (preferably in its original packaging). The Product should include all parts & accessories originally packaged with the Product. Include evidence of original purchase & a note describing the defect that has caused you to return it. The Product should be shipped freight prepaid, by traceable means, to warrantor at:

**Uniden America Service**  
c/o Saddle Creek  
743 Henrietta Creek Rd., Suite 100  
Roanoke, TX 76262

Copyright ©2017 Uniden America Corporation, Irving Texas. ALL RIGHTS RESERVED.

Uniden®  
AppCam 40PT

1080p Pan/Tilt | WiFi Camera

Quick Start Guide



1080p Full HD | Pan Tilt | Two-way Audio | No Fees | Night Vision | Remote Viewing