



Installing Batteries

Open the M-BTi using the latch on the right side of the camera housing. The M-BTi requires eight (8) AA alkaline or lithium batteries. There are two levels for battery placement within the compartment. Be sure to orientate the batteries according to the polarity icons found in the compartment.

Downloading the SmartSet™ app

All settings for the M-BTi are controlled using the Moultrie SmartSet app and a Bluetooth connection. Download your free SmartSet app through the App Store or on Google Play.

Powering Up

The power switch is located next to the SD card slot. Slide left for on, the red LED will come on momentarily.

Installing SD Card

Access the SD Card port using the latch on the right side of the camera housing. Slide card into slot with label side up (see icon next to card slot). Card will click into place. To remove, push card inward to eject. Be sure to format your SD Card once you have downloaded the SmartSet™ app (See Quick Start Instructions).

Understanding the Red LED

The red LED comes on:

- A. To indicate there is power to the camera. The LED will then go off indicating it is ready to capture images.
- B. Once the sensor detects movement and captures an image
- C. When a Bluetooth connection is made using the SmartSet app

SD Card Slot

Accepts up to a 32GB SD Card (Class 4 or higher) for photo and video storage. **NOTE:** A Class 4 or higher SD Card must be installed for the camera to operate (sold separately). Ultra/turbo SD cards are not recommended.

USB Port

Download still pictures and video onto your computer by connecting a micro-B to USB cable (not included) to the USB port, or connect to a Moultrie Mobile compatible modem.

External Power Port

Accepts Moultrie power accessories (sold separately) only. Refer to www.moultriefeeders.com for more information. **NOTE:** The use of any other power source will void your warranty and possibly harm your camera.



FCC Statements



Moultrie Products
MCG-13268

M-BTi

Note: changes and modifications not expressly approved by the party responsible could void the user's authority to operate this device.

This device complies with Part 15 of the FCC Rules. Operation is subject to the following two conditions: (1) This device may not cause harmful interference, and (2) this device must accept any interference received, including interference that may cause undesired operation.

NOTE: THE MANUFACTURER IS NOT RESPONSIBLE FOR ANY RADIO OR TV INTERFERENCE CAUSED BY UNAUTHORIZED MODIFICATIONS TO THIS EQUIPMENT. SUCH MODIFICATIONS COULD VOID THE USER'S AUTHORITY TO OPERATE THE EQUIPMENT.

NOTE: This device complies with the limits for a Class B digital device, pursuant to Part 15 of the FCC Rules. These limits are designed to provide reasonable protection against harmful interference in a residential installation. This device generates, uses, and can radiate radio frequency energy and, if not installed and used in accordance with the instructions, may cause harmful interference to radio communications. However, there is no guarantee that interference will not occur in a particular installation. If this device does cause harmful interference to radio or television reception, which can be determined by turning the equipment off and on, the user is encouraged to try to correct the interference by one or more of the following measures:

- Reorient or relocate the receiving antenna.
- Increase the separation between the equipment and receiver.
- Connect the equipment into an outlet on a circuit different from that to which the receiver is connected.
- Consult the dealer or an experienced radio/TV technician for help.



www.moultriefeeders.com

PRADCO Outdoor Brands • 3280 Highway 31, Ste B • Calera, AL 35040

01252018 / MCG-13268



Instructions for the M-BTi Game Camera

THANK YOU for your purchase of an M-BTi Game Camera. Please read this booklet before using the unit. If you should have any questions about this product, please contact us using the information on the back of this booklet. Please register your camera at www.moultriefeeders.com/warranty to activate your warranty.

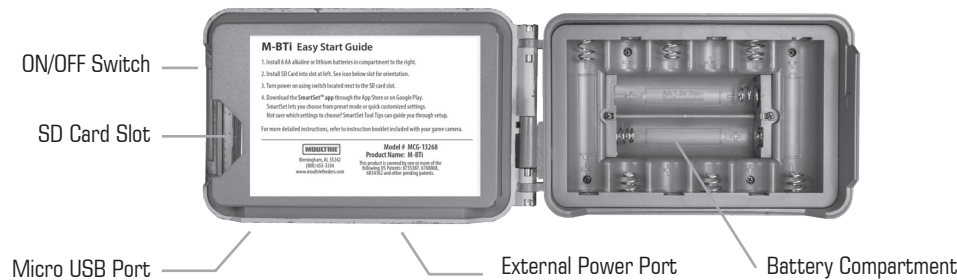
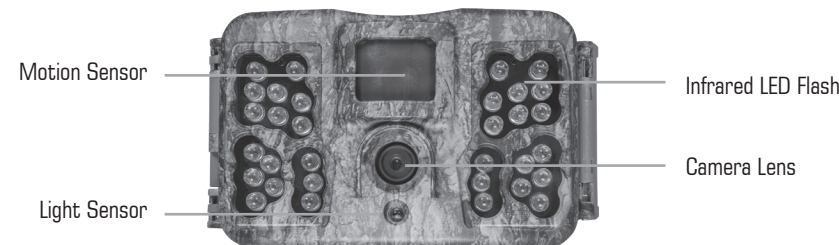



Easy redefined.

Set up the M-BTi on your smartphone using the Moultrie SmartSet™ app and a Bluetooth connection.

SmartSet™ speeds setup.

Choose from preset modes or easily customize to your preferred settings.

From managing memory to selecting photo settings, it's all done with a tap. Plus, time and date are now set automatically by the Moultrie SmartSet app!

Not sure which settings to choose? SmartSet Tool Tips can guide you through setup.



Requires the Moultrie SmartSet™ app, a free download, available for iOS and Android.



Google Play is a trademark of Google Inc.

Apple and the Apple logo are trademarks of Apple Inc., registered in the U.S. and other countries. App Store is a service mark of Apple Inc.

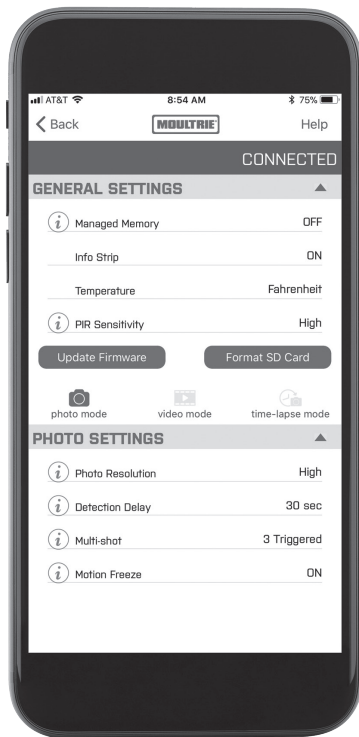

QUICK START INSTRUCTIONS

Use the steps below to quickly set up your camera using the factory default settings.

STEP 1

Open camera cover. Install eight (8) AA size alkaline or lithium batteries with polarities as indicated in the battery compartment. Turn on camera. Next, download the SmartSet™ app onto your smartphone using the Apple App Store or Google Play.

STEP 2

Insert SD card, then open your SmartSet app. In General Settings select Format SD Card. **The SD card must be formatted for camera operation. Note that formatting the SD card will erase all images on that card. Camera will not operate without formatted SD card.**

STEP 3

Mount camera in desired location using the included mounting strap. The camera also has two (2) Python™ Cable Loops for added security (cable sold separately). **NOTE: Camera must be attached to a stable object for motion detection to function properly. Mounting camera on an unstable structure may result in excessive image captures with no subject (false triggers).**

STEP 4

Confirm the camera is still on. Close cover.

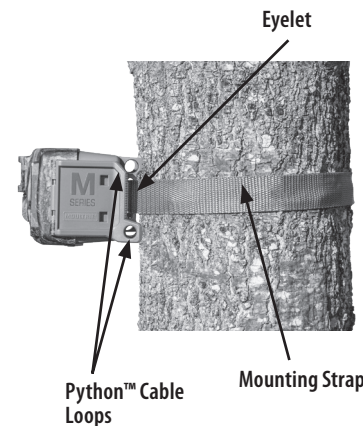

Important Battery Information

- Only use Alkaline or Lithium batteries. We recommend the use of Energizer® batteries.
- Do not mix old and new batteries. Always replace ALL the batteries at the same time.
- When the camera is not in use, please remove the batteries.
- Using weak batteries can adversely affect the performance of your camera and degrade the Bluetooth® connection between your app and camera.

Moultrie Limited Warranty

This product has been thoroughly tested and inspected before shipment. It is guaranteed from defects in material and workmanship from the date of purchase for two (2) years. Under this limited guarantee we agree to replace or repair free of charge any part or parts which have been found to be defective in original material or workmanship. Should you require in-warranty service, call our Customer Service Department. If your problem cannot be addressed over the telephone, we may need you to send us your defective product plus proof of purchase.

You must register your camera at www.moultriefeeders.com/warranty to activate your two-year warranty.

Troubleshooting

For troubleshooting and helpful tips please visit the "Help" section within the Moultrie SmartSet™ app. If you require additional assistance, email us at info@MoultrieSmartSet.com.

Returns and Repairs

Please visit <http://www.moultriefeeders.com/return-policy> and complete the form.

Moultrie Mobile® Compatibility

The M-BTi game camera is compatible with Moultrie Mobile when connected to a Moultrie Mobile modem. Please visit [Moultrie Mobile.com](http://MoultrieMobile.com) for monthly plan pricing and more information.

Terms and Conditions

This product and the Moultrie SmartSet application are subject to terms and conditions. Use of the product or the Moultrie SmartSet application constitutes acceptance of those terms and conditions. For details about the terms and conditions, download the Moultrie SmartSet application for your mobile device.