

NEBULA

For a detailed user manual and more information,
scan the QR code or visit:

support.seenebula.com/s



support@seenebula.com
support@anker.com (日本)
support.me@seenebula.com
(For Middle East and Africa Only)
ced-cn@anker.com (中国)

+1 (800) 988 7973 (US/Canada)
+44 (0) 1604 936200 (UK)
+49 (0) 69 9579 7960 (DE)
+971 529750842 (Middle East & Africa)
+971 8000320817 (UAE)
+966 8008500030 (KSA)
+965 22069086 (Kuwait)
+20 8000000826 (Egypt)
+61 3 8331 4800 (AU)
+90 (850) 460 14 14 (TR)
+8 (800) 511-86-23 (RU)
+86 400 0550 036 (中国)
03 4455 7823 (日本)
+82 02-1661-9246 (한국)
+91 18003138831 (India)
+886 801 491310 (中国台湾)

© Anker Innovations Limited, All rights reserved.
NEBULA and the NEBULA logo are trademarks of Anker Innovations
Limited, registered in the United States and other countries.
Model: D4112

51005004708 V01

Important Safety Instructions

- Due to the enclosure material, the product must only be connected to a USB 2.0 or higher.
- The adapter shall be installed near the product and shall be easily accessible.
- Please ensure you use only the adapter offered by the manufacturer. Using unauthorized adapter may cause danger and violate the authorization of the product and the guarantee article.
- Do not use the product in an environment where the temperature is too high or too low. Never expose the product to strong sunshine or wet environments.
- The suitable temperature range for the projector and its accessories is 32°F-95°F / 0°C-35°C (32°F-113°F/ 0°C-45°C when supplying).
- It is recommended to supply the product in an environment with a temperature that ranges from 41°F-77°F / 5°C-25°C.
- When supplying, place the device in an environment that has a normal room temperature and good ventilation.
- Possibly hazardous optical radiation emitted from this product may be harmful to the eyes. Do not stare at operating beam.
- Potential hazards may exist during lamp or product servicing.
- Service shall be performed only by authorized, trained servicing, trained servicing personnel.
- Do not open the enclosure of the product.
- When the enclosure of the product is damaged, please do not use it anymore.
- Do not open the enclosure of laser module inside the product.
- When the enclosure of laser module inside the product is damaged, please do not use it anymore.
- Laser inside, be aware of the risk of skin or corneal burns.

- Do not use the product in any way other than described herein in order to avoid personal injury or property damage.
- User should comply with the laws and regulations of the corresponding countries and regions where the equipment is located (used), abide by professional ethics, pay attention to safety obligations, and strictly prohibit the use of our products or equipment for any illegal purposes. Our company will not be responsible for any violators' legal liability under any circumstances.

Warning:

- Replacement of a battery with an incorrect type that can defeat a safeguard;
- Disposal of a battery into fire or a hot oven, or mechanically crushing or cutting of a battery, that can result in an explosion;
- Leaving a battery in an extremely high temperature surrounding environment that can result in an explosion or the leakage of flammable liquid or gas; and
- A battery subjected to extremely low air pressure that may result in an explosion or the leakage of flammable liquid or gas.

Attention:

- Remplacement d'une batterie par un type incorrect pouvant supprimer une protection;
- Mise au rebut d'une batterie dans un feu ou dans un four chaud, ou écrasement mécanique ou coupure d'une batterie, susceptible de provoquer une explosion;
- Maintien d'une batterie dans un environnement à très haute température pouvant provoquer une explosion ou la fuite de liquide ou de gaz inflammables; et
- Batterie soumise à une pression de l'air extrêmement faible pouvant provoquer une explosion ou la fuite de liquide ou de gaz inflammables.

 CAUTION: RISK OF EXPLOSION IF BATTERY IS REPLACED BY AN INCORRECT TYPE. DISPOSE OF USED BATTERIES ACCORDING TO THE INSTRUCTIONS.

 ATTENTION RISQUE D'EXPLOSION SI LA BATTERIE EST REMPLACÉE PAR UN TYPE INCORRECT. ÉLIMINER LES BATTERIES USÉES SELON LES INSTRUCTIONS.

Notice (Europe and United Kingdom)

 This product complies with the radio interference requirements of the European Community.

Declaration of Conformity

Hereby, Anker Innovations Limited declares that this device is in compliance with the essential requirements and other relevant provisions of Directive 2014/53/EU. For the Declaration of Conformity, visit the Web site <https://support.seenebula.com/s/article/Recommend?type=Download&secondType=doc>.

The suitable temperature range for the projector and its accessories is 0°C-25°C.
The adapter is for indoor use only. The adapter type is PN4531 (with rated output voltage / current of 5VDC/3A or 9V = 3A or 12V = 3A or 15V = 3A or 20V = 2.25A) or A2713 (with rated output voltage / current of 5V = 3A or 9V = 3A or 15V = 3A or 20V = 3.25A).

RF exposure information

The Maximum Permissible Exposure (MPE) level has been calculated based on a distance of d=20 cm

between the device and the human body. To maintain compliance with RF exposure requirement, use product that maintain a 20cm distance between the device and human body.

Frequency bands and power as below:

Function	Bands	Operation Frequency	Max.Power
Bluetooth (Projector)	2.4 GHz	2402-2480 MHz	EIRP 13.70 dBm
WIFI (Projector)	5 GHz	2412-2472 MHz	EIRP 18.42 dBm
		5150-5250 MHz	EIRP 21.68 dBm
		5250-5350 MHz	EIRP 19.00 dBm
		5470-5725 MHz	EIRP 18.52 dBm
Bluetooth (Remote Control)	2.4 GHz	5725-5850 MHz	EIRP 13.32 dBm
		2402-2480 MHz	EIRP 3.63 dBm

5150~5350 MHz can be used indoors only.

AT	BE	BG	HR	CY	CZ	DK
EE	FI	FR	DE	EL	HU	IE
IT	LV	LT	LU	MT	NL	PL
PT	RO	SK	SI	ES	SE	UK

The following importer is the responsible party (contract for EU matters):

Anker Innovations Deutschland GmbH I
Georg-Muche-Strasse 3, 80807 Munich, Germany



Your product is designed and manufactured with high quality materials and components, which can be recycled and reused.



This symbol means the product must not be discarded as household waste, and should be delivered to an appropriate collection facility for recycling. Proper disposal and recycling helps protect natural resources, human health, and the environment. For more information on disposal and recycling of this product, contact your local municipality, disposal service, or the shop where you bought this product.

Notice (United States of America) FCC Statement

This device complies with Part 15 of the FCC Rules. Operation is subject to the following two conditions: (1) this device may not cause harmful interference, and (2) this device must accept any interference received, including interference that may cause undesired operation.

Warning: Changes or modifications not expressly approved by the party responsible for compliance could void the user's authority to operate the equipment.

Note: This equipment has been tested and found to comply with the limits for a Class B digital device, pursuant to Part 15 of the FCC Rules. These limits are designed to provide reasonable protection against harmful interference in a residential installation.

This equipment generates uses and can radiate radio frequency energy and, if not installed and used in accordance with the instructions, may cause harmful interference to radio communications. However, there is no guarantee that interference will not occur in a particular installation. If this equipment does cause harmful interference to radio or television reception, which can be determined by turning the equipment off and on, the user is encouraged to try to correct the interference by one or more of the following measures: (1) Reorient or relocate the receiving antenna. (2) Increase the separation between the equipment and receiver. (3) Connect the equipment into an outlet on a circuit different from that to which the receiver is connected. (4) Consult the dealer or an experienced radio/TV technician for help.

FCC Radio Frequency Exposure Statement

The device has been evaluated to meet general RF exposure requirements. The device can be used in fixed/mobile exposure condition. The min separation distance is 20cm.

Notice: Shielded cables

All connections to other computing devices must be made using shielded cables to maintain compliance with FCC regulations. The following importer is the responsible party. Company Name: Fantasia Trading LLC Address: 5350 Ontario Mills Pkwy, Suite 100, Ontario, CA 91764 Telephone: 1-800-988-7973 5150~5350 MHz can be used indoors only.

Notice (Canada) IC Statement

This device complies with Industry Canada licence-exempt RSS standard(s). Operation is subject to the following two conditions: 1) this device may not cause interference, and 2) this device must accept any interference, including interference that may cause undesired operation of the device.

Le présent appareil est conforme aux CNR d'Industrie Canada applicables aux appareils radio exempts de licence. L'exploitation est autorisée aux deux conditions suivantes: 1) l'appareil n'émet pas de brouillage, et 2) l'utilisateur de l'appareil doit accepter tout brouillage radioélectrique subi, même si le brouillage est susceptible d'en compromettre le fonctionnement. This Class B digital apparatus complies with Canadian ICES-003. Cet appareil numérique de la classe B est conforme à la norme NMB-003 du Canada.

IC RF Statement

When using the product, maintain a distance of 20cm from the body to ensure compliance with RF exposure requirements. Lors de l'utilisation du produit, maintenez une distance

de 20 cm du corps afin de vous conformer aux exigences en matière d'exposition RF. 5150~5250 MHz can be used indoors only. 5150~5250 MHz peut être utilisé à l'intérieur uniquement.



The Bluetooth® word mark and logos are registered trademarks owned by the Bluetooth SIG, Inc. and any use of such marks by Anker Innovations Limited is under license. Other trademarks and trade names are those of their respective owners.



HDMI, and HDMI logo and High-Definition Multimedia Interface are trademarks or registered trademarks of HDMI licensing LLC in the United States and other countries.



Manufactured under license from Dolby Laboratories. Dolby, Dolby Audio, and the double-D symbol are trademarks of Dolby Laboratories Licensing Corporation.

Anker Innovations Limited

Room 1318-19, Hollywood Plaza, 610 Nathan Road, Mongkok, Kowloon, Hong Kong

Laser Safety



- RG1 IEC 62471-5:2015
- Complies with IEC 60825-1:2014 Class 1 and IEC 62471-5:2015 Risk Group 1.
- Potential hazards may exist during lamp or product servicing.
- Service shall be performed only by authorized, trained servicing personnel.
- Do not open the enclosure of the product.
- When the enclosure of the product is damaged, don't use it anymore.
- Do not open the enclosure of laser module inside the product.
- When the enclosure of laser module inside the product is damaged, don't use it anymore.
- Laser inside. Be aware of the risk of skin or corneal burns.

Statement of Compliance

Hereby, Anker Innovations Limited declares that this device is in compliance with The Product Security and Telecommunications Infrastructure (Security Requirements for Relevant Connectable Products) Regulations 2023 . For the Statement of Compliance, visit the Web site <https://uk.seenebula.com/ps-ti-related>.

PAP 22

Raccolta Carta

NEBULA
by Anker



Lens

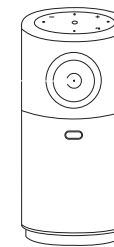

Camera for autofocus and auto keystone correction

Speaker

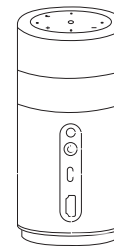

Infrared receiver
Power button
USB-C port
HDMI port

1

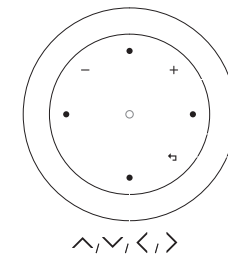

Volume up / down buttons
Confirmation button
Return button
Navigation buttons

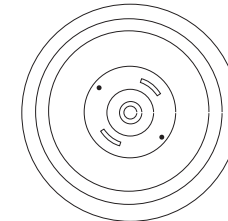

1/4" tripod socket

2

Auto image adjustment
Power on / off
Navigation



Press to activate Google Assistant
Confirm a selection / pause / resume
Access the home menu
Access more options
Volume up
Open Youtube
Open Netflix
Press to mute the sound

Remote Control Nebula RC Model: D0442X

3

For first-time use, slide to open the battery compartment, and install two AAA batteries.

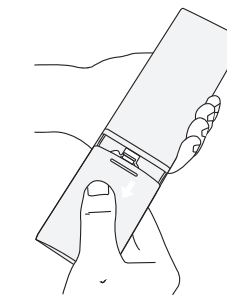

To replace the batteries, slide off the battery compartment backplate, insert new batteries (matching the polarity (+/-) as indicated), and close the battery compartment.

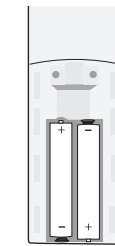

4

For first-time use, fully charge the built-in battery using the provided adapter.

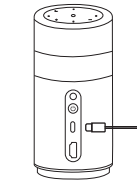

Press and hold  for 1.5 seconds to power on the projector.

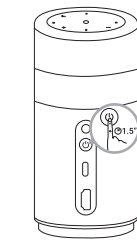

5

- Slightly move the projector to enable autofocus and auto keystone correction.
- Press  to enable autofocus.

For first-time use, follow the on-screen instructions to complete the basic setup. Adjust settings in the projector's **Settings** menu if necessary.

Wirelessly cast movies, games, and music from your phone to Nebula Capsule Air. Play a video clip on your phone and tap the cast icon  on the video screen. Select the device Nebula Capsule Air. The projector will mirror the screen of the connected phone.

6

Make sure Nebula Capsule Air and your phone are connected to the same wireless network.

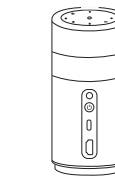

Connect to HDMI playback devices such as a TV box, TV stick, DVD player, set-top box (STB), or gaming consoles.

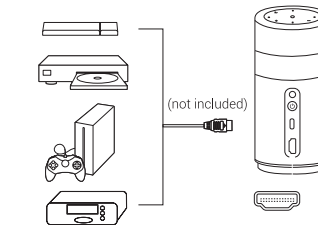

7

1. Carefully align the bottom of Nebula Capsule Air with the inner circle of the snap-on base.

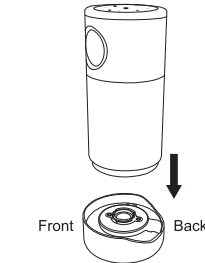

2. Turn the device clockwise until the device are firmly attached to the base.

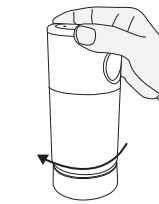

8

You can choose to install the device with the Nebula logo facing either the front or back side of the base, so as to use the device in multiple angles and scenarios.

3. Now you're ready to enjoy your favorite content wherever you like.

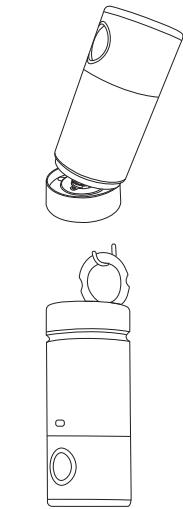

9

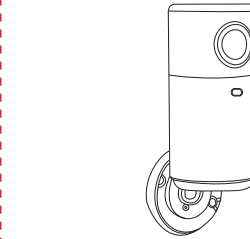

Download the **Nebula Connect** app for the best projector experience.



10