

# AM20 Plantation Shutter Motor Manual Instruction

## I .Motor Features

- User friendly removable battery case; accept 5V type-C USB charging
- Built-in 900mAh rechargeable lithium battery. Motor can connect with solar panel extending running time.
- Compatible both Bluetooth bi-directional communication control and radio frequency remote control.
- Featuring rational light tilting mode and one touch tap-to-run mode.
- The push/pull force is up to 50N (5kgs).
- Running speed 8mm/s, quick response.
- Various fixed methods are available, screws fixed and 3M adhesive tape.



AM20-D50N-82MM

## II.Motor specification

Push/ pull power	Running speed	Running distance	Rated power	Charging voltage	Battery capacity	Standby time	RF frequency	IP class	Operation life	Working Temperature
50N	8mm/s	0-82mm	2W	5VDC	lithium battery 900mAh	3 months(It is recommended to charge every three months)	433.92MHz	IP32	15000 times	-10℃ ~+55℃

## III.Accessory

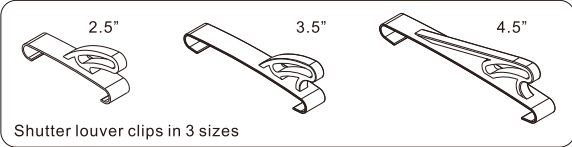

Shutter louver clips in 3 sizes

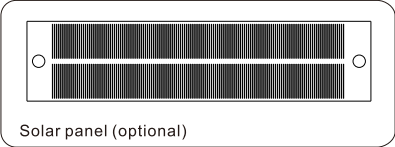

Solar panel (optional)

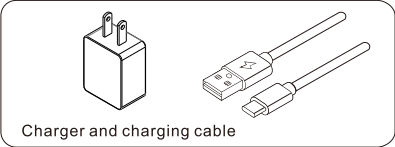

Charger and charging cable

## IV.Installation instructions

### Shutter louver clips installation method

In order to achieve better light blocking effect, the clip is recommended to install onto the middle louver of the shutter.

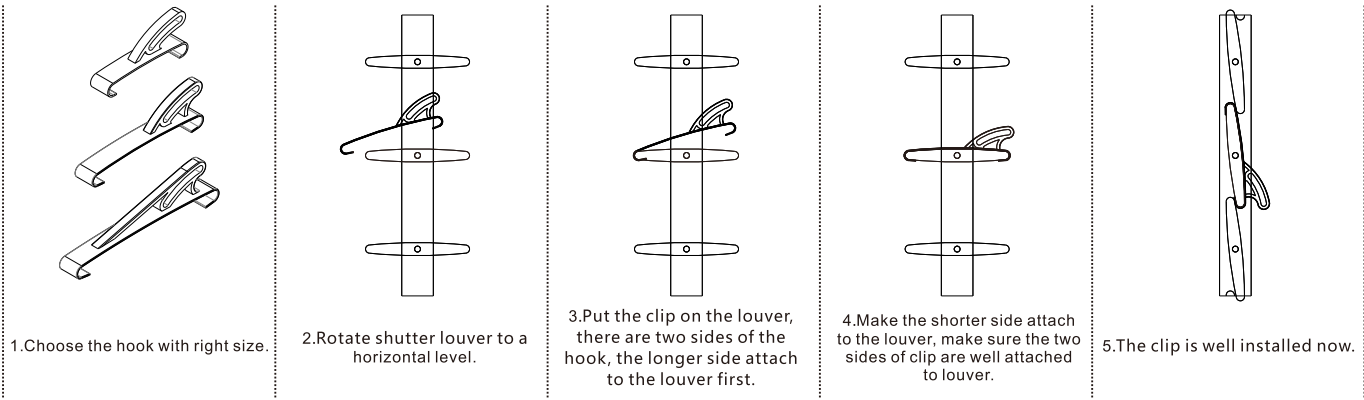

### Plantation Motor Installation Method

#### Preparation

- 1.When the clip is well installed, make the shutter louvers fully closed.
- 2.The driving rod of the motor should run to the lowest limit(the default limit of the motor is lower limit),and insert the rod to the arc-shaped hole of the hook.
- 3.Pull the motor straightly down, make sure the shutter louvers are tightly closed, and mark down the position of the motor.

#### Fixed the motor

##### Method 1: screw fixed

- a.Fix the motor onto shutter and mark position.
- b.Use Phillipe screwdriver to fix two screws on the motor(like the right picture①), the screws are in the accessory kit package.
- c.Attached the clip to motor rod, lock the screw nuts.
- d.Press the two screw caps into the screw holes, Motor installation completed.

##### Method 2: 3M adhesive tape fixed

- a.Put the 3M adhesive tape on motor(like right picture②), don't attach the adhesive tape on battery pack.
- b.Install the motor on the marked position.
- c.Attached the clip to motor rod, lock the screw nuts.
- d.Press the two screw caps into the screw holes, Motor installation completed.

#### Caution:

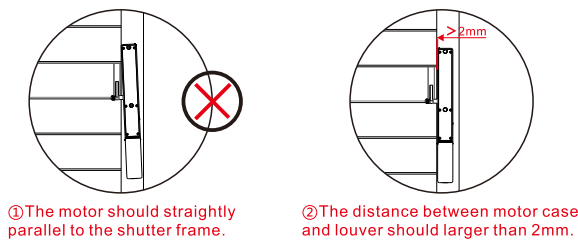

①The motor should straightly parallel to the shutter frame.

②The distance between motor case and louver should larger than 2mm.

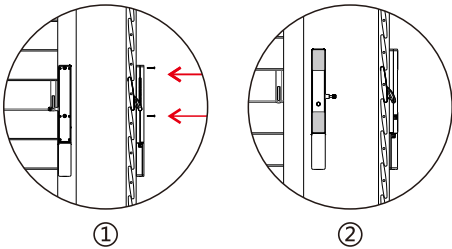

## V.Operating instructions

### 1.Enter pairing mode

#### Method 1

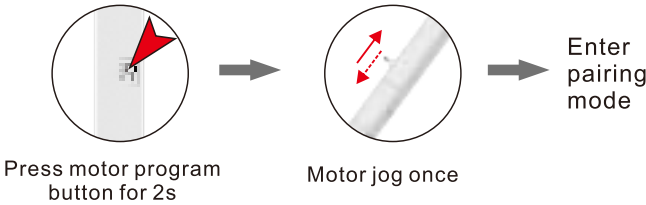

#### Method2

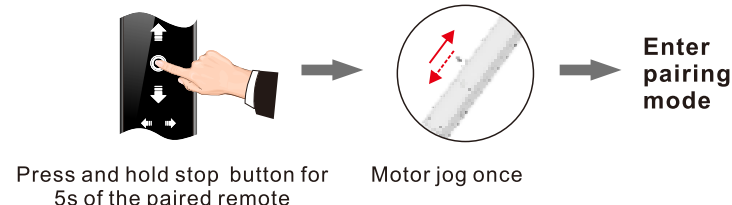

### 2.Pair to remote

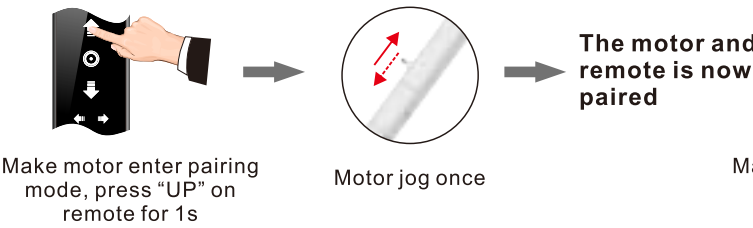

### 3.Reverse motor direction

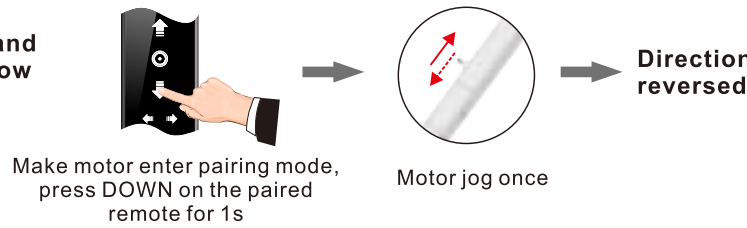

### 4.Switch light tilting mode and tap-to-run mode

### 5.Movement calibration function

(one short press + one long press)

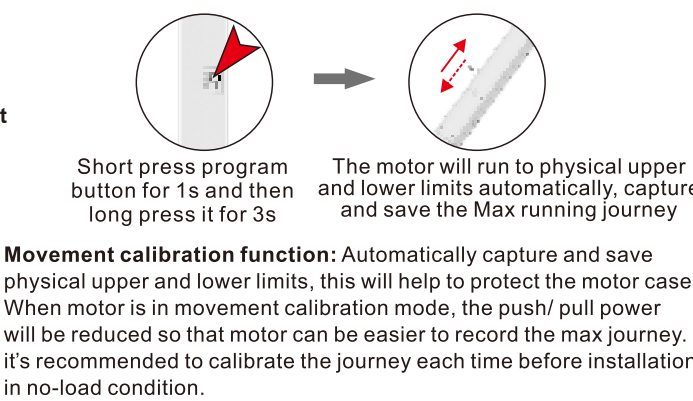
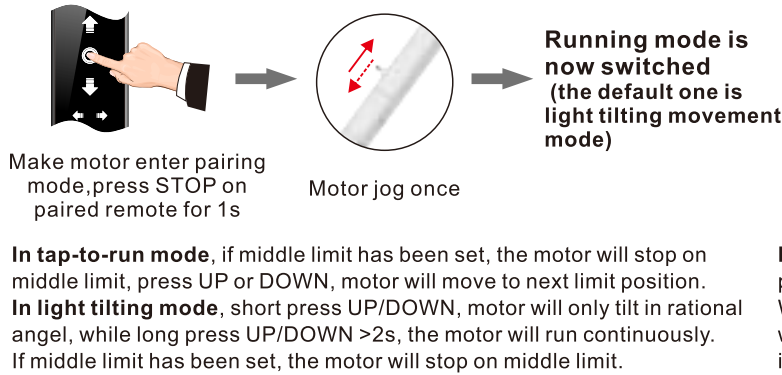

### 6.Delete single channel

### 7.Delete all memories



### 8.Adjust upper/lower limits

When movement calibration finished, the default upper limit is max journey calibration, and the lower limit is minimum journey calibration.

