

4

3

2

1

D

D

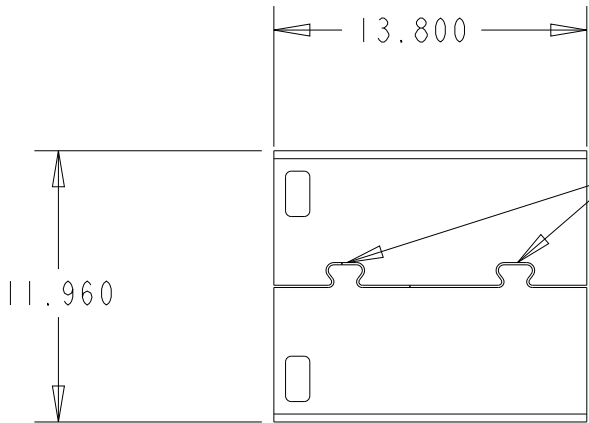
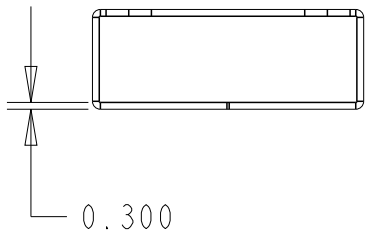

VENDOR TO PROVIDE
REQUIRED INTERLOCK
GEOMETRY OF INDICATED
FEATURE

- NOTES: UNLESS OTHERWISE SPECIFIED
1. INTERPRET DRAWING PER ANSI/ASME Y14.5M-LATEST REVISION.
 2. MATERIAL: STAINLESS STEEL, 302
 3. FLAGNOTES AND BALLOONED ITEMS () INDICATE INSPECTION CRITERIA.
 4. PACKAGE PARTS TO AVOID DAMAGE AND LABEL PACKAGE WITH PART NUMBER, DASH NUMBER, REVISION LEVEL AND DATE OF MANUFACTURE.
 5. FINISHED PART MUST BE ROHS COMPLIANT.

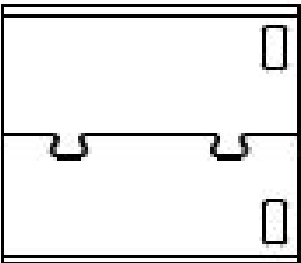

Laser Etched Regulatory Details

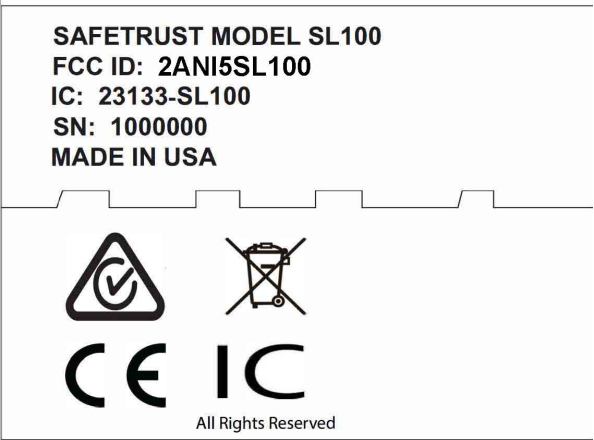

C

C

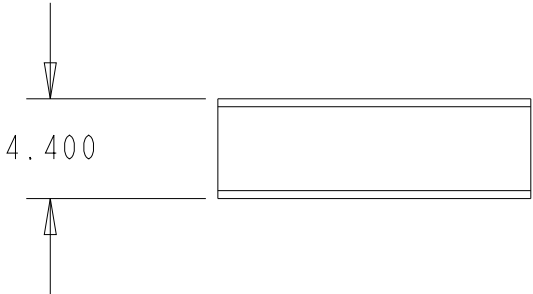
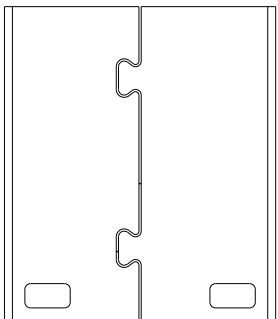

B

B



SCALE 1.000

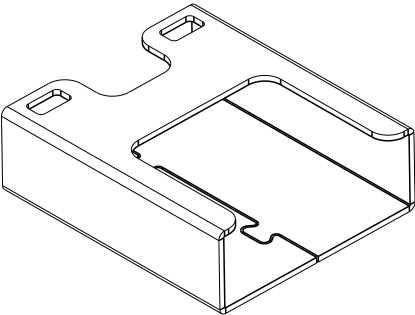
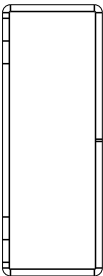
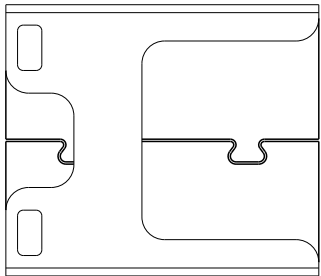

A

A

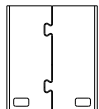

UNLESS OTHERWISE SPECIFIED, DIM'S ARE IN MM'S. TOLERANCES ARE:		THIS DOCUMENT CONTAINS CONFIDENTIAL INFORMATION WHICH MAY BE PROPRIETARY. NEITHER THIS DOCUMENT NOR THE INFORMATION CONTAINED HEREIN SHALL BE DISCLOSED OR REPRODUCED, IN WHOLE OR IN PART, WITHOUT THE EXPRESS WRITTEN CONSENT OF EITHER PRECISION ENGINEERING AND CONSULTING LLC, OR THE CUSTOMER.		PRECISION ENGINEERING AND CONSULTING, LLC 21820 31st Drive SE Bothell, WA 98021	
∠ =	±.5°			USB SLEEVE	
.XX =	±.25MM			SIZE B	REV A
.XXX =	±.127MM			SABRE_USB_SLEEVE-01	
.XXXX =	N/A			SCALE: 3.000	SHEET: 1 OF 1

4

3

2

1

Safetrust Laser Marking

SAFETRUST MODEL SL100

FCC ID: 2ANI5SL100

IC: 23133-SL100

SN: 1000000

MADE IN USA



CE

IC

All Rights Reserved