

USE AND CARE GUIDE

SMART LED VENTILATION FAN

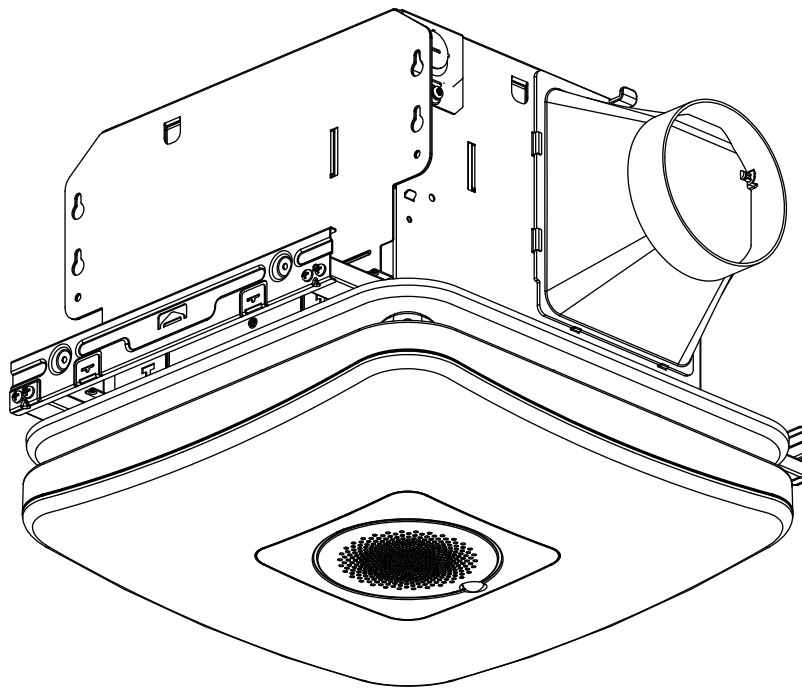

Questions, problems, missing parts? Before returning to the store,
call Commercial Electric Customer Service
8 a.m. - 7 p.m., EST, Monday-Friday, 9 a.m. - 6 p.m., EST, Saturday

1-800-986-3460

HOMEDEPOT.COM/Hubspace

THANK YOU

We appreciate the trust and confidence you have placed in Commercial Electric through the purchase of this ventilating bath fan. We strive to continually create quality products designed to enhance your home. Visit us online to see our full line of products available for your home improvement needs. Thank you for choosing Commercial Electric!

Table of Contents

Table of Contents	2	Tools Required	5
Safety Information	2	Package Contents	6
Product Specifications	4	Installation - New Construction with Flex Bracket	7
Typical Installation	4	Installation - New Construction without Flex Bracket	11
Wiring Diagram	4	Installation - Existing Construction	11
Warranty	5	Installation - Wall Switch	13
LIMITED LIFETIME WARRANTY	5	Operation	13
What is Covered	5	Care and Maintenance	14
Pre-installation	5	Troubleshooting	14
Planning Installation	5		

Safety Information

Please read, understand and save this entire manual before attempting to assemble, operate or install the product.

1. Always disconnect the power supply prior to servicing the fan, motor or junction box.
2. Follow all local building, safety and electrical codes as well as NEC (National Electrical Code) and OSHA (Occupational Safety and Health Act).
3. Electric Service supply must be 120 volts, 60 hertz.
4. This product must properly connect to the grounding conductor of the supply circuit.
5. Do not bend or kink the power wires.
6. Do not use this fan with any solid state control device, such as a remote control, dimmer switch, or certain timers. Mechanical timers are not solid state devices.
7. Do not install in a ceiling with insulation greater than R50.
8. Duct work should be installed in a straight line with minimal bends.
9. Duct work size must be the same size as the discharge and should not be reduced. Reducing the duct size may increase fan noise.
10. To ensure the performance, please use the recommended dimmers in the list if necessary.



WARNING: To reduce the risk of fire, electric shock, or injury to persons, observe the following:

1. Use this unit in the manner intended by the manufacturer. If you have any questions. Please call customer service.
2. Before servicing or cleaning unit, switch power off at service panel and lock the service disconnecting means to prevent power from being switched on accidentally. When the service disconnecting means cannot be locked, securely fasten a prominent warning device, such as a warning tag, to the service panel.
3. Installation work and electrical wiring must be done by qualified persons in accordance with all applicable codes and standards, including fire-rated construction.
4. Sufficient air is needed for proper combustion and exhausting of gases through the flue (chimney) of fuel burning equipment to prevent backdrafting. Follow the heating equipment manufacturer's guideline and safety standards such as those published by the National Fire Protection Association (NFPA), and the American Society for Heating, Refrigeration and Air Conditioning Engineers (ASHRAE) and local code authorities.
5. When cutting or drilling into the wall or ceiling, do not damage electrical wiring and other hidden utilities.
6. Ducted fans used to exhaust contaminants must always be vented to the outdoors.
7. If this unit is to be installed over a tub or shower, it must be marked as appropriate for the application and be connected to a GFCI (Ground Fault Circuit Interrupter) – protected branch circuit.
8. FOR USE IN ONE- AND TWO-FAMILY DWELLINGS ONLY.
9. TYPE IC-THERMALLY PROTECTED
10. FOR USE IN NON FIRE RATED INSTALLATIONS ONLY.
11. WHEN INSTALLED IN A GFCI PROTECTED BRANCH CIRCUIT, SUITABLE FOR INDOOR WET LOCATIONS, ACCEPTABLE FOR USE OVER A BATHTUB OR SHOWER
12. To reduce risk of fire and to properly exhaust air, be sure to duct air outside – Do not vent exhaust air into spaces within walls or ceilings or into attics, crawl spaces, or garages.
13. To Reduce The Risk Of Fire, Electric Shock Or Injury To Persons, Do Not Use Replacement Parts That Have Not Been Recommended By The Manufacturer (e.g. Parts Made At Home Using A 3D Printer).

Safety Information



CAUTION: For general ventilating use only. Do not use to exhaust hazardous or explosive materials and vapors.



CAUTION: Not for use in kitchens.



CAUTION: To reduce the risk of injury to persons, install the fan at least 7 feet (2.1 m) above the floor.

FCC Warning

Changes or modifications to this unit not expressly approved by the party responsible for compliance could void the user's authority to operate the equipment.

NOTE: This equipment has been tested and found to comply with the limits for a Class B digital device, pursuant to Part 15 of the FCC Rules. These limits are designed to provide reasonable protection against harmful interference in a residential installation. This equipment generates uses and can radiate radio frequency energy and, if not installed and used in accordance with the instructions, may cause harmful interference to radio communications.

However, there is no guarantee that interference will not occur in a particular installation. If this equipment does cause harmful interference to radio or television reception, which can be determined by turning the equipment off and on, the user is encouraged to try to correct the interference by one or more of the following measures:

Reorient or relocate the receiving antenna.

Increase the separation between the equipment and receiver.

Connect the equipment into an outlet on a circuit different from that to which the receiver is connected.

Consult the dealer or an experienced radio/TV technician for help.

This equipment complies with FCC radiation exposure limits set forth for an uncontrolled environment. This equipment should be installed and operated with a minimum distance of 20cm between the radiator & your body. This transmitter must not be co-located or operating in conjunction with any other antenna or transmitter.

Unique Identifier (Model name) : BF1112,BF1112WS

FCC compliance information is listed as below:

Responsible party: Leedarson America, Inc.

Responsible party address: 300 Technology Court SE Suite 100, Smyrna, GA 30082

Telephone number: (678) 293-8382

Wireless Protocol

The Wi-Fi CERTIFIED™ Logo is a certification mark of Wi-Fi Alliance®. Apple and the Apple logos are trademarks of Apple, Inc., registered in the U.S., and other countries. App Store is a service mark of Apple Inc. Google and Google Play are trademarks of Google LLC.



Bluetooth®

This device complies with Part 15 of the FCC Rules. Operation is subject to the following two conditions: (1) this device may not cause harmful interference, and (2) this device must accept any interference received, including interference that may cause undesired operation.

This device contains licence-exempt transmitter(s)/receiver(s) that comply with Innovation, Science and Economic Development Canada's licence-exempt RSS(s). Operation is subject to the following two conditions:

(1) This device may not cause interference.

(2) This device must accept any interference, including interference that may cause undesired operation of the device.

L'émetteur/récepteur exempt de licence contenu dans le présent appareil est conforme aux CNR d'Innovation, Sciences et Développement économique Canada applicables aux appareils radio exempts de licence. L'exploitation est autorisée aux deux conditions suivantes :

1) L'appareil ne doit pas produire de brouillage;

2) L'appareil doit accepter tout brouillage radioélectrique subi, même si le brouillage est susceptible d'en compromettre le fonctionnement.

This equipment complies with IC RSS-102 radiation exposure limits set forth for an uncontrolled environment. This equipment should be installed and operated with a minimum distance of 20cm between the radiator and any part of your body.

Pour se conformer aux exigences de conformité CNR 102 RF exposition, une distance de séparation d'au moins 20 cm doit être maintenue entre l'antenne de cet appareil et toutes les personnes.

Product Specification

SPECIFICATIONS

Model NO.	Airflow	Main Light	Night Light	Voltage	Duct Diameter	Sound Output	Power consumption		Weight	Ceiling Opening Dimension Requirements
							Fan	Light		
BF1112	80/110 CFM	1500ml	2200K	AC 120 V 60 Hz	4in	0.8/1.0 Sones	30W	23W	14.11lbs	10.24in x 9.37in

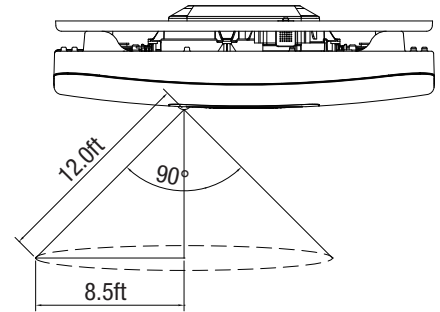

Typical Installation

The ducting from this fan to the outside of the building has a strong effect on the air flow, noise and energy use of the fan. Use the shortest, straightest duct routing possible for best performance, and avoid installing the fan with smaller ducts than recommended. Insulation around the ducts can reduce energy loss and inhibit mold growth. Fans installed with existing ducts may not achieve their rated air flow.



NOTE: When installing ventilation ducts and air vents, ensure that the air vents are not directly exposed to rain, and install appropriate protective measures around the air vents, such as rain cover or waterproof cover, to reduce the possibility of rainwater directly entering the ventilation ducts.

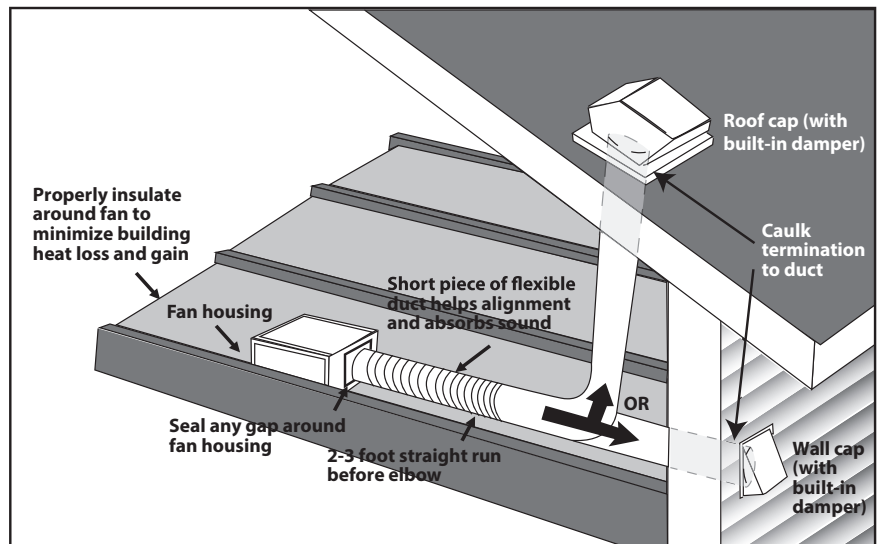

Wiring Diagram

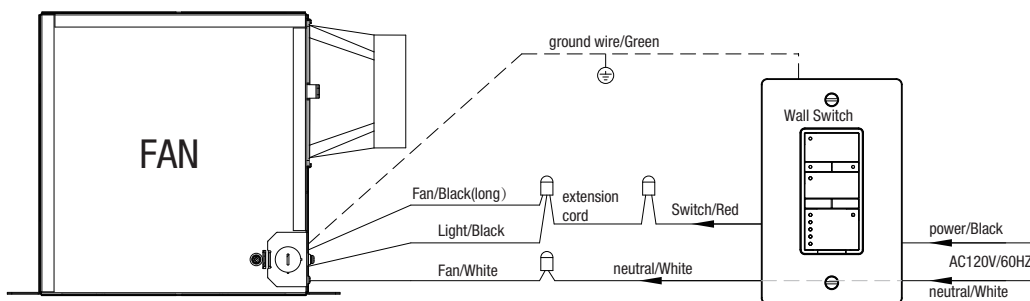

WARNING: Wiring must comply with all applicable electrical codes. Turn OFF power before removing or installing connectors



WARNING: COPPER TO COPPER ONLY. Do not use Aluminum wire.

Warranty

LIMITED LIFETIME WARRANTY

WHAT IS COVERED

The supplier warrants the sensor part to be free from defects in workmanship and material present at time of shipment from the factory for a period of three years after the date of purchase by the original purchaser. The supplier also warrants that all other fan parts, to be free from defects in workmanship and material at the time of shipment from the factory for a period of six years after the date of purchase by the original purchaser. This warranty does not cover products that have been abused, altered, damaged, misused, cut or worn. This warranty does not cover use in commercial applications. Use only manufacturer-supplied genuine warranty repair replacement parts to repair this fan. Use of non-genuine repair parts will void your warranty. The manufacturer DISCLAIMS all other implied or express warranties including all warranties of merchantability and/or fitness for a particular purpose. As some states do not allow exclusions or limitations on an implied warranty, the above exclusions and limitations may not apply. This warranty gives you specific legal rights, and you may have other rights that vary from state to state.

This warranty is limited to the replacement of defective parts only. Labor charges and/or damage incurred during installation, repair, replacement as well as incidental and consequential damages connected with the above are excluded. Any damage to this product as a result of neglect, misuse, accident, improper installation or use other than the purpose SHALL VOID THIS WARRANTY. Shipping costs for return product as part of a claim on the warranty must be paid for by the customer.

Contact the Customer Service Team at 1-800-986-3460 or visit www.HOMEDEPOT.COM/Hubspace.

Pre-installation

PLANNING INSTALLATION

Before beginning assembly of the product, make sure all parts are present. Compare parts with the package contents list and hardware contents. If any part is missing or damaged, do not attempt to assemble the product.



WARNING: Turn off electricity at breaker box before beginning installation.

Carefully remove the unit from the carton.

Check area above installation location to be sure that wiring can run to the planned location and that duct work can be run and the area is sufficient for proper ventilation.

Inspect duct work and wiring before proceeding with installation.

Before installation, provide inspection and future maintenance access at a location that will not interfere with installation work.

Pre-installation (continued)



NOTE: Installation may vary depending on how the previous bath fan was installed. Supplies necessary for the installation of your bath fan are not all included. However, most are available at your local home improvement or hardware store.

TOOLS REQUIRED (not included)

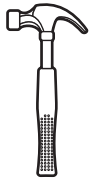

Claw hammer

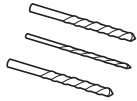

Drill bits

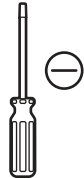

Flathead screwdriver



Duct tape



Pliers

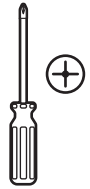

Phillips head screwdriver



Utility knife



Electric drill



Goggles



Gloves

PACKAGE CONTENTS

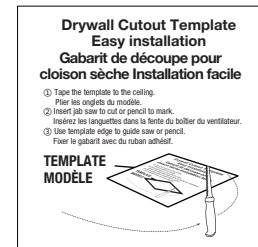
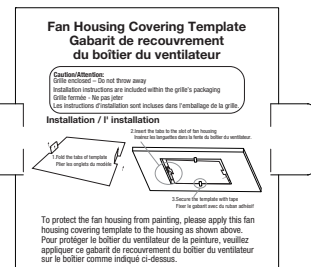
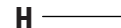
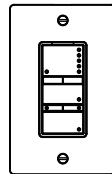
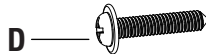
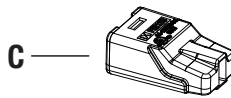
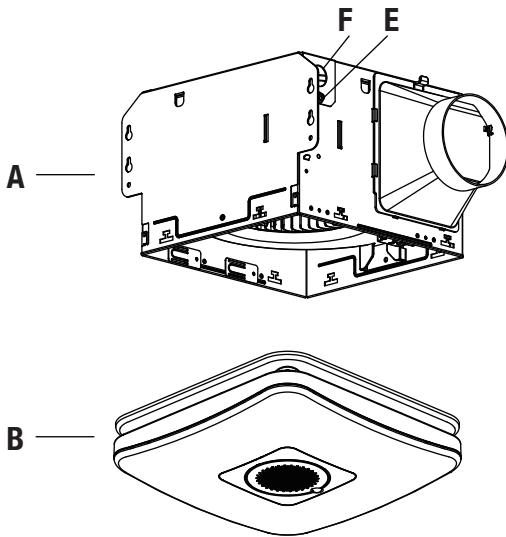

Part	Description	Quantity
A	Fan housing	1
B	Grille with light	1
C	Quick connector	7
D	Joist screw(ST4 X 20)	5
E	Short screw	1
F	Wire cover	1
G	Flex bracket	1
H	Cut-hole template	1
I	Drywall cover board	1
J	Wall Switch(BF1112WS)	1

Installation - New Construction with Flex Bracket



CAUTION: □ Make sure power is switched off at service panel before starting installation.
□ Wear gloves during installing to help protect your hands from injury.



NOTE: Ceiling mount only.

IMPORTANT:

Please remove the tape, which protects the damper during shipping and installation, from the duct adaptor as shown below.

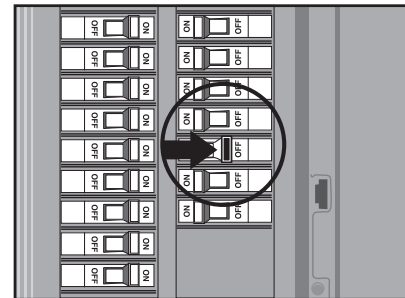
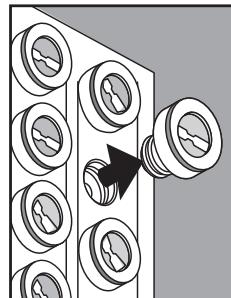
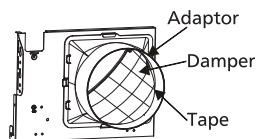

1 Install the flex bracket

- Bend down 6 tabs on the side of flex bracket (G) for positioning, lift flex bracket lean against the joist and the left and right side tabs close to the bottom of flex joist, and then insert the middle tab into joist, pre-install the flex bracket to joists by using 2 screws (D) on one side.
- Adjust the length of flex bracket (G) to fit the spacing between the joists (11.5in. to 22in.). Attach the flex bracket with the other 2 screws (D).
- Please make sure the bottom of the flex bracket will be flush with the bottom of the joists.

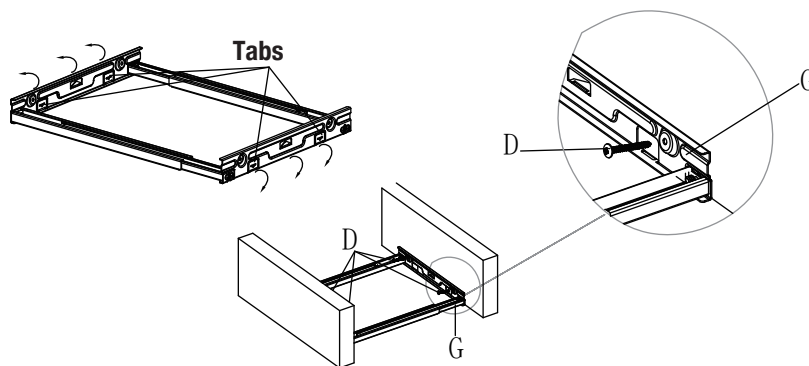

2 Adjust the tabs of fan housing

- Pull the 4 tabs (AA) of the fan housing into the vertical position.

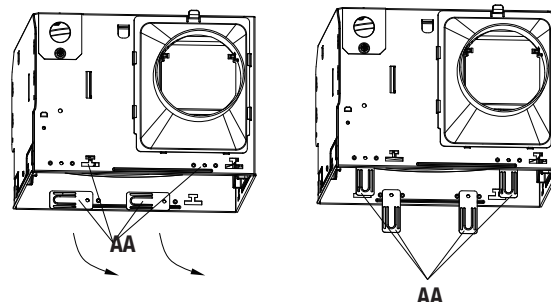

3 Install the fan housing on bracket

- Align the 4 tabs (AA) on the fan housing through the slots on the flex bracket (G). Then insert the tabs through the slots until the fan housing (A) sitting on the flex bracket (G).
- Then bend the tabs (AA) to both sides to attach the fan housing firmly on the flex bracket (G).

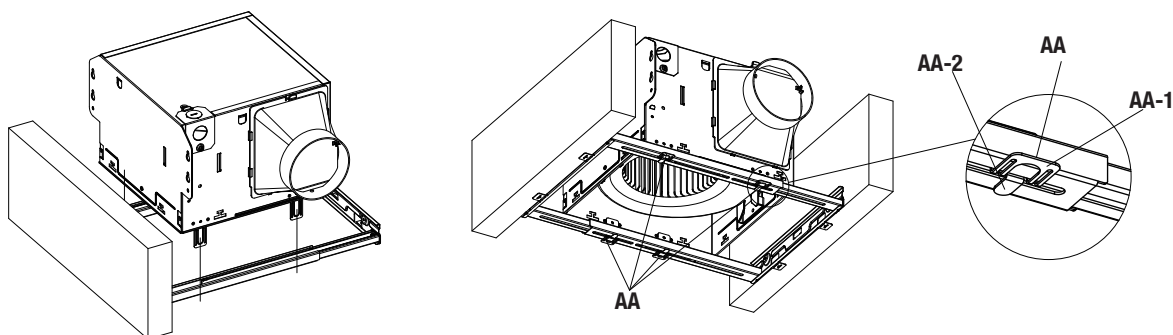

Installation - New Construction with Flex Bracket (continued)

4 Connect the wire

- Loosen the short screw (E) and remove the wire cover (F).
- Pull the house wires through the knockout of wire cover (F). Using the quick connectors to connect 120 V AC house wiring from the wall switch to the fan as shown in the wiring diagram on page 3.
- Carefully push the connected wires back into the wiring compartment of the fan housing (A). Reattach the wire cover (F) and attach it firmly with the short screw (E).



NOTE: Attach the 1/2" ROMEX connector or 1/2 "Flexible Metal Conduit connector (supplied by others) to wiring compartment cover and lock in place with 1/2 lock nut included with connector.



CAUTION: If the electrical wires do not match the colors listed, you must determine what each house wire represents before connecting. You may need to consult an electrical contractor to determine safely.

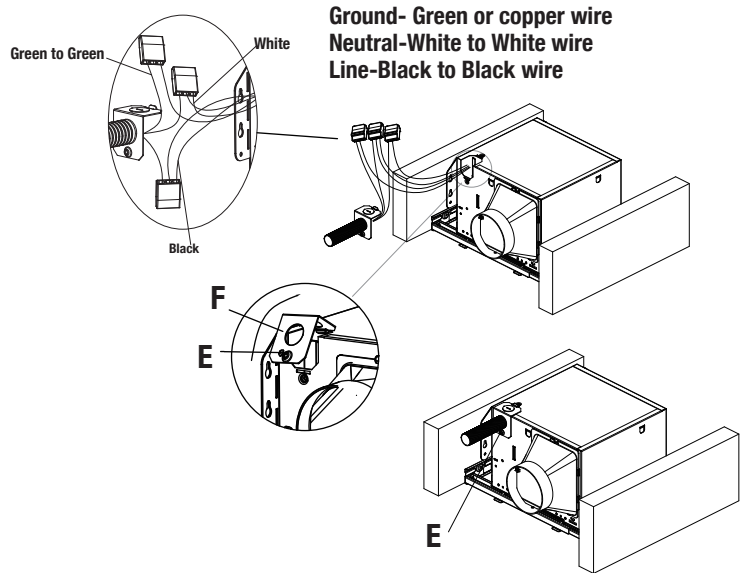

5 Connect the duct

- Connect a 4 in. circular duct (not supplied) and vent to the duct connector. Secure it with duct tape (not supplied) or a clamp (not supplied) to make the connection secure and air tight.
- Turn on the power source. Check the fan for any abnormal sound or vibration.



CAUTION: After checking the fan, please remember to turn off the power before next installation step.

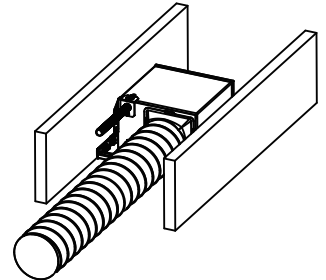

6 Finish the ceiling work

- After electrical and construction inspection is completed, the dry wall ceiling can be installed.
- Cut the ceiling hole with the cut-hole template (H) or the size 10.24*9.37inch (260*238 mm). Ceiling hole should be aligned with the inside edge of fan housing.
- Important: Cover and seal up all gaps with duct tape



NOTE: That it is common practice in heating and ventilation systems using sheet metal ductwork and fittings or flexible duct work tubing to use duct tape or aluminum tape to ensure air tight seals and improve efficiency.

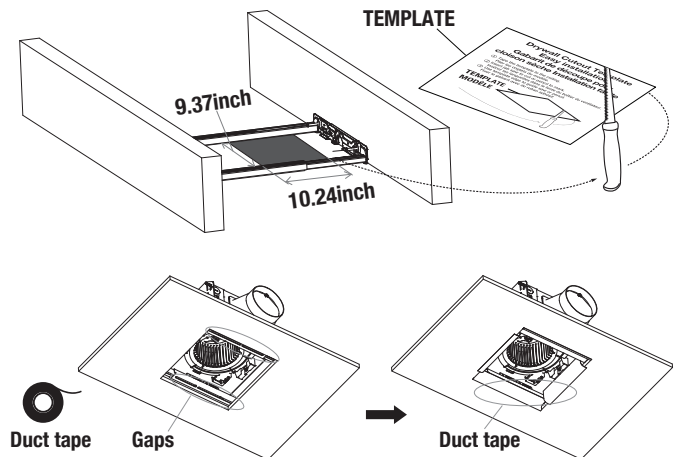

7 Select the airflow

- Select desired airflow (80CFM or 110CFM) by sliding the toggle switch on the bottom of the housing (A).

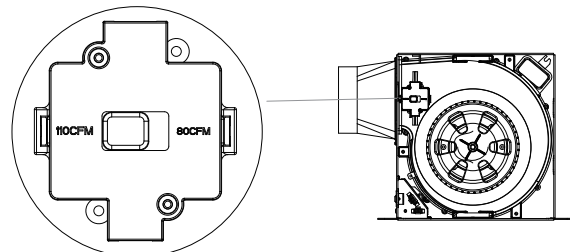

Installation - New Construction with Flex Bracket (continued)

8 Install the grille with light

- Attach the grille by squeezing one spring together and inserting the springs into the spring guides in the fan housing (A) firstly.
- Connect LED wire to fan housing by terminal.
- Then insert another spring and push the grille (B) up against the ceiling.
- Check that the installation is secure and safe from falling objects.

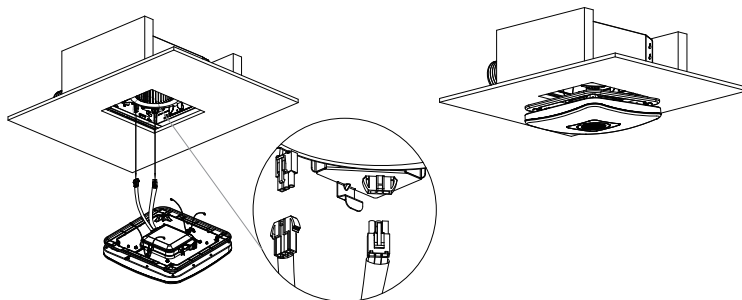

Installation - New Construction without Flex Bracket



CAUTION: ▫ Make sure power is switched off at service panel before starting installation.
▫ Wear gloves during installing to help protect your hands from injury.



NOTE: Ceiling mount only.

IMPORTANT:

Please remove the tape, which protects the damper during shipping and installation, from the duct adaptor as shown below.

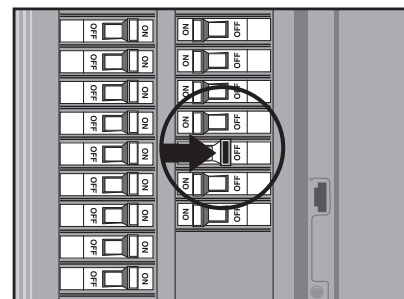
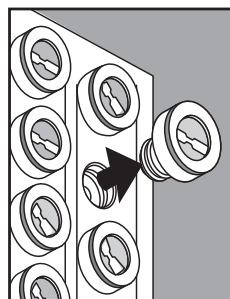
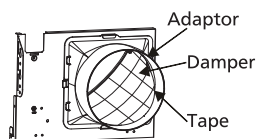

1 Remove the duct connector and wire cover

- To remove duct connector, pull up on the finger latch, then slide the duct connector until it is removed from the fan housing (A).
- Loosen the short screw (E) and remove the wire cover (F).

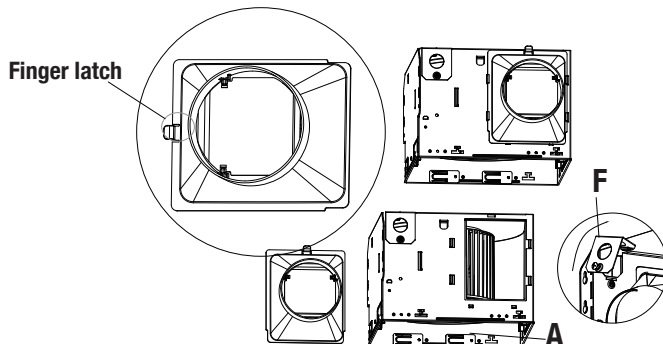

2 Mount the housing to the joist

- Bend down 2 tabs on the side of flex bracket (G) for positioning
- Place the fan housing next to a ceiling joist or wall stud. The fan housing should be level and perpendicular to the joist or stud.
- Secure fan housing (A) through mounting keyholes on bracket with with 4 screws (D). Make sure bottom of fan housing will be flush with finished ceiling.

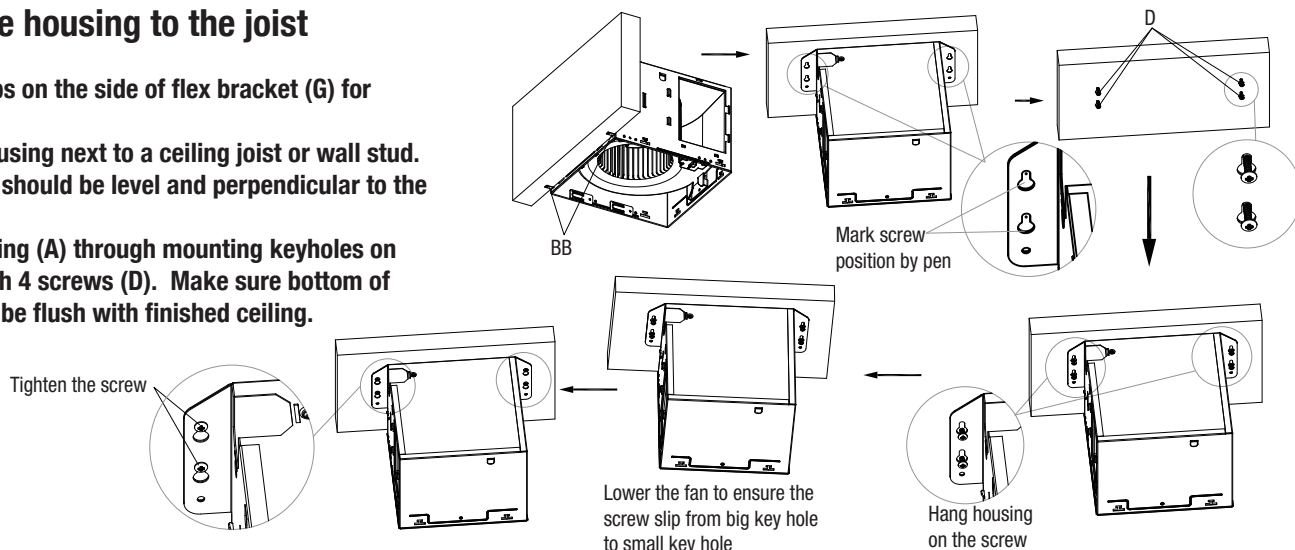

Installation - New Construction without Flex Bracket (continued)

3 Connect the wire

- Pull the house wires through the knockout of wire cover (F). Using the quick connectors to connect 120 V AC house wiring from the wall switch to the fan as shown in the wiring diagram on page 3.
- Carefully push the connected wires back into the wiring compartment of the fan housing (A). Reattach the wire cover (F) and attach it firmly with short screw (E).



NOTE: Attach the 1/2" ROMEX connector or 1/2" Flexible Metal Conduit connector (supplied by others) to wiring compartment cover and lock in place with 1/2 lock nut included with connector.

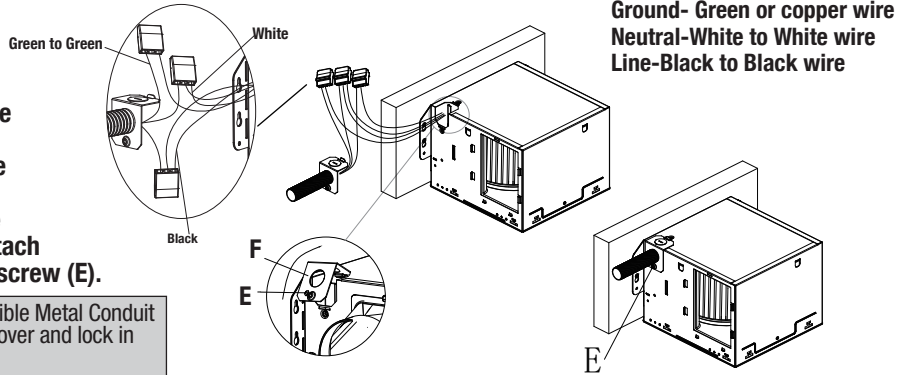

4 Connect the duct

- Connect a 4 in. circular duct (not supplied) and vent to the duct connector. Secure it with duct tape (not supplied) or a clamp (not supplied) to make the connection secure and air tight.
- Insert the duct connector back to the fan housing (A) follow the guide slot from left to right. And it will be in place with a "click" sound. Please secure it tightly.



NOTE: If you have to connect to 4in. circular duct, please use a 6in. to 4in. duct adapter (not supplied).

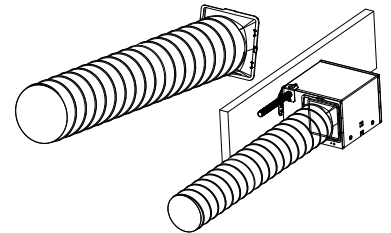

5 Select the airflow

- Select desired airflow (80CFM or 110CFM) by sliding the toggle switch on the bottom of the housing (A).

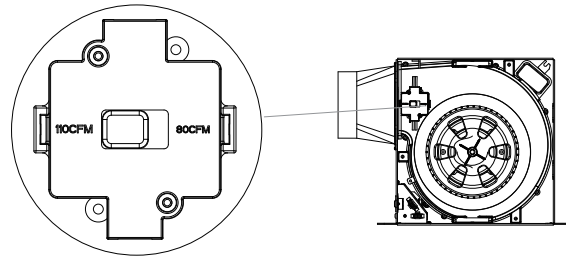

6 Finish the ceiling work

- After electrical and construction inspection is completed, the dry wall ceiling can be installed.
- Cut the ceiling hole with the cut-hole template (H) or the size 10.24*9.37inch (260*238 mm). Ceiling hole should be aligned with the inside edge of fan housing.
- Important: Cover and seal up all gaps with duct tape



NOTE: MAKE SURE ONE EDGE OF THE OPENING IS FLUSH WITH THE JOIST FOR INSTALLATION.



NOTE: That it is common practice in heating and ventilation systems using sheet metal ductwork and fittings or flexible duct work tubing to use duct tape or aluminum tape to ensure air tight seals and improve efficiency.

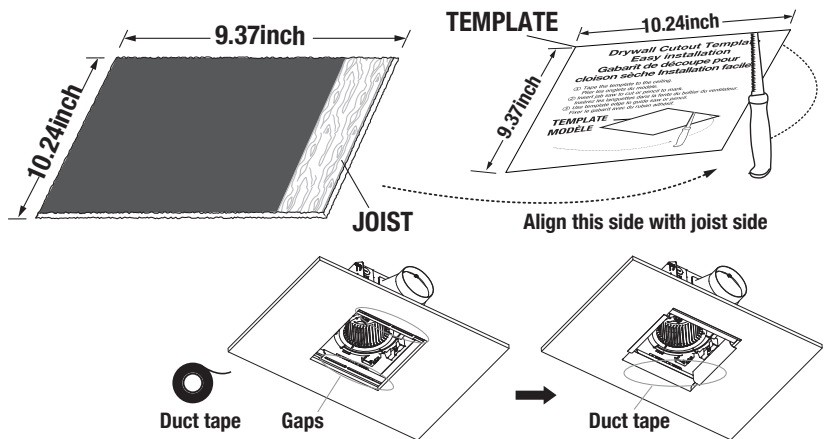

7 Install the grille with light

- Attach the grille by squeezing one spring together and inserting the springs into the spring guides in the fan housing (A) firstly.
- Connect LED wire to fan housing by terminal.
- Then insert another spring and push the grille (B) up against the ceiling.
- Check that the installation is secure and safe from falling objects.

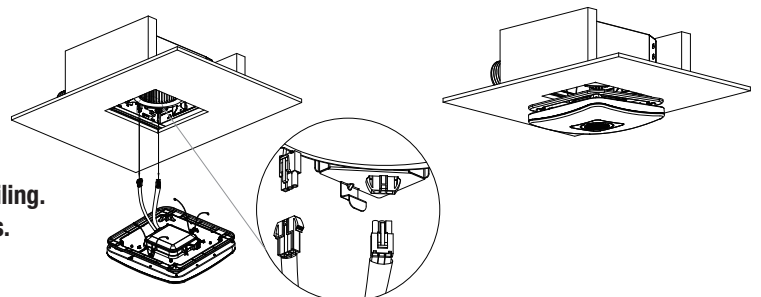

Installation - Existing Construction

1 Remove the existing fan



CAUTION: □ Make sure power is switched off at service panel before starting installation.
□ Wear gloves during installing to help protect your hands from injury.

- Remove the old fan from the ceiling.

IMPORTANT:

Please remove the tape, which protects the damper during shipping and installation, from the duct adaptor as shown below.

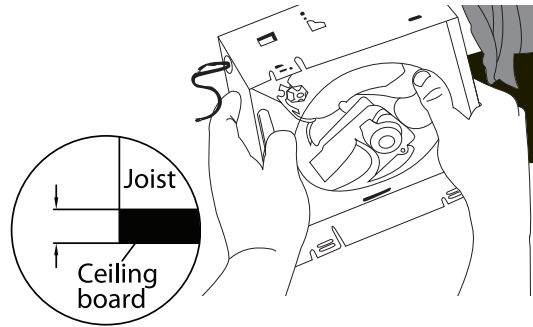
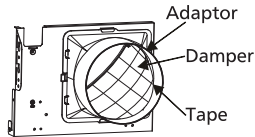

2 Ceiling cut out work

- Measure the opening to ensure it is large enough to accommodate the new fan body (A) (10.24 in. x 9.37 in.).
- If this fan is not replacing an old fan, be sure to cut a 10.24 in. x 9.37 in. opening for the fan body (A).



NOTE: □ Wear safety goggles to prevent getting dust, falling insulation or other debris into your eyes, nose and mouth.
□ Carefully cut open the ceiling hole with out cutting into electrical or gas or water lines that may not be visible.

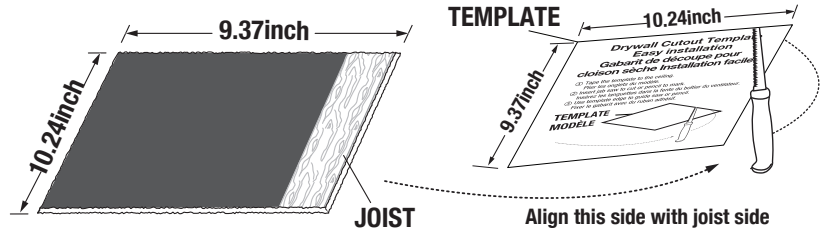

3 Remove the duct connector and wire cover

- To remove duct connector, pull up on the finger latch, then slide the duct connector until it is removed from the fan housing (A).
- Loosen the short screw (E) and remove the wire cover (F).

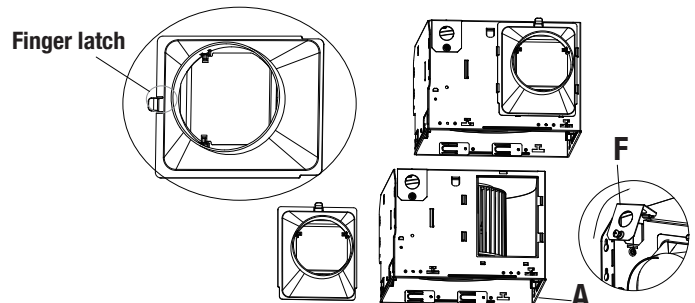

4 Place the fan housing

- Place the fan housing (A) inside the ceiling through the hole. And then place on the side. Shown as in picture.

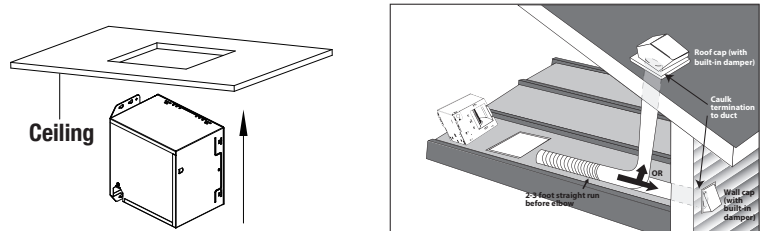

5 Connect the wire

- Pull the house wires through the knockout of wire cover (F). 5 Using the quick connectors to connect 120 V AC house wiring from the wall switch to the fan as shown in the wiring diagram on page 3.
- Carefully push the connected wires back into the wiring fan housing (A). Reattach the wire cover (F) attach it firmly with the short screw (E).

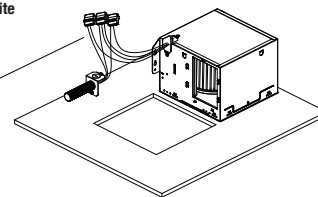
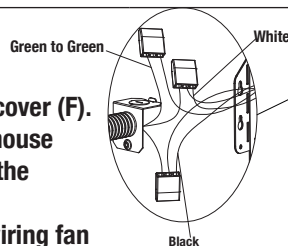

Ground- Green or copper wire
Neutral- White to White wire
Line- Black to Black wire

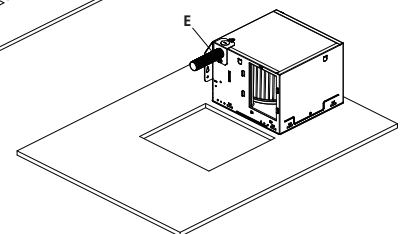

NOTE: Attach the 1/2" ROMEX connector or 1/2 "Flexible Metal Conduit connector (supplied by others) to wiring compartment cover and lock in place with 1/2 lock nut included with connector.

Installation - Existing Construction(continued)

6 Connect the duct

- Connect a 4 in. circular duct (not supplied) and vent to the duct connector. Secure it with duct tape (not supplied) or a clamp (not supplied) to make the connection secure and air tight.
- Insert the duct connector back to the fan housing (A) follow the guide slot from left to right. And it will be in place with a “click” sound. Please secure it tightly.

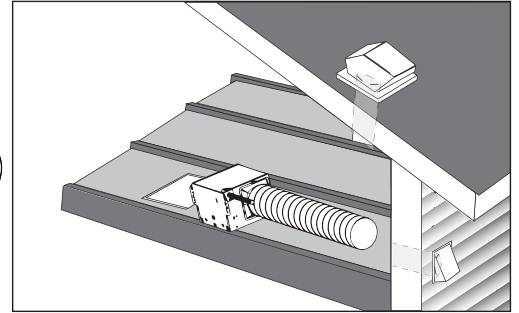
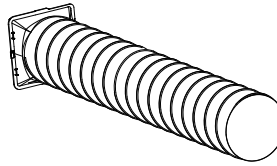

NOTE: If you have to connect to 4in. circular duct, please use a 6in. to 4in. duct adapter (not supplied).

7 Install the flex bracket

- Put the flex bracket (G) inside the ceiling through hole.
- Fix the flex bracket (G) onto the joists with 4 screws (D). The flex bracket is adjustable to fit different space (12~22inches) between the joists.
- Please make sure the bottom of the flex bracket will be flush with the bottom of the joists.

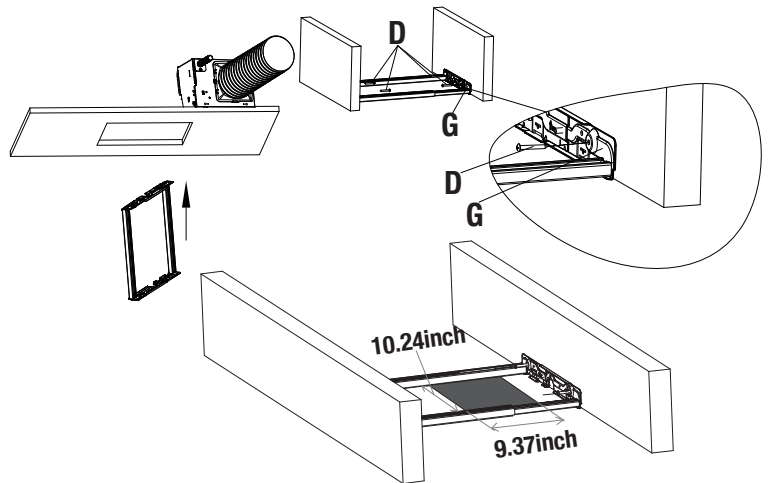

8 Adjust the inserts of fan housing

- Pull the 4 tabs (AA) of the fan housing into the vertical position.

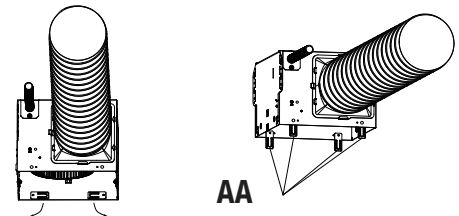

9 Install the fan housing on bracket

- Align the 4 tabs (AA) on the fan housing through the slots on the flex bracket (G). Then insert the tabs through the slots until the fan housing (A) sitting on the flex bracket (G).
- Then bend the tabs (AA) to both sides to attach the fan housing firmly on the flex bracket (G).
- Important: Cover and seal up all gaps with duct tape

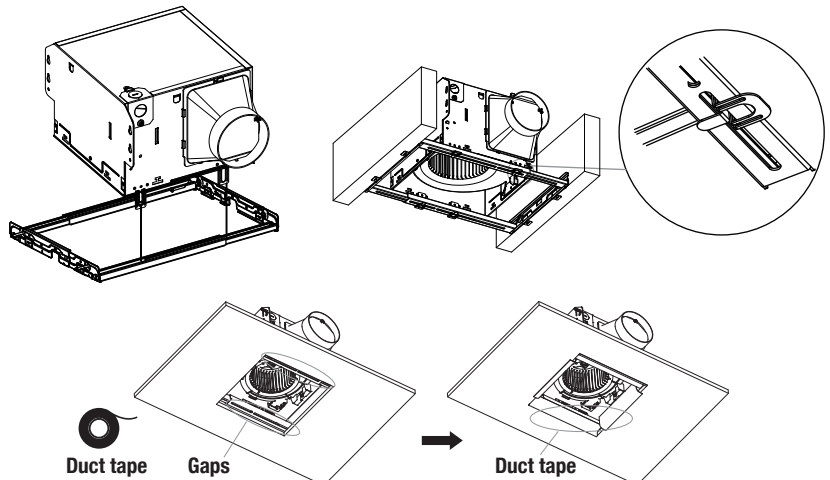

NOTE: That it is common practice in heating and ventilation systems using sheet metal ductwork and fittings or flexible duct work tubing to use duct tape or aluminum tape to ensure air tight seals and improve efficiency.

Installation - Existing Construction(continued)

10 Select the airflow

- Select desired airflow (80CFM or 110CFM) by sliding the toggle switch on the bottom of the housing (A).

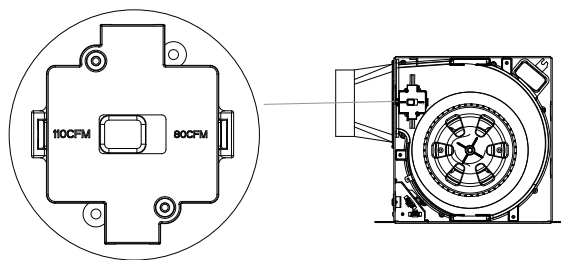

11 Install the grille with light

- Attach the grille by squeezing one spring together and inserting the springs into the spring guides in the fan housing (A) firstly.
- Connect LED wire to fan housing by terminal.
- Then insert another spring and push the grille (B) up against the ceiling.
- Check that the installation is secure and safe from falling objects.

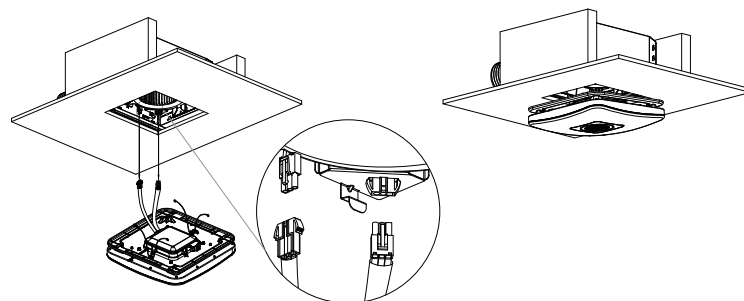

Installation - Wall Switch

1 Turn off the power

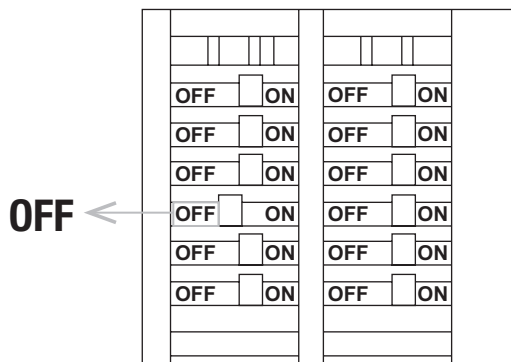

3 Connect the new switch wires as follows.

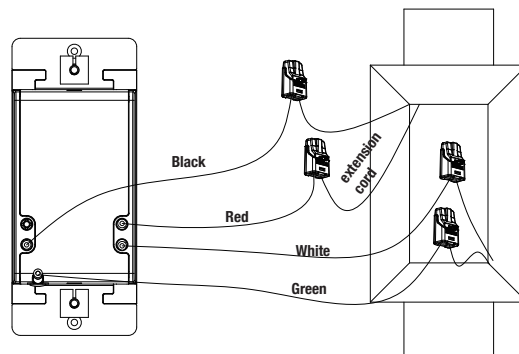

 **NOTE:**Please skip this step if use the existing switch.

2 Remove the existing switch by disconnecting all wires.

4 Mount the switch with the screws and attach Wall Plate(J).

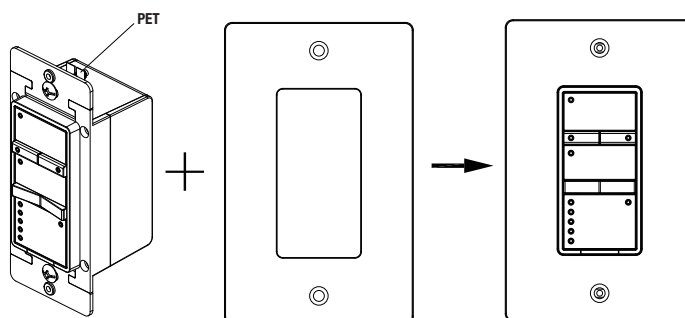

In-wall switch Operation

ALL ON/OFF

- Press once: turn Fan and Light On or OFF together
- Press & hold for 3s: pair the switch & bath fan
- Press 5 times: get into Hubspace setup mode

Motion Sensing

- Press once: turn motion detection ON/OFF
- Default: On

Brightness Decrease & Color Changing

- Press once: dim the light
- Press and hold - cycle RGB color and then release - select desired color
- ✓ Under night light status, press this button to switch to main light

Brightness Indicator lights

- 20%-40%-60%-80%-100%

Air Gap Switch

- Pull to cut power

Humidity Sensing

- Press once: turn humidity detection ON/OFF
- Default: On

Fan On/OFF

- Press once: turn Fan ON/OFF
- Press & hold for 3s: turn ON/OFF BT Speaker

Brightness Increase & CCT changing

- Press once: brighten the light
- Press and hold - cycle CCT and then release - select desired brightness
- ✓ Under night light status, press this button to switch to main light

Light On/OFF

- Press once: turn Light ON/OFF
- Press & hold for 3s: switch to Night Light
- ✓ Light remain previous setting while light on again

ALL ON/OFF

- Default: LED OFF, blinks once when actions occur
- Blinks slowly when in Pairing & Setup Mode

Motion Sensing

- Default: LED ON, blinks once when motion is detected

Fan On/OFF

- Default: LED OFF, blinks once when actions occur
- Blinks slowly when in BT pairing Mode

Brightness Indicator lights

- Default: ON

Humidity Sensing

- Default: LED ON, blinks when humidity triggered

Light On/OFF

- Default: LED OFF, blinks once when actions occur

Smart Setup Operation

1 Download the Hubspace™ app from the App Store or the Google Play Store.



For more information on the Hubspace app, visit hubspace.com/Hubspace.

2 Create an account to sign in or log in if you already have an account.

3 Connect your bath fan to power and follow the instructions on the app screen.



NOTE:

- This Hubspace device requires a 2.4GHz Wi-Fi channel. Hubspace only shows Wi-Fi networks that your device can use.
- If you do not see your Wi-Fi network name when you attempt to connect your devices, please check your router settings or move your product closer to your Wi-Fi router.

4 Tap the '+' button in the upper right corner to add your bath fan.

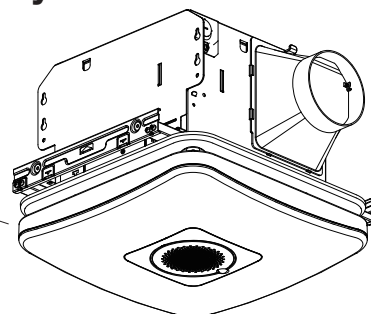

NOTE: Bluetooth access is required for device setup.

5 Scan the QR Code

- In the Hubspace app, tap the plus sign in the upper right corner.
- Scan your product's QR code. You can find the QR code on the bottom of grille and on the Quick Start Guide paper included with the fan.

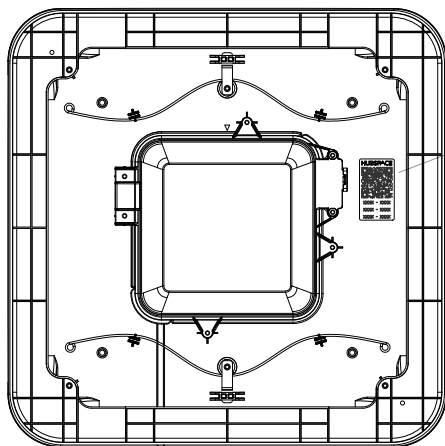

NOTE: If the QR code cannot be scanned, you can enter the code manually. Tap Enter Code and follow the instructions.

6 Using Your Smart Bath Fan

- Turn your smart Bath fan on or off from the Home page on the Hubspace app.
- To set a schedule or timer, tap the name of the smart Bath fan on the Home page. You will see options for setting Schedules and Auto-Off Timers.

7 Set up your Voice Assistant

- You can connect your smart Bath fan to Google Home and Alexa from the Hubspace app. Or, you can sign in to Alexa app or Google Home and connect to your Hubspace devices from there.

Care and Maintenance



WARNING: Disconnect power supply before servicing.

- See **SAFETY INFORMATION** before proceeding. Routine maintenance should be done at least once a year.
- Never use solvents, thinner or harsh chemicals for cleaning the fan.
- Do not allow water to enter the motor.
- Do not immerse metal parts in water.

Troubleshooting

Problem	Possible Cause	Solution
The fan seems louder than it should.	The CFM is too great.	Be sure the CFM rating on the fan matches the square footage of your room.
	The damper is damaged or not working properly.	Check the damper to ensure it is opening and closing properly. If the damper has become damaged, please call Customer Service.
	The bend in the duct is too close to the fan discharge.	Be sure you do not have any sharp bends in the duct closer than 18 in. to the fan discharge.
	The fan discharge is reduced to fit a smaller duct.	Use the recommended size ducting to reduce fan noise.
	The fan body is not attached securely.	Be sure the fan is securely attached to the ceiling joists.
The fan is not clearing the room.	There is insufficient airflow intake in the room.	Be sure a door or window is slightly ajar or opened to allow airflow. The fan is not able to draw air out of the room without enough airflow to draw from.
	There is insufficient CFM.	Be sure the CFM rating on the fan matches the requirements for your room size.
		 NOTE: Using a tissue is not the correct method for determining if the fan is operating properly. If the fan clears steam from the room within approximately 15 minutes of completing your shower, then the fan is operating properly.
	The gap between the Housing and the ceiling is not sealed.	Please seal the gap with tape to prevent air leakage.
	The finger latch is not open.	Remove the tape on the finger latch and check whether the finger latch can open and close normally. If not, contact customer service.
Abnormal sound	Foreign objects hit the wind wheel.	Tap the grill to remove the foreign object.
	The finger latch falls off.	Check the duct connector and re-fasten it.
	The duct connector and duct are not sealed.	Please seal the duct connector and duct with tape.

Troubleshooting

Problem	Solution
My Hubspace device is not connecting to Wi-Fi.	Make sure your device is connected to a power source. Your Internet connection or Wi-Fi network may be down.
My device cannot find any Wi-Fi networks.	Make sure you have a 2.4GHz capable Wi-Fi network within range of the device you are trying to add.
My device is in a location that does not have Wi-Fi. Can I still use it with the Hubspace app?	Yes. Use the app on a phone with an Internet connection like LTE. The phone must be within Bluetooth range of your Hubspace device and have Bluetooth enabled.
I cannot find the QR code.	It is on the ceiling fan housing. A copy of the QR code is also included in your device's documentation.
The QR code has become damaged. How do I add the device?	Under the QR code are numbers. You can enter those in manually instead of scanning the code.
I lost my QR code. How do I add a device?	<ol style="list-style-type: none">1. Make sure the device is connected to power.2. In the Hubspace app, tap +, then Add Device.3. On the Scan Device screen, tap the Search button in the lower right corner.4. Follow the onscreen instructions.
The device is on another account. How do I transfer it?	Scan the QR code and it will transfer to your account.
My device is offline for long periods of time.	Make sure your Wi-Fi signal strength is sufficient. You may need to move your router, use mesh Wi-Fi, or Wi-Fi extenders.
The device is on and I scanned the QR code, but the app cannot connect to it.	Turn off Bluetooth on your phone and turn it back on. Then, scan the QR code. If the problem persists, turn your phone off and on, then try again.
Can I scan the same QR code to add multiple products?	No. Each product has a unique QR code.



**Questions, problems, missing parts? Before returning to the store,
call Commercial Electric Customer Service
8 a.m. - 7 p.m., EST, Monday-Friday,
9 a.m. - 6 p.m., EST, Saturday**

1-800-986-3460

[HOMEDEPOT.COM/Hubspace](https://www.homedepot.com/Hubspace)

Retain this manual for future use.

FCC compliance information is listed as below:
Responsible party: Leedarsen America, Inc.
Responsible party address: 300 Technology
Court SE Suite 100, Smyrna, GA 30082
Telephone number: (678) 293-8382

4021V1.0