

Tremor Instruction
Prints 1 Color Process Black

Folded size: 65mm x 121mm
Extended size: 392mm x 121mm



MINI COOPER S

CAUTION - ELECTRIC TOY:

NOT RECOMMENDED FOR CHILDREN UNDER 6 YEARS OF AGE. AS WITH ALL ELECTRIC PRODUCTS, PRECAUTIONS SHOULD BE OBSERVED DURING HANDLING AND USE TO PREVENT ELECTRIC SHOCK.

CHARGER:
INPUT: AC 120V 60Hz 4.5W
OUTPUT: DC 6V 240mA
DC 7.5V 200mA
DC 9V 155mA

Fast Lane is a mark of Geoffrey, Inc.
©1999 Geoffrey, Inc.
Distributed by Toys"R"Us, Inc.,
Wayne, NJ 07470
Made in China
www.toysrus.com



ATTENTION PARENTS:
IT IS RECOMMENDED THAT THIS TOY AND ALL ACCESSORIES BE PERIODICALLY EXAMINED FOR POTENTIAL HAZARDS AND THAT ANY POTENTIALLY HAZARDOUS PARTS BE REPAIRED OR REPLACED.

OPERATING INSTRUCTIONS

BATTERY PACK CARE / CAUTIONS:

- Use only a fresh battery and battery pack of the required size and type.
- If you do not plan to use the vehicle for several days, remove the battery from the transmitter and the battery pack from the vehicle.
- Do not mix old and new batteries. Do not mix alkaline, standard (carbon zinc), or rechargeable (nickel-cadmium) or Ni-MH batteries.
- Never leave dead or weak batteries in the vehicle.
- Dispose of old batteries promptly and properly; do not bury or burn them.
- Do not charge non-rechargeable batteries.
- Insert batteries with the correct polarity.
- Do not short the supply terminals.
- Remove rechargeable batteries from the vehicle before being charged.
- Keep the package and owner's manual since it contains important information.

BATTERY INSTALLATION:

TRANSMITTER:

The transmitter requires one 9-volt battery (included). For the best performance and longest life, we recommend an alkaline battery. Follow these steps to install the battery in the transmitter:

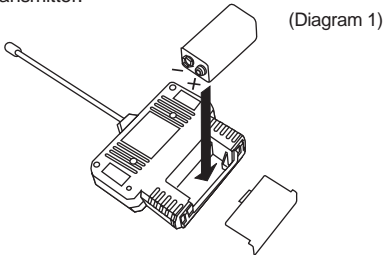

- Remove battery compartment cover by sliding it in the direction of the arrow shown on the compartment cover.
- Place battery in the compartment according to the polarity symbols (+ and -) marked inside. (See diagram 1)
- Replace the cover and snap it shut.

When the transmitter's range decreases, replace battery.

CAR:

Your vehicle requires a 6-volt rechargeable battery pack (included). **You must charge the battery pack with a battery charger before you can use it to power your vehicle.** To charge it, follow the battery charger instructions. Then follow these steps to put the battery pack in the vehicle:

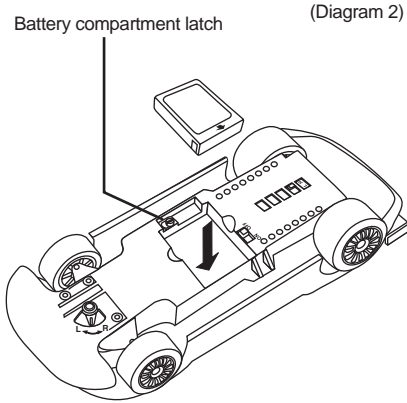

- Slide **ON/OFF** switch on the bottom of the vehicle to **OFF**.
- Insert battery pack into the battery compartment as shown. (See diagram 2)
- Push battery pack forward in direction of arrow engraved on battery pack.
- Use a coin to turn the battery compartment latch counterclockwise until it stops to lock the battery pack in position.

When the vehicle slows down, recharge the battery pack. When the battery pack will no longer hold a charge, replace it.

Note: To remove, use a coin to turn the battery compartment latch clockwise until it stops, slide the battery pack up and remove it from the battery compartment.

BATTERY CHARGER INSTRUCTIONS:

CHARGER MUST BE OPERATED BY ADULT ONLY.

- Plug charger into a standard household outlet (110/120 Volt).
- Join together the plug from the battery to the receptacle plug attached to the charger wires. Be sure to get a firm fit by having the ridge snap into place with the clip.
- Allow battery to charges for 5 hours for a complete and full charge. Additional charging will not improve your battery's output, and could eventual damage the battery. Do not charge a battery if you notice it leaking or see corrosion on any part of the battery.

- A characteristic of Ni-Cd batteries is a loss of power quickly. A spare battery is therefore recommended for longer play, and happier operates.
- If the battery is hot after operation please wait until it is cool before recharging. Attempting to recharge a battery in this condition can reduce the life of the battery and maybe cause damage later.
- The rechargeable battery must be charged with the recommended battery charger.
- The battery charger is not a toy.
- The battery charger is to be regularly examined for damage to the cord, plug enclosure and other parts, in the event of such damage; the rechargeable batteries must not be used with this battery charger until the damage has been repaired.
- Dispose of old batteries properly.

CHARGING THE 6V BATTERY PACK:

NOTE: THE RECHARGEABLE Ni-Cd BATTERY PACK IS NOT CHARGED, PLEASE CHARGE PRIOR USE

- Plug the wall pack battery charger into the wall outlet.
- Click the battery pack into the charger. Make sure the battery pack is secure in charger.
- After charging for 5 hours, the battery pack will be warm. This condition is normal for full-charged batteries.
- To disconnect cables, push the button of the charger (see Diagram 3) and simultaneously slide battery pack out.
- If the speed of the vehicle slows down suddenly, it is time to recharge.
- After use, the battery pack will be hot! Wait until it cools before recharge.
- Recharging a warm, or hot battery pack will greatly shorten the battery's life.
- Unplug the charger from the electrical outlet if it is not going to be used for a long period of time.

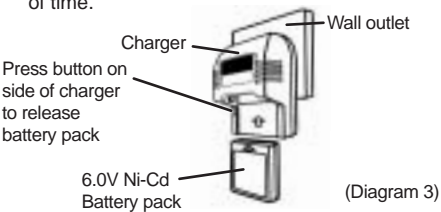

DRIVING THE CAR:

Warning: Never play with your vehicle in the street.

- Slide **ON/OFF** switch on the side of the vehicle to **ON**. (See diagram 4)

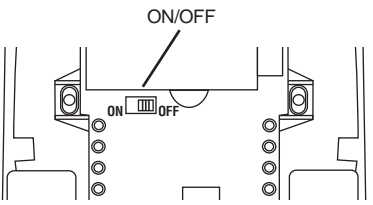

(Diagram 4)

- Use the transmitter's control levers as follows: (See diagram 5)

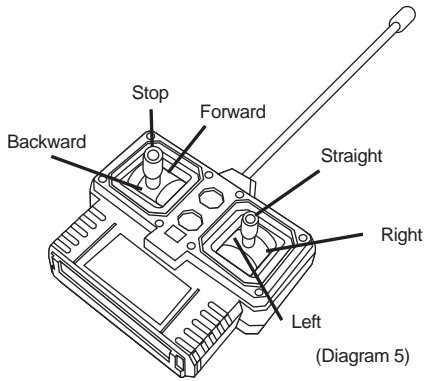
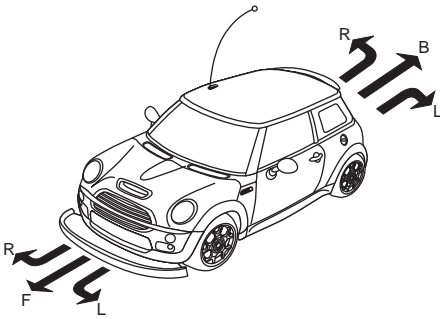

Left Control Lever:

- Push forward to move forward (**F**).
- Pull back to move backward (**B**).
- Release to stop.

Right Control Lever:

- Push left to move left (**L**).
- Push right to move right (**R**).
- Release to go straight.

Caution: If the vehicle gets stuck under an object, immediately release the control levers on the transmitter, then retrieve the vehicle.

- When you finish driving, slide the **ON/OFF** switch on the vehicle to **OFF**.

HOW TO OPERATE:

- If the vehicle does not go in a straight line when you release the right control lever, adjust the wheel alignment control on the bottom of the vehicle. Turn the wheel alignment control toward **L** if the vehicle is pulling to the right, or toward **R** if the vehicle is pulling to the left. (See diagram 6)

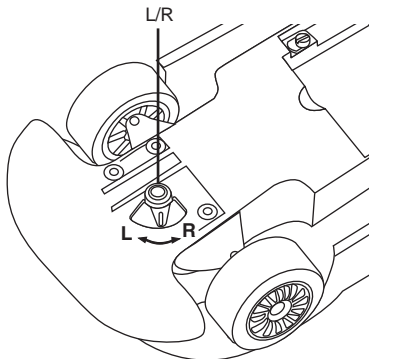

(Diagram 6)

- Slide **L/H** switch beneath the rear bumper to **H** for driving on a smooth surface or to **L** for a rough surface or climbing slopes. (See diagram 7)

Note: If you cannot easily slide the switch, slightly turn the vehicle's back wheels by hand. Then try again.

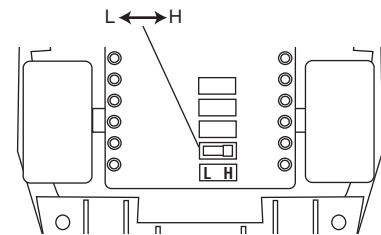

(Diagram 7)

HELPFUL HINTS:

The following hints can help you get the most enjoyment from your vehicle:

- Running your vehicle continuously for long periods generates high heat levels. Heat causes wear and tear on the motor. When your vehicle's battery dies, let the vehicle cool at least 10 minutes before installing a newly charged battery pack. This helps keep heat levels down.
- If the vehicle's motor runs but does not respond to the transmitter, move closer to the vehicle and try again.

- If someone uses a CB nearby, it might interfere with control of the vehicle. If this happens, move the vehicle and transmitter away from the CB.
- You cannot operate your vehicle near devices with transmitters that use the same frequency, (27 MHz or 49 MHz). Check the packaging to see which frequency your vehicle uses.
- If the vehicle moves slowly, and you have installed a recharged battery pack, check the wheel mechanisms for lint, thread, hair or dust.

CARE:

The following suggestions will help you care for your vehicle so you can enjoy it for years:

- Never drive the vehicle on a wet floor, on sand, or in mud, rain, or snow. These can damage it.
- Do not expose the vehicle to extreme temperatures.
- To protect the vehicle's wheel mechanisms from lint and hair, do not drive it on carpet.
- Occasionally wipe the vehicle with a damp cloth to keep it looking new. Do not use harsh chemicals to clean the vehicle.

Modifying or tampering with the vehicle or the transmitter's internal components can cause a malfunction and void your FCC authorization to operate them.

THE FCC WANTS YOU TO KNOW:

Your vehicle or transmitter might cause TV or radio interference even when it is operating properly. To determine whether your vehicle or transmitter is causing the interference, turn off your vehicle and release the transmitter's control levers. If the interference goes away, your vehicle or transmitter is the cause.

Try to eliminate the interference by:

- Moving your vehicle and transmitter away from the TV or radio.

If you cannot eliminate the interference, the FCC requires that you stop using your vehicle.

嘉 華 塑 膠 製 品 廠
KA WAH MANUFACTORY LIMITED

WAH HING INDUSTRIAL MANSIONS, 10/F., FLAT "F"
36, TAI YAU STREET, SAN PO KONG, KOWLOON.
TEL: 23260221-4 FAX: 852-23523401

POWER OF ATTORNEY

MODEL NO: 7115

Nov. 17, 2003

Federal Communications Commission
Authorization and Evaluation Division
7435 Oakland Mills Road
Columbia, MD21046

To whom it may concern:

We, the undersigned, hereby authorized TIMCO ENGINEERING, INC. on our behalf, to apply to the Federal Communications Commission on our equipment. Any and all acts carried out by TIMCO ENGINEERING, INC. on our behalf shall have the same effect as acts of our own. This authorization expires on 31 March, 2004.

This is to advise that we are in full compliance with the Anti Drug Abuse Act. We, the applicant are not subject to a denial of Federal benefits pursuant to Section 5301 of the Anti Drug Act of 1988, 21 USC835a, and no party to the application is Subject to a denial of Federal Benefits pursuant to that section.

KA WAH MANUFACTORY LIMITED

For and on behalf of
KA WAH MANUFACTORY LIMITED

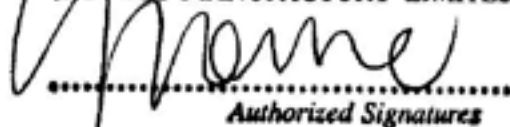
.....
Authorized Signatures

Yvonne Hui
Sales and Marketing Director

Manufacturers:

1. Ka Wah Manufactory Ltd.
Wah Hing Ind. Mansions, 10/F., Flat F, 36 Tai Yau Street, San Po Kong, Kln., HK.
2. Kei Seng Plastic Manufacturing (Shenzhen) Co., Ltd.
Lougang Industrial Area, Buji, Longgang, Shenzhen, China.