

MC3300ax

Mobile Computer

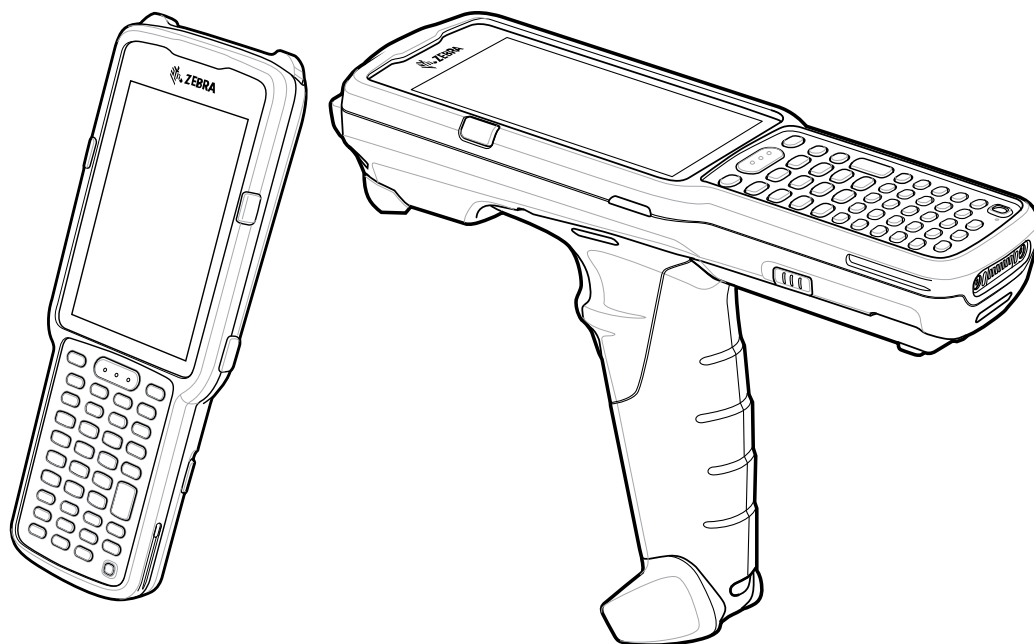

Quick Start Guide



ZEBRA and the stylized Zebra head are trademarks of Zebra Technologies Corporation, registered in many jurisdictions worldwide. All other trademarks are the property of their respective owners.
© 2021 Zebra Technologies Corporation and/or its affiliates. All rights reserved.

Information in this document is subject to change without notice. The software described in this document is furnished under a license agreement or nondisclosure agreement. The software may be used or copied only in accordance with the terms of those agreements.

For further information regarding legal and proprietary statements, please go to:

SOFTWARE: zebra.com/linkoslegal

COPYRIGHTS: zebra.com/copyright

WARRANTY: zebra.com/warranty

END USER LICENSE AGREEMENT: zebra.com/eula

Terms of Use

Proprietary Statement

This manual contains proprietary information of Zebra Technologies Corporation and its subsidiaries ("Zebra Technologies"). It is intended solely for the information and use of parties operating and maintaining the equipment described herein. Such proprietary information may not be used, reproduced, or disclosed to any other parties for any other purpose without the express, written permission of Zebra Technologies.

Product Improvements

Continuous improvement of products is a policy of Zebra Technologies. All specifications and designs are subject to change without notice.

Liability Disclaimer

Zebra Technologies takes steps to ensure that its published Engineering specifications and manuals are correct; however, errors do occur. Zebra Technologies reserves the right to correct any such errors and disclaims liability resulting therefrom.

Limitation of Liability

In no event shall Zebra Technologies or anyone else involved in the creation, production, or delivery of the accompanying product (including hardware and software) be liable for any damages whatsoever (including, without limitation, consequential damages including loss of business profits, business interruption, or loss of business information) arising out of the use of, the results of use of, or inability to use such product, even if Zebra Technologies has been advised of the possibility of such damages. Some jurisdictions do not allow the exclusion or limitation of incidental or consequential damages, so the above limitation or exclusion may not apply to you.

Publication Date

June 8, 2021

Configurations

MC3300ax used in this guide refers to all configurations, except where noted. MC3300ax-G refers to the Trigger configuration. MC3300ax-S refers to the Straight configuration.

MC3300ax-G Features

Front View

Figure 1 MC3300ax-G Front View

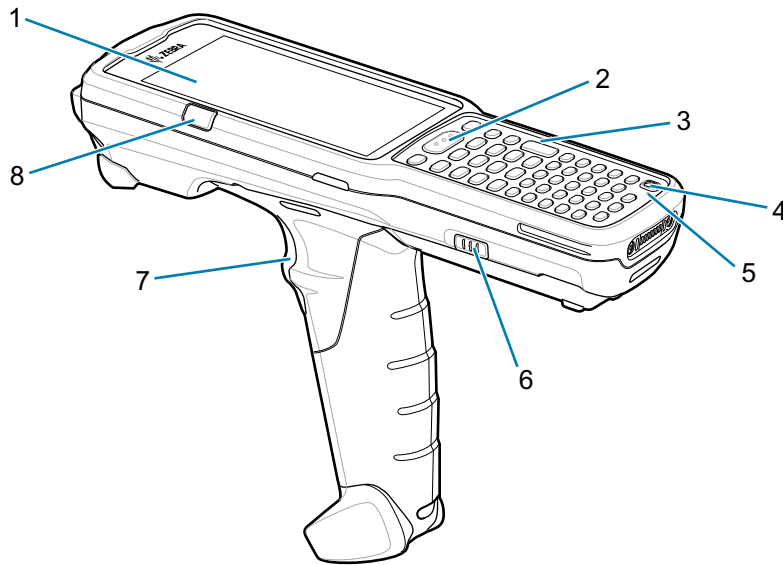

NOTE: The MC3300ax-G does not ship with a pre-installed hand strap. However, one can be purchased separately as a standalone accessory (SG-MC33-HDSTPG-01) if required.

Number	Item	Function
1	Display	Displays all information needed to operate the device.
2	Scan button	Initiates data capture when a scan application is enabled.
3	Keypad	Use to enter data and navigate on screen functions.
4	Power key	Press to suspend and resume device. Provides the following options: Power off - Turn off the device. Restart - Reboot the device when software stops responding.
5	Microphone	Use for communications in Handset mode.
6	Battery release latch	Release the battery from the device.
7	Trigger	Initiates data capture when a scan application is enabled.
8	Charge /Application notification LED or scan/decode status	Indicates the battery charge state while charging, an application notification was received, or the scan/decode status.

Back View

Figure 2 MC3300ax-G Back View

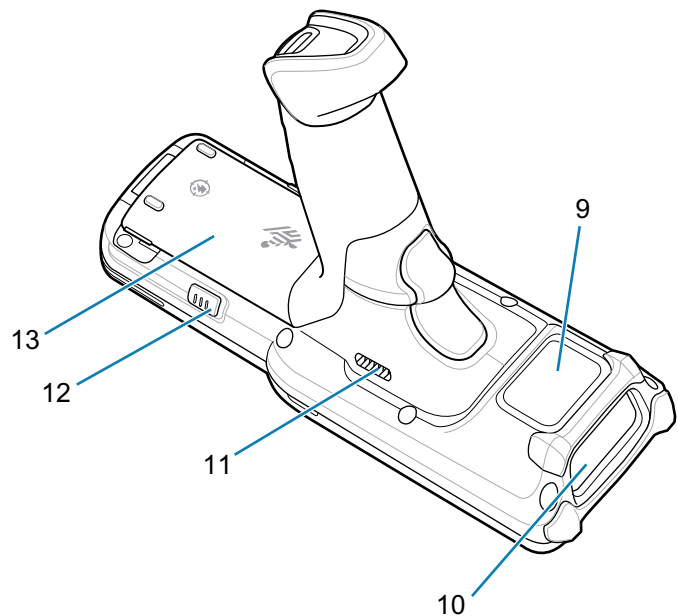

Number	Item	Function
9	NFC antenna	Provides communication with other NFC-enabled devices.
10	Scanner exit window	Provides data capture using integrated scanner/imager option.
11	Speaker	Provides audio output for video and music playback.
12	Battery release latch	Release the battery from the device.
13	Battery	Provides power for operating the device.

MC3300ax-S Features

Front View

Figure 3 MC3300ax-S Front View

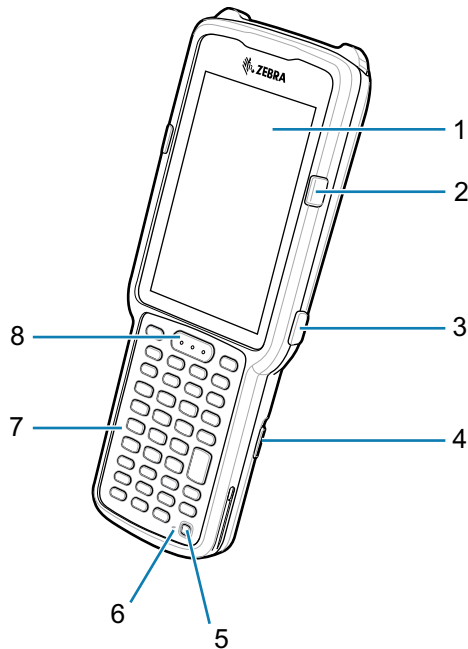

Number	Item	Function
1	Display	Displays all information needed to operate the device.
2	Charge /Application notification LED or scan/decode status	Indicates the battery charge state while charging, an application notification was received, or the scan/decode status.
3	Side Key scan button	Initiates data capture when a scan application is enabled.
4	Battery release latch	Release the battery from the device.
5	Power key	Press to suspend and resume device. Provides the following options: Power off - Turn off the device. Restart - Reboot the device when software stops responding.
6	Microphone	Use for communications in Handset mode.
7	Keypad	Use to enter data and navigate on screen functions.
8	Scan button	Initiates data capture when a scan application is enabled.

Back View

Figure 4 MC3300ax-S Back View

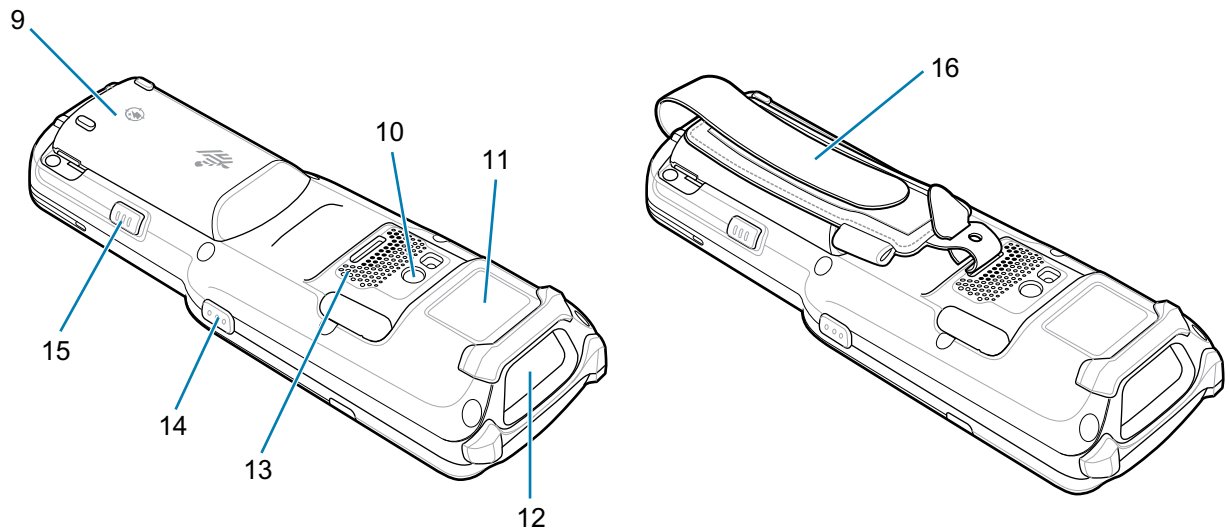

Number	Item	Function
9	Battery	Provides power for operating the device.
10	Camera/Flash	Provides image capture capability with LED illumination.
11	NFC antenna	Provides communication with other NFC-enabled devices.
12	Scanner exit window	Provides data capture using the scanner.
13	Speaker	Provides audio output for video and music playback.
14	Side key scan button	Initiates data capture when a scan application is enabled.
15	Battery release latch	Release the battery from the device.
16	Hand strap	Use for securely holding the device. Comes pre-installed on every MC3300ax-S device.

Setup

To start using the device for the first time:

- Install a microSD card (optional)
- Install the battery
- Charge the device
- Power on the device.

Installing a microSD Card

The microSD card slot provides secondary non-volatile storage. The slot is located under the battery pack. Refer to the documentation provided with the card for more information, and follow the manufacturer's recommendations for use.



CAUTION: Follow proper electrostatic discharge (ESD) precautions to avoid damaging the microSD card. Proper ESD precautions include, but are not limited to, working on an ESD mat and ensuring that the operator is properly grounded.

1. Using a coin or finger, remove the microSD card cover.

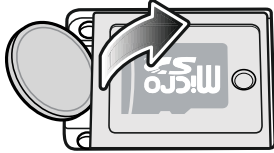

2. Slide the microSD card holder to the Open position.

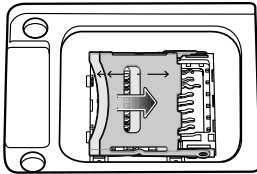

3. Lift the microSD card holder.

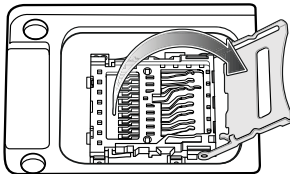

4. Place the microSD card into the contact area with the contacts facing down.

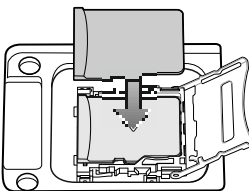

5. Close the microSD card holder and slide the microSD card holder to the Lock position.

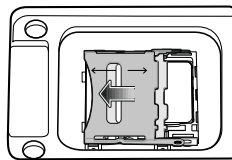
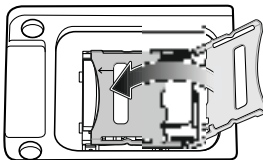

6. Replace the microSD card cover and ensure that it is installed properly.

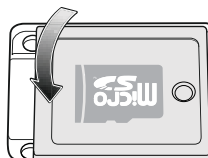
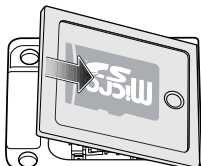

Installing the MC3300ax-G Battery

The device is shipped with the 7000 mAh PowerPrecision+ battery. The MC33 rechargeable Li-Ion battery with BLE beacon is available as an option.

To install the battery:

1. Loosen the hand strap (if installed).
2. Align the battery into the battery compartment.

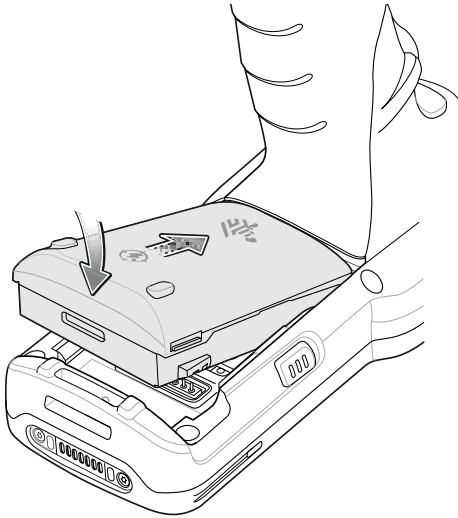

3. Slide the front of the battery into the battery compartment.
4. Press battery down firmly. Ensure that both battery release buttons on the sides of the MC3300ax-G return to the home position.

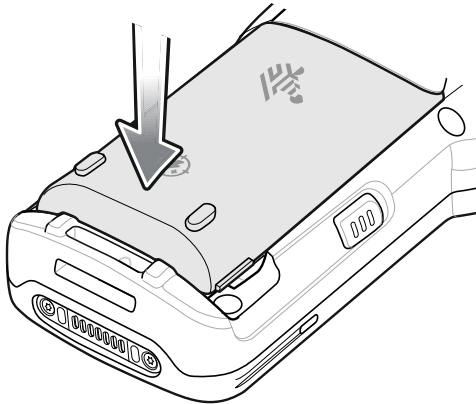

5. Tighten the hand strap (if installed).
6. Press and hold the Power key (until you see a Zebra splash screen) to turn on the device.

Installing the MC3300ax-S Battery

The device is shipped with the 7000 mAh PowerPrecision+ battery. The MC33 rechargeable Li-Ion battery with BLE beacon is available as an option.

To install the battery:

1. Loosen the hand strap, if needed.
2. Align the battery into the battery compartment.

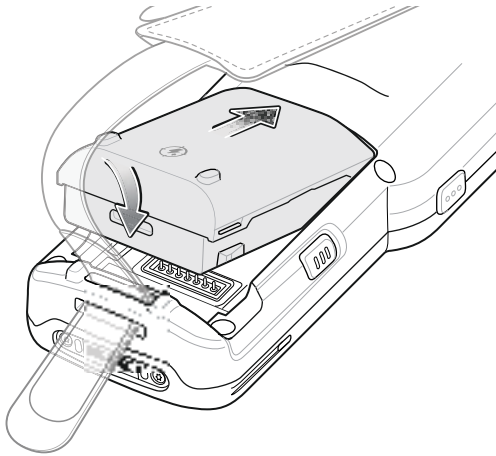

3. Slide the front of the battery into the battery compartment.
4. Press battery down firmly. Ensure that both battery release buttons on the sides of the MC3300ax-S return to the home position.

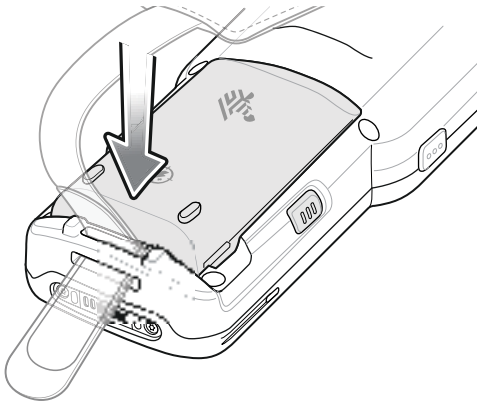

5. Tighten the hand strap, if needed.
6. Press and hold the Power key (until you see a Zebra splash screen) to turn on the device.

Replacing the Battery in the MC3300ax-G

1. Push in the two Battery Release buttons.

The battery ejects slightly. With Hot Swap mode, when the user removes the battery, the display turns off and the device enters low power state. The MC3300ax-G supports wireless connectivity persistence for 30 sec (indicated by flashing Amber LEDs), followed by RAM data persistence for approximately five minutes. Replace the battery within five minutes to preserve memory persistence.

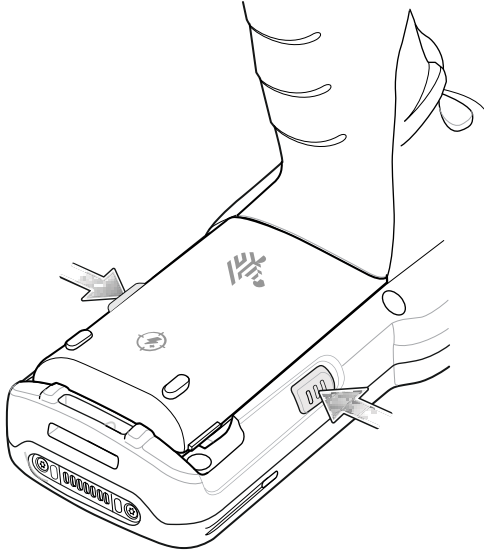

2. Remove the battery from the battery compartment.

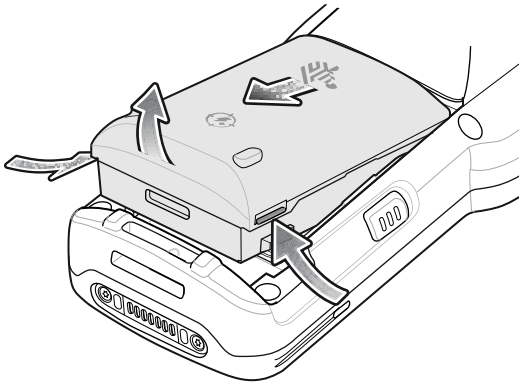

3. Align the battery into the battery compartment.
4. Slide the front of the battery into the battery compartment.
5. Press battery down firmly. Ensure that both battery release buttons on the sides of the MC3300ax-G return to the home position.
6. The device automatically resumes after a battery removal and installation (in a hot swap change). The only time the Power key needs to be pressed is if the device has been powered off or left for a prolonged duration without a battery pack.

Replacing the Battery in the MC3300ax-S

1. Push in the two Battery Release buttons.

The battery ejects slightly. With Hot Swap mode, when the user removes the battery, the display turns off and the device enters low power state. The MC3300ax-S supports wireless connectivity persistence for 30 sec (indicated by flashing Amber LEDs), followed by RAM data persistence for approximately five minutes. Replace the battery within five minutes to preserve memory persistence.

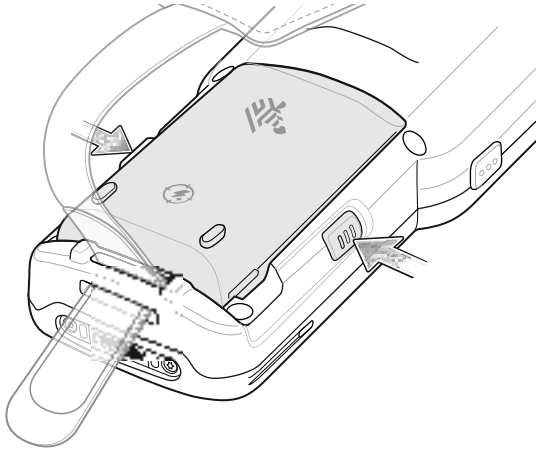

2. Remove the battery from the battery compartment.

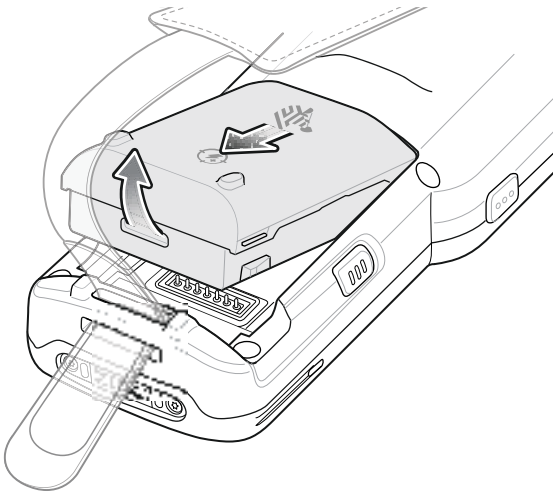

3. Align the battery into the battery compartment.
4. Slide the front of the battery into the battery compartment.
5. Press battery down firmly. Ensure that both battery release buttons on the sides of the MC3300ax-S return to the home position.
6. The device automatically resumes after a battery removal and installation (in a hot swap change). The only time the Power key needs to be pressed is if the device has been powered off or left for a prolonged duration without a battery pack.

MC33 Rechargeable Li-Ion Battery with BLE Beacon

The MC33 rechargeable Li-Ion battery with BLE beacon is a 7000 mAh PowerPrecision+ battery with a BLE beacon that allows users to track lost and powered off devices.



NOTE: The device is shipped with the 7000 mAh PowerPrecision+ battery. The MC33 rechargeable Li-Ion battery with BLE beacon is available as an option.



IMPORTANT: The Secondary BLE beaconing functions only if the MC33 rechargeable Li-Ion battery with BLE beacon is in the device before the device is powered off.

MC33 rechargeable Li-Ion battery with BLE beacon:

- Has a Bluetooth logo.

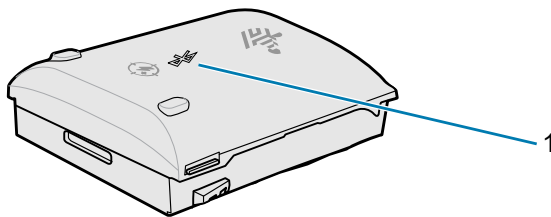

1	Bluetooth Logo
---	----------------

- The Secondary BLE settings are controlled by the operating system of the device. For more information on configuring the Secondary BLE settings, go to:
techdocs.zebra.com/emdk-for-android/8-0/mx/beaconmgr/.



IMPORTANT: Power on the device after installing the MC33 rechargeable Li-Ion battery with BLE beacon to ensure the operating system transfers the Secondary BLE settings to the battery.

- Transmits a Bluetooth signal (beacon) only when the device is powered off or in Airplane mode (disabled by default).
- Must be in the device for the MC33 rechargeable Li-Ion battery with BLE beacon to transmit a signal (beacon).
- Transmits a BLE signal for at least seven days after the device is powered off due to battery depletion.

Battery Comparison

The table below displays a comparison of the MC33 rechargeable Li-ion battery with BLE beacon, MC3300x, and MC33XX batteries.

Table 1 Battery Comparison

Feature	MC33XX	MC3300x	MC33 Rechargeable Li-ion Battery with BLE Beacon
Battery Type	PowerPrecision+	PowerPrecision+	PowerPrecision+
Includes Zebra and PowerPrecision+ recessed logos	Yes	Yes	Yes
Secondary BLE Beacon	No	No	Yes
Back Label	Blue	Black	Violet

Battery Compatibility

The following re-occurring message will be displayed if the incorrect battery is used with the MC3300ax device. Please make sure you use one of the MC3300ax compatible batteries.

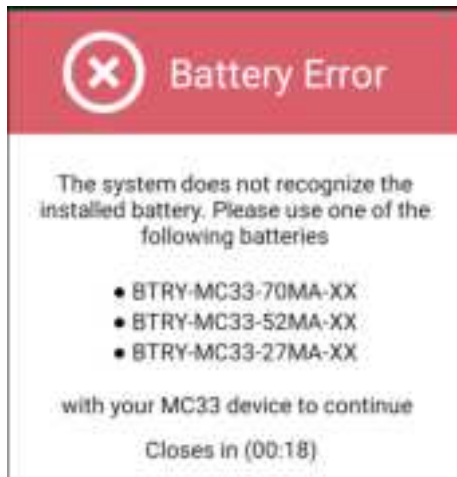

NOTE: The battery notification (shown above) cannot be disabled or suppressed on the MC3300ax handheld device. Please make sure you use the appropriate MC33 PP+ batteries with the MC3300ax device.

Charging the MC3300ax

Use one of the following accessories to charge the MC3300ax and/or spare battery.

Table 2 Charging and Communication

Description	Part Number	Charging		Communication	
		Battery (In Device)	Spare Battery	USB	Ethernet
1-Slot USB Charge Cradle with Spare Battery Charger	CRD-MC33-2SUCHG-01	Yes	Yes	Yes	No
5-Slot Charge Only ShareCradle	CRD-MC33-5SCHG-01	Yes	No	No	No
5-Slot Ethernet ShareCradle	CRD-MC33-5SETH-01	Yes	No	No	Yes
5-Slot Charge ShareCradle with 4-Slot Battery Charger	CRD-MC33-4SC4BC-01	Yes	Yes	No	No
5-Slot Ethernet ShareCradle with 4-Slot Battery Charger	CRD-MC33-4SE4BC-01	Yes	Yes	No	Yes
4-Slot Spare Battery Charger	SAC-MC33-4SCHG-01	No	Yes	No	No
20-Slot Spare Battery Charger	SAC-MC33-20SCHG-01	No	Yes	No	No
USB Charge Cable	CBL-MC33-USBCHG-01	Yes	No	Yes	No
MC32N0 1-Slot Cradle with MC33XX Cradle Adapter	CRD3000-1001RR ADP-MC33-CRDCUP-01	Yes	Yes (Only charges MC32N0 batteries in the spare battery slot)	Yes	No

Charging the Main Battery



NOTE: Ensure that you follow the guidelines for battery safety described in the MC3300ax Product Reference Guide.



NOTE: To function properly, ensure that the hand strap, if attached, does not interfere with the charging contacts when the device is inserted into a charging cradle.

1. To charge the main battery, connect the charging accessory to the appropriate power source.
2. Insert the device into a cradle or attach to a USB charge cable. The device turns on and begins charging. The Charging/Notification LED remains amber while charging, then turns solid green when fully charged.

Charging the Spare Battery

1. Insert a spare battery into the spare battery slot.
2. Ensure the battery is seated properly.

The Spare Battery Charging LED blinks indicating charging. See [Table 3](#) for charging indicators.

Charging Indicators

Table 3 Charging/Notification LED Indicators

State	Indication
Off	<ul style="list-style-type: none"> The battery is not charging. The battery is not inserted correctly in the cradle or connected to a power source. Cradle is not powered.
Blinking Amber	Active wireless connectivity session during battery hot swap.
Solid Amber	Battery is charging.
Solid Green	Battery charging is complete.
Fast Blinking Red 2 blinks/second	Charging error, e.g.: <ul style="list-style-type: none"> Temperature is too low or too high. Charging has gone on too long without completion (typically eight hours).
Solid Red	<ul style="list-style-type: none"> Spare battery is charging and battery is at the end of useful life. Charging complete and battery is at the end of useful life.
Blinking Blue	Indicates an application notification is received.

Charging Temperature

Charge batteries in temperatures from 0°C to 40°C (32°F to 104°F). The device or cradle always performs battery charging in a safe and intelligent manner. At higher temperatures (e.g. approximately +37°C (+98°F)) the device or cradle may for small periods of time alternately enable and disable battery charging to keep the battery at acceptable temperatures. The device and cradle indicates when charging is disabled due to abnormal temperatures via its LED.

Enterprise Browser



NOTE: Zebra's Enterprise Browser is licensed to MC3300ax mobile computers.

Enterprise Browser enables developers to build web applications that integrate seamlessly with the features in Zebra Technologies mobile computers and peripherals such as barcode scanning, signature capture, and printing.

Installation

To install Enterprise Browser:

1. Go to the Zebra Enterprise Browser Support web site at zebra.com/us/en/support-downloads/software/developer-tools/enterprise-browser.html or [Google Play](#).
2. Download Enterprise Browser version 3.2.0.0 or higher.
3. Install Enterprise Browser on the device.

For more information about installing Enterprise Browser, refer to the Application Deployment in the MC3300ax Mobile Computer Product Reference Guide.

4. To set up Enterprise Browser refer to techdocs.zebra.com/enterprise-browser/3-0/guide/setup/.

1-Slot USB Charge Cradle

The 1-Slot USB Charge Cradle:

- Provides 9 VDC power for charging the mobile computer and charging the battery.
- Provides 4.2 VDC power to charge the spare battery.
- Provides a USB port for data communication between the mobile computer and a host computer or other USB devices (e.g., a printer).
- Synchronizes information between the mobile computer and a host computer. With customized or third party software, it can also synchronize the mobile computer with corporate databases.
- Compatible with the following batteries (charging in a device):
 - MC3300ax 7000mAh PowerPrecision+ extended capacity battery
 - MC3300x 7000mAh PowerPrecision+ extended capacity battery
 - MC33XX 5200mAh PowerPrecision+ high capacity battery
 - MC33XX 2740mAh PowerPrecision+ standard capacity battery (MC3300x-R/S & MC3300-R/S only).
- Compatible with the following batteries (charging in a spare battery slot only):
 - 7000mAh PowerPrecision+ extended capacity battery
 - MC33 7000mAh PowerPrecision+ extended capacity battery with a BLE beacon
 - MC33XX 5200mAh PowerPrecision+ high capacity battery
 - MC33XX 2740mAh PowerPrecision+ standard capacity battery.

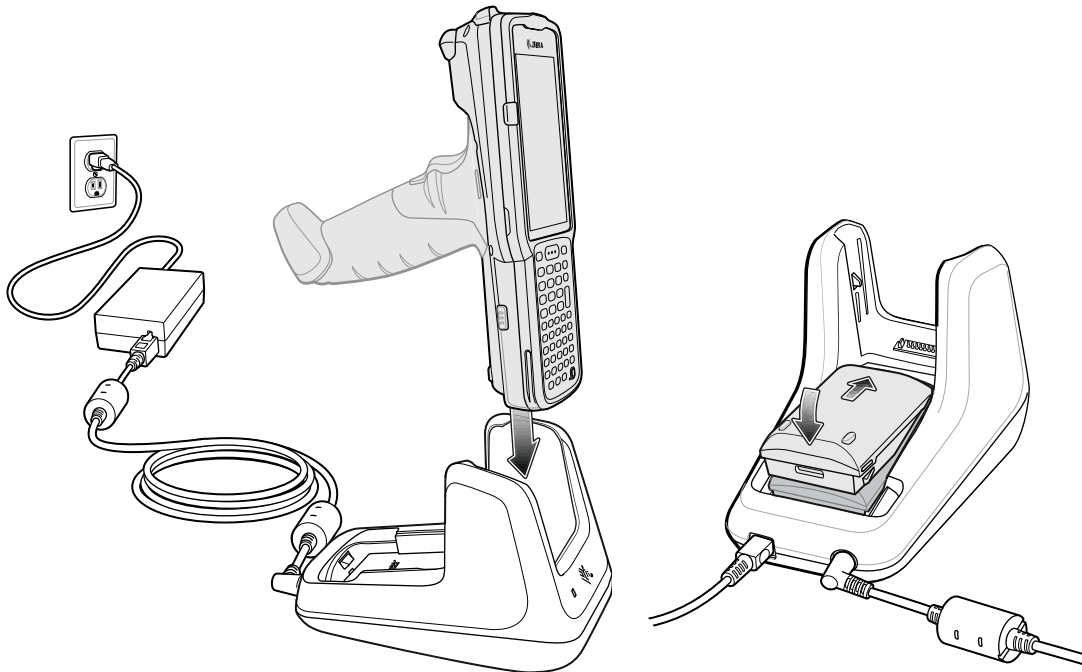

5-Slot Charge Only ShareCradle

The 5-Slot Charge Only ShareCradle:

- Provides 9 VDC power for operating the mobile computer and charging the battery.
- Simultaneously charges up to five mobile computers.
- Compatible with the following batteries (charging in a device):
 - MC3300ax 7000mAh PowerPrecision+ extended capacity battery
 - MC3300x 7000mAh PowerPrecision+ extended capacity battery
 - MC33XX 5200mAh PowerPrecision+ high capacity battery
 - MC33XX 2740mAh PowerPrecision+ standard capacity battery (MC3300x-R/S & MC3300-R/S only).

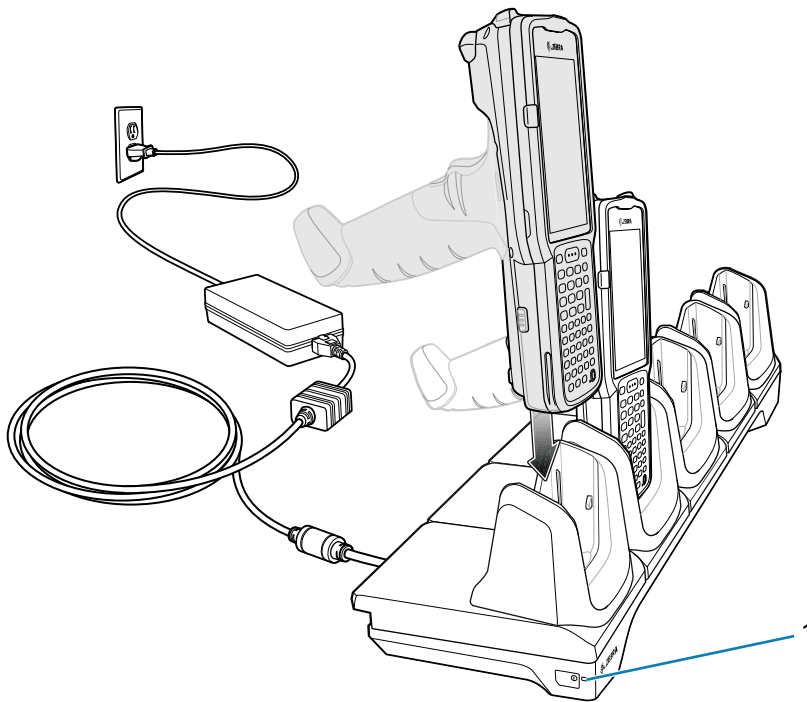

1	Power LED
---	-----------

5-Slot Ethernet ShareCradle

The 5-Slot Ethernet ShareCradle:

- Provides 9 VDC power for operating the mobile computer and charging the battery.
- Simultaneously charges up to five mobile computers.
- Compatible with the following batteries (charging in a device):
 - MC3300ax 7000mAh PowerPrecision+ extended capacity battery
 - MC3300x 7000mAh PowerPrecision+ extended capacity battery
 - MC33XX 5200mAh PowerPrecision+ high capacity battery
 - MC33XX 2740mAh PowerPrecision+ standard capacity battery (MC3300x-R/S & MC3300-R/S only).

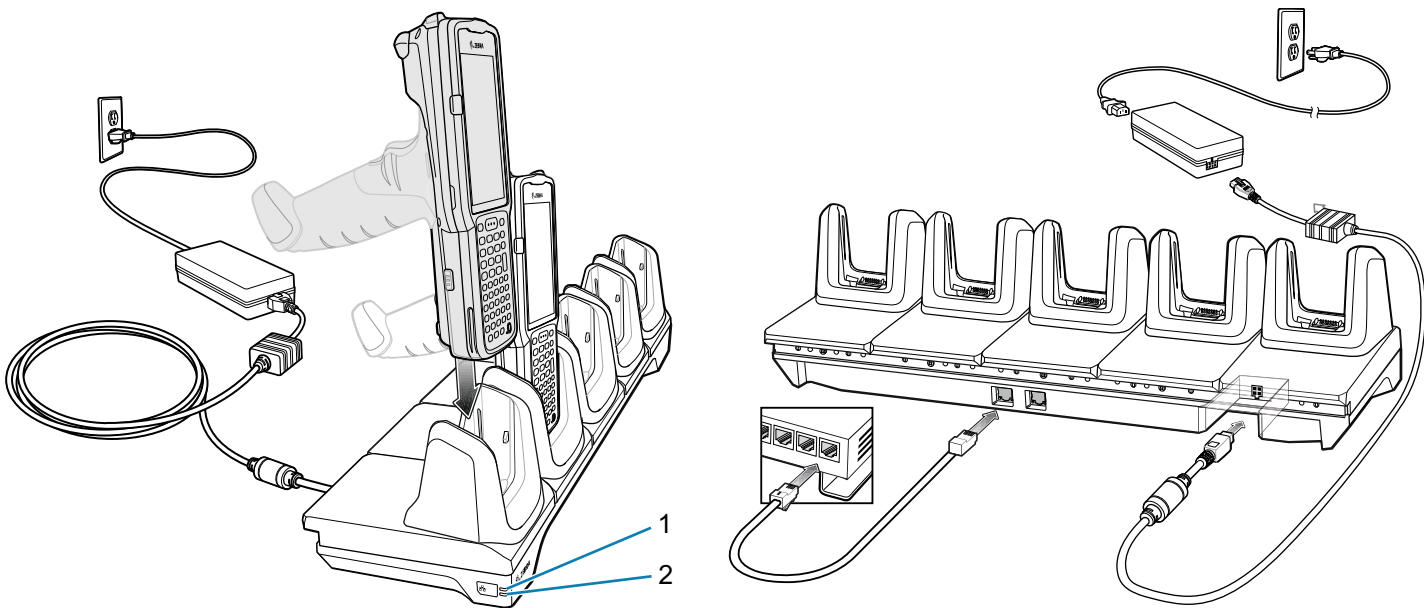

1	1000 LED
2	10/100 LED

5-Slot ShareCradle with 4-Slot Battery Charger

The 5-Slot ShareCradle with 4-Slot Battery Charger:

- Provides 9 VDC power for operating the mobile computer and charging the battery.
- Provides 4.2 VDC power for charging spare batteries.
- Simultaneously charges up to four mobile computers and four spare batteries.
- Compatible with the following batteries (charging in a device):
 - MC3300ax 7000mAh PowerPrecision+ extended capacity battery
 - MC3300x 7000mAh PowerPrecision+ extended capacity battery
 - MC33XX 5200mAh PowerPrecision+ high capacity battery
 - MC33XX 2740mAh PowerPrecision+ standard capacity battery (MC3300x-R/S & MC3300-R/S only).
- Compatible with the following batteries (charging in a spare battery slot only):
 - 7000mAh PowerPrecision+ extended capacity battery
 - MC33 7000mAh PowerPrecision+ extended capacity battery with a BLE beacon
 - MC33XX 5200mAh PowerPrecision+ high capacity battery
 - MC33XX 2740mAh PowerPrecision+ standard capacity battery.

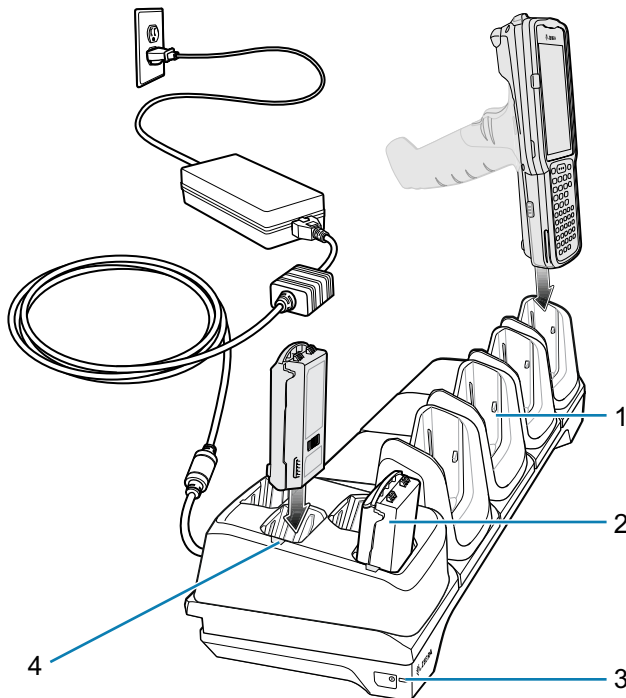

1	Charging slot
2	Spare battery slot
3	Power LED
4	Spare battery charging LED

5-Slot Ethernet ShareCradle with 4-Slot Battery Charger

The 5-Slot Ethernet ShareCradle with 4-Slot Battery Charger:

- Provides 9 VDC power for operating the mobile computer and charging the battery.
- Provides 4.2 VDC power for charging spare batteries.
- Simultaneously charges up to four mobile computers and four spare batteries.
- Compatible with the following batteries (charging in a device):
 - MC3300ax 7000mAh PowerPrecision+ extended capacity battery
 - MC3300x 7000mAh PowerPrecision+ extended capacity battery
 - MC33XX 5200mAh PowerPrecision+ high capacity battery
 - MC33XX 2740mAh PowerPrecision+ standard capacity battery (MC3300x-R/S & MC3300-R/S only).
- Compatible with the following batteries (charging in a spare battery slot only):
 - 7000mAh PowerPrecision+ extended capacity battery
 - MC33 7000mAh PowerPrecision+ extended capacity battery with a BLE beacon
 - MC33XX 5200mAh PowerPrecision+ high capacity battery
 - MC33XX 2740mAh PowerPrecision+ standard capacity battery.

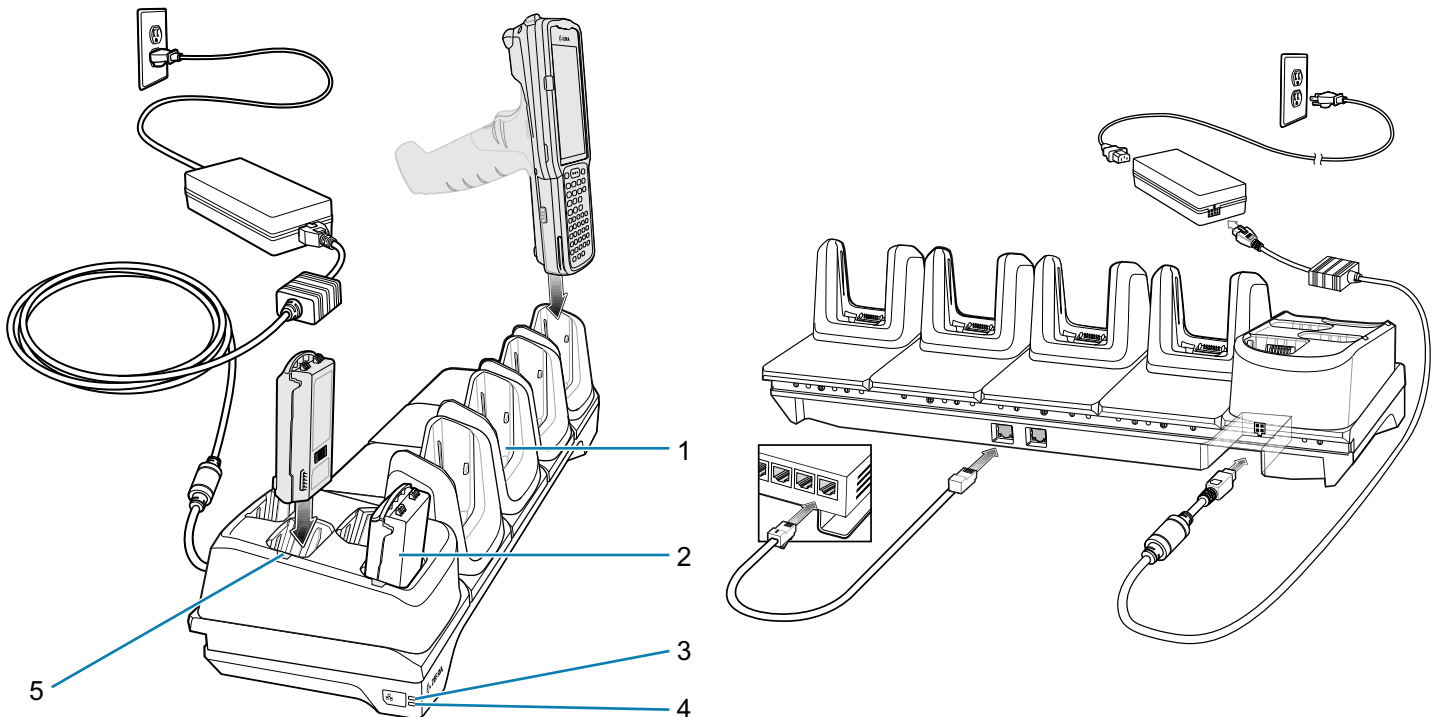

1	Charging slot
2	Spare battery slot
3	1000 LED
4	10/100 LED
5	Spare battery charging LED

4-Slot Spare Battery Charger

The 4-Slot Battery Charger:

- Charges up to four spare batteries.
- Provides 4.2 VDC power to charge the spare battery.
- Compatible with the following batteries (charging in a spare battery slot only):
 - 7000mAh PowerPrecision+ extended capacity battery
 - MC33 7000mAh PowerPrecision+ extended capacity battery with a BLE beacon
 - MC33XX 5200mAh PowerPrecision+ high capacity battery
 - MC33XX 2740mAh PowerPrecision+ standard capacity battery.

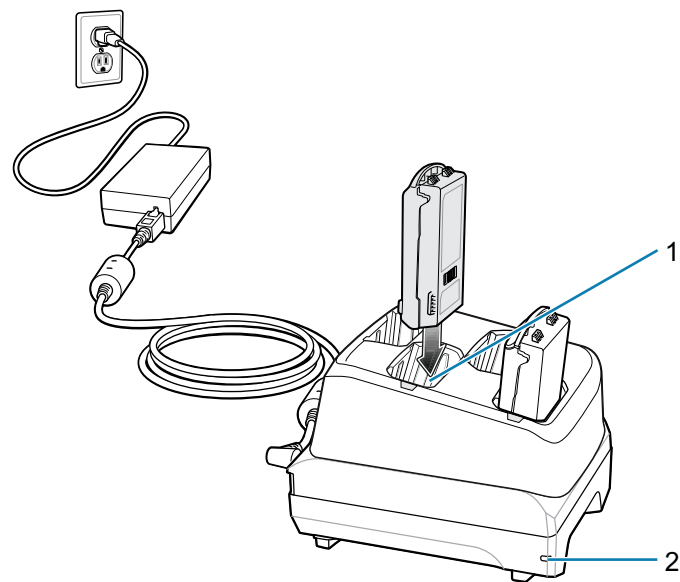

1	Spare battery charging slot
2	Power LED

20-Slot Spare Battery Charger

The 20-Slot Battery Charger:

- Charges up to twenty spare batteries.
- Provides 4.2 VDC power to charge the spare battery.
- Compatible with the following batteries (charging in a spare battery slot only):
 - 7000mAh PowerPrecision+ extended capacity battery
 - MC33 7000mAh PowerPrecision+ extended capacity battery with a BLE beacon
 - MC33XX 5200mAh PowerPrecision+ high capacity battery
 - MC33XX 2740mAh PowerPrecision+ standard capacity battery.

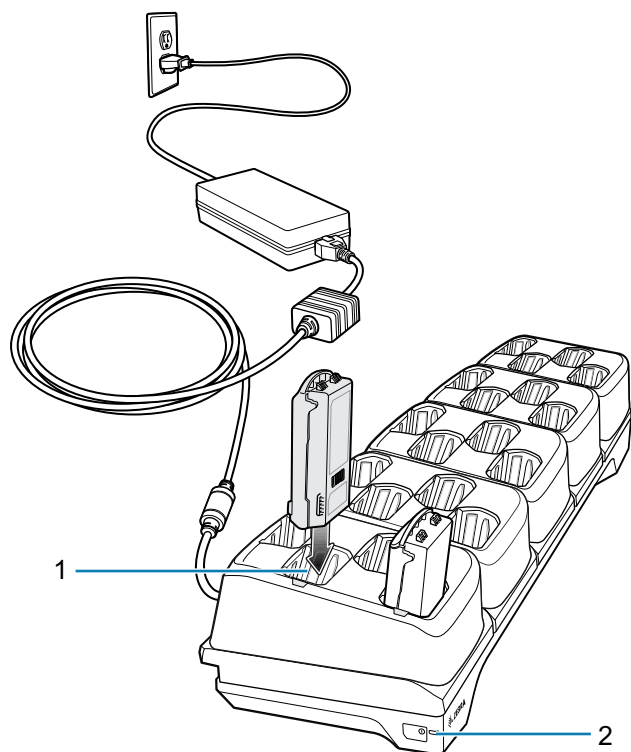

1	Spare battery charging slot
2	Power LED

USB Charge Cable

The USB Charge Cable:

- Provides 5 VDC power to charge the battery.
- Provides power and/or communication with the host computer over USB to the device.
- Compatible with devices using the following batteries:
 - MC3300ax 7000mAh PowerPrecision+ extended capacity battery
 - MC3300x 7000mAh PowerPrecision+ extended capacity battery
 - MC33XX 5200 mAh PowerPrecision+ high capacity battery
 - MC33XX 2740 mAh PowerPrecision+ standard capacity battery (MC3300x-R/S & MC3300-R/S only).

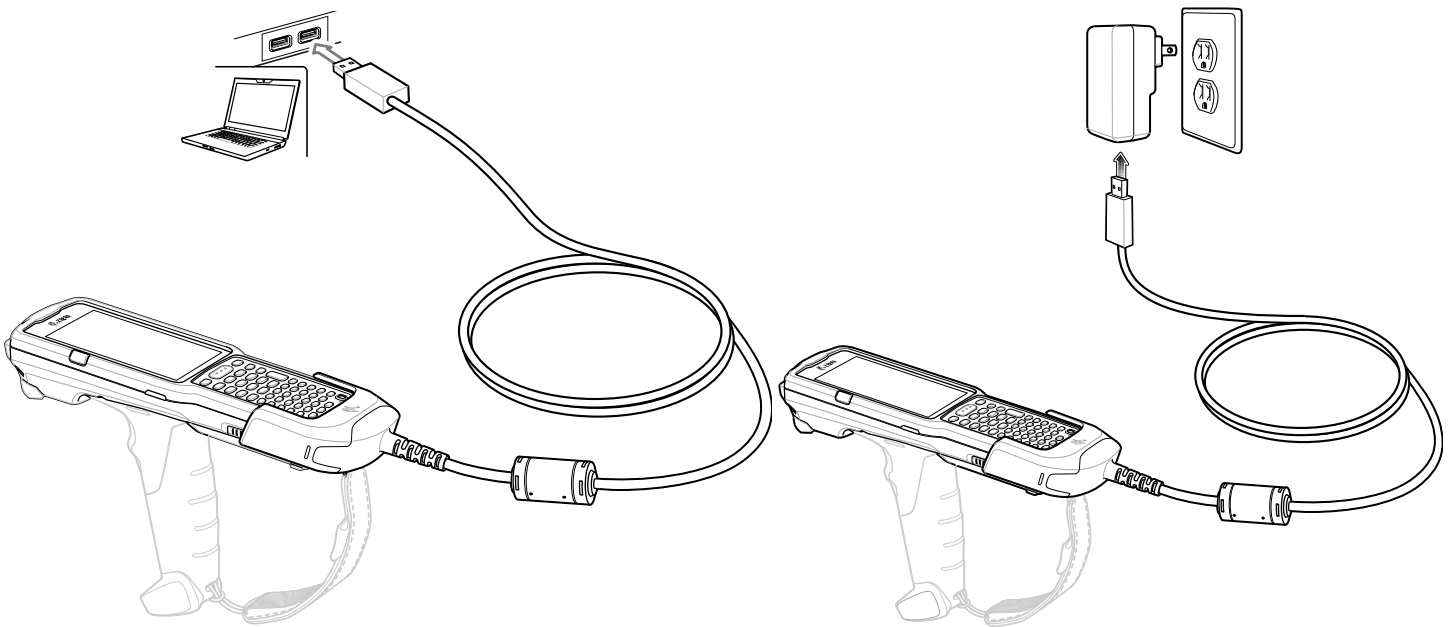
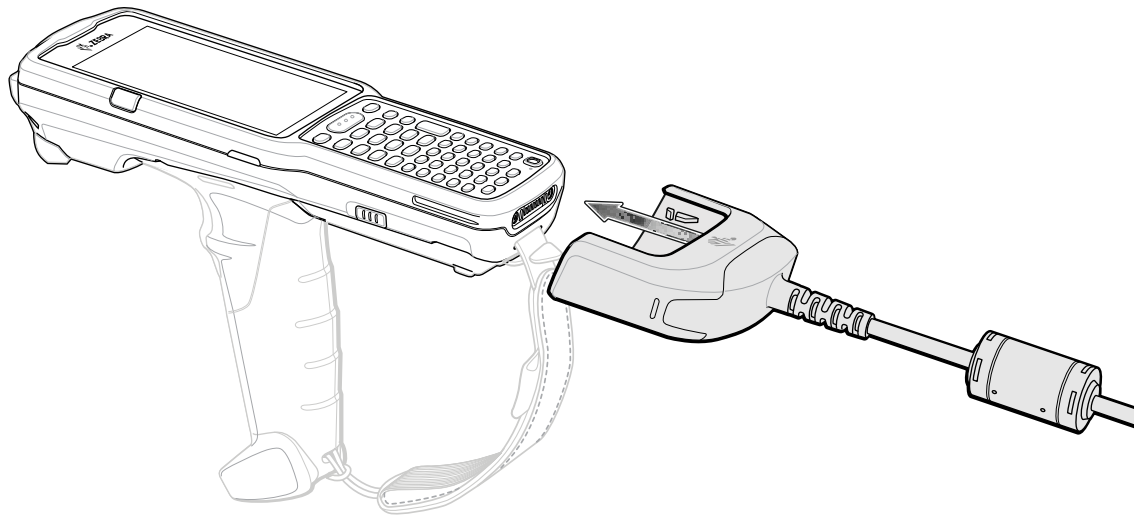

MC33XX Charge Only Adapter

Use the MC33XX Charge Only Adapter for backwards compatibility with the MC32N0 cradles and the MC3300, MC3300x, or MC3300ax mobile computer. The MC33XX Charge Only Adapter is compatible with the MC3300, the MC3300x, and MC3300ax mobile computers for charge only (no communication) on the legacy MC32N0 1-Slot and 4-Slot cradles.

- MC33XX Charge Only Adapter supports the MC32N0 1-Slot USB Cradle, MC32N0 4-Slot Charge Only Cradle, and MC32N0 4-Slot Ethernet Cradle.
- MC33XX Charge Only Adapter provides charge only; no communication when used with the MC32N0 cradles.
- MC32N0 1-Slot USB Cradle provides 5.4 VDC to charge the device.
- MC32N0 1-Slot USB Cradle (with the MC33XX Charge Only Adapter) is compatible with an MC3300, MC3300x, or MC3300ax mobile computer charging the PowerPrecision+ batteries.

MC33XX Charge Only Adapter Installation

To install the MC33XX Charge Only Adapter:

1. Clean the MC32N0 cradle and contacts with an alcohol wipe, using a back and forth motion with your finger.

For more information about cleaning, refer to the Maintenance and Troubleshooting chapter of the MC3300ax Mobile Computer Product Reference Guide.

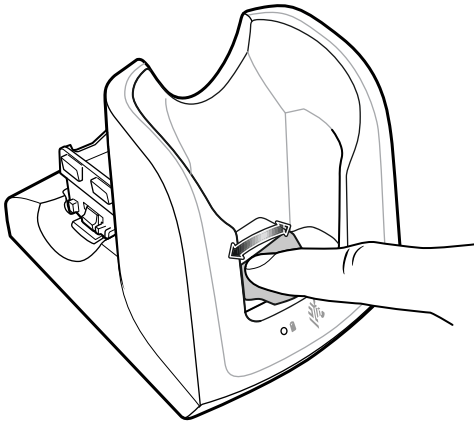

2. Peel and remove the adhesive from the back of the adapter.

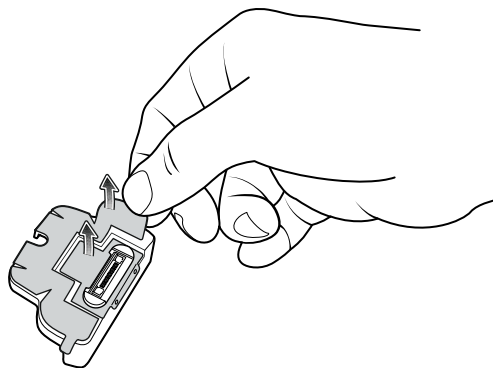

3. Insert the adapter into the MC32N0 cradle and adhere to the bottom of the cradle.

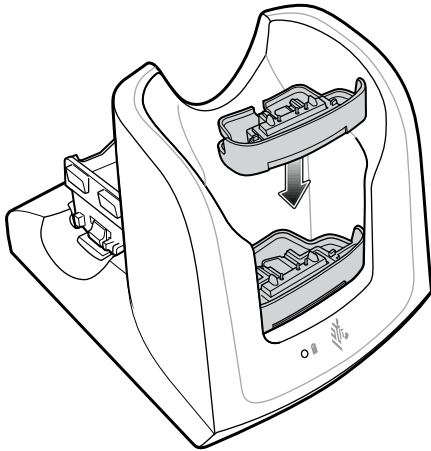

4. Insert the device into the MC32N0 cradle.

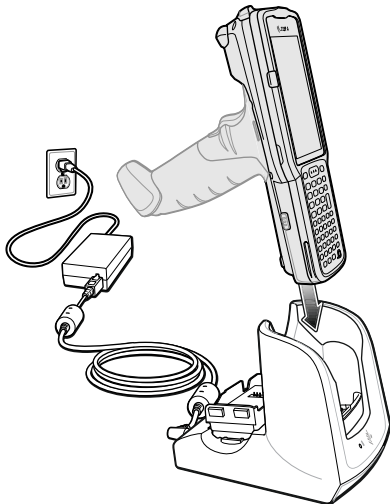

Scanning

The MC3300ax offers the following data capture options:

- SE4770 1D/2D
- SE4850-ER 1D/2D

Refer to the MC3300ax Mobile Computer Product Reference Guide for other scanning options.

Scanning with Internal Imager

Use the internal imager to capture barcode data.



NOTE: To read a barcode, a scan-enabled app is required. The device contains the DataWedge app that allows the user to enable the imager, decode the barcode data, and display the barcode content.

To scan with the internal imager:

1. Ensure that an app is open on the device and a text field is in focus (text cursor in text field).
2. Point the exit window on the top of the device at a barcode.
3. Press and hold the scan button or trigger.

The red laser aiming pattern turns on to assist in aiming.

4. Ensure the barcode is within the area formed by the cross-hairs the aiming pattern. The aiming dot increases visibility in bright lighting conditions.

Figure 5 Aiming Pattern: Standard and Extended Range

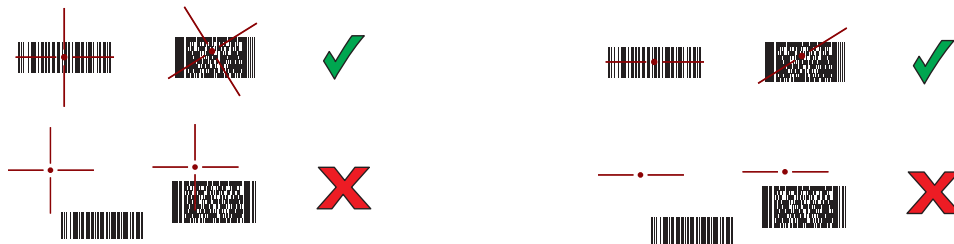

NOTE: When the device is in Pick List Mode, the device does not decode the barcode until the center of the cross-hair touches the barcode.

Figure 6 Pick List Mode with Multiple Barcodes in Aiming Pattern: Standard and Extended Range



The Scan LEDs light green and a beep sounds, by default, to indicate the barcode was decoded successfully.

5. Release the scan button or Trigger.

The barcode content data appears in the text field.

Ergonomic Considerations

Taking breaks and task rotation is recommended.

Optimize Body Posture for Low Scanning

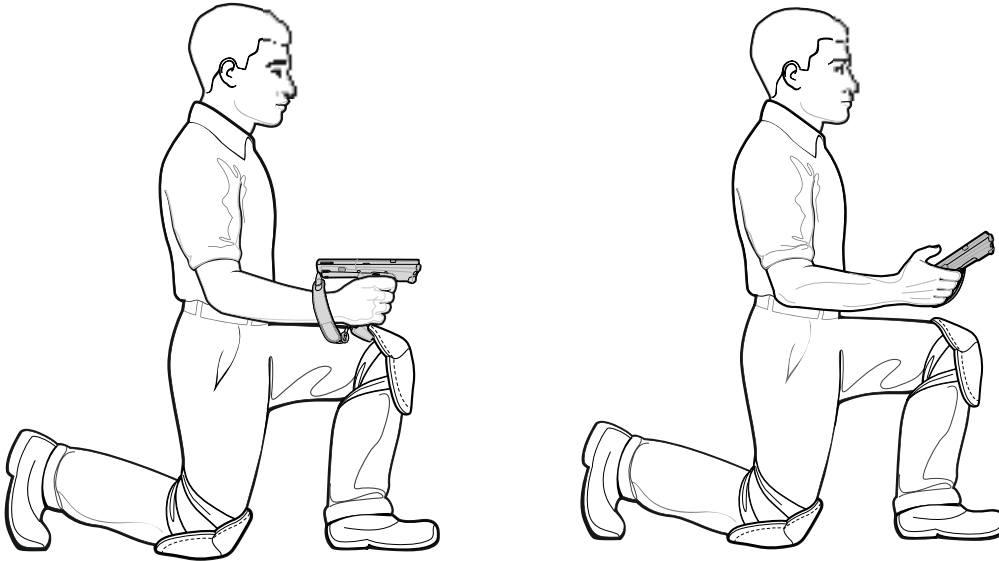

Alternate left and right knees.

Optimize Body Posture for High Scanning

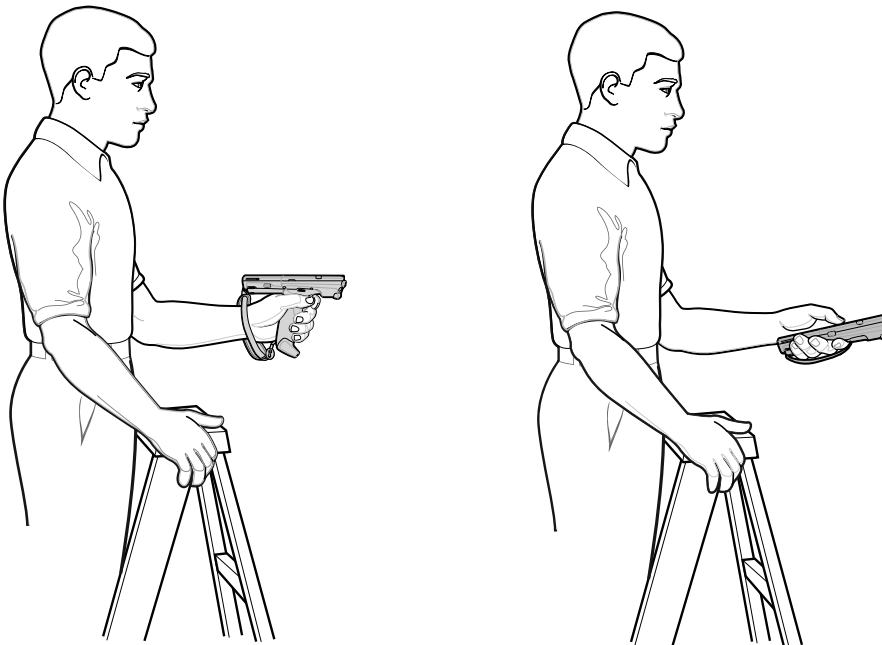

Alternate left and right hand.

Avoid Bending

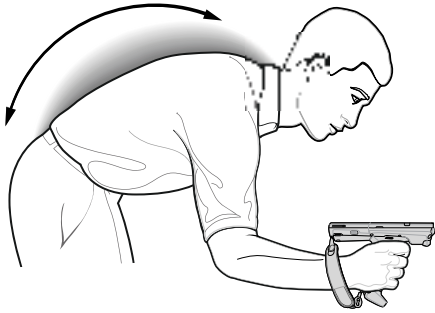

Avoid Reaching

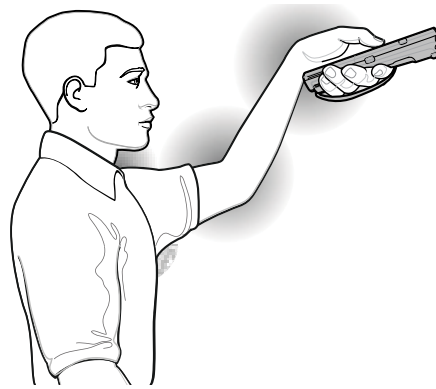

Avoid Extreme Wrist Angles

