

## FCC / IC LABEL

## SECTION 2.1033 (c) and Part 15.21

SECTION 2.1033 (c) Label and label location - A photo showing the identification label clearly (you must be able to see the name and FCC ID number), and the location on the device. In lieu of a photo for this, you may submit an engineer's drawing.

Part 15.21 Statement - for all intentional and unintentional radiators is also printed on the label. All devices shall bear the following statement in a conspicuous location on the device:

**" This device complies with Part 15 of the FCC Rules  
Operation is subject to the following two conditions:  
(1) this device may not cause harmful interference,  
and (2) this device must accept any interference  
received, including interference that may cause  
undesired operation. "**

## EXACT LABEL LOCATION ON THE BACK PLASTIC

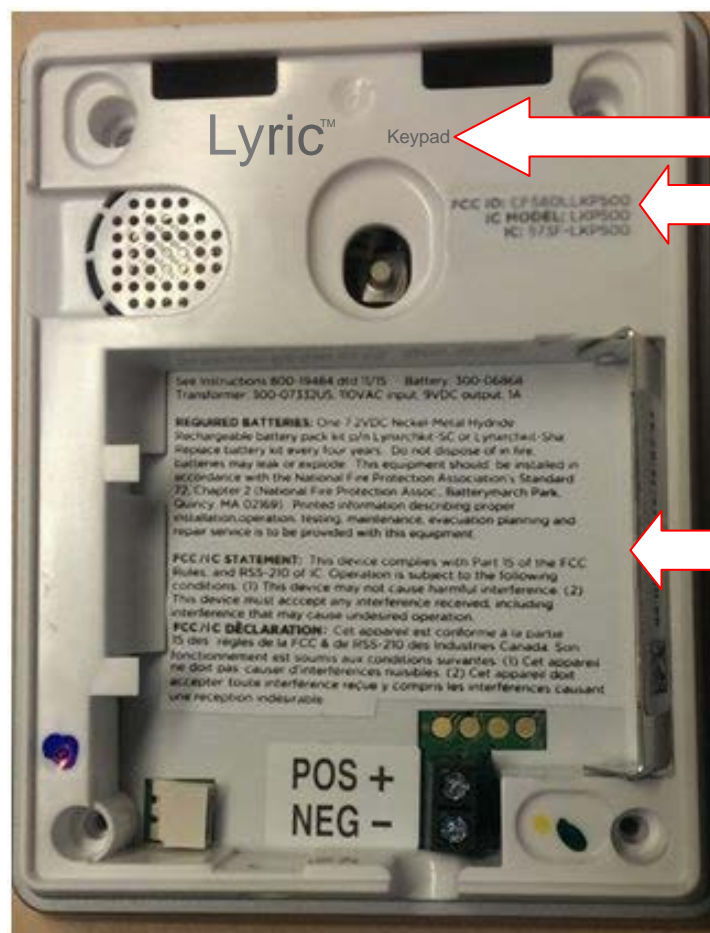

PAD PRINT  
(DIRECT  
PRINT TO PLASTIC)

FOMEX INSERT  
(NO ADHESIVE).  
HELD IN PLACE BY  
CASE BACK, 2  
BOTTOM SCREWS,  
AND BOSSES IN  
CASE BACK  
PLASTIC.

FCC / IC LABEL CONT.

DETAILED DRAWING OF EACH LABEL

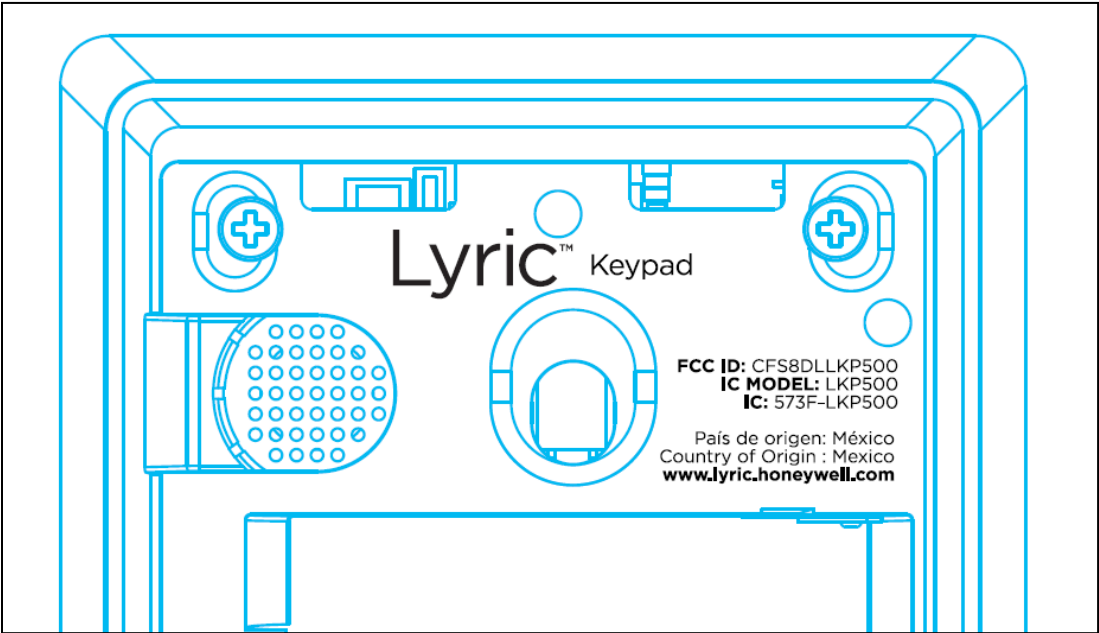

PAD PRINT LABEL (DIRECT PRINT TO PLASTIC)

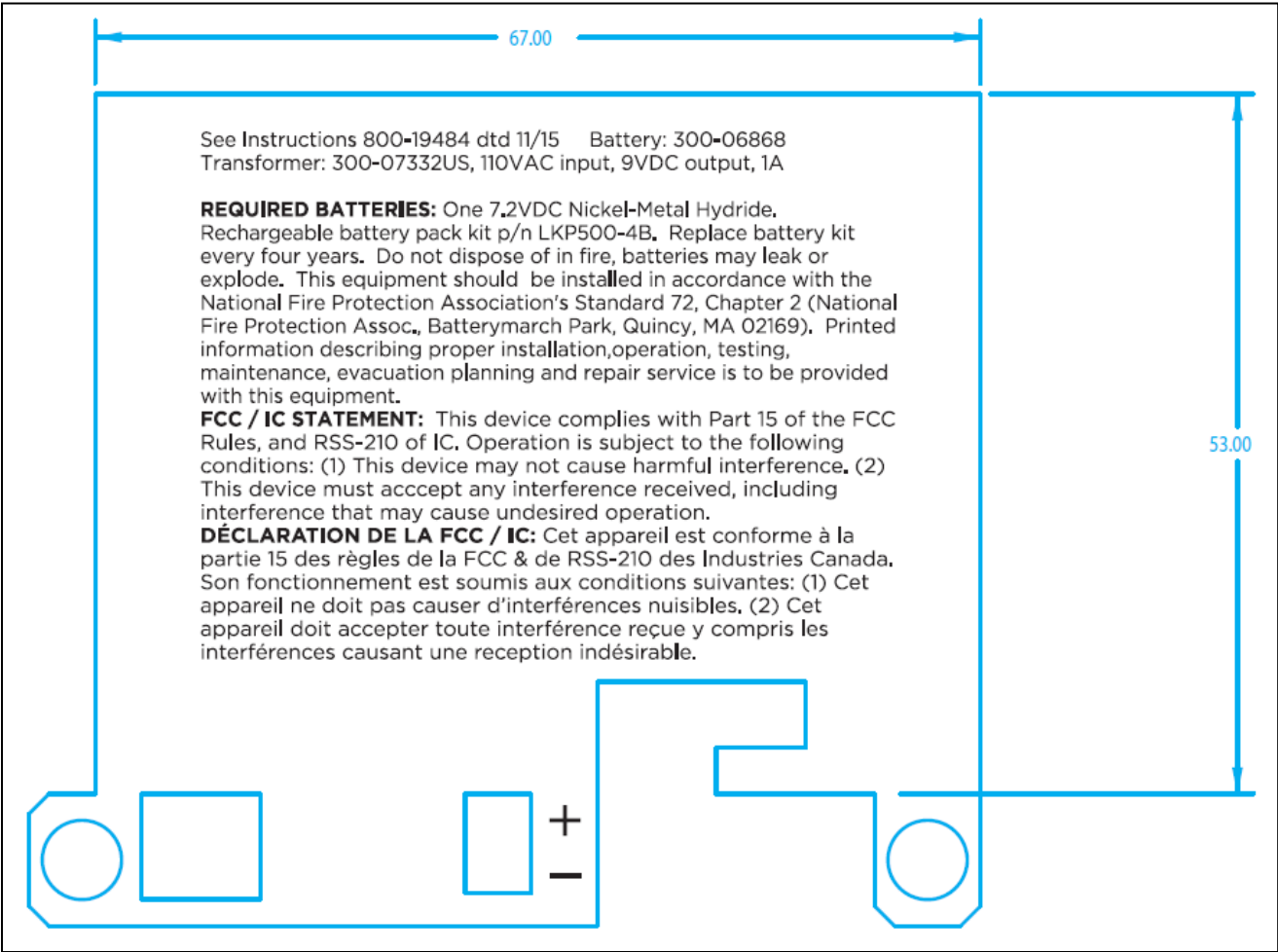

FOMEX LABEL INSERT