

■ Low Voltage Microwave Bi-level Sensor

ANT-3C Instruction



ANT-3C



RC-100

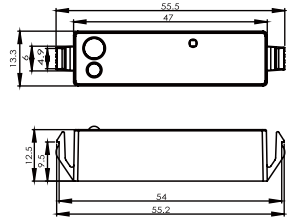

SPECIFICATIONS

Power supply	10-14V DC, >50mA
HF System	5.8GHz±75MHz
Dim control output	0-10V, max. 25mA sinking current
Detection radius/angle	Max 12ft.(4m)/360°
Mounting height	Max 12ft.(4m)
Remote range	50ft. (15m) indoor, no backlight
Humidity	Max. 95% RH
Temperature	-40°F ~ +158°F (-40°C ~ +70°C)

NOTE: The high-frequency output of this sensor is <0.2mW-that is just one 5000th of the transmission power of a mobile phone or the output of a microwave oven.

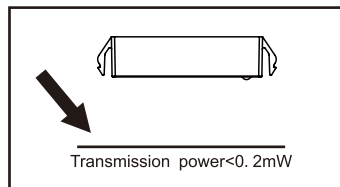

SENSOR COVERAGE

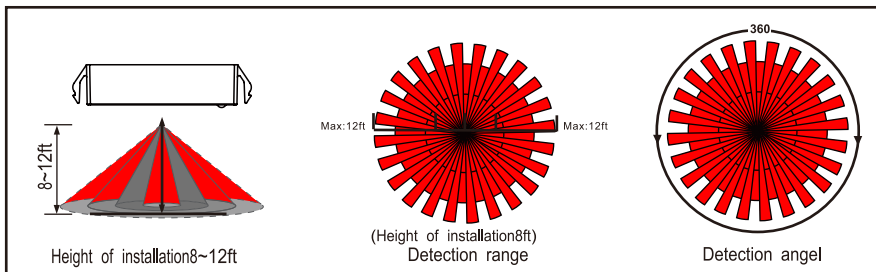

Once powering the device up, the ANT-3C will use factory default parameters to operate. If adjustments are needed, "RC-100 "Wireless IR Configuration tool must be used.

UTILIZING FIELD AND INTRODUCTION

ANT-3C is a moving object sensor that can detect range of 360° and it's working frequency is 5.8GHz. The advantage of this product is stable working state (stable working temperature: -40°C~+70°C), ANT-3C adopts a microwave sensor (high-frequency output <0.2mW), so that it is safe and performs better than infrared sensor.

■ Low Voltage Microwave Bi-level Sensor

ANT-3C Instruction

DAYLIGHT HARVESTING FUNCTION (ONLY BY USING RC100 REMOTE CONTROL)

Open the daylight harvesting function only by choosing “👁️” button when remote control is in setting condition. Memory and maintain current ambient brightness.



When the natural light is sufficient or dark, movement is detected and the light will turn on 100% brightness.

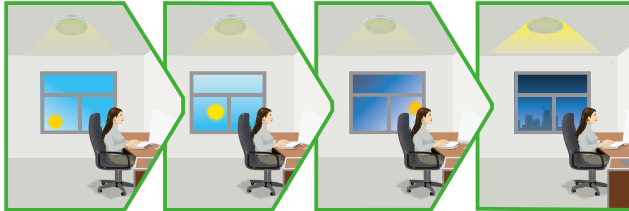

The light turns on at full or dims to maintain the lux level. The light output regulates according to the level of natural light available.

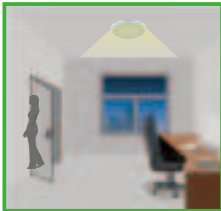

The light dims to stand-by period after hold-time and stays on selected minimum dimming level.



The light switches off completely after the stand-by period.

Setting on this demonstration:
BRIGHTNESS:100%
SENSITIVITY:100%
HOLD TIME:30MIN
DAYLIGHT SENSOR: 👁️
STAND BY DIM: 30%
STAND BY TIME: 1MIN

WIRING DIAGRAMS

Wiring with dimming ballast or LED driver.

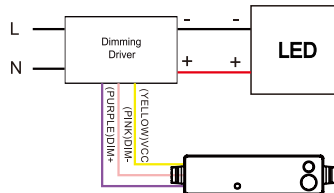

FCC STATEMENT

This equipment has been tested and found to comply with the limits for a Class B digital device pursuant to Part 15 of the FCC Rules. These limits are designed to provide reasonable protection against harmful interference in a residential installation. This equipment generates uses and can radiate radio frequency energy and, if not installed and used in accordance with the instructions, may cause harmful interference to radio communications. However, there is no guarantee that interference will not occur in a particular installation. If this equipment does cause harmful interference to radio or television reception, which can be determined by turning the equipment off and on, the user is encouraged to try to correct the interference by one or more of the following measures:

- Reorient or relocate the receiving antenna.
- Increase the separation between the equipment and receiver... Connect the equipment into an outlet on a circuit different from that to which the receiver is connected.
- Consult the dealer or an experienced radio/TV technician for help.

This device complies with part 15 of the FCC Rules. Operation is subject to the following two conditions:

- (1) This device may not cause harmful interference, and (2) this device must accept any interference received, including interference that may cause undesired operation. Changes or modifications not expressly approved by the party responsible for compliance could void the user's authority to operate the equipment

⚠️ RF warning for Mobile device:

This equipment complies with FCC radiation exposure limits set forth for an uncontrolled environment. This equipment should be installed and operated with minimum distance 20cm between the radiator & your body.