

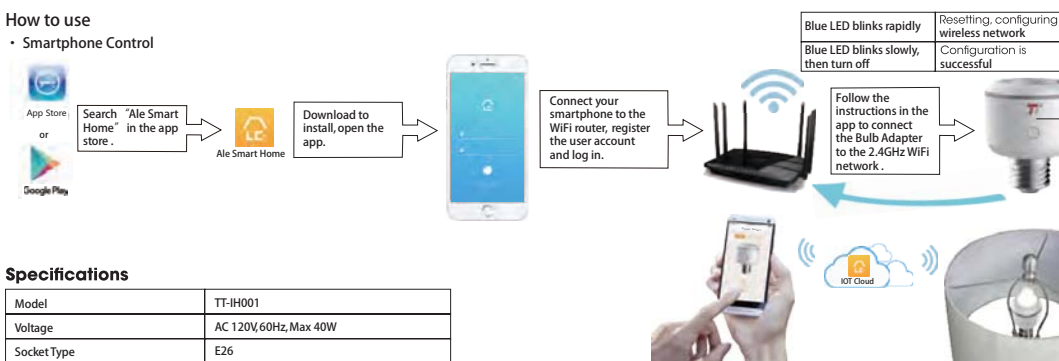

## TAOTRONICS BULB ADAPTER User Guide

### How to use

#### • Smartphone Control



### Specifications

Model	TT-IH001
Voltage	AC 120V, 60Hz, Max 40W
Socket Type	E26

TT-IH001

**TaoTronics**  
www.taotronics.com

**NORTH AMERICA**  
E-mail : support@taotronics.com(US)  
support.ca@taotronics.com(CA)  
Tel : 1-888-456-8468 (Monday-Friday: 9:00 - 17:00 PST)  
Address: 46724 Lakeview Blvd, Fremont, CA 94538

**ASIA PACIFIC**  
E-mail : support.jp@taotronics.com(JP)  
JP Importer: 株式会社ニアバイダイレクトジャパン

**EUROPE**  
E-mail:  
support.uk@taotronics.com(UK)  
support.de@taotronics.com(DE)  
support.fr@taotronics.com(FR)  
support.es@taotronics.com(ES)  
support.it@taotronics.com(IT)  
EU Importer: ZBT International Trading GmbH, Halstenbeker Weg 98C, 25462 Rellingen, Deutschland

### • Voice Control

Follow the Smartphone Control section above to configure the adapter with the WiFi router, then set up your Alexa as below to command and use the adapter through voice control.

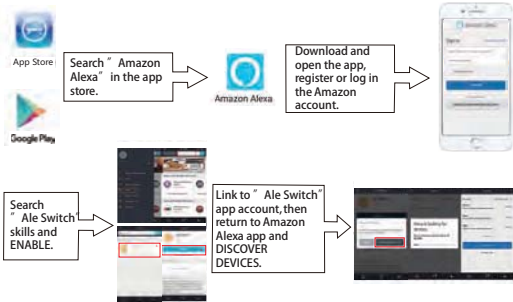

### Caution

1. Indoor use only.
2. Power off the unit first when changing the bulb, keep your hands dry and keep away from the screws.
3. We do not recommend to use bulbs with a capacity higher than 40W.  
Note: If used with a bulb higher than 40W, the adapter will cut off power automatically. To resume normal operation of the adapter:
  - 1) Switch off the AC power, wait for 10 minutes until the fuse cools off, then turn the power back on.
  - 2) Turn off the adapter through the app, wait for 10 minutes until the fuse cools off, then switch on the adapter through the app.
  - 3) Send a voice control signal to Alexa to shut off the adapter, wait for 10 minutes, then restart the adapter through the Alexa voice control.

**FCC STATEMENT**

1. This device complies with Part 15 of the FCC Rules. Operation is subject to the following two conditions:

- (1) This device may not cause harmful interference, and
- (2) This device must accept any interference received, including interference that may cause undesired operation.

2. Changes or modifications not expressly approved by the party responsible for compliance could void the user's authority to operate the equipment.

NOTE: This equipment has been tested and found to comply with the limits for a Class B digital device, pursuant to Part 15 of the FCC Rules. These limits are designed to provide reasonable protection against harmful interference in a residential installation. This equipment generates uses and can radiate radio frequency energy and, if not installed and used in accordance with the instructions, may cause harmful interference to radio communications. However, there is no guarantee that interference

will not occur in a particular installation. If this equipment does cause harmful interference to radio or television reception, which can be determined by turning the equipment off and on, the user is encouraged to try to correct the interference by one or more of the following measures:

Reorient or relocate the receiving antenna.

Increase the separation between the equipment and receiver.

Connect the equipment into an outlet on a circuit different from that to which the receiver is connected.

Consult the dealer or an experienced radio/TV technician for help.

**FCC Radiation Exposure Statement**

This equipment complies with FCC radiation exposure limits set forth for an uncontrolled environment. This equipment should be installed and operated with minimum distance 20cm between the radiator & your body