

封面

100.00 mm

# USER MANUAL

## 3-in-1 15W Wireless Charging Stand



**Note:** In order to make sure charging 3 devices safely and efficiently, you must use 9V/2A adapter (Qualcomm Quick Charger 2.0 or 3.0) and quick charge cable(if not use the appropriate adapter and quick charge cable, the charger may not charge phone or may not charge 3 devices simultaneously or may even damage the charger)

## PRODUCT INTRODUCTION

The 3 in 1 Wireless Charger is multi function charging station, you can charge three smart devices (Qi smart phone, iWatch and earbuds) on our product at the same time. It is compatible with Qi enable smart phone, iWatch, AirPods and most of Android earbuds.

It is unique design with elegant appearance, and perfect to use at office or at home. It is very convenient to charge your smart devices on our product, especially for Apple user. There is protection of over-charge and FOD function, you can enjoy your charging experience safely.

## PRODUCT APPEARANCE



## HOW TO USE

- 1.Plug in the Type-C cable to power on the wireless charger.
- 2.Put on your Qi enable devices to start charging.

## LED LIGHT INSTRUCTIONS

| LED status | Standby mode   | Phone Charging       | FOD                     |
|------------|--|----------------------|-------------------------|
| LED light  | Turn on the green light for 10 seconds and turn off the lights | Blue light breathing | Blue and green flashing |

## Wireless charging of multiple devices

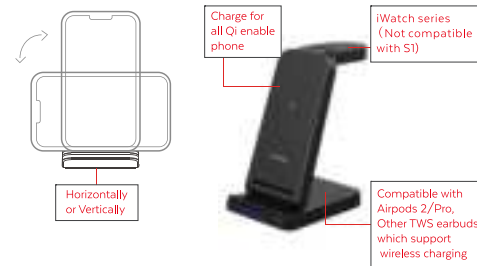

## PACKING LIST

- 1 X Wireless Charger
- 1 X Type-C quick charge cable
- 1 X User manual
- 1 X QC3.0 adapter

### APPLICABLE DEVICES

1. Smart Phone:
  - ① Apple: iPhone 13/14/15, iPhone 12/12 Pro, 12 Pro Max, 12 mini, SE, 11/11 Pro, 11 Pro Max, Xs, Xs Max, XR, X, 8, 8 Plus;
  - ② Samsung: Galaxy S: 21 5G, 21+ 5G, 21 Ultra 5G, FE 5G, 20 5G, 20+ 5G, 20 Ultra 5G, 10,10+ 10e, 9,9+, 8+, 7,7 edge, 6,6 edge, 6 edge+, 6 G20, 6 Active; Galaxy Note: 10,10e, 10+, 9,8,7,6,5;
  - ③ LG: G2/(VS980, Verizon version), G3, G6, G6+, G7, G7 ThinQ, G7+ ThinQ, G8, G8 ThinQ, V30, V30+, V35, V40 ThinQ, V50, V50 ThinQ, LG Lucid2 (VS870), LG Optimus F5 (As870), LG Optimus Vu 3, Spectrum 2, Optimus G Pro, Optimus VuII, Optimus LTE 2, etc.
  - ④ MOTOROLA: Droid Turbo, Droid Turbo2, Droid 5, Moto Maxx, Ultra M, Moto X Force.
  - ⑤ Huawei: P30 Pro, P40 Pro, P40 Pro+, Mate: 40E, 40 RS, 40 Pro+, 40 Pro, 40, 30E Pro, 30 5G, 30 Pro 5G, 30, 30 Pro, 30 RS, 20 Pro, RS;
  - ⑥ Xiaomi: 10,10 Pro, 9,9 Pro, Mix3, Mix2+;  
Including other devices with wireless charging receiver built-in;  
(Note: All devices must meet the Qi standard).
2. Smart Watch:
  - Apple: iWatch S2, S3, S4, S5, S6, SE.
3. Earbuds:
  - Apple AirPods 2, AirPods Pro,
  - Samsung Galaxy Buds/Buds+/Buds Pro/Buds Live;
  - Huawei Freebuds 2/3/4i/Pro; and more TWS (others Qi enable earbuds).

## PRODUCT SPECIFICATION

Input: 9V/2A  
Phone Output: 15W/10W/7.5W/5W  
Earbuds Output: 3.0W  
iWatch Output: 2.5W  
Input socket: Type-C  
Transmission Distance(Phone):  $\leq 8\text{mm}$   
Conversion Rate(Phone):  $\geq 73\%$   
Product Size: 132.51 X75X28.58mm



## FCC Warning

This device complies with part 15 of the FCC Rules. Operation is subject to the following two conditions:

- (1) This device may not cause harmful interference, and
- (2) this device must accept any interference received, including interference that may cause undesired operation.

Any Changes or modifications not expressly approved by the party responsible for compliance could void the user's authority to operate the equipment.

Note: This equipment has been tested and found to comply with the limits for a Class B digital device, pursuant to part 15 of the FCC Rules. These limits are designed to provide reasonable protection against harmful interference in a residential installation. This equipment generates uses and can radiate radio frequency energy and, if not installed and used in accordance with the instructions, may cause harmful interference to radio communications. However, there is no guarantee that interference will not occur in a particular installation. If this equipment does cause harmful interference to radio or television reception, which can be determined by turning the equipment off and on, the user is encouraged to try to correct the interference by one or more of the following measures:

- Reorient or relocate the receiving antenna.
- Increase the separation between the equipment and receiver.
- Connect the equipment into an outlet on a circuit different from that to which the receiver is connected.
- Consult the dealer or an experienced radio/TV technician for help.

The FCC certification of this device refers to RF exposure testing performed in typical operating conditions, where a person is not less than 20 centimeters from the device surface at all times, except for non-repetitive patterns with transient time intervals in the order of a second. Only in the stated conditions, the device is shown to fully comply with the FCC RF Exposure requirements of KDB 447498.