

EXHIBIT 1**IDENTIFICATION LABEL**

(Pursuant to FCC Part 2.907, 2.908 and RSP 100 Sec 3)

FCC / IC Identification Label

A representative image of the FCC / IC Identification label is shown below. This label is generated as part of the standard manufacturing process and is printed in the factory.

Much of the information that is on the label, such as serial number, model number, etc. is driven by the ordering process and is unique per customer order.

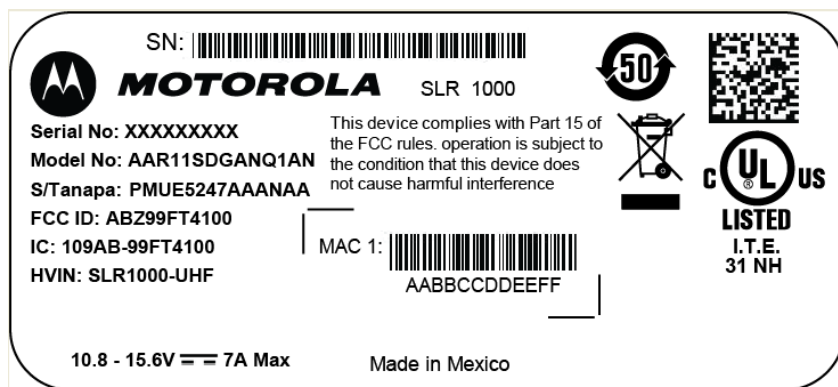

FCC / IC Identification Label

Equipment Label

The location of the identification label is on the back of the radio, as shown in the photograph below.

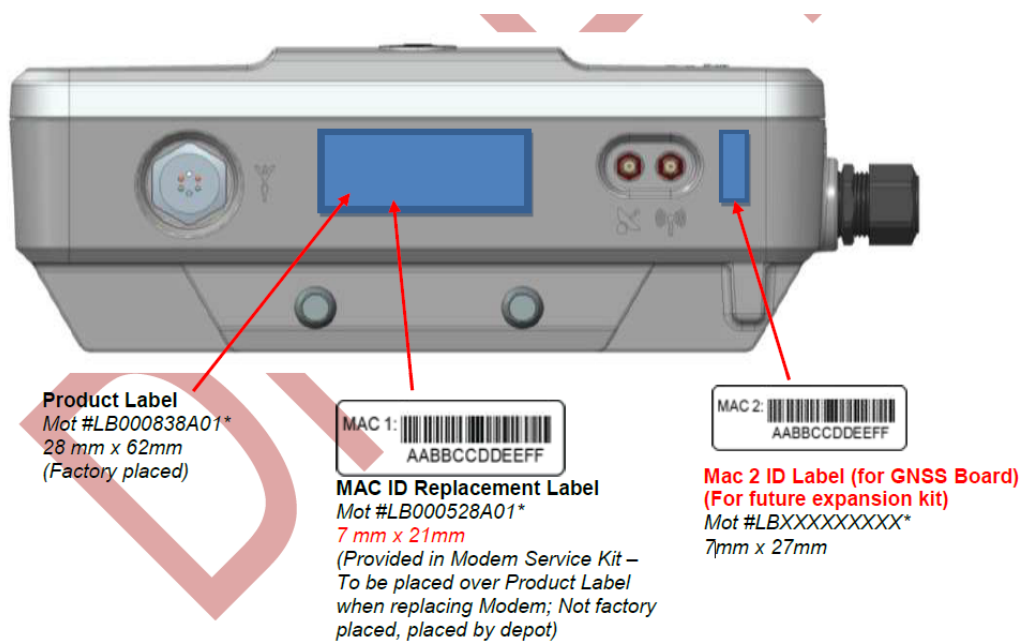

Product Label
Mot #LB000838A01*
28 mm x 62mm
(Factory placed)

MAC 1: [barcode]
AABCCDDEEFF

MAC ID Replacement Label
Mot #LB000528A01*
7 mm x 21mm
(Provided in Modem Service Kit –
To be placed over Product Label
when replacing Modem; Not factory
placed, placed by depot)

MAC 2: [barcode]
AABCCDDEEFF

Mac 2 ID Label (for GNSS Board)
(For future expansion kit)
Mot #LBXXXXXXXXXX*
7mm x 27mm