

User Manual



- ① bracelet and buckle
- ② Hardware frame
- ③ Hardware decoration accessories
- ④ hardware buttons
- ⑤ hardware buckle
- ⑥ 2.5D glass
- ⑦ charging terminal
- ⑧ heart rate indicator
- ⑨ charging indicator
- ⑩ plastic bottom case

●Product Functions

This is a smart wearable product combining low power consumption Bluetooth chip and high-tech sensor technology. The product can be used to monitor data related to sports and health such as walking, running, cycling, basketball, football, swimming, heart rate, sleep, sports track, etc., and synchronize time, weather, information and other push with multiple functions like find-phone function of mobile phone, sedentary reminder, and alarm reminder and so on.

●Operation Method

■Wearing Method



1. Wear the bracelet correctly according to the method shown in the picture.
2. Adjust and fasten the watch strap until comfortable and keep the heart rate indicator close to the

skin without loosening.

■Power on/off

Long press on the side button for 3S to get powered on and have the screen lit up. Then enter the main interface, find "Shut down" in the menu, and turn off by touching the menu.



■Device Connection

Make sure the bracelet is on, open the APP on the phone, and implement the device scanning. When the ID number corresponding to the bracelet is identified, confirm the link. When the link is successful, implement the data synchronization to the APP.

■Interface Switching

There are 4 main screens. Press the main screen for 3S and slide to have corresponding screens displayed. After selection, go back to main menu. The selected screen will be displayed accordingly.



■Step Counting

Real - time step counting is conducted. The device starts counting after 20 steps are taken, and will continue to provide synchronous step counting, which will be displayed synchronously on the APP, together with the corresponding data of mileage and calories burned.

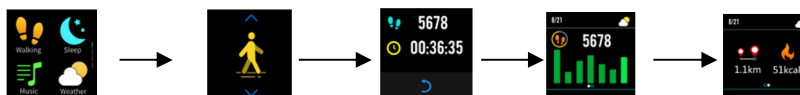

■Monitor of Heart Rate, Blood Pressure and Blood Oxygen

When switched to “heart rate”, the indicators of blood pressure and heart rate will flicker constantly. After 30S, automatic monitoring will be conducted with corresponding data displayed on the device and APP synchronously. When switch or return to another interface, the monitoring will be terminated.

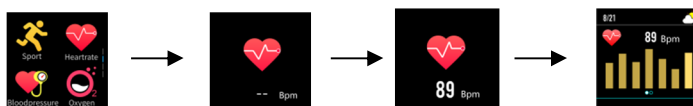

■Monitor of Motion Mode

Multiple motion modes



After entering any of the motion modes, click on 321 to start timing and click on “stop” at the end of exercises. The mileage, time and calories will be displayed accordingly.

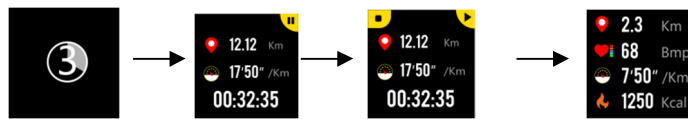

■ Sleep Monitoring

Set the corresponding sleep time, such as 8H, start time and end time in the APP.

At the end of the second day, the sleep status, the time of wakefulness, light sleep and deep sleep, and the corresponding comparison chart will be displayed in the APP.



■ More Settings

Brightness adjustment- 8 levels of brightness are provided. Slide up till the brightness adjustment menu appears, then increase the brightness by clicking clockwise and reduce the brightness by clicking anti-clockwise.



To query the product ID number and software version, slide to "Settings" and click to enter the "about" menu, and then the corresponding product ID number and software version will be displayed.

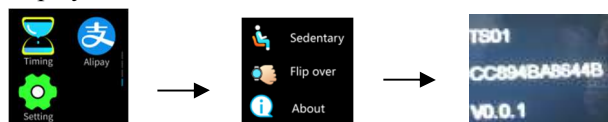

Flip over can be turned on in the settings of the watch and APP.

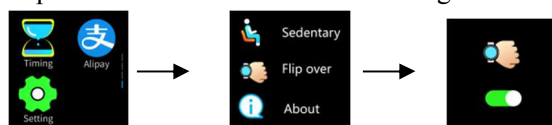

Sedentary reminder can be turned on in the settings of the watch and APP.

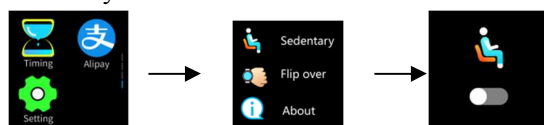

Stopwatch: Turn on stopwatch by clicking on the menu, click “start” to get it work and click “end” to terminate the stopwatch.

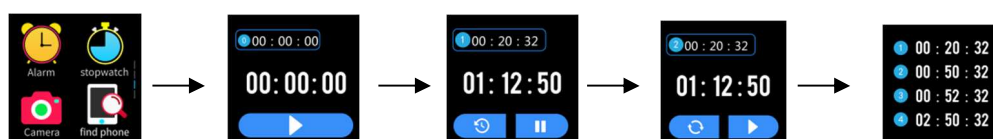

Alarm: Turn on the alarm by clicking on the menu, set the time and motor vibration reminder will

be activated at the set time.

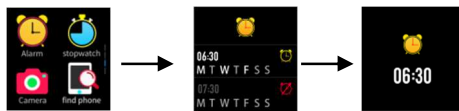

Find phone: Activate the function in the APP setting. When the phone cannot be found, the device will send reminders for searching by vibration within an appropriate distance.

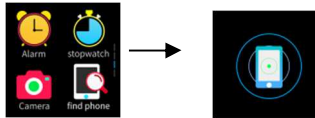

Music control: Open the function in the APP setting. Turn on the applied program of music player in the mobile setting, and previous/next/pause functions can be achieved accordingly.

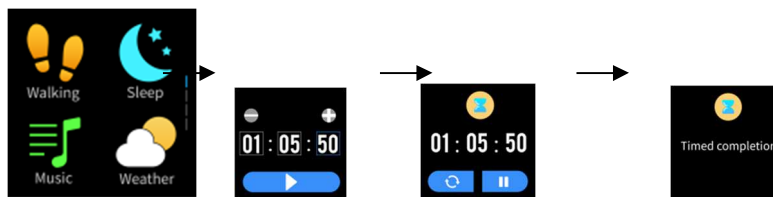

Cameral control: Open the function in the APP setting and turn on the applied program of camera in the mobile setting.

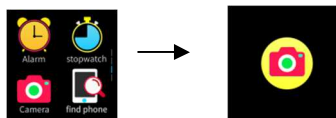

●Factory data reset: Find and click on “setting” till “About” is spotted, continue clicking till “Reset” is found. The device will be restarted after 3-5s.



●Charging: Plug one end of the magnetic USB charging cable into the 5V 500Mah charger port, and the other end directly to the charging contact point of the watch. The charging status is displayed while charging. Generally, it takes 2h to get fully charged.



● Installation and Operation of APP



Google play

Android APP

IOS APP

Scan the QR code below to identify the APP and install after downloading it directly from the Google play or App store.

Equipment requirements: IOS8.0 or above, Android 4.4 or above, support for Bluetooth 4.0

● Bluetooth connection: After the pairing is successful, the APP automatically saves the

Bluetooth address of the bracelet. After the APP is opened and runs in the background, it will automatically search and connect successfully.

- Data synchronization: Manually pull down to get synchronization data on the APP homepage, and the bracelet can store offline data of 7 days. The more data there is, the longer the synchronization time may be. After the synchronization is completed, there will be a corresponding prompt.

● **Cautions**

- Avoid strong impact, extreme heat and heavy rain
- Do not disassemble, repair or modify the machine by yourself.
- Use 5V 500Mh charging, and avoid using overload power supply voltage
- The operating temperature is 0-45 °. Do not throw into the fire to avoid explosions.
- Do not charge with wet hands, otherwise, oxidation of the charging hardware terminal may be caused, resulting in charging failure.
- Keep away from chemicals such as gasoline, cleaning solvents, propanol, alcohol or insect repellent.
- Do not use this product in high-voltage and high-magnetic environments.
- If you have sensitive skin or wear too tight, you may feel uncomfortable.
- Do not wear bracelet to take a hot bath.
- Please promptly wipe the sweat droplets on the wrist, as when the watchband is exposed to long time contact with soap sweat, allergens or contaminated ingredients, allergic itching may be caused to the skin.

● **FAQ**

- What can be done when the Bluetooth doesn't work? (connection failure/slow connection)
Make sure that your device supports Bluetooth 4.0 in IOS8.0 and Android4.4 or above
 1. Due to the problem of signal interference in wireless connection, the connection time may be too long. If the connection cannot be preceded for a long time, please make sure to operate in the environment without magnetic field or interference of multiple Bluetooth devices.
 2. Turn off Bluetooth and turn it on again.
 3. Restart the phone after turning off the applications.
 4. Do not connect other Bluetooth devices or functions to your phone at the same time.
 5. Check whether the APP is running normally in the background, otherwise, it may not be connected.

● **Unable to search for mobile phone**

1. If the Bluetooth is not searched by the phone, make sure the phone is powered and activated and not bound to other phones. Then close the bracelet to the phone. If it still doesn't work, please turn off the phone Bluetooth, and restart the Bluetooth after 20S.
2. Make sure the phone GPS is turned on.

● **Why wear a tight bracelet when measuring heart rate?**

The bracelet adopts the principle of light reflection and collects the signal reflected to the sensor after the light source penetrates the skin to calculate your heart rate. If you wear it loosely, there will be ambient light entering the sensor, which will affect the measurement accuracy.

● **Whether the bracelet is waterproof**

Support IP67 waterproof and dustproof (can be worn at will when washing hands and cars normally)

● **Basic parameters**

Device Model	TS01	Battery Type	Polymer
Display Screen	1.3 inches 2.5D	Battery Model	382227
Touch Screen	Full Touch	Battery Volume	180MAH
CPU	NRF52832	Bracelet Length	25cm
Waterproof Level	IP67	Weight	40G
Band Material	TPU/Silica Gel/Dermis Optional	Packaging List	Host, Charging Wire, Manual

This device complies with Part 15 of the FCC rules. Operation is subject to the following two conditions: 1) this device may not cause harmful interference, and 2) this device must accept any interference received, including interference that may cause undesired operation.

Changes or modifications not expressly approved by the party responsible for compliance could void the user's authority to operate the equipment.

Note: This equipment has been tested and found to comply with the limits for a Class B digital device, pursuant to part 15 of the FCC Rules. These limits are designed to provide reasonable protection against harmful interference in a residential installation. This equipment generates, uses and can radiate radio frequency energy and, if not installed and used in accordance with the instructions, may cause harmful interference to radio communications. However, there is no guarantee that interference will not occur in a particular installation. If this equipment does cause harmful interference to radio or television reception, which can be determined by turning the equipment off and on, the user is encouraged to try to correct the interference by one or more of the following measures:

- Reorient or relocate the receiving antenna.
- Increase the separation between the equipment and receiver.
- Connect the equipment into an outlet on a circuit different from that to which the receiver is connected.
- Consult the dealer or an experienced radio/TV technician for help.