



BATMAN™

Parent and Rider manual

STOP!

DO NOT RETURN TO STORE

**This product cannot be returned for a refund
after it has been unpacked and used.**

**Call us Toll-Free
at 1-866-424-0500 or Fax
us at 1-775-248-5155 for
assistance and information
from our
trained technical staff.**

**CAUTION-CHARGER IS A ELECTRONICALLY OPERATED PRODUCT:
Not recommended for children under 3 years of age. As with all
electric products, precautions should be observed during
handling and use to prevent electric shock.**

For assistance with your assembly call:
1.866.424.0500 toll-free
417.206.0563 Local

Ballard Pacific

With directions for assembly and operation

Please read this manual before assembly.
Remember to save your receipt.

Parent and Rider Manual

Suitable for 3+ Years



USE ON HARD SURFACE



TOLL FREE SERVICE HOTLINE
1-866-424-0500



12-volt Rechargeable Battery Powered Ride-on Toy



WARNING:

CHOKING HAZARD - Small parts.
Not for children under 3 years.

MAX WEIGHT: 130 LBS. (59 KG)

MAX RIDERS: 2

MAX SPEED: 5 MPH (8KPH) FORWARD

EASY PUSH-BUTTON OPERATION

12 VOLT BATTERY AND CHARGER INCLUDED.

WORKS ON HARD SURFACES AND GRASS.

CONTAINS LEAD ACID BATTERY



WARNING:

Adult assembly required.

RECHARGEABLE BATTERY INCLUDED

CONTAINS SEALED LEAD-ACID BATTERY. MUST BE RECYCLED OR DISPOSED OF SAFELY.
FOR FURTHER INFORMATION REGARDING THE BATTERY AND THE DISPOSAL OF THE BATTERY,
PLEASE CALL: 1-866-424-0500

REQUIRES ONE 12 VOLT LEAD ACID BATTERY (INCLUDED)

KEEP OPERATORS MANUAL FOR IMPORTANT SAFETY INFORMATION.

EC-2113



WARNING:

RISK OF FIRE. DO NOT BYPASS FUSE. REPLACE ONLY WITH SAME TYPE 35A FUSE BATTERY PACK. TO REDUCE RISK OF INJURY, NEVER USE IN ROADWAYS OR NEAR MOTOR VEHICLES. NEVER USE ON OR NEAR STEEP INCLINES OR STEPS. NEVER USE NEAR SWIMMING POOLS OR OTHER BODIES OF WATER. ALWAYS WEAR SHOES. NEVER ALLOW MORE THAN 2 RIDERS.
MAX WEIGHT: 130 LBS. (59 KG)

DISTRIBUTED BY:
Ballard Pacific Resources Inc.
1-866-424-0500 toll-free
or 417-206-0563 Local
410 Adele Joplin, Mo. 64801

Ballard Pacific

Ballard Pacific



Notes:

- **ADULT ASSEMBLY REQUIRED!**
- **Battery must be charged and connected before first use. see page 5.**
- The battery must be charged for at least 14 HOURS before the toy's first use. Disconnect the battery from the charger after 14 hours of charging. To start charging the battery before starting assembly, see Battery Charging and Installation information. See Battery Charging instructions on page 5.
- Use of any other 12 Volt battery or charger may damage the toy and will void the warranty. Please contact Customer Service at 1-866-424-0500 for replacement parts.
- Instruct children on safe operation and driving rules before they take their first ride:
 - Do not allow more than two riders at a time
 - Sit in the proper position in the toy when riding
 - Always wear shoes when riding the toy
 - Do not allow other children near the toy when riding
 - Do not place your hands, feet, or any part of your body, clothing, or other articles near moving parts while the toy is in operation.
- Instruct children to bring the toy to a complete stop before switching between forward and reverse.
- Do not overload the vehicle or exceed the maximum weight capacity of 130 lbs. (59 kg)
- For all questions, please contact us at **1-866-424-0500**.
- **Please read this manual completely for** operation and safety information before using the toy. Keep these instructions for future reference.

Ballard Pacific

Safety

Warnings and Cautions

WARNING: Electrical Hazard

RISK OF FIRE. Do not bypass the fuse. Replace only with the same 35A fuse (on battery pack).

- Only use a Ballard Pacific Resources, Inc. 12V lead-acid battery.
- Only use a Ballard Pacific Resources, Inc. 12V charger.
- Never modify the electrical system. Changes could cause a fire resulting in serious injury or death, and could also ruin the electrical system.
- Never lift or carry the battery by the wires or connectors. This can damage the battery and possibly cause a fire resulting in serious injury or death. Always use the battery holder to carry it.
- The battery should be handled by adults only. The battery is heavy and contains sulfuric acid (electrolyte). Always use the attached battery handle for carrying.
- Children should never be allowed to charge the battery. Charging the battery must be done by adults only. The electricity involved in charging the battery could injure a child.
- The motors will get hot, handle carefully.
- Each time you charge the battery, check the battery, charger, and its connectors for excessive wear or damage. Do not use the charger or the battery if damage or excessive wear is detected until you have replaced the worn or damaged parts.
- Carefully read the safety instruction about the battery.

WARNING: Riding Hazard

To reduce the risk of injury, adult supervision is required.

- Never use on roadways or near motor vehicles
- Never use on or near steep inclines or steps
- Never ride near swimming pools or other bodies of water
- Always wear shoes while riding
- Never allow more than 2 riders at a time
- Max. weight of 130 lbs. (59 kg)

WARNING: Charger

Changes or modifications to this unit not expressly approved by the party responsible for compliance could void the user's authority to operate the equipment.

NOTE: This equipment has been tested and found to comply with the limits for a Class B digital device, pursuant to Part 15 of the FCC Rules. These limits are designed to provide reasonable protection against harmful interference in a residential installation.

This equipment generates, uses and can radiate radio frequency energy, and if not installed and used in accordance with the instructions, may cause harmful interference to radio communications. However, there is no guarantee that interference will not occur in a particular installation. If this equipment does cause harmful interference to radio or television reception, which can be determined by turning the equipment off and on, the user is encouraged to try to correct the interference by one or more of the following measures:

- Reorient or relocate the receiving antenna.
- Increase the separation between the equipment and receiver.
- Connect the equipment into an outlet on a circuit different from that to which the receiver is connected.

Consult the dealer or an experienced radio/TV technician for help.

CAUTION:

- When fully unassembled, this package contains small parts. Adult assembly is required.
- Use the charger in dry, ventilated areas only.

For assistance with your assembly call:
1.866.424.0500 toll-free
417.206.0563 Local

Ballard Pacific

Safety

Riding Safety

WARNING: Adult Supervision Required

- Always Teach Safety First.
- While most children can develop the physical skills necessary to operate this toy, it is important to remember that they do not yet have mature judgment skills. Children should never be allowed to ride this toy without adult supervision. Before any child rides this toy, an adult must evaluate the child's skill levels and abilities to operate the toy safely. Even after instruction, hazards are not always anticipated or recognized by children. So before any child operates the toy, teach them appropriate safety rules.
- THERE IS NO SUBSTITUTE FOR DIRECT ADULT SUPERVISION.

WARNING: Safe Riding Rules

To reduce the risk of injury, adult supervision is required.

- Only sit on the seat.
- Always wear shoes.
- No more than two riders at a time.
- Do not operate on loose dirt, sand or gravel.
- Do not operate near drop-offs, obstructions, swimming pools or other bodies of water.
- Do not operate on roadways on the street or near moving vehicles.
- Do not operate on or near steep inclines or steps. Use on generally level ground only.
- Do not operate in the dark as unexpected obstacles could cause a crash.
- Do not operate on slopes. The toy may accelerate or roll backwards at unsafe speeds even if the pedal is released.
- Do not place anything near moving parts such as motors, gears or wheels. Rotating parts can snag hair, fingers, etc. causing serious injury.
- Do not operate near flammable vapors (such as gasoline, paint thinner, acetone, liquid wax, etc.).
- Electrical components can produce an internal spark when first turned on or off. Using the toy near flammable liquids or vapors could cause an explosion or fire resulting in serious injury or death.

Specifications

Suitable Age:	3+ years
Battery:	12V 12AH x 1
Charge Time:	10-12 hours
Charge:	Input: depends on local voltage output – DC 12v 1.0A
Load Capacity:	Under 130 lbs. (59 kg)
Car Size:	52" x 32" x 24" (1313 mm x 810 mm x 600 mm)
Speed:	5 MPH (8 KPH)

For assistance with your assembly call:
1.866.424.0500 toll-free
417.206.0563 Local

Ballard Pacific

Battery

Charging and Installation



**CAUTION: The battery and charger are not toys.
All battery charging must be done by an adult.**

The battery is located under the seat. Use the provided screwdriver to remove the seat.

- The battery must be charged 14 hours before its first use. The battery must be in the upright position before charging. Be very careful to avoid any contact to both terminals at the same time.
- To disconnect the battery, squeeze the tabs of the connector and pull. Hold the connectors firmly, and do not pull the wires.
- Connect the battery with the charger connector, then plug the charger into the wall outlet.
- Make sure to only plug the charger into standard 120V wall outlets. Use only the charger supplied. The charger has the rating: Input 120V AC, 60 Hz, Output 12V DC, 1.0A.
- You must recharge the battery for at least 10-12 hours after each time you use the toy. Disconnect the battery from the charger in time after the battery is fully charged.
- Disconnect the battery from the charger and then the charger from the wall outlet. Reconnect the battery connector with the motor harness connector. Be sure they are locked together. If you are not going to use the toy for a long period of time, make sure you recharge the battery at least once a month.
- Never lift or carry the battery by the wires or connector, this can cause damage. Only carry the battery using the provided handle. The battery compartment is not a storage area. Storing other articles in the battery compartment may create a fire hazard.
- Do not charge or store the battery upside down. Charging the battery produces explosive gases. Make sure to charge the battery away from flames, sparks, and lit cigarettes. Always charge in a well ventilated area.

CARE

- Always charge the battery before storing the toy for a long period of time. Make sure to charge the battery at least once a month, even if the toy is not being used.
- Never let the battery run down completely before charging.
- Never leave the battery in a discharged condition. It may cause permanent damage.
- Never store the battery in temperatures above 75°F (28.8°C) or below 10°F (12.2°C).
- Never allow the battery to move freely inside the battery compartment.
- Before each charge, examine the battery, charger, and their connectors for excessive wear or damage. If you find damage, do not use the battery or charger until you have replaced the worn or damaged part.
- Make sure to remove an exhausted battery from the toy. Battery leakage and corrosion can damage the toy.

DISPOSAL

- Your toy's battery is a sealed lead-acid battery. You must recycle or dispose of it in an environmentally sound manner.
- Never dispose of your battery in the regular, household trash. The incineration, land-filling, or mixing of a sealed lead-acid battery with your household trash is prohibited by law in most areas.
- Make sure to return exhausted batteries to a federal or state approved lead-acid battery recycler, or contact Ballard Pacific Resources, Inc. at 1-866-424-0500.
- Always remove exhausted batteries from your toy. Dispose of dead batteries properly; never burn or bury them.
- Contact Customer Service at 1-866-424-0500 for a replacement battery. You will receive free shipping with the purchase of a battery.
- To locate a battery service center, contact your local waste management company.
- Do not mix old and new batteries.
- Do not mix alkaline, standard (carbon-zinc) or rechargeable (nickel-cadmium) batteries.

For assistance with your assembly call:
1.866.424.0500 toll-free
417.206.0563 Local

Ballard Pacific

Battery Charging

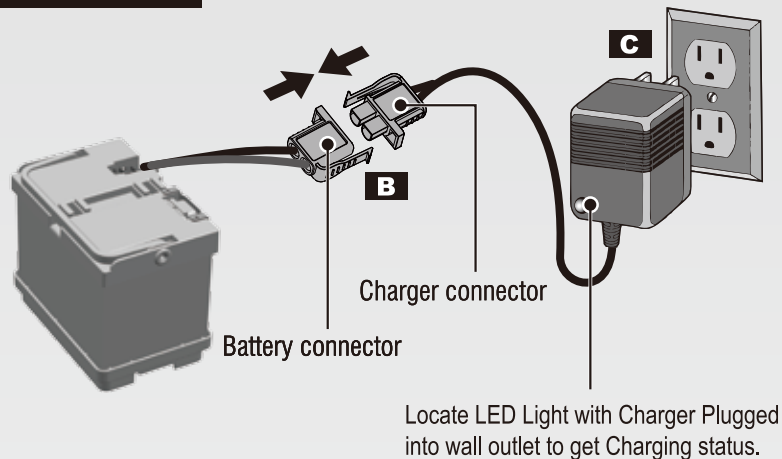
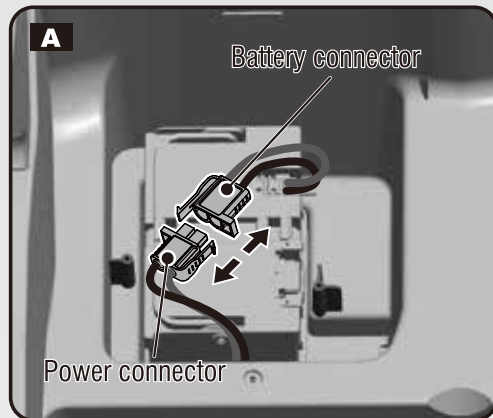

Recharging the Battery

- Remove the seat. Disconnect the battery connector from the power connector.
- Connect the battery connector to the charger.
- Plug the charger into a wall outlet. The red light shows the battery is charging. The green light on shows the battery is charged. After recharging, reconnect the battery connector to the power connector and replace the seat.

LED Color Light Signals:

- Alternating Red to Green = Bad Battery Connection.
- LED Light is showing Red = Battery Charging.
- LED Light is showing Green = Battery Charged.
- If LED Light shows no color leave battery to charge for 1 hour. If still there is no LED Light signal the battery has failed.

Changing The Fuse

Follow these steps to check the fuse:

- Remove the screws on the top of the blue fuse baffle with a screwdriver.
 - Remove the blue fuse baffle.
 - Remove the black cover.
 - Pull the fuse out. Hold the fuse up to see if the metal conductor is broken or melted. It is not always possible to confirm a damaged fuse visually. You may want to install a replacement even if the fuse appears to be good.
- Replace the fuse: Remove one of the spare fuses from the top of the battery case. Insert it in the location of the old fuse. Discard the old fuse. Replace the blue fuse baffle and the black fuse cover. Reinstall the seat using a screwdriver. Diagram 5 on page 10.

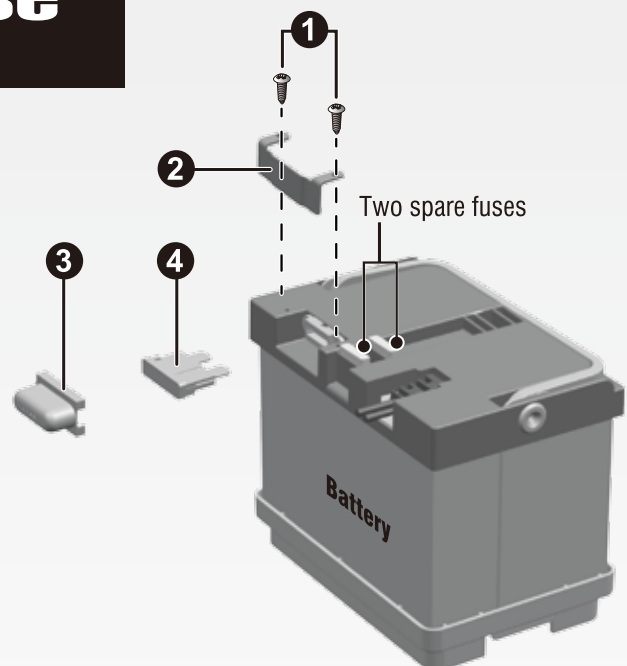

For assistance with your assembly call:
1.866.424.0500 toll-free
417.206.0563 Local

Ballard Pacific

Parts

Pre-assembly Part and Tool Identification

All items on this page are included in this package.
Metal parts have been coated with a lubricant to protect them during shipment.
Wipe all metal parts with a paper towel to remove any excess lubricant.



Vehicle body



Seat



Rear wheels



Front wheels



Wheel cover caps X 4



Steering wheel

Tools

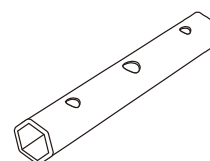

Socket wrench X 2



Screwdriver X 2

For assistance with your assembly call:
1.866.424.0500 toll-free
417.206.0563 Local

Ballard Pacific

Assembly

⚠ WARNING: Adult assembly required.

⚠ WARNING: CHOKING HAZARD - Small parts. Not for children under 3 years.

Children can be harmed by small parts, sharp edges and sharp points in the vehicle's unassembled state, or by electrical items. Care should be taken in unpacking and assembly of the vehicle. Children should not handle parts, including the battery.

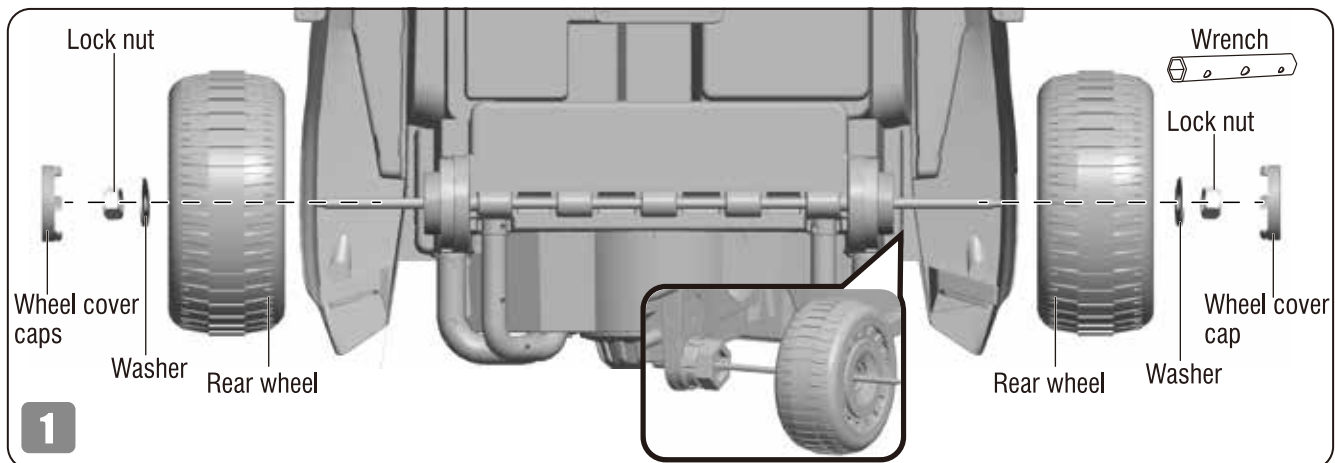

Install Rear Wheels

Remove the nuts from the Rear axle using the wrench provided, pull off the small washers. Place the rear wheels on the axle. Make sure the rear wheel, the gear box and wheel connectors are well connected. Insert a washer and a nut at each end of the rear axle then tighten with wrench provided at the same time. Add the wheel cover cap on the place as shown in Diagram 1.

For assistance with your assembly call:
1.866.424.0500 toll-free
417.206.0563 Local

Ballard Pacific

Assembly

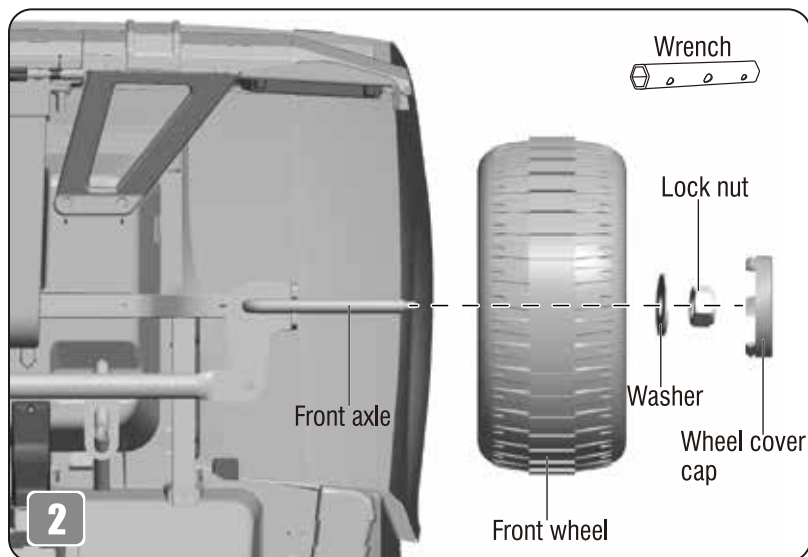

Install Front wheels

Remove the nut from the front axle using the wrench provided. Pull off the small washer. Place the front wheel on the axle. Replace the small washer and lock nut on the axle and then tighten. Put the wheel cover cap in place as shown in Diagram 2.

Repeat this on opposite side.

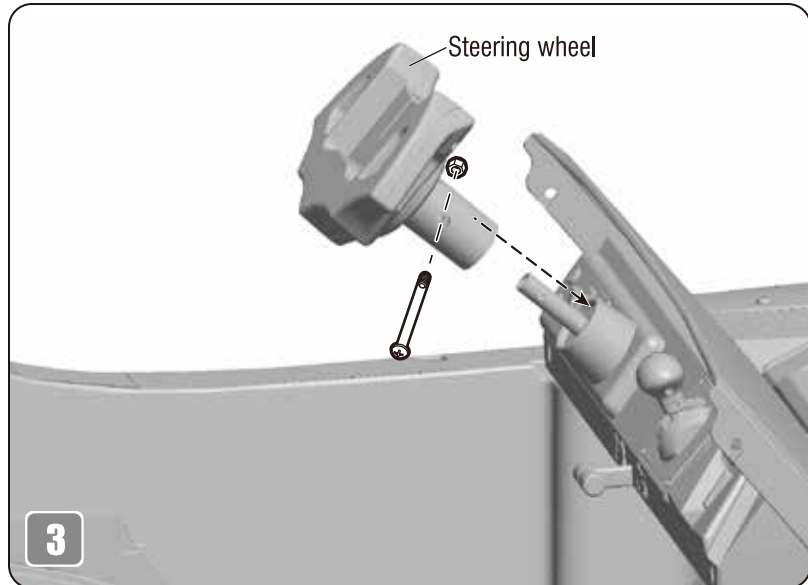

Install Steering Wheel

Locate the steering wheel. Remove the screw and nut on the steering wheel, then align the hole on the steering wheel with the steering bar and insert it. Make sure the screw holes on the steering wheel and the steering bar are on the same line to tighten the screw easily. Diagram 3

For assistance with your assembly call:
1.866.424.0500 toll-free
417.206.0563 Local

Ballard Pacific

Assembly

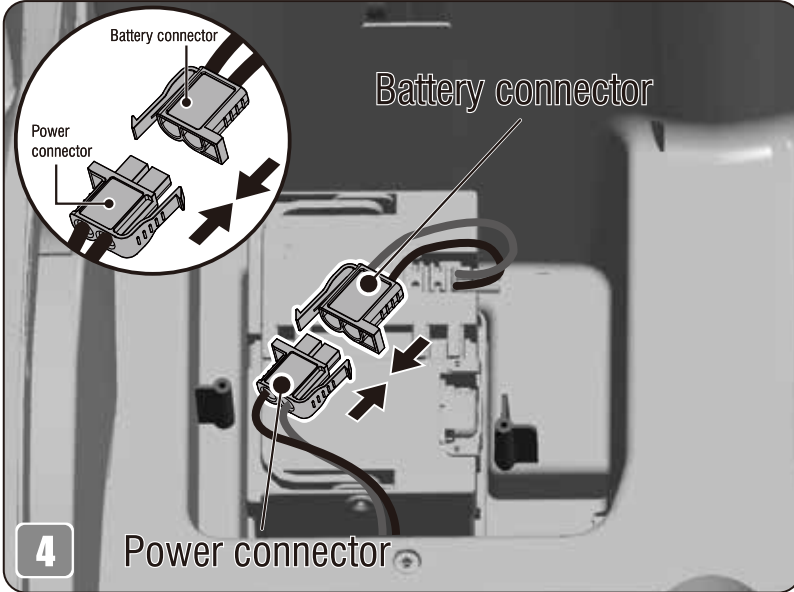

Connect Power Supply

Identify the battery connector and power cable. Align the positive and negative connections and press the connectors together. Do not force the connection. If they do not go together smoothly, double check the alignment to be sure that positive is connecting to positive and negative to negative.

Diagram 4

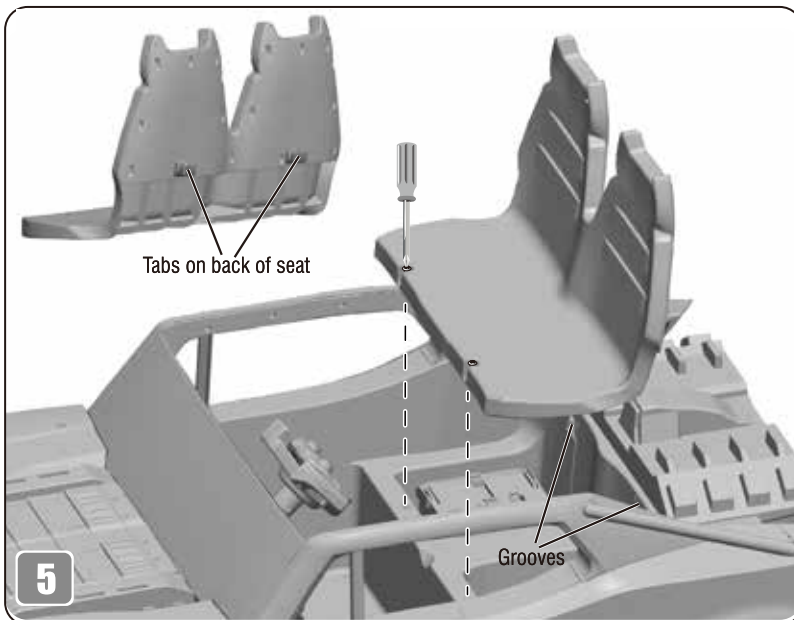

Install Seat

Insert the tabs on the back of the seat into the grooves in the vehicle body and slide the seat into place. Then tighten the two screws with a screwdriver.

Diagram 5

For assistance with your assembly call:
1.866.424.0500 toll-free
417.206.0563 Local

Operation

Functions

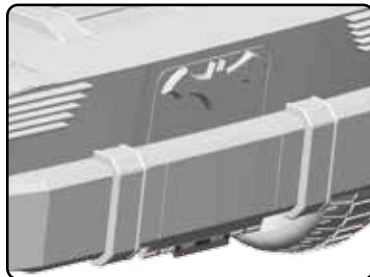
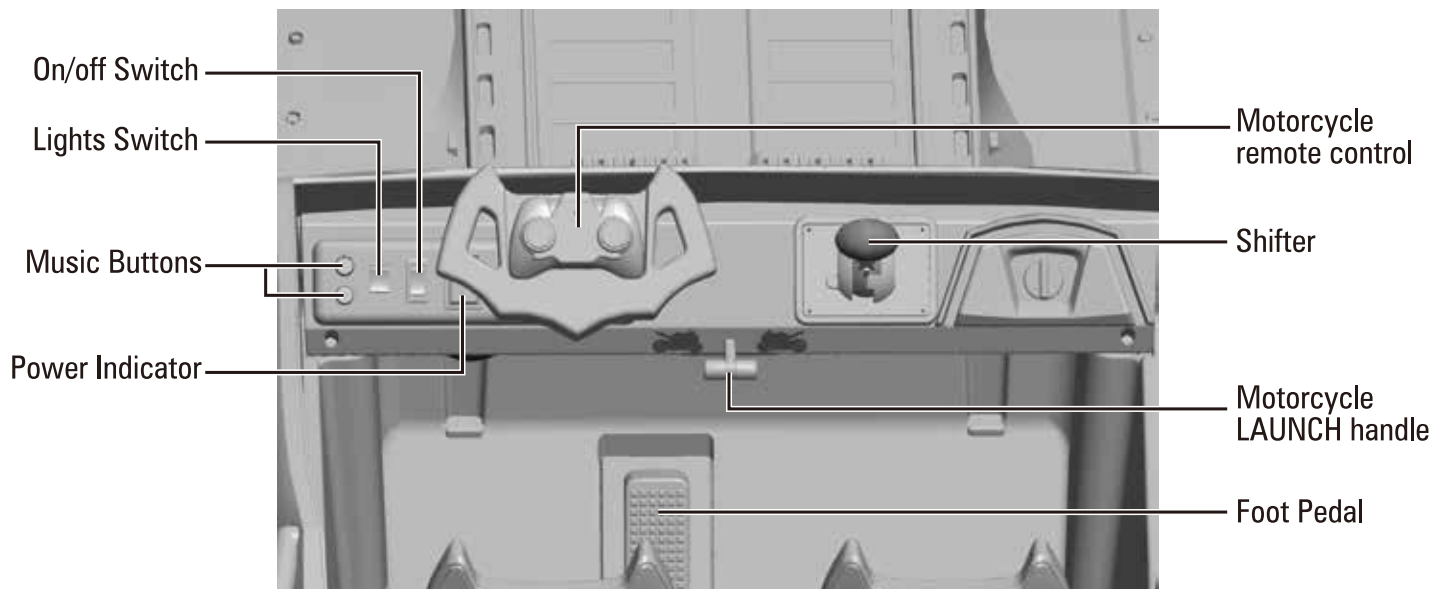

Note: Ensure the motorcycle launch door is completely closed as shown in the picture.

There is a safety switch that stops the toy while the motorcycle door is open.

Power Indicator

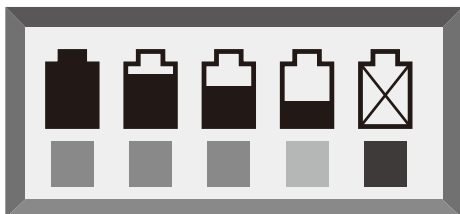

Hint: For the most accurate reading, do not operate the vehicle and ensure the vehicle is stop.

Check the power level of your battery:

- ■ ■ ■ ■ All five lights means the battery is 100% (fully) charged.
- ■ ■ ■ ■ Four lights means the battery is 75% (mostly) charged.
- □ ■ ■ ■ Three lights means the battery is 50% charged.
- □ □ ■ ■ Two lights means the battery is 25% charged. We recommend recharging your battery for 10-12 hours.
- □ □ □ ■ One or no lights means the battery needs charging. Fully charge your battery for 10-12 hours.

For assistance with your assembly call:
1.866.424.0500 toll-free
417.206.0563 Local

Ballard Pacific

Operation

Motorcycle function

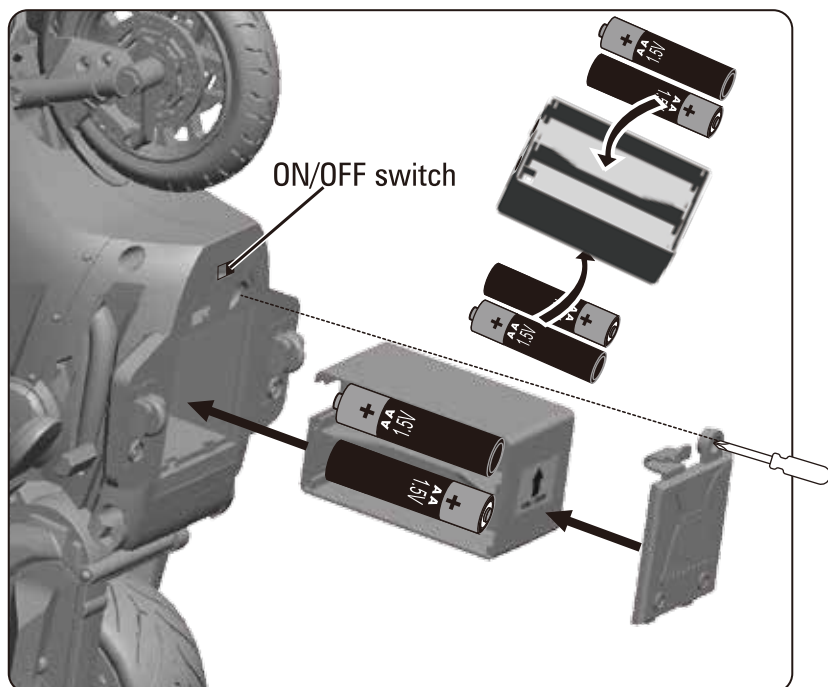

Install battery

Loosen the screw at the bottom of the motorcycle with a screwdriver, remove the battery cover, then take out the battery box.

Insert 4 AA 1.5V batteries correctly, Follow the (+/-) diagram in the battery compartment. Place the battery box back into the bottom of the motorcycle. Ensure the battery box contacts are aligned with the motorcycle contacts. Replace the battery cover and tighten the screw.

Turn on the switch to ON position when use.

NOTE: To save battery power, turn switch to OFF position.

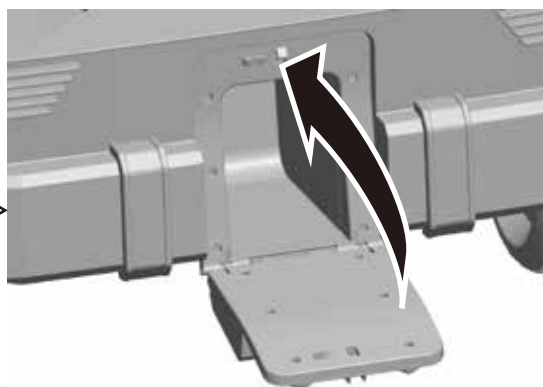
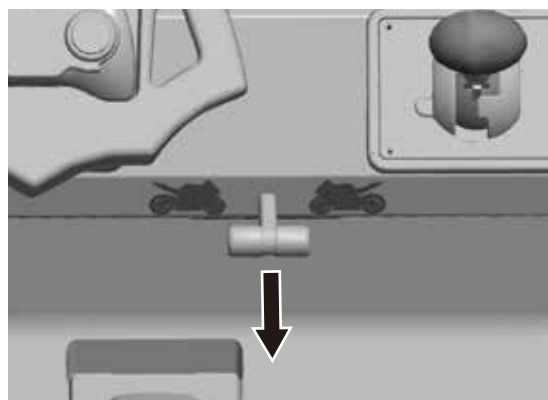

Pull the LAUNCH handle to open the motorcycle launch ramp located at the front of the vehicle.

This is also the motorcycle storage bay. Please note, when the ramp is down, the safety switch is activated and the vehicle will not function. Ensure the ramp is completely closed to reactivate the vehicle.

For assistance with your assembly call:
1.866.424.0500 toll-free
417.206.0563 Local

Ballard Pacific

Operation

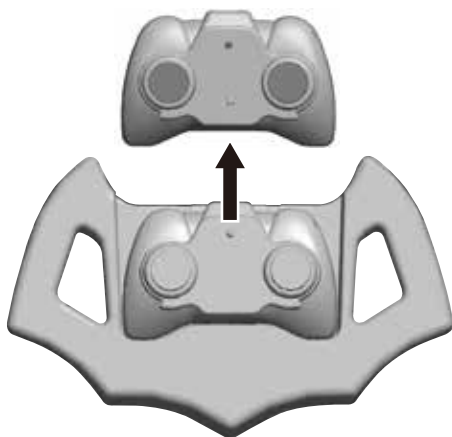

Push the remote control on the steering wheel up as shown in left diagram and remove the remote control. Press the remote control in opposite direction to replace it when you don't use.

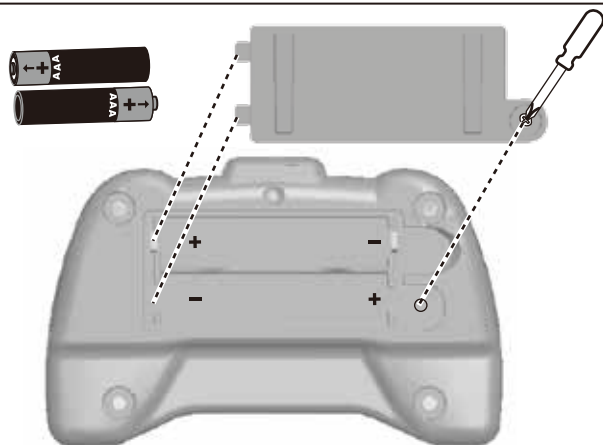

Loosen the screw at the back of remote control and remove the battery cover. Then insert 2 AAA 1.5V batteries. Follow the polarity(+/-) diagram in the battery compartment. Replace the battery cover and secure with the screw.

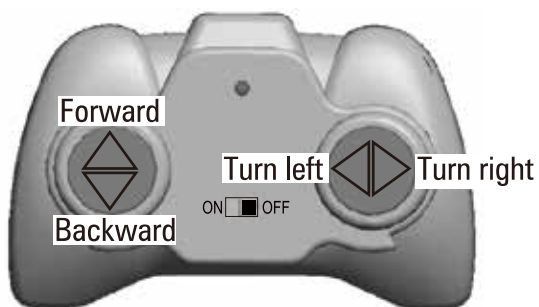

Press the switch to the "ON" position and ensure the switch of motorcycle turned on at the same time, then you can operate the motorcycle by remote control.

For assistance with your assembly call:
1.866.424.0500 toll-free
417.206.0563 Local

Ballard Pacific

Operation

Speed Settings and How to Ride Your Toy

Low Speed Drive

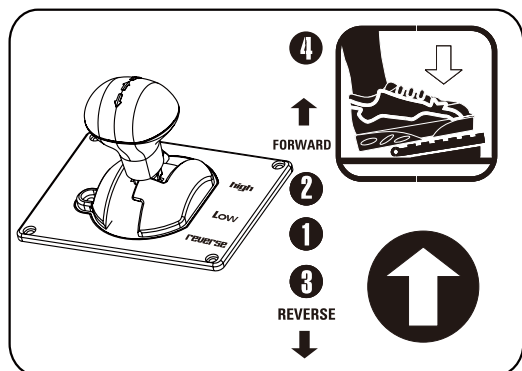

- Make sure the shifting knob is set to the Low position. ①
- Press down on the foot pedal. ④ The vehicle will move forward at a maximum speed of 2.5 mph.
- Help your child practice steering to learn how long and how fast to turn the steering wheel when driving forward in low speed.

High Speed Drive

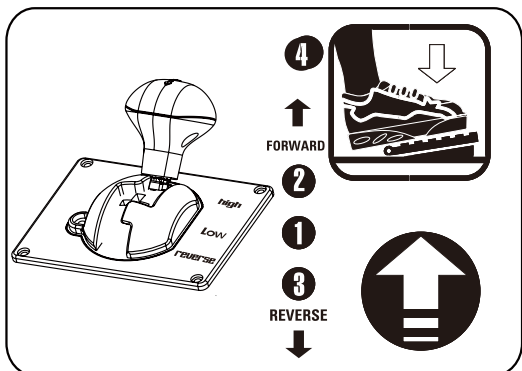

- Make sure the shifting knob is set to the High position. ②
- Press down on the foot pedal. ④ The vehicle will move forward at a maximum speed of 5 mph.
- High speed drive should only be used once Low Speed Drive and Reverse have been mastered.

Reverse

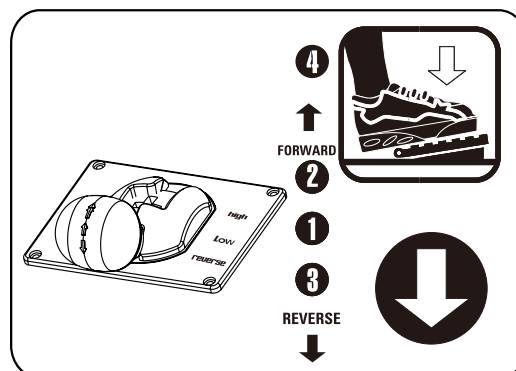

Note: To avoid damaging the motors and gears, stop the vehicle before shifting from forward to reverse, or reverse to forward.

- Only after your child is completely comfortable with operating the vehicle in forward mode should you introduce reverse.
- Make sure the shifting knob is set to the Reverse position. ③
- Press down on the foot pedal. ④ The vehicle will go in reverse at a maximum speed of 2.5 mph.

CAUTION: To avoid damaging your vehicle's gearbox when in forward gears, avoid shifting directly into reverse until the vehicle has come to a complete stop.

Please take attention that changes or modification not expressly approved by the party responsible for compliance could void the user's authority to operate the equipment.

This device complies with Part 15 of the FCC Rules. Operation is subject to the following two conditions:

- (1) This device may not cause harmful interference, and
- (2) This device must accept any interference received, including interference that may cause undesired operation.

For assistance with your assembly call:
1.866.424.0500 toll-free
417.206.0563 Local

Ballard Pacific

Maintenance

Vehicle Care

Check all screws, cap nuts and protective coverings regularly and tighten as required. Check plastic parts on a regular basis for cracks or broken pieces.



During snow or rainy weather, the vehicle should be stored inside or under a protective cover. Remember to charge the battery at least once per month while your vehicle is not in regular use.



Avoid operating the vehicle in wet or snowy conditions and do not spray the vehicle with a hose. Do not wash the vehicle with soap and water. Water or moisture in the motors or electrical switches can cause them to corrode and could cause switch or motor failure.



Avoid operating the vehicle on sand, loose dirt or gravel. sand, loose dirt or gravel in the motors or electrical switches can cause them to jam and could cause switch or motor failure.



The vehicle can be wiped down with a soft, dry cloth. For a shiny finish, you can wipe plastic parts with a non-wax furniture polish applied to a soft-cloth. Do not use automotive wax. Do not use soap and water or spray the vehicle with a hose.



For assistance with your assembly call:
1.866.424.0500 toll-free
417.206.0563 Local

Ballard Pacific

Parts

Parts Diagram Exploded View

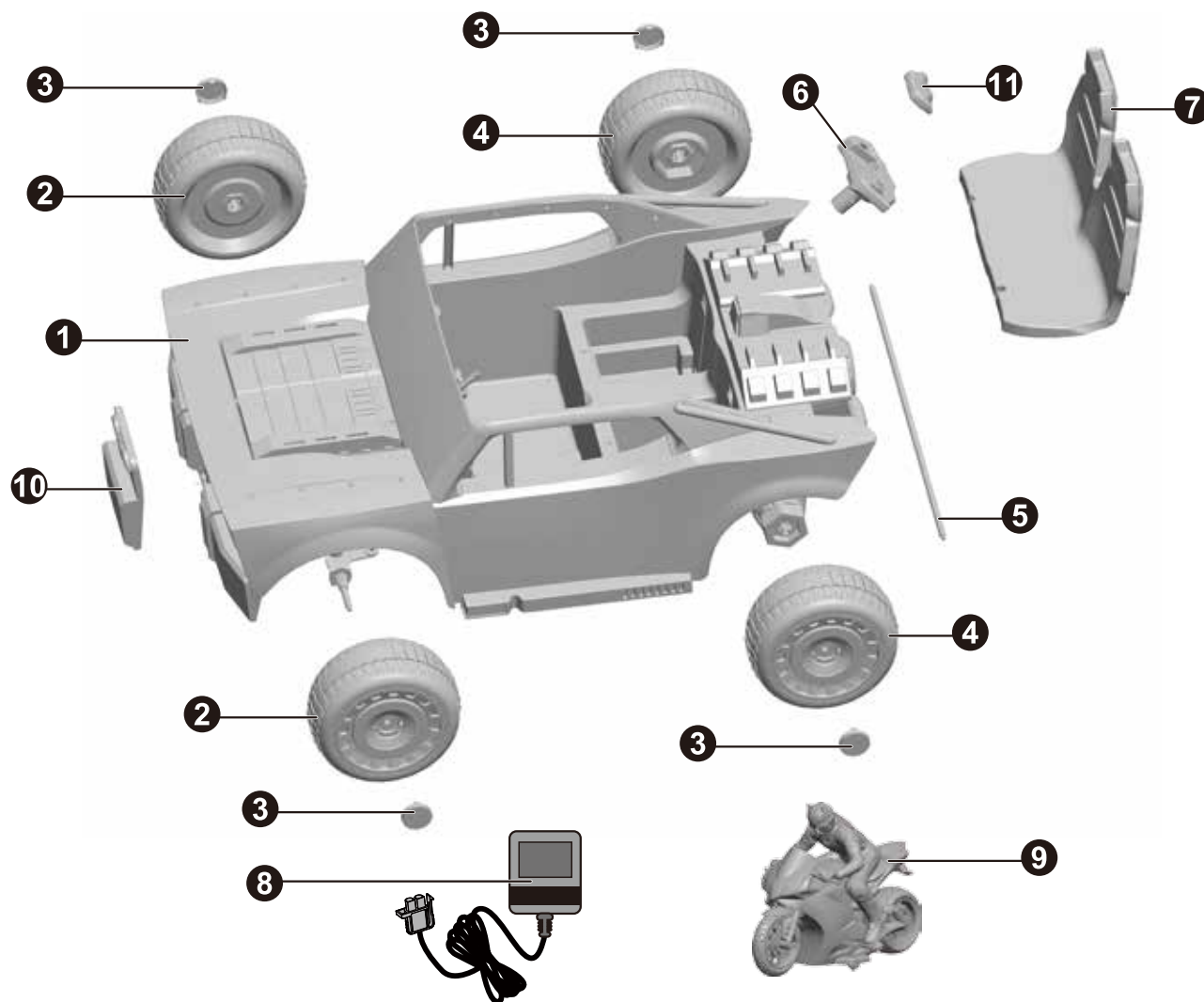

1. Vehicle body	2. Front wheel	3. Wheel cover caps
4. Rear wheel	5. Rear axle	6. Steering wheel assembly
7. Seat	8. Charger	9. Motorcycle
10. Launch ramp	11. The motorcycle remote control	

For assistance with your assembly call:
1.866.424.0500 toll-free
417.206.0563 Local

Ballard Pacific

Troubleshooting

Solutions Guide

Problem

Ride-On Toy does not move

Possible Cause

Circuit breaker tripped

Solution

Circuit breaker may trip and stop the toy if it is overloaded or if the driving conditions are too severe. The breaker will automatically reset after approximately 25 seconds, and the toy will operate normally. To avoid repeated shut down, don't overload the toy by exceeding the weight limit of 130 lbs. (59 kg), or by towing anything behind the toy. Don't drive up steep hills or run into objects, which can cause the wheels to stop turning while power is still being supplied to the motor. If breaker continually trips, contact Ballard Pacific Resources, Inc. at 1-866-424-0500.

Loose wire or connectors

Check all wires and connectors. Make sure that the motor harness connector is plugged in tightly to the battery, and that there are no loose wires around the motor.

Dead battery

An old or improperly cared for battery may be dead. If you're not sure whether it is dead or not, contact Ballard Pacific Resources, Inc. at 1-866-424-0500.

A new battery must be charged for at least 14 hours before using the toy for the first time. After that, it must be recharged for at least 10-12 hours after each use. Disconnect the battery from the charger in time after the battery is full charged. Check all connectors, and make sure the charger is plugged into the wall. Make sure the power flow to the wall outlet is on.

If you think there may be a problem with the charger, contact Ballard Pacific Resources, Inc. at 1-866-424-0500.

Electrical switch damage

When exposed to water or moisture, electrical switches can become corroded, or can jam due to loose dirt, sand or gravel. Call Ballard Pacific Resources, Inc. at 1-866-424-0500 for diagnosis and repair.

Motorcycle door is not closed

Ensure the motorcycle launch door is completely closed.

Ride-On Toy does not run

Loose wire or connectors

Check all wires and connectors. Make sure that the motor harness connector is plugged in tightly to the battery, and that there are no loose wires around the motor.

Circuit breaker tripped

Circuit breaker may trip and stop the toy if it is overloaded or if the driving conditions are too severe. The breaker will automatically reset after approximately 25 seconds, and the toy will operate normally. To avoid repeated shut downs, don't overload the toy by exceeding the weight limit of 130 lbs. (59 kg), or by towing anything behind the toy. Don't drive up steep hills or run into objects, which can cause the wheels to stop turning while power is still being supplied to the motor. If breaker continually trips, contact Ballard Pacific Resources, Inc. at 1-866-424-0500.

Fuse burn

Please refer to "Changing the fuse".

SHORT OPERATING TIME

NOTE: Although the maximum weight capacity is 130 lbs. (59 kg), riders over this weight capacity may significantly reduce the vehicle's run-time per charge

Undercharged battery

A new battery must be charged for at least 14 hours before using the toy for the first time. After that, it must be recharged for at least 10-12 hours after each use. Disconnect the battery from the charger in time after the battery is full charged. Check all connectors, and make sure the charger connector is plugged into the battery. Also check that the charger is plugged into the wall. Make sure the power flow to the wall outlet is on.

Old battery will not accept full charge

Rechargeable batteries don't last forever, even with proper care. Depending on toy use and use conditions, the average battery lasts 1 to 3 years. Replace an old battery with a new Ballard Pacific Resources, Inc. approved 12V battery. Contact Customer Service for a replacement battery and receive free shipping with the purchase of a battery. Never substitute parts.

For assistance with your assembly call:
1.866.424.0500 toll-free
417.206.0563 Local

Ballard Pacific

Limited Warranty

**DON'T RETURN YOUR
VEHICLE TO THE STORE.**

Product needs to be returned in original packaging and unused as purchased from your retail store and include the following items to validate your limited warranty.

1. Two items must be presented:
 - a. YOUR PRODUCT REGISTRATION FORM OR CARD.
 - b. COPY OF YOUR PURCHASE OR SALES RECEIPT.
2. Products must be new and unused.
3. Products must be shipped back with original packing, parts and accessories.

If any part be found missing when returned, each part cost (list on Service Manual) will be deducted from the product purchase amount of money.

Ballard Pacific Resources, Inc. offers the following limitations, terms and conditions to the original owner of the Ballard Pacific Resources, Inc. Electric Ride-On Toy. Should this Ballard Pacific Resources, Inc. Electric Ride-On Toy or any part be determined defective by Ballard Pacific Resources, Inc. to be covered by this limited warranty, it will be repaired or replaced at Ballard Pacific Resources, Inc. sole option, which will be conclusive and binding. Ballard Pacific Resources, Inc. will pay all labor costs, connected with the repair or replacement of all parts covered under this limited warranty. Under no circumstances does this limited warranty include the cost of travel or shipment to and from any retailer or consumer. Such cost, if any, shall be borne by the original or subsequent owner.

This Ballard Pacific Resources, Inc. Electric Ride-On Toy has not been designed or engineered for ramp riding, jumping, aggressive riding, in severe climates or over severe terrain, riding with heavy loads (over 130lbs. or 59 kg) or any similar activities. Such uses may damage the Ballard Pacific Resources, Inc. Electric Ride-On Toy, that can cause serious injury to the rider and in all cases will void this warranty.

6 Months from the date of the purchase on vehicle

Ballard Pacific Resources, Inc. Electric Ride-On body, display throttle and throttle assembly, control wiring harness, wiring and wiring harness, motor and associated transmission and all components not directly associated with the 12V battery are warranted from 6 months from date of purchase to THE ORIGINAL PURCHASER against any defects in material, manufacturing, and/or workmanship. If there is any evidence of consumer repair, the warranty is voided. Any claim of damage under this clause cannot be due to owner abuse or neglect and must first be reported to Ballard Pacific Resources, Inc. Customer Service and a Return Merchandise Authorization (RMA) tag to be issued.

3 Months from the date of the purchase on battery

The battery must be charged for a full 14 hours before the unit's first use. Disconnect the battery from the charger after 14 hours of charging. The 12V battery and battery charger (AC Adapter) that is included with the original toy is warranted to be free from defects in material, parts and/or workmanship, again not due to owner abuse or neglect. If there is evidence of customer repair or use of another battery or charger, the warranty is voided. This limited warranty is only valid to the original purchaser and must first be reported to Ballard Pacific Resources, Inc. Customer Service and a Return Merchandise Authorization (RMA) tag to be issued.

Wheels are considered a wear and tear item and are only under warranty in the event of manufacturer defect.

Items not covered under warranty terms under any conditions:

1. Damage due to failure to maintain the battery as accurately described on various product warning stickers and the product's owner's manual.
2. Damage due to maintenance or the actual damage caused by the lack of maintenance.
3. Damage due to improperly assembled products.
4. Damage due to climatic or environmental damage, various cleaners and/or chemicals that may result in a damaged finish.

This warranty does not cover and is intended to exclude any liability on the part of Ballard Pacific Resources, Inc. Whether under this warranty or implied by law or indirect or consequential damages for breach of warranty.

This warranty gives you specific legal rights. You may also have other rights that vary from state to state and province to province. In those states that do not allow the exclusion of implied warranties or limitation of incidental or consequential damages, the above limitations or exclusions may not apply to you. This warranty applies to the United States and Canada.

DON'T RETURN YOUR TOY TO THE STORE: Should you require service or assistance with your toy during the warranty period, contact our trained technical staff at Ballard Pacific Resources, Inc. at 1-866-424-0500.

For assistance with your assembly call:
1.866.424.0500 toll-free
417.206.0563 Local

Product Registration

Note:

Activation of your warranty gives you FREE telephone and online technical service help. Please fill out registration below and immediately mail with your sales receipt to:

Ballard Pacific Resources, Inc.
410 S. Adele Avenue
Joplin, MO 64801



BATMAN and all related characters and elements © & ™ DC Comics.
DC LOGO: TM & © DC. WB SHIELD: TM & © WBEI. (s22)

Designed, manufactured and distributed by **Ballard Pacific Resources**.
All rights reserved.



For a record of your purchase fill in immediately and send to:
410 S. Adele Ave. Joplin, Mo. 64801



Ballard Pacific Resources, Inc.

Owners Name: _____ (PLEASE PRINT)

Address: _____ (PLEASE PRINT)

City: _____ **State:** _____ **Zip:** _____

Tel: _____ **E-mail:** _____

Date Purchased: _____ **Place of Purchase:** _____

Model Name: _____

Serial Number: _____

For assistance with your assembly call:
1.866.424.0500 toll-free
417.206.0563 Local

Ballard Pacific