

材质：128g双铜纸，4C印刷，风琴折(封面在最上面)

130.00 mm -

-95.00 mm

UHF Wireless Instrument Microphone N90 User Manual

Please Read The Instruction Carefully Before You Use It

A diagram of a handheld radio with numbered callouts 1 through 8. The callouts are: 1. Push-to-talk button, 2. Volume knob, 3. Microphone, 4. Antenna, 5. Battery cover latch, 6. Battery cover, 7. Base, 8. Coiled cable.

1. Digital displays (show battery level after 12s)
2. Volume- (long press 3s switch switch frequency conversion mode and volume mode)
3. Volume+ / long press 10s to pair
4. Power on/off
5. DV 5V charging port
6. Charging indicator (red light when charging)
7. Mic

A diagram of a black mobile phone with five numbered callouts (1 to 5) pointing to specific features. Callout 1 points to the earpiece, 2 to the camera lens, 3 to the screen, 4 to the keypad, and 5 to the side of the phone.

1. 3.5mm output jack
2. Working station indicator (blue light)
3. Charging indicator (red light when charging)
4. Power on/off
5. DV 5V charging port

1. Direction buckle (Buckle the transmitter in the direction)
2. Clip (Fix the transmitter on the saxophone's bell)

It will be displayed the frequency/battery status and volume.

The image shows three identical black handheld devices, each with a small screen at the top. Below each device is a label: 'Volume (Four level, 008-011)', 'Frequency', and 'Battery status'. The devices are arranged horizontally.

correct installation:
The microphone should be at an Angle of 45° from the bell mouth, and the distance should not be less than 10cm

Incorrect installation:
The microphone is at an angle of 0 ° with the horn, and the distance is less than 10cm, because too close distance can easily cause microphone distortion.

Three images showing different microphone types:

- 3.5mm Mic Jack
- 6.35mm Mic Jack
- 6.35mm Mic Jack

Need inset 6.3mm receiver in 3.5mm adapter
if the MIC jack is 3.5mm.

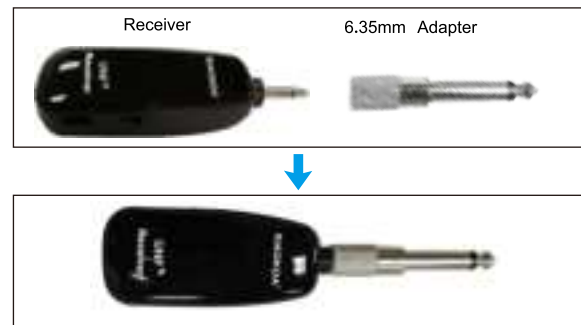

(▲Important step)

1. How to connect the transmitter and receiver

Turn on the transmitter, long press and hold the "+" button on the transmitter, When the red light "---" on the display flashes and then releases.

Turn on the receiver at same time and wait for pairing, blue light on receiver will flash.
After a few seconds, the transmitter display is normal and the receiver blue light is on (stop flash). That's mean paired successfully.

2.How to change channel

After the microphone and receiver is connect successfully, long press “-” button on transmitter switch to frequency conversion mode. The number at the beginning of the display “C” represents the channel mode (such as C06). Short press “+/-” key to change frequency, the number at the beginning of “U” indicates volume mode (such as U08).

3.How to use multiple units that will not string frequency:

This microphone can use up to 15 units at the same time, don't string frequency and without interference.

Note:

When multiple units are used at the same time, need reconnect according to the above steps firstly. [refer to (▲Important step)]

If 1 0 sets are used at the same time, long press the “-” button on the transmitter to switch to the frequency conversion mode, and then short press the “-” or “+” button to change the frequency conversion. The first set is adjusted to “C01”, the second set is converted to “C02”, and the third set is converted to “C03”.

Note:

Be sure to convert the frequency in order, multiple frequency numbers

4.How to reset:

Firstly, turn off the transmitter and receiver.

Secondly, press volume "+" button of transmitter and don't loose, turn on the switch at the same time, the red light on the display enters the cyclic flash mode and then releases.

Thirdly, turn on receiver, the blue light will be blinking and wait for pairing.
Finally, the screen display is normal and the receiver's blue light is on.
The reset is successful.

Transmission frequency	U Band
Audio Signal	Digital Sampling 48Khz
Frequency Response	20Hz- ·16Khz
Usage Time	5-6 hours
Wireless Range	50m (in classroom)
Power consumption	0db<75mA
Audio output	mixed output
Power supply	built-in 400mAh polymer battery

- 1 x Transmitter
- 1 x Receiver
- 1 x Clip
- 1 x Charging Cable
- 1 x 6.35mm Adapter
- 1 x User Manual

	Question	Answer
1	Inconsistent sound	1. Narrow the distance between microphone and the receiver. 2. Adjust the receiver to the visible range as much as possible. 3. Switch channels
2	The blue light of receiver keep flash	1. Disconnect to see whether the microphone has been turned on or not. Pairing operation required if necessary 2. Narrow the distance with the microphone.
3	Display screen "----" flash quickly	The battery is low, need to charge.
4	No sound	1. Check if the microphone and the receiver pairing successfully 2. Whether the receiver is properly connected to the amplifier 3. Check the amplifier is turned on or not.
5	The sound of the amplifier is too small	1. Volume up the amplifier 2. Volume up the microphone 3. Adjust the distance and direction of the microphone from instrument

At XIAOKOA we believe in our products. That's why we back them all with 1 years warranty and provide friendly, easy-to-reach support.

@XIAOKOA
support@xiaokoa.com
<http://www.xiaokoa.com>

PLS CONTACT US DIRECTLY WITH ANY
QUESTION OR ISSUE WE ARE ALWAYS HERE TO
ASSIST YOU, THANKS!



FCC Statement

This equipment has been tested and found to comply with the limits for a Class B digital device, pursuant to part 15 of the FCC Rules. These limits are designed to provide reasonable protection against harmful interference in a residential installation. This equipment generates, uses and can radiate radio frequency energy and, if not installed and used in accordance with the instructions, may cause harmful interference to radio communications. However, there is no guarantee that interference will not occur in a particular installation. If this equipment does cause harmful interference to radio or television reception, which can be determined by turning the equipment off and on, the user is encouraged to try to correct the interference by one or more of the following measures:

- Reorient or relocate the receiving antenna.
- Increase the separation between the equipment and receiver.
- Connect the equipment into an outlet on a circuit different from that to which the receiver is connected.
- Consult the dealer or an experienced radio/TV technician for help.

Caution: Any changes or modifications to this device not explicitly approved by manufacturer could void your authority to operate this equipment.

This device complies with part 15 of the FCC Rules. Operation is subject to the following two conditions: (1) This device may not cause harmful interference, and (2) this device must accept any interference received, including interference that may cause undesired operation.

RF Exposure Information

The device has been evaluated to meet general RF exposure requirement. The device can be used in portable exposure condition without restriction.