

Thank you for choosing
Asante GarageViewer

If you have any questions regarding the product, please feel free to contact
Asante Technical Support: (408) 435-8388 Ext.511 or send us an email to support@asante.com

Package contains:

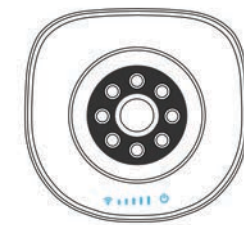

Asante GarageViewer Qty: 1



Power Adapter Qty: 1



Wires Qty: 2

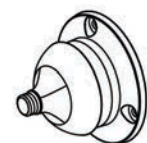

Mounting Bracket Qty: 1

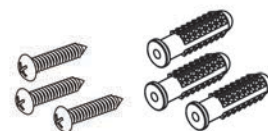

Screws Qty:3
Plastic Anchors Qty:3



Wall mount button
reference guide Qty:1

Asante GarageViewer Lights and Ports

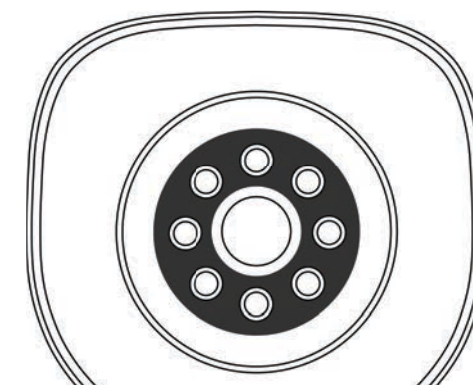

WiFi wireless
connectivity
light

Power light
Signal strength
light for wireless

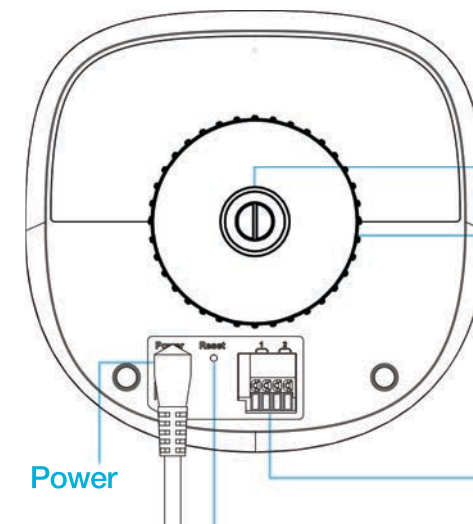

Mounting hole

Fastening wheel
This wheel is meant to
move freely to be able
to remove and install
camera while the wires
are still attached.

Power

Reset button

To factory reset, connect the
device to power and wait at
least 1 minute.
With power connected, press
and hold down the reset
button until quick blinking of
lights are noticed. Let go of
reset button and wait for
device to reboot.

Connection to
garage door wall
mount button

STEP 1

Download App & Power on Asante GarageViewer

- 1a. Look for free app **Asante 2.0** from Apple Store or Google Play and download it.
- 1b. Connect the power to your Asante GarageViewer. Wait until the WiFi lights change from all blinking at the same time to scrolling.
- 1c. Create an account and login with the account created. Follow the setup wizard steps inside the app to complete the installation of Asante GarageViewer.

Once the device is successfully installed, disconnect it from power and move it to garage area to prepare for installation.

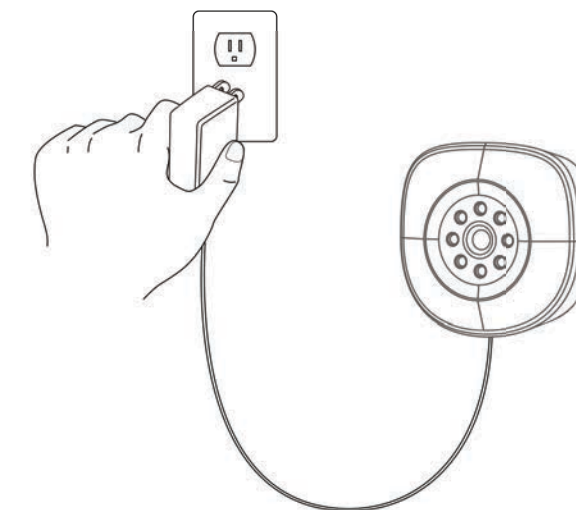

STEP 2

Insert Wires into Your Asante GarageViewer

Each Asante GarageViewer can control up to two garage doors. (One pair of wire needed for one door)
Use one set of wires (provided), insert tips into the green connectors.



Insert a pair of wires into green
connector to lock it in.

Connect the shorter side of the wires
to your GarageViewer, making sure
that after they are inserted, they are
not touching each other.

If you need to remove the wires for any
reason, press the tab under the connector
and hold down. Then pull out the wire.

Connect to Garage door opener
wall mount button.

Remove PVC cover of the wires
and use this end to attach the
wires to your current wall mount
button.

STEP 3

Connect to Garage Door Wall Mount Button

Connect the other side of wires to your garage door opener's wall mount button. Note that the wires from Asante GarageViewer need to co-exist with previous wires that were attached to the garage door motor. For wiring instruction, please refer to enclosed wall mount button reference guide. You can also download it from Asante official site: https://www.asante.com/documents/Wall_Mount_Buttons_Reference_Guide.pdf

We recommend to unplug your garage door electric motor from the AC power during the installation.

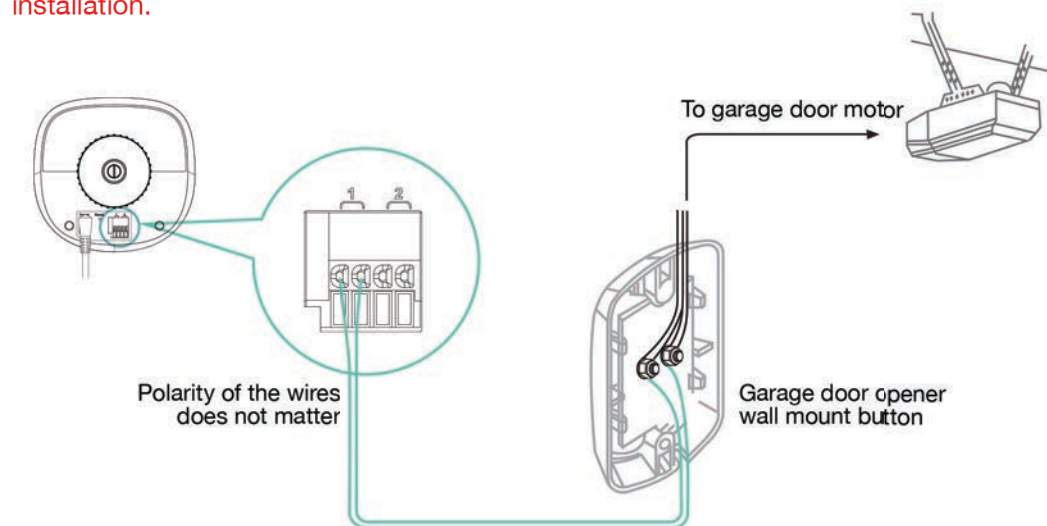

STEP 4

Control Your Garage Using the App

Reconnect the power to your garage door motor and Asante GarageViewer.

Wait until WiFi lights on Asante GarageViewer are established. Before mounting your Asante GarageViewer at desired location, login to app and make sure you can see the video. Also press the button to see if the garage door can be opened or closed.

This concludes the installation of Asante GarageViewer.

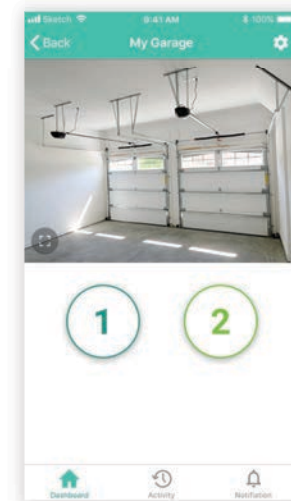

STEP 5

Mounting Device

Hold the mounting base against the wall and mark the screw holes using a pen. Pay close attention to make sure the camera's location can cover your garage doors. Using the screws provided attach the base to the wall (Figure A)

With wires connected to the Asante GarageViewer, attach it to the base. To fasten, turn the screw knob clockwise (Figure B) To pan or tilt the camera, hold the camera, pull gently and move it (excessive pull and twisting will damage the mounting unit).

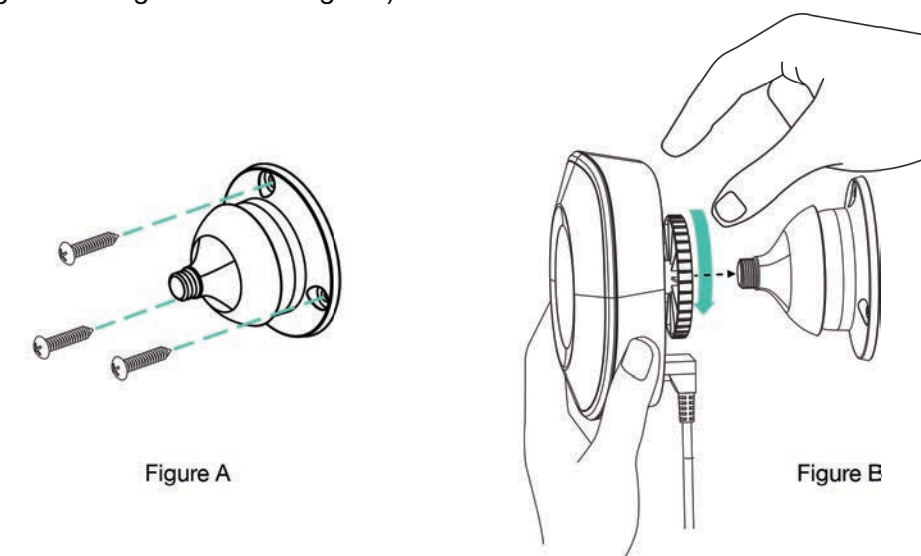

FEDERAL COMMUNICATIONS COMMISSION INTERFERENCE STATEMENT
This equipment has been tested and found to comply with the limits for a Class B digital device, pursuant to Part 15 of the FCC Rules. These limits are designed to provide reasonable protection against harmful interference in a residential installation. This equipment generates, uses and can radiate radio frequency energy and, if not installed and used in accordance with the instructions, may cause harmful interference to radio communications. However, there is no guarantee that interference will not occur in a particular installation. If this equipment does cause harmful interference to radio or television reception, which can be determined by turning the equipment off and on, the user is encouraged to try to correct the interference by one or more of the following measures:

- Reorient or relocate the receiving antenna.
- Increase the separation between the equipment and receiver.
- Connect the equipment into an outlet on a circuit different from that to which the receiver is connected.
- Consult the dealer or an experienced radio/TV technician for help.

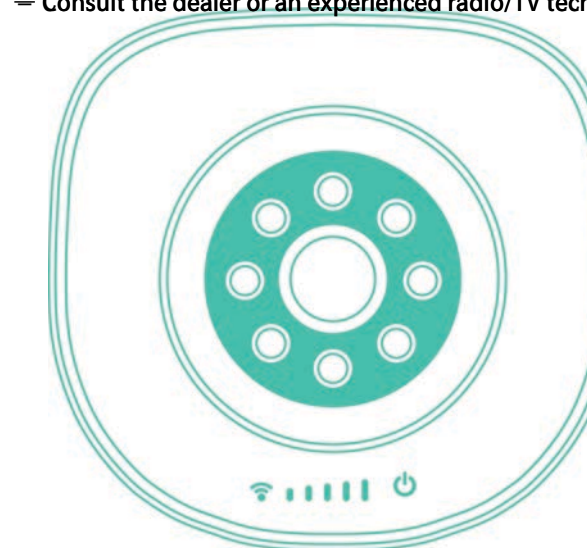

Asante GarageViewer Installation Guide

CAUTION:
Any changes or modifications not expressly approved by the party responsible for compliance could void the user's authority to operate the equipment.
This device complies with Part 15 of the FCC Rules. Operation is subject to the following two conditions:
(1) This device may not cause harmful interference and
(2) This device must accept any interference received, including interference that may cause undesired operation.
RF exposure warning
This equipment must be installed and operated in accordance with provided instructions and the antenna(s) used for this transmitter must be installed to provide a separation distance of at least 20 cm from all persons and must not be co-located or operating in conjunction with any other antenna or transmitter.
End-users and installers must be provide with antenna installation instructions and transmitter operating conditions for satisfying RF exposure compliance.