

# User Manual

## Model: Qistand

Foldable Wireless Charging Stand

### Accessories:

- Wireless transmitter ×1
- Type C data cable ×1
- User manual ×1

### Note:

Thank you for your acquisition of this wireless transmitter, compatible with all Qi devices like Samsung S7/S7 edge, S8/S8 edge, S9/S9 edge, S10/S10 edge, iPhone 8/8 Plus, iPhone X, iPhone XR, iPhone XS, iPhoneXS MAX, iPhone 11, iPhone 11 Pro, iPhone 11 Pro MAX.

For optimum performance and safety, please read this manual carefully before using this product.

### SPECIFICATIONS

Power	15W / 10W / 7.5W / 5W
Input	5V/2A, 9V/2A, 12V/1.67A
Wireless Output	5V/1A, 9V/0.83A, 9V/1.12A, 9V/1.67A
Charging Efficiency	≥70%
Transmission Distance	≤8mm
Product Size	137.3 x 69.3x10 mm
Weight	145 g

### PRODUCT STRUCTURE AND COMPOSITION

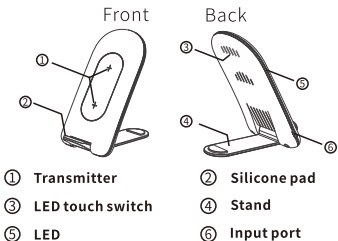

### HOW TO USE

#### Charging your wireless transmitter



- Charge your wireless transmitter via included Type C data cable.
- Wireless transmitter is ready for your mobile device.

#### Charging mobile device from wireless transmitter

- Put your mobile device (the phone you used must be able to support the wireless charging or your phone are equipped with wireless receiver chip) .

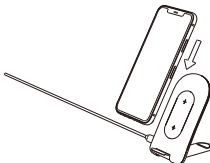

#### LED usage

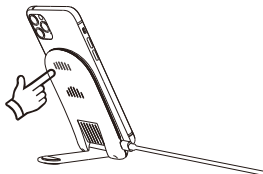

The product is with LED indicator  
When power on and standby: **Light is red**  
When wireless charging: **Light is blue**

**Tips:** When you do not need the light on, you can touch the touch switch on the back of the product to turn off it

### When your wireless transmitter working improperly

- Clean the clutters on the wireless transmitter.
- When the wireless transmitter is over-heating, take your mobile device away from your wireless transmitter. The transmitter will stop charging automatically when over-heating. Please try charging again when the wireless transmitter cooling down.

This device complies with Part 15 of the FCC Rules. Operation is subject to the following two conditions:  
(1) this device may not cause harmful interference, and  
(2) this device must accept any interference received, including interference that may cause undesired operation.

Operation frequency: 110.256kHz to 147.436kHz  
H-filed strength: -8.16dBuA/m@10m

#### Reference for correct placement

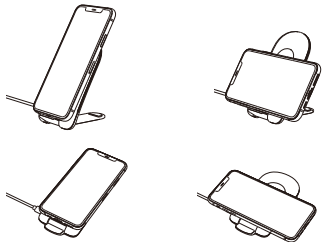

### REMARKS

1. The charging adapter you used should meet with QC2.0, QC3.0 or QC4.0 standard.
2. The Type C charging cable you used should be the data cable, not the charging function only.
3. It's normal that this charger and your smart phone will be hot under operating conditions, especially when the phone charging and using at the same time (such as playing music).
4. The charging adapter is not included. A charging adapter is required.
5. Not works with 5V/1A or lower input. For safety, please do not use less than 5V/1A input charger or USB port to power up.

This device complies with Part 15 of the FCC Rules. Operation is subject to the following two conditions:  
(1) this device may not cause harmful interference, and (2) this device must accept any interference received, including interference that may cause undesired operation.

changes or modifications not expressly approved by the party responsible for compliance could void the user's authority to operate the equipment.  
This equipment has been tested and found to comply with the limits for a Class B digital device, pursuant to Part 15 of the FCC Rules. These limits are designed to provide reasonable protection against harmful interference in a residential installation. This equipment generates, uses and can radiate radio frequency energy and, if not installed and used in accordance with the instructions, may cause harmful interference to radio communications. However, there is no guarantee that interference will not occur in a particular installation.

If this equipment does cause harmful interference to radio or television reception, which can be determined by turning the equipment off and on, the user is encouraged to try to correct the interference by one or more of the following measures:  
-- Reorient or relocate the receiving antenna.  
-- Increase the separation between the equipment and receiver.  
-- Connect the equipment into an outlet on a circuit different from that to which the receiver is connected.  
-- Consult the dealer or an experienced radio/TV technician for help.

This equipment complies with FCC radiation exposure limits set forth for an uncontrolled environment. This equipment should be installed and operated with minimum distance 20cm between the radiator and your body.  
This transmitter must not be co-located or operating in conjunction with any other antenna or transmitter.

Company Name: Shenzhen Esorun Technology Co., Ltd.  
Address: 425(E02), No. 5 Golf Avenue, Guangpei Community, Guanlan Street, Longhua District, Shenzhen, China

Anton Clemens Automotive GmbH  
Braunsberg 35, D-51429 Bergisch Gladbach, Germany