

Nile Global Inc.

NSW250 Quick Start Guide

Product Specification

NSW250

Product dimensions	425mm x 433mm x 44.3mm
Product weights	9.12kg
Power source	100-240V, 6 A, 50-60Hz
Mounting mode	Rack mount/Wall mount
Operation temperature	0 ~ 45 C
Operation humidity	
Altitude	Sea Level

NSW250

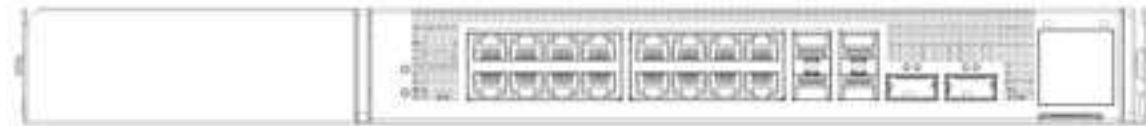

Installation Guide

1 Remove the inner rail.

2 Install the inner rail onto the chassis.

3 Installing the rail on the rack(For 4 post rack)

Detach Bracket from Rack Post

① Press the latch of rear bracket and install it on rear rack post.
② Press the latch of front bracket and install it on front rack post.

① Press the latch of front bracket and install it on front rack post.
② Press the latch of rear bracket and install it on rear rack post.

Screw sack

ITEM	NAME
A	(A)M4x5L(P0.7)
B	(B)M6x13L(P1.0)
C	(C)M6-NUT

For 2-post rack(center position)

① Remove the front and rear bracket of rail first.
② Installed front and rear brackets based on the position demand.(center position and flush position)

Front bracket
 B: M6*13
 C: M6-NUT

4 Installing the system into rail(Stab In)

1. Pull the middle rail fully extended in lock position, ensure ball bearing retainer is located at the front of the middle rail.
2. Insert the chassis into middle-outer rail.
3. When hit a stop, please pull/push the blue release tab on the inner rail.
4. Tighten chassis with thumb screw.

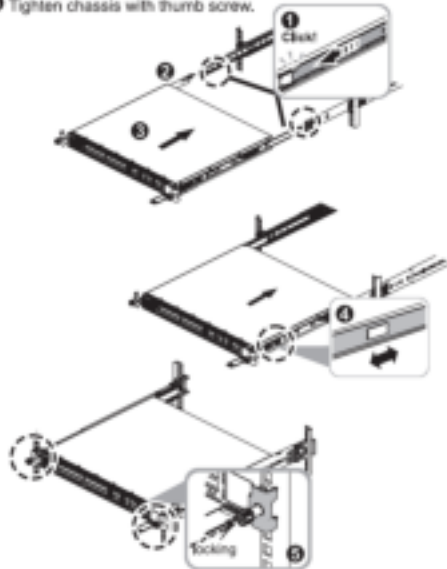

Remove the chassis from rack

1. Loosen thumb screw to pull out chassis
2. Pull the disconnect tab
3. Remove the chassis out of rail.
4. Pull the tab to retract the middle rail back.

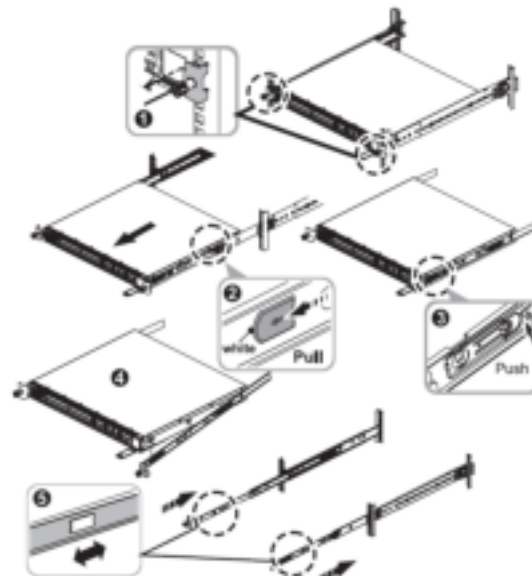

Installing the system into rail(Drop In)

1. Pull the inner rail out.
2. Install the chassis
3. Pull the released latch to retract the chassis.
4. Fasten the thumb screw.

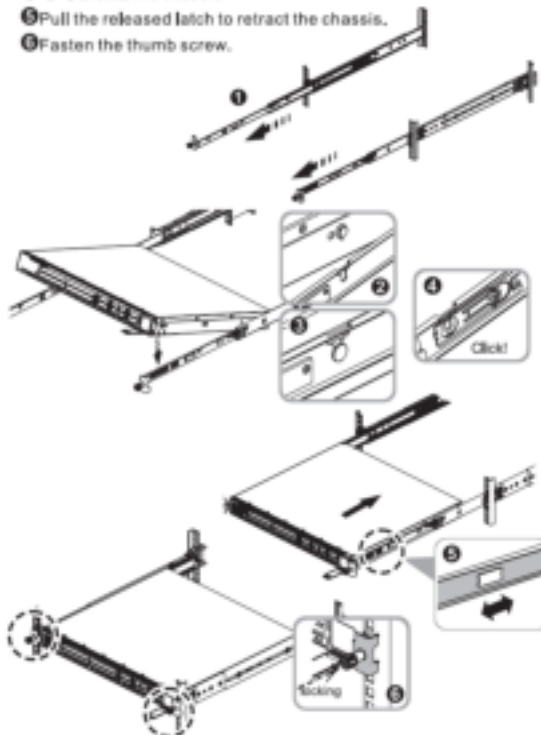

Remove the chassis from rack(Drop In)

1. Loosen the thumb screw.
2. Pull out the chassis.
3. Press the keyhole spring plate to remove inner rail.
4. Press the released tab to retract inner rail.

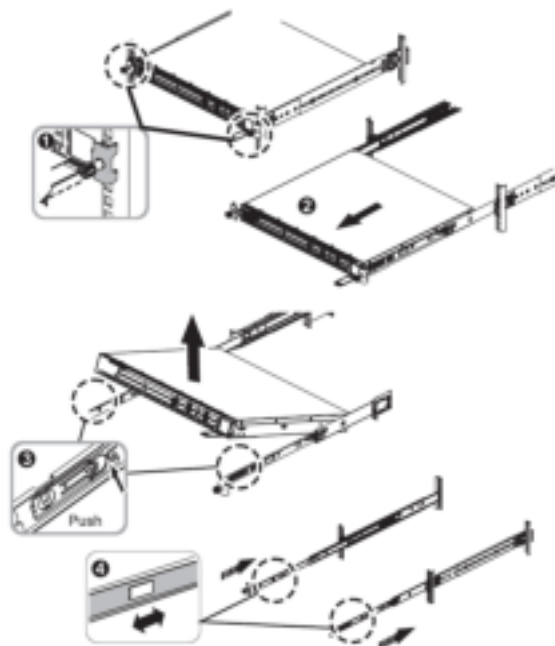

Rack & Stack NSW 250 on a 4-Post Rack

- Mount the rails first to the rack

L & R is mentioned on the rails for easy understanding L= Left, R = Right



Back



- Verify the direction of the notches and slide the device into the grooves so that the pins on the switch will align with the grooves on the rail.

Please ensure these notches are facing downwards



- After verifying that all the pins are sitting in the grooves, pull the blue pin on the side towards the front of the rail so that it releases the lock to push the switch into place. Twist the screws to tighten it in place

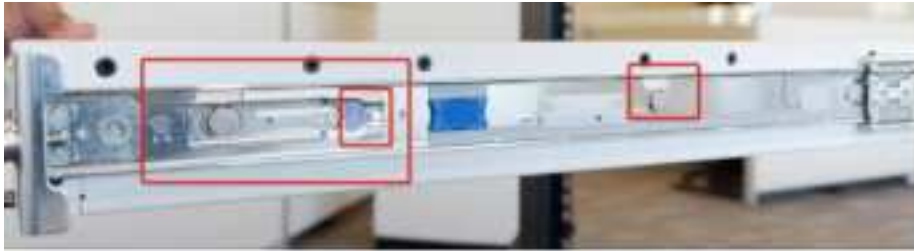

Rack & Stack NSW250 on a 2-Post Rack

- Unpack the rails from the box and verify the L and R sides >> Remove the screws to remove the back plate off the rail.

L & R is mentioned on the rails for easy understanding L= Left, R = Right

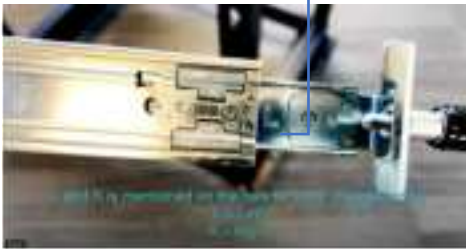

Remove the two screws



Remove the back

- Find a small rail named “Rail B” in the box and let’s install that onto the main rail as below:



We will mount the other plate now



Use the new screws



- Verify the direction of the rails and attach them to the rails using the 12-24 screws to the rack. Tighten them using a screwdriver.



Please ensure these notches are facing downwards



- Once the switch fits in the grooves, pull the blue tab on the side of the rail towards the front of the rail and secure the switch to the rail by tightening the screw



NSW250 dry wall mount.

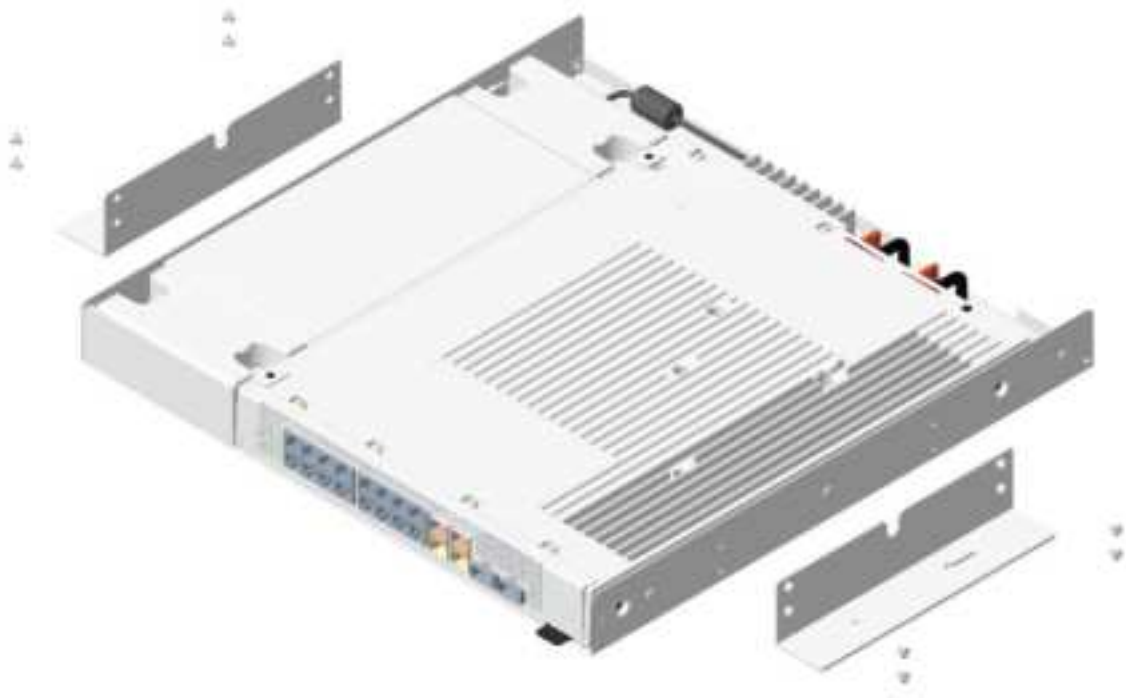

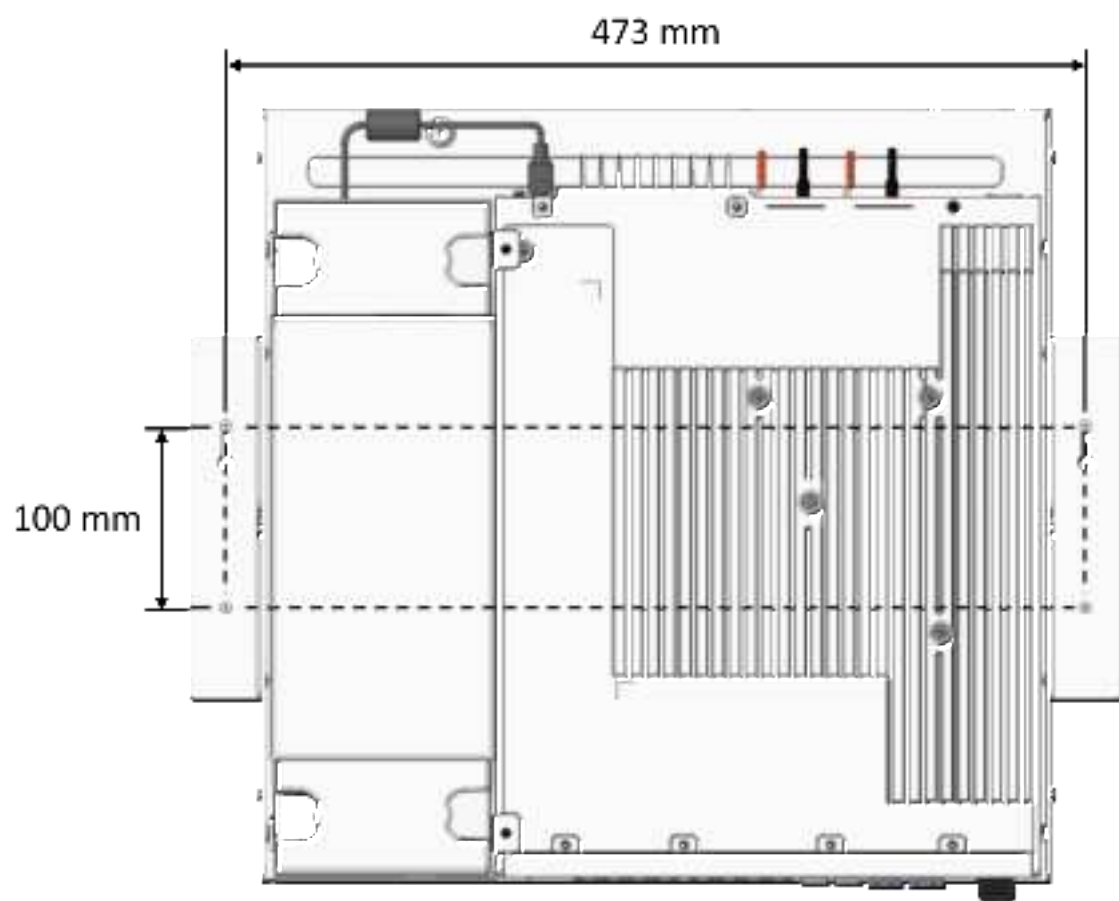

NSW250 dry wall mount without bottom tray

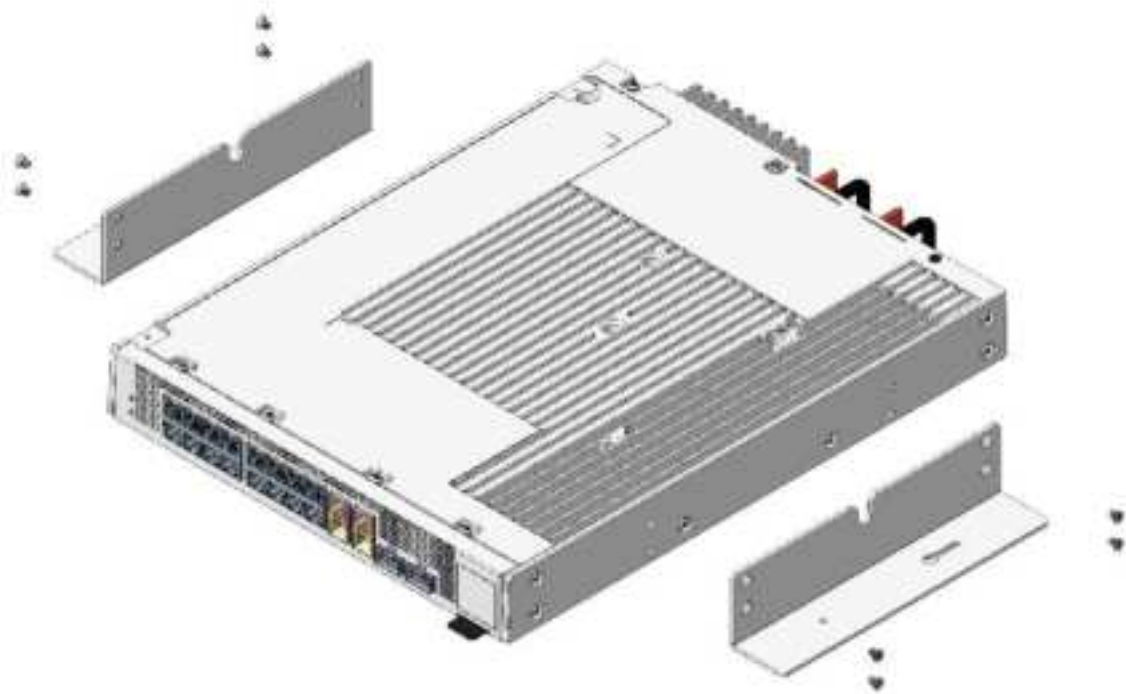

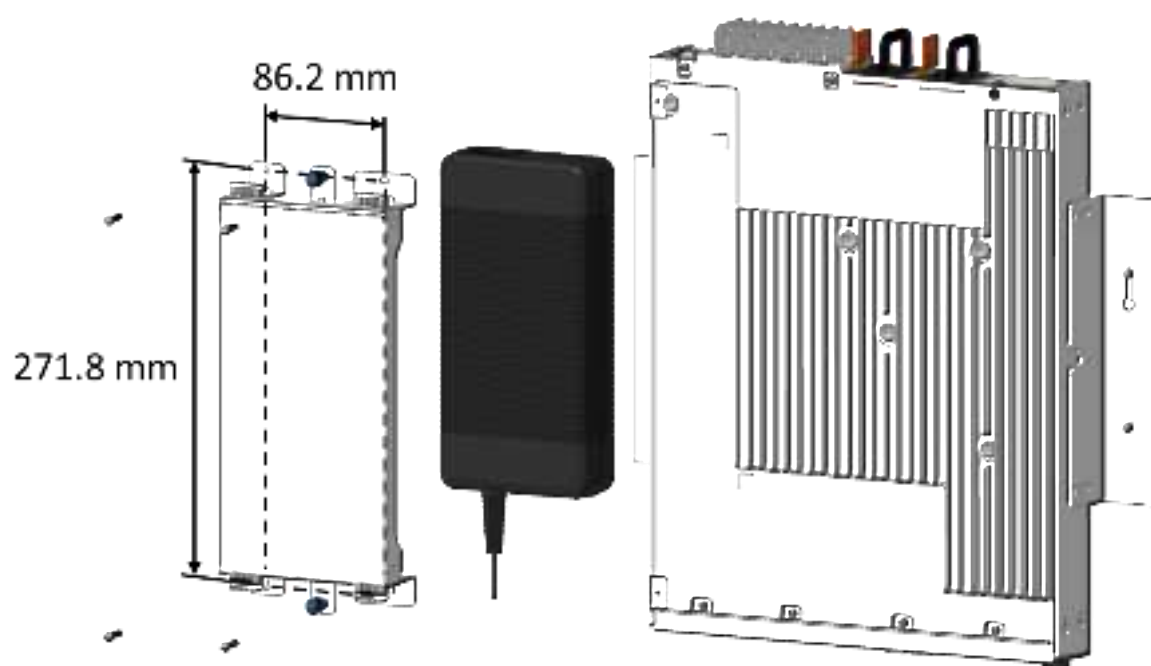
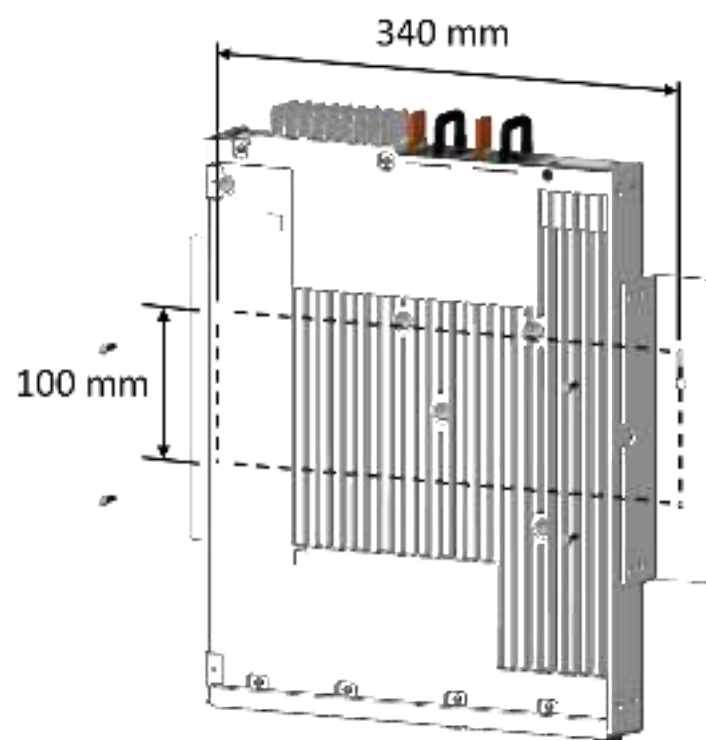

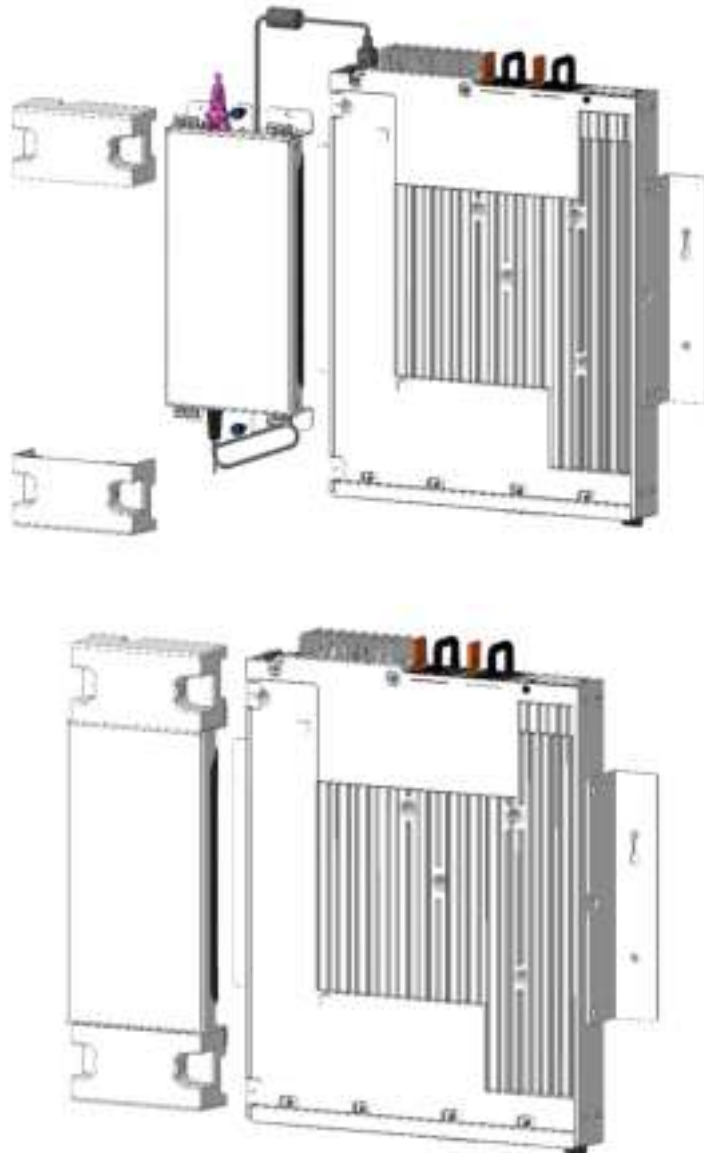

Regulatory Compliance Information:

Safety Notice

- . Please use CSA/UL Certification Approval Power Supplier.
- . There is a risk of fire if the battery is replaced with an incorrect type.

Before extending the rack to the installation position, read the installation instructions.
Do not put any load on the slide-rail mounted equipment in the installation position.
Do not leave the slide-rail mounted equipment in the installation position.

Grounding Caution

This equipment must be grounded and the power cord for product should be connected to a socket-outlet with earthing connection.

FCC Warning

This device complies with Part 15 of the FCC Rules. Operation is subject to the following two conditions: (1) This device may not cause harmful interference, and (2) this device must accept any interference received, including interference that may cause undesired operation.

NOTE: This equipment has been tested and found to comply with the limits for a Class A digital device, pursuant to part 15 of the FCC Rules. These limits are designed to provide reasonable protection against harmful interference when the equipment is operated in a commercial environment. This equipment generates, uses, and can radiate radiofrequency energy and, if not installed and used in accordance with the instruction manual, may cause harmful interference to radio communications. Operation of this equipment in a residential area is likely to cause harmful interference in which case the user will be required to correct the interference at his own expense.

FCC Caution:

- Any changes or modifications not expressly approved by the party responsible for compliance could void the user's authority to operate this equipment.
- This transmitter must not be co-located or operating in conjunction with any other antenna or transmitter.

Radiation Exposure Statement:

This equipment complies with FCC radiation exposure limits set forth for an uncontrolled environment. This equipment should be installed and operated with minimum distance 20cm between the radiator & your body.

IC Warning

This device complies with ICSED's licence-exempt RSSs. Operation is subject to the following two conditions: (1) This device may not cause harmful interference, and (2) this device must accept any interference received, including interference that may cause undesired operation.

Le présent appareil est conforme aux CNR d' ICSED applicables aux appareils radio exempts de licence. L'exploitation est autorisée aux deux conditions suivantes : (1) le dispositif ne doit pas produire de brouillage préjudiciable, et (2) ce dispositif doit accepter tout brouillage reçu, y compris un brouillage susceptible de provoquer un fonctionnement indésirable.

Radiation Exposure Statement:

This equipment complies with ICSED radiation exposure limits set forth for an uncontrolled environment. This equipment should be installed and operated with greater than 20cm between the radiator & your body.

Déclaration d'exposition aux radiations:

Cet équipement est conforme aux limites d'exposition aux rayonnements ISED établies pour un environnement non contrôlé. Cet équipement doit être installé et utilisé à plus de 20cm entre le radiateur et votre corps.