

REVISIONS		
REV	ECN	DATE
--	---	----

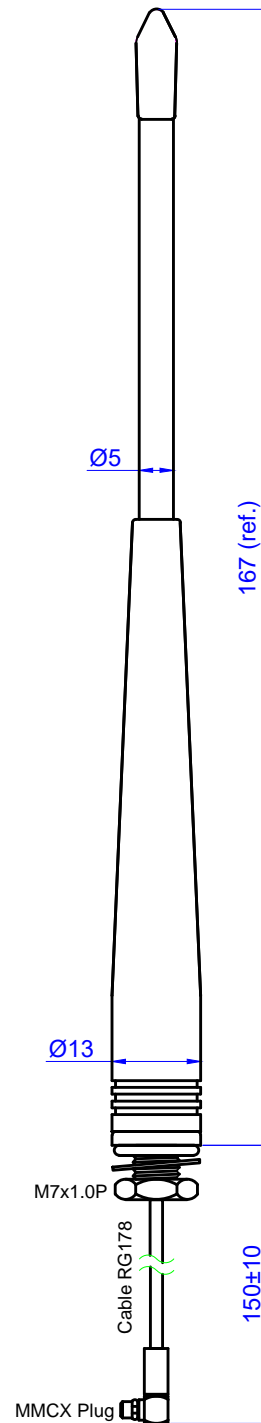

## NOTES

- THIS IS A RoHS COMPLIANT PRODUCT

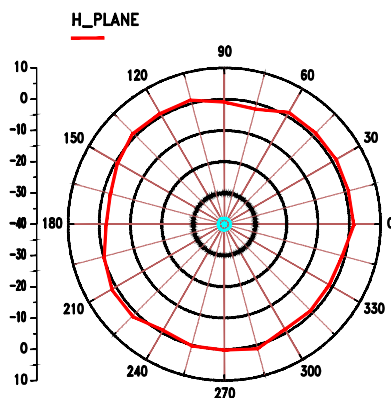
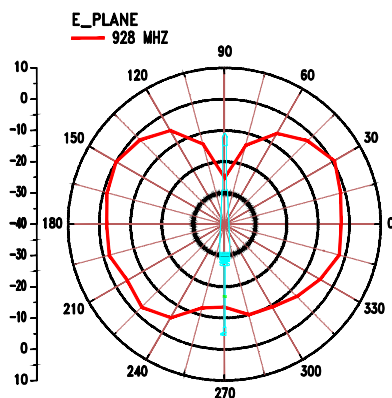
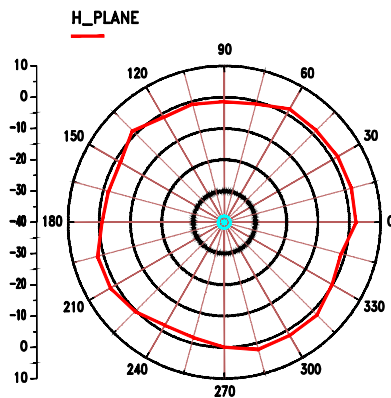
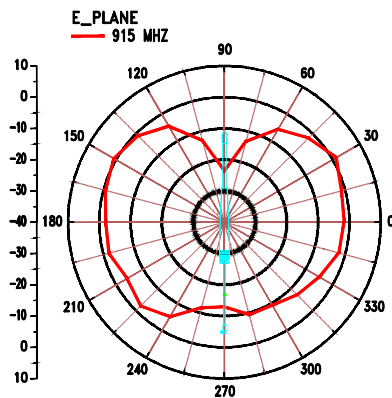
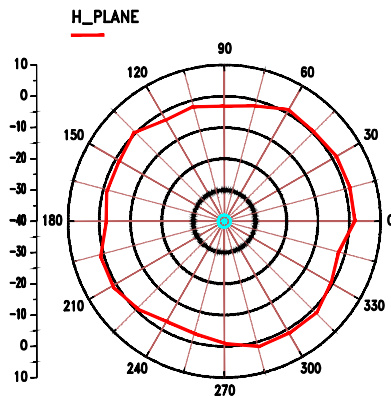
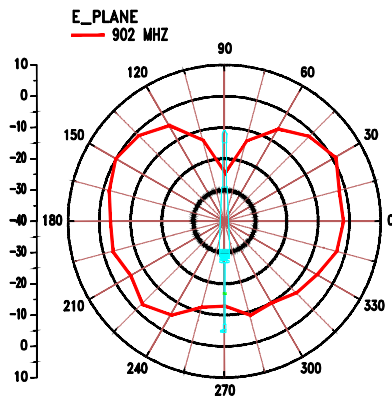
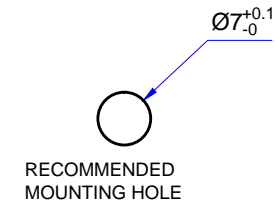

## Electrical Properties

Frequency Range	902~928 MHz
Impedance	50Ω
V.S.W.R.	≤2.0
Radiation	Omni
Gain	2dBi
Polarization	Vertical

## Mechanical Properties

Body Material	PU/TPE
Connector	Brass
Weight	22.5 g (est )
Operating Temp	-20℃ ~ +65℃

TITLE	ISM Band Fixed Mount Straight Antenna - 467 model	Rev. Date	SHEET
		042524	1 OF 1
UNIT	DWG. NO.	S467FL-5-RMM-915	
mm			
SCALE			
none			

**NEARSON**