

**61 FLASH PIANO KEYS MULTIMEDIA
ELECTRONIC KEYBOARD WITH
APPINTELLIGENT TEACHING FUNCTION**

DK-10S



OWNER'S MANUAL



Before use, please read these instructions carefully so you better play to its performance, And keep it for future reference.



空白页

Blank page

DIRECTORY

I. Panel function keys and external ports.....	1
1. Name of the function keys of the electronic organ.....	1
2. Name of the external port on the back of the electronic organ.....	1
II, the use of power adapter and battery:.....	2
1. Use AC power adapter.....	2
2. Use of battery.....	2
3 Use of charging.....	2
4. Use of audio output.....	2
5 Use headphones.....	2
6.MIDI function.....	2
III, the performance and operation of the electronic organ.....	3
(I) power switch/total volume/and the selection of timbre.....	3
1. Power switch.....	3
2. Total Volume.....	3
3. Function of function keys.....	3
4. Selection of timbre.....	3
5. Force on/off.....	4
(II) Use of sound effects.....	4
1. Use of the function of lifting and adjusting.....	4
2. Trill.....	4
3. Sound extension.....	4
4. Dual tone switch.....	4
5. Dual keyboard Switch.....	4
6. Metronome.....	4
(III) Learning and demonstrating the use of musical functions.....	4
1. Demo songs : (See Appendix III for the list of demo songs).....	4
2. Demonstration song.....	4
3. Selected songs for demonstration and learning function auditions.....	5
4. Learning Function 1 (single-key mode).....	5
5. Learning Function 2 (follow-up mode).....	5
6. Learning Function 3 (Ensemble mode).....	5
7. Keyboard light on/off.....	5
(IV) Use of recording and rhythm programming functions.....	5
1. Use of recording and playback.....	5
2. Use of programming and playback.....	6
(V). Rhythm, chord, programming, prelude/Endnote functions.....	6
1. Start of rhythm.....	6
2. Choice of rhythm.....	6
3. Use of synchronization function.....	6
4. Use of synthetic chords.....	7
5. Use of insert function.....	7
6. Adjust the pace of the beat.....	7
7. Accompaniment volume.....	7
8. Prelude/Finale.....	7
IV、【POP Piano】Bluetooth connection and instructions for APP.....	8
V、"Play the piano" APP connection and instructions.....	12
VI、Play the piano APP instructions.....	13
Appendix I (140 kinds) timbre table.....	14
Appendix II (128 kinds) Rhythmic table.....	15
Appendix III : song comparison table.....	16
Appendix IV: single finger chord chart.....	17
Appendix V: multi-fingered chord chart (1).....	18
AppendixVI: multi-fingered chord chart (2).....	19
Maintenance precautions.....	20

Introduction to Main Functions

- | | |
|--|---|
| 1. 61 standard strength piano keys | 11. There are three learning functions of duet singing, continuous singing and demonstration song |
| 2. Keyboard flash function | 12. 60 demonstration music |
| 3. Function keys automatically emit light | 13. Metronome function |
| 4. Connect the learning APP function | 14. Synthesizing chord functions |
| 5. The learning APP can be connected via Bluetooth and cable Two ways to connect | 15. Sound extension and trill function |
| 6. 61 keyboard percussion | 16. Shift function |
| 7. Dual timbre and keyboard functions | 17. Master volume, accompaniment volume, beat speed control |
| 8. 140 kinds of timbre and 128 kinds of rhythm | 18. MIDI input and output |
| 9. Recording, programming and playback functions | 19. DC5-9V input and charging function |
| 10. Function of synchronization and insertion | |

I. Panel function keys and external ports

1. Name of the function keys of the electronic organ

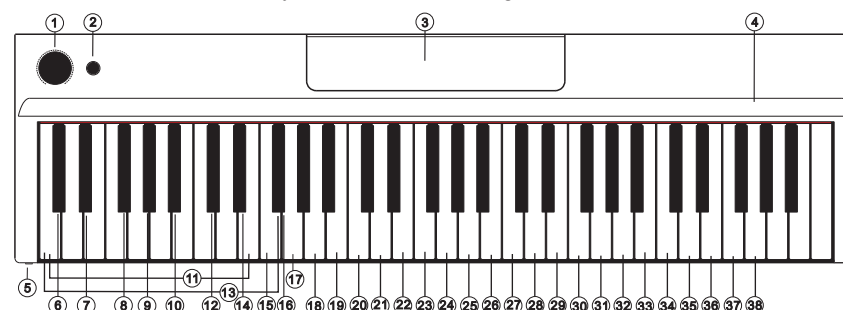

2. Name of the external port on the back of the electronic organ

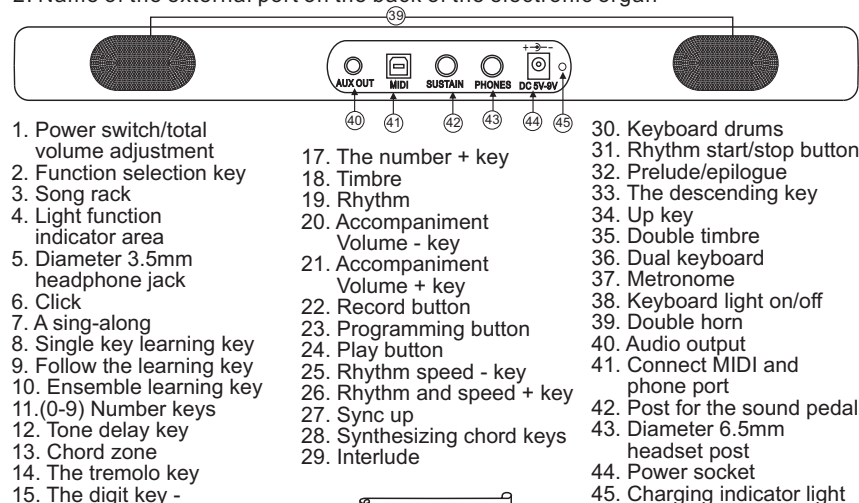

- | | | |
|---|--------------------------------|---------------------------------|
| 1. Power switch/total volume adjustment | 17. The number + key | 30. Keyboard drums |
| 2. Function selection key | 18. Timbre | 31. Rhythm start/stop button |
| 3. Song rack | 19. Rhythm | 32. Prelude/epilogue |
| 4. Light function indicator area | 20. Accompaniment Volume - key | 33. The descending key |
| 5. Diameter 3.5mm headphone jack | 21. Accompaniment Volume + key | 34. Up key |
| 6. Click | 22. Record button | 35. Double timbre |
| 7. A sing-along | 23. Programming button | 36. Dual keyboard |
| 8. Single key learning key | 24. Play button | 37. Metronome |
| 9. Follow the learning key | 25. Rhythm speed - key | 38. Keyboard light on/off |
| 10. Ensemble learning key | 26. Rhythm and speed + key | 39. Double horn |
| 11. (0-9) Number keys | 27. Sync up | 40. Audio output |
| 12. Tone delay key | 28. Synthesizing chord keys | 41. Connect MIDI and phone port |
| 13. Chord zone | 29. Interlude | 42. Post for the sound pedal |
| 14. The tremolo key | | 43. Diameter 6.5mm headset post |
| 15. The digit key - | | 44. Power socket |
| 16. Force on/off | | 45. Charging indicator light |

II, the use of power adapter and battery:

1. Use AC power adapter:

The machine is equipped with lithium battery, turn on the power switch of the piano can be used normally, or plug in the "power adapter" of the piano to "charge" the machine and use the power supply of the machine at the same time, plug the standard socket of the AC "power adapter" into the corresponding AC mains socket. Insert the other end into the "DC5V-9V" jack at the back of the electronic organ (at this time, after the power adapter is plugged in, the "red" charging indicator lights up, indicating that the machine is being charged), turn on the power switch on the piano, and it can be used normally. When the battery of the machine is fully charged, the "red" charging indicator light will go out).

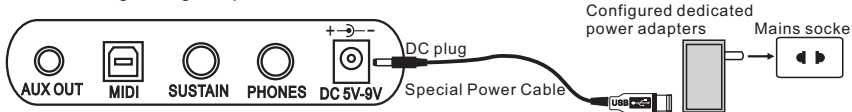

Note: When the power adapter is used for power supply, the power adapter will also charge the machine.

2. Use of battery:

The instrument is equipped with a 1800 mah lithium battery. If you need to use the instrument when going out, you can use the built-in battery to power the electronic organ. When the battery is fully charged, you can turn on the power switch of the instrument.

3 Use of charging:

When using the battery of the machine for power supply is too low, the sound quality will become smaller, worse, inaccurate sound, function changes, all the indicators will turn dark and flash or will constantly restart the machine, and so on. At this time, the battery is too low, the battery should be charged in time. Plug the "power adapter" of the piano into the mains and plug the other side into the DC socket of the piano to charge the piano (at this time, the "red" charging indicator light will light up, and when the battery is fully charged, the "red" charging indicator light will turn off, indicating that the battery is fully charged). Warning: When the "power adapter" is connected to the piano, the "power adaptor" will charge the piano no matter the "power switch" is "on" or "off". Please remove the "power adapter" from the AC mains when you are not using the piano and do not need to charge it, so as to avoid battery damage caused by excessive charging over a long time, explosion and fire.

Note: It takes about (2-3) hours for the battery to be fully charged. Do not charge the battery for more than 6 hours. It may damage the battery and cause overheating, explosion and fire. Charge the piano when it is necessary to have special care, to prevent unnecessary accidents. Please limit the use of the power adapter supplied by our factory. Using the wrong power adapter will cause overheating and damage the internal components of the electronic organ.

4. Use of audio output:

The audio outlet (AUX OUT) of the electronic organ can be connected to the sound box with a power amplifier to provide a sound source output port.

5 Use headphones:

There are two kinds of headphone plugs with diameter 6.5 and 3.5 for users to choose by themselves. You can insert the selected headphone into the headphone jack (PHONES). After inserting the headphone, the audio output of the speaker of the phone will be automatically shielded. (If you want to use this instrument, please pull out the headphone spike).

Note: The 6.5 diameter of the headset header is on the back of the instrument (PHONES), and the 3.5 diameter of the headset header is on the front left of the instrument (PHONES).

6.MIDI function:

Connect the MIDI jack of the piano to the USB jack of the computer. Through various professional MIDI editing software (such as Cakewalk), the MIDI information of the piano can be transmitted to the MIDI information of the computer.

Note: This piano is not equipped with computer cable and MIDI editing software, users need to purchase.

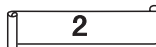

III, the performance and operation of the electronic organ

(I) power switch/total volume/and the selection of timbre

1. Power switch:

The power "switch" and "Total volume" control knobs are integrated knob switches. Turn the power clockwise to "On" and turn the power counterclockwise until the power is "off". Turn the power switch to the "on" direction, and then the panel function indicator light will light up. At the same time, it also lights up the function bar indicator), the startup is playing mode, and the tone is "piano" by default. Every time it is restarted, the electronic organ automatically resets to "000" (piano tone) and "000" (club pop).

2. Total Volume:

Great that the total volume of the adjustable or is small, the boot can be rotated principal directly under the state of the volume knob to adjust the volume of the sound big or small volume, the volume knob clockwise counterclockwise rotation volume knob volume smaller, when the counter clockwise rotation to is closed at the end of the machine power supply.

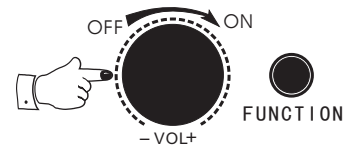

3. Function of function keys:

In the selection of any function, press and hold down the "function" key, and then press the corresponding function key to select the required function, select the required function after the release of the "function" button.

4. Selection of timbre:

This instrument has a total of "140" realistic timbre, from "000" to "139" can be used freely. Before selecting a tone, please hold down the "Function" key, press the "Tone Selection" button, and then select the number key. Example: Select a timbre numbered "018". First hold down the "Function" key, then press the "tone selection" key → press the number key "0" → press the number key "1" → press the number key "8", and then release the "Function" key, then the tone is "018". Select the tone color numbered "113", hold down the "Function" key, and then press the "tone color selection" key → press the number key "1" → press the number key "1" → press the number key "3" and release the "Function" key, then the tone color is "113". (as shown below) Use "-" and "+" to hold down the "Function" key, and then press the "Timbre" key: In the timbre selection mode, press the "-" key, or press the "+" key, and the timbre number increases or decreases in sequence until you select the timbre.

Note: The "Function" button can be released only after selecting the desired tone.

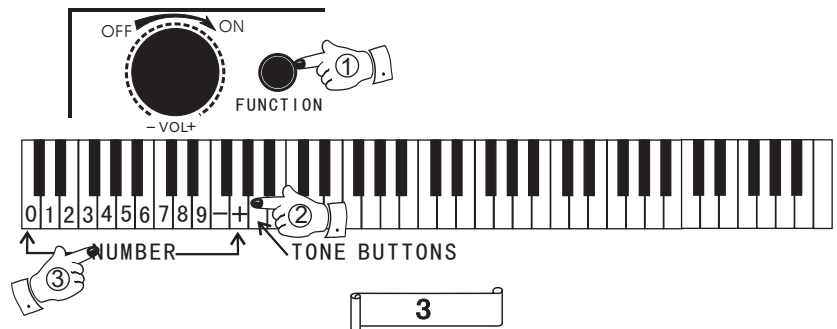

5. Force on/off:

"Strength" on/off, is to turn on or off the keyboard strength response switch, start the default strength on. In the startup state, first hold down the "Function" key, and then press the "strength" key once to close the strength and then press again to open the cycle.

(II) Use of sound effects:

1. Use of the function of lifting and adjusting:

The up and down tuning function can change the tone of the keyboard.Press the "Function" key first, and then press the "Uptone" or "Downtone" key to set the variable value. Every time you press the "Uptone" or "downtone" key, the tone will be "up" or "down" half a tone, and the variable value ranges from "-6" to "+6". After holding down the "Function" key and then pressing the "Uptone" and "downtone" key at the same time, the default value (00) will be returned.

2. Trill:

Press and hold down the "Function" key and then press the "Vibrato" key, and then release the "Function" key. At this time, the timbre will produce dithering effect. If you repeat the operation more than once, the vibrato effect will be cancelled.

3. Sound extension:

First hold down the "function" key and then press the "delay" key, and then release the "function" key. At this time, the sound effect of the syllable can be lengthened, and the delay effect can be canceled if the operation is repeated more than once.

4. Dual tone switch:

First press and hold down the "Function" key, and then press the "double tone" key. At this time, two different Musical Instruments will be played at the same time, that is, the main tone and the selected second tone will sound at the same time. At this time, you can press and hold down the "function" key, and then press the "tone" key and the "numeric keyboard" to select the required second tone. Hold down the "Function" key and press the "Double Tone" key again to exit this function.

5. Dual keyboard Switch:

First hold down the "Function" key and then press the "Double keyboard" key, then the keyboard will be divided into C2~B3 and C4~C7. The positions of C2~B3 on the keyboard correspond to the positions of C4~B5. At this time, the original timbre of C4~C7 keys can be replaced by the way of "select timbre" to select the timbre, and the keyboard can be divided into two different timbre for simultaneous performance. To cancel this function, hold down the "Function" key and press the "Dual Keyboard" key once.

6. Metronome:

In the normal state, first hold down the "Function" key to do not play, and then press the "metronome" key every time, the beat will be 1/4 beat → 2/4 beat → 3/4 beat → stop → 1/4 beat...For this loop, the default speed is 120.Stop metronome: Hold down the "Function" button and press the "Start/Stop" button again.

(III) Learning and demonstrating the use of musical functions:

1. Demo songs :(See Appendix III for the list of demo songs).

First hold down the "Function" key and then press the "Sing" key, that is, play the current song. Then hold down the "function" key and press the "sing" key once to stop playing. Then press the "sing" key again to play the next song so as to cycle.

Note: First hold down the "Function" key and then press the "Chant" key to play one song at a time, then press this key to stop, then press again to play the next song, then press one by one, then you can select each song in the memory of the piano.

2. Demonstration song:

First hold down the "Function" key and then press the "Continuous singing" key, that is, play the current song, then the song starts to play from the current song, and then plays the next one after playing, and keeps playing all the songs until you press the "continuous singing" key again and stop playing.

Note: To cancel "clicking" or "sing-along", hold down the "Function" key first, and then press the "Start/Stop" key again.



3.Selected songs for demonstration and learning function auditions:

In the "singing" or "singing" mode, the song selection mode will be automatically entered. You can also select the song you want through the numeric keypad. Press and hold down the "Function" key, then directly enter the number of the demonstration song on the numeric key, and then release the function key.

4. Learning Function 1 (single-key mode) :

Press the "Function" key first, and then press the "Single key" key to enter the single-key teaching mode. Press any key to play the main melody notes and accompanying music. If you do not play the music after selecting the music, the machine will play a certain part of the accompanying music repeatedly.Until you play any key (this function is suitable for beginners), you can select the demonstration songs through the "- or +" key during the learning process. Select the demonstration songs: hold down the "Function" key and then press the "- or +" key to select the required demonstration songs, and cancel the "single key" learning function.Hold down the "Function" button, then press the "Single" button or the "Start/Stop" button, and release the "Function" button to exit the function.

5. Learning Function 2 (follow-up mode) :

Press and hold the "Function" key first, then press the "follow play" key, and then release the "function" key, then enter the follow play teaching mode, the machine will play the accompaniment music of the song you choose, the user must press the corresponding key according to the notes indicated by the light of the key, then continue to play the next note. If not press the keys light 或 without any background operation has been repeated this section, to play a normal only after playing the next note, in the process of learning through "- or +" key to select the demonstration songs, choose demonstration song: hold the "function" key and press "- or +" key to select the required to demonstrate, cancel "and" learning function, Hold down the "Function" button, then press the "Follow up" button or the "Start/Stop" button, and release the "Function" button to exit the function.

6. Learning Function 3 (Ensemble mode) :

Press the "function key" and then press the "ensemble" key to enter the ensemble teaching mode. The machine will play the accompaniment music of the song, and learners can play the main melody by themselves according to the accompaniment music played by the machine.If you do not play for 3 seconds, the main melody will be played automatically, and the key light will be lit to remind the learner. In the learning process, the "- or +" key can be used to select the demonstration song. Select the demonstration song: hold down the "Function" key and then press the "- or +" key to select the required demonstration song, cancel the learning function of "ensemble", hold down the "function" key, then press the "ensemble" key or "Start/Stop" key, and then release the "Function" key to exit the function.

7. Keyboard light on/off:

Keyboard light/open or closed the keyboard indicator is the key to open the key, switch on the keyboard light is "on" by default. Press and hold down the Function key and then the Keyboard Light key to turn off the keyboard light. If you repeat this operation more than once, the keyboard light can be turned on.

(IV) Use of recording and rhythm programming functions:

1. Use of recording and playback:

First hold down the "Function" key, then press the "recording" key, and then release the "Function" key, then you can record the notes you played. After the song is recorded, hold down the "Function" key, then press the "Play" key, and then release the "Function" key. At this time, the song you just played will be played from beginning to end. Press and hold down the "Function" key, then press the "Play" key again, you can re-play the song just recorded.To cancel the Recording and Play functions, simply hold down the Function key, then press the Recording key or the Start/Stop key, and release the Function key.

Note: The recording can record up to "695" notes, after the record will not record the following notes.

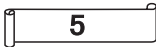

2. Use of programming and playback:

First hold down the "Function" key, then press the "programming" key, and then release the "Function" key, the piano will automatically switch to the percussion mode keyboard, then you can play the corresponding percussion instrument on the keyboard, the piano can record the percussion music you play on the keyboard one by one (up to 128 drum beats can be recorded), hold down the "function" key and then press the "play" key after recording. At this time, the piano will play the percussion notes you just edited. To adjust the playback speed, you can press the Speed - or Speed + key. To cancel the programming function, hold down the "Function" button and then press the "Programming" button or press the "Start/Stop" button once.

(V). Rhythm, chord, programming, prelude/Endnote functions:

1. Start of rhythm:

Press and hold the "Function" button first, then press the "Start/Stop" button once to start the rhythm immediately. To turn off the rhythm, hold down the "Function" button, press the "Start/Stop" button again, and then release the "Function" button.

2. Choice of rhythm:

This machine has 128 kinds of rhythm, numbered from "000" to "127" for you to choose, hold down the "Function" key, then press the "rhythm" key, you can select the rhythm you want on the number key. For example, if the rhythm code is 108, hold down the Function key, press the Rhythm key → press the 1 key → press the 0 key → press the 8 key and release the Function key. Use the "-" and "+" buttons to select the rhythm, hold down the "Function" key and then press the "-" key, the rhythm number will be reduced in sequence, press "+", the rhythm number will be increased in sequence until you select the rhythm, and then release the "Function" button. (as shown below)

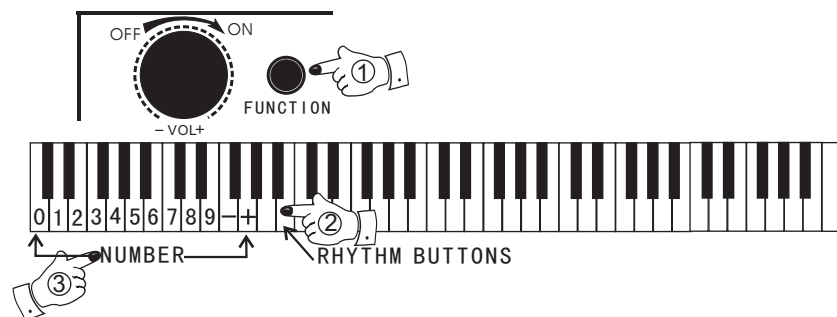

3. Use of synchronization function:

The rhythm and the main note are played synchronously. First hold down the "function" key and then press the "Sync" key. Then release the "function" key and press the chord keyboard area (1 ~ 19 keys from the left).

4. Use of synthetic chords:

Click "sync" button, then press "harmony", and in accordance with the "single chord" fingering or "refers to the chord" fingering playing, press the keyboard area (from left the keys of 1 ~ 19), the "single chord or" chord "refers to" sound broadcast together with the "rhythm", use "comprehensive harmony" when playing when using the "single chord" fingering the harp will automatically identify as "single chord", The piano recognizes polyfingering when the player uses polyfingering.

Note: To cancel the "Integrated chord", hold down the "function key" and then press the "Chord" key once. If you want to close the "chord tone" and "rhythm" together, hold down the "function key" and then press the "Start/Stop" key to stop the chord and rhythm playing.

5. Use of insert function:

In the process of rhythm use, first hold down the "function" key, and then press the "Insert" key, this opportunity will automatically play a strong intermezzo, and then continue the rhythm accompaniment.

6. Adjust the pace of the beat:

The speed of the rhythm is set to 120 beats/min. You can slow down or speed up the rhythm by holding down the "Function" key and then pressing the "Speed -" or "Speed +" key. There are 270 sections of speed control, and the speed range is 30 ~ 300. Normal power-on mode, the preset speed is 120; When selecting a demonstration song to play, the speed of the song will be the main, and the preset speed has nothing to do with; When selecting the rhythm to play, the set rhythm speed will be the main. Hold down the "Function" button and then press the "Speed -" or "Speed +" button for more than 2 seconds to continuously reduce or increase the speed. While playing the song, hold down the "Function" key and then hold down the "speed -" and "speed +" keys simultaneously to return the speed to the song's own speed. When playing the rhythm, hold down the "Function" key and then hold down the "Speed -" and "Speed +" keys at the same time. Then the speed will return to the default speed of the rhythm itself.

7. Accompaniment volume:

First hold down the "Function" key, then press the "Accompaniment -" key to reduce the electronic organ accompaniment volume, the minimum value can be adjusted to "1"; Press the "Accompaniment +" key to increase the accompaniment volume. The maximum volume can be set to "10".

8. Prelude/Finale:

Hold down the "Function" key and then press the "Prelude/Endnote" key to stop playing the rhythm after playing a short piece of endnote; If you hold down the "Function" key and press the "Prelude/Endnote" key when no rhythm is played, the current rhythm will begin to play after a short prelude.

IV、【POP Piano】Bluetooth connection and instructions for APP

【1】、"POP Piano APP" installation method:

Both apple and android devices can scan the qr code on the right to download and install

【2】、Find like-minded partners to exchange learning problems by POP Piano:



Product WeChat official account
POP Piano



Product QQ communication group
681178264

POP Piano APP



Official product website
WWW. abcpiano. cn

【3】、"POP Piano APP" bluetooth connection method:

- 1.Both apple and android devices can scan the qr code, download and install "POP Piano APP".
2. After installing the "POP" APP learning software on the phone.
3. Open the "POP" learning software on the phone and click the "🎹" icon on the phone to find blue Teeth (as shown below).

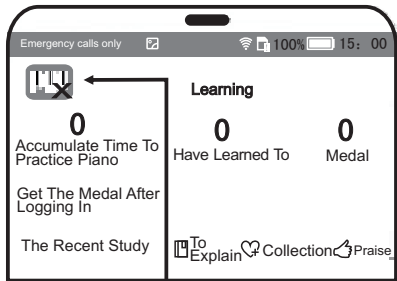

step 1:
Click on the icon on the phone
to go to the search Bluetooth and connect.

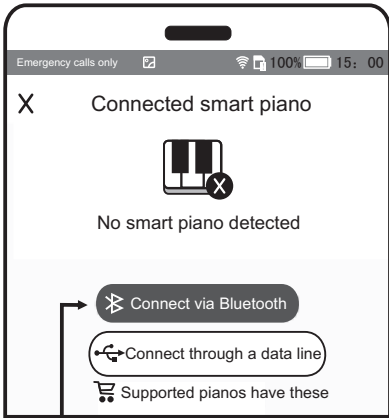

Step 2:
Click the icon on the phone to find the
bluetooth of the piano.

Step 3:
Click on the
Phone the
Figure of
Under the
Confirmation
One-step
Operation.

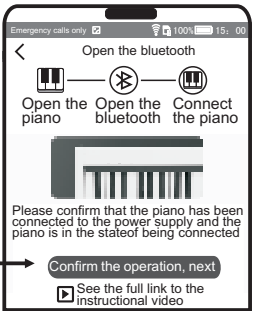

Step 5:
Click on the
Phone the
Figure of
Under the
Confirmation
One-step
Operation.

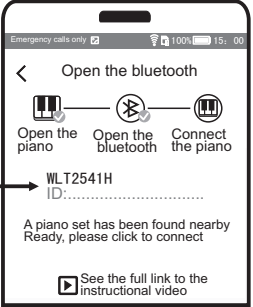

Step 7:
Click on the
Phone the
Figure of the
Go to the
Library
Selections.

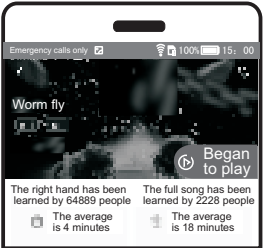
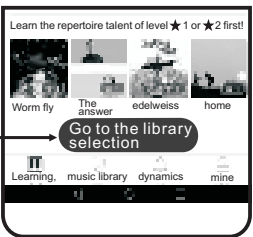

Step 9:
Click start
Push the
Phone
proceed
To the next
Step operation.

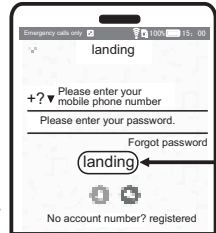

Step 4:
Click on the
Phone the
Figure of under
The confirmation
One-step operation.

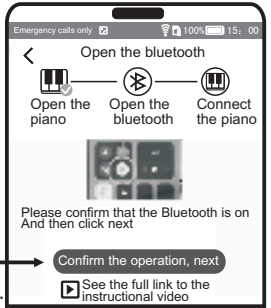

Step 6:
Click on the phone
This icon right here
To do bluetooth
The connection.

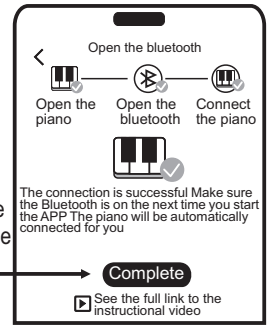

Step 8:
Click on the phone
These ICONS can
Choose your own
Favorite tracks.

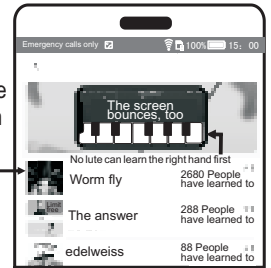

Step 10:
If there is no account The
number is available First
"wechat or""qq" account
Log in if there is an
Account enter it directly
Number and password
Then click"login" Key,
login can be.

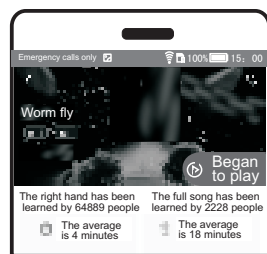

Step 11:
Go back to the beginning
Play the interface and
Press it again "start
Playing" button the
Phone prompts
One-step operation.

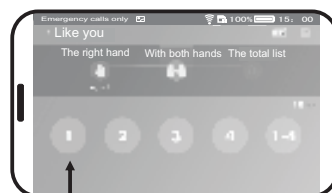

Step 12:
You can click "1" from the right hand
Learn, learn the right hand after further
Learning play with both hands.

【4】、"POP Piano APP" USES "data line" connection method:

1. The mobile phone is connected with the data cable to use the APP. The mobile phone of "POP Piano APP" learning software is downloaded and installed. The USB B end of the data cable is connected to the MIDI interface of the electronic organ, and the other end is connected to the mobile phone (as shown below)

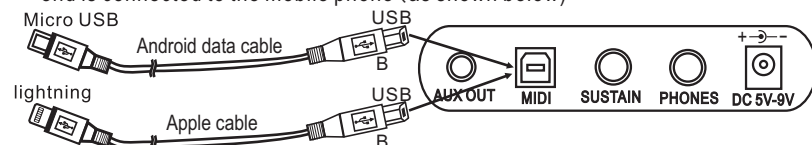

2. After the phone is connected, open the learning software "POP Piano APP", and then follow the instructions of the phone to conduct the next connection until the connection is successful (The following figure) .

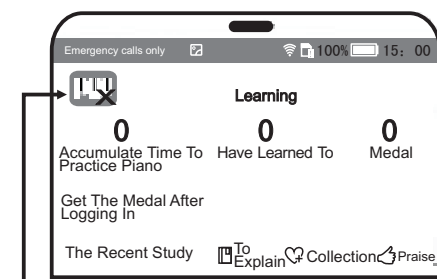

Step 1:
Click on this image on your phone
Enter "use data line"
Perform the connection operation.

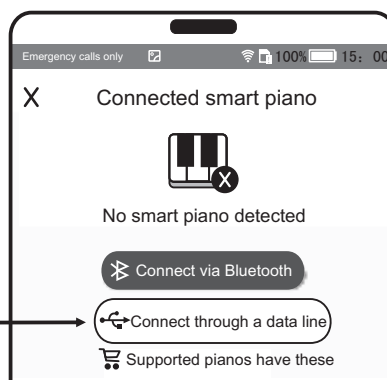

Step 2:
Click the icon on the phone to conduct "connect via
Data cable" connect, at this point can be installed
According to the phone prompt for the next step
Make the mobile phone will always prompt the next
Operation, can press the mobile phone prompt until
The connection is successful.

10

Note: compatibility of equipment

1. Iphone: it is suitable for iphone 5 and above with POP APP.
2. Android phone: it is suitable for use of POP APP and compatible with android phones above 5.0.

【5】、Search music score:

1. Search music score:

Open "POP Piano" APP and click on the top of "music library" to find your favorite songs through "popular songs", "all" and "children's songs" or search function.

2. POP Piano APP learning method introduction

Unique learning methods, complex tracks can also be self-taught, track decomposition step by step.

Simple step 4



- Challenge yourself to learn the piano with high scores
It's like playing a game

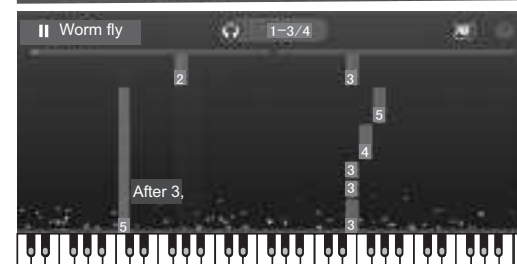

- The red bar states the left hand
- The blue bar is the right hand

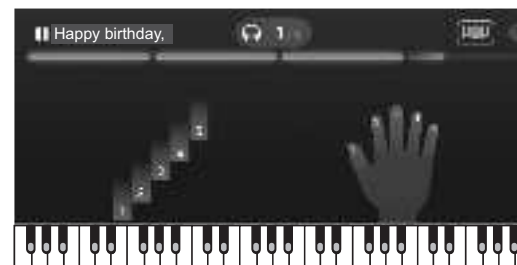

- 12345 represents fingering Numbers
- It is recommended to start at 1 star difficulty

11

V、"Play the piano" APP connection and instructions

(I) Installation method of "play the piano" :

Both apple and android devices can scan the qr code on the right, download and install "play the piano".

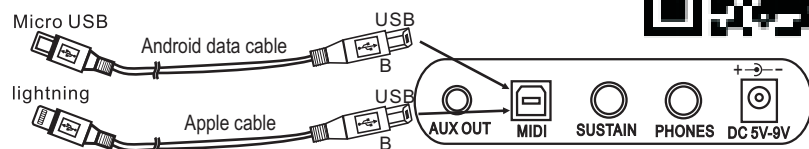
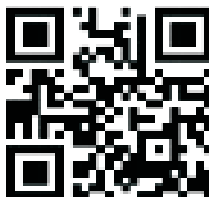

(II). Methods to connect "lute bar" APP with data cable:

1. Iphone:

1.1. Connect USB b-head of apple data cable to MIDI interface of electronic organ, and the other end of apple device is; Lightning connects to a phone or tablet.

2、Equipment compatibility requirements:

2. 1 . The apple version;

IOS 8.0 and above. Los6.0 above system supports iPhone5, 5c, 5s, 6s, 6plus, iPad4/air, iPad mini/mini2.

3 . How to use the "bluetooth" connection of iphone:

Apple also can use "bluetooth" system mobile phones to connect to our electric piano, first of all to download and install the good and "play" mobile phone APP learning software, and open the "bluetooth" in the mobile phone to open the "play" APP on your phone, and then click the "spectral library" on the APP to choose songs, find the favorite songs and then click the "staff" on the APP to open the selected songs, after open the selected songs interface, this interface has a "set" button, click "Settings" button, can be found in the Settings button the submenu "bluetooth connection" click "bluetooth connection" button to go right now, The phone will automatically look up the bluetooth and automatically connect to the piano.

Note: apple mobile phone system in the use of "play" and "bluetooth", by connecting the APP on the "play" APP temporarily does not support that the light of learning function, (suggest use "data line" with apple system mobile phones connect this harp, mobile phone using the "play" APP for apple system through "data line" way to connect the instrument to support lighting function).

(3) . Android version: mobile phone, tablet connection method:

1、Android phone connection method:

Connect USB B of the android data cable to the MIDI interface of the keyboard, and connect the other end of android to the phone or tablet with Micro USB.

Android 4.0 and above. (after connecting, run lute bar, the system will pop up "allow application lute bar access to this USB device?" To select "yes" or "yes", allow the system to connect to the electric piano.

Note: 1.some android devices USB hos function compatibility problems, if encountered this problem, please replace the device connection.

2. "Lute bar" APP learning software only supports the connection of "data line" when android devices are connected to the piano, and does not support other connections such as "bluetooth" connection.

VI、Play the piano APP instructions

(I) Search music score:

1、Search music score:

Open the APP of "lute bar", click "switch instrument" at the top of "music library" and select "piano". Then in the page of music library, you can find your favorite songs through "hottest collection", "hit single" or search function.

2、Music score display mode:

After entering the selected track interface, there will be music score display mode selection, select "staff" will enter the normal staff display interface, you can see the spectrum play "kara piano" will enter the waterfall flow interface, you can exercise gamification.

(II) Intelligent learning functions:

1、To play:

After playing the music score, click the icon of intelligent learning function "To play" in the APP, and you can choose the following mode:" left hand ", "right hand" or both hands. Example: after selecting "right hand" mode, the piano will automatically play the melody of the left hand, and the keyboard flash will indicate which key should be pressed by the right hand. If you stop and do not play practice, music will not go down, only you play right to continue.

2、With flare:

After the music is played, click the icon of intelligent learning function "With play" in the APP to select the accompanying mode:" left hand "and" right hand ". For example: after selecting the "right hand" mode, the piano will automatically play the melody of the left hand. The player only needs to play the melody of the right hand.

3、Speed:

In the practice of playing, users can also press the "speed control" menu by selecting (-original speed +) to change the playback speed of the music to adjust the difficulty of playing.

4、AB answer read:

In playing practice, you can press "AB repeat" to select the interval of the music score for repeat reading. For example, when the music score is played to A certain syllable, press "A", and then press "B" after the music score continues to play for A period, then the music score will be repeatedly played between the two presses.

Appendix I (140 kinds) timbre table

000 Acoustic Grand Piano	047 Timpani	094 Pad 7 (halo)
001 Bright Acoustic Piano	048 String Ensemble1	095 Pad 8 (sweep)
002 Electric Grand Piano	049 String Ensemble2	096 FX 1 (rain)
003 Honky-tonk Piano	050 Synth Strings1	097 FX 2 (soundtrack)
004 Rhodes Piano	051 Synth Strings2	098 FX 3 (crystal)
005 Chorused Piano	052 Choir Aahs	099 FX 4 (atmosphere)
006 Harpsichord	053 Voice Oohs	100 FX 5 (brightness)
007 Clavichord	054 Synth Voice	101 FX 6 (goblins)
008 Celesta	055 Orchestra Hit	102 FX 7 (echoes)
009 Glockenspiel	056 Trumpet	103 FX 8 (sci-fi)
010 Music box	057 Trombone	104 Sitar
011 Vibraphone	058 Tuba	105 Banjo
012 Marimba	059 Muted Trumpet	106 Shamisen
013 Xylophone	060 French Horn	107 Koto
014 Tubular Bell	061 Brass Section	108 Kalimba
015 Dulcimer	062 Synth Brass1	109 Bagpipe
016 Drawbar Organ	063 Synth Brass2	110 Fiddle
017 Percussive Organ	064 oprano Sax	111 Shanai
018 Rock Organ	065 Alto Sax	112 Tinkle Bell
019 Church Organ	066 Tenor Sax	113 Agogo
020 Reed Organ	067 Baritone Sax	114 Steel Drums
021 Accordion	068 Oboe	115 Woodblock
022 Harmonica	069 English Horn	116 Taiko Drum
023 Tango Accordion	070 Bassoon	117 Melodic Tom
024 Acoustic Guitar (nylon)	071 Clarinet	118 Synth Drum
025 Acoustic Guitar (steel)	072 Piccolo	119 Reverse Cymbal
026 Electric Guitar (jazz)	073 Flute	120 Guitar Fret Noise
027 Electric Guitar (clean)	074 Recorder	121 Breath Noise
028 Electric Guitar (muted)	075 Pan Flute	122 Seashore
029 Overdriven Guitar	076 Bottle Blow	123 Bird Tweet
030 Distortion Guitar	077 Shakuhachi	124 Telephone Ring
031 Guitar Harmonics	078 Whistle	125 Helicopter
032 Acoustic Bass	079 Ocarina	126 Applause
033 Electric Bass(finger)	080 Lead 1 (square)	127 Gunshot
034 Electric Bass (pick)	081 Lead 2 (sawtooth)	128 Dulcimer
035 Fretless Bass	082 Lead 3 (calliope lead)	129 zheng
036 Slap Bass1	083 Lead 4 (chiff lead)	130 Zhong Ruan
037 Slap Bass2	084 Lead 5 (charang)	131 Pi Pa
038 Synth Bass1	085 Lead 6 (voice)	132 Big Souna
039 Synth Bass2	086 Lead 7 (fifths)	133 Souna
040 Violin	087 Lead 8 (bass+lead)	134 Er Hu
041 Viola	088 Pad 1 (new age)	135 Yue Hu
042 Cello	089 Pad 2 (warm)	136 Di Zi
043 Contrabass	090 Pad 3 (polysynth)	137 Bong Di
044 Tremolo Strings	091 Pad 4 (choir)	138 Koto
045 Pizzicato Strings	092 Pad 5 (bowed)	139 Qu Di
046 Orchestral Harp	093 Pad 6 (metallic)	

Appendix II (128 kinds) Rhythmic table

000 Club Pop	043 Calypso	086 Disco Party
001 16 Beat Pop	044 GuadDance	087 Disco Samba
002 8 Beat Pop	045 Reggae12Beat	088 UK Pop
003 8 Beat Soul	046 Reggae16Beat	089 Club Dance
004 8 Beat Rock	047 Bossanova	090 Modern R&B
005 Rap Pop	048 Mambo 1	091 Hip Shuffle
006 Pop Rock	049 Mambo 2	092 Charleston
007 60's Soul	050 Bolero	093 DiscoPop
008 70's Soul	051 Cumbia	094 DiscoSoul
009 Funk	052 Latin Rock	095 DiscoTrot
010 16 Beat Shuffle	053 Disco Latin	096 EuroBeat
011 Twist	054 Tijuana	097 Rap
012 British Pop	055 Reggae	098 Rave
013 Hard Rock	056 Slow Rock 1	099 Country 1
014 Fusion	057 Slow Rock 2	100 Country 2
015 FunkShuffl	058 Slow Rock 3	101 Big Band Shuffle 1
016 FusionShuffl	059 Slow Soul	102 Big Band Shuffle 2
017 Rock'n Roll 1	060 8 Beat Adria	103 Big Band Shuffle 3
018 Rock'n Roll 2	061 Classic Piano	104 Fast Band 1
019 Straight Rock	062 Unplugged	105 Fast Band 2
020 Jazz Rock	063 Pop Ballad	106 Cat Groove
021 FastGospel	064 Pop New Age	107 Dixie Jazz
022 FolkRock	065 8 Beat Modern	108 Medium Jazz
023 RockBilly	066 Country Ballad	109 Jazz Big Band
024 RockBoogie	067 Love Song	110 Jazz Club
025 RockChaCha	068 Modern Country Pop	111 Ragtime
026 RockClassical	069 Electro Pop	112 Ober Polka
027 RockShuffle	070 Acoustic Ballad	113 Polka Pop
028 RockPop	071 Piano Ballad	114 Blue Grass 1
029 Waltz	072 R&B Ballad	115 Blue Grass 2
030 Cha Cha	073 Rock Ballad	116 Blue Grass 3
031 Rumba	074 Slow & Easy	117 Pop Waltz
032 Jive	075 Analog Ballad	118 USA March
033 Pasodoble	076 E_Ballad	119 Hully Gully
034 Samba 1	077 Techno 1	120 Tarantella
035 Samba 2	078 Techno 2	121 Limbo Rock
036 Schlager Rock 1	079 Funky Disco	122 Swing Waltz
037 Schlager Rock 2	080 Saturday Night	123 Pub Piano
038 FoxTrot	081 Club Latin	124 Jazz Waltz 1
039 Viennese Waltz	082 Disco Chocolate	125 Jazz Waltz 2
040 Tango1	083 Disco Fox	126 Show Tune
041 Tango2	084 Disco Funk	127 Polka
042 Salsa	085 Disco Hands	

Appendix III: Song comparison table

000 Radiant	020 erquan Mirroring The Moon	040 Dreams Of Rive Town
001 Night On The Grassland	021 The Palm Of God	041 Grandma's Penghu Bend
002 Come Back Home Often	022 Purple Bamboo Tune	042 The Lover
003 Good Days	023 Three Auspicious Treasures	043 Wish You Peaceful
004 Childhood	024 There Is Always Love	044 Impulsive Punishment
005 Curved Moon	Everywhere	045 Shepherd Boy Piccolo
006 Liuyang River	025 In That Far Away Place	046 Spring Festival Overture
007 Meet At Aobao	026 Prairie Song	047 May All Be Blessed
008 Is Where The Peach Blossoms Bloom	027 On Market Road	With Longevity
009 Tibetan Plateau	028 Lifts Your Hood	048 Platforms
010 The Girl Of Ali Mountain	029 Same Song	049 Welcome March
011 Go In To A New Era	030 Eighteen Bends On Mountain Road	050 Exultant
012 The Butterfly Lovers	031 Farewell	051 Efforts Will Win
013 Why Are Flowers So Red	032 Happy Hometown	052 Dance Song
014 Good Life Of Peace	033 Love Song Of Kangding	053 Xinjiang Dance Music
015 Horse Racing	034 Iron Blood Heart	054 The Sunset Is Drunk
016 Whip And Horse Transport Grain Busy	035 Beijing Tune	055 Prairie Paeon
017 Step Higher And Higher	036 A Plum	056 When Will You Come Again
018 Beautiful Taihu Lake	037 Full Moon West Building	057 Snail And Oriole Bird
019 Osmanthus Blossoms	038 Goodbye Dabie Mountain	058 March Of The Warships
Everywhere In August	039 Happy Chinese Year	059 Mighty Division



































Appendix IV: 61 groups of keyboard percussion comparison table

C2# 	D2# 	F2# 	G2# 	A2# 	C3# 	D3# 	F3# 	G3# 	A3#
C2 	D2 	E2 	F2 	G2 	A2 	B2 	C3 	D3 	E3
C4# 	D4# 	F4# 	G4# 	A4# 	C5# 	D5# 	F5# 	G5# 	A5#
C4 	D4 	E4 	F4 	G4 	A4 	B4 	C5 	D5 	E5
C6# 	D6# 	F6# 	G6# 	A6# 	C7 				



















Appendix IV: single finger chord chart

	M	m	7	m7
C				
C#				
D				
D#				
E				
F				
F#				
G				
G#				
A				
A#				
B				

Appendix V: multi-fingered chord chart (1)

	M	m	7	m7	dim7	M7	m7-5	dim
C								
C#								
D								
D#								
E								
F								
F#								
G								
G#								
A								
A#								
B								

Appendix VI: multi-fingered chord chart (2)

	aug	sus4	7sus4	m add9	mM7	7-5	add9
C							
C#							
D							
D#							
E							
F							
F#							
G							
G#							
A							
A#							
B							

Maintenance precautions

It is very important to do the maintenance of the piano well and reduce the fault.

- ◆ do not open the shell of the piano and try to decompose the components, and do not make any changes to the interior. If the function is abnormal in use, please stop using the instrument and send it to qualified maintenance personnel for maintenance.
- ◆ please use the specified voltage and adapter, using the wrong voltage and adapter will damage the electronic organ.
- ◆ before connecting the instrument to other devices, all the power should be turned off and the volume should be turned down to the lowest level.
- ◆ do not put the power adapter near a heat source (such as a heater or radiator). Do not bend the adapter wire too much. Do not place heavy objects or wind other objects on the adapter wire to avoid damaging the adapter wire. Do not use the plug of the instrument in the multi-purpose socket and near the flammable and explosive places, so as not to cause danger. When need not be in long time or thunder, want to close power supply and adapter unplug, when unplug adapter power supply plug, want to hold adapter to pull out, do not pull wire directly. The adapter used in this product cannot be used for other products to avoid danger .
- ◆ do not put the instrument in an environment with dust, vibration, low temperature or high temperature (such as in direct sunlight, next to the heater or in the car under the sun) to avoid damage to the appearance and internal components.
- ◆ do not put the instrument in an unstable place, lest it is damaged by falling. Do not sit or place heavy objects on the harp.
- ◆ avoid the electric piano from rain or damp. Do not place liquid containers on the instrument to prevent liquid from flowing into the instrument and damaging the internal components.
- ◆ please remove the adapter before cleaning the instrument body. Do not use wet hands to insert or remove the adapterWipe it.
- ◆ do not use paint coating, organic solvent or chemical impregnation cloth to wipe the piano body, do not put vinyl products on the piano body, so as not to make the panel or keyboard fade, check the adapter regularly and remove the dirt on its surface.
- ◆ Wet weather needs to do a good job of moisture-proof work, because excessive humidity will make the internal circuit bad phenomenon. Therefore, the instrument should always be electrified in wet weather, and dissipate the moisture in the instrument through the heat generated during operation. If the weather is too humid, use a dust proof damp cloth to cover the instrument.
- ◆ it must be used by adults after opening the packaging, please remove the plastic packaging bag and other packaging items properly stored or discarded, do not let children play, prevent suffocation! This product contains small parts, do not put into the mouth to avoid accidental swallowing, this product is not suitable for children aged 3 and under .

- ▶ The specifications are subject to change without prior notice.
- ▶ this instruction manual and the design of the packing box are for reference only.

空白页

Blank page

FCC STATEMENT :

This device complies with Part 15 of the FCC Rules. Operation is subject to the following two conditions:

- (1) This device may not cause harmful interference, and
- (2) This device must accept any interference received, including interference that may cause undesired operation.

Warning: Changes or modifications not expressly approved by the party responsible for compliance could void the user's authority to operate the equipment.

NOTE: This equipment has been tested and found to comply with the limits for a Class B digital device, pursuant to Part 15 of the FCC Rules. These limits are designed to provide reasonable protection against harmful interference in a residential installation. This equipment generates uses and can radiate radio frequency energy and, if not installed and used in accordance with the instructions, may cause harmful interference to radio communications. However, there is no guarantee that interference will not occur in a particular installation. If this equipment does cause harmful interference to radio or television reception, which can be determined by turning the equipment off and on, the user is encouraged to try to correct the interference by one or more of the following measures:

- Reorient or relocate the receiving antenna.
- Increase the separation between the equipment and receiver.
- Connect the equipment into an outlet on a circuit different from that to which the receiver is connected.
- Consult the dealer or an experienced radio/TV technician for help.

RF warning statement:

The device has been evaluated to meet general RF exposure requirement. The device can be used in portable exposure condition without restriction.