

NEBULA

by Anker

✉ support@seenebula.com
support@anker.com (日本)
support.me@seenebula.com (For Middle East and Africa Only)
ced-cn@anker.com (中国)

☎ +90 (850) 460 14 14 (TR) +44 (0) 1604 936200 (UK)
+8 (800) 511-86-23 (RU) +49 (0) 69 9579 7960 (DE)
+86 400 0550 036 (中国) +971 8000320817a (UAE)
03 4455 7823 (日本) +966 8008500030 (KSA)
+82 02-1661-9246 (한국) +965 22069086 (Kuwait)
+91 18003138831 (India) +20 8000000826 (Egypt)
+886 801 491310 (中国台湾) +61 3 8331 4800 (AU)
+1 (800) 988 7973 (US/Canada)
+971 529750842 (Middle East & Africa)

© Anker Innovations Limited. All rights reserved.
NEBULA and the NEBULA logo are trademarks of Anker Innovations Limited, registered in the United States and other countries.
Model: D2342

For a detailed user manual and more information, scan the QR code or visit:
support.seenebula.com/s



51005004881 V01

8. Bluetooth Speaker Mode

The projector can also be used as a Bluetooth speaker.

- Go to Settings > Display & Sound > Sound > Bluetooth Speaker Mode to switch your NEBULA projector from Projector Mode to Bluetooth Speaker Mode.
- Enable Bluetooth on your smartphone and select **[NEBULA Cosmos 4K SE]** as the device to be connected.

9. Playing Video from HDMI / USB Devices

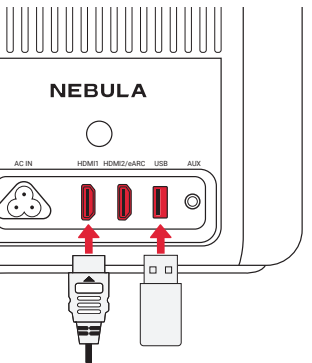

This projector supports connections with various HDMI playback devices such as TV sticks, TV boxes, DVD players, set-top boxes (STB), game consoles, or other devices.

With this projector, you can also enjoy music, video, and pictures that are stored on a USB storage device (not included).

The HDMI2/eARC port supports the connection of external devices such as sound systems for audio return capabilities.

Important Safety Instructions

- The power cord shall connect to socket-outlet with earthing connection.
- The power supply should be installed near the equipment and for pluggable equipment, the socket-outlet must be easily accessible.
- Only use the power cord provided by the manufacturer. Using unauthorized power cord may cause danger and violate the authorization of the projector as well as the guarantee.
- Plug of the power cord is considered as the disconnect device. Once unplugged, the main unit is considered as disconnected from the power source.
- Do not use the device in an environment where the temperature is too high or too low. Never expose the device to strong sunshine or wet environments.
- The suitable temperature range for projector D2342 and its accessories is 32°F-95°F / 0°C-35°C.
- The suitable temperature for remote controller D0442X is 113°F / 45°C max.
- It is recommended to supply the device in an environment with a temperature that ranges from 41°F-77°F / 5°C ~25°C.
- When supplying, place the device in an environment that has a normal room temperature and good ventilation.
- Possibly hazardous optical radiation emitted from this product may be harmful to the eyes. Do not stare at operating beam.

Remote controller
CAUTION: RISK OF EXPLOSION IF BATTERY IS REPLACED BY AN INCORRECT TYPE. DISPOSE OF USED BATTERIES ACCORDING TO THE INSTRUCTIONS.

ATTENTION : RISQUE D'EXPLOSION SI LA BATTERIE EST REMPLACÉE PAR UN TYPE INCORRECT. JETEZ LES BATTERIES USAGÉES CONFORMÉMENT AUX INSTRUCTIONS.

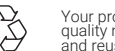

Your product is designed and manufactured with high quality materials and components, which can be recycled and reused.

13

NOTICE (Europe and United Kingdom)

This product complies with the radio interference requirements of the European Community.

Declaration of Conformity

Hereby, Anker Innovations Limited. declares that this device is in compliance with the essential requirements and other relevant provisions of Directive 2014/53/EU. For the Declaration of Conformity, visit the website:
<https://support.seenebula.com/s/articleRecommend?type=Download&secondType=doc>

RF exposure information for D2342 : The Maximum Permissible Exposure (MPE) level has been calculated based on a distance of d=20 cm between the device and the human body. To maintain compliance with RF exposure requirement, use product that maintain a 20cm distance between the device and human body.
Bluetooth Operating Frequency Range: 2402~2480 MHz;
Bluetooth Maximum Output Power: 6.99dBm(EIRP);

	AT	BE	BG	HR	CY	CZ	DK
	EE	FI	FR	DE	EL	HU	IE
	IT	LV	LT	LU	MT	NL	PL
	PT	RO	SK	SI	ES	SE	UK

The following importer is the responsible party (contract for EU matters)
Anker Innovations Deutschland GmbH | Georg-Muche-Strasse 3, 80807 Munich, Germany
The following importer is the responsible party (contract for UK matters):
Anker Technology (UK) Limited | GNR8, 49 Clarendon Road, Watford, Hertfordshire, WD17 1HP, United Kingdom

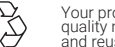

Your product is designed and manufactured with high quality materials and components, which can be recycled and reused.

14

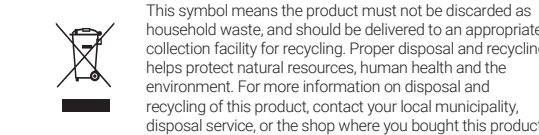

Notice (United States of America) FCC Statement

This device complies with Part 15 of the FCC Rules. Operation is subject to the following two conditions: (1) this device may not cause harmful interference, and (2) this device must accept any interference received, including interference that may cause undesired operation.

Warning: Changes or modifications not expressly approved by the party responsible for compliance could void the user's authority to operate the equipment.

Note: This equipment has been tested and found to comply with the limits for a Class B digital device, pursuant to Part 15 of the FCC Rules. These limits are designed to provide reasonable protection against harmful interference in a residential installation.

This equipment generates uses and can radiate radio frequency energy and, if not installed and used in accordance with the instructions, may cause harmful interference to radio communications. However, there is no guarantee that interference will not occur in a particular installation. If this equipment does cause harmful interference to radio or television reception, which can be determined by turning the equipment off and on, the user is encouraged to try to correct the interference by one or more of the following measures: (1) Reorient or relocate the receiving antenna. (2) Increase the separation between the equipment and receiver. (3) Connect the equipment into an outlet on a circuit different from that to which the receiver is connected. (4) Consult the dealer or an experienced radio/TV technician for help.

FCC Radio Frequency Exposure Statement

(Projector) The device has been evaluated to meet general RF exposure requirements. The device can be used in fixed/mobile

15

exposure conditions. The min separation distance is 20cm. (Remote Control) According to the Federal Communications Commission (FCC) Radiation Exposure Statement, the device has low power and does not require calculation of RF exposure. This device can be used without restrictions under portable exposure conditions.

Notice: Shielded cables

All connections to other computing devices must be made using shielded cables to maintain compliance with FCC regulations.

The following importer is the responsible party.

Company Name: Fantasia Trading LLC
Address: 5350 Ontario Mills Pkwy, Suite 100, Ontario, CA 91764
Telephone: 1-800-988-7973
5150~5350 MHz can be used indoors only.

Notice (Canada) IC Statement

This device complies with Industry Canada licence-exempt RSS standard(s). Operation is subject to the following two conditions: 1) this device may not cause interference, and

2) this device must accept any interference, including interference that may cause undesired operation of the device.

L'exploitation est autorisée aux deux conditions suivantes:

1) l'appareil ne doit pas produire de brouillage, et
2) l'utilisateur de l'appareil doit accepter tout brouillage radioélectrique subi, même si le brouillage est susceptible d'en compromettre le fonctionnement.

This Class B digital apparatus complies with Canadian ICES-003. Cet appareil numérique de la classe B est conforme à la norme NMB-003 du Canada.

IC RF Statement

(Projector) When using the product, maintain a distance of 20cm from the body to ensure compliance with RF exposure requirements. (Projecteur) Lors de l'utilisation du produit, maintenez une distance de 20 cm du corps afin de vous conformer aux exigences en matière d'exposition RF.

(Remote Control) According to the Industry Canada (IC) Radiation on Exposure Statement, the device has low power and does not require calculation of RF exposure.

16

This device can be used without restrictions under portable exposure conditions.

(Télécommande) Selon la déclaration d'Industrie Canada (IC) sur l'exposition aux radiations, l'appareil a une faible puissance et ne nécessite pas de calcul d'exposition aux RF. Cet appareil peut être utilisé sans restrictions dans des conditions d'exposition portables. 5150~5250 MHz can be used indoors only. 5150~5250 MHz peut être utilisé à l'intérieur uniquement.

Statement of Compliance

Hereby, Anker Innovations Limited declares that this device is in compliance with The Product Security and Telecommunications Infrastructure (Security Requirements for Relevant Connectable Products) Regulations 2023 . For the Statement of Compliance, visit the Web site <https://uk.seenebula.com/psti-related>.

Laser Safety



- RG1 IEC 62471-5:2015
- Complies with IEC 60825-1:2014 Class 1 and IEC 62471-5:2015 Risk Group 1.
- Potential hazards may exist during lamp or product servicing.
- Service shall be performed only by authorized, trained servicing personnel.
- Do not open the enclosure of the product.
- When the enclosure of the product is damaged, don't use it anymore.
- Do not open the enclosure of laser module inside the product.
- When the enclosure of laser module inside the product is damaged, don't use it anymore.
- Laser inside. Be aware of the risk of skin or corneal burns.

17

HDMI
HIGH-DEFINITION MULTIMEDIA INTERFACE
HDMI, and HDMI logo and High-Definition Multimedia Interface are trademarks or registered trademarks of HDMI licensing LLC in the United States and other countries.

Dolby AUDIO
Dolby, Dolby Audio, Dolby Vision, and the double-D symbol are trademarks of Dolby Laboratories Licensing Corporation. Manufactured under license from Dolby Laboratories. Confidential unpublished works. Copyright © 1992~2024 Dolby Laboratories. All rights reserved.

Dolby VISION

Bluetooth®
The Bluetooth® word mark and logos are registered trademarks owned by the Bluetooth SIG, Inc. and any use of such marks by Anker Innovations Limited is under license. Other trademarks and trade names are those of their respective owners.

PAP 22
Raccolta Carta



18

NEBULA

by Anker

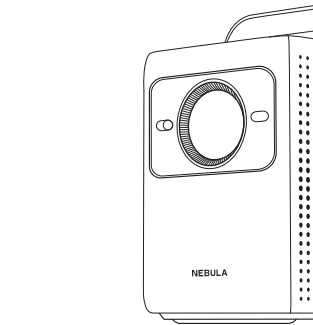

Cosmos 4K SE Quick Start Guide

1. Scan for Support



01

2. At a Glance

• Front & Back

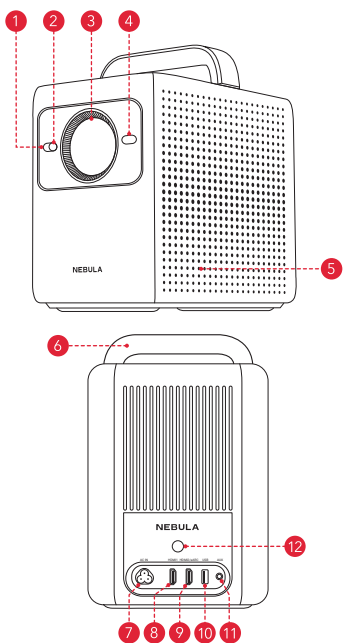

02

• Top & Bottom

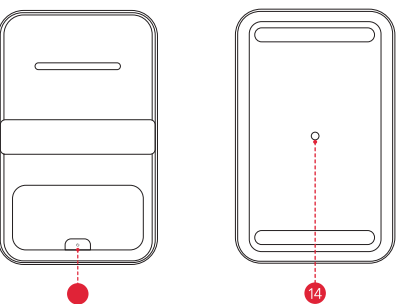

1	Illuminance Sensor	8	HDMI 1
2	Image Sensor	9	HDMI 2/eARC
3	Lens	10	USB-A
4	ToF (Time of Flight)	11	AUX
5	Speaker	12	Infrared Receiver
6	Handle	13	Power Button
7	AC Input	14	1/4" Tripod Socket

03

• Remote Control

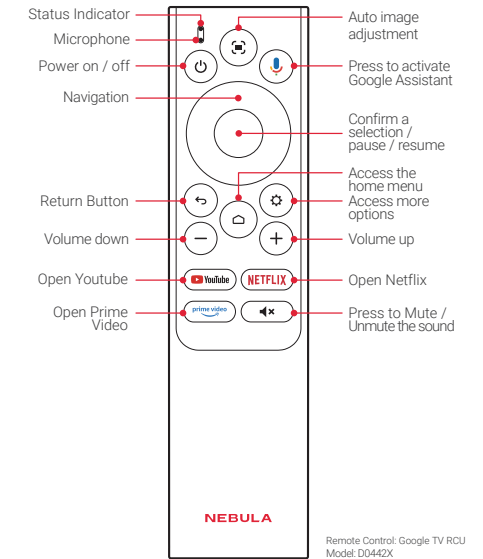

Remote Control: Google TV RCU
Model: D0442X

04

3. Preparing Remote Control

- Slide down to open the battery compartment.
- Insert 2 new AAA batteries, matching the polarity (+ / -) as indicated.

05

4. Connecting to Power

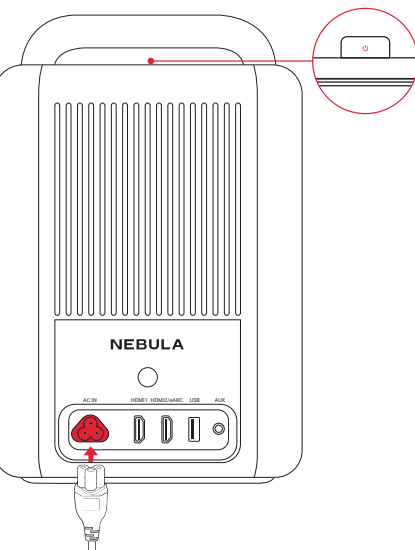

Connect the power cord to NEBULA Cosmos 4K SE and then to the power supply.

When successfully connected to the power supply, the power button on the projector will light up in red.

06

5. Powering On/Off

Power On: Press the power button once.

When the projector is powered on, the power button will turn steady blue.

Power Off:

- Press and hold the power button for 3 seconds (wait for on-screen prompt).
- Confirm power off with the remote control or wait 20 seconds for automatic power off. Then the power button will go off.

Standby Mode: Short press the power button to enter standby mode.

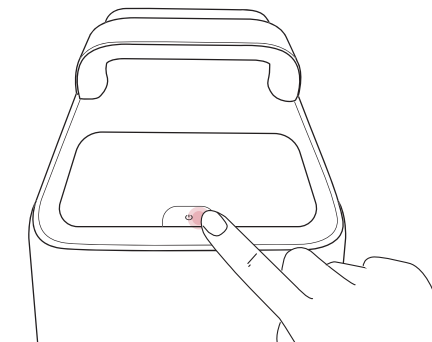

07

6. Controlling

• Connect the Projector with the Remote Control

After powering on the projector, follow the on-screen instructions to pair your remote control with the projector.

Press and hold the confirm and volume down buttons for several seconds until the prompt of successful Bluetooth connection appears.

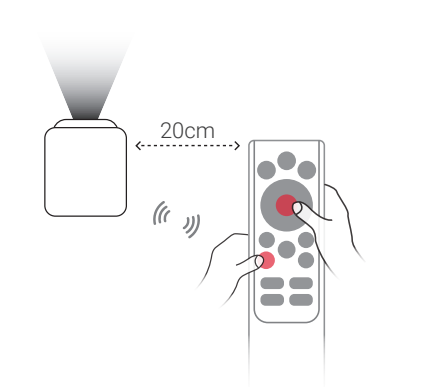

Activating Google Assistant via remote control is unavailable without Bluetooth connection.

08

• Control the Projector with NEBULA Connect App



You can also easily control your projector via the NEBULA Connect app on your smartphone.

09

7. Wireless Screen Mirroring

Wirelessly cast movies, games, and music from your phone to NEBULA Cosmos 4K SE.

To enable Screen Mirroring, please make sure NEBULA Cosmos 4K SE and your phone are connected to the same wireless network.

• For iOS devices:

- Access the Control Center of your device and click .
- Click on "NEBULA Cosmos 4K SE" in the device list.

• For Android devices:

- Enter Google Home APP and select "NEBULA Cosmos 4K SE".
- Tap  on the page.

• Streaming Services:

- Enter streaming service APP and tap the Airplay icon or  icon.
- Click on the name of your NEBULA device in the device list: "NEBULA Cosmos 4K SE".

Copyright content from streaming services like Netflix, Disney+, and the DRM video cannot be mirrored.

10