

# WF01

Product user guide

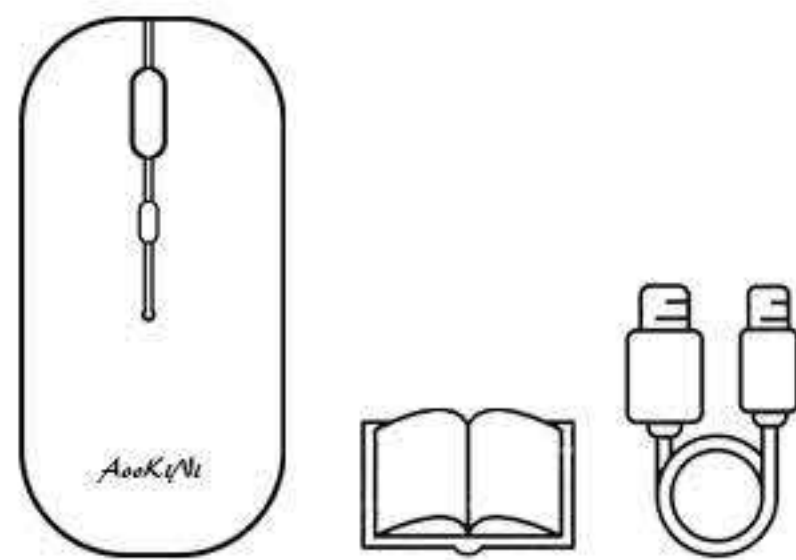

Packaging includes:

- ▶ Wireless Mouse
- ▶ USB charging cable
- ▶ Quick operation guide

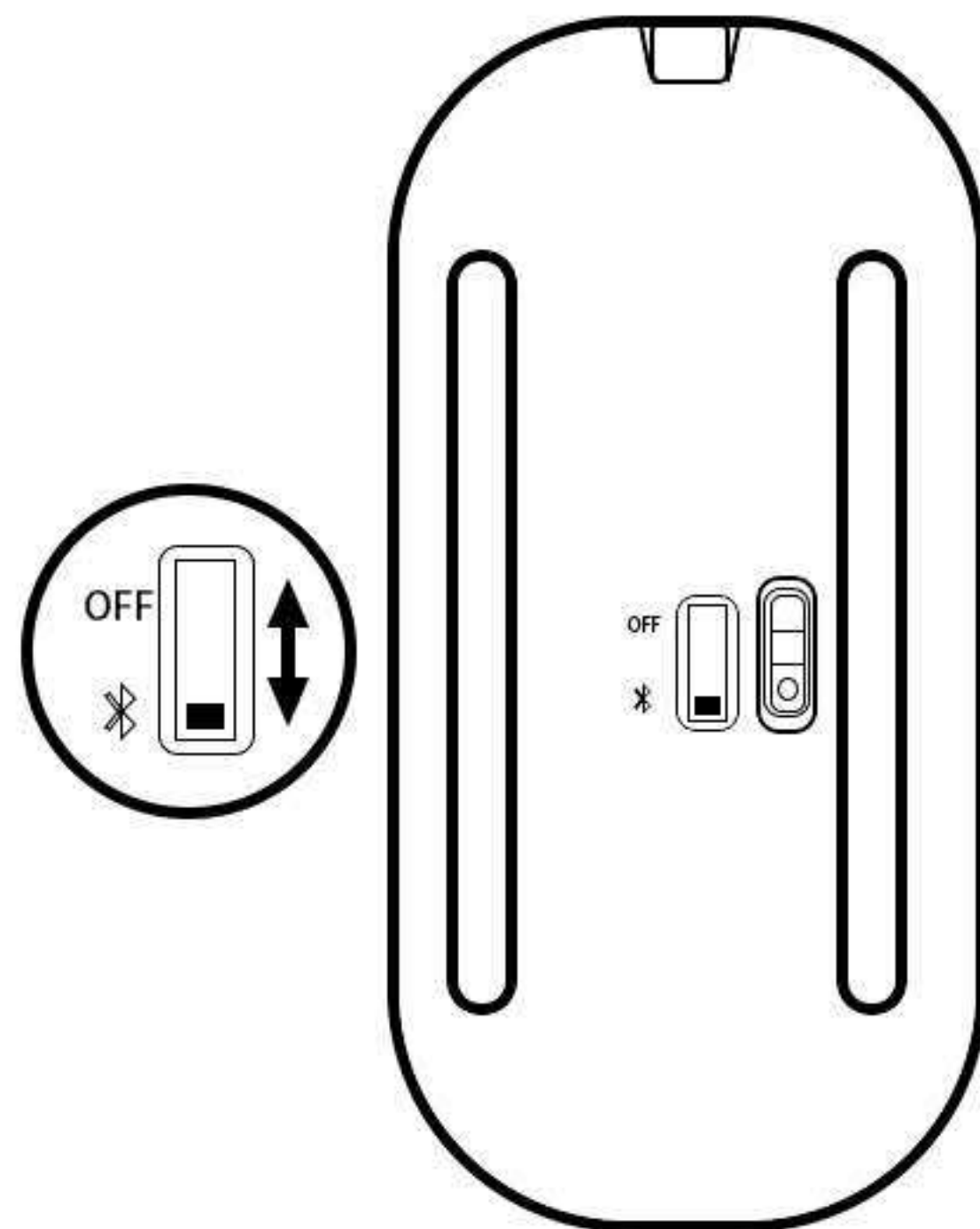

Choose the connection mode you want

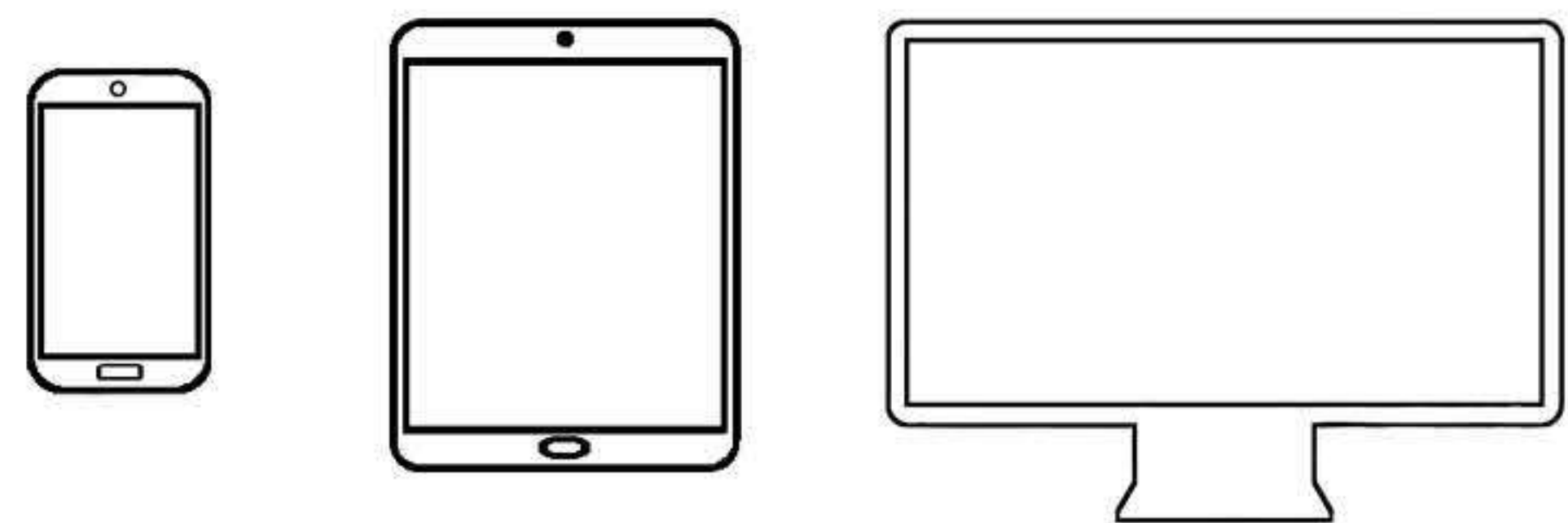

Compatible with Windows/Android/MAC OS system and other systems suitable for desktops, laptops, PCs, Macbooks and other devices

## Charge function instruction

When the battery is insufficient, use the USB cable to connect the mouse charging interface

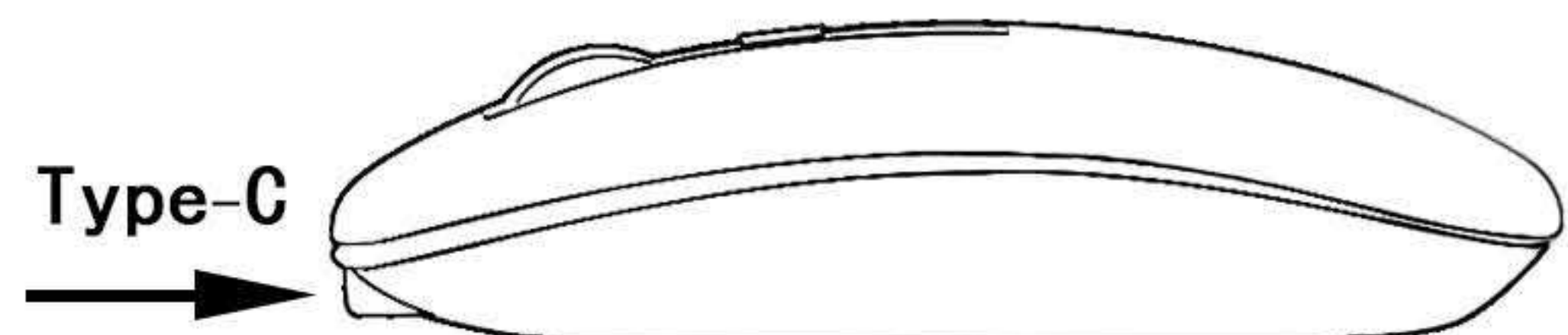

Charging cable connected to the computer is USB, charging when the red light, the charging process is about 1-2 hours, charging complete the red light goes out

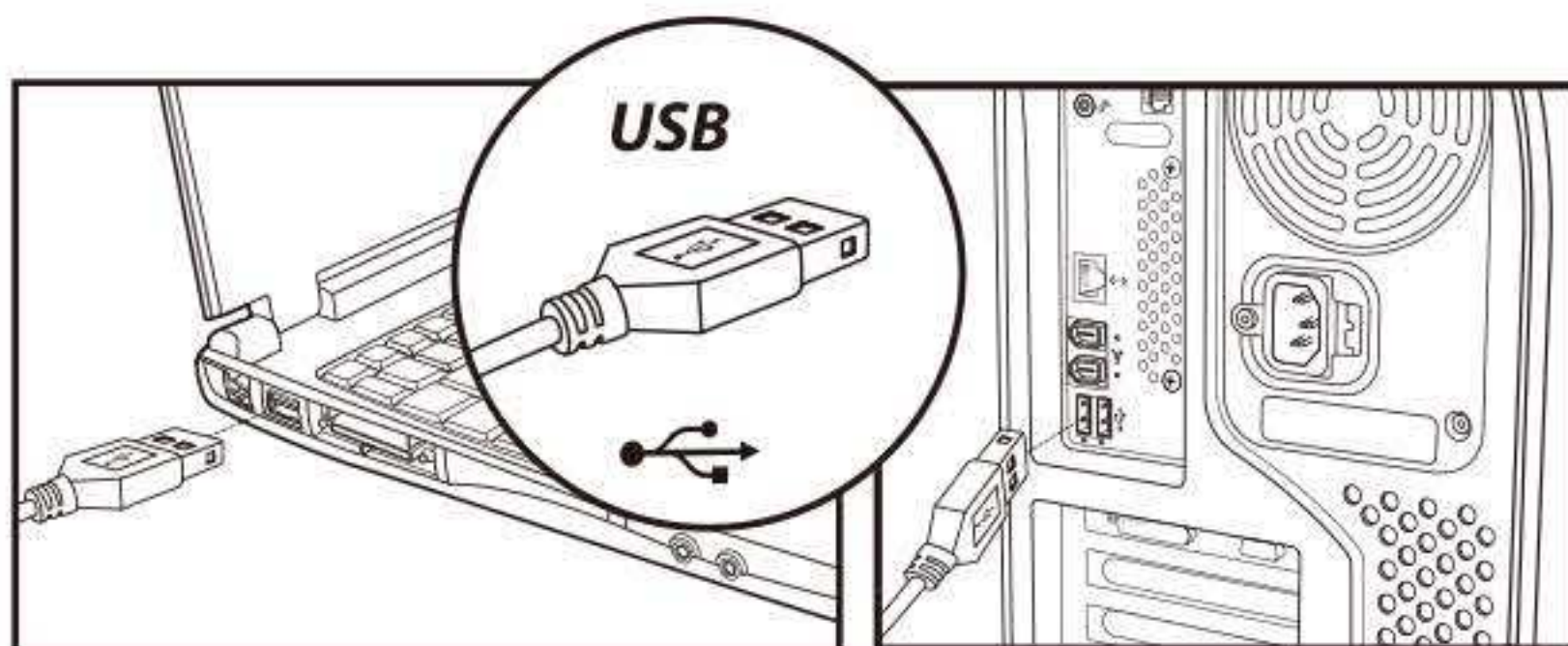

## Data parameter

**Basic:**  
Data transmission: 2Mbps  
Frequency: 2402MHZ-2480MHz  
Channel: 40  
Engine: Red optical  
Distance: 20m  
Charging battery: 3.7V/400mA  
Voltage: 3.7V  
Current: 20mA  
Mouse Key life: Above 3 millions  
Mouse Size: 102x57x32mm  
Mouse Weight: 79±3g

**Step current:**  
Working current: 20mA  
Standby current: 1.3mA  
Dormancy current: 50uA  
No receiver state: 10-25uA

**Tracking performance:**  
Mouse resolution: 1600DPI  
Mouse rate of return: 250Hz

**System requirement:**  
IBM or compatible computer  
Windows: 2000/ME/XP(X64)  
Vista/7/8/10  
Mac OS X (More than V10.4)  
Workable USB port

### Compensation

(1) We stand behind the quality of our mouse and want you to be completely satisfied with your purchase. If you encounter any quality problems with the product within one year of the purchase date, we offer free replacement of the product. Just provide your order information and the problem you encountered. We will verify the issue and arrange for a replacement product for you as soon as possible.

(2) In addition, if you are not satisfied with the mouse within 30 days of receiving it, you can return it for a full refund or exchange, no questions asked. We understand that sometimes products may not meet your expectations or needs, and we want to make sure you have a hassle-free shopping experience with us. We will verify the issue and arrange for a replacement product for you as soon as possible.

(3) If you have any questions, concerns, or feedback about the mouse or our service, please do not hesitate to contact our customer service at any time. We are committed to providing prompt and useful assistance to all customers, and value your confidence and endorsement.

(4) The limited warranty does not cover problems or damages caused by the following reasons:

- ① Accidents, misuse, improper operation, or any unauthorized maintenance, modification, or dismantling.
- ② Improper operation or maintenance, violation of the product description during application, or improper connection of the voltage source.

### FCC Statement

Note: This equipment has been tested and found to comply with the limits for a Class B digital device, pursuant to part 15 of the FCC Rules. These limits are designed to provide reasonable protection against harmful interference in a residential installation. This equipment generates, uses, and can radiate radio frequency energy and, if not installed and used in accordance with the instructions, may cause harmful interference to radio communications. However, there is no guarantee that interference will not occur in a particular installation. If this equipment does cause harmful interference to radio or television reception, which can be determined by turning the equipment off and on, the user is encouraged to try to correct the interference by one or more of the

following measures:

- Reorient or relocate the receiving antenna.
- Increase the separation between the equipment and receiver.
- Connect the equipment into an outlet on a circuit different from that to which the receiver is connected.
- Consult the dealer or an experienced radio/TV technician for help.

This device complies with part 15 of the FCC Rules. Operation is subject to the following two conditions:

- (1) This device may not cause harmful interference, and
- (2) this device must accept any interference received, including interference that may cause undesired operation. Any changes or modifications not expressly approved by the party responsible for compliance could void the user's authority to operate the equipment. The device has evaluated to meet general RF exposure requirement. The device can be used in portable exposure without restriction.