



Anker Innovations Limited. All rights reserved, registered in the United States and other countries.

Anker Innovations Limited  
Unit 56, 8th Floor, Tower 2, Admiralty Centre, 18 Harcourt  
Road, Hong Kong

Model: T8426  
51005005153\_V1



# Floodlight Camera E30

## Quick Start Guide

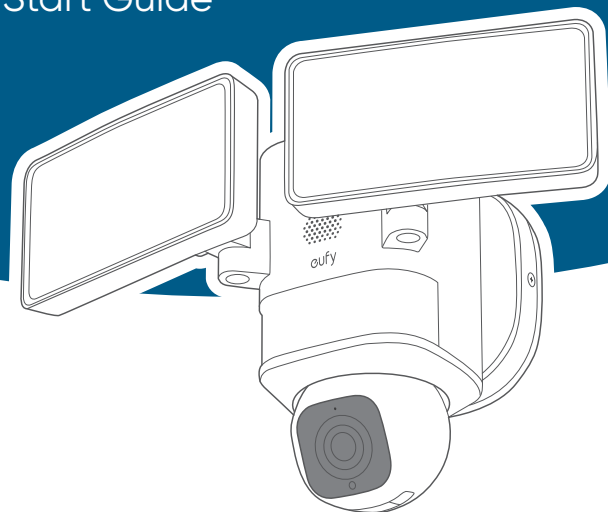

# SAFETY INSTRUCTIONS

- Check your local laws for installation. If you are outside of North America, installation and wiring must be performed by a licensed electrician.
- This manual is for informational purposes only. Working with electricity can be dangerous, so it's important to take proper safety precautions. Hire a licensed electrician if you are not comfortable or inexperienced with the processes and tools described.
- Disconnect power at the fuse or circuit breaker before installation.
- Do not install the product near flammable surfaces.
- To avoid the risk of shock, injury, or death, always be cautious when working with electricity.
- Make sure the floodlight camera is properly grounded.
- The floodlight camera must be mounted on a wall and on a UL-listed junction box.

# WHAT'S IN THE BOX

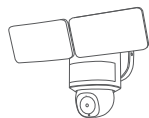

Floodlight Cam



USB Cable  
(For Quick Setup  
Only)



Mounting Bracket  
(Pre-installed on  
Camera)



Positioning  
Sticker



Wall Screws  
(Bag A)



Base Screws  
(Bag B)

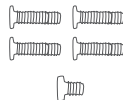

Bracket and Earth  
Screws (Bag C)

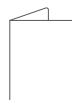

Quick Start  
Guide

# WHAT YOU NEED (Not Provided)



#2 or #1 Phillips  
Crosshead Screwdriver  
02

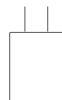

USB  
Power Adapter



Ladder  
(If necessary)

# AT A GLANCE

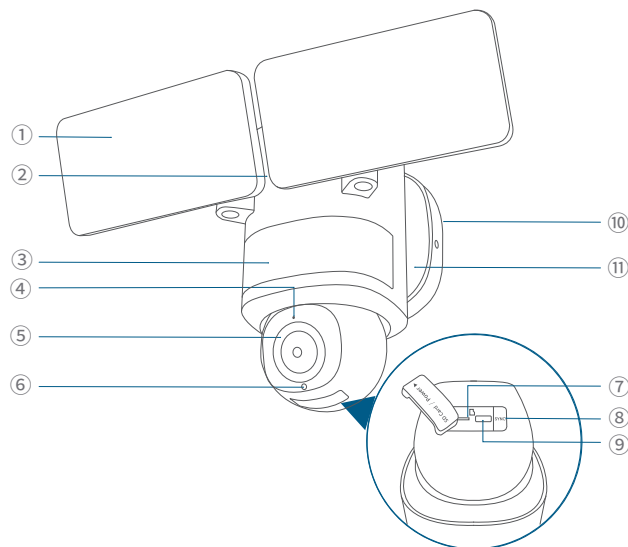

- ① Floodlight
- ② Speaker
- ③ Motion Sensor Component
- ④ Microphone
- ⑤ Camera
- ⑥ LED Indicator
- ⑦ MicroSD Card Slot  
• Insert a microSD card\* (not provided) to store recordings
- ⑧ SYNC Button
- ⑨ Power Input (For Quick Setup)
- ⑩ Mounting Bracket
- ⑪ Mounting Base

**\*Use at least a Class 10 microSD card with a maximum of 128 GB.**

# SETTING UP THE SYSTEM

1. Download and install the eufy Security app, then sign in or create an account.



2. Power on the floodlight camera by using the USB-C charging cable and a power adapter (5V/2A, not provided).

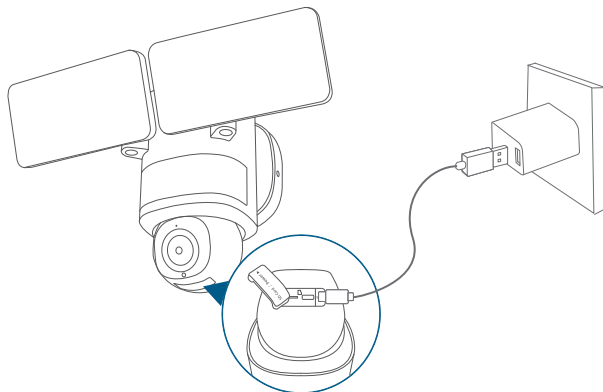

- To avoid scratching the floodlight camera, do not peel off the protective film for the time being.
- The floodlights will only light up when in wired power mode. The USB-powered connection is used for setting up the camera safely inside your home.
- Make sure you can stream video from your floodlight camera **BEFORE INSTALLATION.**

3. Tap + in the app and follow the in-app instructions to add the camera.

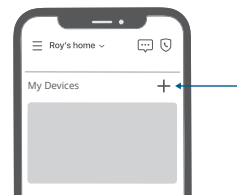

4. Disconnect from the power adapter, then close the USB port cover.

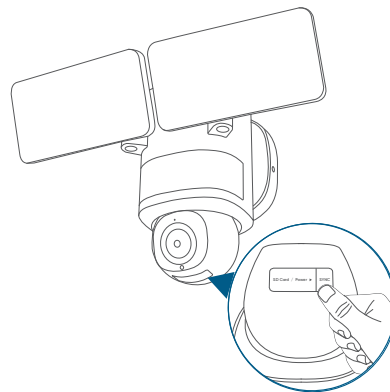

The USB port cover must be closed to prevent water from entering the floodlight camera.

# PREPARING FOR INSTALLATION (IMPORTANT)

## Check local laws for installation

If you are outside of North America, installation and wiring must be performed by a licensed electrician. Always follow code standards when installing wired connections.

## Shut Power Off at the Breaker



### Risk of Electrical Shock

- Turn off the power at your circuit breaker or fuse box before continuing, consult with a licensed electrician if needed.
- Switch on/off the lights to make sure the electricity to the installation area is shut off.
- Verify that the power supply is a 100~240 VAC 50/60 Hz power source.
- Keep the breaker off at any time during the installation process.

NOTE: Do not use a dimmer switch or timer for this product.

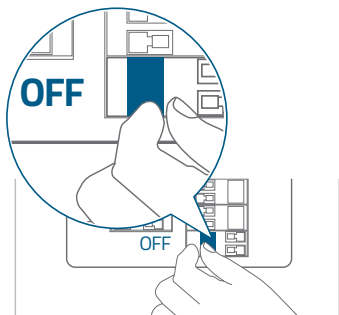

# INSTALLING YOUR FLOODLIGHT CAMERA

## Separate the Mounting Bracket

Separate the mounting bracket from the camera and set it aside for later installation.

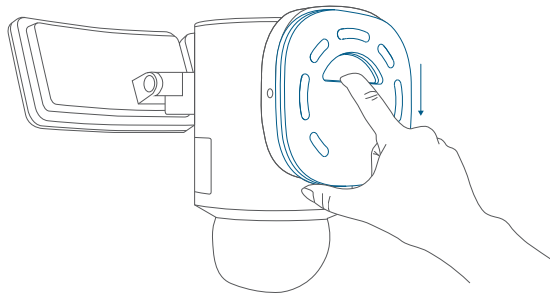

## Select a Location

You can mount the floodlight camera vertically on a wall or hang it from a ceiling. **With the power off at the breaker**, remove the existing floodlight if you have one.

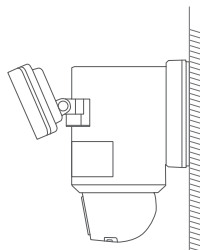

Wall Mounting

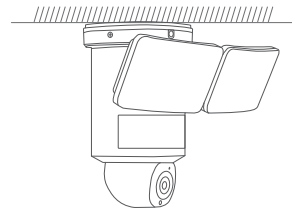

Overhang Mounting

For overhang mounting, reinstall the mounting base first.

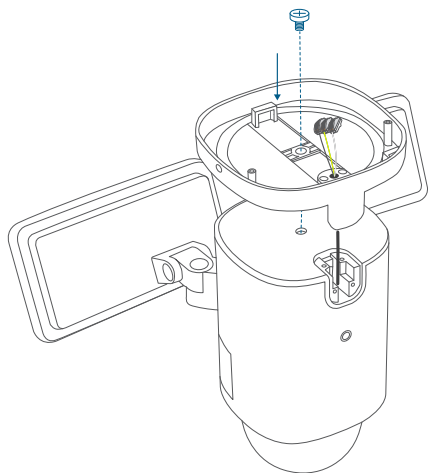
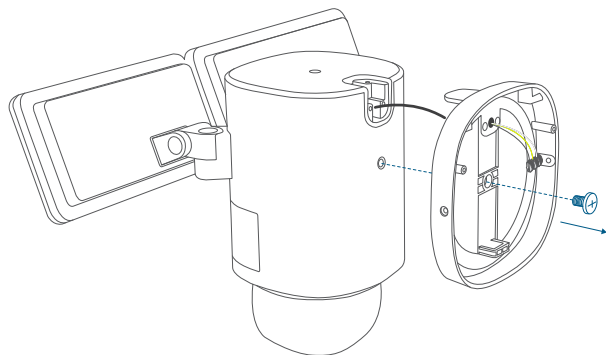

## Recommended Height

We recommend mounting the camera 8 ft (2.44 m) above the ground to achieve up to 40 ft (12 m) of motion detection range.

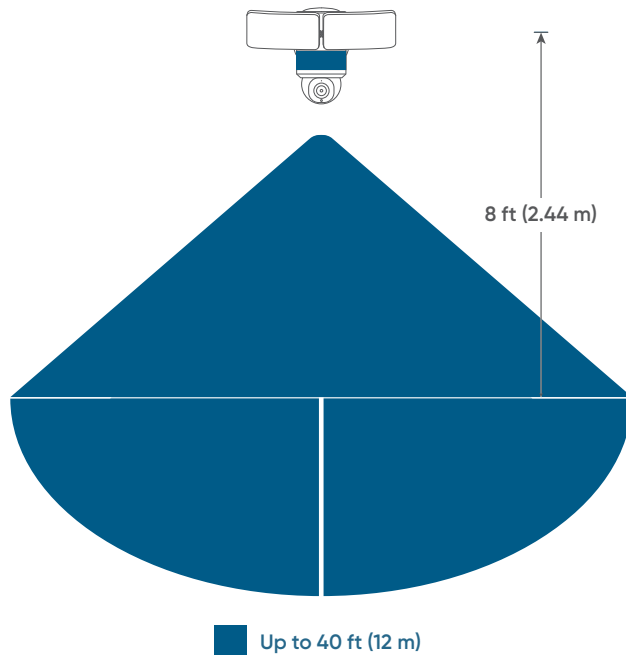

## Install the Mounting Bracket

1. Run the existing wires through the hole of the junction box.
2. Hold the mounting bracket onto the junction box, align the screw holes, remove the foam from the holes, then secure the mounting bracket on the wall or ceiling with the **Bracket Screws (Bag C)**.

### Wall Mounting

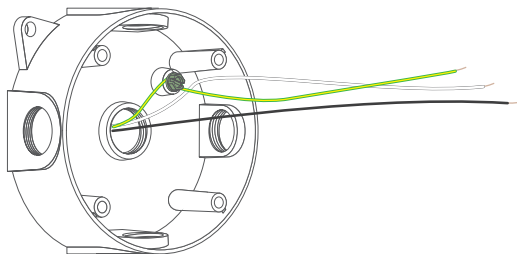

2. Separately connect the junction box's ground wire (bare copper / green / green & yellow), live wire (black), and neutral wire (white) to the floodlight camera's ground wire (green & yellow), live wire (black), and neutral wire (white) using wire connectors, then secure the connections with a screwdriver.

- If the existing ground wire has been connected to the junction box, or if there is no ground wire, connect the floodlight camera's ground wire directly to the junction box or mounting plate.

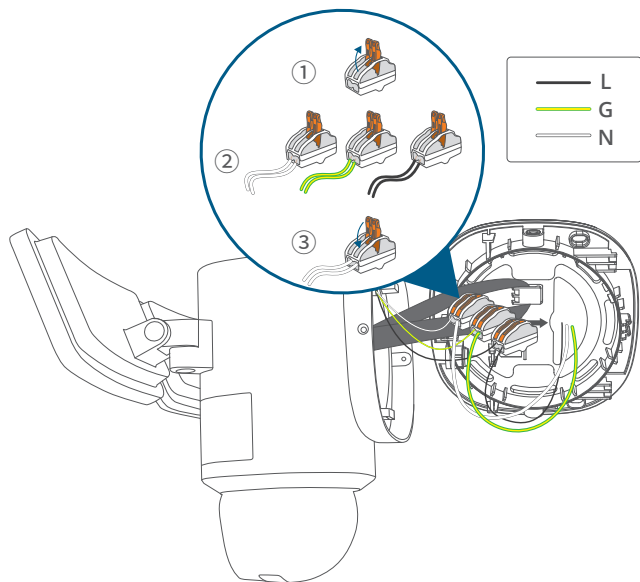

Never cross-connect. The wires must be connected with matching colors. If you have problems with the proper operation of the floodlight camera, consult a licensed technician.

## Place the Camera on the Mounting Bracket

Snap the mounting base onto the mounting bracket, align the holes, and secure it with 2 base screws (**Bag B**).

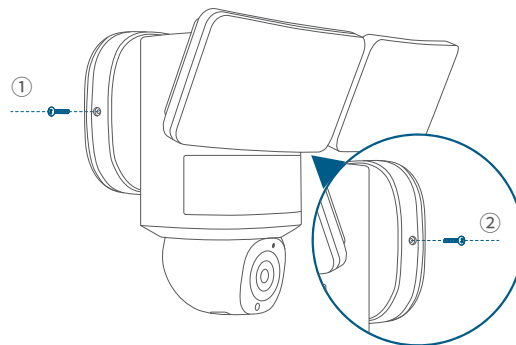
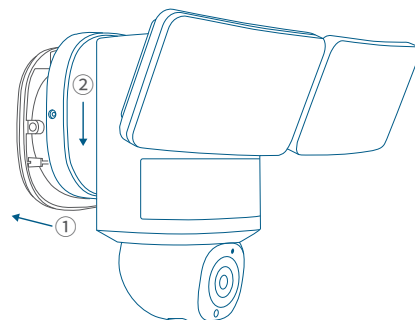

2. Remove the label and protective film from the floodlight.



Clean the camera with a lens cleaning cloth.



# ADJUSTING THE LIGHTING ANGLE

Manually pull up and down or left and right to adjust the floodlight vertically or horizontally.

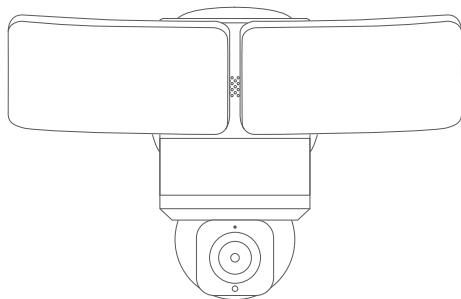
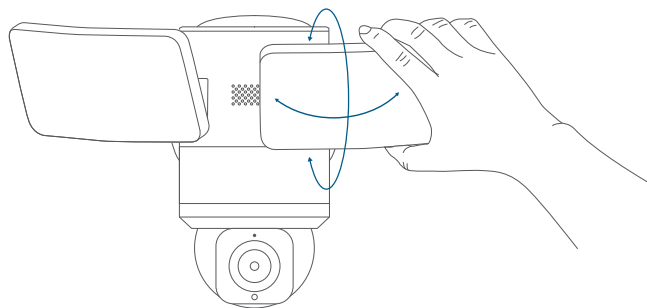

# RESTORING POWER



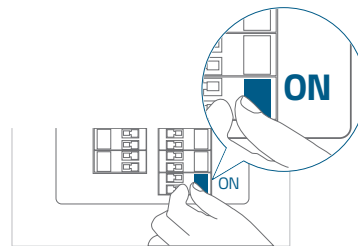

1. Switch on the main circuit breaker in the house.



In case the floodlight camera is not powered on, switch off the circuit breaker before checking the wiring of the floodlight camera.

2. Now you can access various features and change settings in the eufy Security app.  
For troubleshooting, check the Help section in the eufy Security app.

# LED LIGHT GUIDE

	Solid Violet	System is initializing
	Solid Blue	Working normally or ready for setup
	Blinking Red	Not connected to the internet
	Solid Red	Recording or the live stream is being viewed
	Flashing Blue and Red	Firmware upgrade in progress Note: Keep the camera connected to a power source

# SAFETY INSTRUCTIONS

- This equipment is not suitable for use in locations where children are likely to be present. This equipment is not intended for use by children.
- Do not use the product in any way other than described herein in order to avoid personal injury or property damage.
- User should comply with the laws and regulations of the corresponding countries and regions where the equipment is located (used), abide by professional ethics, pay attention to safety obligations, and strictly prohibit the use of our products or equipment for any illegal purposes. Our company will not be responsible for any violators' legal liability under any circumstances.
- An appropriate disconnect device shall be provided as part of the building installation
- An all-pole mains switch in accordance with Annex L shall be incorporated in the electrical installation of the building
- The luminaire intended to be mounted on or over an outlet box and shall be provided with supply conductors long enough to extend 150mm(6 in) into the outlet box.
- ⚠ Caution, risk of electric shock

## THIS PRODUCT MUST BE INSTALLED IN ACCORDANCE WITH THE APPLICABLE INSTALLATION CODE BY A PERSON FAMILIAR WITH THE CONSTRUCTION AND OPERATION OF THE PRODUCT AND THE HAZARDS INVOLVED

MIN 90°C SUPPLY CONDUCTORS

# NOTICE

## NOTICE (United States of America)

### FCC Statement

This device complies with Part 15 of the FCC Rules. Operation is subject to the following two conditions: (1) this device may not cause harmful interference, and (2) this device must accept any interference received, including interference that may cause undesired operation.

Warning: Changes or modifications not expressly approved by the party responsible for compliance could void the user's authority to operate the equipment.

Note: This equipment has been tested and found to comply with the limits for a Class B digital device, pursuant to Part 15 of the FCC Rules. These limits are designed to provide reasonable protection against harmful interference in a residential installation.

This equipment generates uses and can radiate radio frequency energy and, if not installed and used in accordance with the instructions, may cause harmful interference to radio communications. However, there is no guarantee that interference will not occur in a particular installation. If this equipment does cause harmful interference to radio or television reception, which can be determined by turning the equipment off and on, the user is encouraged to try to correct the interference by one or more of the following measures: (1) Reorient or relocate the receiving antenna. (2) Increase the separation between the equipment and receiver. (3) Connect the equipment into an outlet on a circuit different from that to which the receiver is connected. (4) Consult the dealer or an experienced radio/TV technician for help.

### FCC Radio Frequency Exposure Statement

The device has been evaluated to meet general RF exposure requirements. The device can be used in fixed/mobile exposure condition. The min separation distance is 20cm.

Notice: Shielded cables

All connections to other computing devices must be made using shielded cables to maintain compliance with FCC regulations.

The following importer is the responsible party

Company Name: POWER MOBILE LIFE, LLC  
Address: 10800 NE 8TH ST #900, BELLEVUE, WA, 98004, UNITED STATES  
Telephone: 1-800-988-7973



Your product is designed and manufactured with high-quality materials and components, which can be recycled and reused.



This symbol means the product must not be discarded as household waste and should be delivered to an appropriate collection facility for recycling. Proper disposal and recycling help protect natural resources, human health, and the environment. For more information on the disposal and recycling of this product, contact your local municipality, disposal service, or the shop where you bought this product.

### IC Statement

This device complies with Industry Canada licence-exempt RSS standard(s). Operation is subject to the following two conditions:

- (1) this device may not cause interference, and
- (2) this device must accept any interference, including interference that may cause undesired operation of the device.

Le présent appareil est conforme aux CNR d'Industrie Canada applicables aux appareils radio exempts de licence. L'exploitation est autorisée aux deux conditions suivantes:

- (1) l'appareil ne doit pas produire de brouillage, et
- (2) l'utilisateur de l'appareil doit accepter tout brouillage radioélectrique subi, même si le brouillage est susceptible d'en compromettre le fonctionnement.

This Class B digital apparatus complies with Canadian ICES-003.  
Cet appareil numérique de la classe B est conforme à la norme NMB-003 du Canada.

### IC RF Statement:

When using the product, maintain a distance of 20cm from the body to ensure compliance with RF exposure requirements.

Lors de l'utilisation du produit, maintenez une distance de 20 cm du corps afin de vous conformer aux exigences en matière d'exposition RF.

## Customer Service



12-month limited warranty



(US) +1 (800) 988 7973  
(UK) +44 (0) 1604 936 200  
(DE) +49 (0) 69 9579 7960  
(中国) +86 400 0550 036  
(日本) 03 4455 7823  
(AU) +61 3 8331 4800  
(Egypt) +20 8000000826  
(UAE) +971 8000320817  
(Kuwait) +965 22069086  
(KSA) +966 8008500030



support@eufy.com  
service@myeufy.com.au



@EufyOfficial



@EufyOfficial



@EufyOfficial

