

快速入门手册

小方灯

65W 双色温摄影灯

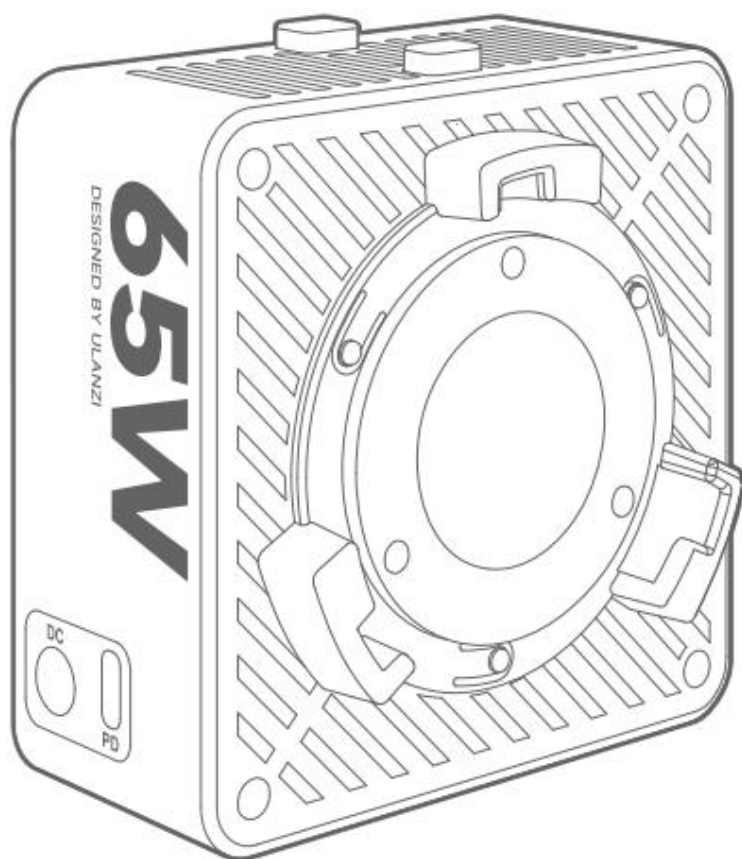

产品视图

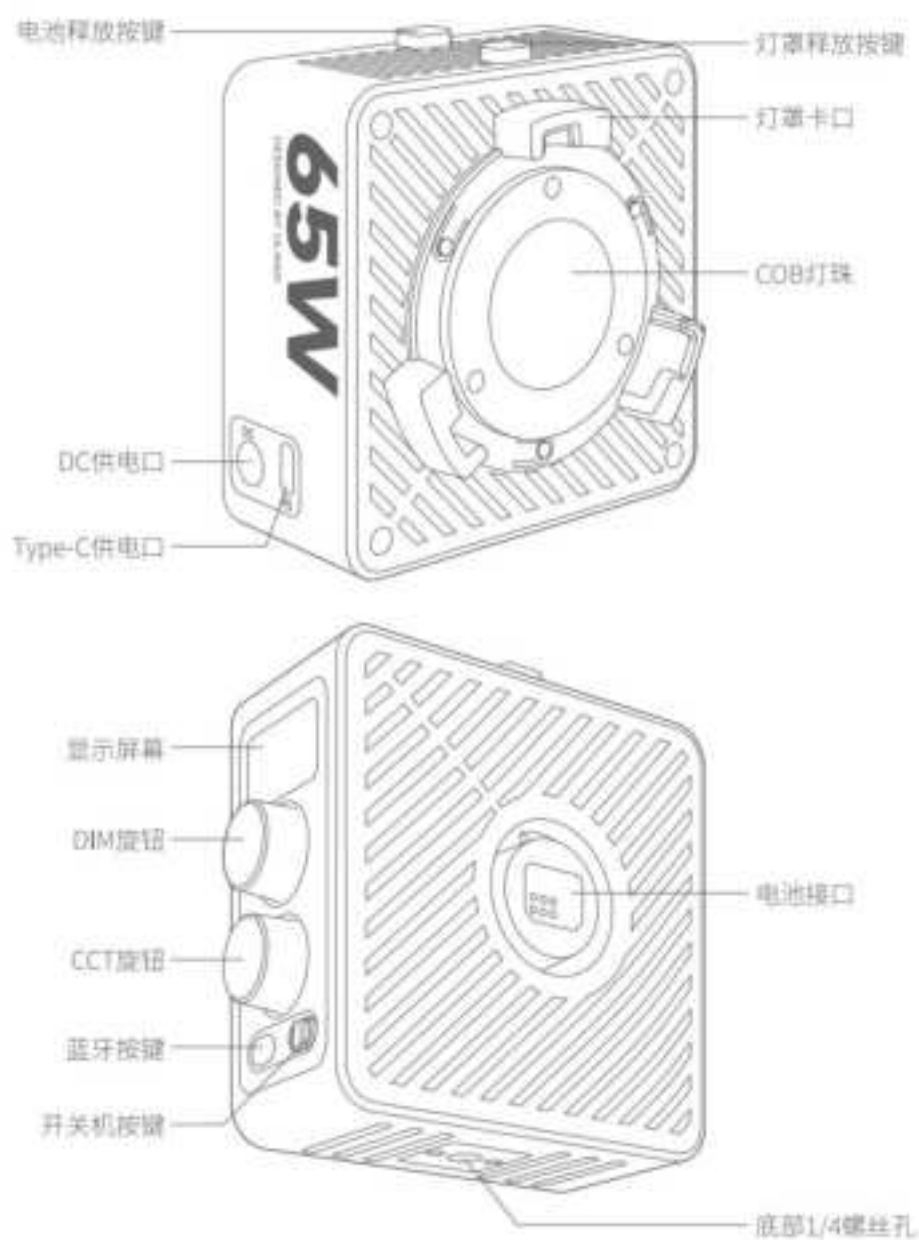

提示 说明书中的随图均为示意图,仅供参考。由于产品不断更新与升级,产品实物与示意图如有差异,请以实物为准。

按钮操作说明

按钮图标	按钮名称	功能说明	灯效说明
	开关机按键	开机: 右推	LED显示屏亮
		关机: 左推	LED显示屏灭
	蓝牙按钮	连接: 单击	待连接: 蓝牙图标闪烁
			已连接: 蓝牙图标常亮
	DIM按钮	亮度调节: 旋转	/
		亮度快切: 短按	10%、20%、30%、50%、80%、100% 6档之间循环切换
	CCT按钮	色温调节: 旋转 (CCT模式)	/
		灯效调节: 旋转 (FX模式)	/
		模式切换: 短按	/
	灯罩释放按钮	安装/拆卸灯罩: 按下	/
	电池释放按钮	安装/拆卸电池模块: 按下	/

◦ 灯罩释放

如果需要拆卸灯罩, 请按下“灯罩释放按钮”后, 按照图示方向选择拆卸。

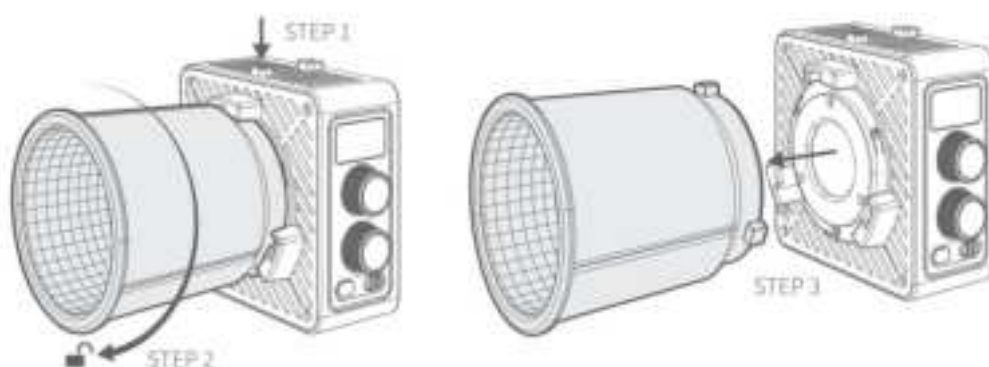

使用本产品过程中, 请勿直视 COB 光源, 不要触摸 COB 灯珠和散热片位置, 以免造成烫伤。

。 电池释放按键

如果需要拆卸电池模块, 请按下“电池释放按键”后, 按照图示方向选择拆卸。

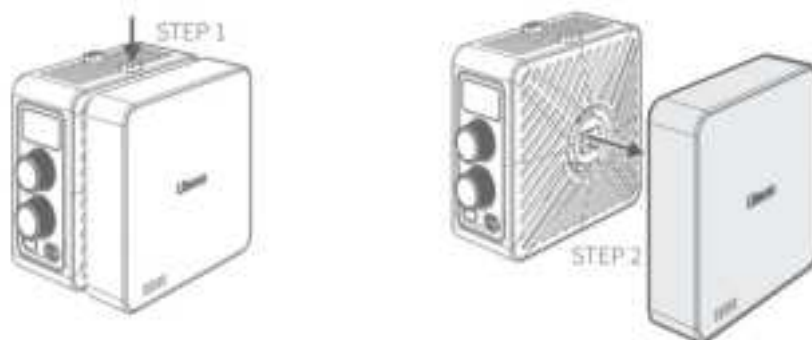

灯罩、电池模块等配件不包含在此包装内, 请按需购买。

注意事项

1. 使用环境应保持干燥、通风;
2. 使用中不得有水或其它液体滴入产品中, 以免造成内部电路短路, 而损坏产品;
3. 灯体发热为正常现象, 请注意高温, 千万不要触摸发光面, 以免烫手;
4. 移动或安装时, 需轻拿轻放, 切勿撞击其它物体, 以免造成变形或灯体损坏;
5. 避免放置在如酒精或汽油等易燃或易挥发的溶剂附近;
6. 请勿在儿童伸手可及之内保管本产品;
7. 非专业人士, 请勿随便拆卸、否则后果自负;
8. LED 灯长时间不用时请切断电源, 如果您购买了电池模块, 请将电池模块、灯体分离储存;
9. 请遵守此注意事项, 否则将可能导致产品损坏。
10. 使用时, 避免尖锐物品、腐蚀性液体、高温物质, 尽量避免挤压、高空跌落, 这些都可能对产品造成损伤。

11. 建议您使用推荐规格的充电头规格和线缆。如果因使用非推荐规格的附件而导致本产品损坏，将不在公司的保修范围内。

12. 本设备内部包含精密电子线路，气柱和灯板属于消耗品。未经许可擅自拆卸导致的故障，将不在公司的保修范围内。您可以选择付费维修，需要维修时请联系授权的维修人员。

供电说明

本产品机身内部不含电池，为保证正常工作，请采用以下方式进行供电：

1、使用 DC 适配器供电

请使用 20V 4A 的 DC 适配器供电

2、使用 PD 充电插头供电

建议使用支持 PD 快充协议 100W （20V 5A）规格充电插头进行供电

为了确保灯板能够达到最佳性能，特别是在需要 100%亮度使用时，我们建议您搭配使用 C

口单口输出支持 100W 及以上规格的充电头

输出支持： 100W （20V 5A）

3、供电线

如果您需要自行购买供电线，请确保选购的线材符合以下规格：100W、6A 的 C to C 连接线。

使用不合规的线材可能会影响设备的充电效率，甚至可能对设备造成损害。为了确保设备的性能和安全，请使用符合上述规格的线材。

规格参数

灯珠：双色温 COB 灯珠

最大功率：65W

显指：94-97

色温：2700-6500K

照度：：6500K，100%亮度，0.5 米 2000Lux （裸灯）

供电口：DC 口、PD 口；

DC:20V4A；PD: 100W（20V5A）

Quick Start Manual

Cube Light

65W Portable Bi-Color LED Video Light

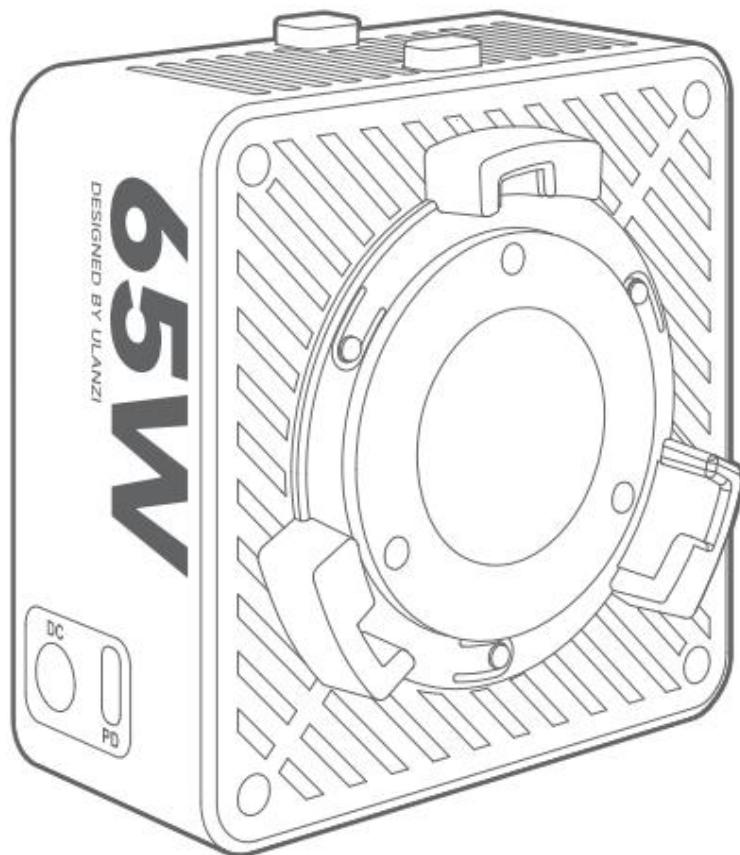

Lamp shade release

If you need to disassemble the lampshade, please press the "lampshade release button" and select the disassembly direction according to the diagram

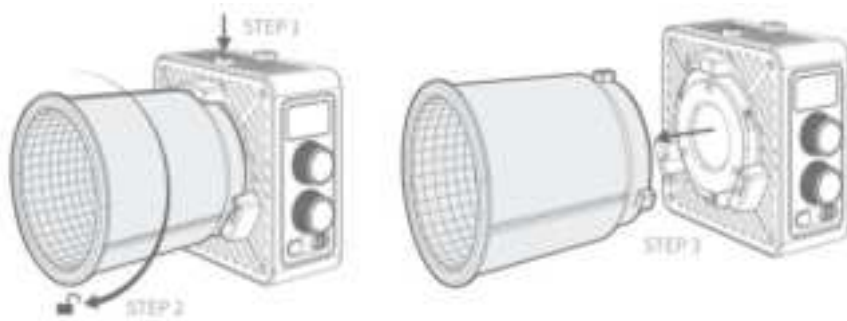

During the use of this product, do not look directly at the COB light source, and do not touch the COB lamp beads and heat sink positions to avoid burns.

Battery release button

If the battery module needs to be disassembled, please press the "battery release button" and select the disassembly direction according to the diagram.



Accessories such as lampshades and battery modules are not included in this package, please purchase as needed.

Precautions

1. The use environment should be kept dry and ventilated;

2. No water or other liquids should drip into the product during use, so as not to cause a short circuit in the internal circuit and damage the product;
3. It is normal for the lamp body to heat up, please pay attention to the high temperature, and do not touch the light-emitting surface to avoid burning your hands;
4. When moving or installing, it should be handled with care, and do not hit other objects, so as not to cause deformation or damage to the lamp body;
5. Avoid placing near flammable or volatile solvents such as alcohol or gasoline;
6. Do not keep this product within reach of children;
7. Non-professionals, please do not disassemble casually, otherwise you will bear the consequences;
8. When the LED light is not used for a long time, please cut off the power supply, if you have purchased a battery module, please separate the battery module and the lamp body;
9. Please observe this precaution, otherwise it may cause damage to the product.
10. When using, avoid sharp objects, corrosive liquids, high-temperature substances, and try to avoid squeezing and falling from high altitudes, which may cause damage to the product.
11. It is recommended that you use the recommended specifications of the charging head and cable. If this product is damaged due to the use of accessories that are not of recommended specifications, it will not be covered by the company's warranty.

12. This equipment contains precision electronic circuits, air columns and light panels that are consumables. Failure caused by unauthorized disassembly will not be covered by the company's warranty. You can choose to pay for repairs, and if you need them, contact an authorized repairer.

Power supply instructions

There is no battery inside the body of this product, in order to ensure normal operation, please use the following methods for power supply:

1. Use DC adapter for power supply

Please use a 20V 4A DC adapter for power supply

2. Use PD charging plug for power supply

It is recommended to use a 100W (20V 5A) charging plug that supports PD fast charging protocol for power supply

In order to ensure the best performance of the light board, especially when 100% brightness is required, we recommend that you use a charging head with a single output of C-mount that supports 100W and above

Output Support: 100W (20V 5A)

3. a power supply line

If you need to purchase your own power cable, please make sure that the cable you choose meets the following specifications: 100W, 6A C to C cable.

The use of substandard cables may affect the charging efficiency of the device and may even cause damage to the device. To ensure the performance and safety of

the device, use a cable that meets the above specifications.

Specifications

Lamp beads: two-color temperature COB lamp beads

Max power: 65W

CRI: 94-97

Color temperature: 2700-6500K

Illuminance: 6500K, 100% brightness, 0.5m 2000Lux (bare light)

Power supply port: DC port, PD port;

DC:20V4A; PD: 100W (2 · 0V5A)

FCC Statement

This device complies with Part 15 of the FCC Rules. Operation is subject to the following two conditions:

(1) This device may not cause harmful interference, and (2) this device must accept any interference received, including interference that may cause undesired operation.

NOTE 1: This equipment has been tested and found to comply with the limits for a Class B digital device, pursuant to part 15 of the FCC Rules. These limits are designed to provide reasonable protection against harmful interference in a residential installation. This equipment generates, uses and can radiate radio frequency energy and, if not installed and used in accordance with the instructions, may cause harmful interference to radio communications. However, there is no guarantee that interference will not occur in a particular installation. If this equipment does cause harmful interference to radio or television reception, which can be determined by turning the equipment off and on, the user is encouraged to try to correct the interference by one or more of the following measures:

- Reorient or relocate the receiving antenna.
- Increase the separation between the equipment and receiver.
- Connect the equipment into an outlet on a circuit different from that to which the receiver is connected.
- Consult the dealer or an experienced radio/TV technician for help.

NOTE 2: Any changes or modifications to this unit not expressly approved by the party responsible for compliance could void the user's authority to operate the equipment.

RF Exposure Statement

To maintain compliance with FCC'S RF Exposure guidelines, This equipment should be installed and operated with minimum 20cm between the radiator and your body. This device and its antenna(s) must not be co-located or operation in conjunction with any other antenna or transmitter.