

# H603B User Manual

297mm

## HRM H603B-EE

### Heart Rate Monitor USER MANUAL

#### B Heat rate chest strap

B-a, Back View

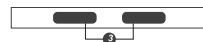

B-b, Front View

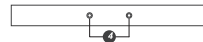

- ③ Electrodes
- ④ Fastening buttons

#### WARNING

- > Cleaning of transmitter and strap in a washing machine or dryer is strongly prohibited.
- > Before hand washing the device, detach the transmitter of Heart Rate Monitor where electrodes are located. This part is not washable.
- > While washing the straps, make sure water is no higher than 30 °C.
- > Ironing, bleaching or heating is prohibited.

#### DATA TRANSMISSION:

ANT+&BLE Sports System is supported to achieve reliable data transmission by this HRM.

#### For ANT+ System:

##### A Pairing

- If the HRM is not paired with the ANT+ compatible receiver, it has to be activated and paired.
- > Ensure that the HRM battery is not drained. Replace the battery if needed.

Thank you for using this product as your sports fitness product of choice. The product is a sensor type heart rate monitor that will track your real-time heart rate and send heart rate data to the Smart phone.

**IMPORTANT** This product is for sport purposes only and it is not meant to replace any medical advice.

This manual contains important safety and care information, and provides step by step instructions for using this product. Read it thoroughly, and keep the manual in a safe place in case you need to refer to it later.

#### C Smart phone (Sold separately)

#### GETTING STARTED:

##### A Unpacking the product

In this box, you will find:

- > Heart rate transmitter
- > Adjustable elastic belt
- > CR2032 battery – already installed
- > User manual

#### BATTERIES:

The transmitter use CR2032 3V battery. The battery already installed. The battery typically last one year.

- A Use the battery door key, twist the battery door counter clockwise until it clicks out of place. To run software on smart phone, receive the heart rate data. (If the battery door key is missing, use a coin and cover the coin with cloth to replace the battery door key)
- B Remove the old battery and insert the new battery with the +side upwards.

- > Ensure there are no other ANT+ transmitting devices within 50 m range, other devices may affect pairing.

- B Ready to use
- If your device is successfully paired, it's ready for use.

- C The new heart rate monitor has memory. It can save the exercise data even you do not connect the monitor to your phone APP, it will upload your exercise data once connect your phone APP

#### DEVICE OVERVIEW:

##### A Heart rate Transmitter

A-a, Front View

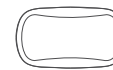

##### B To wear chest strap

B-a, Wet the conductive pads on the rear of the chest belt with a few drops of water, Saliva or conductive gel to ensure solid contact.



B-b, Strap the heart rate chest belt across your chest. To ensure an accurate heart rate signal, adjust the strap until the belt fits snugly below your (chest) pectoral muscles.



##### C Replace the battery door by twisting it clockwise until it is firmly in place.

- \* Follow the open direction to open it, keep twisting the battery door until the door popup.

We advice use a coin and cover the coin with cloth to open the battery door.

A-b, Back View

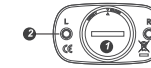

- ① Battery Door
- ② Left & Right wearing directions

B-c, Attach the transmitter to the strap, marked 'L' towards left.

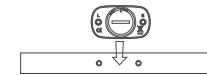

**WARNING** Inaccurate heart rate data will be detected if the device is worn in wrong directions.

- C To run software on smart phone, receive the heart rate data.

#### IMPORTANT

> Non-rechargeable and rechargeable batteries must be disposed of properly. For this purpose, special containers are provided for battery disposal at communal collection centers.

> Batteries are extremely dangerous when swallowed! Therefore, keep batteries and small articles away from children.

> The batteries supplied must not be recharged, reactivated by any other means, dismantled, put into fire or short-circuited.

- B In addition, this device is also recommended to work with the following APPs:

- > Endomondo
- > Strava
- > Sports Tracker
- > MapMyRide
- > Wahoo

All brand names and trademarks are properties of their respective owners.

### **FCC RF Exposure Information and Statement**

The device has been evaluated to meet general RF exposure requirement. The device can be used in portable exposure condition without restriction.

### **FCC Warning**

This device complies with Part 15 of the FCC Rules. Operation is subject to the following two conditions:

(1) This device may not cause harmful interference, and (2) this device must accept any interference received, including interference that may cause undesired operation.

NOTE 1: Any changes or modifications to this unit not expressly approved by the party responsible for compliance could void the user's authority to operate the equipment.