

## LENOVO Home Robot Camera

### Quick manual



Scan QR Code to follow on We-chat

## 1 About camera

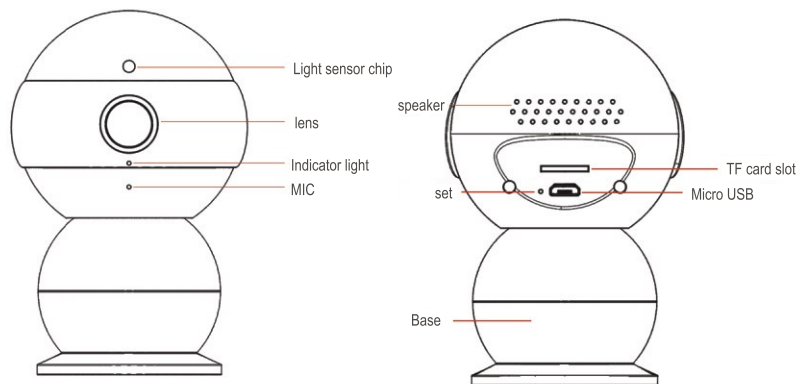

### packing list

camera  
power adapter  
power cable  
bracket  
Quick manual  
reset pin  
3m

## 2 camera configuration

- 1.Before configuring,please confirm the environment.
2. Environment covered with Wi-Fi signal can be used.
- 3.Support android 4.4 and ios8.0 smart devices.

### Step one Scan QR Code to download APP

Scan QR Code to download APP (you can also scan the QR code on the package to download)

- For IOS,you can scan the QR code by we-chat to download directly.
- For android4.4,after scanned by we-chat you need to follow the tips to download by browser
- You can also download by the QR code scanning tools of "QQ Browser" or UC browser



## Step two Registration and login



Please use your phone number to register .

For the First time register please click 新用户 Sign Up?

Enter the phone number to get the verification code.



Set your login password. After login, follow the APP tips to complete the camera configuration.



## 3 FAQ

### 1.How to reset the camera?

Use the reset pin insert the reset hole on the back of the machine, and press the reset button, about 30s you will hear the prompt 等待 for installation ? that means reset finished.

### 2.Why is cloud video discontinuous?

When you watch it remotely on phone, in order to save mobile traffic and reduce the useless message, to avoid wasting customer's time, remote recording adopts mobile detection mode, the video is only recorded when the object is found moving.

### 3.How much capacity does the TF card support? Format?

At present, the camera supports the FAT32 format Class10 TF card, with the maximum support of 32G, and after TF card is fully loaded it will automatically delete from former video for automatic deletion.

### 4.What Wi-Fi support? What not?

At present only support 2.4GHZ, do not support 5g Wi-Fi. Router encryption support WPA2/WPA2-PSK, do not support WEP, and also do not support hidden SSID.

### 5.Indicator light displays information.

The red light flashing	Waiting for configuration
The blue green light flashing	Connecting to the cloud server
Green light normally on	Normal operation
The blue light flashing	Download the update
Blue light normally on	Camera offline

## Camera wall installation instructions:

### Step 1

The camera is enclosed with wall installation accessories. (Circular iron sheet and 3M glue). The iron can be pasted on the wall or roof.

### Step 2

When the wall mounting accessories are fixed, the camera base can be pulled apart, screw in the direction of the base arrow, and then adsorb on the wall by the base with magnet.

### Instruction

The camera base is designed with magnetic adsorption base. You can stick it on the surface of the fridge, air conditioner, distribution box, etc.

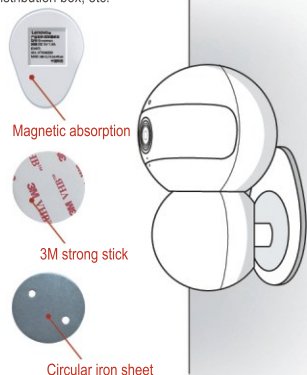

## Kindly Reminder:

- It may cause an explosion, fire or other hazards if you use unrecognized or incompatible power sources.
- The products and accessories including some small parts. Please send the products and its accessories in the place where children can not reach them, avoid the children inadvertently damaging the products and accessories, or swallowing small parts to cause suffocation or other hazards.
- This product is not a toy, Children should use products under adult supervision.
- Please use the product within a range of 0 C -50 C . Product failure may occur when the temperature is too high or too low.
- Please avoid rain or dampness of products and accessories, so as not to affect the use of products.
- When you used the products, please do not place it on the computer or computer hard drive.

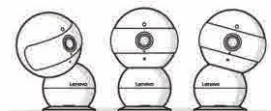

## After-sales service

### 1.Product warranty information

Application product	Warranty scope	Warranty period(Month)	type of service
Lenovo housekeeping products	Camera Base Adapter power line	12	Provide warranty service within the warranty period

### 2.Lenovo Non-warranty policy for intelligent camera products.

1. No proof of three guarantees or three guarantees expired.
2. The products damaged by usage , maintenance and keeping not under instruction.
3. The products damaged by force majeure.
4. The normal decolorization and loss of the product during the use is not covered by the warranty

If you want to know the more informations of products, please check the website: [lelink.lenovo.com.cn](http://lelink.lenovo.com.cn)

### Product service support information.

Lenovo service line  
Lenovo housekeeping wechat official account: lenovokjb  
Lenovo housekeeping website: [lelink.lenovo.com.cn](http://lelink.lenovo.com.cn)  
Address: Beijing 8688 letter box , Lenovo (Beijing) company.  
Lenovo housekeeping products clients service  
Postcode: 100085



## Attachment: Lenovo housekeeping- The name and content of harmful substances in products.

To meet the relevant provisions and requirements of the control measures for pollution control of electronic information products and Order 39 of the ministry of industry and information technology of the PRC. The toxic and harmful substances in this product are classified by parts., statement as follows:

Description of the contents of harmful substances in products.

Part	Hazardous Substance					
	Pb	Hg	Cd	Cr(VI)	PBB	PBDE
System	○	○	○	○	○	○
Cable and Cable Assembly	X	○	○	○	○	○
Auxiliary Equipment	○	○	○	○	○	○

○ The content of toxic and harmful substances in all materials of this part shall not exceed the limit specified in the SJ/T11363-2006 standard.  
X Toxic and hazardous substances at least one of the components of a material exceeding the SJ/T11363-2006 standard limit requirements.

Lenovo, Lenovo TM and other lenovo logos are trademarks or registered trademarks of lenovo LTD or associated Institution on the mainland or (and) other country or regions. The names of other products mentioned are trademarks or registered trademarks of their respective holders.

**FCC Statement**

This equipment has been tested and found to comply with the limits for a Class B digital device, pursuant to part 15 of the FCC rules. These limits are designed to provide reasonable protection against harmful interference in a residential installation. This equipment generates, uses and can radiate radio frequency energy and, if not installed and used in accordance with the instructions, may cause harmful interference to radio communications. However, there is no guarantee that interference will not occur in a particular installation. If this equipment does cause harmful interference to radio or television reception, which can be determined by turning the equipment off and on, the user is encouraged to try to correct the interference by one or more of the following measures:

- Reorient or relocate the receiving antenna.
- Increase the separation between the equipment and receiver.
- Connect the equipment into an outlet on a circuit different from that to which the receiver is connected.
- Consult the dealer or an experienced radio/TV technician for help.

To assure continued compliance, any changes or modifications not expressly approved by the party.

Responsible for compliance could void the user's authority to operate this equipment. (Example- use only shielded interface cables when connecting to computer or peripheral devices).

This equipment complies with Part 15 of the FCC Rules. Operation is subject to the following two conditions:

- (1) This device may not cause harmful interference, and
- (2) This device must accept any interference received, including interference that may cause undesired operation.

**FCC Radiation Exposure Statement:**

The equipment complies with FCC Radiation exposure limits set forth for uncontrolled environment. This equipment should be installed and operated with minimum distance 20cm between the radiator and your body.

.