

# microlab

microlab

just listen

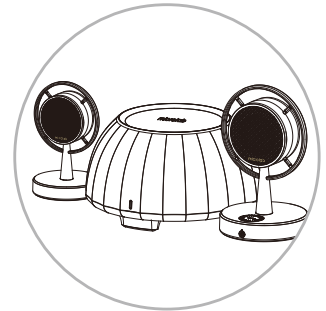

Micmusic \ Virtuoso  
User Manual

[www.microlab-global.com](http://www.microlab-global.com)  
Microlab Electronics Co., Ltd  
Made in China

 **Bluetooth®** FCC ID:OR8-VIRTUOSO  
IC:21231-VIRTUOSO

Microlab Micmusic Bluetooth Speaker System

Disclaimer: All symbols and logos belong to the respective brand holder or registered holder. All specifications and information are subject to changes without further notice. Slight variations and differences might appear between the printed photos and actual product due to product enhancement.

Prior to initial use, please read the manual carefully

## ETL certification declaration

## IMPORTANT SAFETY INSTRUCTIONS

1. Read these instructions.
2. Keep these instructions.
3. Heed all warnings.
4. Follow all instructions.
5. Do not use this apparatus near water.
6. Clean only with dry cloth.
7. Do not block any ventilation openings. Install in accordance with the manufacturer's instructions.
8. Do not install near any heat sources such as radiators, heat registers, stoves, or other apparatus (including amplifiers) that produce heat.
9. Do not defeat the safety purpose of the polarized or grounding-type plug. A polarized plug has two blades with one wider than the other. A grounding type plug has two blades and a third grounding prong. The wide blade or the third prong are provided for your safety. If the provided plug does not fit into your outlet, consult an electrician for replacement of the obsolete outlet.
10. Protect the power cord from being walked on or pinched particularly at plugs, convenience receptacles and the point where they exit from the apparatus.
11. Only use attachments/accessories specified by the manufacturer.
12. Use only with the cart, stand, tripod, bracket or table specified by the manufacturer, or sold with the apparatus. When a cart is used, use caution when moving the cart/apparatus combination to avoid injury from tip-over.
13. Unplug this apparatus during lightning storms or when used for long periods of time.
14. Refer all servicing to qualified service personnel. Servicing is required when the apparatus has been damaged in any way, such as power-supply cord or plug is damaged, liquid has been spilled or objects have fallen into the apparatus, the apparatus has been exposed to rain or moisture, does not operate normally or has been dropped.

Where the MAINS plug is used as the disconnect device shall remain readily operable.

**WARNING:** TO PREVENT FIRE OR SHOCK HAZARD, DO NOT EXPOSE THIS APPLIANCE TO RAIN OR MOISTURE.



This equipment is a Class II or double insulated electrical appliance. It has been designed in such a way that does not require a safety connection to electrical earth.

**CAUTION**

RISK OF ELECTRIC SHOCK DO NOT OPEN



The lightning flash with arrowhead symbol, within an equilateral triangle is intended to alert the user to the presence of uninsulated dangerous voltage within the products enclosure that may be of sufficient magnitude to constitute a risk of electric shock.



The exclamation point within an equilateral triangle is intended to alert the user to the presence of important operating and maintenance (servicing) instructions in the literature accompanying the appliance.

15. The highest environmental temperature suitable for this product is 0°C to 35°C for indoor use only .

16. Applicable to altitude below 2000 meters



DU When apparatus operation and installation instructions contain instructions contain instructions for use by service personnel, such instructions shall be separate in format from other instructions and preceded by the word "CAUTION" and the following or the equivalent. "These servicing instructions are for use by qualified service personnel only. To reduce the risk of electric shock do not perform any servicing other than that contained in the operating instructions unless you are qualified to do so"

## MESURES DE SÉCURITÉ IMPORTANTES

1. Lisez ces instructions .
2. Conservez ces instructions.
3. Respectez tous les avertissements.
4. Suivez toutes les instructions.
5. N'utilisez pas cet appareil près de l'eau.
6. Nettoyez uniquement avec un linge sec.
7. Les fentes et ouvertures ne doivent jamais être bloquées ni recouvertes. Toute installation de l'appareil doit respecter les instructions du fabricant.
8. Ce produit doit être éloigné des sources de chaleur comme celles des radiateurs, des contrôleurs de chaleur, des cuisinières ou d'autres produits (incluant les amplificateurs) produisant de la chaleur.
9. Ne pas détériorer la sécurité de la fiche polarisée, ou de la fiche de terre. Une fiche dont une broche est plus large que l'autre est une fiche polarisée. Une fiche de type mise à la terre à deux broches, possédant une troisième broche de mise à la terre. La broche plus large ou mise à la terre s'agit d'une mesure de sécurité. Cette fiche se branchera à la prise de courant d'une seule manière. Si vous ne pouvez pas l'insérer complètement dans la prise, contactez un électricien pour le remplacement de la prise défectueuse.
10. Les cordons d'alimentation doivent être orientés de façon à ne pas être piétinés, ou être coincés par des objets placés sur, ou contre eux. Portez une attention particulière aux cordons à fiche, aux prises de courant adéquates et aux points où les cordons sortent du produit.
11. Utilisez uniquement des accessoires recommandés par le fabricant.
12. Utilisez uniquement avec un chariot, un présentoir, un trépied, un support, ou une table recommandée par le fabricant, ou vendu avec le produit. La combinaison d'un appareil et d'un chariot doit être déplacée avec prudence.
13. Pour plus de protection pendant un orage, ou lorsque le produit est inutilisé pour de longues périodes de temps, débranchez-le de la prise de courant.
14. Confiez toute réparation au personnel qualifié. Une réparation est requise lorsque le cordon d'alimentation ou la fiche sont endommagés, si du liquide a été renversé sur le produit, ou si un objet est tombé à l'intérieur, si le produit a été exposé à la pluie ou à l'eau, si le produit ne fonctionne pas normalement, ou si le produit a été lâché des mains.

AVERTISSEMENT : La fiche d'alimentation fonctionne en tant que dispositif de déconnexion, elle doit rester toujours prête à fonctionner.

**MISE EN GARDE :** POUR RÉDUIRE LE RISQUE D'INCENDIE OU DE CHOC ÉLECTRIQUE, NE PAS EXPOSER L'APPAREIL À LA PLUIE OU À L'HUMIDITÉ.



Cet équipement est de classe II ou dispose d'une isolation double, et n'exige pas de mise à la terre.

**MISE EN GARDE**

RISQUE DE CHOC ÉLECTRIQUE NE PAS OUVRIR



Le symbole de l'éclair et d'une flèche à l'intérieur d'un triangle équilatéral signale à l'utilisateur, la présence d'une « tension dangereuse » non isolée à l'intérieur de l'appareil, pouvant être d'une magnitude suffisante pour provoquer un choc électrique.



Le point d'exclamation à l'intérieur d'un triangle équilatéral signale à l'utilisateur la présence d'instructions importantes concernant les soins et l'entretien (réparation) incluses dans la documentation accompagnant l'appareil.

This device complies with part 15 of the FCC Rules. Operation is subject to the following two conditions: (1) This device may not cause harmful interference, and (2) this device must accept any interference received, including interference that may cause undesired operation.

Note: This equipment has been tested and found to comply with the limits for a Class B digital device, pursuant to part 15 of the FCC Rules. These limits are designed to provide reasonable protection against harmful interference in a residential installation. This equipment generates uses and can radiate radio frequency energy and, if not installed and used in accordance with the instructions, may cause harmful interference to radio communications. However, there is no guarantee that interference will not occur in a particular installation. If this equipment does cause harmful interference to radio or television reception, which can be determined by turning the equipment off and on, the user is encouraged to try to correct the interference by one or more of the following measures:

Reorient or relocate the receiving antenna.

Increase the separation between the equipment and receiver.

Connect the equipment into an outlet on a circuit different from that to which the receiver is connected.

Consult the dealer or an experienced radio/TV technician for help.

Any Changes or modifications not expressly approved by the party responsible for compliance could void the user's authority to operate the equipment.

The device has been evaluated to meet general RF exposure requirement. The device can be used in portable exposure condition without restriction.

This device complies with Industry Canada licence-exempt RSS standard(s).

Operation is subject to the following two conditions: (1) This device may not cause interference, and (2) This device must accept any interference, including interference that may cause undesired operation of the device.

Le présent appareil est conforme aux CNR d'Industrie Canada applicables aux appareils radio exempts de licence.

L'exploitation est autorisée aux deux conditions suivantes:

(1) l'appareil ne doit pas produire de brouillage, et

(2) l'utilisateur de l'appareil doit accepter tout brouillage radioélectrique subi, même si le brouillage est susceptible d'en compromettre le fonctionnement.

L'appareil a été évalué pour répondre aux exigences générales d'exposition aux RF. L'appareil peut être utilisé dans une condition d'exposition portable sans restriction.

## Introduction

Virtuoso is a fascinating 2.1 multimedia speaker system with wireless streaming technology. The old fashioned microphone design brings you back to the flapper era of the past. Wherever Virtuoso is located, a sense of nostalgia fills in the whole room.

With Bluetooth wireless technology, it's able to stream music from smart phones, tablets and other digital devices. The unique cabinet design of subwoofer is optimal for deep bass production.

Featuring powerful bass and clear highs, Virtuoso is ideal for home entertainment with wireless fun.

## Features

- 10 Watt of acoustic power with 6.5" woofer and 2 x 2.5" satellites.
- Stylish 2.1 Bluetooth home speaker with built-in amplifier.
- Vintage microphone design adds a nostalgic twist to your room.
- Special designed subwoofer with large cabinet for deeper bass.
- Full audio spectrum performance for optimum listening experience.
- 3.5mm stereo output supports earphone jack in.

## Package contents

- |                               |       |
|-------------------------------|-------|
| • Virtuoso subwoofer          | 1 pc  |
| • Virtuoso satellite          | 2 pcs |
| • 3.5 mm - 3.5mm stereo cable | 1 pc  |
| • User manual                 | 1 pc  |

## Front View

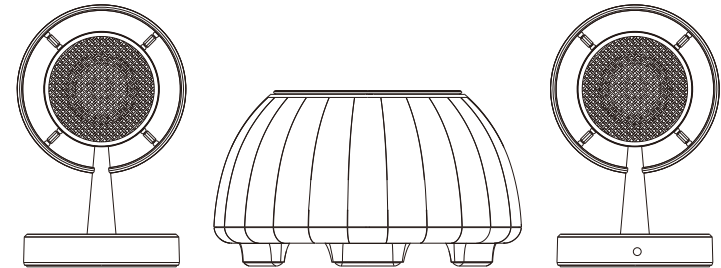

Left satellite

Subwoofer

Right satellite

## Rear and Bottom Views

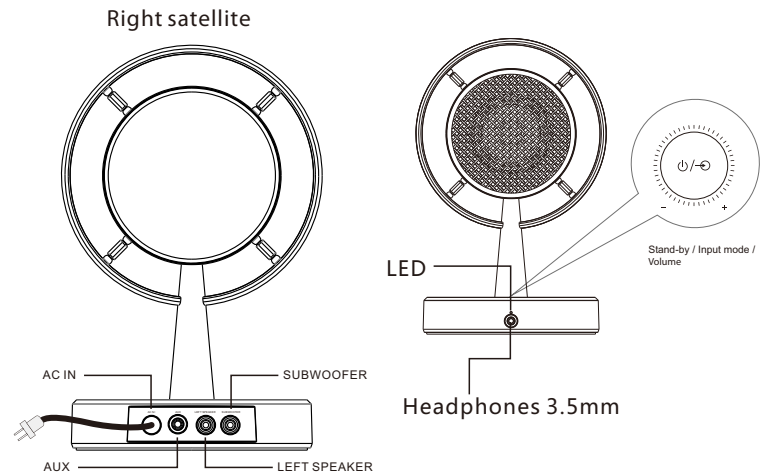

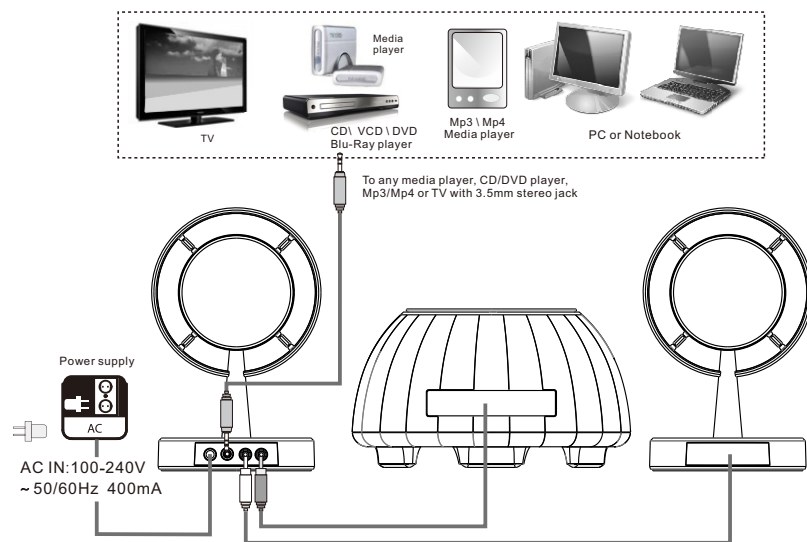

## Operations

### Installation:

Precaution: Prior to connecting the speakers, ensure the AC power plug is removed from the AC source. Secondly, ensure the volume knob is set to zero.

1. First connect the left and right satellite speakers, then connect the right satellite to the subwoofer.
2. Place both satellites on extreme sides of the listening position.
3. Place the subwoofer on the floor and with its back near the wall for more bass.
4. Next, connect the playback source to the 3.5mm audio input jack.
5. Last, connect the AC power cord to the AC power supply source. Please always ensure the AC power ratings printed on the rear panel of the satellite match with your country's AC power supply ratings. If they do not match, please do not connect the power. This will damage the speaker system.

### Operation:

1. Plug the AC power plug to the wall AC source or any AC power distribution sockets.
2. Ensure the volume level is lowered to minimum.
3. Start the media player and its playback audio.
4. Slowly increase the volume level to your preferred level.
5. Press "Input mode" knob to switch between Bluetooth and AUX modes.
6. Long press the Stand-by Knob 2 seconds or no receiving signal within 15 mins, turn into standby mode and LED illuminates red. Adjust the Volume Knob to enter working state.

Note: Never listen to loud music for prolong period as it might affect your hearings.

### Wireless (Bluetooth®)

1. Please turn on the speaker system. The LED blinks blue and the speaker emits a tone. It will default to Bluetooth pairing mode.
2. Turn on Bluetooth function on your device, search and select "Vitruoso" in the Bluetooth device list.
3. Play music from Bluetooth enabled devices.

### AUX Mode

1. Plug in Vitruoso speaker and it turns on, default to Bluetooth mode. LED illuminates blue with a prompt tone.
2. Short press the Volume Knob into AUX Mode, LED illuminates purple with a prompt tone.
3. Play music from Bluetooth enabled devices.

**Factory Reset:** Long press Volume Knob 5 seconds.

## Technical Information

### Amplifier

Out power power, RMS	10 Watt RMS
Power distribution, Watt	2.5 Watt x 2 + 5 Watt
Harmonic distortion	< 0.5% 1 W 1 kHz
Frequency response	50 Hz - 20 kHz
Signal/Noise ratio, dB	> 70 dB
Separation, dB	> 44 dB

### Speaker

Tweeter driver type	2.5" x 2
Woofer driver type	6.5"

### Interface

Input	3.5 mm stereo jack
Output	2RCA jacks, 3.5 mm stereo (Headphones)

## Troubleshooting

Question	Solution
Power LED won't light up	Check if the system is powered on Check the power plug is well connected
No sound	Check if the audio source is working well Check if the audio and speaker cables are connected Check if the volume is at the right level
One or more satellite no sound	Check if the satellite cable is well connected, and ensure source connection is correctly inserted
Static sound heard when volume knob is turned	Turn off the playback source first, then turn the speaker volume knob several times. Playback again and monitor. The static noise is due to dust, so simply turning the volume will remove it easily.
What are the products supported?	Any playback devices such as PC, notebook, CD/DVD player, Media players with 3.5 mm stereo plug
Sound is distorted	Check if the source file is not corrupted, play a different song and test
If the problem still exists, please contact the distributor or ask for professional service	