

Echelon X6

USER GUIDE

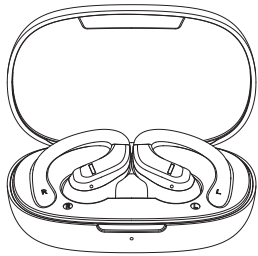

TRULY WIRELESS EARBUDS

- Inside the Box:**
- 1.Echelon X6 Wireless Earbud ×2PCS
 - 2.On-the-go charging Case ×1PCS
 - 3.Type C charging Cable ×1PCS
 - 4.Eartips(Size S/M/L) ×3Pairs
 - 5.User Manual ×1PCS

Specification:
Bluetooth Version:BT5.2+EDR
Earbud charging time:1.5 hours
Charging case Charging time:2.5 hours
Earbud Battery:3.7V/50mAh
Charging Case Battery:3.7V/650mAh

Safety precautions:
The Earbuds are excellent quality,in order to extent the earbuds, please make sure of the following instruction
1. Please keep away the device away from extreme heat, humidity of corrosive environment.
2. Please don't over-charing the earbuds or charging case for a long time,as they will decrease the battery service life.
3. Use a dry cloth to wipe the earbud charging part after using the earbuds.

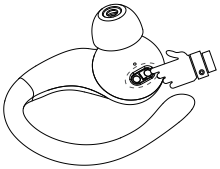

01

WEARING

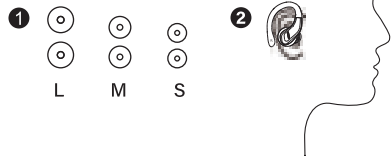

Wearing:Choose the silicone eartips that are most suitable for your ears.

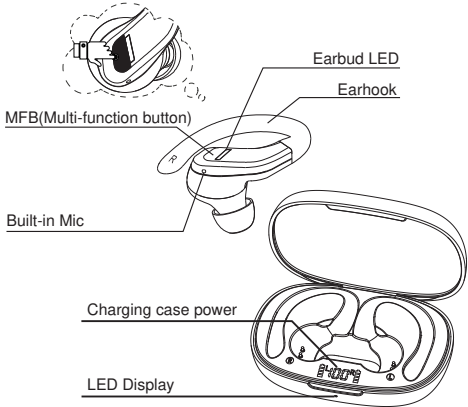

02

ON/OFF

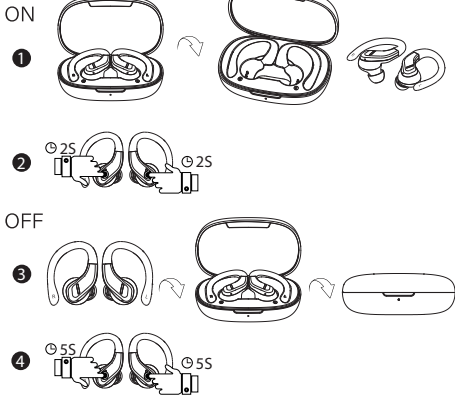

03

PAIRING

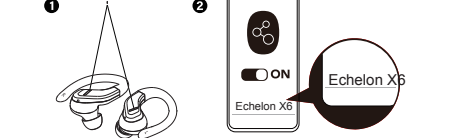

Pairing:When the charging case battery level is sufficient,open the charging case and remove earbuds from the case,the earbuds will automatically turn on then enter Bluetooth pairing mode,At this time,the indicator of the main earbud will flash red and white light alternately and the indicator of the secondary earbud will flash white light once every 3 secons,Then please turn on the Bluetooth function of your phone,search "Echelon X6" and click to connect.

CHARGING

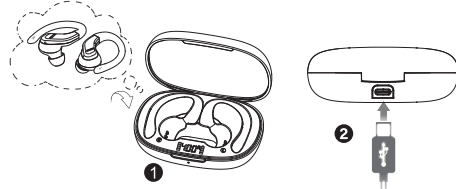

Charging:Before the first time use,please make sure the charging case and the earbuds are fully charged.

04

CONTROL

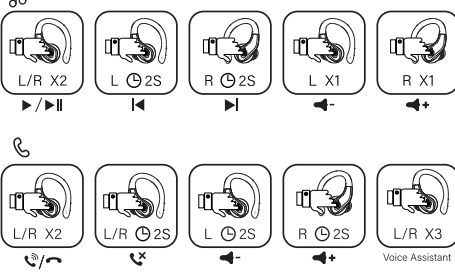

Play/pause:Double-tap the MFB on L/R.
Previous song:press and hold the MFB on L.
Note:In mono mode,Press and hold the MFB on L will trigger next song function.
Next song:Press and hold the MFB on R.
Volume down:Tap the MFB on L to decrease the volume continuously.
Note:In mono mode,volume adjustment is unavailable.
Volume up:Tap the MFB on R to increase the volume continuously.
Note:In mono mode,volume adjustment is unavailable.
Answer/hang up a call:Double-tap the MFB on L/R.
Reject a call:Press and hold the MFB on L/R for 2 seconds.
Activate voice assistant:Triple-tap the MFB on L/R.
Note:In mono mode,tapping the MFB on L/R three times will turn on the voice assistant.

05

RESET

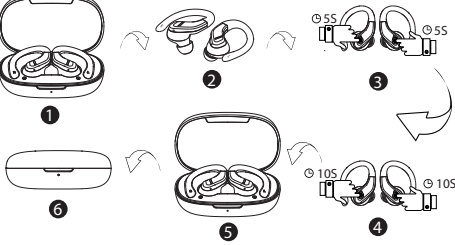

Reset:
1)Delete the pairing name "Echelon X6" on your mobile phone and turn off the Bluetooth function.
2)Turn off the left and right earbuds,press and hold the MFB on L and R at the same time for 10 seconds. Release the MFB until the indicators of both earbuds flash red and white alternately for 3 times and then go out.
3)Put the earbuds back into charging case and close the cover, Leave it for 5 seconds.
4)Open the charging case and double-tap the MFB on L/R select the pairing name on your phone,The reset is successful.

WARNING

Do not listen at high volume levels for long periods. ⚠️

06

DESCRIPTIONS OF LED INDICATORS

B LED:
The middle number represent the amount of power in the charging case
The left and right power lights represent the charging status of earbuds

LED Indicator & Voice Prompt
Earbuds are being charged:B Power indicator running
Note:when the case over,A LED blinking white light
Earbuds are fully charged:B Power indicator full

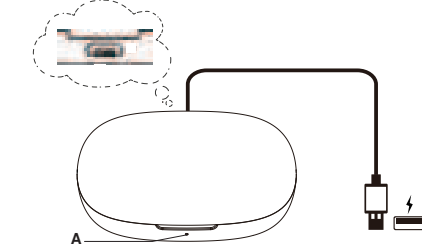

Charging case in low battery: Blinking red light of A LED
Charging case in fully charged:Solid red lights of A LED

07

FCC Statement

This device complies with part 15 of the FCC rules. Operation is subject to the following two conditions: (1) this device may not cause harmful interference, and (2) this device must accept any interference received, including interference that may cause undesired operation.

Changes or modifications not expressly approved by the party responsible for compliance could void the user's authority to operate the equipment.

NOTE: This equipment has been tested and found to comply with the limits for a Class B digital device, pursuant to part 15 of the FCC Rules. These limits are designed to provide reasonable protection against harmful interference in a residential installation. This equipment generates uses and can radiate radio frequency energy and, if not installed and used in accordance with the instructions, may cause harmful interference to radio communications. However, there is no guarantee that interference will not occur in a particular installation. If this equipment does cause harmful interference to radio or television reception, which can be determined by turning the equipment off and on, the user is encouraged to try to correct the interference by one or more of the following measures:

- Reorient or relocate the receiving antenna.
- Increase the separation between the equipment and receiver.
- Connect the equipment into an outlet on a circuit different from that to which the receiver is connected.
- Consult the dealer or an experienced radio/TV technician for help.

The device has been evaluated to meet general RF exposure requirement. The device can be used in portable exposure condition without restriction.