

size:105X145mm

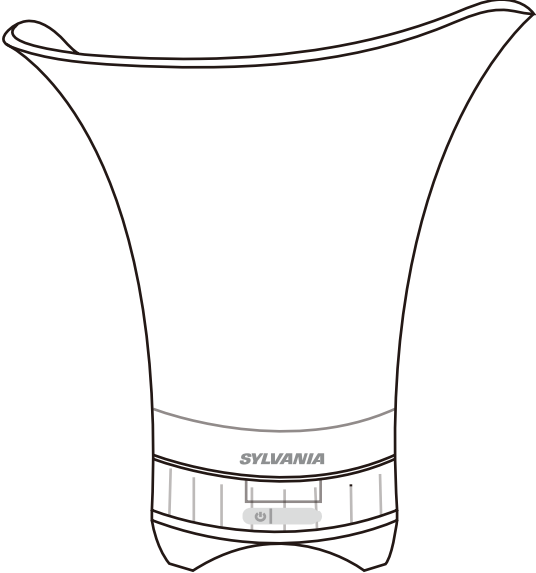

**Please read these instructions thoroughly
before use and retain for future reference**

SYLVANIA is a registered trademark of OSRAM Sylvania Inc. used under license

Description of Parts

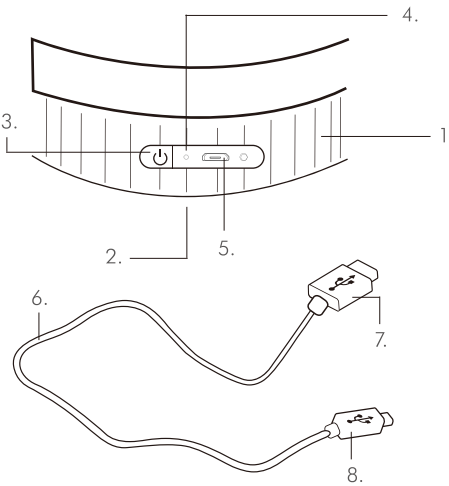

1. Wine cooler Led light up bluetooth speaker
2. Speaker
3. Power on/off, Play/Pause , light modes change, FM Button (🔊)
4. LED Indicator light
5. 5V 1A DC Charging Port
6. USB Charging Cable
7. USB Connector
8. Micro USB Connector

Specifications

Bluetooth Version: 5.0
Wireless Range: 10m
Speaker Output: 5W
Power Supply: 5V 1A DC
Working Voltage: 3.7V
Rechargeable Battery: 1200mAh
Frequency Response: 80 Hz-18 kHz
Operating Frequency: 2.4 GHz

Instructions for Use

Charging the Battery



The speaker is fitted with a 3.7V 1200mAh battery (non-removable). It is recommended that the battery is fully charged before first use;

Connect the micro USB end of the USB charging cable into the 5V 1A DC charging port on the speaker and the other end to a compatible USB port.

While charging, the LED indicator light will illuminate red. Once the battery has fully charged, the LED indicator light will switch off.

Carefully disconnect both ends of the USB charging cable and store it safely for future use.

Using Bluetooth® Speaker Basic Functionality

Turn on the speaker by pressing and holding  for approx 3 seconds, Pause a track by pressing ; press it again to resume the track. Press and hold  for approx.3 seconds to turn the speaker off .

Double press the  to change the lights . Total 9 light modes and the double press 10th is turn off the light

Bluetooth Mode

STEP 1: Once the speaker has been turned on, the LED indicator light will flash blue to signal that the speaker is ready to be paired with a bluetooth compatible device.

STEP 2: Search for the speaker using a Bluetooth compatible device. Select 'Sylvania SP720' and pair. Once a connection has been made, the speaker will play a tone to signal that the devices are paired.

STEP 3: To unpair or remove a Bluetooth compatible device from the speaker turn off the Bluetooth function on the compatible device. The speaker can now be paired with a new compatible device.

Note: Once connected, volume can be controlled using the relevant controls on the Bluetooth compatible device

FCC STATEMENT :

This device complies with Part 15 of the FCC Rules. Operation is subject to the following two conditions:

- (1) This device may not cause harmful interference
(2) This device must accept any interference received, including interference that may cause undesired operation.

Warning: Changes or modifications not expressly approved by the party responsible for compliance could void the user's authority to operate the equipment.

NOTE: This equipment has been tested and found to comply with the limits for a Class B digital device, pursuant to Part 15 of the FCC Rules. These limits are designed to provide reasonable protection against harmful interference in a residential installation. This equipment generates uses and can radiate radio frequency energy and, if not installed and used in accordance with the instructions, may cause harmful interference to radio communications. However, there is no guarantee that interference will not occur in a particular installation. If this equipment does cause harmful interference to radio or television reception, which can be determined by turning the equipment off and on, the user is encouraged to try to correct the interference by one or more of the following measures:

- Reorient or relocate the receiving antenna.
- Increase the separation between the equipment and receiver.
- Connect the equipment into an outlet on a circuit different from that to which the receiver is connected.
- Consult the dealer or an experienced radio/TV technician for help.

RF warning statement:
The device has been evaluated to meet general RF exposure requirement. The device can be used in portable exposure condition without restriction.

For service assistance and product information, please call: 1-800-968-9853.
Curtis International Ltd.
7045 BECKETT DRIVE, UNIT 15, MISSISSAUGA, ON, L5S 2A3
www.curtisint.com

90 day Warranty

This product is warranted to be free from defects in material and workmanship for a period of ninety (90) days from the date of original purchase. During this period, your exclusive remedy is repair or replacement of this product or component found to be defective, at our option; however, you are responsible for all costs associated with returning the product to us. If the product or component is no longer available, we will replace with a similar one of equal or greater value. Prior to a replacement being sent, the product must be rendered inoperable or returned to us.

This warranty does not cover glass, filters, wear from normal use, use not in conformity with the printed directions., or damage to the product resulting from accident, alteration, abuse, or misuse. This warranty extends only to the original consumer purchaser or gift recipient. Keep the original sales receipt, as proof of purchase is required to make a warranty claim. This warranty is void if the product is used for other than single-family household use or subjected to any voltage and waveform other than as on the specified rating on the label (e.g., 120V-60Hz).

We exclude all claims for special, incidental, and consequential damages caused by breach of express or implied warranty. All liability is limited to the amount of the purchase price. Every implied warranty, including any statutory warranty or condition of merchantability or fitness for a particular purpose, is disclaimed except to the extent prohibited by law, in which case such warranty or condition is limited to the duration of this written warranty. This warranty gives you specific legal rights. You may have other legal rights that vary depending on where you live. Some states or provinces do not allow limitations on implied warranties or special, incidental, or consequential damages, so the foregoing limitations may not apply to you.

For faster service, locate the model, type, and serial numbers on your appliance.

4

5

6

7

8