



## CARPET ONE CRUISER

Smart Powerful Carpet Cleaner

Instruction Manual

Manual De Uso

Mode D'emploi



\*Actual product may differ from illustration.

**TINECO IS HERE TO HELP.**



We'll get back to you within 24 hours.



[www.tineco.com](http://www.tineco.com)



1-855-292-8864



# CONTENTS

Important Safety Instructions.....	2
Specifications .....	7
Overview.....	8
Accessories.....	10
Assembly .....	11
Operation .....	13
Maintenance .....	20
Troubleshooting.....	24
Warranty .....	25

**TINECO IS HERE TO HELP.**

We'll get back to you within 24 hours.



[www.tineco.com](http://www.tineco.com)



1-855-292-8864

# Important Safety Instructions

## SAVE THESE INSTRUCTIONS

### Household use only.

When using an electrical appliance, basic precautions should always be followed, including the following:

READ ALL INSTRUCTIONS BEFORE USING (THIS APPLIANCE). Failure to follow the warnings and instructions may result in electric shock, fire and/or serious injury.

## WARNING – To reduce the risk of fire, electric shock, or injury:

1. This appliance can be used by children aged from 8 years and above and persons with reduced physical, sensory or mental capabilities or lack of experience and knowledge if they have been given supervision or instruction concerning use of the appliance in a safe way and understand the hazards involved. Children should not play with the appliance. Cleaning and user maintenance shall not be performed by children without supervision.
2. The appliance is not to be used by persons (including children) with reduced physical, sensory or mental capabilities, or lack of experience and knowledge, unless they have been given supervision or instruction concerning use of the appliance by a person responsible for their safety. Children should be supervised to ensure that they do not play with the appliance.
3. Use only indoors, do not immerse. To reduce risk of electric shock – Use only on carpet moistened by cleaning process.
4. Do not allow to be used as a toy. Close attention is necessary when used by or near children, pets or plants.
5. To reduce the risk of fire and electric shock – Use only Tineco cleaning products intended for use with this machine.
6. Use only as described in this manual. Use only manufacturer's recommended attachments.
7. Do not pull or carry by cord, use cord as a handle, close a door on cord, or pull cord around sharp edges or corners. Do not run appliance over cord. Keep cord away from heated surfaces.
8. Do not unplug by pulling on cord. To unplug, grasp the plug, not the cord.
9. Do not handle plug or appliance with wet hands.
10. Do not use with a damaged cord or plug. If appliance has been dropped, damaged, left outdoors, dropped into water, or is not working as it should, return it to a service center.
11. Do not put any object into openings. Do not use with any opening blocked; keep free of dust, lint, hair, and anything that may reduce air flow.
12. Keep hair, loose clothing, fingers, and all parts of your body away from openings and moving parts.
13. Use extra care when cleaning on stairs.
14. Do not use to pick up flammable or combustible liquids, such as gasoline, or use in areas where they may be present.

15. Do not pick up anything that is burning or smoking, such as cigarettes, matches, or hot ashes.
16. Do not use without filter.
17. To reduce the risk of electric shock, always install float before any wet pick-up operation.
18. Prevent unintentional activation. Ensure the switch is in the off-position before picking up or carrying the appliance. Carrying the appliance with your finger on the switch or energizing appliance that have the switch on invites accidents.
19. Always switch off the appliance before making any adjustments, changing accessories, or storing the appliance. Such preventive safety measures reduce the risk of starting the appliance accidentally.
20. TO REDUCE THE RISK OF ELECTRIC SHOCK – UNPLUG BEFORE CLEANING OR SERVICING. UNPLUG BEFORE CONNECTING HOSE.
21. Always turn off this appliance before connecting or disconnecting the motorized nozzle.
22. Turn off all controls before unplugging.
23. Do not leave appliance when plugged in. Unplug from outlet when not in use and before servicing.
24. Do not use to pick up ultrafine particles, such as lime, cement, sawdust, gypsum powder, or ashes.
25. Do not use to pick up sharp objects, such as metallic nails, pieces of glass, metal paper clips, or pins.
26. Do not use to pick up hazardous material and chemicals, such as solvent, drain cleaner, strong acids, or strong alkali.
27. Stop using immediately if the appliance is overheating, making unusual noises, producing unusual odors, performing low suction, or leaking electricity.
28. Turn cleaner OFF and disconnect from electrical outlet for long-term storage.
29. Always clean the Dirty Water Tank after each use to avoid potential blockage, which may lead to low suction power, motor overheating, or reduce the service life of the appliance.
30. Do not expose to rain.
31. Store appropriately indoors in a dry place after use.
32. Do not place or submerge appliance in standing water or try to clean flooded areas.
33. The plug must be removed from the socket-outlet before cleaning or maintaining the appliance.
34. A hazard may occur if the appliance runs over the supply cord.
35. Connect to a properly grounded outlet only. See Grounding Instructions.
36. To reduce the risk of fire and electric shock due to internal component damage, use only Tineco cleaning fluid/solution: Carpet Deodorizing & Cleaning Solution intended for use with this appliance. See the Cleaning Fluid/Solution section of this manual.
37. Do not turn over nozzle, or touch the bottom surface of the nozzle when using the dry function.
38. Do not use appliance in an enclosed space filled with vapors given off by oil base paint, paint thinner, some moth proofing substances, flammable dust, or other explosive or toxic vapors.

39. Do not store cleaner with solution in Clean Water Solution Tank or dirty water in Dirty Water Tank. Mineral deposits and mildew can form which will affect the performance of your carpet cleaner.
40. If the supply cord is damaged, it must be replaced by the manufacturer, its service agent or similarly qualified persons in order to avoid a hazard.

## Range of Usage

1. The Carpet washer is to be used on carpets, such as level loop, etc.
2. Some Loop Berber carpets, Natural Fiber (including silk and wool), and Soft Fiber carpets can fuzz with wear. Some vacuums & carpet cleaners can worsen this carpet wear. If cleaning on Berber, Natural Fiber, or Soft Fiber carpeting, first test on a small hidden area of carpet by running the carpet washer over it. If no fuzzing or overwetting occurs, continue cleaning. Avoid overwetting Berber carpets. If you have any questions or concerns, consult with your carpet manufacturer on deep cleaning recommendations.
3. Important: Keep the foot of the deep cleaner perpendicular to the rug's edge with each cleaning pass to prevent damage.
4. Important! Please check manufacturer's tag before cleaning area rugs for any specialized cleaning instructions. It's not advisable to perform deep cleaning on delicate, silk, wool, antique or area rugs without a manufacturer's tag.
5. When cleaning area rugs, place the rug on a sealed surface to test for colorfastness in an inconspicuous area. Your cleaner should not be used on unsealed surfaces.
6. Avoid using it on rugs or carpets that require dry cleaning.
7. For upholstery, check cleaning code - Use your Tineco Carpet Washer only if the upholstery fabric is marked with a "W" (for "wet" clean) or "S/W" (for "solvent/dry" or "wet" clean). Do not clean fabric marked "S" ("solvent/dry" clean only). If your upholstery does not have a code, seek professional assistance.
8. Test for colorfastness - Wet a white absorbent cloth with the solution. In a small, hidden area, gently rub the surface with the dampened cloth. Wait for ten minutes and check for color removal. If surface has more than one color, check all colors.
9. Keep your appliance away from heat sources, such as fireplace or heater, to avoid casing deformation.
10. Do not use to pick up flammable or combustible liquids, ultrafine particles, sharp objects, hazardous material, chemicals or anything that is burning or smoking, as described above.

## About Cleaning Fluid/Solution

1. **WARNING:** To Reduce the Risk of Fire and Electric Shock due to internal component damage, use only Tineco Carpet Cleaning Solution intended for use with the appliance.
2. A large amount of cleaning solution entering into the motor may cause damage to the appliance. Don't shake the machine violently.
3. Add solution as instructed in the Operation section. We recommend using the provided cleaning solution.
4. Keep out of the reach of children. Avoid contact with eyes and skin, otherwise, rinse thoroughly with water. If irritation persists, seek medical advice. If product is swallowed seek medical advice.

5. Dirty water and solution disposal should comply with local environmental regulations.

## About the Appliance

1. Do not modify or attempt to repair the appliance except as indicated in the instructions for operating and cleaning.
2. Use extra care when cleaning on stairs.
3. Ensure that the Power Switch is in the OFF-position and unplug before picking up or carrying the appliance. Do not lay flat or lean the appliance so as to prevent dirty water from entering into the motor.
4. Always install the Dirty Water Tank and Clean Water Tank properly before use.
5. Do not allow the appliance to get wet to avoid risk of fire or injury caused by a short circuit.

## Grounding Instructions

1. This appliance must be grounded. If it should malfunction or breakdown, grounding provides a path of least resistance for electric current to reduce the risk of electric shock. This appliance is equipped with a cord having an equipment-grounding conductor and grounding plug. The plug must be inserted into an appropriate outlet that is properly installed and grounded in accordance with all local codes and ordinances.
2. **WARNING** – Improper connection of the equipment-grounding conductor can result in a risk of electric shock. Check with a qualified electrician or service person if you are in doubt as to whether the outlet is properly grounded. Do not modify the plug provided with the appliance – if it will not fit the outlet, have a proper outlet installed by a qualified electrician.
3. This appliance is for use on a nominal 120-V circuit and has a grounding attachment plug that looks like the plug illustrated in sketch in Figure. Make sure that the appliance is connected to an outlet having the same configuration as the plug. No adaptor should be used with this appliance.

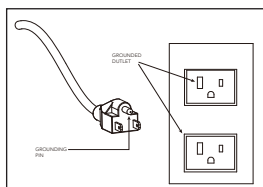

## FCC Supplier's Declaration of Conformity

TINECO / CARPET ONE SERIES

This appliance complies with part 15 of the FCC Rules. Operation is subject to the following two conditions:

- (1) This appliance may not cause harmful interference, and (2) this appliance must accept any interference received, including interference that may cause undesired operation.

TINECO INTELLIGENT, INC.  
1700 WESTLAKE AVENUE N., SUITE 200, SEATTLE, WA, 98109, USA  
WWW.TINECO.COM  
1-855-292-8864

Changes or modifications not expressly approved by the party responsible for compliance could void the user's authority to operate the equipment.

Note: This equipment has been tested and found to comply with the limits for a Class B digital appliance, pursuant to Part 15 of the FCC Rules. These limits are designed to provide reasonable protection against harmful interference in a residential installation.

This equipment generates uses and can radiate radio frequency energy and, if not installed and used in accordance with the instructions, may cause harmful interference to radio communications. However, there is no guarantee that interference will not occur in a particular installation. If this equipment does cause harmful interference to radio or television reception, which can be determined by turning the equipment off and on, the user is encouraged to try to correct the interference by one or more of the following measures:

- (1) Reorient or relocate the receiving antenna.
- (2) Increase the separation between the equipment and receiver.
- (3) Connect the equipment into an outlet on a circuit different from that to which the receiver is connected.
- (4) Consult the dealer or an experienced radio/TV technician for help.

## FCC Radiation Exposure Statement

This equipment complies with FCC radiation exposure limits set forth for an uncontrolled environment. This equipment should be installed and operated with a minimum distance of 20cm between the radiator and any part of your body.

## Note

The manufacturer is not responsible for any radio or TV interference caused by unauthorized modifications to this equipment, such modifications could void the user's authority to operate this equipment.

## IC Note

This appliance contains licence-exempt transmitter(s)/receiver(s) that comply with Innovation, Science and Economic Development Canada's licence-exempt RSS(s).

Operation is subject to the following two conditions:

- (1) this appliance may not cause interference.
- (2) this appliance must accept any interference, including interference that may cause undesired operation of the appliance.

- This Class B digital apparatus complies with Canadian ICES-003.
- This equipment complies with ISED RSS-102 radiation exposure limits set forth for an uncontrolled environment. This equipment should be installed and operated with a minimum distance of 20cm between the radiator and any part of your body.

## Specifications

Product	CARPET ONE SERIES
Rating	120V, 60Hz
Current	11.3A
CWT Capacity	2L
DWT Capacity	1.7L

- All data and technical instructions of this manual are based on results from lab tests of Tineco or designated third parties. The company reserves all rights for final explanations.

## Disposal

Accessories and packaging should be sorted for environmental friendly recycling. Do not put them into fire, water or soil.

# Overview

EN

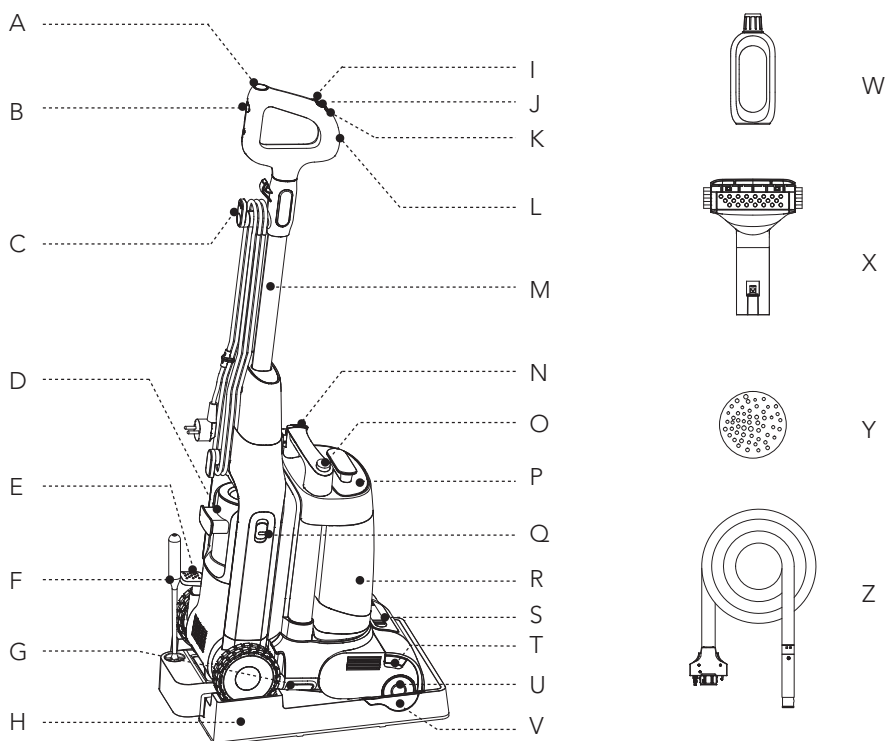

- A. Self-cleaning Button
- B. WiFi/Mute/Language Switch Button
- C. Cord Wrap
- D. Filter Chamber
- E. Recline Pedal
- F. Cleaning Tool
- G. Dryness Indicator
- H. Storage Tray
- I. Power On/Off
- J. Mode Switch Button
- K. Drying Button
- L. Digital Display
- M. Tube
- N. Clean Water Tank Cap

- O. Water Tank Release Button
- P. Dirty Water Tank Lid
- Q. Propulsion Assist
- R. 2 in 1 Water Tank
- S. Suction Port Door
- T. Brush Cover Release Button
- U. Brush Roller Release Button
- V. Hair Cleaning Tool
- W. Tineco Solution
- (Solutions may vary among markets)
- X. 2 in 1 Nozzle
- Y. Sponge Filter
- Z. Accessory Hose

# Digital Display



- |   |   |
|---|---|
| A. Self-cleaning Indicator  | F. Accessory Mode   |
| B. Dryness Indicator  | G. WiFi Indicator   |
| C. Dirt Monitoring Loop<br>(Blue to red according to the dirt amount) | H. Filter Chamber   |
| D. MAX Mode   | I. DWT Full or Blocked  |
| E. AUTO Mode  | J. CWT Empty  |
|   | K. Brush Roller Blocked<br>or Assisted Steering Wheel Failure |

# Accessories

## Note:

Accessories may vary among markets. If you require more accessories, please go to [www.tineco.com](http://www.tineco.com) or [store.tineco.com](http://store.tineco.com).



### Pre-treat Formula

Great for a variety of stains, this stain remover formula loosens tough, set-in stains & odors, and it works with Tineco Carpet One Series perfectly.

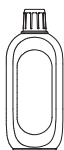

### Carpet Care & Deep Cleaning Solution

Removes dirt, grime, grease and tough stains from most types of carpets. Always use Tineco solution in your appliance. Add two bottle caps of solution to each full tank of clean water.



### Cleaning Tool

A full brush to clean the DWT, brush chamber and opening. The tool also has a bristled end to remove dirt and mud on the roller and DWT.

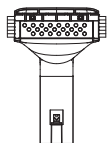

### 2 in 1 Nozzle

Remove stubborn stains on the carpet & upholstery.



### Sponge Filter

Sponge filter can block large particles and debris, ensure the appliance's durability.

\*Please reinstall the sponge filter after maintenance, or it may lead to weak suction gradually.



### Hair Cleaning Tool

Use the end with small blade to remove hair wrapped around the roller.

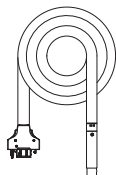

### Accessory Hose

A 2.5-meter hose to connect the appliance and the accessory brush.

# Assembly

## How to Assemble/Disassemble

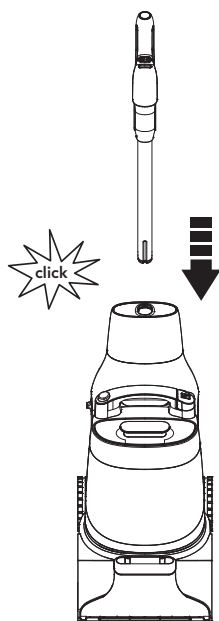

To assemble the handle, insert it into the appliance until you hear a “click”.

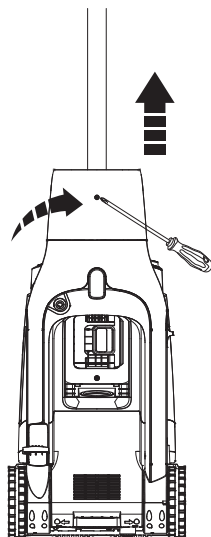

In the event that the handle needs to be disassembled, press the spring to release the handle with a tool (like a screwdriver) and lift the released handle from the appliance.

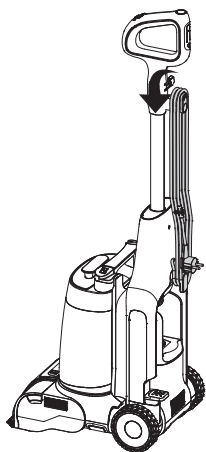

Wrap the power cord around the cord hooks for convenient storage.

## Water Tank

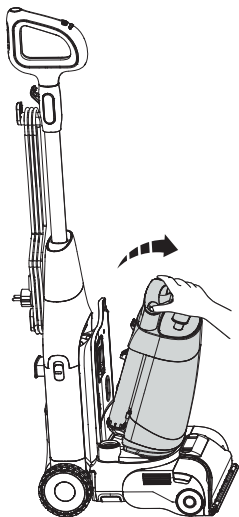

Press the water tank release button and lift the handle to remove it.

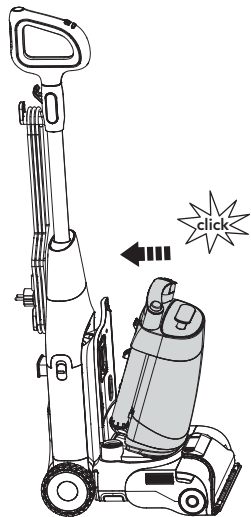

Install the Clean Water Tank into the appliance. You should hear a "click" if done correctly.

## Accessory Hose & 2 in 1 Nozzle

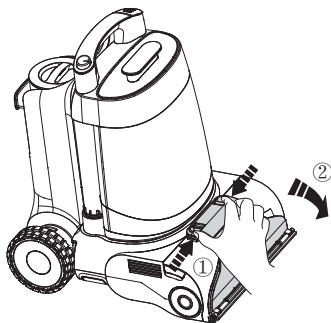

Pinch the suction port door latch, and rotate the suction port door open to uncover the hose connection port.

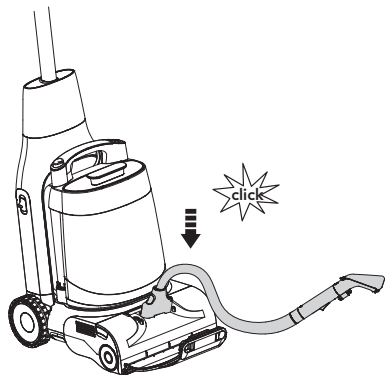

Insert the hose end into the port. You should hear one "click" if done correctly.

# Operation

## Preparing for Use (Appliance)

EN

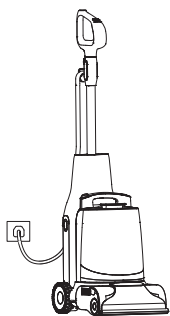

Unwrap the power cord and plug into an electrical outlet.

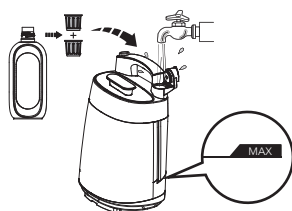

Open the tank cap, add two bottle caps of solution to the CWT, then fill with tap water to the Max line and tightly close the cap.

### Note:

Only use water under 140°F/60°C.  
**DO NOT USE HOT WATER.**

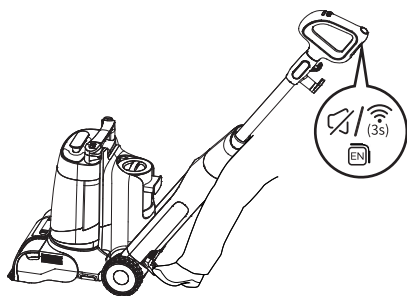

Step on the recline pedal to recline the unit to cleaning position.

### Tips:

- Press the button to adjust the voice volume.
- Press the button twice to switch languages.
- Press & hold for 3s to connect/disconnect WiFi.

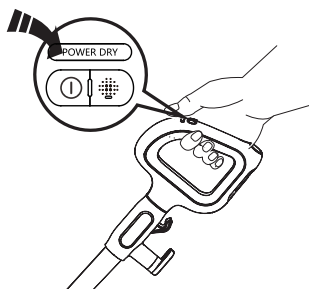

- Press the button and the appliance will start in AUTO mode by default. Press it again to turn off the appliance. Switch between AUTO, MAX and Carpet Care mode by pressing the button.
- Switch the appliance to Drying mode at any cleaning modes by pressing the button. Press the button again to switch back to cleaning modes.

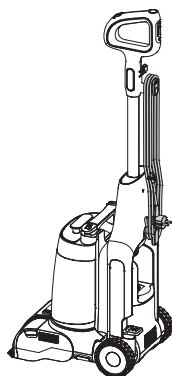

Stop Working

In AUTO/MAX/DRYING mode, the appliance will stop working when put uprightly and start running again when reclined.

In ACCESSORY mode, the appliance will only work when stand uprightly.

### Note:

- Pretreat spots and heavy traffic areas with Tineco Pretreat Cleaning Solutions to achieve better cleaning effect. Follow Directions on bottle.
- The carpet cleaner differs from the traditional vacuum cleaner.
- In all modes, it blows hot air, whose temperature is 158-176°F (70-80°C).  
\* Appropriate temperature is conducive to dissolve the dirt and helps surfactant in the solution to decompose the dirt.
- In AUTO/MAX mode, it sprays water when moving forward and stops spraying when moving backward.
- Take a spot test on a small and marginal area of the carpet for colorfastness. Gently rub surface with a damp white cloth. Then wait for ten minutes and check for color removal.
- During use, don't keep the appliance at a resting position for a long time.
- Important: Keep the foot of the deep cleaner perpendicular to the rug's edge with each cleaning pass to prevent damage.
- Important! Please check manufacturer's tag before cleaning area rugs for any specialized cleaning instructions. It's not advisable to perform deep cleaning on delicate, silk, wool, antique or area rugs without a manufacturer's tag.
- Some Loop Berber carpets, Natural Fiber (including silk and wool), and Soft Fiber carpets can fuzz with wear. Some vacuums & carpet cleaners can worsen this carpet wear. If cleaning on Berber, Natural Fiber, or Soft Fiber carpeting, first test on a small hidden area of carpet by running the carpet washer over it. If no fuzzing or overwetting occurs, continue cleaning. Avoid overwetting Berber carpets. If you have any questions or concerns, consult with your carpet manufacturer on deep cleaning recommendations.
- Avoid using it on rugs or carpets that require dry cleaning.
- For upholstery, check cleaning code - Use your Tineco Carpet Washer only if the upholstery fabric is marked with a "W" (for "wet" clean) or "S/W" (for "solvent/dry" or "wet" clean). Do not clean fabric marked "S" ("solvent/dry" clean only). If your upholstery does not have a code, seek professional assistance.
- Test for colorfastness - Wet a white absorbent cloth with the solution. In a small, hidden area, gently rub the surface with the dampened cloth. Wait for ten minutes and check for color removal.

# Preparing for Use (Accessory Hose & 2 in 1 Nozzle)

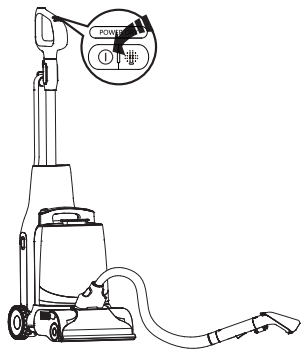

Attach the accessory hose, stand the appliance upright and ensure that it is powered on (if not, press the ① button), the appliance will enter ACCESSORY mode, the appliance will stop working when reclined.

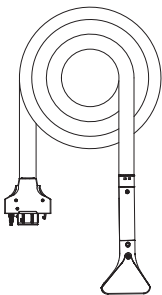

Please rinse and let dry after use, then store the accessory in the bag afterwards.

**Note:**

Do not vacuum foamed liquid.  
If additional cleaning is necessary, wait until the upholstery is completely dry before using the tool again to achieve better cleaning effect.

## App

All the functions can be performed using the Tineco app. Download the Tineco app from App Store, Google Play and Tineco Official Site.

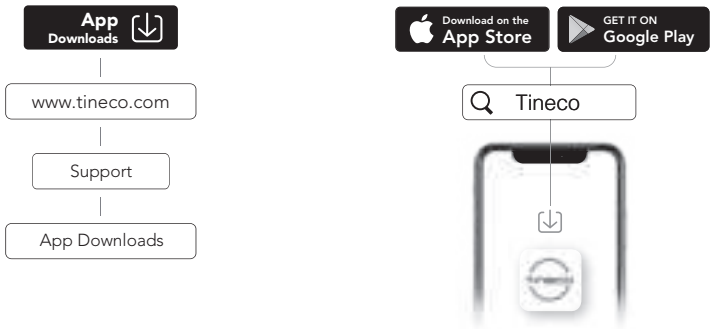

**Note:**

The default setting for voice prompt is English, you can change it to other languages via App or by pressing the language switch button twice.

## Cleaning Mode Selection

### AUTO Mode



- In AUTO mode, the iLoop sensor automatically detects how dirty the carpet is and applies the appropriate volume of water spray.
- A red dirt monitoring loop indicates more dirt is detected, and a blue loop indicates less dirt is detected. This mode automatically provides the best cleaning solution.

### MAX Mode



- In AUTO mode, press the  button to enter MAX mode.
- The iLoop still displays the dirty amount, yet the spray volume keeps at the maximum.

### ACCESSORY Mode

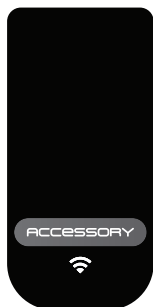

- Ensure the appliance is powered on (if not, press the  button), the appliance will enter ACCESSORY mode once the hose attachment is inserted. Press and hold the trigger on the 2 in 1 Nozzle to spray water.
- Stand the appliance upright, remove the accessory hose, the appliance will enter AUTO mode.

## DRYING Mode

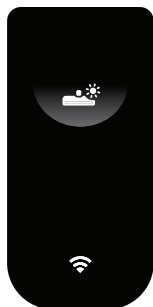

- In any cleaning modes, press the **POWER DRY** button to enter DRYING mode. In DRYING mode, the dryness indicator and iLoop ring will change with the humidity detected by the humidity sensor. Red indicates drying, Blue means dried, meanwhile, the iLoop ring will display the real-time dryness level.
- Press the  button to switch to AUTO mode.

# Indicator

EN



Solid red light: dirt sensor malfunction or blocked.



Indicator blinking: appliance is in need of self-cleaning.



iLoop red light blinks: appliance malfunction.



Indicator illuminated: CWT is empty.



Indicator illuminated: DWT is full or not installed.



Illuminated: WiFi has successfully connected.



Blinking: WiFi is connecting.



Off: WiFi is not connected, please connect to the network.



Indicator illuminated: Brush Roller is blocked or Assisted Steering Wheel Failure



Indicator illuminated: Filter Chamber Blocked

## Voice Prompt (Contents may vary, please in kind prevail.)

Status	Reminder
Voice prompts on	Voice prompts on
Voice prompts disabled	Voice prompts disabled
AUTO mode by default	AUTO mode
Switch to MAX mode	MAX mode
Switch to DRYING mode	DRYING mode
Switch to Accessory mode	Accessory mode
Unable to use Accessory mode	Stand the appliance upright to apply Accessory mode
Accessory installed, start cleaning	Accessory installed, start cleaning
Accessory removed, start AUTO mode	Accessory removed, now in AUTO mode
Clean Water Tank is empty	Insufficient water in the Clean Water Tank. Please fill up water
Dirt sensor malfunction or blocked	Clean the channel under the dirty water tank
Dirty Water Tank is full	Please check the dirty water tank
Filter Chamber Blocked	Filter chamber blocked, please empty
Brush roller is tangled	Please clean the brush roller
In Accessory mode, switch to other modes	Remove Accessory before using other modes
Operate Accessory mode	Stand the appliance upright to start Accessory mode
Stand the appliance upright	Stand the appliance upright
Shutting down	Shutting down
Power is off	Power off, please clean the dirty water tank
Restore factory settings	Factory settings restored
Self-cleaning starts	Self-cleaning has started
Self-cleaning complete	Self-cleaning complete
The appliance needs self-cleaning	Please place appliance on the storage tray to begin self-cleaning
Carpet detected dried	Heated drying completed, please check the result
Brush Roller Blocked	Please clean the brush roller
Assisted Steering Wheel Failure	Please check the assisted steering wheel

# Maintenance

## Note:

- For optimal performance and to prevent odors, always **clean** and **dry** the water tank, filters, brush roller, brush roller cover, 2 in 1 nozzle **completely** after each use.
- Please make sure each part is installed correctly or the appliance may not work properly.
- After maintenance, place the appliance vertically. Do not expose the appliance to direct sunlight, and store it indoors in a dry place.

## Brush Roller Self-cleaning

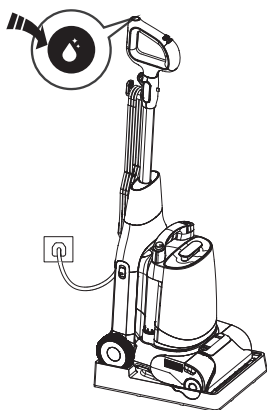

1. Place the appliance on the storage tray after use.
2. Plug it in, and press the self-cleaning button on top to start self-cleaning.
3. Once complete, please clean up the water tank.

## Note:

Before self-cleaning cycle, please plug in and ensure the water level in the CWT exceeds 40%.

## Main Body

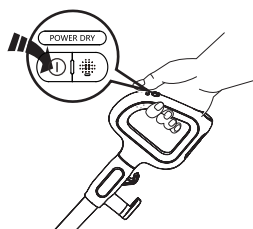

To reduce the risk of injury, switch off before performing maintenance.

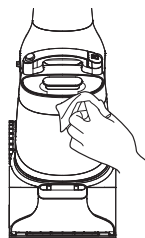

Use a cloth to clean the surface with a neutral detergent. The cloth should be dry to prevent water from entering the appliance.

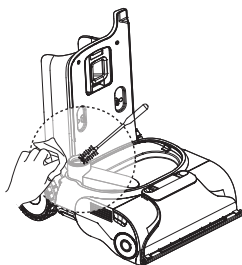

Remove the water tank, clean the dirt sensor with a damp cloth or the cleaning tool.

## Filter Chamber

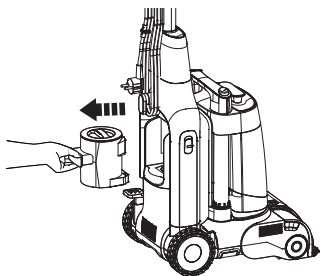

Grab the grip and pull out the filter chamber.

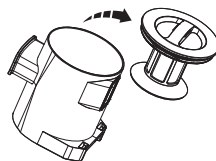

Take out the lid.

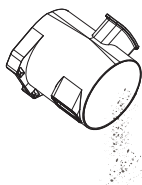

Empty the filter chamber regularly to avoid blockages.

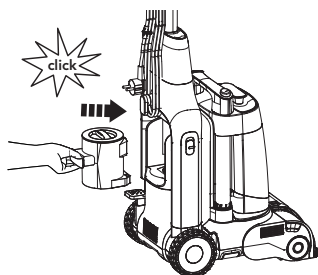

And you should hear a "click" when installed correctly.

## 2 in 1 Water Tank

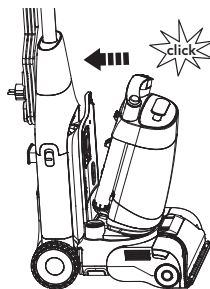
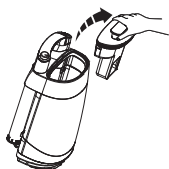
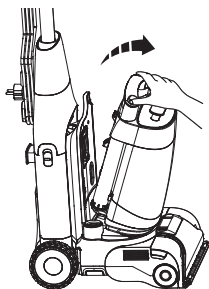

- When dirty water reaches the Max line, the appliance will stop working and show a reminder on the display and play a voice prompt.
- Grab the tank handle and press the release button on handle.
- Pull up the tank lid to empty the DWT. Use the cleaning tool to remove remaining debris. Rinse the inside of the DWT & tank lid and place back into the appliance.