

# User Manual

Thanks for choosing us!

This is a smart phone wireless charger that allows you enjoy the fun of digital products easily.

Please kindly read the user manual before using and keep it for future reference.

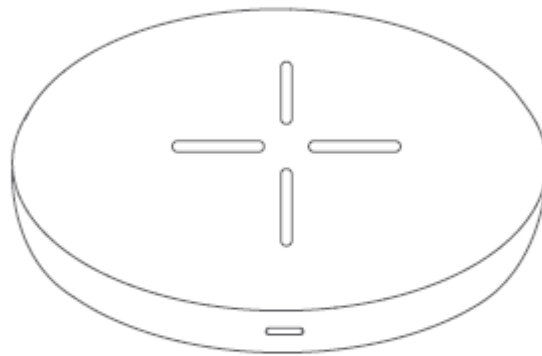

## Specification

---

Input: DC5V,2.0A DC9V,1.67A

Frequency:115~205KHz

Dimensions:  $\phi 99 \times 10\text{mm}$

Charging distance:  $\leq 10\text{mm}$

Conversion:  $\geq 72\%$

NW.: 107g

## Connect to Power Adapter

---

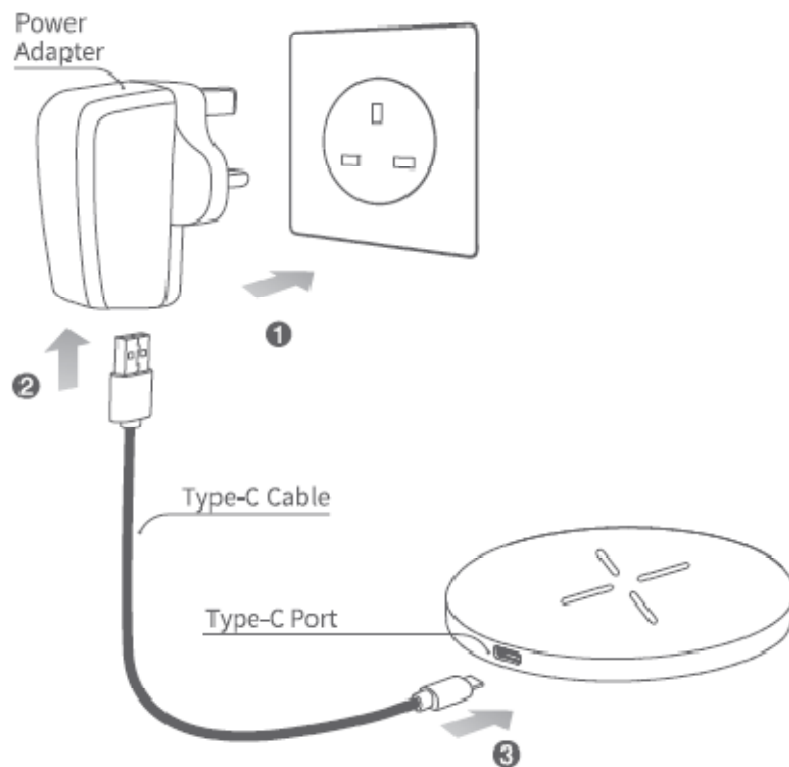

- ① Connect the power adapter to socket.
- ② Connect adapter to the Type-C interface, the other Type-C to pad.
- ③ The standby indicator light is green.

Note: this product works with Type-C to Type-C charging cable. Only QC 2.0 or QC3.0 standard power adapter support this product's quick charge function. You need to buy power adapter separately. Type-C to Type-C charging cable and power adapter need to be bought separately.

## Charging Mode

---

①

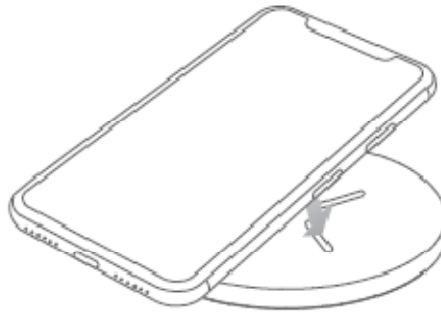

②



- ① Make sure the wireless charger dock connect to the power supply.
- ② Put the Qi-enabled smart phone properly on the transmitter, the indicator light become blue and start charging. The device enter to standby mode when take away the phone from charging pad.

Note: When Samsung phones which are built-in wireless charging function get fully charged with this product, if don't move the phone in a long time, the battery power keeps in fully charged status(supplementary charge).

## Notes

---

- 1、 Do not squeeze or collisions.
- 2、 Do not disassemble or throw into fire or water, to avoid causing a short circuit leakage.
- 3、 Do not use wireless charger in severely hot, humid or corrosive environments, to avoid circuit damage and occurs leakage phenomenon.
- 4、 Do not place too close with magnetic stripe or chip card ( ID card, bank cards, etc. ) to avoid magnetic failure.
- 5、 Please keep the distance at least 20cm between implantable medical devices ( pacemakers, implantable cochlear, etc. ) and the wireless charger, to avoid potential interference with the medical device.
- 6、 To take care of the children, to ensure that they won't play the wireless charger as a toy, to avoid unnecessary accidents.

The involved images are sketch maps, the final product as per the material subjects.

Includes: wireless charger, power cable, user's manual.

### **Federal Communications Commission (FCC) Statement**

This device complies with part 15 of the FCC Rules. Operation is subject to the following two conditions: (1) This device may not cause harmful interference, and (2) this device must accept any interference received, including interference that may cause undesired operation.

**Note:** This equipment has been tested and found to comply with the limits for a Class B digital device, pursuant to part 15 of the FCC Rules. These limits are designed to provide reasonable protection against harmful interference in a residential installation. This equipment generates, uses and can radiate radio frequency energy and, if not installed and used in accordance with the instructions, may cause harmful interference to radio communications. However, there is no guarantee that interference will not occur in a particular installation. If this equipment does cause harmful interference to radio or television reception, which can be determined by turning the equipment off and on, the user is encouraged to try to correct the interference by one or more of the following measures:

- Reorient or relocate the receiving antenna.
- Increase the separation between the equipment and receiver.
- Connect the equipment into an outlet on a circuit different from that to which the receiver is connected.
- Consult the dealer or an experienced radio/TV technician for help.

Warning: Changes or modifications made to this device not expressly approved by Shenzhen Powerqi Technology Co.,Ltd may void the FCC authorization to operate this device.

Note: The manufacturer is not responsible for any radio or TV interference caused by unauthorized modifications to this equipment. Such modifications could void the user's authority to operate the equipment.