

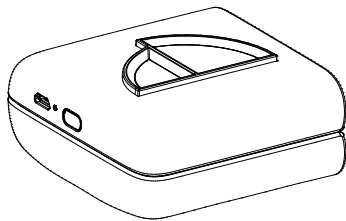

快速安装指南

Quick Start Guide

HPRT L5/L5S



开箱清单



HPRT L5/L5S



安装指南



热敏纸卷

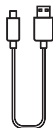

USB数据线

⚠ 注意:箱内实际内容以出货清单为准。

使用向导



电源键状态

长按两秒即可ON/OFF

- 常亮:待机状态/充电完成
- 慢闪:充电状态/固件升级中
- 快闪:耗材不足,设备盖没有关紧,电量不足,打印头过热



USB数据线

除专用充电线外也可使用手机充电线

- 建议使用专用充电线充电
- 使用5V/1A充电时大约需要90分钟



充电状态

购买后第一次使用时

- 我们建议充满电后使用
- 可以使用电源适配器或电脑USB口充电(出货时不配适配器)*

*注意:若使用电源适配器供电,则应购买并使用获得CCC认证并满足标准要求的电源适配器。

外观及组件

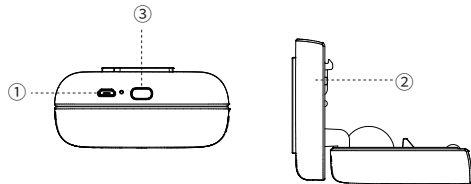

① USB接口

② 上盖

③ 电源键

下载APP

扫描下方二维码下载安装APP:



连接设备

注册并登录APP, 点击添加设备, 通过搜索蓝牙连接设备。

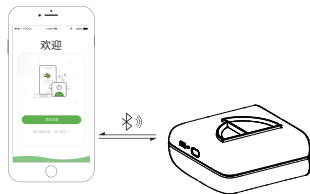

APP设置



简单操作

APP设置

- 可以在设备管理中查看剩余电量、固件版本等信息

耗材的更换



图1



图2



图3

- 将打印机如图1放置，注意查看机身箭头指示。
- 参照图2所示，向下推开上盖。
- 更换耗材时，参照图3所示方向，放入耗材。
- 确认耗材放置正确后，请将上盖与下盖合上，向上推动上盖恢复原状。

⚠ 打印机更换耗材时，请勿触碰打印头以防过热烫伤。

官方耗材的种类

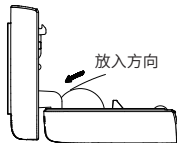
不干胶纸	有背胶可粘贴，方便错题整理，可以裁切大小，留影时长10年
十年纸	打印清晰，显色稳定，适合日常使用，留影时长10年
标签纸	有背胶可粘贴，固定大小的贴纸，不能裁切，留影时长10年
畅打纸	价格实惠，适合文字打印，留影时长2年
*所有打印纸都不含有双酚-A	
*若因未使用专用打印纸而产生机器故障，则无法享受三包政策	

安全及注意事项



电池过热

电池管理及注意事项

- 充电完成时，我们建议拔掉充电线。
- 为了避免火灾，请不要在高温地点充电（如汗蒸房、篝火附近等）。



烧伤危险

打印头过热

- 打印后，请勿直接触碰打印头，以防过热烫伤。



充电器注意

打印头管理及注意事项

- 有可能因为充电不当而导致打印头损坏。
- 我们建议不要在高湿度或多灰尘地带使用。



充电端口损坏现象

充电中的注意事项

- 请轻轻插入或拔出充电线，以防用力过猛损坏充电端口。

FCC

This device complies with part 15 of the FCC Rules. Operation is subject to the following two conditions: (1) this device may not cause harmful interference, and (2) this device must accept any interference received, including interference that may cause undesired operation.

Warning: Any changes or modifications not expressly approved by the party responsible for compliance could void the user's authority to operate the equipment.

NOTE: This equipment has been tested and found to comply with the limits for a Class B digital device, pursuant to Part 15 of the FCC Rules. These limits are designed to provide reasonable protection against harmful interference in a residential installation. This equipment generates, uses and can radiate radio frequency energy and, if not installed and used in accordance with the instructions, may cause harmful interference to radio communications.

However, there is no guarantee that interference will not occur in a particular installation. If this equipment does cause harmful interference to radio or television reception, which can be determined by turning the equipment off and on, the user is encouraged to try to correct the interference by one or more of the following measures:

- Reorient or relocate the receiving antenna.
- Increase the separation between the equipment and receiver.
- Connect the equipment into an outlet on a circuit different from that to which the receiver is connected.
- Consult the dealer or an experienced radio/TV technician for help.

FCC Radiation Exposure Statement

The device has been evaluated to meet general RF exposure requirement.
The device can be used in portable exposure condition without restriction.