

Saramonic

Sound.Remarkable. 

Plug-on Transmitter

插接式发射器

Vlink2 TX-XLR

User Manual

用户手册



FCC Caution:

Any Changes or modifications not expressly approved by the party responsible for compliance could void the user's authority to operate the equipment.

This device complies with part 15 of the FCC Rules. Operation is subject to the following two conditions: (1) This device may not cause harmful interference, and (2) this device must accept any interference received, including interference that may cause undesired operation.

IMPORTANT NOTE:

Note: This equipment has been tested and found to comply with the limits for a Class B digital device, pursuant to part 15 of the FCC Rules. These limits are designed to provide reasonable protection against harmful interference in a residential installation. This equipment generates, uses and can radiate radio frequency energy and, if not installed and used in accordance with the instructions, may cause harmful interference to radio communications. However, there is no guarantee that interference will not occur in a particular installation. If this equipment does cause harmful interference to radio or television reception, which can be determined by turning the equipment off and on, the user is encouraged to try to correct the interference by one or more of the following measures:

- Reorient or relocate the receiving antenna.
- Increase the separation between the equipment and receiver.
- Connect the equipment into an outlet on a circuit different from that to which the receiver is connected.
- Consult the dealer or an experienced radio/TV technician for help.

FCC Radiation Exposure Statement:

This equipment complies with FCC radiation exposure limits set forth for an uncontrolled environment.

Statement

Please read this manual carefully before use and operate and store in strict accordance with the instructions provided. Please retain for future reference. For any issues that cannot be resolved with the user manual, please refer to your retailer for help or contact us at: info@saramonic.com.

General Introduction

The Saramonic Vlink2 TX-XLR is a 2.4GHz wireless XLR transmitter that features an easy-to-use OLED display, 48V phantom power supply and mute function. It can be powered by a rechargeable Li-ion battery or two AA batteries. The Vlink2 TX-XLR works with Vlink2 RX receiver for wireless audio transmission in a wide range of applications.

Product Structure

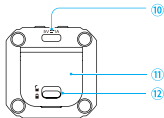
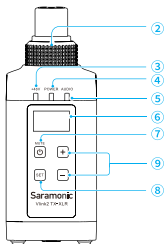
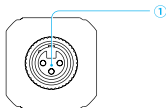

- ① XLR audio input jack
- ② Locking ring
- ③ 48V phantom power indicator

Status	Indicator
48V power supply enabled	Solid blue light
48V power supply disabled	Light off

④ Power indicator

Status	Indicator
Sufficient battery level	Solid blue light
Low battery	Flashing red light
Charging	Solid red light
Fully charged	Solid blue light
Charging error occurs	Quickly flashing red light

⑤ Audio indicator

Status	Indicator
Unpaired	Light off
Pairing	Quickly flashing blue light
Successfully paired	Solid blue light
Mute ON (Paired Successfully)	Slowly flashing blue light

⑥ OLED display

For more details, please refer to "OLED Display Operation Guide".

⑦ Power/Mute button

Status	Operation
Power ON/OFF	Long press
Mute ON/OFF	Short press

⑧ SET button

Long press the SET button to enter the displayed menu. Then, short press the SET button to confirm your setting, or long press again to exit without saving.

⑨ +/- button

Short press + or - button to select different functions or values shown on the display.

Long press + and - buttons simultaneously to enter pairing mode.

⑩ USB-C charging port

⑪ Battery compartment cover

⑫ Cover release

OLED Display Operation Guide

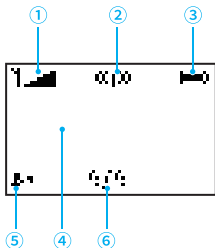

Home screen

If no operation is performed within 20 seconds on menu screens, the display will automatically return to home screen.

① Signal strength indicator

- Signal is strong
- Signal is weak
- Unpaired

② Pairing status indicator

- Successfully paired
- (Flashing indicator) Pairing
- Unpaired

③ Battery level indicator

Displays the battery level. Please recharge the transmitter immediately as soon as the indicator starts flashing.

④ Audio input level meter

Displays the audio input level.

⑤ Mute indicator

- Mute ON
- Mute OFF

⑥ Mic gain

Menu screen

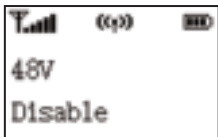

48V Phantom Power Setting

Enable/disable the 48V phantom power supply function. When set to "Enable", 48V phantom power is provided to the connected microphone, and the 48V indicator lights up. Default is "Disable".

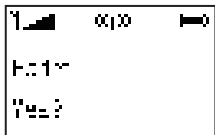

Pairing

Select "Yes?" to pair the transmitter with Vlink2 RX receiver. For details of operation, please refer to "Pairing the transmitter with Vlink2 RX receiver".

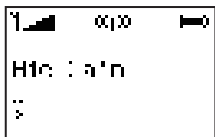

Mic Gain Setting

Adjust the microphone's input gain level (0~9). Default is "9".



Backlight Setting

Set backlight to always on or on for 10/30/60 seconds. Default is "ON".

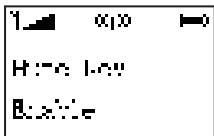

Mute Key Setting

Enable or disable mute key button function. If "Enable" is selected, short press the mute button can mute/unmute the microphone. If "Disable" is selected, the mute

key function is disabled, and short press the button won't mute the microphone.
Default is "Enable".

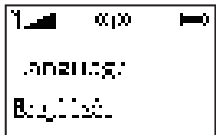

Language Setting

English and Chinese are available.
Default is English.

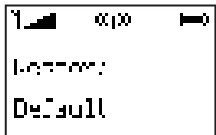

Restore Default Setting

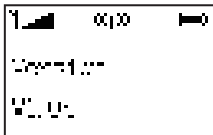

Version of the Vlink2 TX-XLR

Attaching a microphone to the transmitter

Connect the microphone to the transmitter's XLR female jack, and then tighten the locking ring as shown.

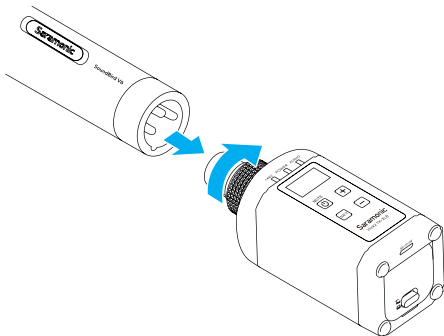

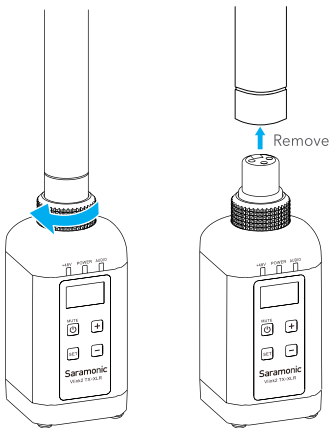

Note:

To remove the microphone, please unlock the ring first.

Inserting batteries

The transmitter is powered by a rechargeable Li-ion battery or two AA batteries. To install batteries, please follow the steps below:

1. Slide the cover release as shown to open the compartment cover.

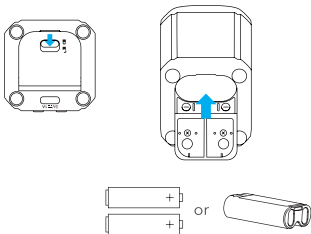

2. Insert two AA batteries or the supplied Li-ion battery into the battery compartment, respecting the polarity indicated inside the compartment.
3. Close the battery cover.

Note:

1. Replacing the batteries during operation may generate a large noise. Be sure to turn off the unit before replacing the batteries.
2. When not using the device for a long period of time, please remove the batteries.

Charging the supplied Li-ion battery

- 1.Insert the supplied Li-ion battery into the battery compartment.(see previous instructions)
- 2.Plug the supplied USB-C charging cable into the USB-C port of the transmitter, then connect the other end of the cable to a power source.

Note:

AA batteries can not be charged via this unit. Please do not charge the unit when two AA batteries are inserted. The power indicator will flash red quickly when this error occurs.

Pairing the transmitter with Vlink2 RX receiver

Pair the plug-on transmitter with a Vlink2 receiver in the following two ways:

1.Using the + and - buttons

- ① Turn on the receiver and the transmitter.
- ② Long press the "+" and "-" buttons at the same time to enter pairing mode.
- ③ The system is paired successfully when transmitter's Audio indicator and receiver's RF indicator turn solid blue.

2.Using the Pair menu

- ① Turn on the receiver and the transmitter.
- ② Use the -button to display the Pair menu on both transmitter and receiver.
- ③ Long press the SET button to enter the menu.
- ④ Select Yes, and short press the SET button to confirm.
- ⑤ The system is paired successfully when transmitter's Audio indicator and receiver's RF indicator turn solid blue.

Specifications

Modulation	GFSK
Transmission type	2.4GHz
Operating range	Up to 230'(70m) (without obstacle)
Audio input connector	3-pin XLR female
Battery capacity	1600mAh Li-ion battery or 2*AA battery
Battery life	> 10 hours
Power requirements	Li-ion battery or USB-C DC 5V or 2*AA battery
Signal-to-noise ratio	> 76dB
RF output power	< 10mW
Frequency response	35Hz-18KHz
Operating temperature	-10 °C to 50 °C
Storage temperature	-20 °C to +55°C
Dimensions	44*43.5*113mm
Weight	179g (6.31oz)

Packing List

- 1×Vlink2 TX-XLR Transmitter
- 1×USB-A to USB-C Charging Cable
- 1×Rechargeable Li-ion Battery
- 1×Leather Pouch

声明

请在使用前仔细阅读本手册，并严格按照说明进行操作和存储。请保存以供将来参考。如果用户手册不能帮助您解决某些问题，请向零售商寻求帮助或给我们发送电子邮件：info@saramonic.com。

概述

枫笛 Vlink2 TX-XLR 是一款 2.4GHz 无线 XLR 发射器，具有易于使用的 OLED 显示屏，48V 幻象供电和静音功能。产品可由两节五号电池或随附的可充电锂电池供电。Vlink2 TX-XLR 与 Vlink2 RX 接收器搭配使用，可在各种应用场景中进行高品质无线音频传输。

产品结构

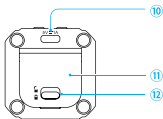
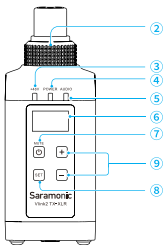
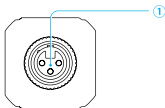

① XLR 音频输入接口

② 锁紧旋钮

③ 48V 幻象电源指示灯

状态	指示灯
48V 供电功能开启	蓝灯长亮
48V 供电功能关闭	蓝灯熄灭

④ 电源指示灯

状态	指示灯
电量充足	蓝灯长亮
低电量	红灯闪烁
充电中	红灯长亮
充满电	蓝灯长亮
充电异常	红灯快闪

⑤ 音频指示灯

状态	指示灯
未联机	蓝灯熄灭
对码中	蓝灯快闪
联机成功	蓝灯长亮
静音状态	蓝灯慢闪

⑥ OLED 显示屏

详情参考“OLED 屏幕操作指南”。

⑦ 电源 / 静音键

状态	操作
开机 / 关机	长按按键
静音模式 / 取消静音	短按按键

⑧ 设置键

长按设置键进入选定菜单，短按确认当前设置，再次长按退出当前设置（不保存）。

⑨ +/- 键

短按 + 或 - 键调整各参数值或功能。
同时长按 + 和 - 键可进入配对模式。

⑩ USB-C 充电孔

⑪ 电池仓盖

⑫ 电池仓开关键

OLED 屏幕操作指南

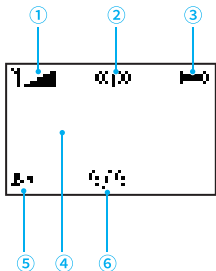

③ 电量指示

显示发射器当前电量。当图标开始闪烁时，请及时为发射器充电。

④ 实时输入电平指示

显示实时输入电平大小

⑤ 静音状态指示

 静音开启  静音关闭

⑥ 麦克风增益

主界面

若超过 20 秒不操作，显示屏会自动跳转回主界面上。

① 信号强度指示



信号最强



信号最弱



未联机状态

② 配对状态指示



联机成功



(图标处于跳动状态) 正在对码



未联机

菜单界面



48V 幻象电源设置

开启 / 关闭 48V 幻象供电功能。设置为“开启”时，可为接入的麦克风提供 48V 幻象电源供电，同时 48V 指示灯亮起。默认设置为“关闭”。

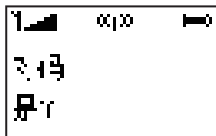

对码

选择“是?”将发射器与 Vlink2 RX 接收器配对。具体操作请参考“发射器与 Vlink2 RX 接收器配对操作”。

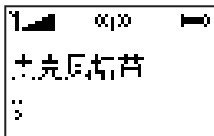

麦克风增益设置

调节麦克风增益（0~9），默认设置为“9”。

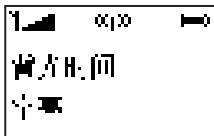

背光时间设置

背光时间可设置为常亮、10 秒、30 秒、或 60 秒，默认设置为“常亮”。

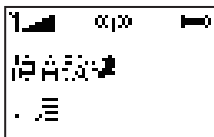

静音按键功能设置

开启或关闭静音按键功能。

开启：短按静音键可将麦克风静音 / 取消静音；

关闭：静音键功能关闭，短按按钮不会使麦克风静音。

默认设置为“开启”。

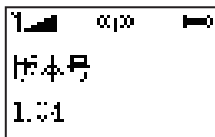

Vlink2 TX-XLR 版本号

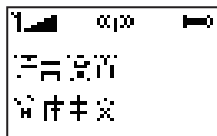

语言设置

English/ 简体中文可供选择，默认设置为“English”。

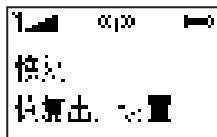

恢复默认设置

麦克风安装指示

如图所示，将麦克风连接到发射器的 XLR 音频接口，然后拧紧锁头。

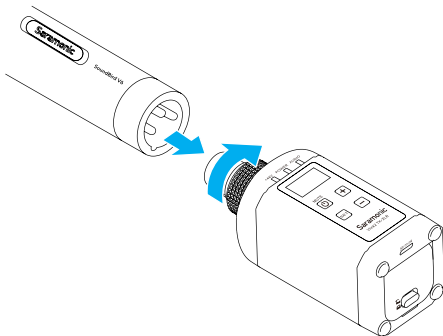

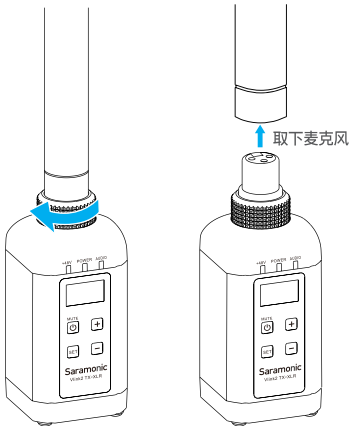

注意：
取下麦克风前，请先松开锁头。

电池安装

Vlink2 TX-XLR 可由两节五号电池或随附的充电锂电池供电。请按照以下步骤安装电池：

1. 如图所示，拨动电池仓开关键，打开盖子。

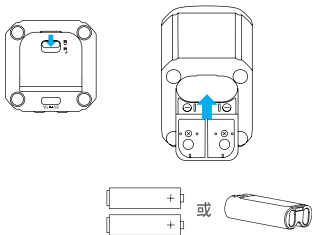

2. 按照电池仓内正负极指示，将两节五号电池或随附的充电锂电池插入电池仓。

3. 关闭电池仓。

注意：

1. 产品在开机使用情况下，直接取出电池可能会导致高噪音。因此，取出电池前，请先将设备关机。
2. 长时间不使用设备时，请取出电池。

充电指示

1. 将随附的锂电池插入产品电池仓。（参见前面的说明）
2. 将随附的 USB-C 充电线插入发射器的 USB-C 充电孔，然后将线的另一端连接到电源。

注意：

五号电池不能通过本机进行充电。若产品已安装两节五号电池，请勿进行充电操作。出现此错误操作时，电源指示灯会呈异常闪烁（红灯快闪）。

发射器与 Vlink2 RX 接收器配对操作

可通过以下两种方式将发射器与 Vlink2 接收器配对：

1. 使用 + 和 - 键进行配对

- ①将发射器和接收器开机。
- ②同时长按 + 和 - 键进入配对模式。
- ③待发射器音频指示灯和接收器的 RF 指示灯呈蓝灯长亮时，配对成功。

2. 通过“对码”菜单进行配对

- ①将发射器和接收器开机。
- ②使用 - 键在发射器和接收器上选择“对码”菜单。
- ③长按 SET 键进入菜单。
- ④选择是，短按 SET 键确认。
- ⑤待发射器音频指示灯和接收器的 RF 指示灯呈蓝灯长亮时，配对成功。

参数

调制方式	高斯频移键控
传输方式	2.4GHz
操作距离	70 米（无障碍）
音频输入接口	XLR 卡侬口
电池容量	1600mAh 锂电池或 2 节 AA 电池
续航时间	> 10 小时
供电方式	锂电池或 USB-C DC 5V 或 2 节 AA 电池
信噪比	> 76dB
射频输出功率	< 10mW
频率响应	35Hz-18KHz
工作温度	-10 ° C ~ 50 ° C
存储温度	- 20 ° C ~ +55° C
尺寸	44*43.5*113mm
重量	179g

包装清单

1 × Vlink2 TX-XLR 发射器

1 × USB-A 转 USB-C 充电线

1 × 充电锂电池

1 × 皮革包



For better recording experience, the application **SmartRecorder** is recommended.

为获得更好的录制体验，推荐使用枫笛 Saramonic 自主研发应用软件 **SmartRecorder**。



Scan the QR code and follow us!

扫描微信关注枫笛公众号

Shenzhen Jiayz Photo Industrial., Ltd

深圳市长丰影像器材有限公司

A16 Building, Intelligent Terminal Industrial Park of Silicon Valley

Power, Guanlan, Longhua District, Shenzhen, China

深圳市龙华区观澜街道大富工业区硅谷动力智能终端产业园 A16 栋



400-613-1096



www.saramonic.com



info@saramonic.com

JIAYZ长丰 | 深圳市长丰影像器材有限公司

产品/零件名称	Vireo2 TX.XLR 说明书	比例	1 : 1	版本	V00
工程图号	Vireo2 TX.XLR 说明书	物料描述	105g 铜版纸过油 骑马钉 正反面印刷 P26		
物料编号	1F0000400309	尺寸/用量	75x50mm 1pcs		
是否需要承认书	是	正负公差			
制图人/日期	杨昕 2022.03.07				