



QUICK START GUIDE STIR IT UP WIRELESS

INDEX

English
Français
Deutsch
Italiano
Español

3
14
20
36
10
43

ENGLISH

PRODUCT MAP

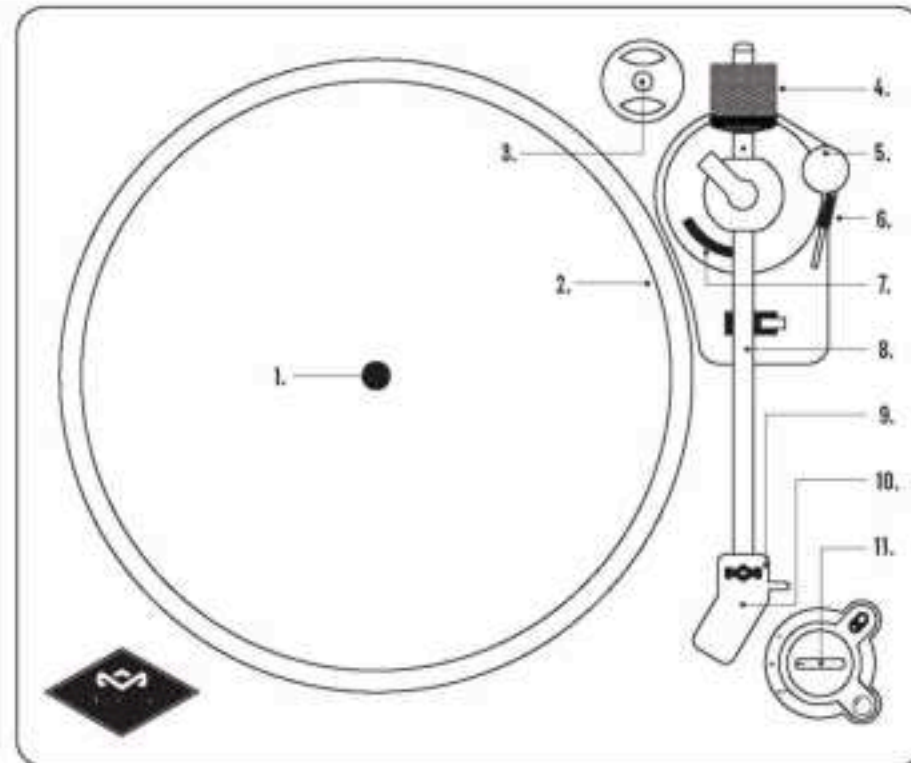

LEGEND

- | | |
|------------------------|--|
| 1. Tonearm | 9. Tone Arm Rest Holder |
| 2. Turntable | 10. Tone Arm |
| 3. 40 Adapter | 11. Stylus |
| 4. Balance Weight | 12. Needle Cover |
| 5. Anti-Clamping Knob | 13. OFF/ON/45 Knob |
| 6. Tone Arm Lift Lever | 14. Power Adapter with 4 Interchangeable Plugs |

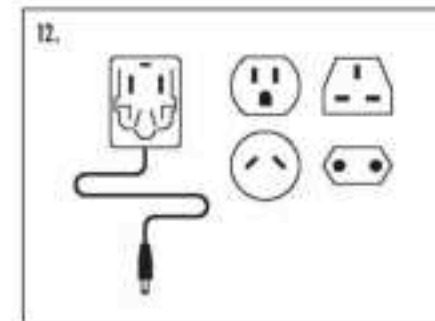

FUNCTION LAYOUT

LEGEND

- | | |
|--------------------------|-----------------------|
| A. RCA Line Out | E. Bluetooth® Button |
| B. Presets Switch Button | F. - VOL + Knob |
| C. USB to PC Recording | G. Headphone Jack |
| D. OFF/ON/45 Knob | H. Anti-Clamping Knob |

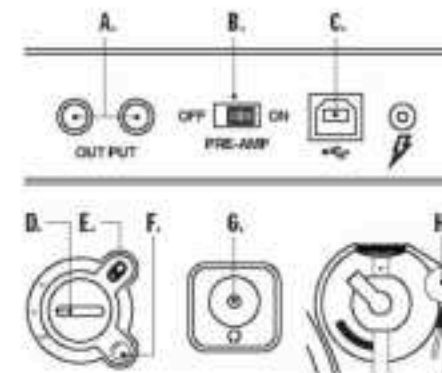

ATTENTION, PLEASE READ QUICK START GUIDE BEFORE USE
ATTENTION, PRIERE DE LIRE LE GUIDE DE
CONNAISSANCE RAPIDE AVANT UTILISATION
ATENCIÓN, Lea la Guía de Inicio Rápido ANTES de USARLO
VOR DEN GEBRAUCHBITTE DIE SCHNELLSTARTANLEITUNG LESEN
ATTENZIONE, LEGGERE LA GUIDA DI AVVIAMENTO RAPIDO PRIMA DEL USO

3/17/21 11:46 AM/11:46 AM / 11:46 AM/11:46 AM

3/17/21 11:46 AM/11:46 AM / 11:46 AM/11:46 AM

3/17/21 11:46 AM/11:46 AM / 11:46 AM/11:46 AM

3/17/21 11:46 AM/11:46 AM / 11:46 AM/11:46 AM

3/17/21 11:46 AM/11:46 AM / 11:46 AM/11:46 AM

3/17/21 11:46 AM/11:46 AM / 11:46 AM/11:46 AM

SETUP

POWERING ON YOUR STIR IT UP WIRELESS



- Your STIR IT UP WIRELESS uses an AC power supply and is powered by a standard wall outlet.
- Connect the power adapter to the wall outlet.

ATTACHING THE DRIVE BELT

Note: The drive belt is stored underneath the aluminum platter. Look on the under side of the platter, it will be the black elastic band stored around the center.

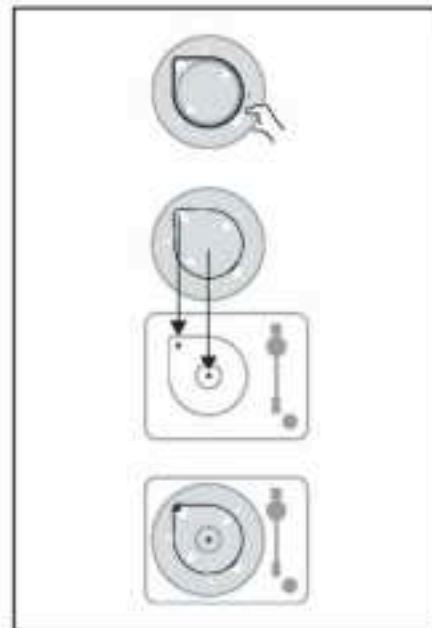

- To fit the belt, lift the belt over one of the larger holes in the platter and hook it around your finger.
- Keeping the belt looped around your finger, place the platter on the turntable base.
- Line up the large hole with the gold-colored spindle and gently loop the belt around it. The belt should now be around the base of the platter and the gold spindle. The platter should be attached to the base.
- Now place the rubber[®] all-over slip mat on the turntable.

BLUETOOTH[®] PAIRING

- Power on the external Bluetooth[®] device first before turning on the BT function on the turntable.
- Press the BT button on the turntable to turn on Bluetooth[®] transmitter.
- Press button again to enable the unit to search the Bluetooth[®] device till BT indicator light becomes solid. This will indicate your device are paired.

Note: If the turntable does not pair with your Bluetooth[®] device within 30 seconds, press the Bluetooth[®] search button again on the turntable and it should pair.



- Blue LED light flash
- Blue LED light stable

DISCONNECT BLUETOOTH[®] PAIRING

Long press and hold the BT button till the BT indicator light turns off. Turntable will then disconnect from external device.

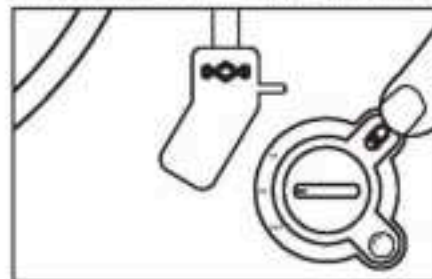

- Blue LED light will turn off.

PLAYING A RECORD

1. Put a vinyl record on the turntable.
2. Assemble the balance weight and set it to a proper position.
3. To adjust the balance weight rotate the balance weight at counter-clockwise.
4. Lift and move the tone arm to turntable. Place the tone arm on the edge of the record.
5. Turn the RPM dial knob to select the speed according to the record you are playing.
6. The turntable platter will auto stop when the auto stop ends. Lift the tone arm and place it to tone arm rest specially.

To listen to side B, flip record and repeat the above steps.

*33 RPM speed to play corresponding size 33 vinyl disc

*45 RPM speed to play corresponding size 45 vinyl disc

To power the unit off rotate the RPM dial knob to the off position.

Note:

Remove the needle cover before you balance the tone arm. Hold tone arm whenever you make any adjustment or action so as to protect the tone arm.

Do not try to adjust the balance weight while playing a record as this could break the needle and scratch the record. Be secured the tone arm before transportation to protect the needle.

Remove the balance weight before transportation to prevent damage or breakage to the unit.

Do not stop or turn the platter manually. Moving or turning the turntable without securing the tone arm clasp could result in damage to the tone arm.

ANTI-SKATING

Normally the anti-skating compensator for inward tracking forces that occur with certain pick-up when the stylus moves the center of the record. If the turntable is experiencing excessive skating while hearing the center spindle, try increase the anti-skating to the increments indicated on the dial. Start by adding an increment of 1. Test its performance, then increase it more, and so on.

Note: During adjusting the anti-skating knob, lower the tone arm and balance weight alone to prevent damaging the stylus (needle).

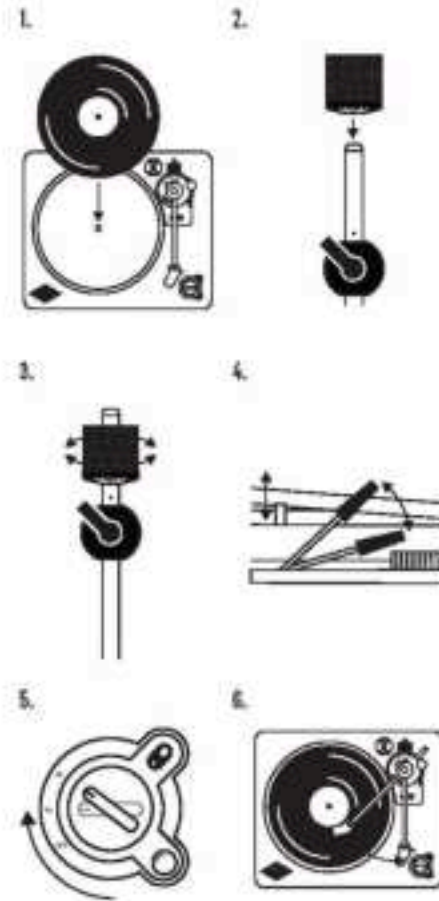

VOLUME CONTROL

Increase Volume: Rotate the Volume knob clockwise.

Decrease Volume: Rotate Volume knob counter clockwise.

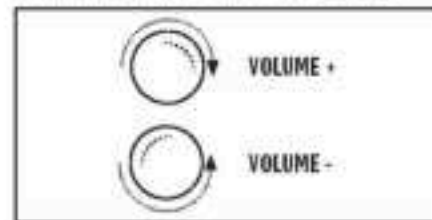

HEADPHONE OPERATION VIA HEADPHONE JACK

Connect a set of headphones (not included) in the headphone jack.

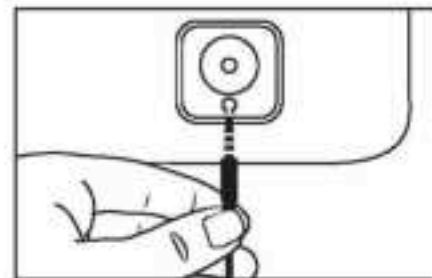

Note: Never put on the headphones till you have plugged in the headphone plug.

USB TO PC RECORDING

Download Full Instruction for the Audacity Software at:

<http://www.audacityteam.org/audacity/>

- Connect the turntable and the computer via the provided USB cable.
- Follow the instruction of the software installation steps and operation software.

NON BLUETOOTH[®] CONNECTION SETUP

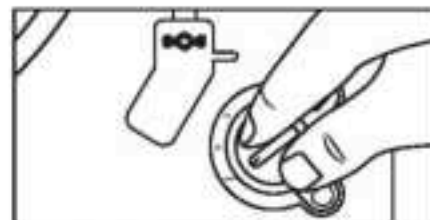

CAREFUL: Switch off the power to all equipment before making connections. Read the instructions of each component you intend to use with this unit. Be sure to insert each plug securely. To prevent hum and noise, avoid bundling the signal interconnection cables together with the AC power cord.

LINE OUT OPERATION

1. Switch the PRE-AMP OFF/ON SWITCH to ON position.
2. Plug one end of the RCA cable (included) into the LINE OUT socket at the back of the unit. Be sure to match the color with the socket.
3. Plug the other end of the cable into the LINE IN socket of your home amplifier device.
4. Switch on the unit and the amplifier device you connected.
5. ADJUST the volume on the amplifier device.

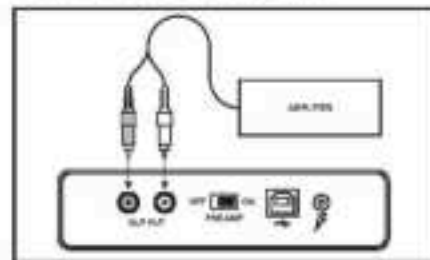

COMPLIANCE INFO

Conformité / Conformidad / Beachtung / Conformità

STIR IT UP WIRELESS

READ ALL INSTRUCTIONS BEFORE USE AND SAVE THESE INSTRUCTIONS FOR FUTURE REFERENCE.

This equipment has been tested and found to comply with the limits for a Class B digital device, pursuant to part 15 of the FCC Rules. These limits are designed to provide reasonable protection against harmful interference in a residential installation. This equipment generates uses and can radiate radio frequency energy and, if not installed and used in accordance with the instructions, may cause harmful interference to radio communications. However, there is no guarantee that interference will not occur in a particular installation. If this equipment does cause harmful interference to radio or television reception, which can be determined by turning the equipment off and on, the user is encouraged to try to correct the interference by one or more of the following measures:

- Reorient or relocate the receiving antenna.
- Increase the separation between the equipment and receiver.
- Connect the equipment into an outlet on a circuit different from that to which the receiver is connected.
- Consult the dealer or an experienced radio/TV technician for help.

This device complies with FCC radiation exposure limits set forth for an uncontrolled environment.

This device complies with Part 15 of the FCC Rules. Operation is subject to the following two conditions: (1) this device may not cause harmful interference, and (2) this device must accept any interference received, including interference that may cause undesired operation.

FCC RF EXPOSURE STATEMENT:

This transmitter must not be co-located or operating in conjunction with any other antenna or transmitter.

CAUTION!

Any changes or modifications not expressly approved by the party responsible for compliance could void the user's authority to operate the equipment.

To maintain compliance with the FCC's RF exposure guidelines, place the product at least 20cm from nearby persons.

ISED C STATEMENT

This device complies with Innovation, Science, and Economic Development Canada license-exempt RSS standard(s). Operation is subject to the following two conditions: (1) this device may not cause interference, and (2) this device must accept any interference, including interference that may cause undesired operation of the device.

Le présent appareil est conforme aux CNR d'Innovation, Sciences et Développement économique Canada applicables aux appareils radio exempts de licence. L'exploitation est autorisée aux deux conditions suivantes : (1) l'appareil ne doit pas produire de brouillage, et (2) l'utilisateur de l'appareil doit accepter tout brouillage radioélectrique subi, même si le brouillage est susceptible d'en compromettre le fonctionnement.

The device complies with RF exposure guidelines, users can obtain Canadian information on RF exposure and compliance.

Les utilisateurs peuvent sur l'exposition aux radiofréquences et la conformité et compliance d'acquiescer les informations correspondantes. Utilisateurs peut obtenir l'information canadienne sur l'exposition et la conformité de rf.

This Class B digital apparatus complies with Canadian ICES-003.

Cet appareil numérique de classe b est conforme à la norme nmb - 003 du canada.

ISED C RF EXPOSURE STATEMENT:

The device is compliance with RF exposure guidelines, users can obtain Canadian information on RF exposure and compliance.

LE PRÉSENT APPAREIL EST CONFORME

Après examen de ce matériel aux conformité ou aux limites d'intensité de champ RF, les utilisateurs peuvent sur l'exposition aux radiofréquences et la conformité et compliance d'acquiescer. les informations correspondantes.

BATTERY REPLACEMENT STATEMENT IN EUROPE

Your Stir It Up Wireless includes a rechargeable battery designed to last the lifetime of the product. In the unlikely event that you should require a replacement battery please contact Customer Services who will supply details of the warranty and out-of-warranty replacement battery service.

BATTERY DIRECTIVE

 This symbol indicates that batteries must not be disposed of in the domestic waste as they contain substances which can be damaging to the environment and health. Please dispose of batteries in designated collection points.

WEEE EXPLANATION

 This marking indicates that this product should not be disposed with other household wastes throughout the EU. To prevent possible harm to the environment or human health from uncontrolled waste disposal, recycle it responsibly to promote the sustainable reuse of material resources.

Hereby, FKA Brands Ltd, declares that this radio equipment is in compliance with the essential requirements and other relevant provisions of Directive 2014/53/ EU. A copy of the Declaration of Conformity can be obtained from www.thehouseofmarley.co.uk/declaration-of-conformity

