



Electro ElitePro 2

TRUE WIRELESS EARBUDS

User manual

Package contents

- Electro ElitePro 2 Earphones unit
- Charging travel case
- USB to USB-C Charging cable
- User manual

SAFETY NOTICE

- KEEP AWAY FROM WATER OR DAMP CONDITIONS.
- DO NOT INSERT FOREIGN ITEMS INTO THE CHARGING PORT OF THE CHARGING CASE. ONLY USE A CORRECT USB TYPE C CABLE.
- KEEP AWAY FROM CHILDREN. THIS IS NOT A TOY.
- DO NOT USE WHILE DRIVING.
- DO NOT OPEN OR DISASSEMBLE THE CHARGING CASE OR AIR BUDS.
- KEEP AWAY FROM OPEN FLAMES.

1. Power ON

The earphones will automatically turn on when removed from the charging case.

You can remove one or both the earphones to begin using.

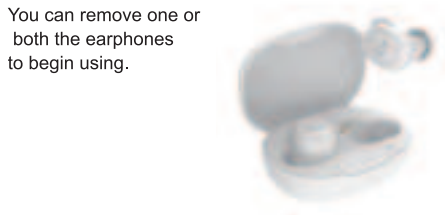

Pairing

The earphones will pair automatically to each other when removed from the charging case.

If it does not pair, put inside the charging case for five seconds and try again.

2. Bluetooth connection

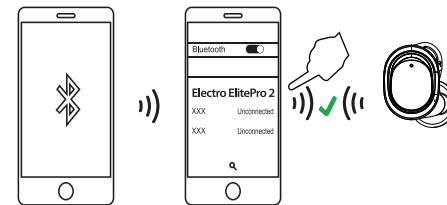

Turn on the Bluetooth function on your device.

Select **Electro ElitePro 2** from the list of available devices.

You will hear an audible notification to confirm that your the device is paired.

Note: Your **Electro ElitePro 2** earphones will automatically connect to this device the next time you use them.

3. Charging

Earphones

The earphones will automatically charge when inserted inside the charging case.

Fully charge the case charging and earphone before using for first time.

Charging Case

There is a USB-C - USB cable in the packaging. Connect it to the USB-C charging port ant the other end into a USB power source to charge your case.

To reduce the risk of injury :
Keep batteries out of reach of children.
Do not heat, open, or dispose of battery pack in fire.
Do not allow metal objects to touch the battery on the device.
Do not expose battery pack to excessive heat.

4. Turn Off

Insert the earphones inside the charging case and close it, automatically turn off.

5. Answer Phone calls

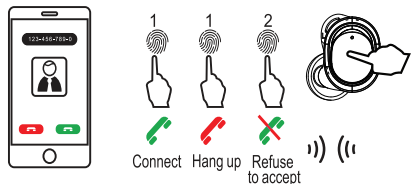

When there is an incoming call:

Answer / Hang Up

Tap left or right earphones once to answer the call.
Tap left or right earphones again to hang up.

Reject

Press and hold left or right earphones for 2 seconds reject the call.

5. Music control

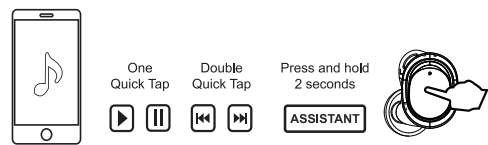

Play/Pause music.

When listening to music. Quick tap the left/right earphones to play or pause the music.

Previous /Next Song

When listening to music.

Quick two tap left earphones to previous song.

Quick two tap right earphones to next song.

Volume +/-

Tap left earphones three times to decrease the volume.

Tap right earphones three times to increase the volume.

Voice assistant

Press and hold left or right earphones for 2 seconds to activate voice assistant.

Troubleshooting

If your earphones are not working properly, try the following:

- Make sure they are fully charged.
- Make sure your Bluetooth device are turned on
- Make sure your Bluetooth device is within range and that there are no barriers between your device and the earphones
- IF you want to use only one earbud at a time, please make sure the other earbud is in the charging case

Technical Details

Chipset: JL6983

Bluetooth version: V5.4

Operating Distance: 10M

Charging case: 200mAh

Earphones:30mAh

Working Time: About 4h per charge time

Total about 15 hours

FCC Warning:

This equipment has been tested and found to comply with the limits for a Class B digital device,pursuant to part 15 of the FCC Rules. These limits are designed to provide reasonable protection against harmful interference in a residential installation. This equipment generates, uses and can radiate radio frequency energy and, if not installed and used in accordance with the instructions, may cause harmful interference to radio communications. However, there is no guarantee that interference will not occur in a particular installation. If this equipment does cause harmful interference to radio or television reception, which can be determined by turning the equipment off and on, the user is encouraged to try to correct the interference by one or more of the following measures:

- Reorient or relocate the receiving antenna.
 - Increase the separation between the equipment and receiver.
 - Connect the equipment into an outlet on a circuit different from that to which the receiver is connected.
 - Consult the dealer or an experienced radio/TV technician for help.
- Caution: Any changes or modifications to this device not explicitly approved by manufacturer could void your authority to operate this equipment.
This device complies with part 15 of the FCC Rules. Operation is subject to the following two conditions:
(1)This device may not cause harmful interference, and (2) this device must accept any interference received, including interference that may cause undesired operation.
This equipment complies with FCC radiation exposure limits set forth for an uncontrolled environment. This equipment should be installed and operated with minimum distance 0cm between the radiator and your body.

myelectronicworldusa.com



Go Green with Electronic world
This package is made of recyclable material.
Please put this package in a container marked with a "recyclable" symbol, when it is no longer needed.