

D1 User Manual

The LinkTap Wireless Water Timer is designed for private use in domestic gardens to control sprinklers and watering systems through the LinkTap app. The LinkTap's device must not be used for industrial purposes or in conjunction with chemicals, dirty water, or easily flammable and explosive substance.

 **Use 4 AA alkaline or 1.5V lithium batteries (not included). Good quality 1.5V Li-ion rechargeable batteries can also be used. Do not use carbon-zinc batteries.**

 **Remove the timer from the faucet during freezing weather and store inside.**

 **Timer should not be submerged in water, used in damp pits or buried.**

Installation

Step 1:

Connect LinkTap Gateway to a LAN port of your home broadband modem (or a network switch, a router, a hub, a Wi-Fi extender) using the supplied ethernet cable. Power on the Gateway using the supplied USB cord and power adapter. 3 solid green LEDs (Power, Link and Internet) indicate that the Gateway has connected to the LinkTap cloud server. This process may take up to a few minutes.

i To reduce possible interference, please place the Gateway over 30cm (or 1 foot) away from any power sockets and/or other electronic devices. Tip: Placing the Gateway at a higher location will usually increase the wireless coverage.

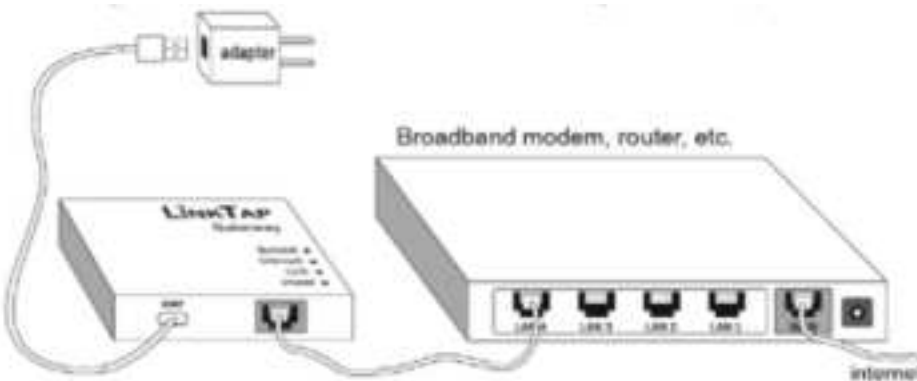

Step 2:

Register the Gateway through LinkTap free mobile app or web app. When the registration is completed, the Synced LED on the Gateway will turn solid green.

Scan QR code to install
LinkTap mobile App



or visit <https://www.link-tap.com/signin> for web App

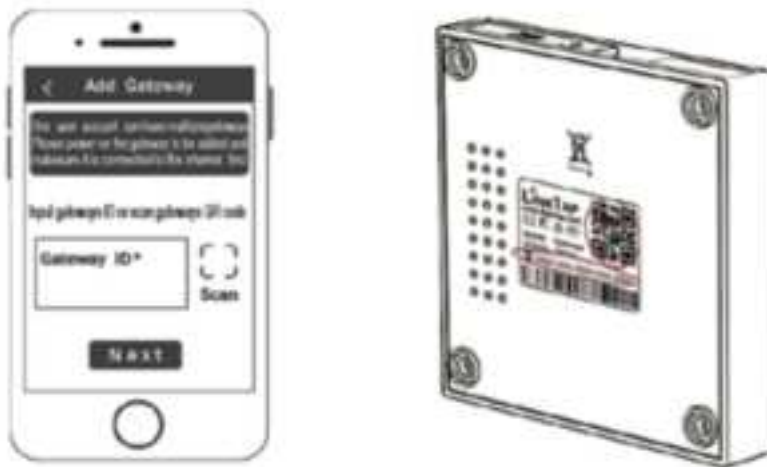

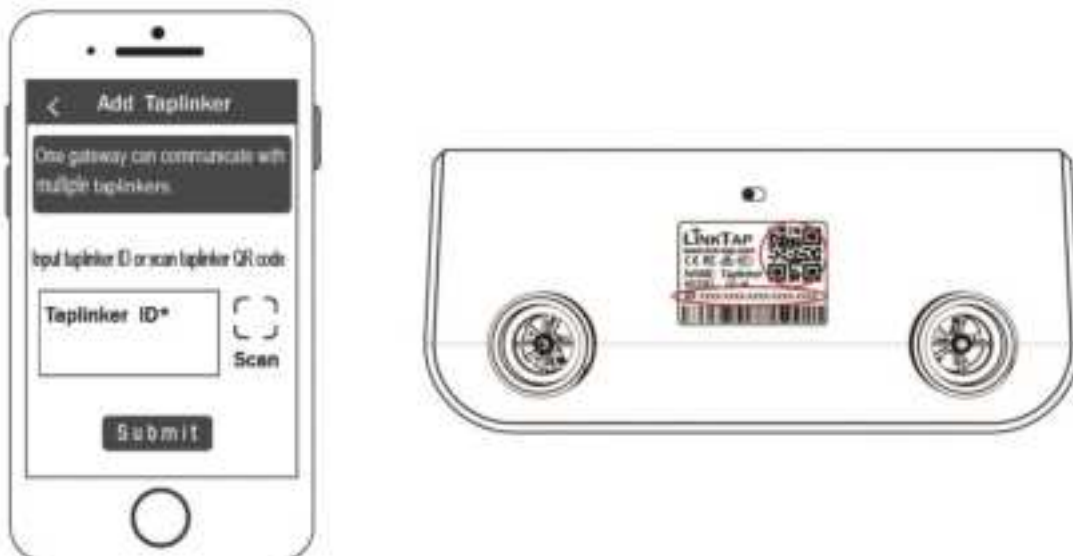

Step 3:

Add a new **D1** TapLinker (i.e., **D1** wireless water timer) through LinkTap app. there will be 2 or 4 ValveLinkers displayed on the app, and each of the ValveLinkers can be controlled independently.



Step 4:

Insert 4 AA alkaline batteries into the TapLinker in the correct orientation and switch it on. The TapLinker will automatically connect to the Gateway in 5~60 seconds, as indicated by 2 solid green LEDs ( and ). These 2 LEDs will go off after being solid green for 15 seconds to save power.

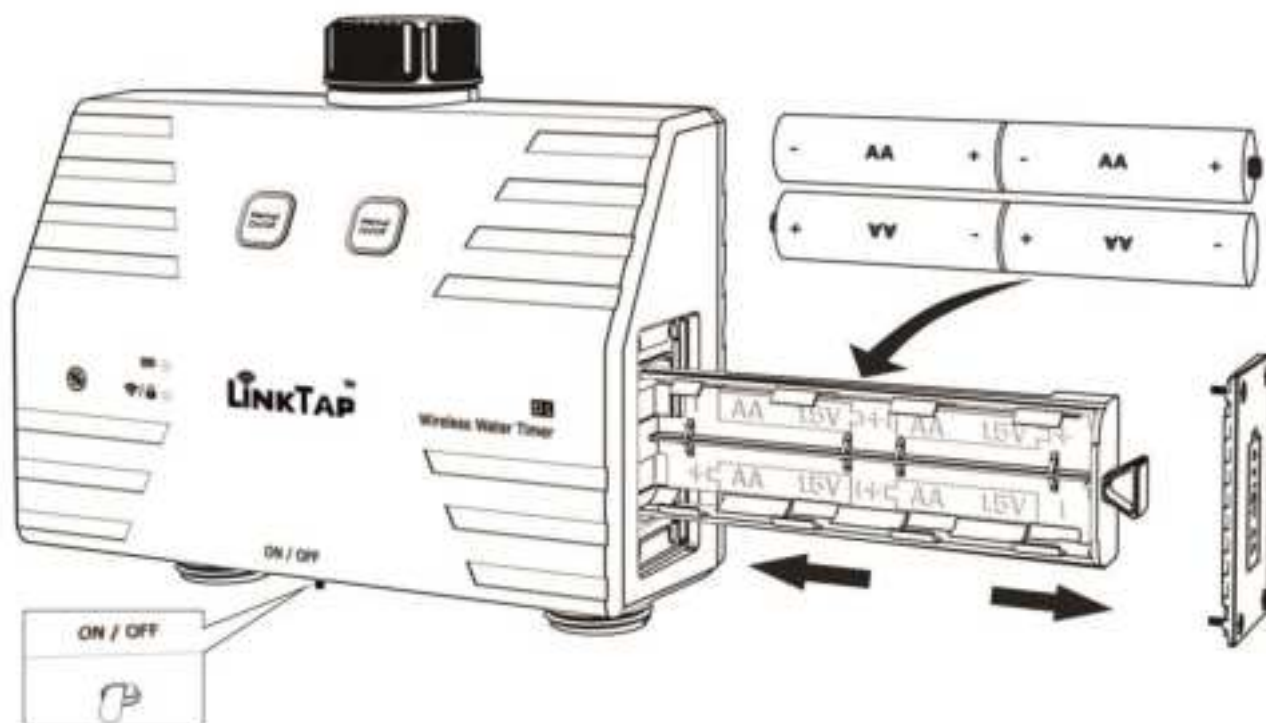

The LinkTap **D1** water timer contains an inclination sensor to detect changes in the tilt angle of the device. If the angle change exceeds a certain threshold, the system will register that the water timer has fallen off the faucet. You can verify the fall detection and notification process of your LinkTap water timer by following the steps below.

- 1) On the Device Details page, check if “TapLinker fall alert” has been disabled. If not, disable it.
- 2) **Place the watering timer upright on a desktop**, then enable the “TapLinker fall alert” in the app.

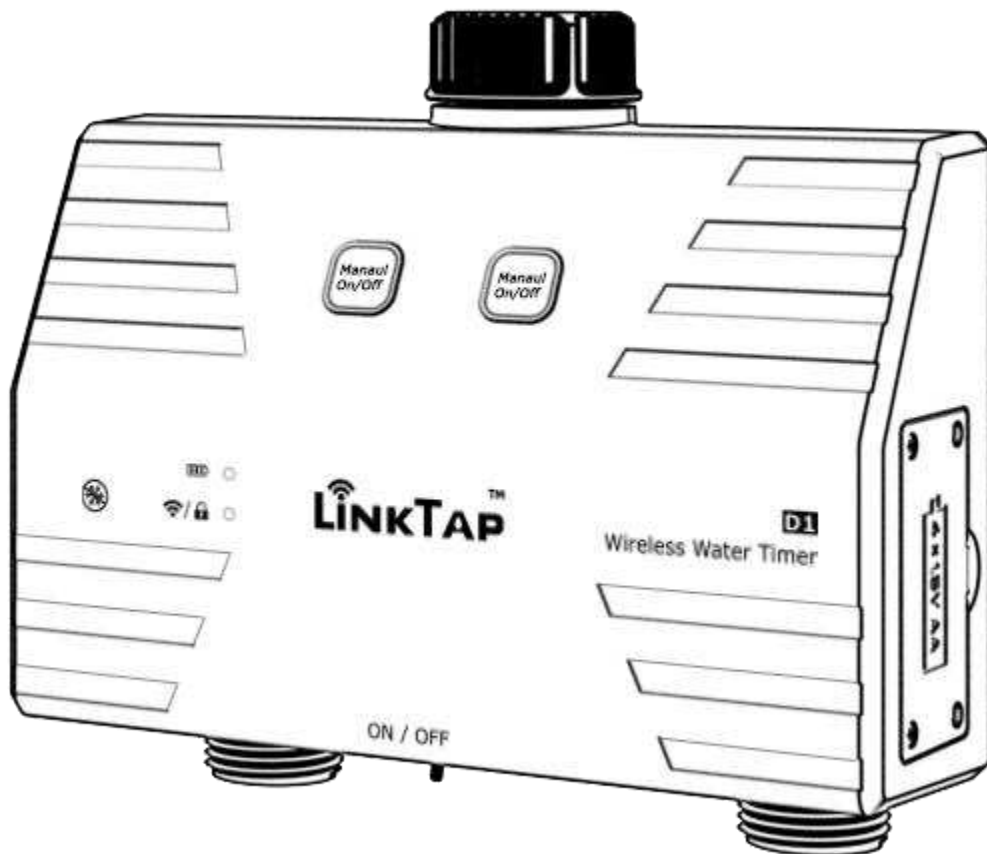

3) Lay the watering timer flat on the desktop. Within 45 seconds, you should receive a TapLinker fall alert on your phone.

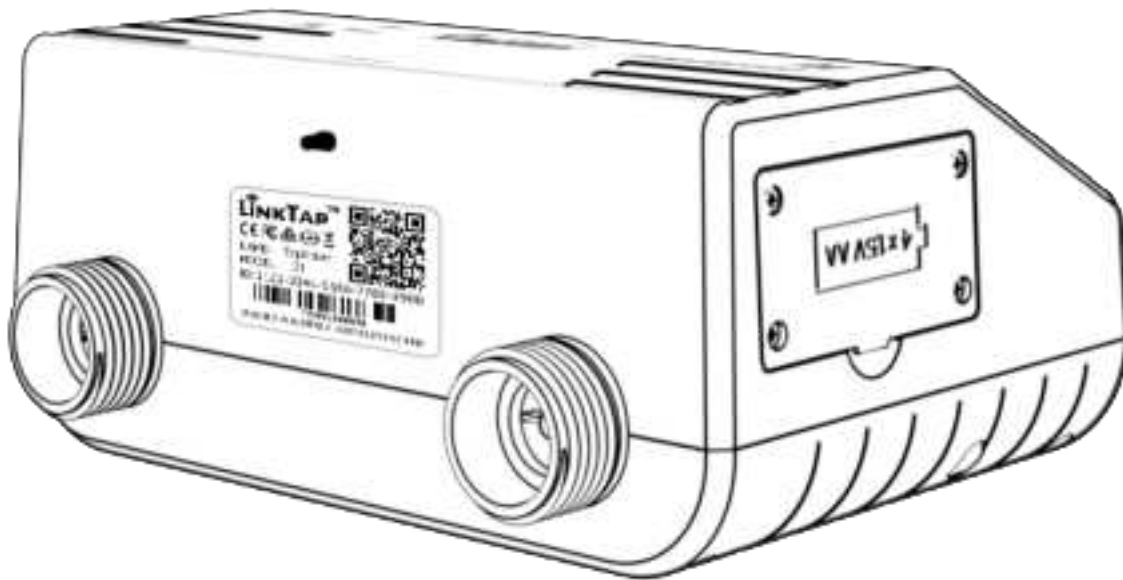

4) Disable the “TapLinker fall alert” in the app to continue the product installation process.

Step 5:

Screw the TapLinker to your garden tap firmly by hand to prevent leaks.

At this point, you can verify the water cut-off detection and notification process by following the steps below:

- 1) Enable "Water cut-off alert" on the app;
- 2) Turn off the faucet completely and make ensure that no water flows out of the faucet;
- 3) Press the Manual On/Off button on the device, or activate Instant mode on the app to start watering.

Within 45 seconds, you should receive a water cut-off alert on your phone.

Manual Watering

Press the blue Manual On/Off button once to start or stop watering. You can also disable, partially enable or fully enable the Manual button lockout function through the app.

Step 6:

Enable all fault alert options on the app. You can now remotely access your wireless water timer with peace of mind!

About the fault detection function:

Your LinkTap water timer contains an inclination sensor and a flow meter sensor. Apart from being able to measure flow rate in real time, the device can detect the following faults in a real time manner and then send push notifications and emails to you and your nominated person, e.g. neighbor, friends, etc.

- 1) The water timer falls off the faucet;
- 2) The water timer failed to shut down the watering properly;
- 3) The water timer failed to open the valve properly;

- 4) The mains water is turned off, causing no water come out of the water timer;
- 5) The water flow rate abnormally increases or decreases.

The real-time push notifications will be sent to all your smartphones and tablets with the LinkTap app installed, and an email will be sent to your registered email address and two other email addresses. You can use email address of your neighbors, friends, family members, or colleagues, so that when a fault occurs but you are unable to handle the failure in time for some reason, they can help you out.

 When a fault occurs, in order to avoid false positives, the system will make multiple measurements, so sending out real-time push notifications and emails will be delayed by 10 to 45 seconds. Similarly, when the flow rate changes, the current flow rate value won't be shown on the app until 10 to 30 seconds later.

Specifications

Operating water pressure range: 0.02-0.8MPa or 2.9-116 psi

Watering cycles per day: up to 100

Watering duration per cycle: 3 seconds to 23 hours 59 minutes

Temperature of water flow: 1°C to 40°C

Flow meter measurement range: 2 to 50 L/min with a measurement error of $\pm 5\%$

Wireless water timer power: 4 AA alkaline or 1.5V lithium batteries

Gateway power input: 5V DC, 1A

Wireless technology: Zigbee

Wireless transmission distance: up to 800m *

Wireless operating spectrum: 2.4GHz ISM

Network security: 256-bit encryption

Max. number of TapLinkers per Gateway: 15

Max. number of Gateways per user account: 6

***Actual ranges may vary depending on environmental conditions, building materials, etc. Wireless coverage claims are used only as a reference and are not guaranteed as each wireless network is unique.**

LinkTap App User Manual

Visit <https://www.link-tap.com/app-manual> or scan the QR code for the LinkTap app user manual.



Warranty

LinkTap guarantees the wireless water timer and gateway products for 2 years from date of purchase. This guarantee covers all serious defects of the device that can be proved to be material or manufacturing faults. Under warranty we will either replace the device or repair it free of charge if the following conditions apply:

- The device must have been handled properly and in keeping with the requirements of the operating instructions.
- Neither the purchaser nor a non-authorised third party have attempted to repair the device.

- Faults which occur as a result of incorrectly installed or leaking batteries or using third party power adapter & USB cord are not covered by the warranty.
 - Damage caused by frost is not covered by the warranty.
-

Disclaimer

LinkTap has done its utmost to ensure that the fault detection & notification function works reliably. However, due to various factors in real world (e.g., network delay or interruption, equipment failure, battery quality problems, improper use of the device, etc.), there is still an extremely low chance of false positives or false negatives. LinkTap and its designated agents are not liable for any possible loss caused by false positives or false negatives.

FCC Statement

Changes or modifications not expressly approved by the party responsible for compliance could void the user's authority to operate the equipment.

This equipment has been tested and found to comply with the limits for a Class B digital device, pursuant to Part 15 of the FCC Rules. These limits are designed to provide reasonable protection against harmful interference in a residential installation. This equipment generates uses and can radiate radio frequency energy and, if not installed and used in accordance with the instructions, may cause harmful interference to radio communications. However, there is no guarantee that interference will not occur in a particular installation. If this equipment does cause harmful interference to radio or television reception, which can be determined by turning the equipment off and on, the user is encouraged to try to correct the interference by one or more of the following measures:

- Reorient or relocate the receiving antenna.
- Increase the separation between the equipment and receiver.
- Connect the equipment into an outlet on a circuit different from that to which the receiver is connected.
- Consult the dealer or an experienced radio/TV technician for help

This device complies with part 15 of the FCC rules. Operation is subject to the following two conditions (1) this device may not cause harmful interference, and (2) this device must accept any interference received, including interference that may cause undesired operation.

This equipment complies with FCC radiation exposure limits set forth for an uncontrolled environment. This equipment should be installed and operated with minimum distance 20cm between the radiator & your body.