

# Circular fingerprint code lock

## Installation Guide/Programming Instructions

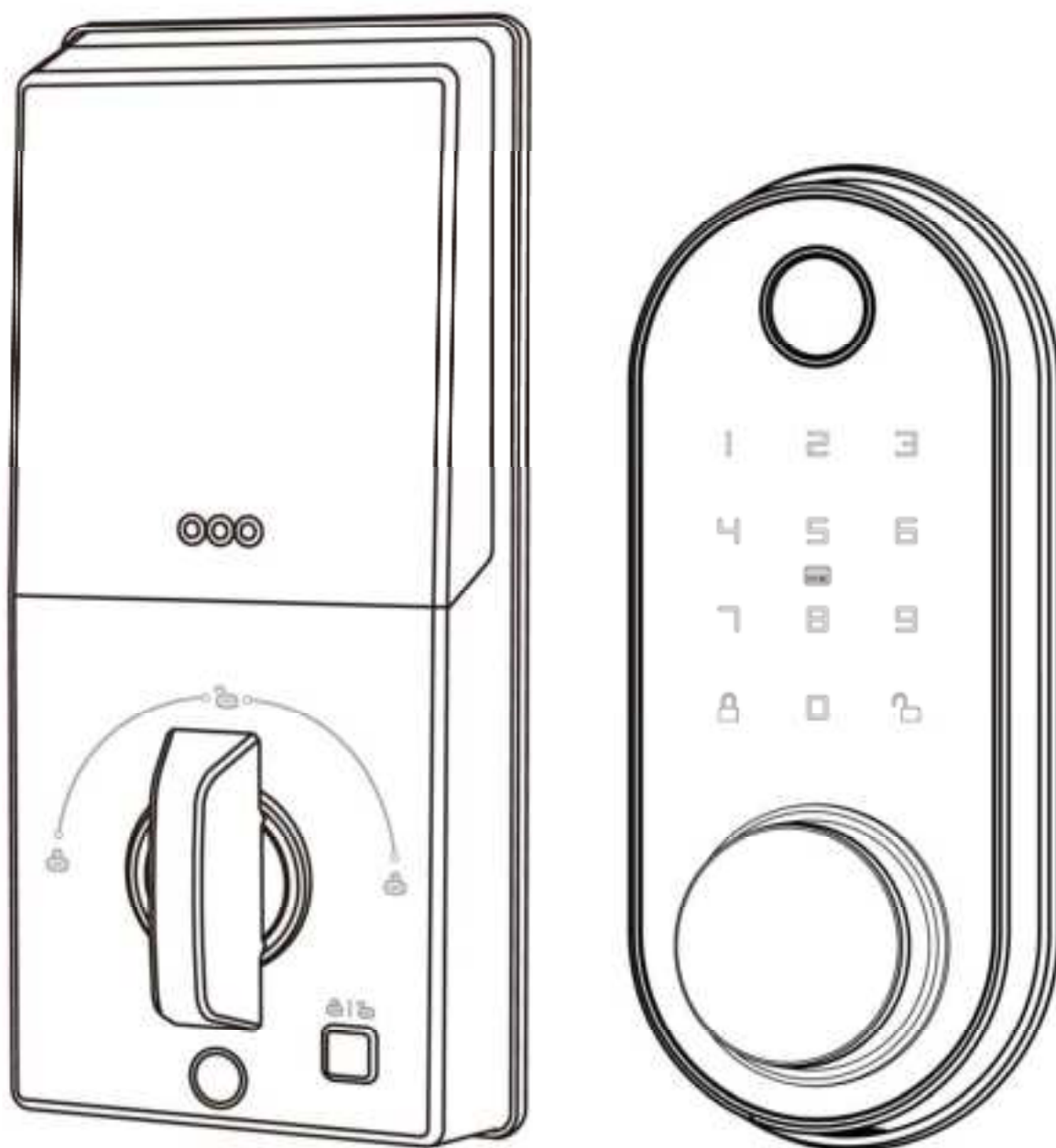

Thank you for purchasing our products. Please review this manual thoroughly before operating your device. All pictures in this manual are for illustration purpose only. Actual product may vary due to product upgrade.

# NOTE:

Please register a administratorpassword first!  
You cannot change anysetting without  
administrator passwordAny fingerprint can  
unlock the doorlockwhen there is no  
administrator passwordin the doorlock,  
even ifno fingerprint hasbeen registered.

# Installation Overview

Please read this manual carefully before installation and operation!

---

**TOOL REQUIRED:**  
Do not use an electric screwdriver  
during installation.

P3	
P4	STEP1.Check accessories
P5	STEP2.Prepare the door and check dimensions
P6	STEP3.Install the latch and buckle box
P7	STEP4.Install exterior assembly
P8	STEP5.Install interior assembly

## PROGRAMMING INSTRUCTIONS

---

P9	Function demonstration
P10	Product parameters
P11	How to use the door lock
P12	Definitions
P13	How to program
P14	Programming step 1.App downloads and accounts
P15-18	Programming step 2.App usage method
P19	Programming step 3.How to delete admin and user
P20	Programmingstep 4.Fast programming
P21	roubleshooting
P22	Information & Safety Warnings

# INSTALLATION OVERVIEW

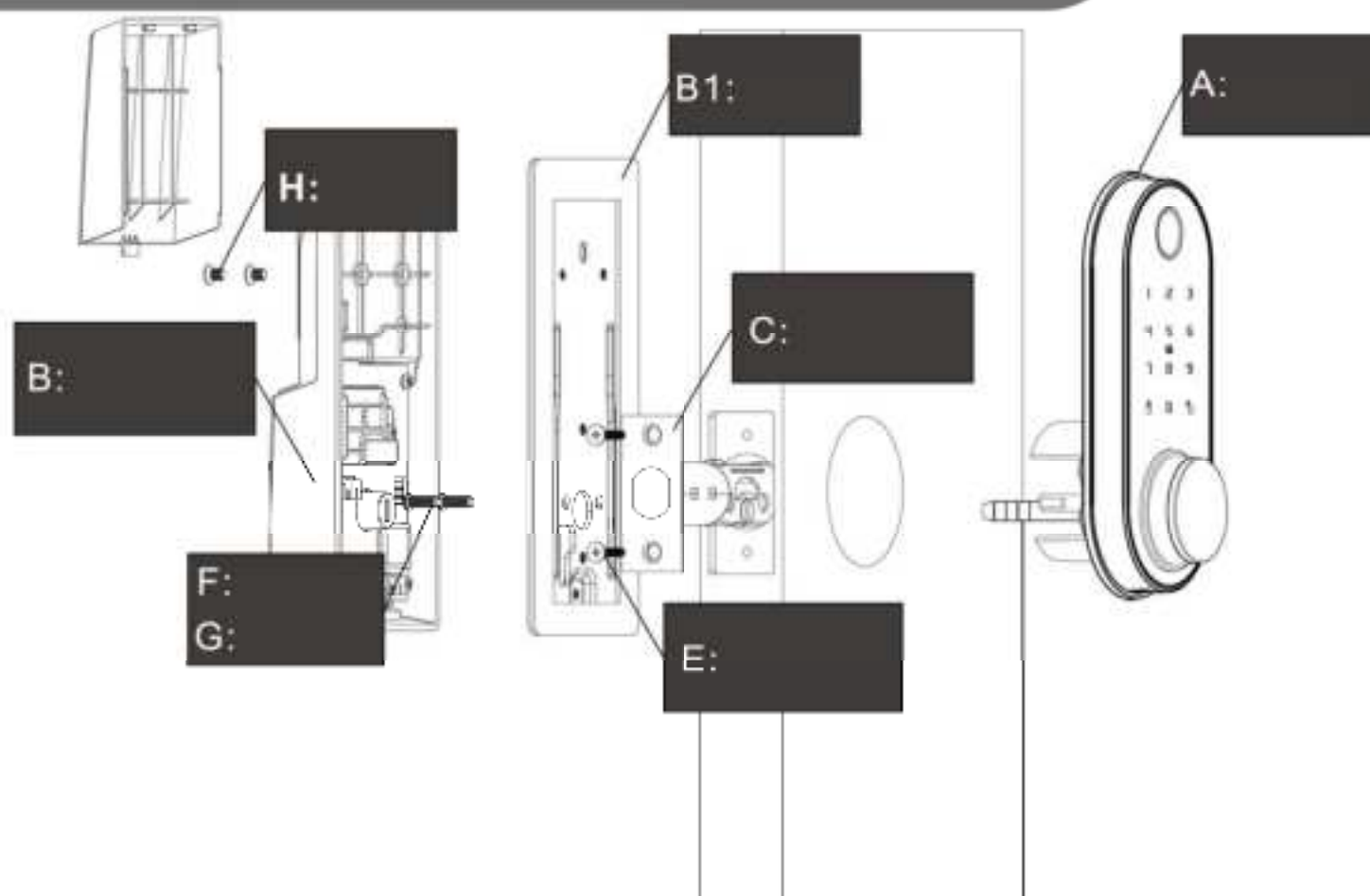

## Step 1 Check accessories

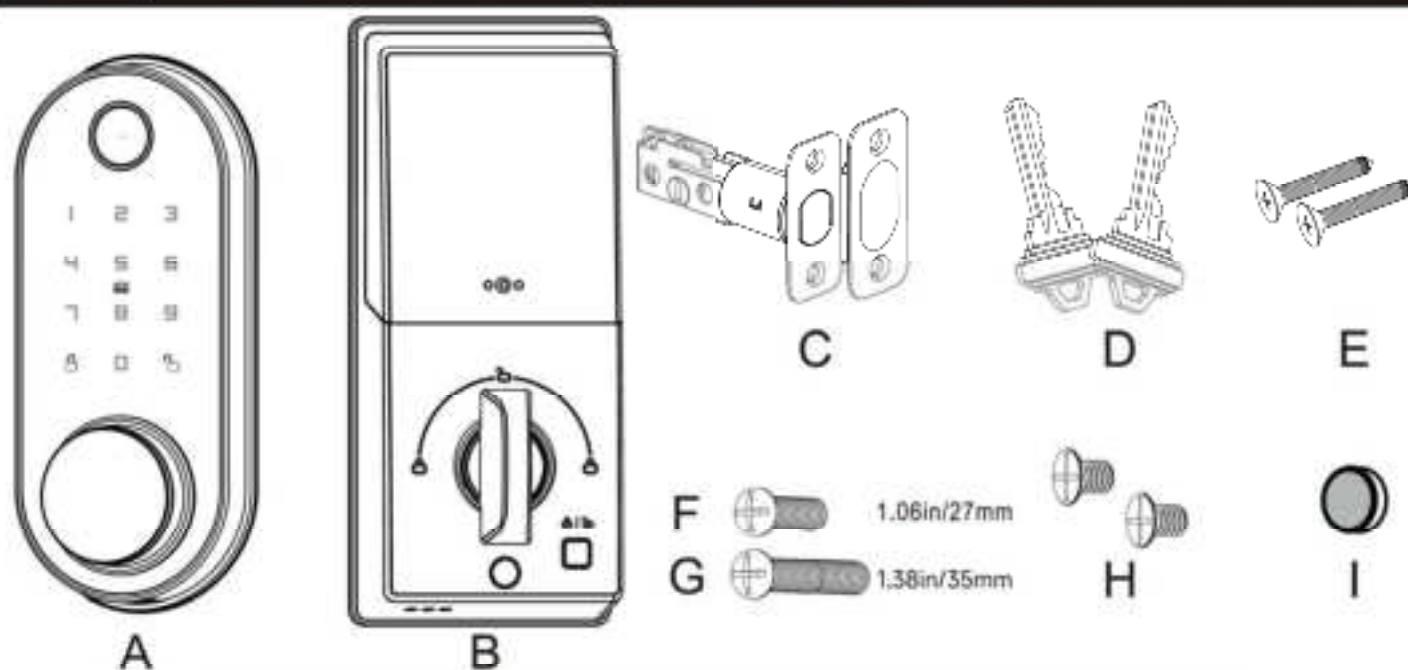

Please make sure that all parts are included when unpacking the product.



## STEP2 . Prepare the door and check dimensions

**A:** Measure to confirm that the hole in the door is 2-1/8" (54mm).  
Measure to confirm that the hole in the door edge is 1" (25mm).

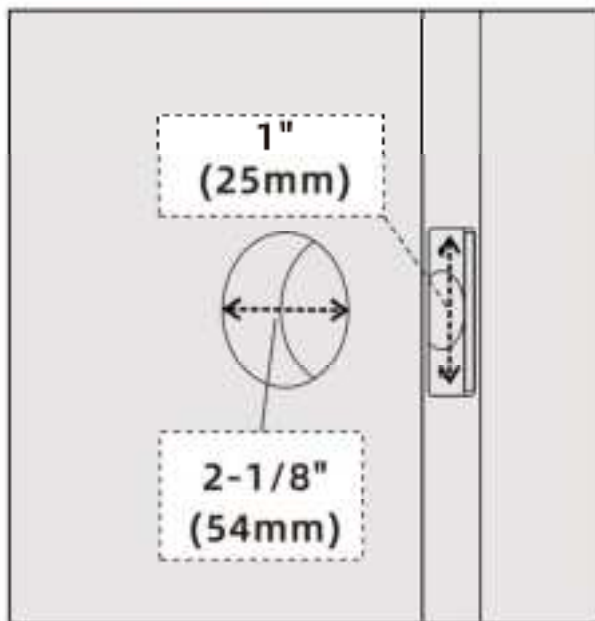

**B:** Measure to confirm that the backset is either 2-3/8" or 2-3/4" (60 or 70mm)

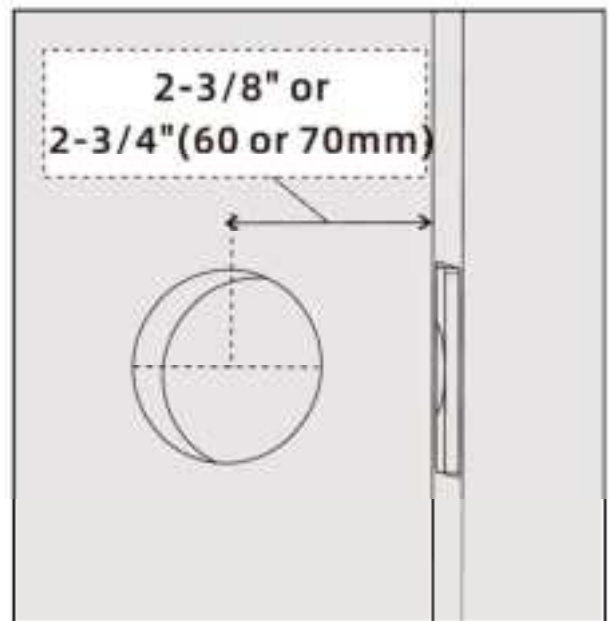

**C:** Measure to confirm that the door is 1-3/8" to 2" (35 mm or 50mm) thick.

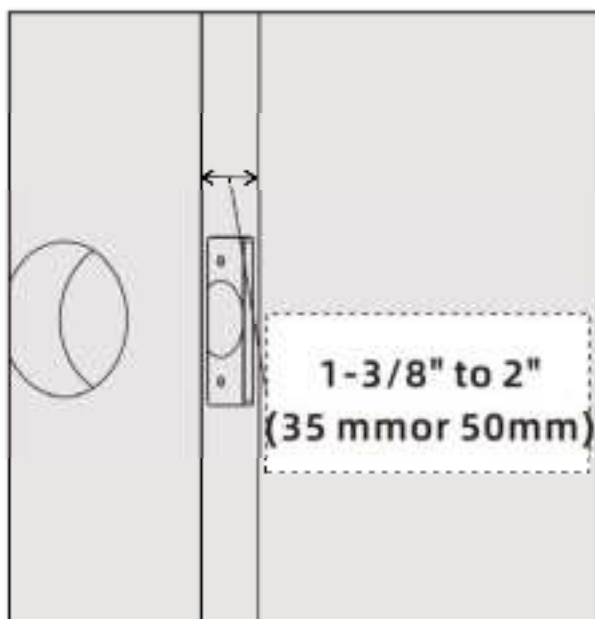

**D:** Make sure the hole in door frame is drilled a minimum of 1" (25mm) deep.

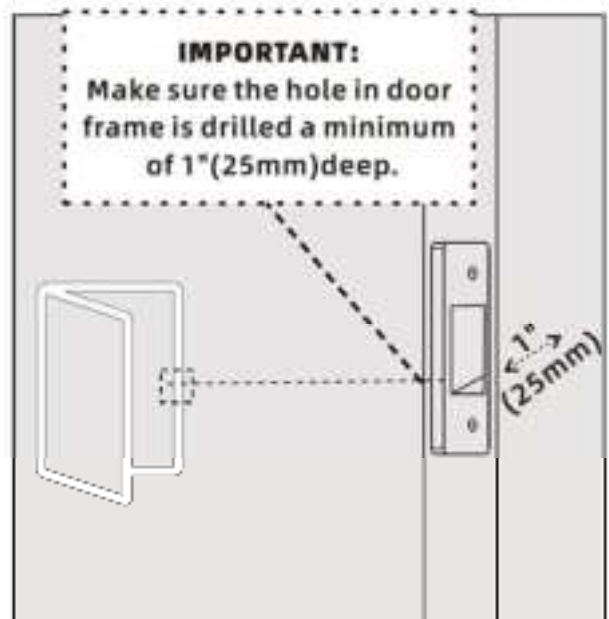

## STEP3 . Install the latch and buckle box

**A:** Adjust the latch to 60mm or 70mm according to the position of the hole in the door

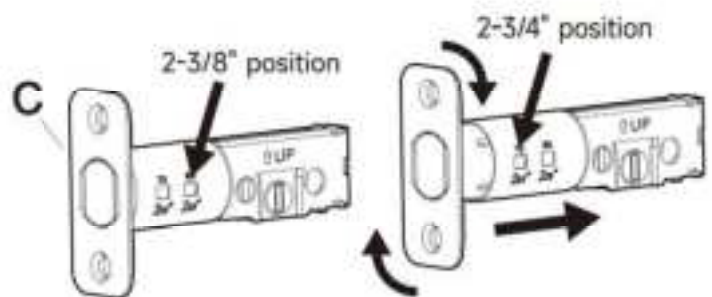
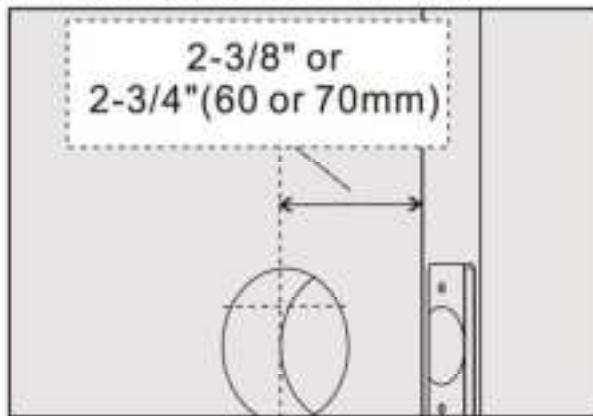

**B:** Secure the latch (C) and buckle box (C1) to the corresponding holes in the opened door with 2\* tapping screws (E).

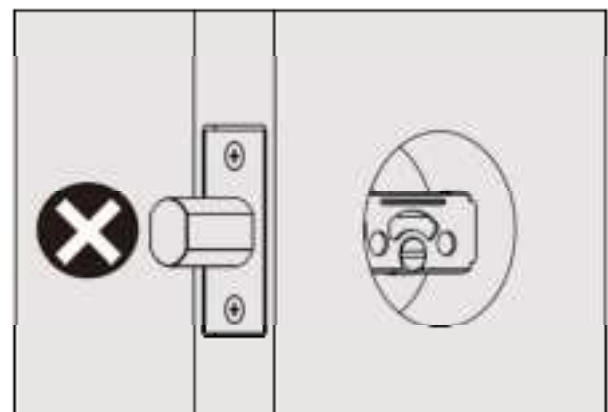
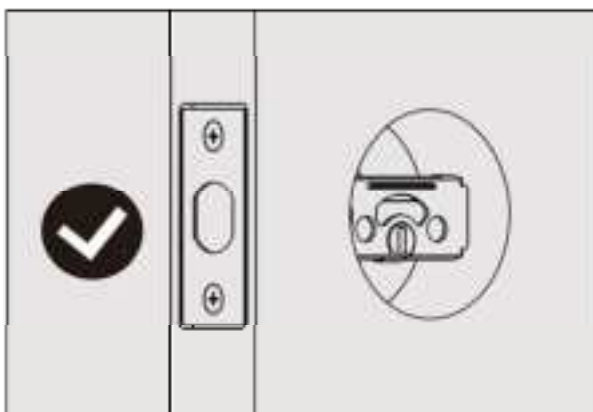
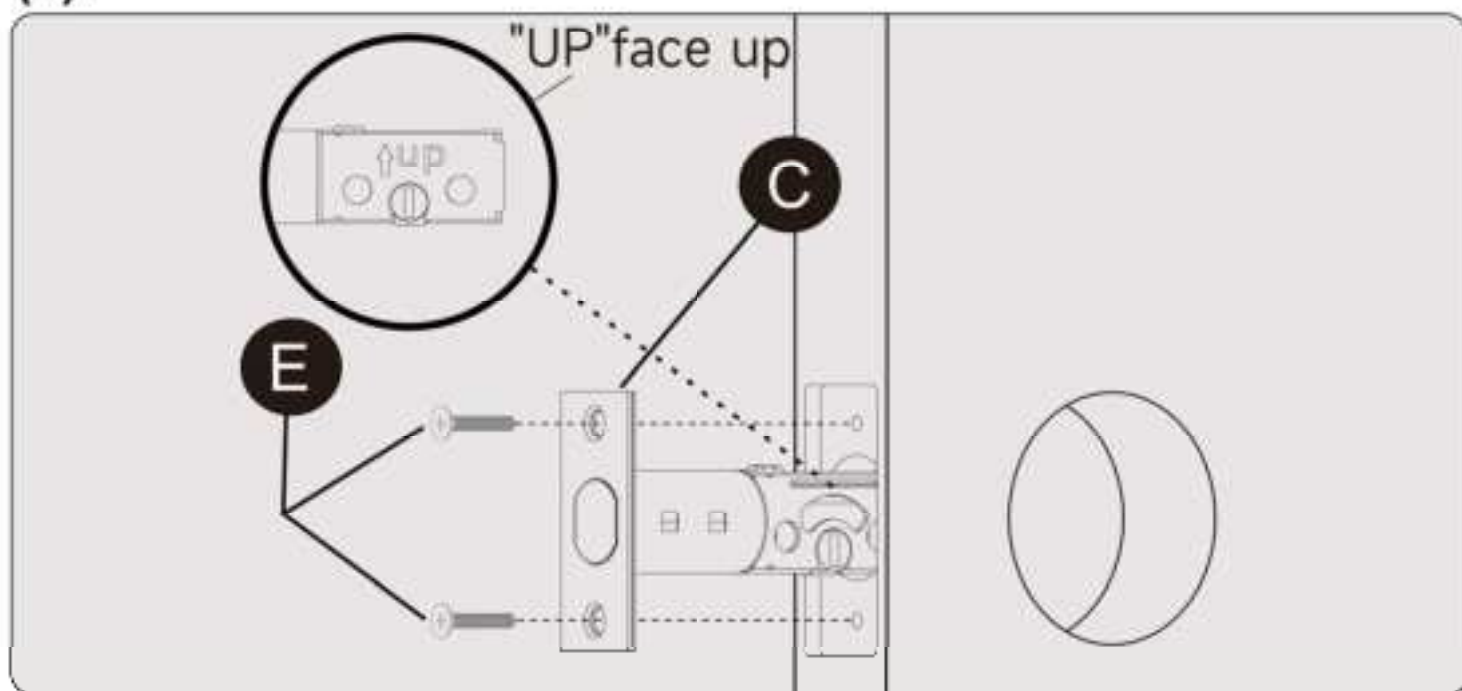

## STEP4.Install exterior assembly

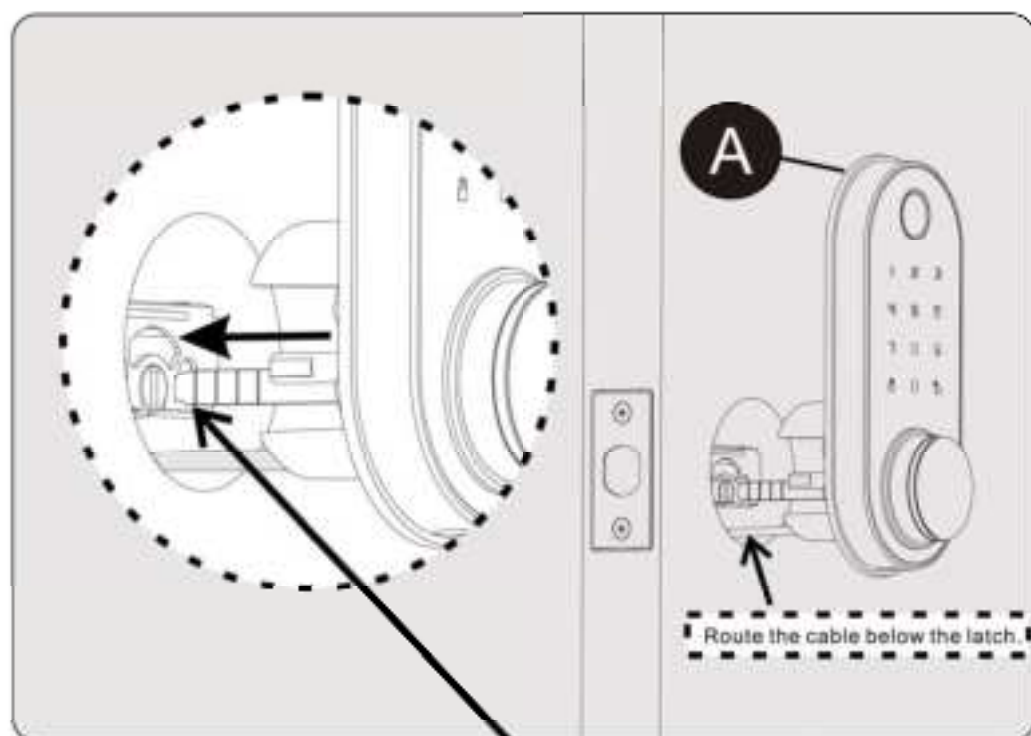

### **IMPORTANT:**

**Bolt must be in unlock position. Note  
Vertical orientation of torque blade**

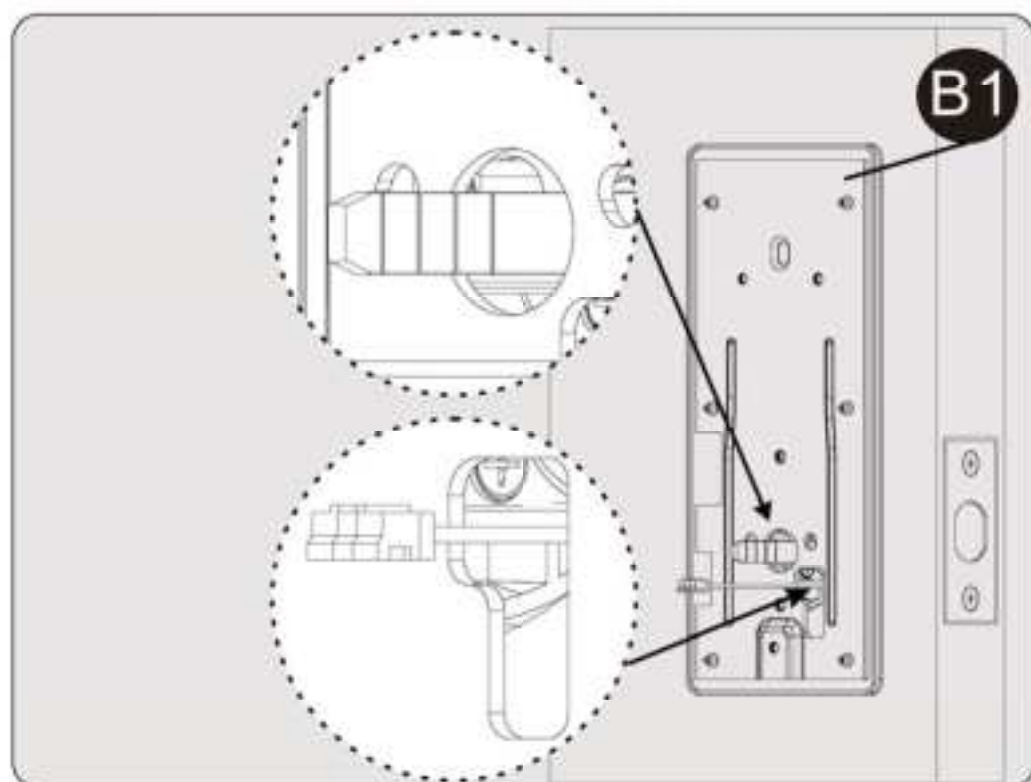

**Route the cable through the  
hole in the mounting plate.**

## STEP4.Install exterior assembly

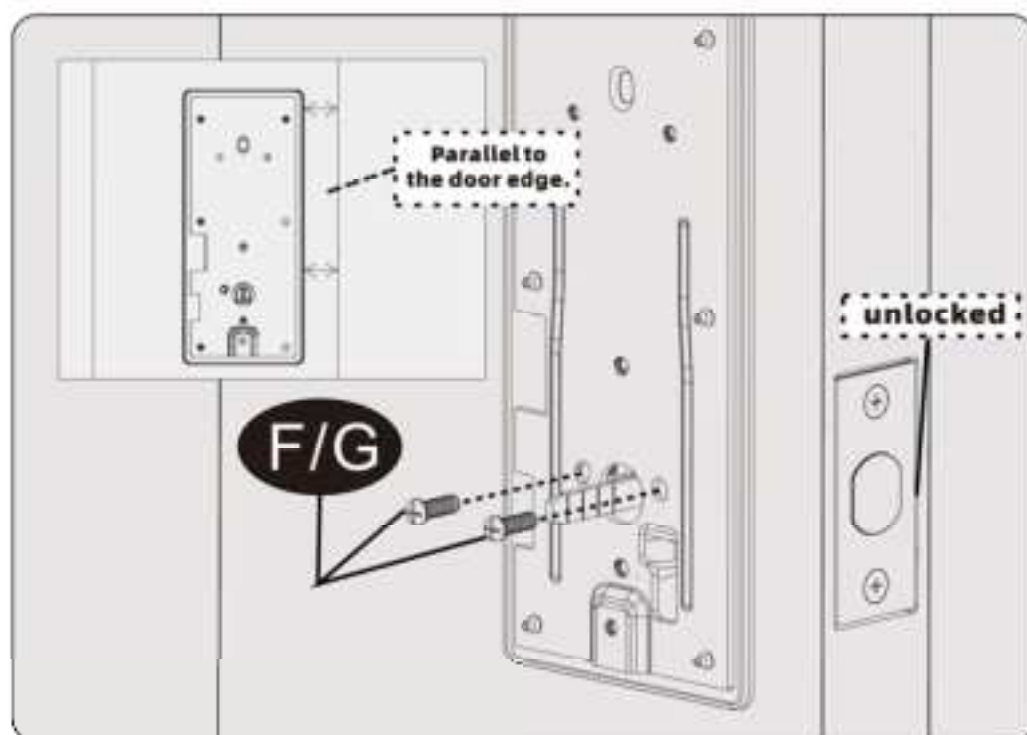

Secure the mounting plate with the supplied screws.

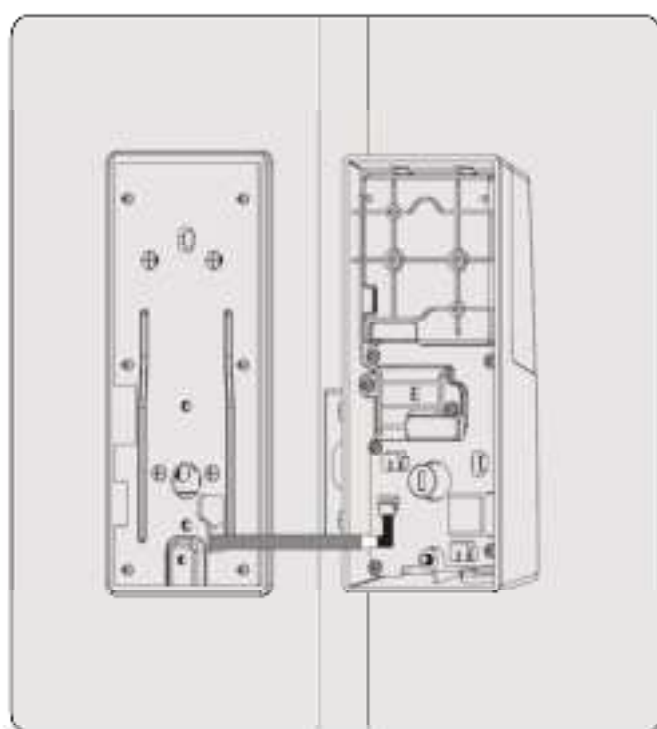

Connect the cable and ensure tight cable connection.

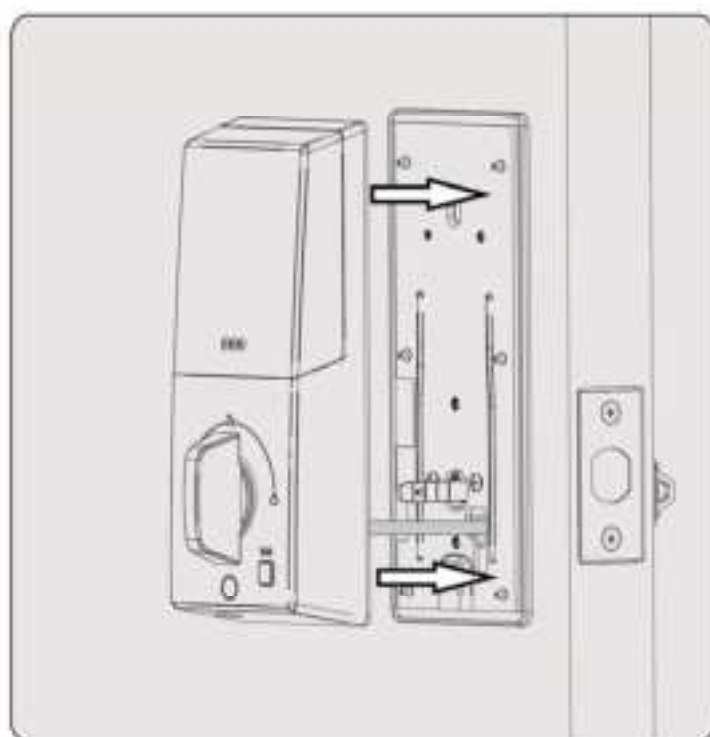

Rotate the Thumb turn in vertical position and insert the horizontal orientation of torque blade into the inside escutcheon.



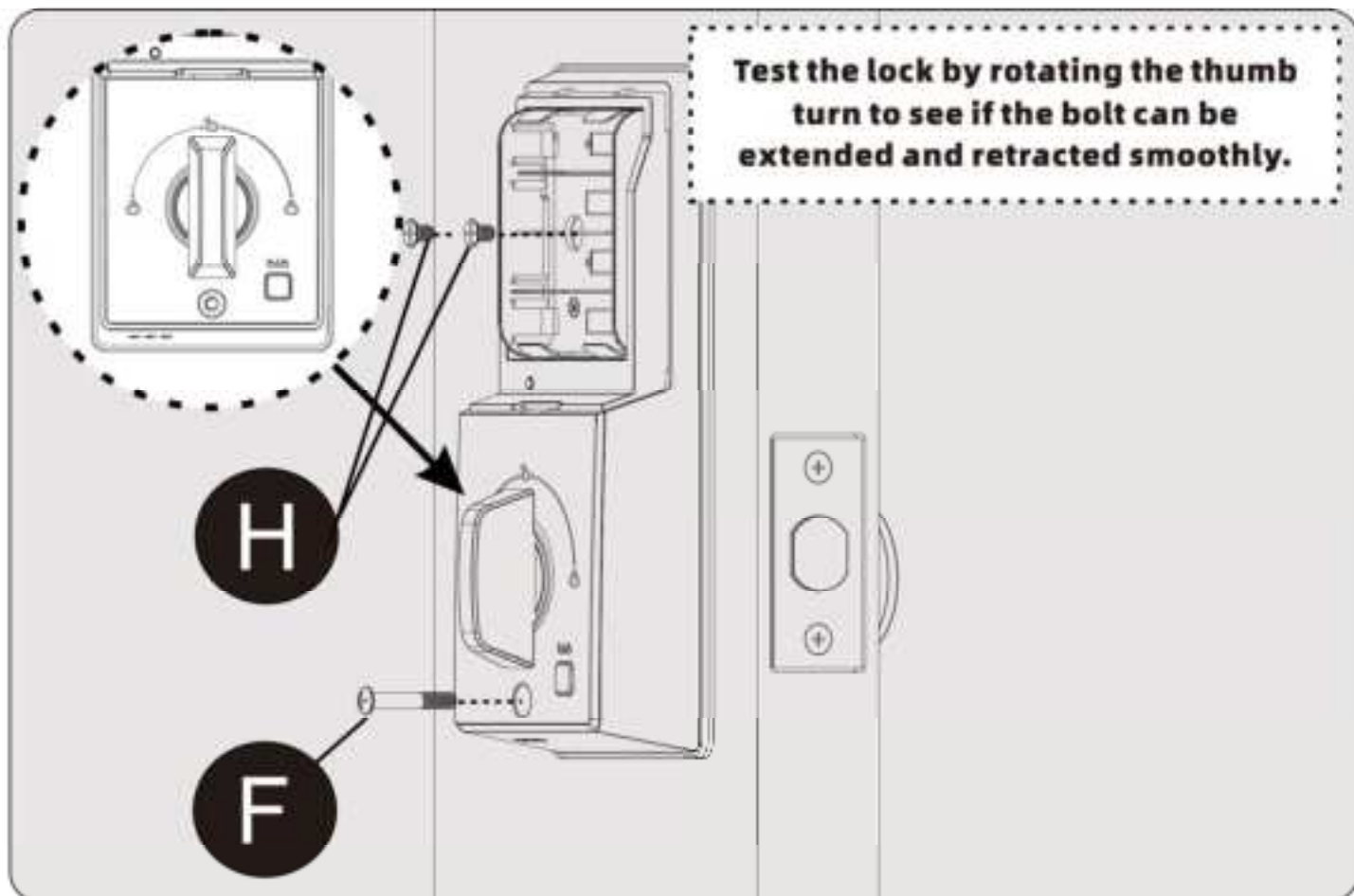

**Secure the interior assembly with the supplied screws.**

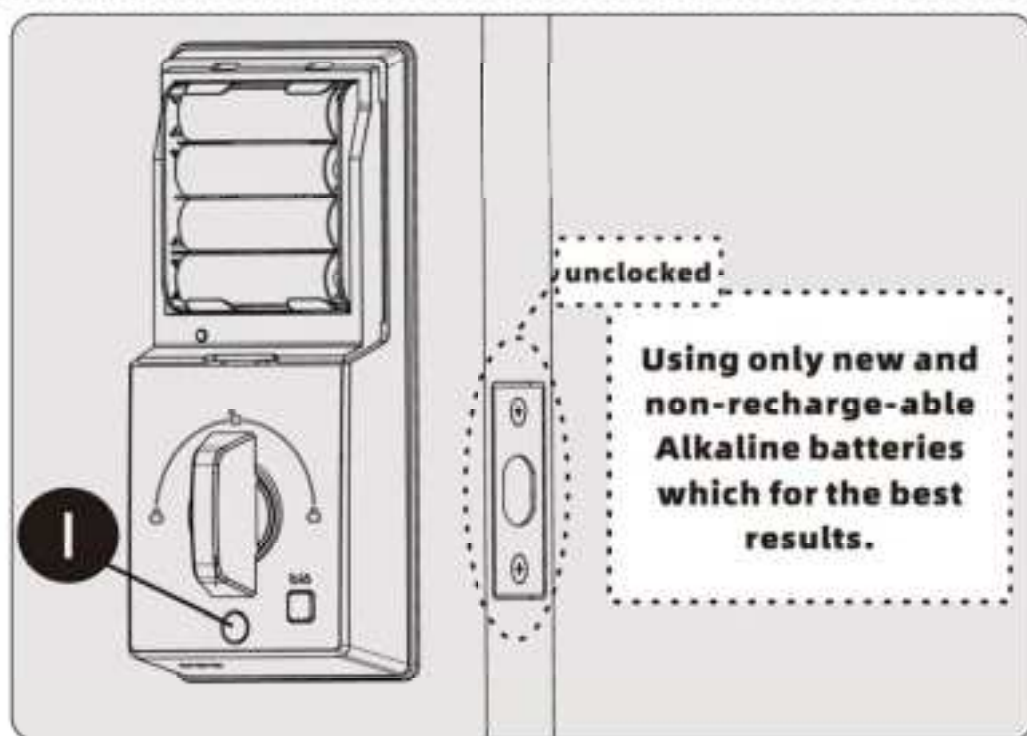

**While the door is open and unlocked, load 4 AA batteries into the interior assembly. And then the latch bolt will extend to learn the orientation of the door.**

# PROGRAMMING INSTRUCTIONS

## Function demonstration



## Product Specification

Name	Content
Unlocking method	Fingerprint, IC card (key FOB/card) Password, Tuya APP, Mechanical key
Password capacity	3 administrators and 47 general users
Power supply	4 AA alkaline batteries
Tips	Prompt of light and buzzer
Low voltage alarm	4.8V
Antistatic	Exposure+ / 8KV Air+ / 15KV
Standby current	<70uA
Dynamic power consumption	<200mA
Operating enviroment	-4°F/-20°C ~ +122°F/+50°C
Operating humidity	0%~95%
Applicable door thickness	1.38 IN/35 MM - 2.17 IN/55 MM

## Keyboard & Indicator Explanation

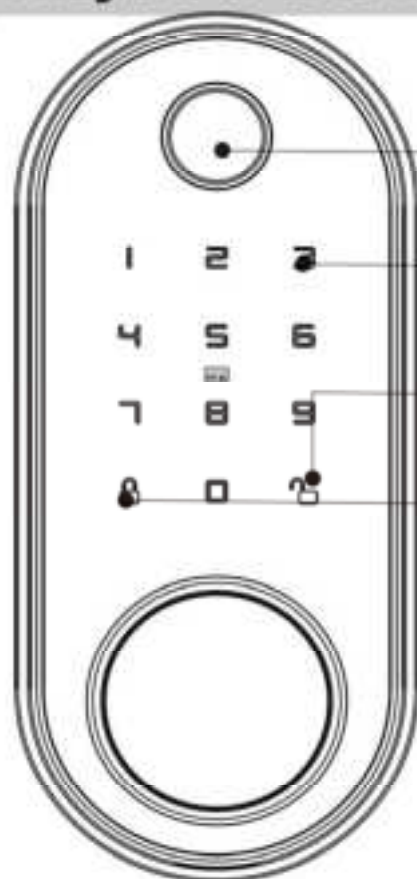

Fingerprint as status indicator  
Indication light of red and green state:  
Green light for success, red light for failure

Number Key  
Backlight: white

Confirmation and unlock key

Cancel and lock key

# How to use

---

## How to open the door

- a:** Enter a 6-10 bit master code or user code →  → Unlocked
- b:** Identify the user's fingerprint → Unlocked
- c:** Pull out the Key cover, rotate to find the keyhole, insert the key rotation → Unlocked
- d:** Tuya APP unlocks → Unlocked
- e:** Tuya APP unlocks → Unlocked
- f:** Turn the inside knob to unlock the door → Unlocked

## How to close the door

---

### **a:Auto Lock mode**

Lock automatically after 10 seconds

### **a:Manual Lock mode**

 **or** Tuya APP off lock

**Tip : Lock mode can be set on Tuya APP or door lock**



# Definitions

**IMPORTANT:**  
Factory mode, any 6-digit password and fingerprints can be unlocked, please set the administrator as soon as possible

- **Unlock mode**

Fingerprints, passwords, IC cards, keys, Tuya APP Bluetooth

- **Master Code**

Master code can be programmed and unlocked, factory state has not set the master code, please set and take good care of the master code before official use. Master code for the first set of 6-8-bit password, can be set on the phone or the door lock. The first phone to bind a door lock was also a door lock administrator.

- **User Code and fingerprint user**

It can only be used to pick locks.

- **Lock mode**

Can be set to automatic lock or manual lock mode, the factory state for automatic lock mode, unlock about 10 seconds after the door lock will be automatically closed. You can change the lock mode on the Tuya APP or on the door lock.

- **Silent Mode**

The beeping of a button can be muted. But you'll still hear low-battery alarms.

- **One Time User Code**

This code can only be used once and is automatically deleted after use. You can set it up on Tuya APP.

- **Low Battery Alarm**

After unlocking the lock in any way, you hear five "Drops" and a red light flashing, which is an alarm of low battery power. Please replace 4 brand new AAA alkaline batteries, do not mix old and new batteries.

- **Unlock with Fake code**

User can prevent pin code exposure from strangers by entering random digits before or after pin code.

46346--159245--78413  
.....  
Password  
.....Random digits.....

# How to program

---

## Overview of programming

- Programming methods

- a . Programming on Tuya App
- b . Program the door lock

**NOTE: Please register a administrator password first!**  
**Add the First Administrator Password**

**A.** Press and hold the reset button until hearing 2 beeps, then release the button, the lock will prompt "Add administrator"

**B.** Enter a 6 to 10 digits password, then press "🔑" to confirm, lock prompts "Please enter the new password again"

**C.** Enter the password again and press "🔑" to confirm, if the password is input correctly, the lock will prompt "Added successfully, number 000" with green light on, and the administrator is added. If you heard 3 beeps with the red light on, the operation failed and you need to repeat these steps.

**Note: You can add up to 3 administrator passwords or fingerprints, and the first 3 passwords or fingerprints added will be set as the administrator access and can be used to verify admin**

**D.** Has set the administrator code on the first lock, at this point the phone can not directly search for the lock. You will need to press "3" + "🔑" + "Set admin code" on the keypad of the door lock. The door lock will send out a paired signal. You can find the door lock by opening the Bluetooth and Tuya APP on your phone.

(it needs to be connected within two minutes, otherwise it will timeout. If the time exceeds 2 minutes, you need to over again)

## Overview of Door Lock programming

- a . Factory state administrator code for any 6-digit.
- b . If the lock and phone are already locked, set an administrator code on the APP, The first code set in the APP is the administrator code. Enter this code to access the lock settings.



# Programming step 1

## App downloads and accounts

### Download the APP and register the user

Search the APP market or scan the QR code to download the "Tuya" APP.



Scan the code to  
Download Tuya App



Turn on the Bluetooth function of your phone, open the Tuya app and register a user.

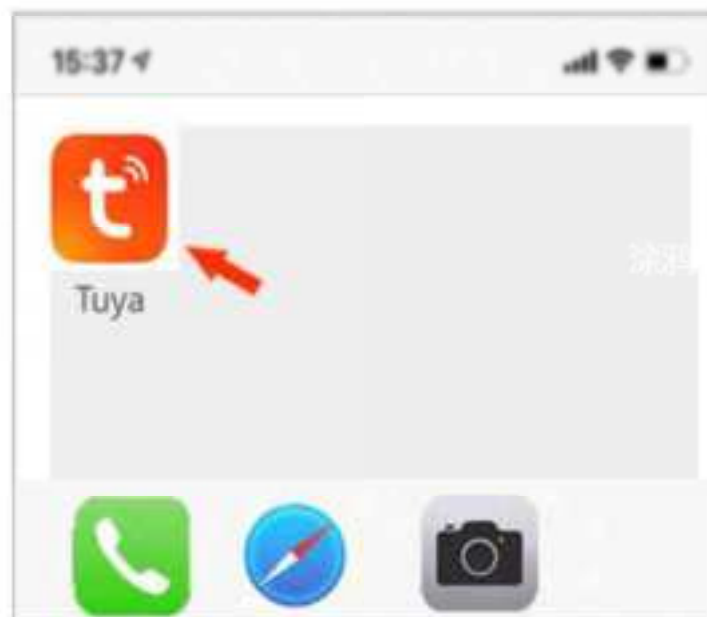

# Programming step 2

## App usage method

### Add a door lock (Turn on Bluetooth function on your phone)

Before adding any administrator, after opening the app, press 3 + unlock key + admin password and connect, as shown in Figure 1, or click "Add Device" as shown in Figure 2. Wait a few seconds and it will show up as shown in Figure 3. At the same time, the door lock will make a "whoosh" sound. Click "Next" to confirm, and then click "Finish" according to the interface shown in Figure 4. The door lock has been added successfully, and now the phone is the door lock manager.

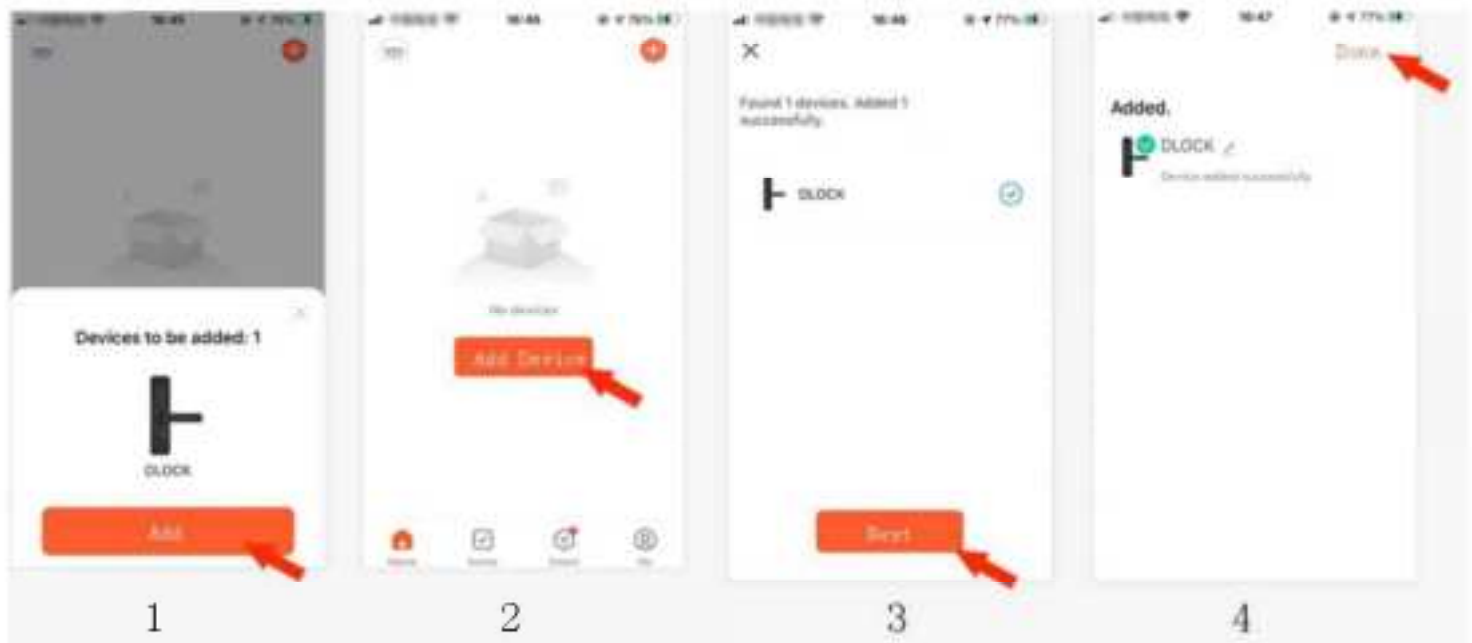

after opening the app, press 3 + unlock key + admin password and connect, as shown in Figure 1,



# Programming step 2

## App usage method

### Door Lock member management

As shown in figure 5 below, click on the added locks to enter the lock Operation Interface, as shown in Figure 6 below, click on "Membership management" to enter the interface of Figure 7, click on the top right corner "+" can be prompted to add the management of the door lock operators. Click "Add member" to add and share other members, set the permissions of members.

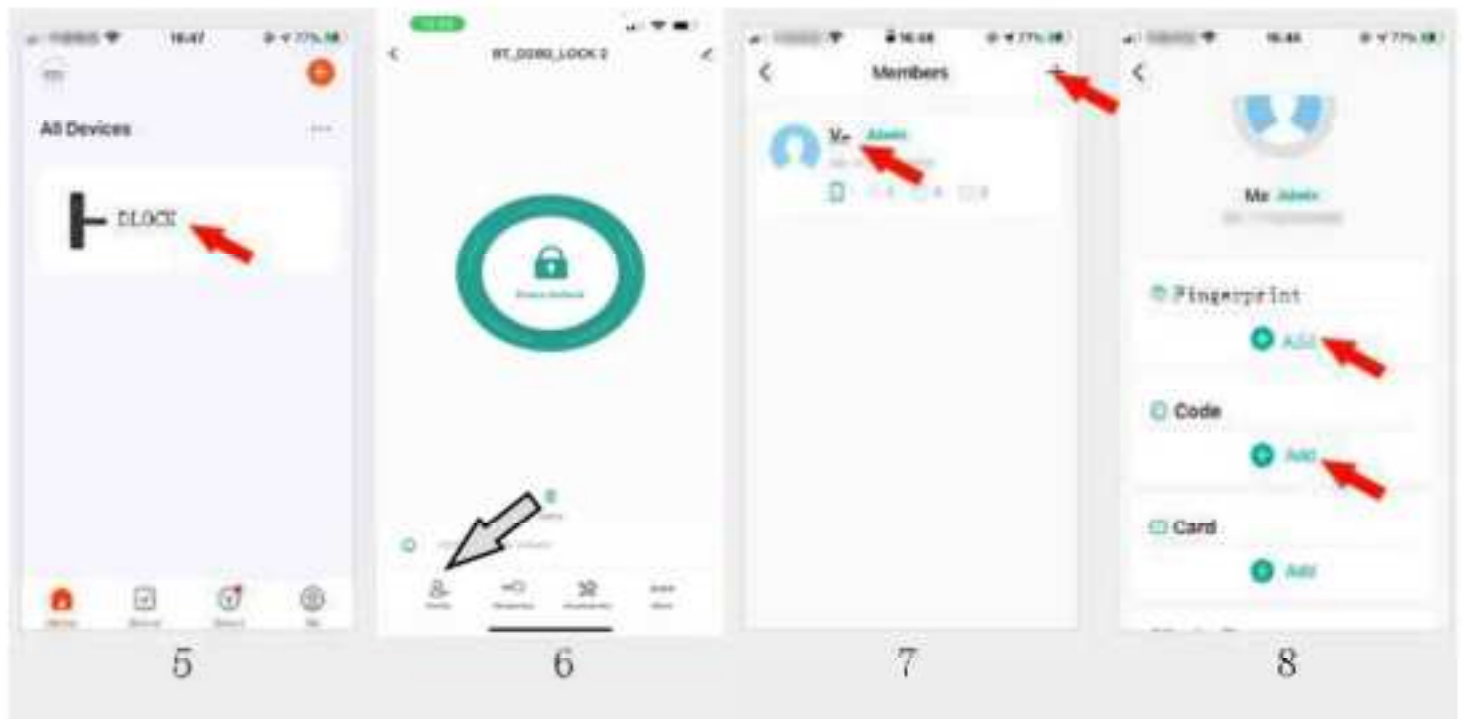

### Add fingerprints, passwords

As shown in figure 7, click "Me", as shown in figure 8, click "Add", according to the prompt for fingerprint, password, input settings, Password set 6-10 digits.

# Programming step 2

## App usage method

### Mobile phone unlock

As shown in Figure 9 below, hold down the key button below and drag it to the right to unlock.



### Set a temporary password

As shown in Figure 10 below, click "Temporary Password" and follow the prompts to set and share a time password.



# Programming step 2

## App usage method

### Power and record

After waking up the door lock, you can display the battery level of the door lock and view the unlocking record on the mobile phone, as shown in Figure 11 below.



### Other function settings

As shown in Figure 12 below, click "Settings" to enter the function menu to set more functions such as "Auto Lock, mute" and so on.



# Programming step 3

## App usage method

### How to delete admin and user

a: Click the button in the upper right corner as shown in Figure 13 below, then click "Remove Device" as shown in Figure 14 below and then click "Unbind and Clear Data" to restore the factory successfully.



### Other function settings

b: Use the reset tool to press the reset button on the hole in the hand after not to put, the red light of the door lock flashing, issued 9 beeps, the sound stops to let go, the light turns green and then goes out. Factory reset successful.

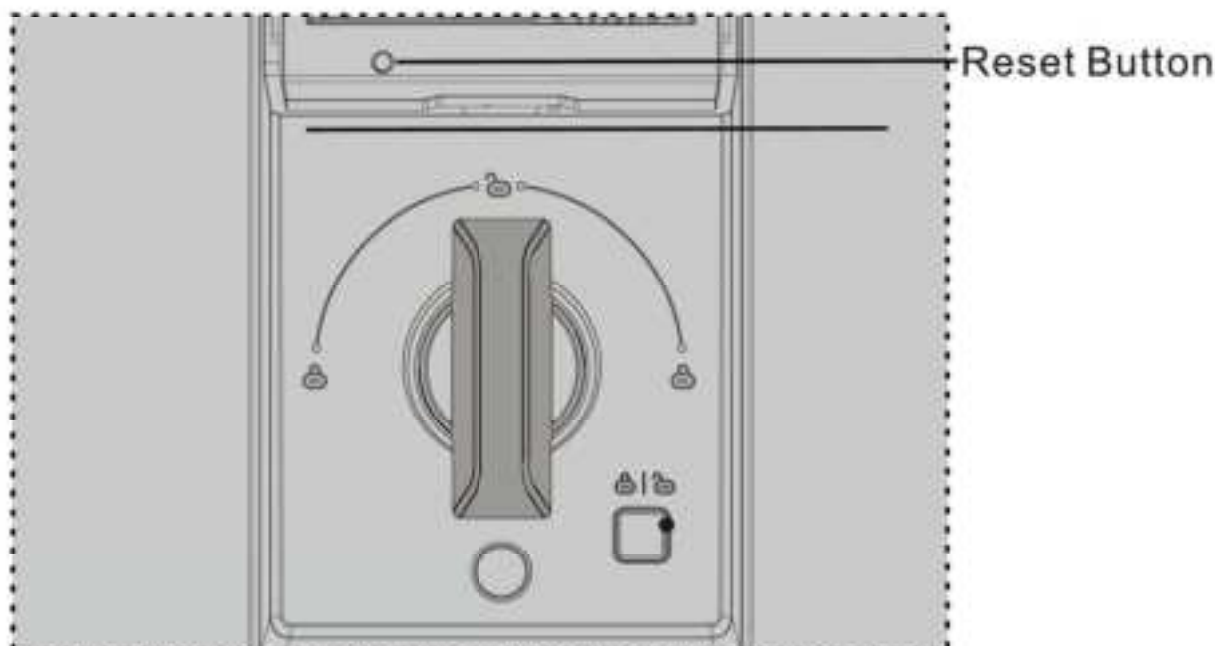



# Programming step 4

## Fast programming

(programming directly on door locks)

### IMPORTANT:

The first time to add an administrator, verify administrator in put any 6-digits, the second time to add users need to verify the administrator code has been set.

1	<b>Add administrator</b>	Press and hold the reset button until hearing 2 beeps, then release the button+ Any 6-8digits++new master code++new master code again+ <b>The administrator password length should be 6-10 digits</b>
2	<b>Add user code</b>	Press and hold the reset button until hearing 2 beeps, then release the button+ Master code++Scan the fingerprint 4 times (6-10 digit password can beset)
3	<b>Add user fingerprint</b>	Press and hold the reset button until hearing 2 beeps, then release the button+ + Master code++Scan the fingerprint 4 times
4	<b>Lock mode</b>	Press 777++ Set Extend Unlock for 1 second to 30 minutes by using Tuya APP (Lock automatically or manually)
5	<b>Voice switch</b>	<b>press"333+</b>
6	<b>Activate Bluetooth</b>	<b>Press 3+ +Master code +</b>
7	<b>Restore factory settings</b>	Press and hold the reset button for 10 seconds,after a sound speaks."initialization succeeded"

Tip: The green light will come on when you program correctly. A bad program will have a red light and a beep, beep, beep

Disclaimer: We reserve the right to change the design due to product improvement without prior notice.

# Troubleshooting

---

## **The product is not electrified after installation**

Please carefully check the installation step 5, check whether the power cord is plugged in, check whether the battery installation direction is correct. Check that the battery cover is installed in the correct direction. All the above checks are OK, Please connect the USB backup power to the front handle. If it can be used normally, it is possible to rip off the power cord during installation

## **Hot batteries consume electricity quickly**

1. Check that the battery cover is installed in the wrong direction.
2. Check if the battery line is squeezed.

## **The user entered a fingerprint or password is not available**

Incorrect programming caused the information storage to fail. Please watch the programming tutorial carefully to re-program.

## **Fingerprint recognition is not sensitive**

Because everyone's fingerprint clearance is different. The area where fingerprints are taken and compared should be consistent. To facilitate fingerprint identification, a finger can be stored as a number of users. As shown in the following figure

## **How can I open the door when the power is out**

Low power conditions will have low alarm. The door can be opened about 200 times after a low alarm. If you forget to replace your battery and you can't open the door, you can plug a power strip into the USB port to open door.

## **Forget the password**

Key can open the door in any case, forget the password can use the key to open the door, and combined with forced recovery factory settings. After reprogramming.

## **Please contact us if you have any further questions**



# Information & Safety Warnings

---

1. Protect your User Codes and Master Code.
2. Restrict access to your lock's interior assembly and routinely check your settings to ensure they have not been altered without your knowledge.
3. Do not use an electric screwdriver during installation
4. This manufacturer advises that no lock can provide complete security by itself
5. This lock may be defeated by forcible or technical means, or evaded by entry elsewhere on the property.
6. No lock can substitute for caution, awareness of your environment, and common sense.
7. Care should be taken to ensure a long-lasting finish. When cleaning is required use a soft, damp cloth. Using lacquer thinner caustic soaps, abrasive cleaners or polishes could damage the coating and result in tarnishing.

## FCC Warning

This device complies with part 15 of the FCC Rules. Operation is subject to the following two conditions: (1) This device may not cause harmful interference, and (2) this device must accept any interference received, including interference that may cause undesired operation.

Any Changes or modifications not expressly approved by the party responsible for compliance could void the user's authority to operate the equipment.

**Note:** This equipment has been tested and found to comply with the limits for a Class B digital device, pursuant to part 15 of the FCC Rules. These limits are designed to provide reasonable protection against harmful interference in a residential installation. This equipment generates uses and can radiate radio frequency energy and, if not installed and used in accordance with the instructions, may cause harmful interference to radio communications. However, there is no guarantee that interference will not occur in a particular installation. If this equipment does cause harmful interference to radio or television reception, which can be determined by turning the equipment off and on, the user is encouraged to try to correct the interference by one or more of the following measures:

- Reorient or relocate the receiving antenna.
- Increase the separation between the equipment and receiver.
- Connect the equipment into an outlet on a circuit different from that to which the receiver is connected.
- Consult the dealer or an experienced radio/TV technician for help.

This equipment complies with FCC radiation exposure limits set forth for an uncontrolled environment. This equipment should be installed and operated with minimum distance 20cm between the radiator & your body.